



ACOUSTIC LUMINAIRE AND BAFFLE SYSTEMS



ACOUSTIC LUMINAIRE AND BAFFLE SYSTEMS

Focal Point acoustic linear luminaires feature modern, eco-friendly, and sound-absorbing housings that can be specified with direct, indirect, or direct/indirect light distributions, or as unlit acoustic baffles.

Seem® 1 Acoustic luminaires leverage the advanced light engine of Seem 1 and can be paired with Seem 1 Acoustic baffles, Seem 1 Acoustic Trio, AirCore Blade or TruBlade™ baffles to create a coordinated lighting and acoustic system.

AirCore Bridge™ marries the superior acoustic performance of AirCore Blade and the many options offered to lighting professionals by Seem 1 Suspended with direct illumination. The result is an integrated acoustic ceiling system that offers unmatched possibilities to control noise and provide optimal lighting.

Focal Point's baffle systems come in a wide range of colors, housing heights, and luminaire lengths, and offer various light distribution options and lumen outputs - all with a narrow aperture. The systems can also be customized to meet the unique needs of each space.

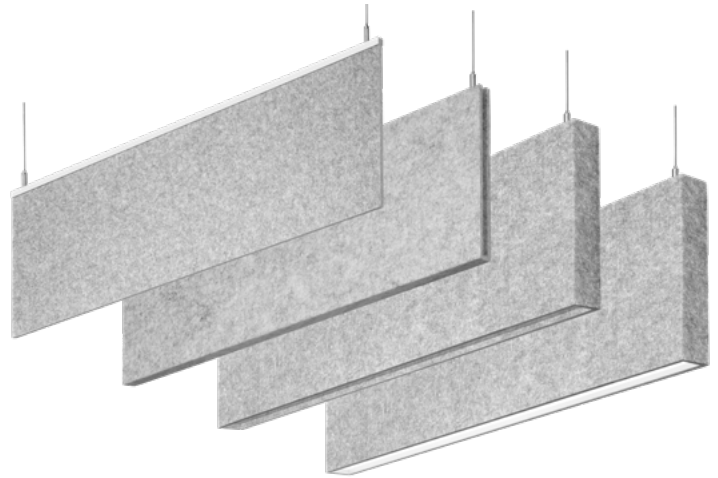

Acoustic Systems Features

- Standard nominal heights of 8", 12" or 16".
- Suspended aircraft cable mounting, Direct to Grid, Direct to Strut, and no mounting hardware options available for select baffles.
- Housing material:
 - 100% polyester containing up to 50% of recycled plastic bottles (PET).
 - Declare Certified, LBC Red List Free.
 - ASTM E-84 Class A / CAN ULC S102 fire rated and moisture resistant.
- Wide range of color options provides design flexibility and personalization for any project.
- Custom lengths, heights, system configurations, and installation methods are available. Consult factory for details.

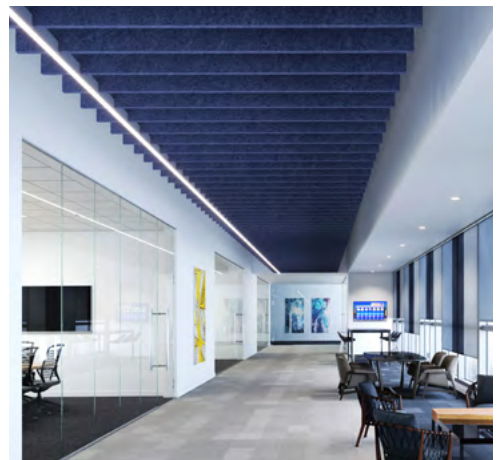
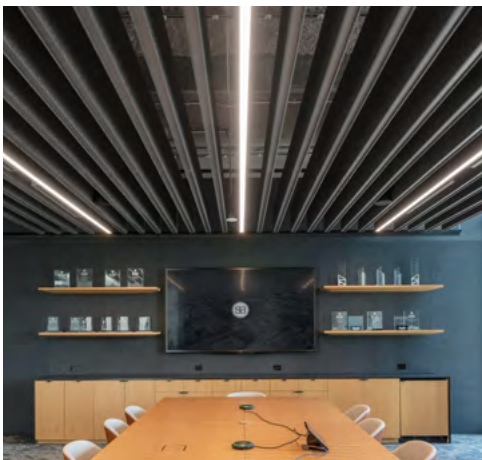
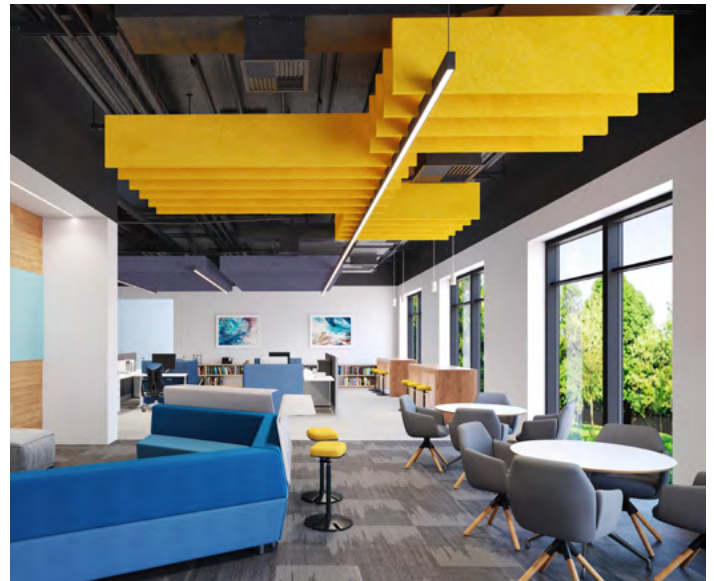

TruBlade™ Features

- 9mm baffle width.
- An economical option to support budget conscious projects.
- Standard lengths available in 2' to 8' lengths in 1" increments.
- Designed to optimize stability and straightness.
- Pair with Seem 1 Acoustic luminaire to create a coordinated look within interior spaces.

AirCore Blade Features

- Slim 1.08" baffle width.
- Supports budget conscious project while meeting the acoustic needs of a space to deliver more comfortable environments.
- Standard lengths available in 2' to 8' lengths in 1" increments.
- Pair with Seem 1 Acoustic luminaire to create a coordinated look within interior spaces.

Seem 1 Acoustic Luminaire Features

- 1.5" lens aperture (2.27" housing width).
- Direct/Indirect, Direct only, Indirect only or unlit baffle options.
- Designed for flexibility to meet the lighting, acoustic, budget, and aesthetic needs of a space.
- Up to 500LF direct and 800LF indirect.
- Driver options: 0-10V, Lutron EcoSystem®, DALI.
- Standard lengths available in 2' to 208' lengths in 1' increments (minimum lengths vary based on distribution).
- Pair with Seem 1 Acoustic Trio, AirCore Blade or TruBlade to create a coordinated look within interior spaces.

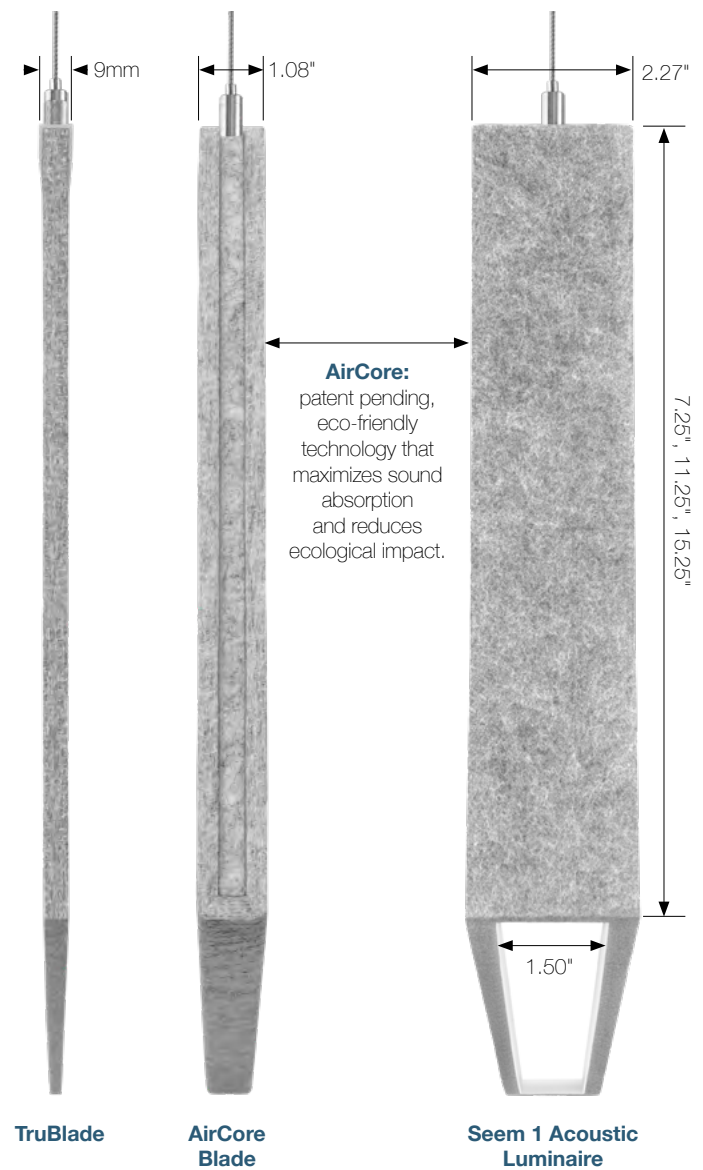

AirCore Bridge™ Features

- Integrated ceiling system using AirCore Blade™ and Seem® 1 Suspended.
- Three standard configurations: Truss, Cantilever, Cantilever Wave with customization ability.
- Lightweight appearance with narrow-aperture acoustic blade and slim linear luminaire with powerful optics.
- Supports diverse applications with baffle lengths from 5' to 8' in 1' increments, with 8", 12" or 16" nominal housing heights and various on-center spacing.
- Luminaire with individual units of 6' minimum and runs up to 208'.
- Ability to combine arrays over large areas.
- Leverages AirCore patent pending, eco-friendly technology to maximize sound absorption and reduce ecological impact.
- Flush, Batwing, and 0.5" Pop-Down lenses meet the lighting needs of each space and enhance the appearance of the array.
- Can be specified as a new array or used to retrofit existing installations using Seem 1 Suspended Direct luminaires.

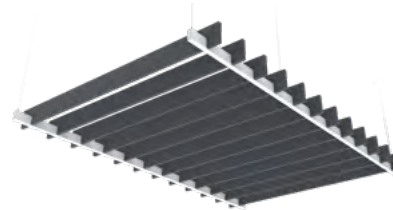

Truss

Truss uses two Seem 1 luminaires as the rails that support AirCore Blade baffles, eliminating all baffle suspension points.

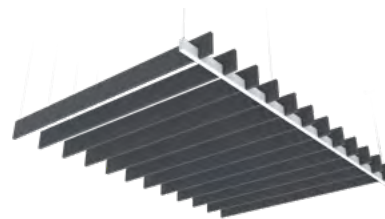

Cantilever

Cantilever creates a visual effect where the AirCore Blade baffles appear to be floating in the space, resting on one Seem 1 luminaire and hanging from the ceiling with a single suspension point at the other extremity.

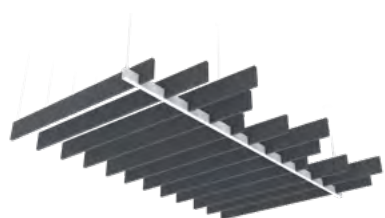

Cantilever Wave

Cantilever Wave adds movement and visual interest to the array with random length baffles resulting in an asymmetric edge.

Acoustic Performance

ASTM C-423 reports are available for all acoustic products. These reports help calculate the quantity of products required to meet the acoustical requirements of a space.

For more information on how to specify acoustic luminaire and baffle systems, or for general inquiries regarding the Focal Point Acoustic Solutions offering, please email acoustic.solutions@focalpointlights.com or contact your Focal Point representative.

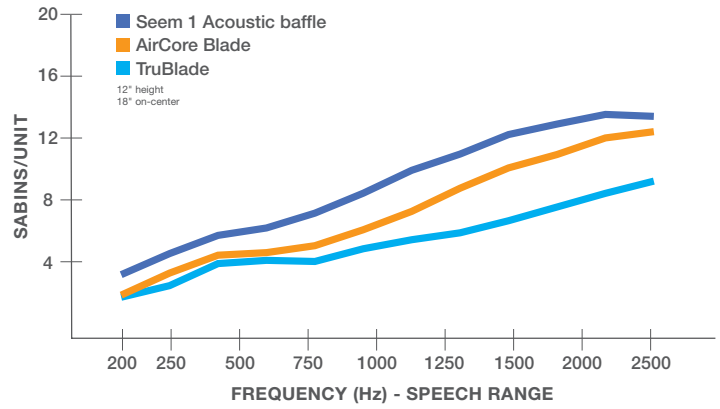

FOCAL POINT®

Bringing It All To Light®



Declare.

9mm PET Felt
Focal Point, LLC

Final Assembly: Chicago, IL, USA

Life Expectancy: 30 Years

End of Life Options: Salvageable/Reusable in its Entirety; Recyclable (100%)

Ingredients:

Polyethylene Terephthalate, Octadecanamide, N,N'-1,2-ethanedithylbis-, Stearic Acid, Benzenepropanoic acid, 3,5-bis(1,1-dimethylethyl)-4-hydroxy-, octadecyl ester, Benzenamine, 4-(1-methyl-1-phenylethyl)-N-[4-(1-methyl-1-phenylethyl)phenyl]-, Titanium Dioxide

Living Building Challenge Criteria:

FPL-0001

VOC Content: N/A

Declaration Status

EXP: 01 FEB 2021

VOC Emissions: CDPH Compliant

☒ LBC Red List Free

☐ LBC Compliant

☐ Declared

MANUFACTURER RESPONSIBLE FOR LABEL ACCURACY
INTERNATIONAL LIVING FUTURE INSTITUTE® declareproducts.com