

# 2.5" id<sup>®</sup> led module & trim

LS2



## FOCAL POINT

DOWNLIGHT

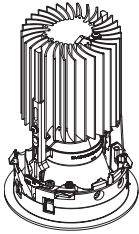

WALL WASH

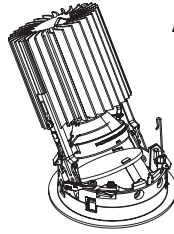

ADJUSTABLE

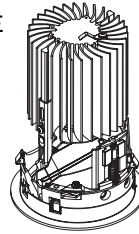

## KEY



POWER OFF



ATTENTION



POWER ON

## WALL WASH



WALL WASH SHIPS IN DOWNLIGHT POSITION

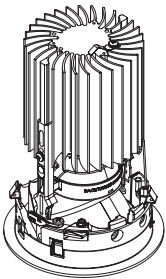

1

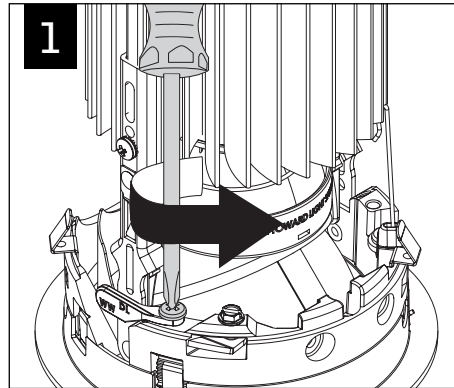

2

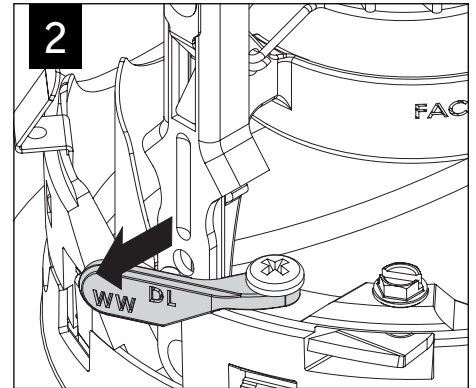

3

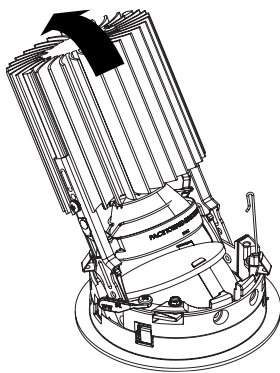

4

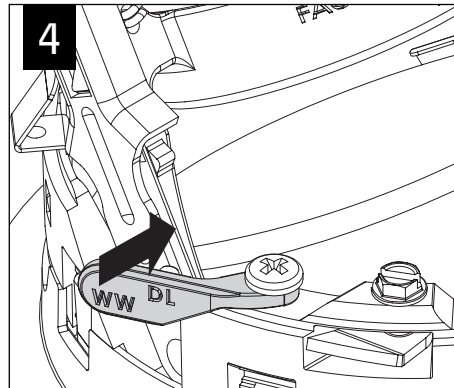

5

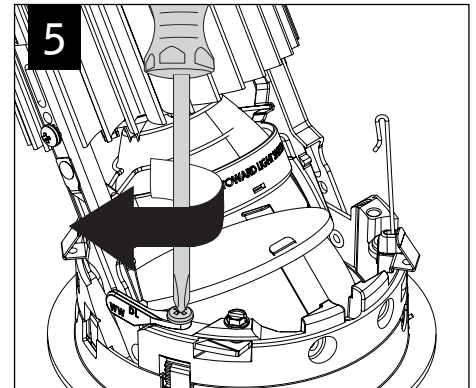

## MODULE INSTALLATION

1

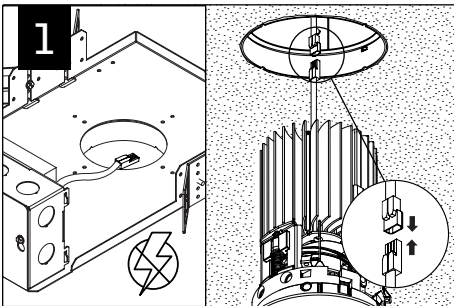

MAKE ELECTRICAL CONNECTION

2

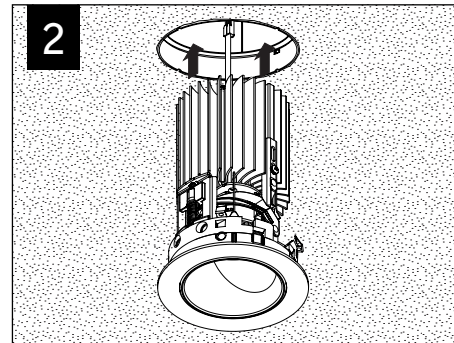

3

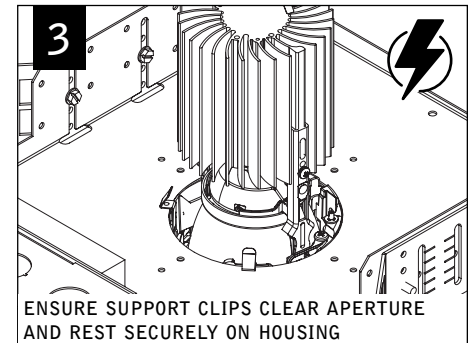

ENSURE SUPPORT CLIPS CLEAR APERTURE AND REST SECURELY ON HOUSING

Luminaires must be installed by a qualified electrician (check with local and national codes for proper installation).  
To prevent electrical shock, disconnect electrical supply before installation or servicing.

Contractor is responsible for adequately reinforcing walls and/or ceilings to support fixture weight. Focal Point, LLC accepts no responsibility for inadequately reinforced walls and/or ceilings. The information contained in this drawing is the sole property of Focal Point, LLC. Any reproduction in part or whole without the written permission of Focal Point, LLC is prohibited.

## TRIM REMOVAL

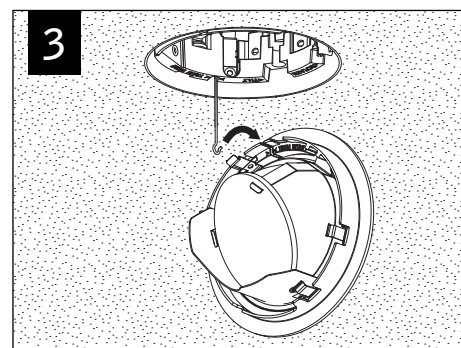
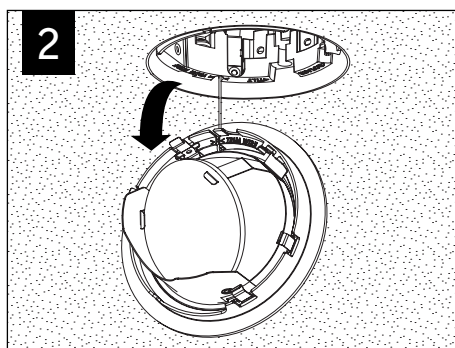
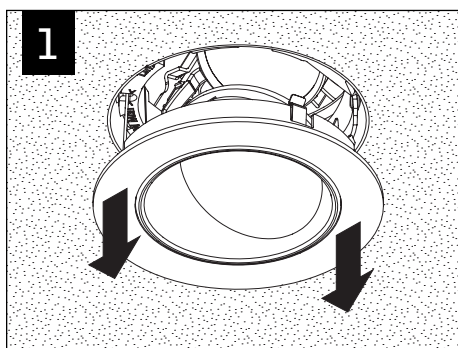

## TILT - ADJUSTABLE ACCENT

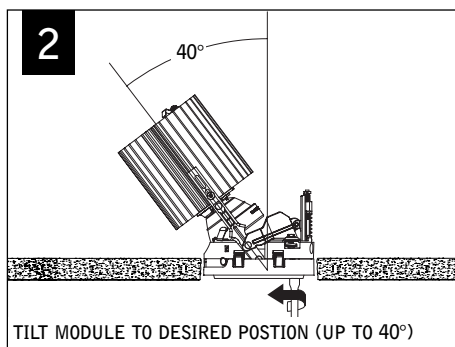
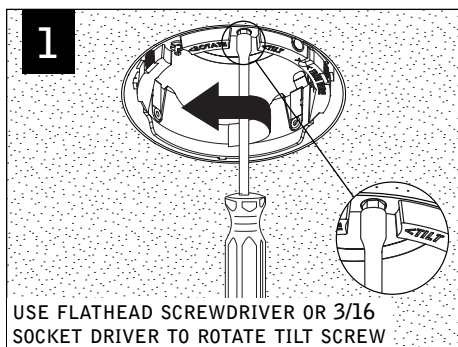

## ROTATE - ADJUSTABLE ACCENT

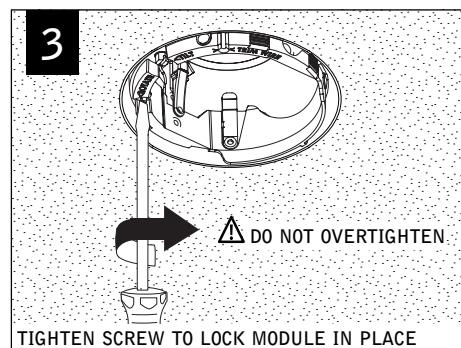
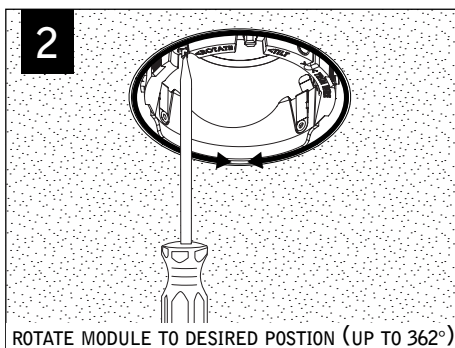
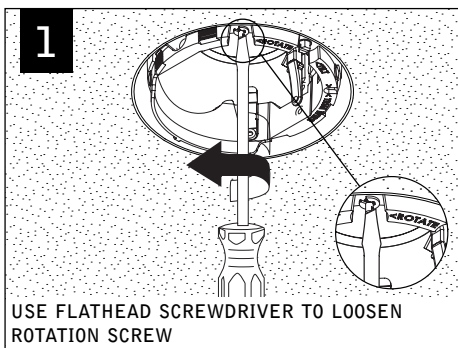

## TRIM INSTALLATION

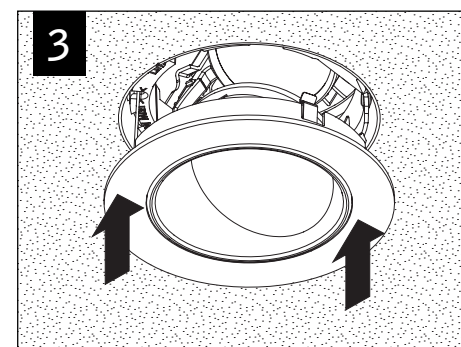
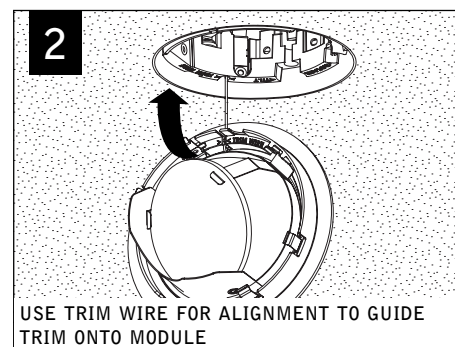
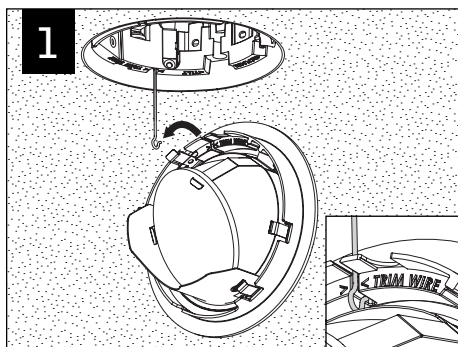

Fixtures must be installed by a qualified electrician (check with local and national codes for proper installation).  
To prevent electrical shock, disconnect electrical supply before installation or servicing.

## OPTIC REPLACEMENT

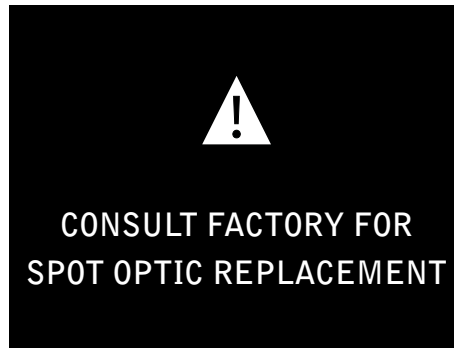
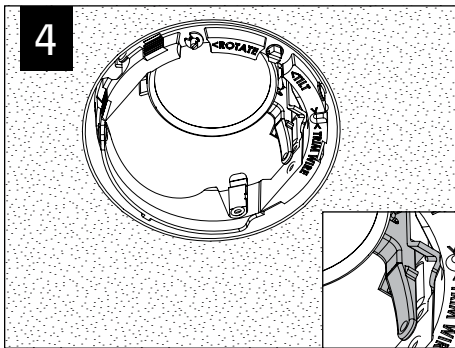
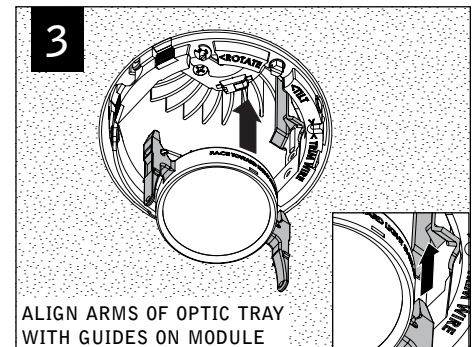
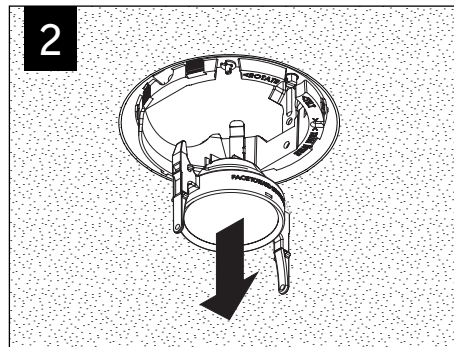
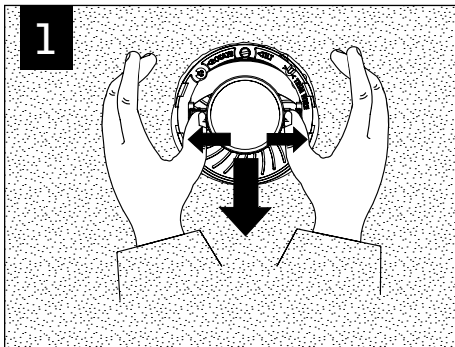

## MODULE REMOVAL

