

# ID+ 2.5" Round Adjustable

FLCS2-RO



## BEFORE YOU BEGIN

- Luminaires must be installed by a qualified electrician (check with local and national codes for proper installation).
- To prevent electrical shock, disconnect electrical supply before installation or servicing.
- Contractor is responsible for adequately reinforcing walls and/or ceilings to support fixture weight.
- Focal Point, LLC accepts no responsibility for inadequately reinforced walls and/or ceilings.
- The information contained in this drawing is the sole property of Focal Point, LLC. Any reproduction in part or whole without the written permission of Focal Point, LLC is prohibited.

## INSTRUCTION KEY



ATTENTION



SEE ADDITIONAL INSTRUCTIONS



POWER OFF



POWER ON



LEVEL

## COMPONENT KEY

### HOUSING

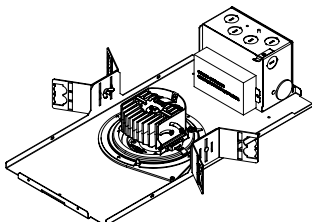

T-Housing

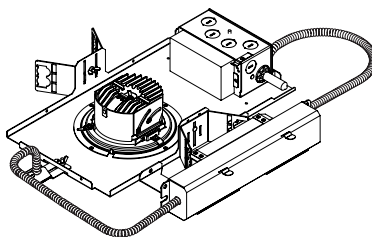

Emergency - Remote Test Switch

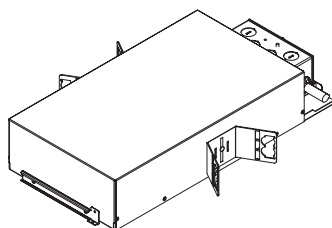

IC & CP Housing

### TRIM

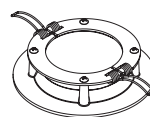

Solite Lens

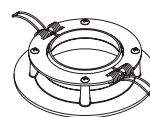

Spot Optic,  
no lens  
0° - 15° tilt

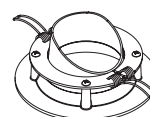

Spot Optic,  
no lens  
15° - 35° tilt

### OPTIONAL BAR HANGERS SOLD SEPARATELY

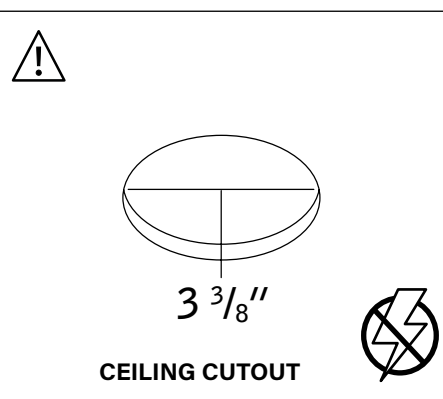
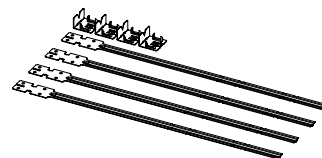

## GRID - 1/2" CONDUIT & CLIP (BY OTHERS)

1 x2

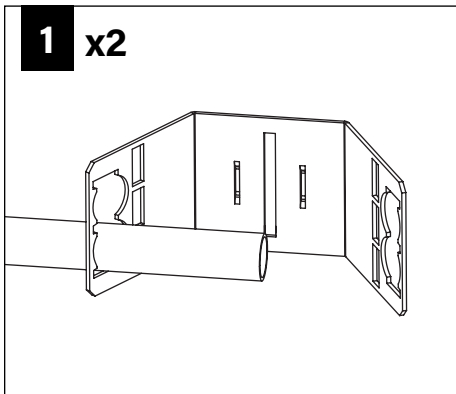

2

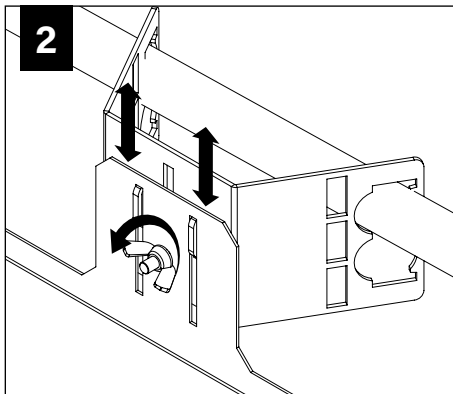

3 x4

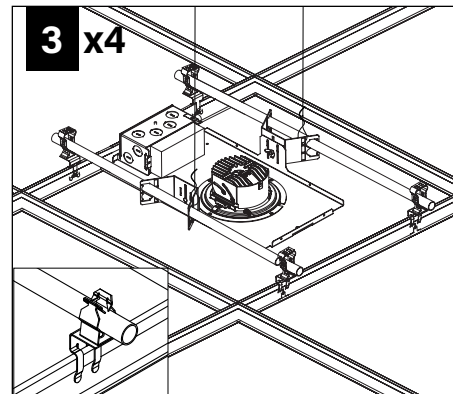

## GRID - BAR HANGERS (SOLD SEPARATELY)

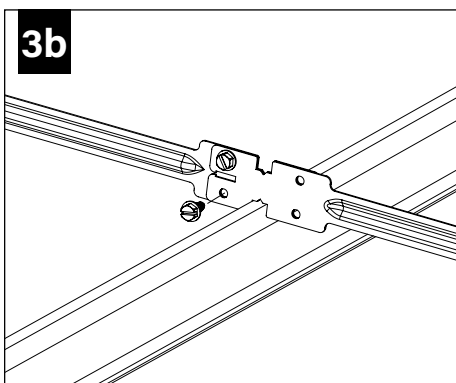
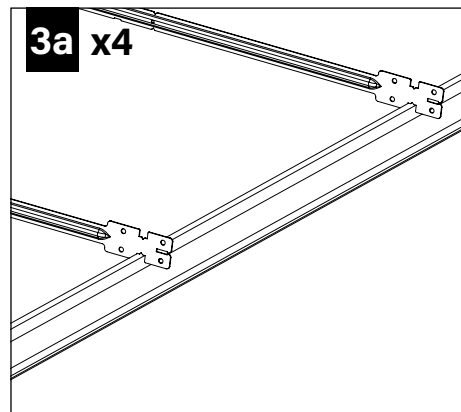
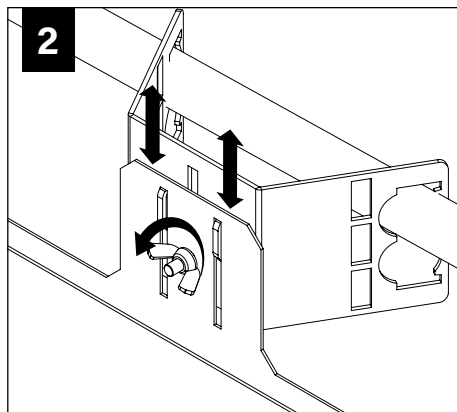
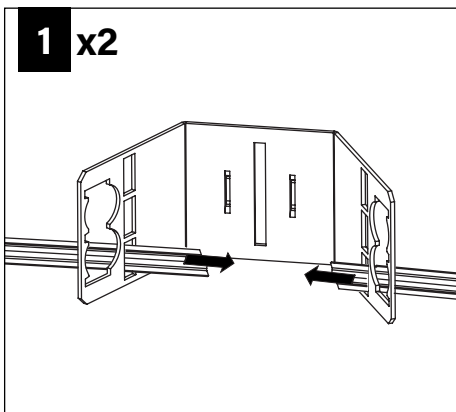

Multiple Luminaires Only

## DRYWALL - BAR HANGERS (SOLD SEPARATELY)

### WOOD STUDS

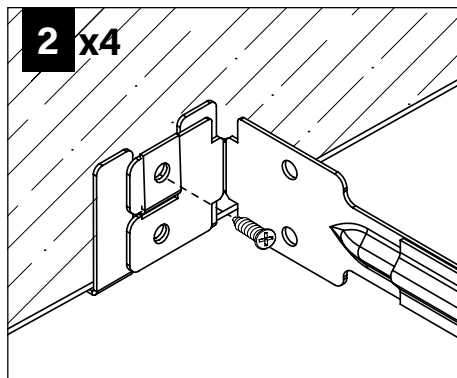
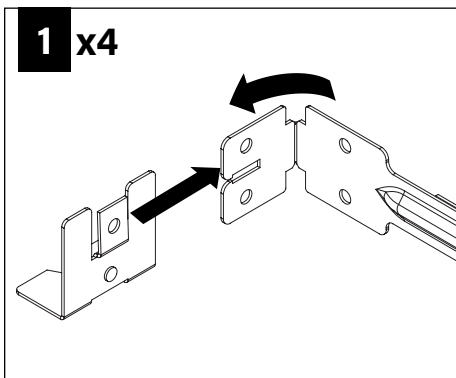

### METAL STUDS

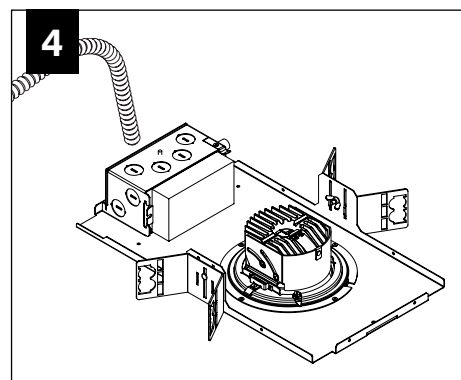
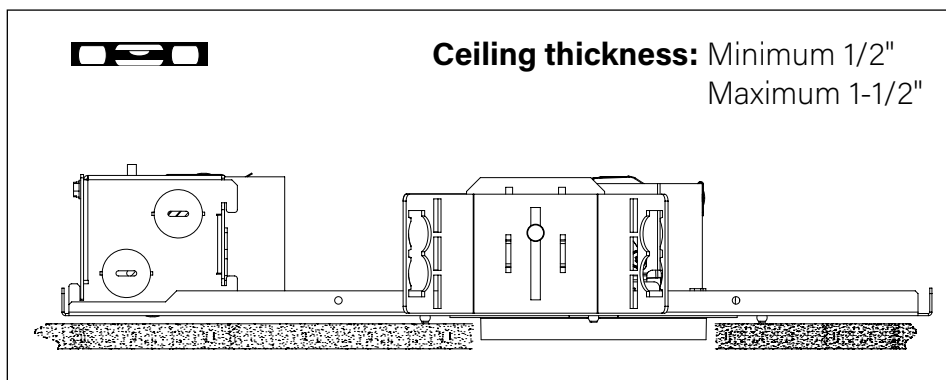
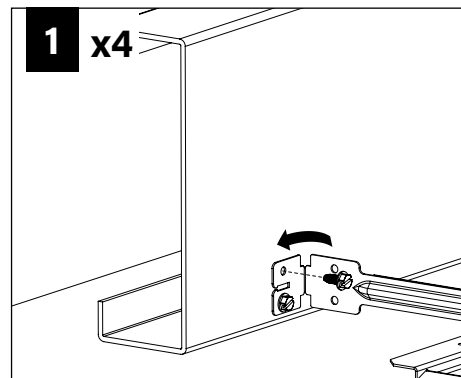

MAKE ELECTRICAL CONNECTION

## EMERGENCY - REMOTE TEST SWITCH

**⚠ ABOVE CEILING ACCESS REQUIRED**

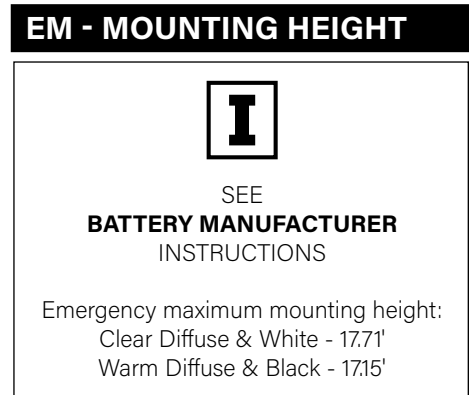
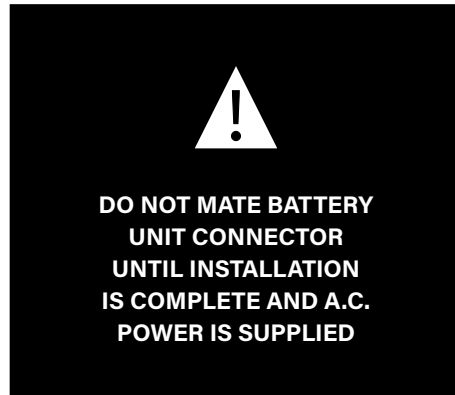
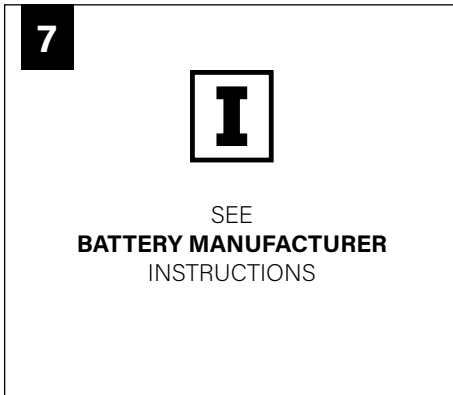
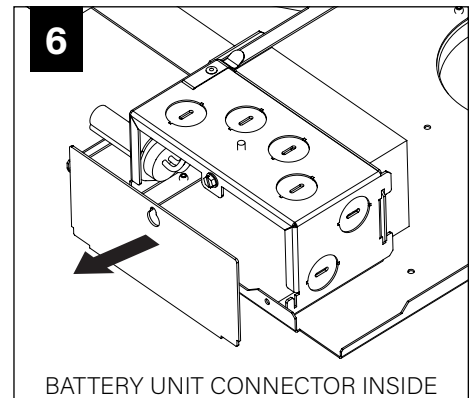
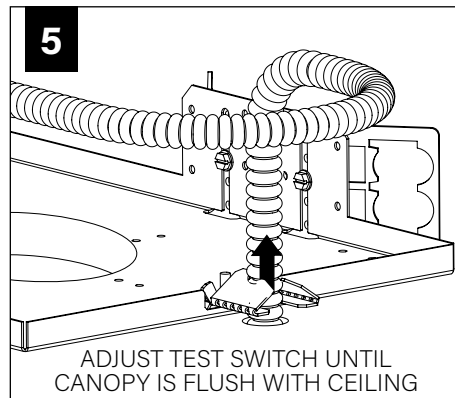
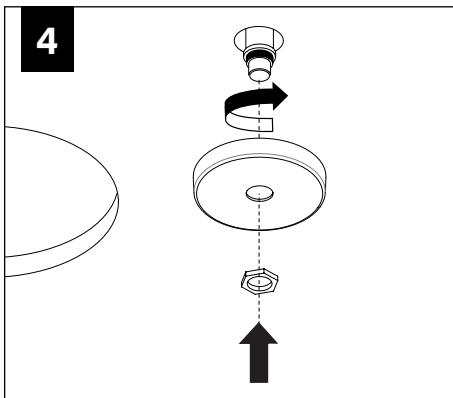
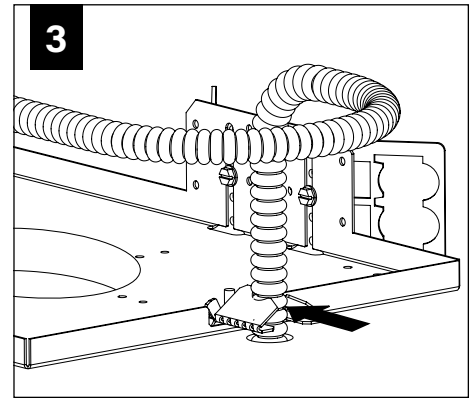
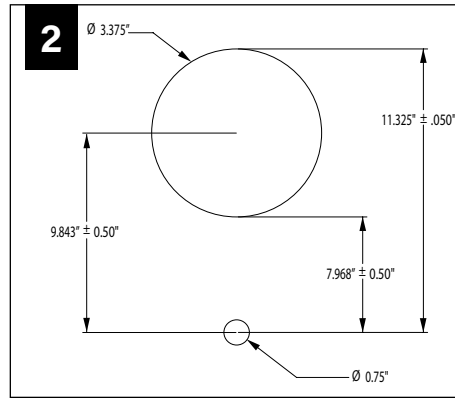
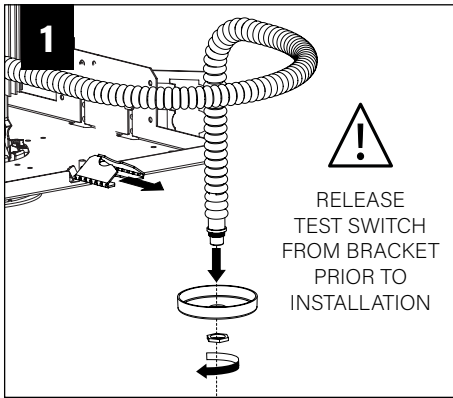

## ROTATE

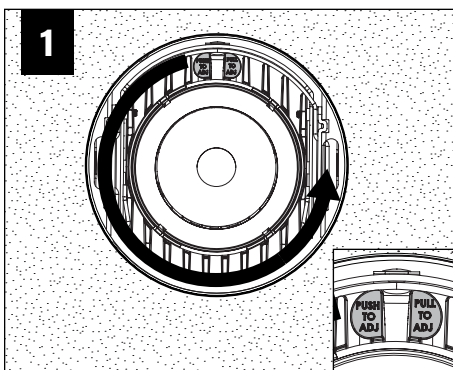

USE ADJUSTMENT HANDLE TO ROTATE UP TO 362°

## TILT

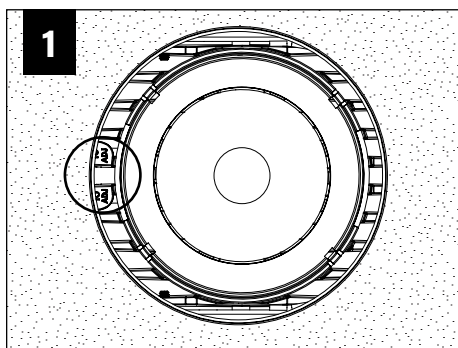

USE ADJUSTMENT HANDLE  
TO TILT UP TO 35°

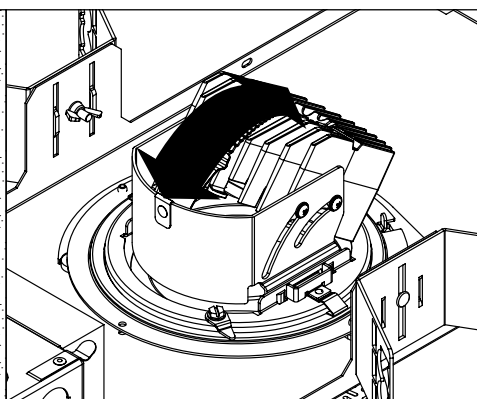
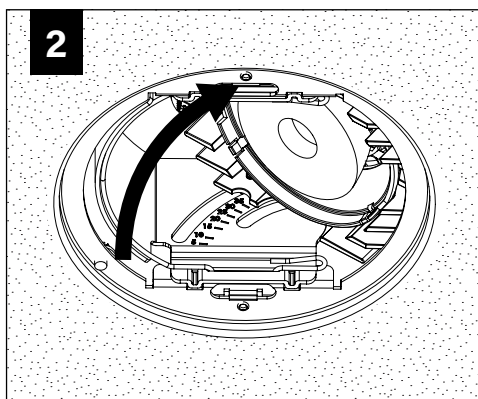

## TRIM INSTALLATION

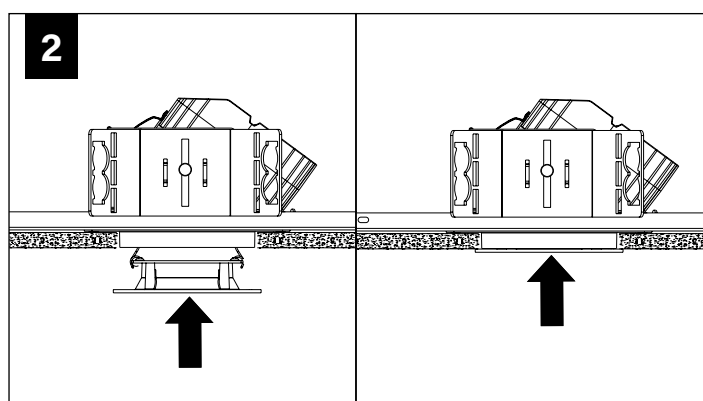
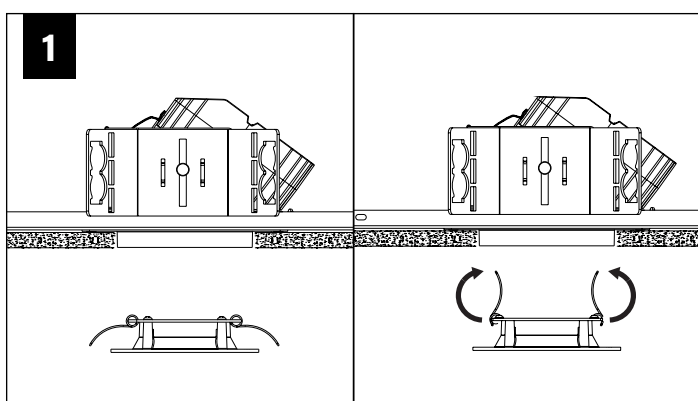

## OPTIC SERVICE



**DISTRIBUTION KITS** INCLUDE AN  
OPTIC AND REFLECTOR ASSEMBLY.

**BOTH ITEMS MUST BE USED**  
TO ACHIEVE SPECIFIED  
DISTRIBUTION.

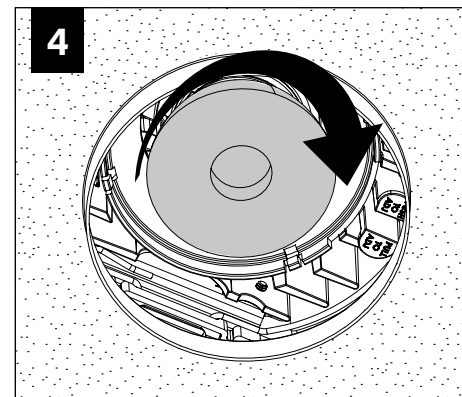
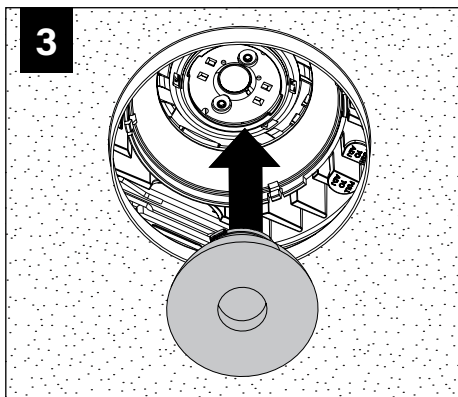
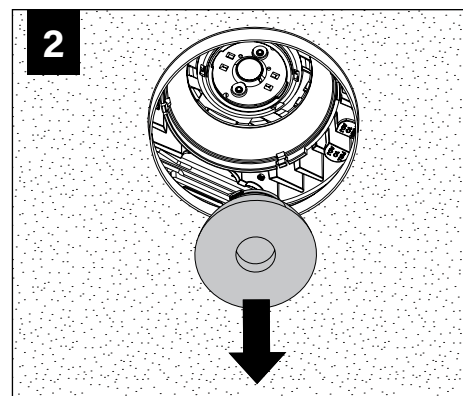
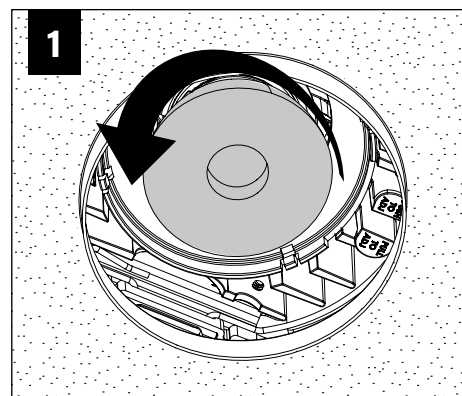

## DRIVER SERVICE

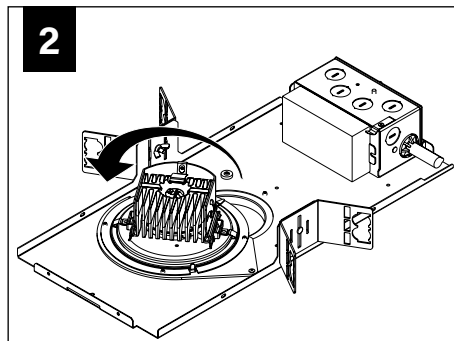
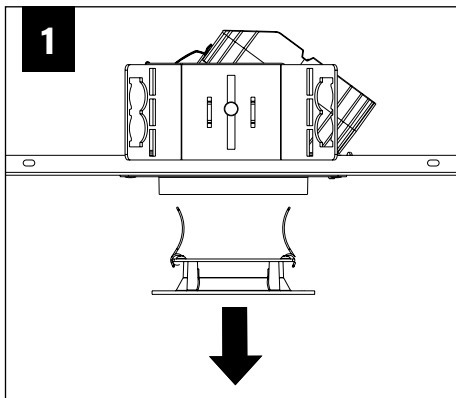

ROTATE ADJUSTMENT MODULE CLEAR OF CEILING OPENING. MODULE HELD IN PLACE MAGNETICALLY.

