

Seem® 2 Grid Ceiling

FSM2L

CONNECTED™
SOLUTIONS

PL Preferred Light
Experience BETTER COLOR



FOCAL POINT®



BEFORE YOU BEGIN

- Luminaires must be installed by a qualified electrician (check with local and national codes for proper installation).
- To prevent electrical shock, disconnect electrical supply before installation or servicing.
- Contractor is responsible for adequately reinforcing walls and/or ceilings to support fixture weight.
- Focal Point, LLC accepts no responsibility for inadequately reinforced walls and/or ceilings.
- The information contained in this drawing is the sole property of Focal Point, LLC. Any reproduction in part or whole without the written permission of Focal Point, LLC is prohibited.

INSTRUCTION KEY



ATTENTION



SEE ADDITIONAL INSTRUCTIONS



POWER OFF



POWER ON

COMPONENT KEY

FOCAL POINT

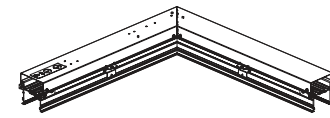

Corner Unit

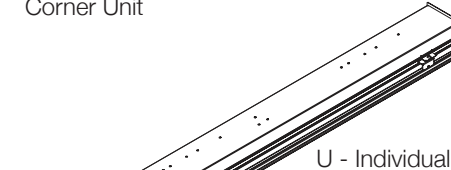

U - Individual



S - Start of Run



I - Intermediate



E - End of Run

PARTS SHIPPED INSTALLED



Joiner Screw
(72074)



Joiner Washer
(700158)

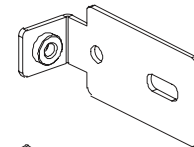

Female
Joiner Bracket
(A47683-01)

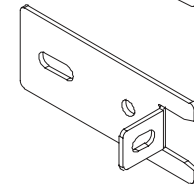

Male
Joiner Bracket
(A47680-02)



AS, BW &
FL Lens



Pop-Down
Lenses



GRID MOUNT ONLY - SPACING FOR ALL GRID TYPES

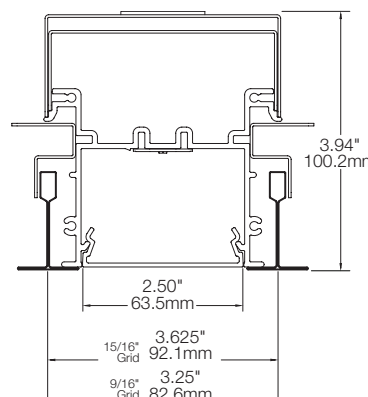

0.5" Pop-down

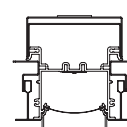

1.5" Pop-down

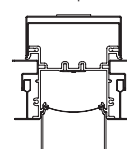

AS, BW, FL lens, Tegral detail

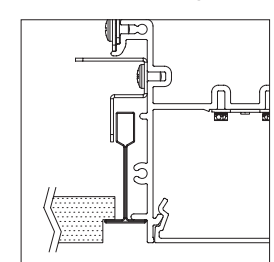

INDIVIDUAL UNITS CANNOT BE
JOINED IN THE FIELD.

CORNER ASSEMBLY

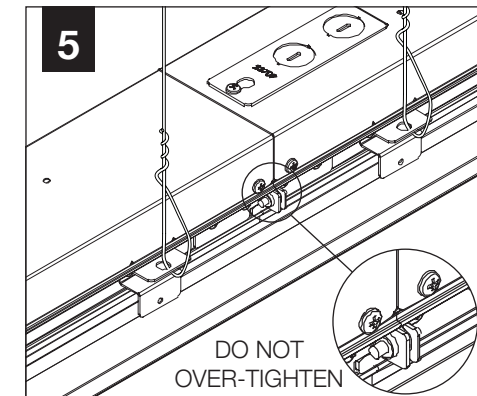
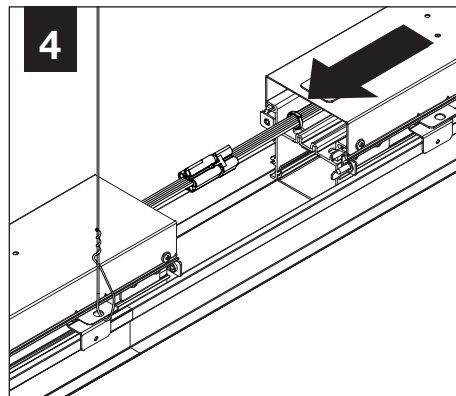
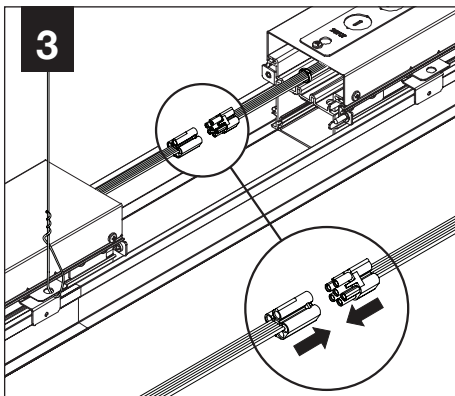
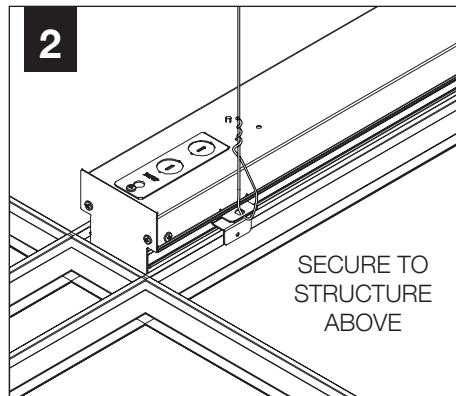
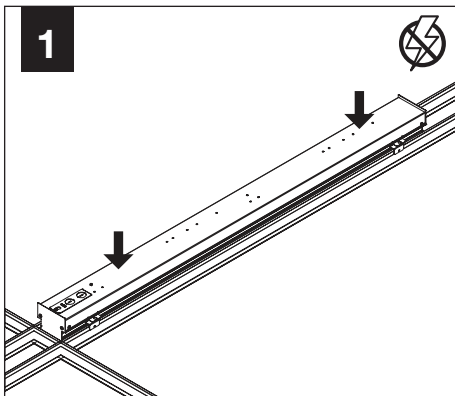
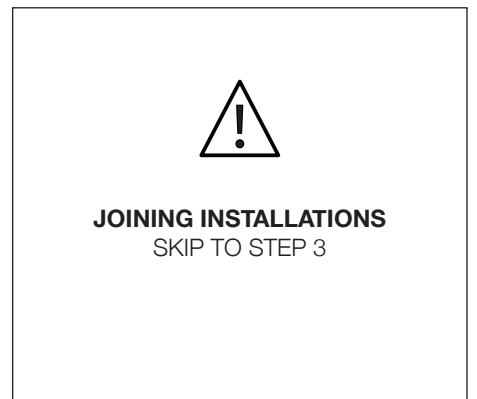
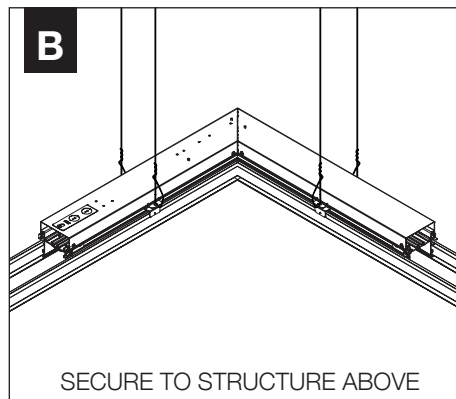
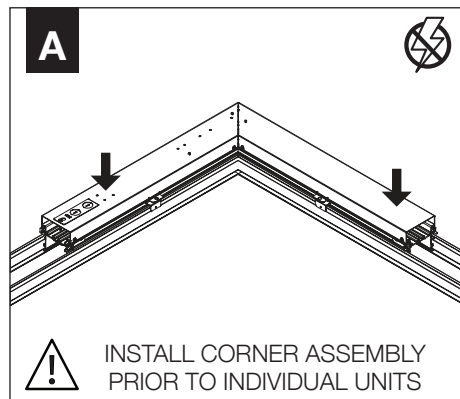

SECURE TO STRUCTURE ABOVE

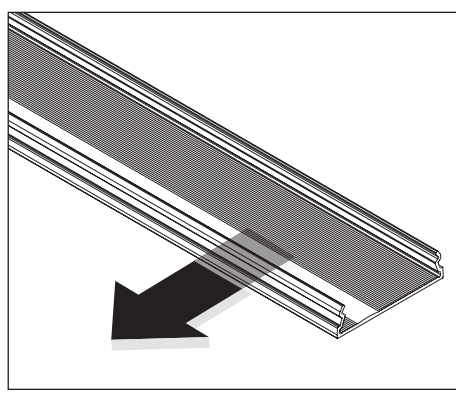
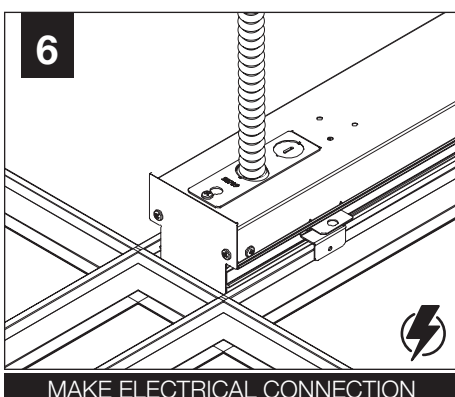

Asymmetric Lens Distribution Direction

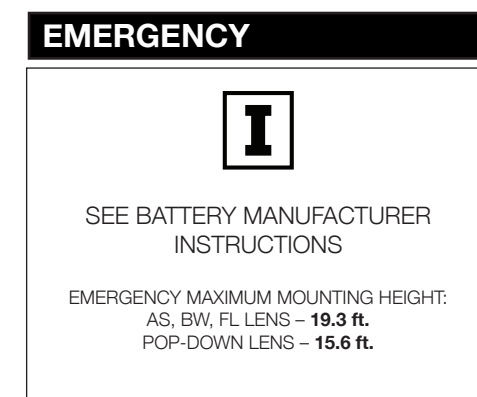

DRIVER SERVICE

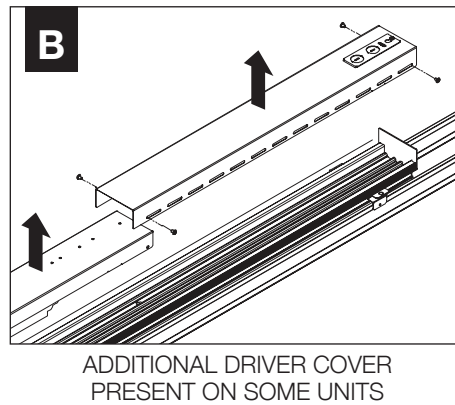
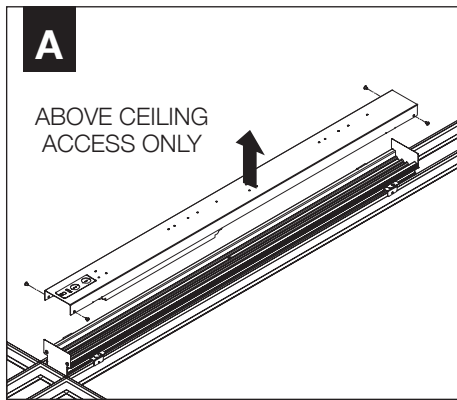

ACUITY nLIGHT

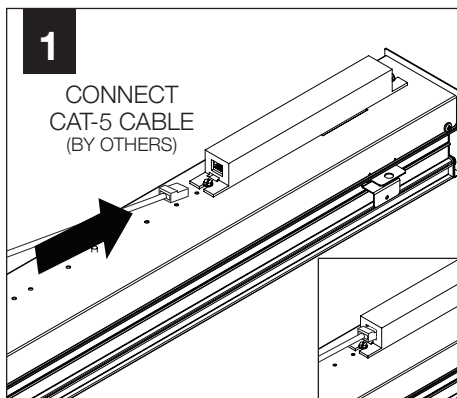

WATTSTOPPER

