

id[®] led 6" round housing - downlight

FL6D



**LUMINAIRE MUST BE INSTALLED PRIOR TO DRYWALL CEILING.
ALL GRID LUMINAIRES MUST BE SECURED TO STRUCTURE ABOVE.**



NON-EMERGENCY

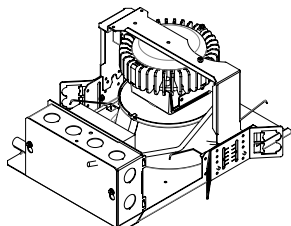

OPTIONAL - BAR HANGERS SOLD SEPARATELY

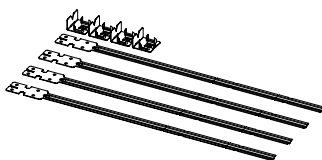

KEY



POWER OFF



POWER ON



LEVEL



ATTENTION



SEE ADDITIONAL INSTRUCTIONS

EMERGENCY - INTEGRAL TEST SWITCH

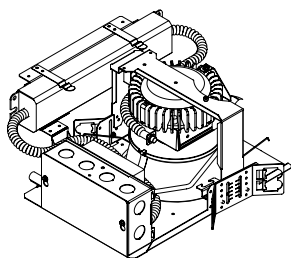

EMERGENCY - REMOTE TEST SWITCH

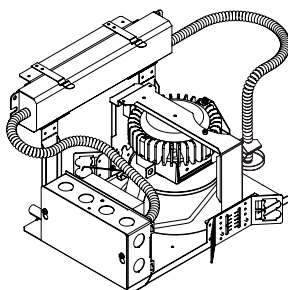

1

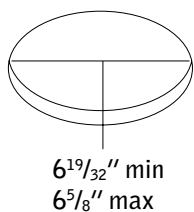

6 19/32" min
6 5/8" max



GRID - 1/2" CONDUIT & CLIP (BY OTHERS)

2 x2

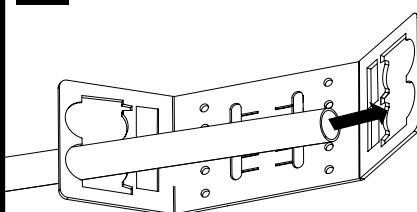

3 x4

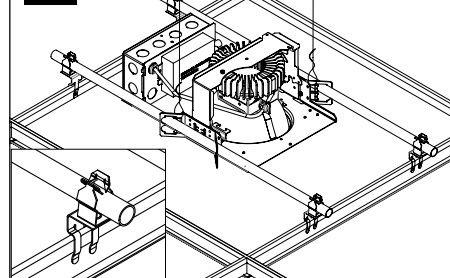

GRID - BAR HANGERS (SOLD SEPARATELY)

2 x2

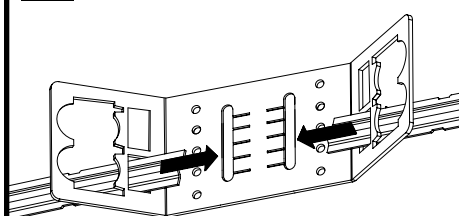

3a x4

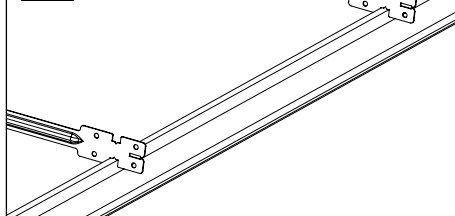

3b multiple luminaires only

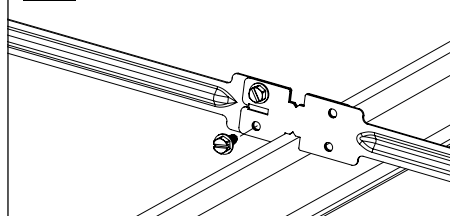

Luminaires must be installed by a qualified electrician (check with local and national codes for proper installation).
To prevent electrical shock, disconnect electrical supply before installation or servicing.

DRYWALL - BAR HANGERS (SOLD SEPARATELY)

2 x2

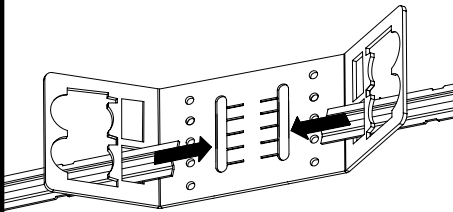

WOOD STUDS

3a x4

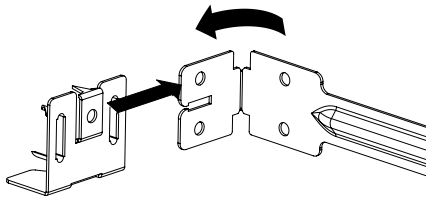

3b x4

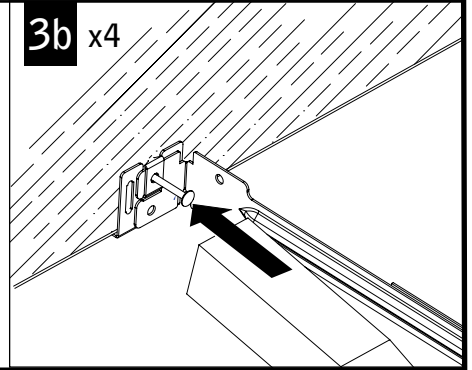

METAL STUDS

3 x4

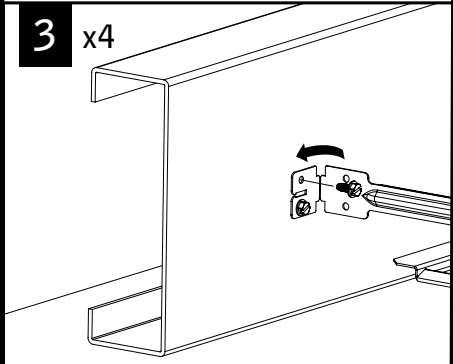

4

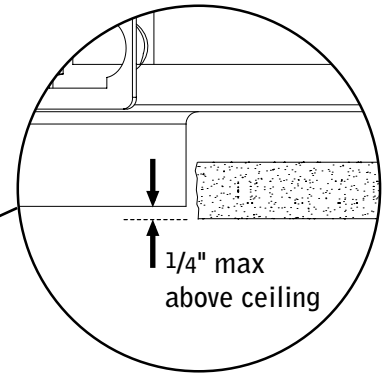
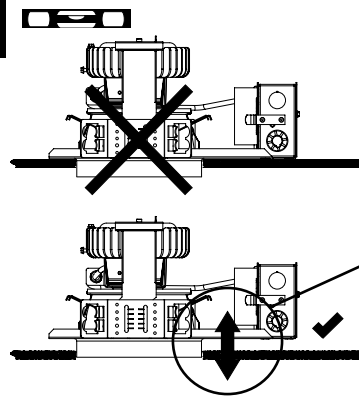

5

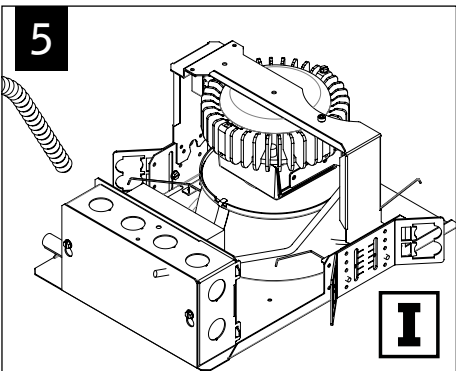

MAKE ELECTRICAL CONNECTIONS

EMERGENCY

A

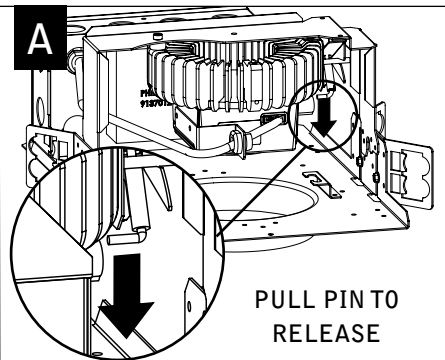

B

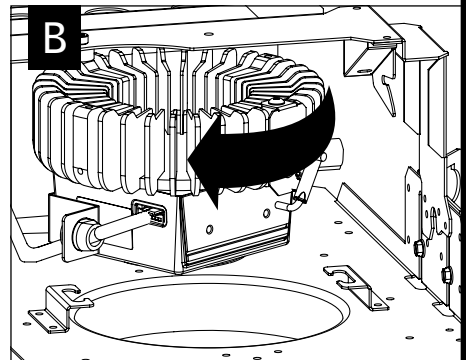

C

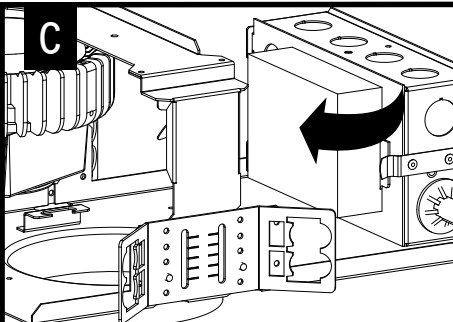

BATTERY UNIT CONNECTOR INSIDE

D



SEE BATTERY
MANUFACTURER
INSTRUCTIONS



DO NOT MATE CONNECTOR
UNTIL INSTALLATION
IS COMPLETE AND A.C.
POWER IS SUPPLIED

Fixtures must be installed by a qualified electrician (check with local and national codes for proper installation).
To prevent electrical shock, disconnect electrical supply before installation or servicing.

EMERGENCY - REMOTE TEST SWITCH ONLY

E

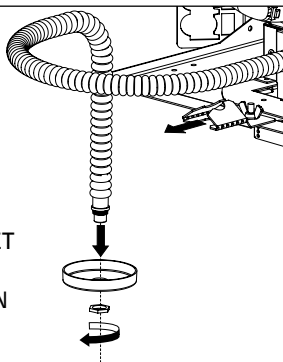

RELEASE
INDICATOR
FROM BRACKET
PRIOR TO
INSTALLATION

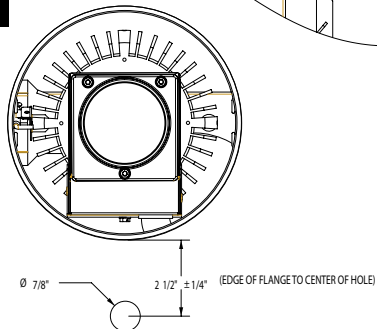

F

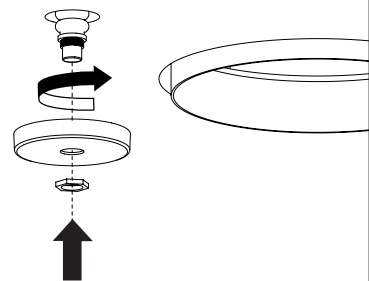

G



H

ADJUST INDICATOR UNTIL
CANOPY IS FLUSH WITH CEILING

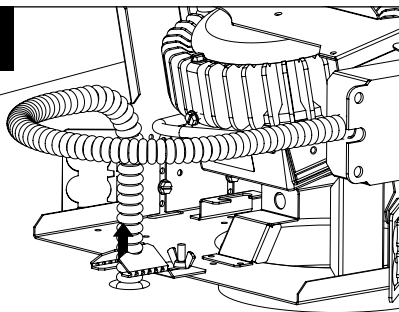

LIGHT MODULE SERVICE



NOTE:
3MM HEX KEY REQUIRED

1

REMOVE TRIM
SEE TRIM REMOVAL ON
FOCAL POINT INSTRUCTION
SHEET IS0288

2

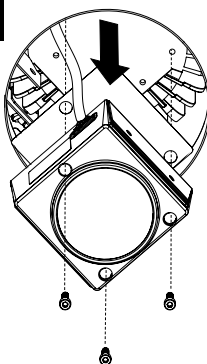

KEEP
THERMAL
PAD FOR
REINSTALL

3

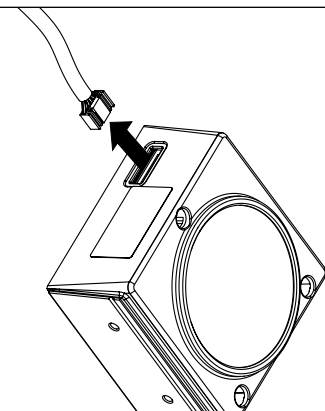

4

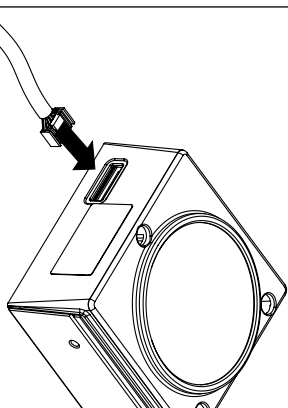

5

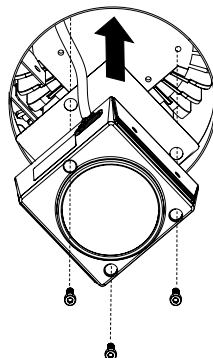

REPLACE
THERMAL
PAD

Fixtures must be installed by a qualified electrician (check with local and national codes for proper installation).
To prevent electrical shock, disconnect electrical supply before installation or servicing.

DRIVER SERVICE

1

REMOVE TRIM
SEE TRIM REMOVAL ON
FOCAL POINT INSTRUCTION
SHEET IS0288

2

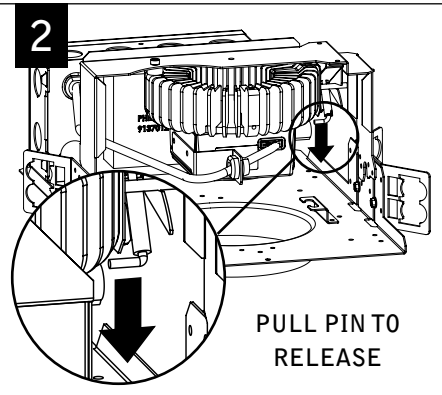

3

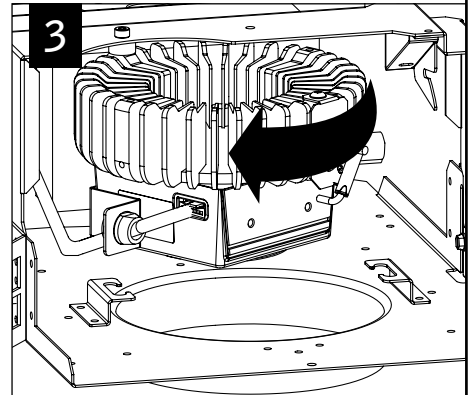

4

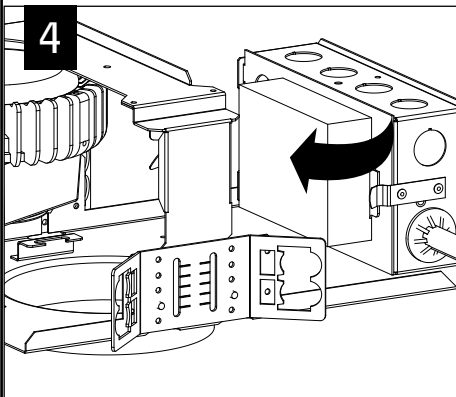

WIRING DIAGRAM

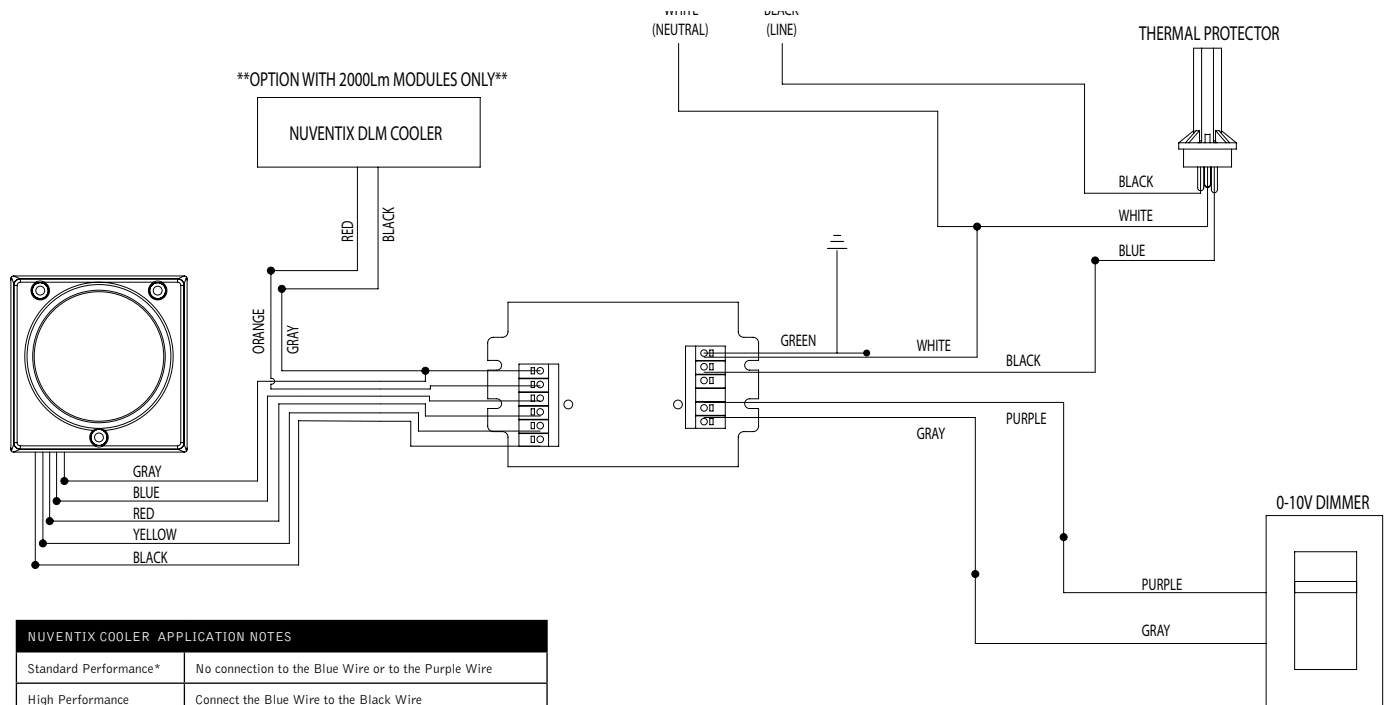

* Default Setting Level if control not used

Contractor is responsible for adequately reinforcing walls and/or ceilings to support fixture weight. Focal Point, LLC accepts no responsibility for inadequately reinforced walls and/or ceilings. The information contained in this drawing is the sole property of Focal Point, LLC. Any reproduction in part or whole without the written permission of Focal Point, LLC is prohibited.