

id+ 4.5" round adjustable

FLCS4 | LCS4



**LUMINAIRE MUST BE INSTALLED PRIOR TO DRYWALL CEILING.
ALL GRID LUMINAIRES MUST BE SECURED TO STRUCTURE ABOVE.**



FOCAL POINT

NON-EMERGENCY - T RATED

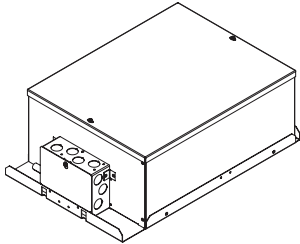

EMERGENCY - REMOTE TEST SWITCH

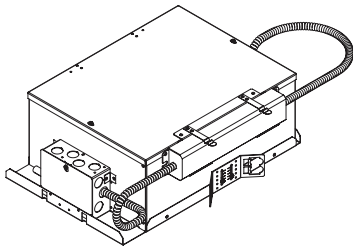

PARTS

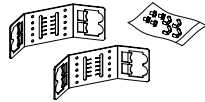

OPTIONAL - BAR HANGERS SOLD SEPARATELY

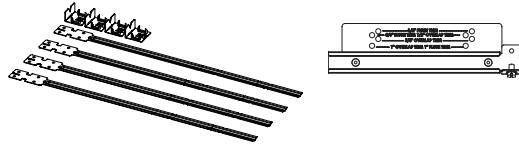

TRIM

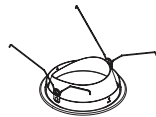

ADJUSTABLE ACCENT

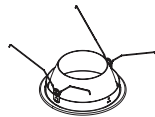

DOWNLIGHT

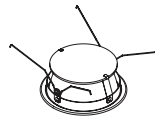

REGRESS CLEAR/
SOLITE LENS

KEY



POWER OFF



ATTENTION



POWER ON



LEVEL



SEE ADDITIONAL INSTRUCTIONS

1

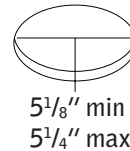

overlap

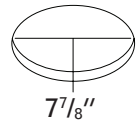

flush

GRID

2 x2

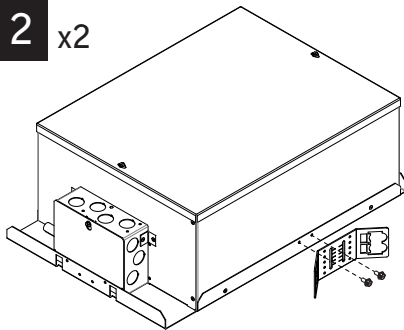

GRID - 1/2" CONDUIT & CLIP (BY OTHERS)

3 x2

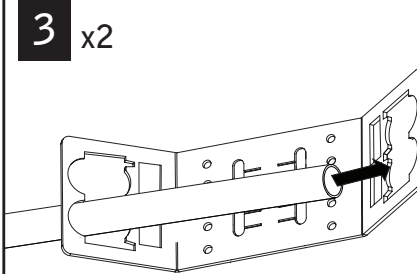

4 x4

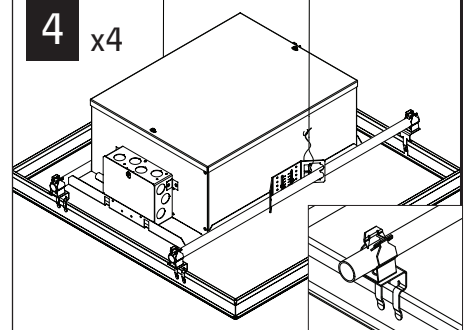

GRID - BAR HANGERS (SOLD SEPARATELY)

3 x2

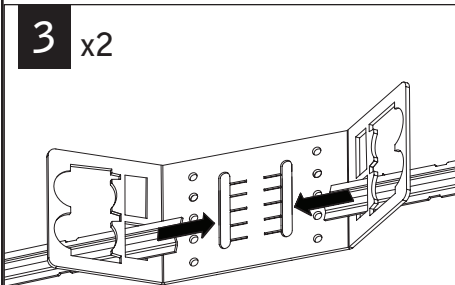

4a x4

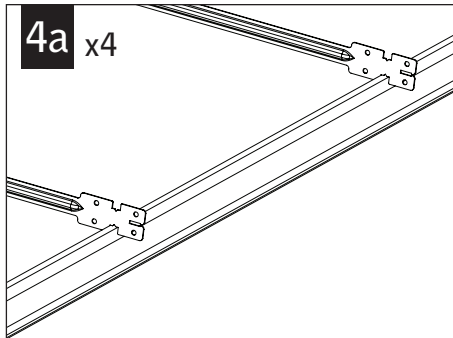

4b multiple luminaires only

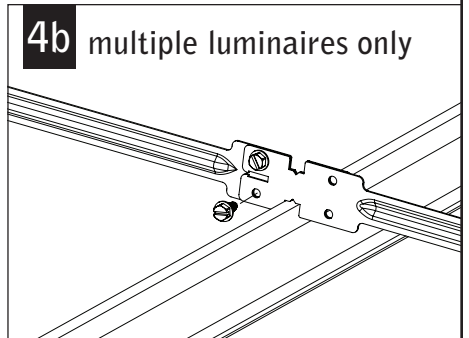

Luminaires must be installed by a qualified electrician (check with local and national codes for proper installation).
To prevent electrical shock, disconnect electrical supply before installation or servicing.

DRYWALL - BAR HANGERS (SOLD SEPARATELY)

2a



SELECT CEILING THICKNESS/TRIM TYPE

..... 1/2" FLUSH TRIM
 5/8" FLUSH TRIM 1/2" OVERLAP TRIM
 5/8" OVERLAP TRIM
 1" OVERLAP TRIM 1" FLUSH TRIM

2b

x4

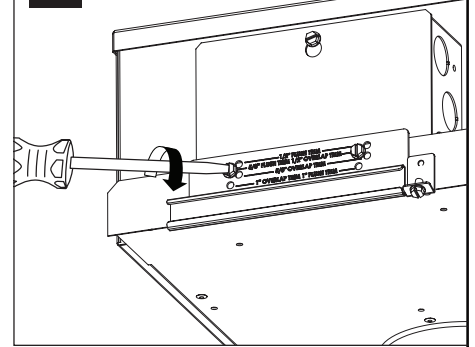

3

x2

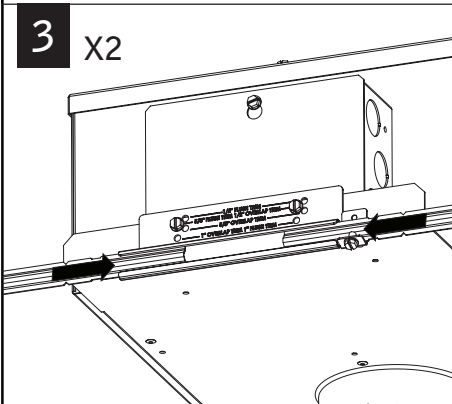

WOOD STUDS

4a

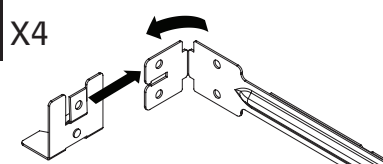

4b

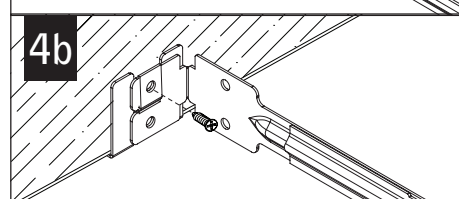

METAL STUDS

4

x4

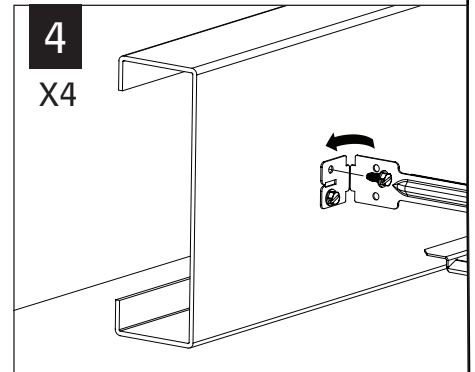

5

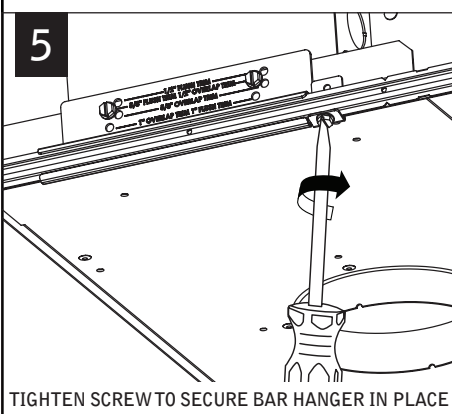

TIGHTEN SCREW TO SECURE BAR HANGER IN PLACE

6

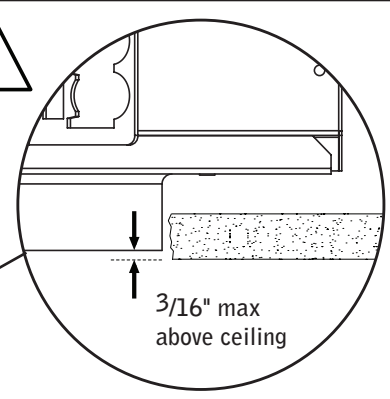
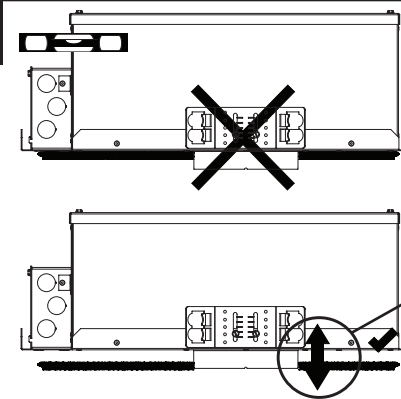

3/16" max
above ceiling

7

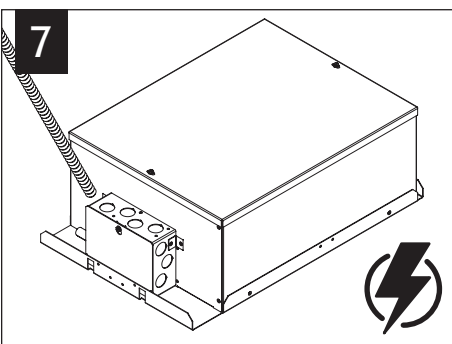

MAKE ELECTRICAL CONNECTIONS

FLUSH TRIM MUD-IN

1

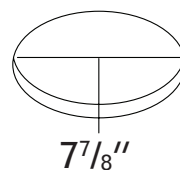

7 1/8"

2

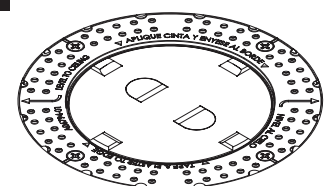

DO NOT REMOVE DUST COVER UNTIL
TAPE AND MUD-IN COMPLETE

Luminaires must be installed by a qualified electrician (check with local and national codes for proper installation).
 To prevent electrical shock, disconnect electrical supply before installation or servicing.

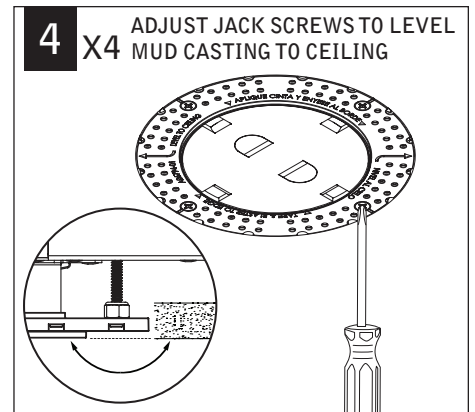
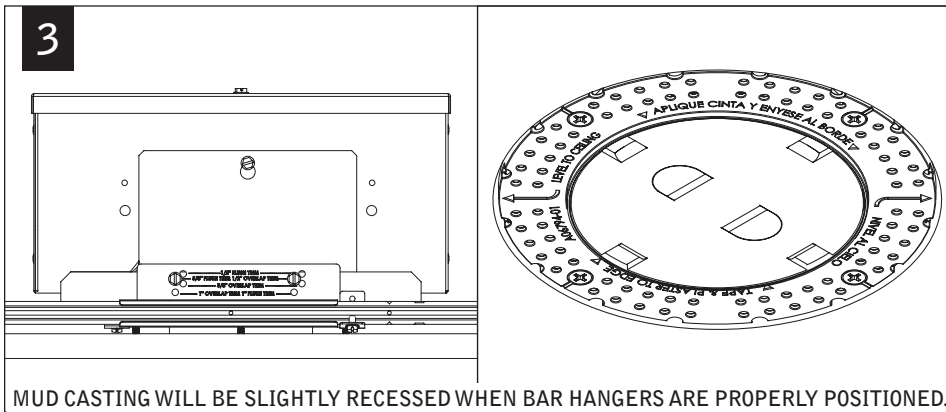

EMERGENCY



EMERGENCY - INTEGRAL TEST SWITCH ⚠ ABOVE CEILING ACCESS REQUIRED ⚠

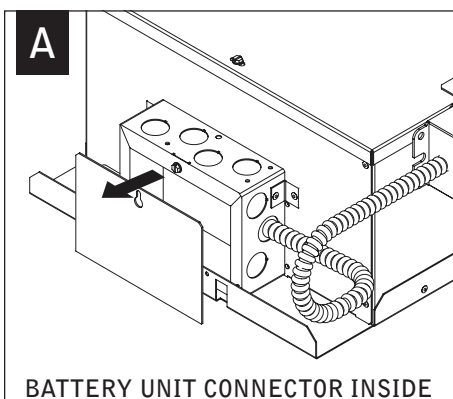

EMERGENCY - REMOTE TEST SWITCH ⚠ ABOVE CEILING ACCESS REQUIRED ⚠

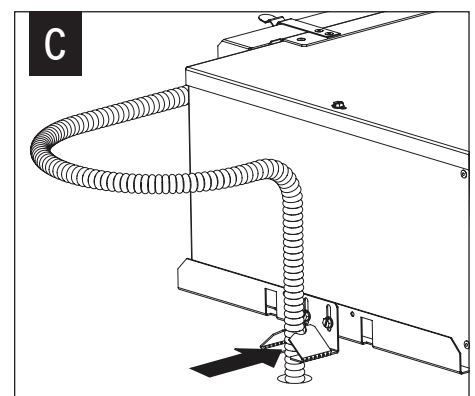
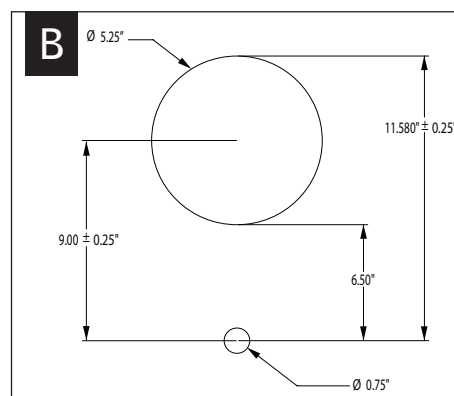
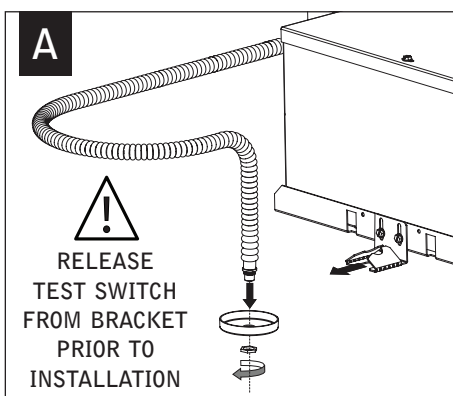

Luminaires must be installed by a qualified electrician (check with local and national codes for proper installation).
To prevent electrical shock, disconnect electrical supply before installation or servicing.

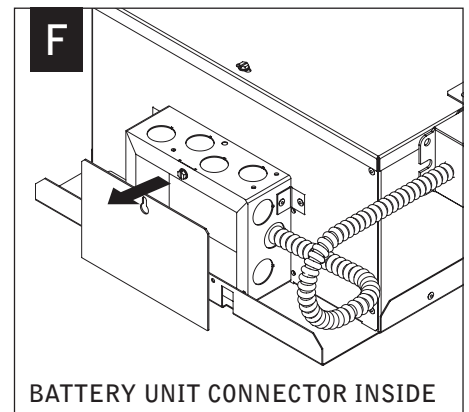
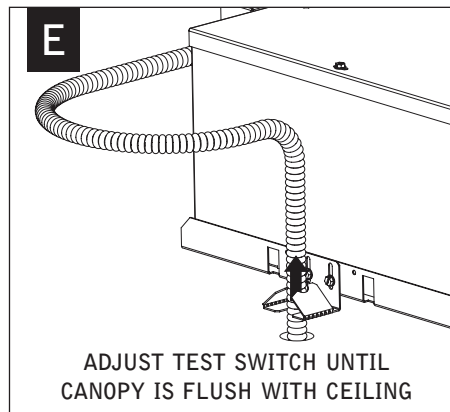
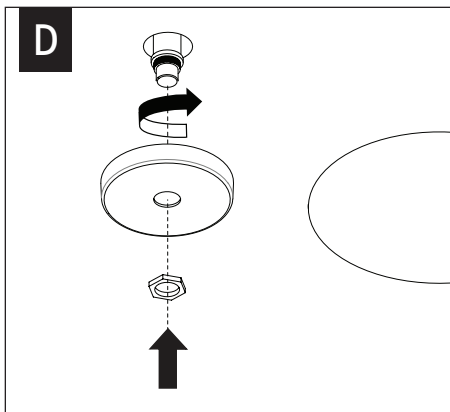

TILT

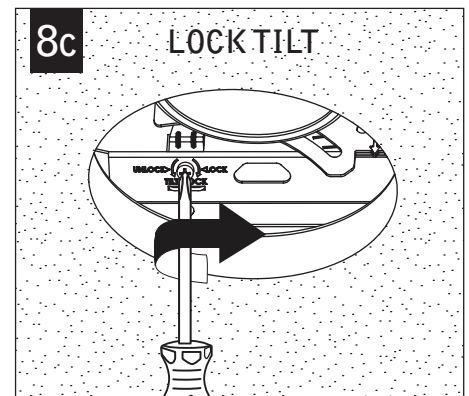
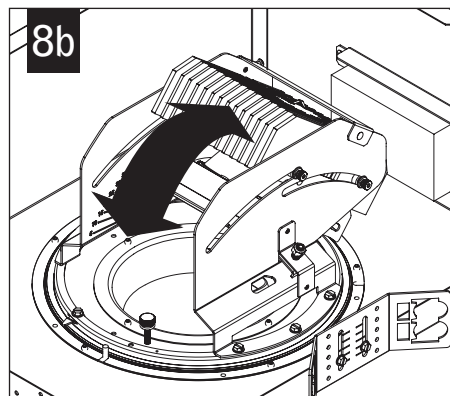
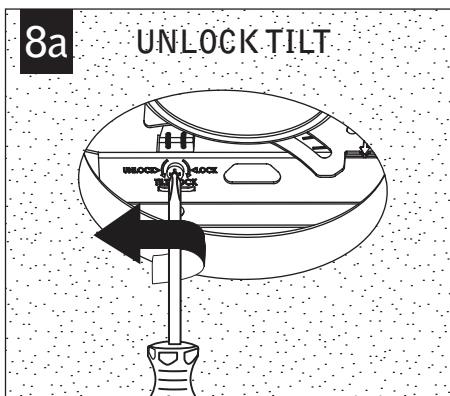

ROTATE

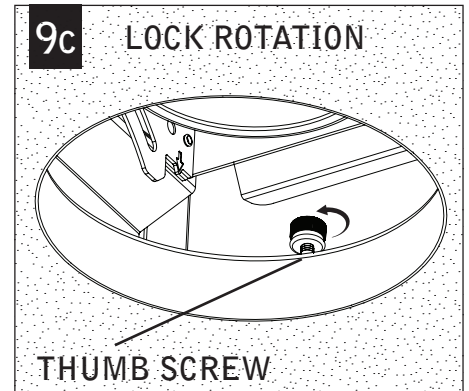
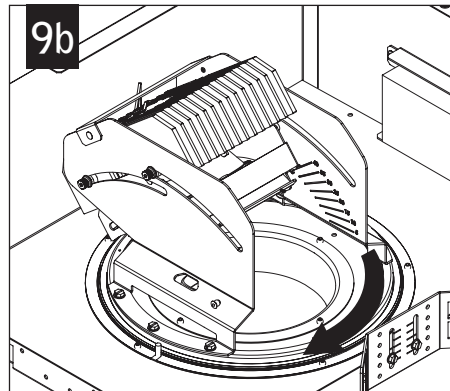
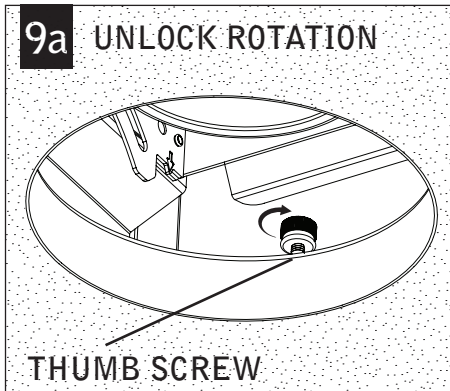

OPTIC SERVICE

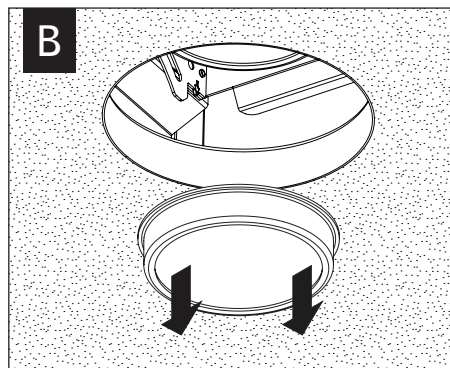
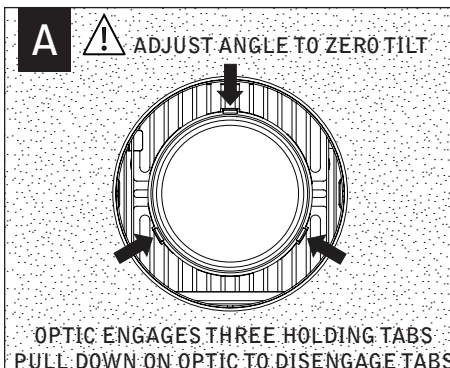

Luminaires must be installed by a qualified electrician (check with local and national codes for proper installation).
To prevent electrical shock, disconnect electrical supply before installation or servicing.

TRIM INSTALLATION

10



ENSURE LED MODULE &
TRIM DO NOT INTERFERE
BEFORE INSTALLING

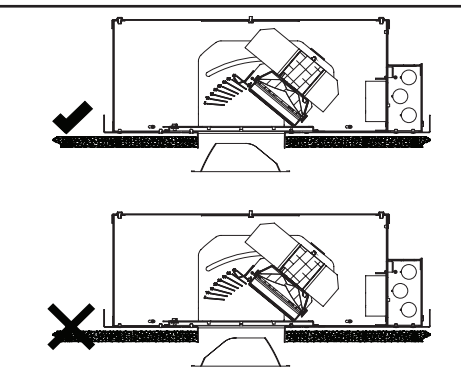
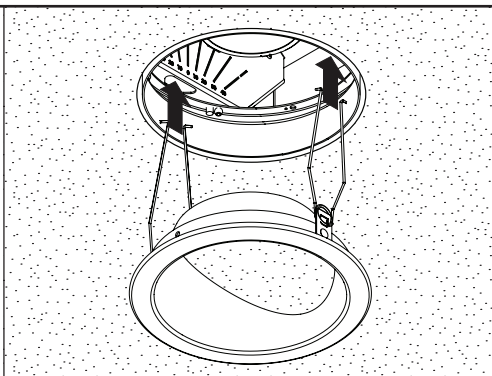

DRIVER SERVICE

1

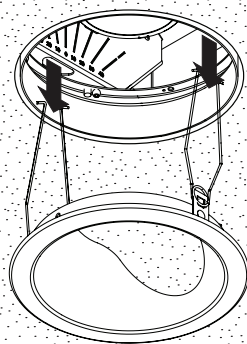

2

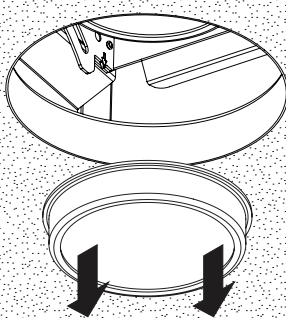

3

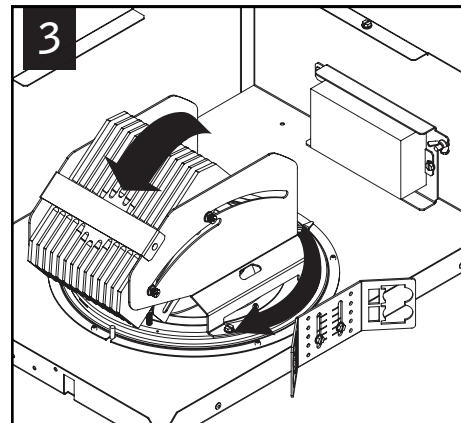

4

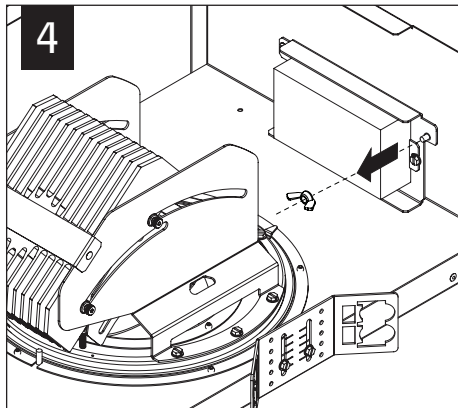

5

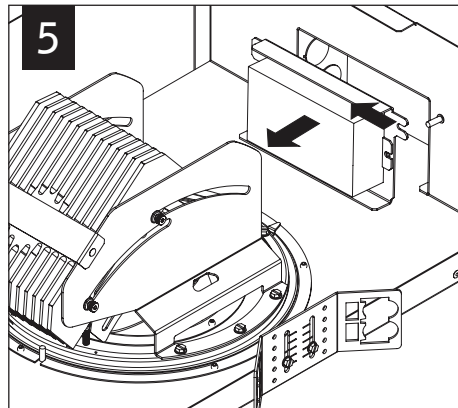

TILT & ROTATE LED MODULE
AWAY FROM DRIVER. SEE
INSTALLATION STEPS 8 & 9
FOR INSTRUCTIONS.