

id+ high ceiling 6" & 8" round

FL6H | FL8H



**LUMINAIRE MUST BE INSTALLED PRIOR TO DRYWALL CEILING.
ALL LUMINAIRES MUST BE SECURED TO STRUCTURE ABOVE.**



NON-EMERGENCY

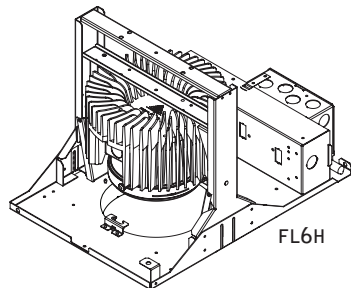

FL6H

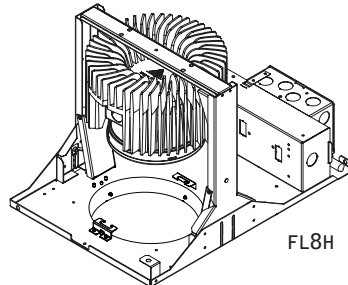

FL8H



x2

KEY



POWER OFF



POWER ON



LEVEL



ATTENTION



SEE ADDITIONAL INSTRUCTIONS

EMERGENCY - REMOTE TEST SWITCH

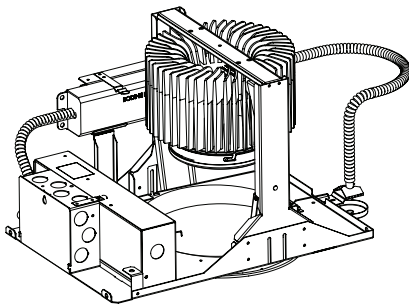

TRIM

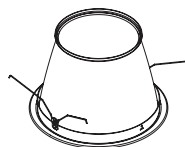

DOWNLIGHT

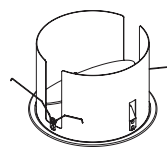

WALL WASH

WALL WASH ORIENTATION

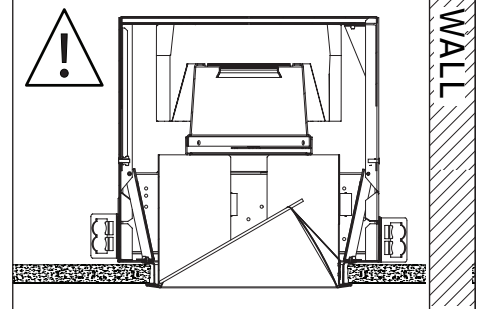

**REMOVE ZIP TIE
PRIOR TO INSTALLATION**

1

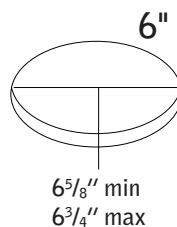

6"
6⁵/₈" min
6³/₄" max



8"

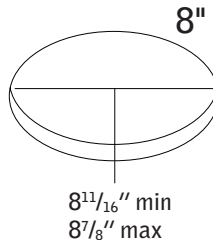

8"
8¹¹/₁₆" min
8⁷/₈" max

GRID - 1/2" CONDUIT & CLIP (BY OTHERS)

2 x2

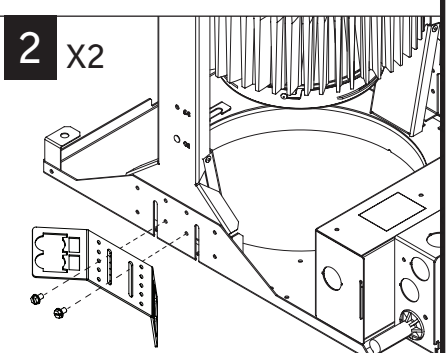

3a x2

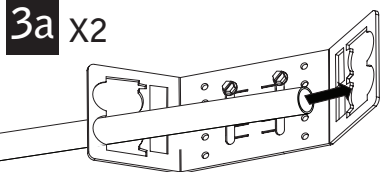

3b

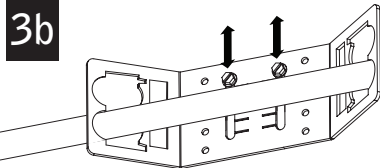

LOOSEN SCREWS TO ADJUST HEIGHT OF HOUSING

4 x4

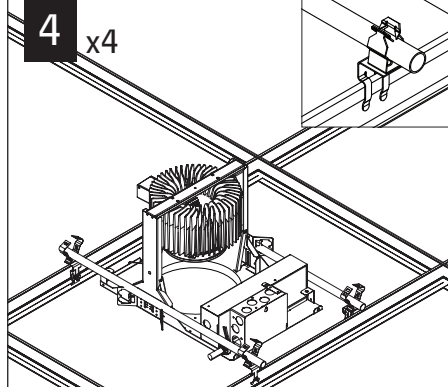

5 x4

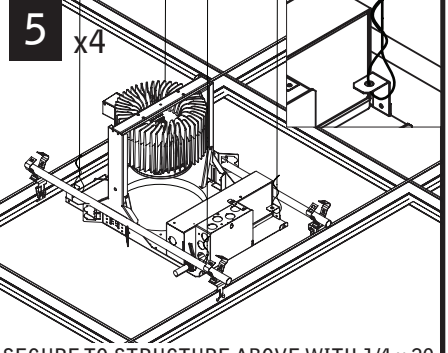

SECURE TO STRUCTURE ABOVE WITH 1/4 x 20
THREADED ROD OR TIEWIRE (BY OTHERS)

Luminaires must be installed by a qualified electrician (check with local and national codes for proper installation).
To prevent electrical shock, disconnect electrical supply before installation or servicing.

DRYWALL

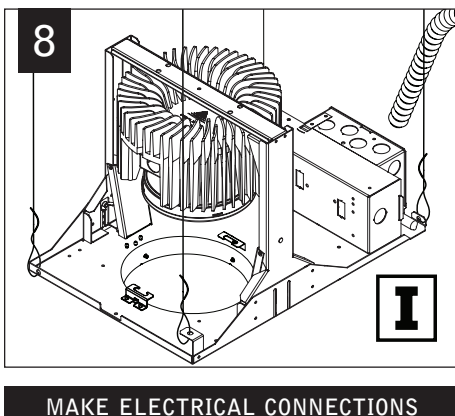
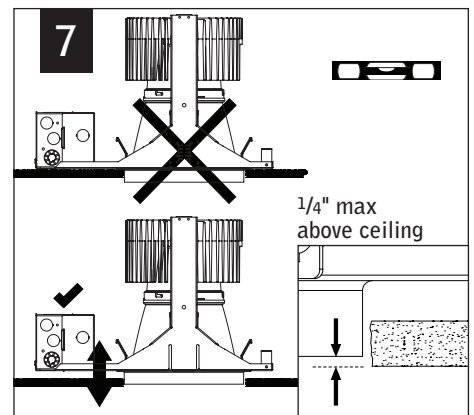
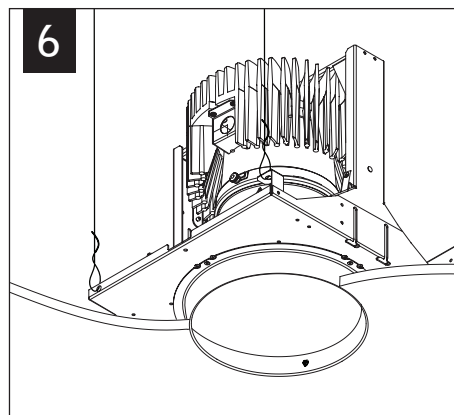
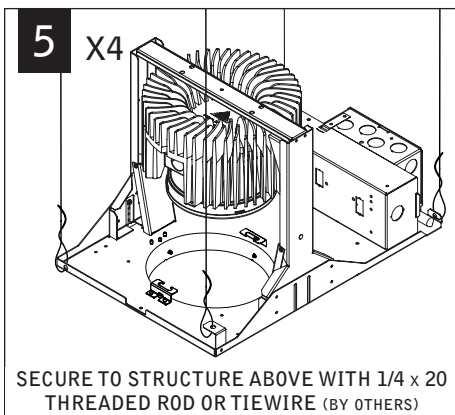
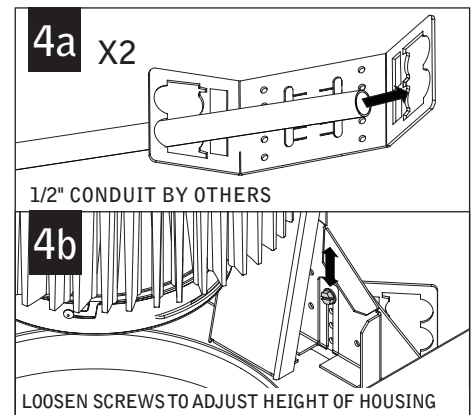
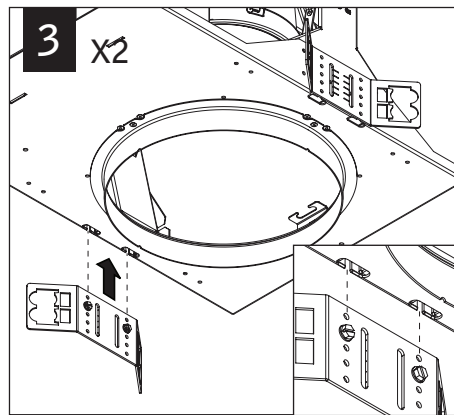
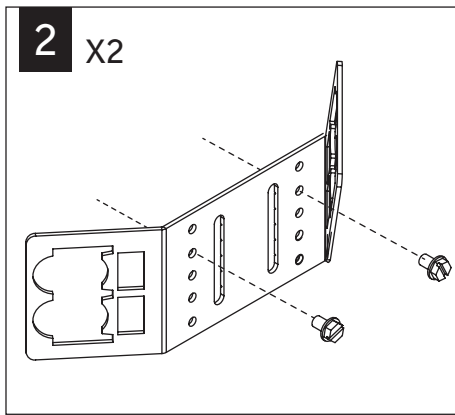

EMERGENCY

A



SEE BATTERY MANUFACTURER
INSTRUCTIONS

EMERGENCY MAXIMUM MOUNTING HEIGHT:
35.00'



DO NOT MATE CONNECTOR
UNTIL INSTALLATION
IS COMPLETE AND A.C.
POWER IS SUPPLIED

B



RELEASE
INDICATOR
FROM BRACKET
PRIOR TO
INSTALLATION

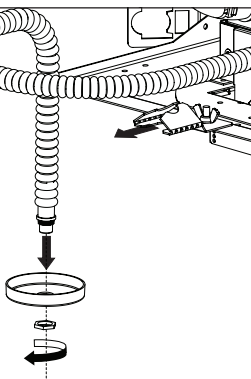

C

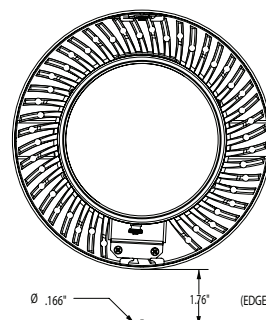
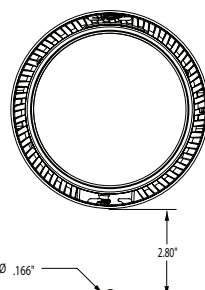

Fixtures must be installed by a qualified electrician (check with local and national codes for proper installation).
To prevent electrical shock, disconnect electrical supply before installation or servicing.

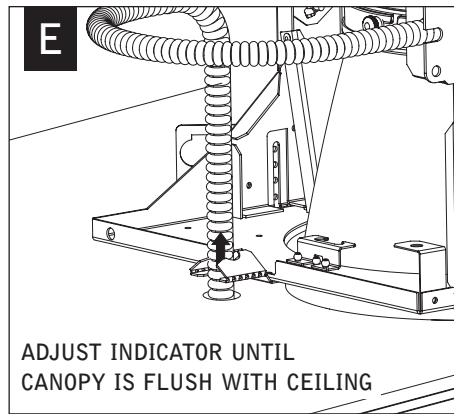
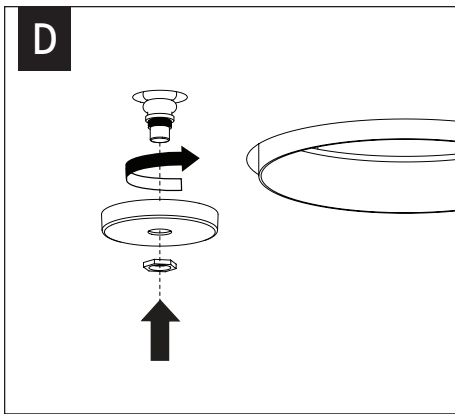

OPTIC ASSEMBLY

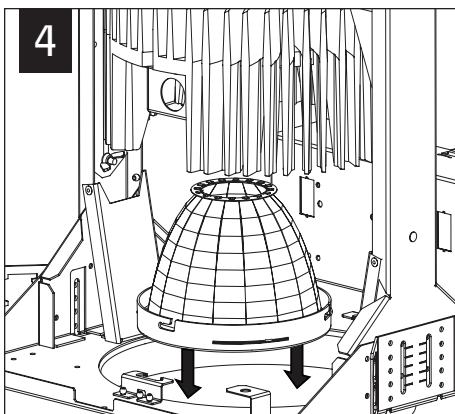
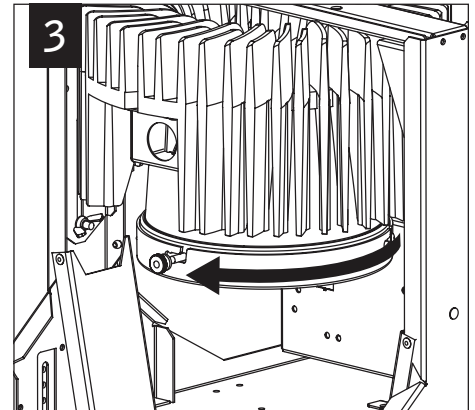
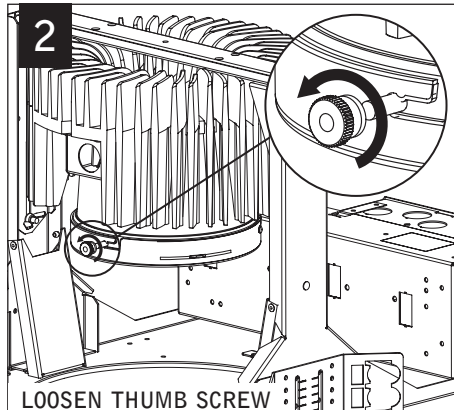

DRIVER SERVICE

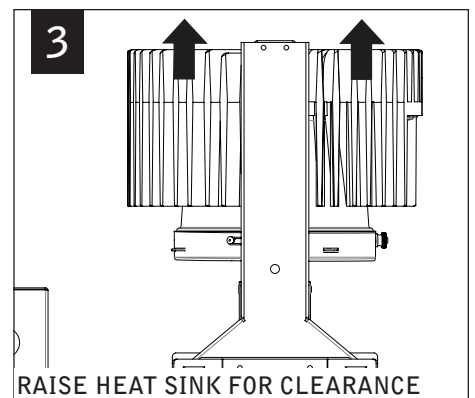
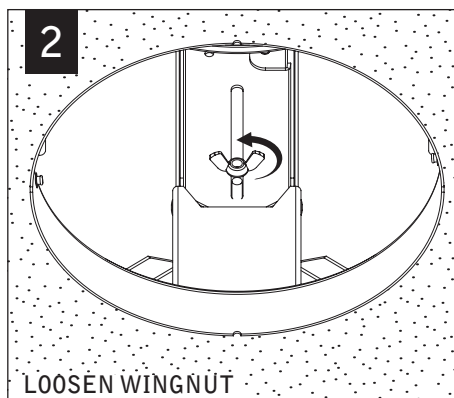
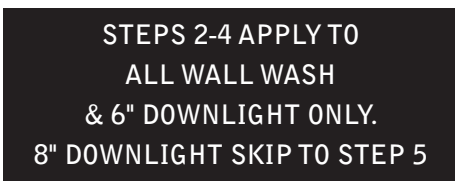
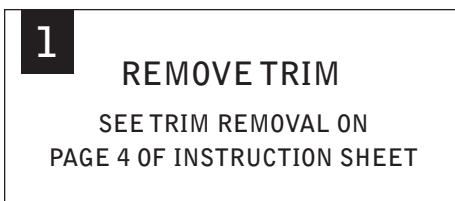

Fixtures must be installed by a qualified electrician (check with local and national codes for proper installation).
To prevent electrical shock, disconnect electrical supply before installation or servicing.

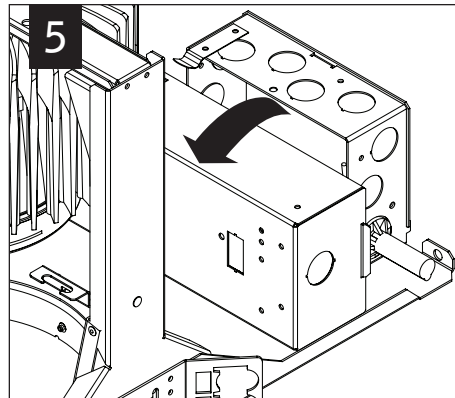
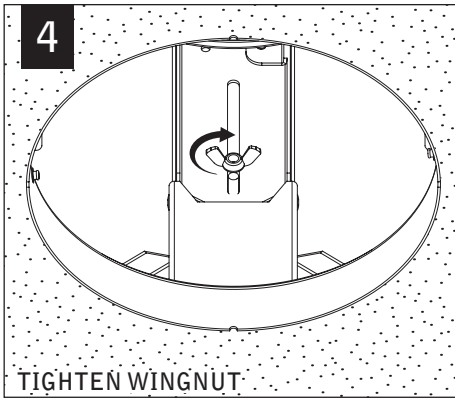

DOWNLIGHT TRIM

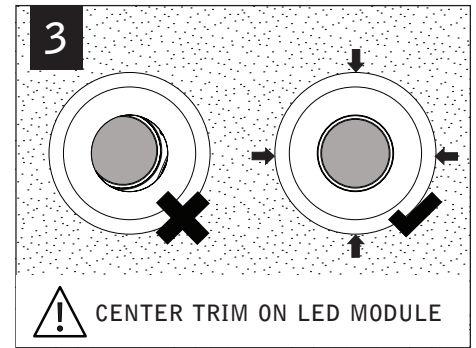
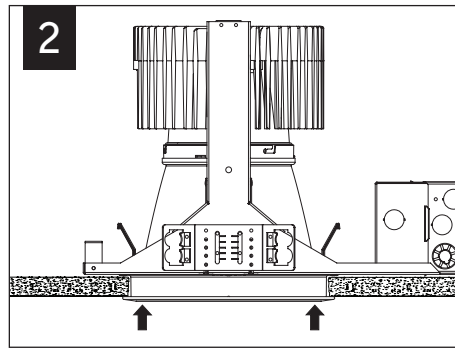
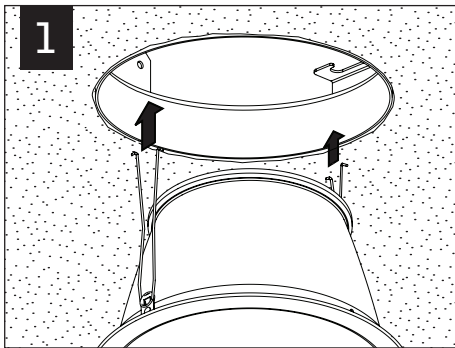

WALL WASH

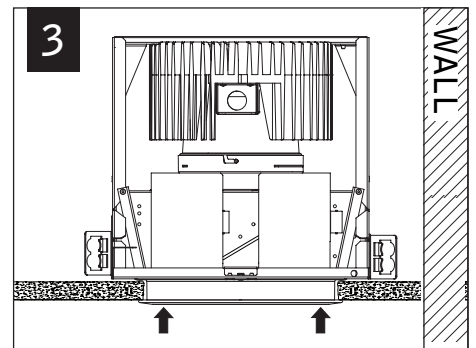
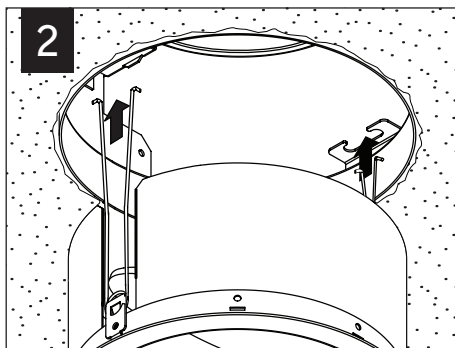
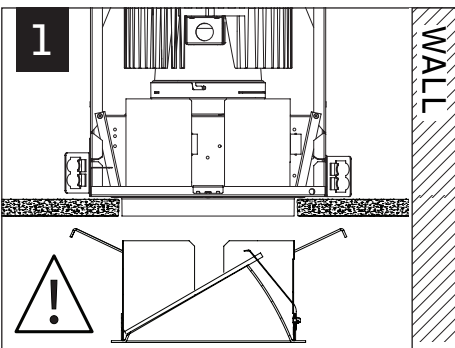

TRIM REMOVAL ! DO NOT PULL ON TRIM FLANGE

DOWNLIGHT

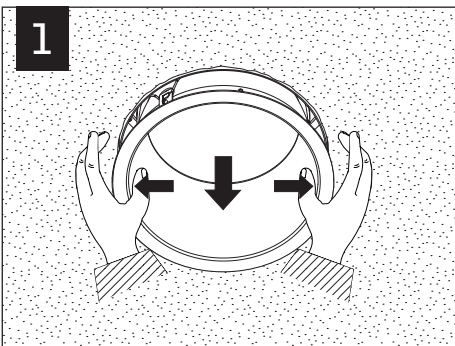

WALL WASH

