



flat diffuser



radial diffuser



suspended or  
surface mount

## DIMENSIONAL DATA

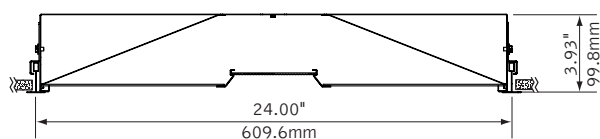

Overall height of luminaire with Air Return is 4.58"

### shielding options



REGRESS

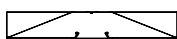

FLAT



RADIAL

### led options

Standard

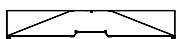

1 LED board

High Efficiency

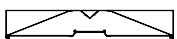

2 LED boards

## FEATURES

High efficacy architectural recessed LED luminaire.

Premium LEDs operate efficiently to achieve excellent thermal management and reliable operation.

Three distinctive aesthetics offer contemporary styling and complement architecture.

MicroGroove diffusers add texture and visual interest with a ribbed pattern that diffuses brightness and provides soft, even illumination.

## PERFORMANCE

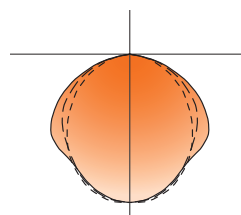

### PRODUCT OVERVIEW

Lumen Output:	2000-4000lm
Wattage:	19-41W
LPW:	91-105
SDCM:	3

High Performance  
2500 Lumens (2500LH)  
Regress Acrylic Diffuser

**Delivered Lumens: 2500lm**

**Total System Watts: 24W**

Photometric performance is measured in accordance with IESNA LM-79.  
Visit [focalpointlights.com](http://focalpointlights.com) for complete photometric data.

fixture:

project:

MOUNTING INFORMATION

**grid**

specify "G" for flat 9/16" and 15/16" tee or "ST" for 9/16" slot tee grid types.

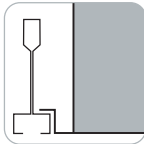
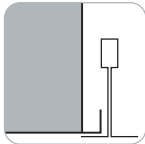

"G" flat tee  
Luminaires may be installed in T-bar ceiling systems up to 1 11/16" high".

"ST" slot tee

**drywall frame kit**

specify "DF" Drywall Frame Kit for drywall ceiling conditions.

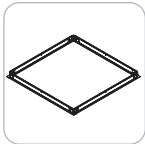
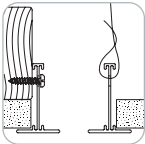

Use tie-wire or screws to secure frame kit.

cut out dimensions:  
2": Min: 24.25"  
Max: 24.563"

SPECIFICATIONS

LED System

Proprietary linear LED module incorporates premium LEDs on a robust platform to achieve excellent thermal management. LEDs are placed to promote a uniform appearance. Available in 2700K, 3000K, 3500K or 4000K with CRI>80 or CRI>90, 3SDCM. 0-10V dimming driver standard. LED modules and drivers are replaceable from below.

Construction

One piece 20 Ga. steel reflector and housing. 20 Ga. steel ends. Bottom access 20 Ga. Steel driver compartment. Positional brackets supplied as standard. Weight: 17 lbs.

Optic

20 Ga. steel reflectors finished in matte satin white powder coat. .095" thick frosted white acrylic lamp diffusers with linear micro-prism pattern.

Electrical

Standard 120-277V driver includes 0-10V analog dimming. Power factor > .9. Optional EcoSystem or forward phase dimming drivers from Lutron available.

Emergency Battery

Bodine BSL310-CAN. Emergency output—10 watts for 90 minutes. Maximum mounting height: 18ft.

Labels

UL and cUL listed. Suitable for Dry or Damp Locations, indoor use only.

Finish

Polyester powder coat applied over a multi-stage pre-treatment.

Lumen Maintenance

Reported: L70 at >60,000 hours  
L80 at >60,000 hours

Calculated: L70 at 153,000 hours  
L80 at 96,000 hours

(Derived from EPA TM-21 calculator. Based on typical conditions, consult factory for additional data.)

Reliability

At Focal Point, our products are designed to stand the test of time. Each luminaire is engineered using superior components, manufactured with the utmost care and rigorously tested. Contact us for reliability data.

Warranty

LED system rated for operation in ambient environments up to 25°C. 5-year limited warranty.

PERFORMANCE CHART

Delivered Lumens		Tested System Watts	LPW
2000 Lumens	2000L	19	105
	2500L	26	96
2500 Lumens	2500LH	24	104
	3000L	33	91
3000 Lumens	3000LH	30	100
	3500LH	36	97
3500 Lumens	4000LH	41	98

Based on 3500K, 80 CRI. Lumen multiplier: 90+ CRI = 0.87. Lumen output may vary +/- 5%. Actual wattage may vary +/- 5%

ORDERING

Luminaire Series		FVRL
Veer LED		FVRL
Nominal Size		22
2' x 2'		22
Shielding		
Radial Acrylic Diffuser		ACR
Flat Acrylic Diffuser		ACF
Regress Acrylic Diffuser		ACG
Lumen Output		
Standard		
2000 Lumens		2000L
2500 Lumens		2500L
3000 Lumens		3000L
High Efficiency		
2500 Lumens		2500LH
3000 Lumens		3000LH
3500 Lumens		3500LH
4000 Lumens		4000LH
Color Temperature		
2700K, 80+ CRI or 90+ CRI		27K or 927K
3000K, 80+ CRI or 90+ CRI		30K or 930K
3500K, 80+ CRI or 90+ CRI		35K or 935K
4000K, 80+ CRI or 90+ CRI		40K or 940K
Circuits		1C
Single Circuit		1C
Voltage		
120 Volt		120
277 Volt		277
UNV Volt		UNV
Control System & Dimming Level		
0-10V - 1% Dimming		L11
0-10V - 10% Dimming		LD1
Lutron Hi-Lume - Forward Phase - 1% Dimming (120 only)		LTE
Step Dimming		SD5
DALI Dimming (Consult factory)		
Mounting		
24" Aircraft Cable		C24
48" Aircraft Cable		C48
96" Aircraft Cable		C96
Drywall Frame Kit (Cut out dimensions: Min: 12.25"/Max: 12.563" Min: 48.25"/Max: 48.563")		F
Grid		G
Slot Tee		ST
Surface Mount		SM
Factory Options		
Air Return (Overall height with Air Return is 4.58")		AR
Chicago Plenum		CP
Emergency Battery Pack with Integral Test Switch		EM
6' New York City Flex Whip		FNY
6' Flex Whip (Sensor options available - consult factory)		FW
Finish		WH
Matte Satin White		WH



10 DAY\*

Options in orange qualify for the Quickship program. 10-day up to 100 pieces. Refer to Quickship Guide for complete details.