

Verve™ IV

LED



radial blade baffle



wall mount
companion

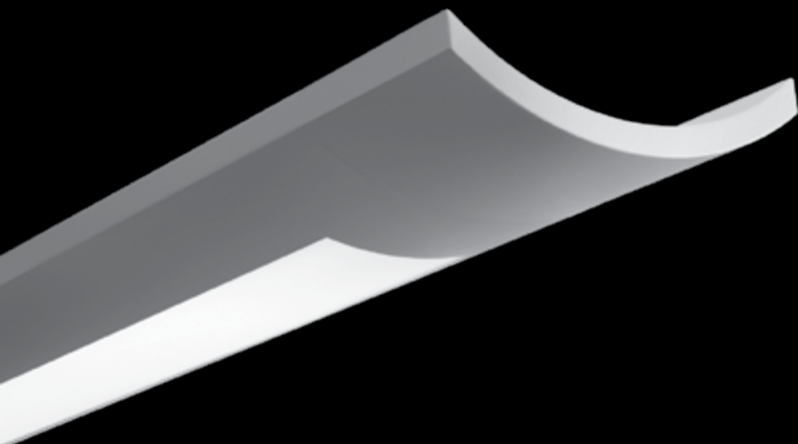

DIMENSIONAL DATA

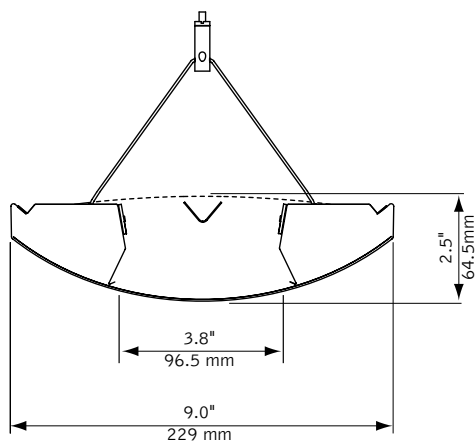

fixture information

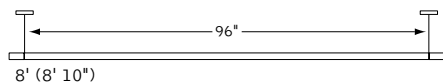
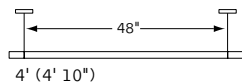

FEATURES

Suspended linear direct/indirect LED with frosted lens or Radial Baffle options.

One-piece steel housing with 5" die-cast end caps

Verve IV is an excellent choice for commercial and educational facilities.

Connected Solutions: Integrates with wired and wireless building lighting control systems.

PoE compatible: Integrates with Power over Ethernet lighting systems via standard, low-voltage wires.

PERFORMANCE

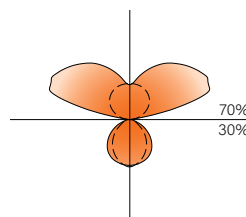

PRODUCT OVERVIEW

Lumen Output:	3000-5000lm
Wattage:	25-39W
LPW:	118-128
SDCM:	3

4' unit, Frosted Lens
Nominal output:
750 Lumens per foot

Delivered Lumens: 3000lm

Total System Watts: 25W

Photometric performance is measured in accordance with IESNA LM-79.
Visit focalpointlights.com for complete photometric data.

SUSPENSION INFORMATION

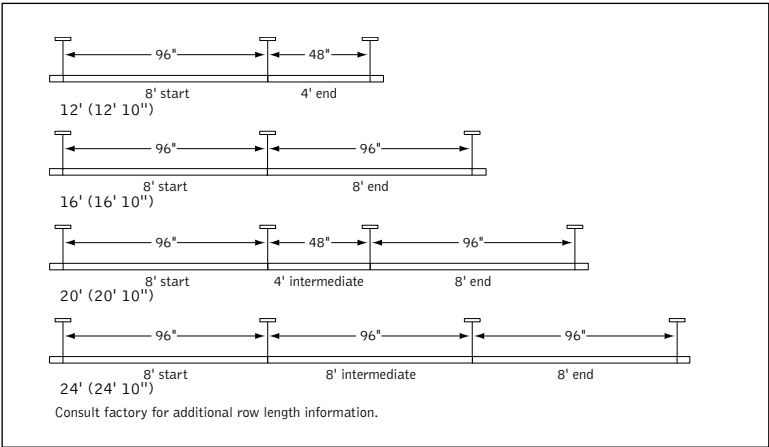

SPECIFICATIONS

LED Systems

Linear LED module incorporates premium LEDs on a robust platform to achieve excellent thermal management. Available in 3000K, 3500K, 4000K with CRI>80, 3SDCM. Contact factory for additional color temperature and CRI options. LED boards and drivers are replaceable.

Construction

One-piece 20 Ga. steel housing. Die-cast 5" end cap standard. For row installation, internal brackets form hairline joint. Standard lengths are available in 4' and 8'. All luminaires are provided with Y-cable suspension mounted on 48" or 96" centers. 4' unit weight: 20 lbs, 8' unit weight: 30 lbs.

Optic

Reflector fabricated of 22 Ga. steel finished in high reflectance matte white. 24 Ga. steel beam softening filter finished in matte white powder coat. .010" thick acrylic lens.

Electrical

Luminaires are pre-wired with factory installed branch circuit wiring and over-molded quick connects. Standard 120-277V constant current driver includes 0-10V analog dimming. Power factor > .9. PoE compatible: Integrates with Power over Ethernet lighting systems via standard, low-voltage wires. PoE runs require an independent PoE node and power feed for each luminaire section.

Emergency

Emergency Battery output—12 watts for 90 minutes. Maximum mounting height: 12.4ft. Emergency Circuit with Connected Solutions (NLT1, ENL1, CLM1, DLM1) shipped standard with leads to connect UL924 compliant device, by others. See EM/EC Guide on page 4 for default locations and ordering details.

Labels

UL and cUL listed. Suitable for Dry or Damp Locations, indoor use only.

Finish

Polyester powder coat applied over a multi-stage pre-treatment. Canopy finished in Matte Satin White.

Lumen Maintenance

Reported: L70 at >60,000 hours Calculated: L70 at 162,000 hours
 L80 at >60,000 hours L80 at 102,000 hours
Derived from EPA TM-21 calculator. Based on typical conditions, consult factory for additional data.

Reliability

At Focal Point, our products are designed to stand the test of time. Each luminaire is engineered using superior components, manufactured with the utmost care and rigorously tested. Contact us for reliability data.

Warranty

LED system rated for operation in ambient environments up to 25°C. 5-year limited warranty.

4' PERFORMANCE CHART

Lumens Per Foot	Delivered Lumens	System Watts	LPW
750LF	3000	25	120
875LF	3500	29	121
1000LF	4000	34	118
1125LF	4500	36	125
1250LF	5000	39	128

Based on Frosted Lens 70 indirect / 30 direct (FL70), 3500K. Shielding Multipliers: FL40 - 0.90, RB - 1.04. Color Temperature multipliers: 3000K - 1.035, 4000K - 0.975. *Lumen output may vary +/- 5%. Actual wattage may vary +/- 5%

ORDERING

Fixture Series	FV4LS
Verve IV LED	FV4LS
Shielding	
Frosted Lens -	FL70
70 Indirect / 30 Direct Distribution	
Frosted Lens -	FL40
40 Indirect / 60 Direct Distribution	
Radial Blade Baffle - White	RB
with frosted acrylic overlay	
70 Indirect / 30 Direct Distribution	
Lumen Output	
750 Lumens per foot	750LF
875 Lumens per foot	875LF
1000 Lumens per foot	1000LF
1125 Lumens per foot	1125LF
1250 Lumens per foot	1250LF
Color Temperature	
3000K	30K
3500K	35K
4000K	40K
Circuits	1C
Single Circuit	1C
Voltage	
120/277 UNV Volt	UNV
347 Volt	347
(LD1 only)	
Low Voltage	LV
Control System & Dimming Level	
0-10V - 10% Dimming	LD1
Low Voltage, PoE compatible	LVN
(No driver. Not available with EM or EC. LV Voltage only)	
0-10V - 1% Dimming	L11
Lutron Hi-Lume EcoSystem (LDE1)	
- 1% Dimming	LH1
DALI - 1% Dimming	D11
Step Dimming	SD5
(Not available with 750LF)	
Acuity nLight - 1% Dimming	NLT1
Enlighted Smart Sensor - 1% Dimming	ENL1
Encelium CLM Connected Lighting	
Module - 1% Dimming	CLM1
(Compatible with Encelium X Light Management System)	
Wattstopper DLM - 1% Dimming	DLM1
Mounting	
24" Cable Suspension	C24
48" Cable Suspension	C48
96" Cable Suspension	C96
(Add "P" for Chicago plenum. Eg: CP12) (Specify one of the following in place of "C" J - for 2" canopies at non-feed locations. CS - for sloped ceilings.)	
Factory Options	
Emergency Battery Pack	_EM
(120/277V only)	
Emergency Circuit	_EC
See EM/EC Guide for default locations and ordering details.)	
Dust Cover	DST
Finish	
Titanium Silver	TS
Matte Satin White	WH
Fixture Run Length	
4'	4'
8'	8'
12' (8'+4')	12'
16' (8'+8')	16'
20' (8'+4'+8')	20'
24' (8'+8'+8')	24'
(Longer run lengths available in 4' increments.)	

Focal Point provides flexibility in meeting the needs of each project by integrating with several building lighting control systems. A variety of sensors, drivers and other components can be specified that allow the luminaires to communicate with wired and wireless networks. All zoning can be digitally reconfigured through the application software. Daylight harvesting, occupancy sensing, integration with HVAC systems, and individual controls enable the monitoring and modulating of light levels and temperature in order to save energy, reduce costs and maximize occupants' comfort. All Connected Solutions luminaires require a compatible building control system.†

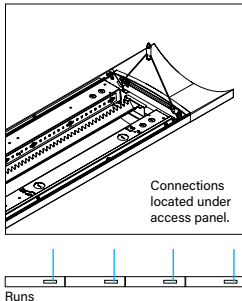

nLight[®] provides a two-way wired digital lighting system allowing for on/off and dimming functionality, occupancy sensing, and multi-zone daylight harvesting.

Acuity nLight - 1% Dimming (NLT1)
Acuity Model #nEPS-60-IO

CAT-5 Cable provided by others. Serial labels will be provided on outside of luminaires and control unit.



Enlighted smart sensor allows for occupancy sensing, daylight harvesting, energy usage, temperature and light level control. Communicates wirelessly with the Enlighted network.

Enlighted Smart Sensor - 1% Dimming (ENL1)
Enlighted Model #SU-5E-IOT

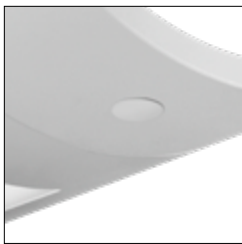

Encelium's Connected Lighting Module (CLM) is fully compatible with the Encelium X Light Management System, as well as with 0-10V and DALI based LED drivers to allow for individual luminaire control, including on/off and dimming functionalities, occupancy sensing, and multi-zone daylight harvesting.

Encelium CLM - 1% Dimming (CLM1)
Encelium Model #ZBHA-CLM-DIM-ENC

Serial labels will be provided on outside of luminaires and control unit.

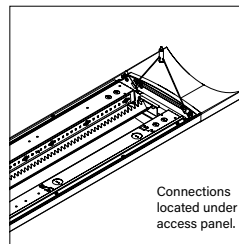

A Digital Lighting Management (DLM) system that provides two-way wired communication between networked luminaires and control system to allow for on/off and dimming functionality, occupancy sensing and multi-zone daylight harvesting.

Wattstopper DLM - 1% Dimming (DLM1)
Wattstopper Model #LMFC-011

Segment Network Wire provided by others. Serial labels will be provided on outside of luminaires and control unit.

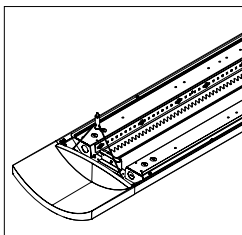

A two-way digital network that enables on/off and dimming functionality, occupancy sensing, and multi-zone daylight harvesting working with Quantum[®], Energi Savr Node[™], and Energi TriPak[®] using EcoSystem[®] communication protocol.

Lutron Hi-Lume EcoSystem - 1% Dimming (LH1)
Lutron Model #LDE1

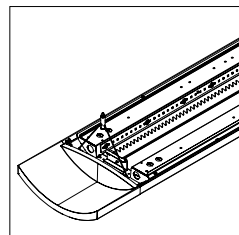

A two-way digital network that enables on/off and dimming functionality, occupancy sensing, and multi-zone daylight harvesting. Communicates with Züm wireless and SpaceBuilder working with Züm hub scheduling or FUSION management.

DALI - 1% Dimming (D11)
0-10V - 1% Dimming (L11)

Note: 0-10V is not a digital network but is compatible with Creston Züm[™] system.

CONNECTED SOLUTIONS DETAILS

Connected Solution	Model #	Protocol	Compatible Networks*	Occupancy	Daylight	Temperature Reporting	Communication to Luminaire	Drivers
Acuity nLight (NLT1)	nEPS-60-IO**	nLight	nLight	Enabled	Enabled	No	Wired	eldoLED ECoDrive , eldoLED SOLOdrive
Crestron (D11, L11)	Specified Driver	DALI 0-10V	Crestron Züm Wireless & SpaceBuilder	Enabled	Enabled	No	Wired	eldoLED ECoDrive (DALI) , Advance by Signify (0-10V)
Enlighted Smart Sensor (ENL1)	SU-5E-IOT**	Enlighted RF	Enlighted	Integrated	Integrated	Yes	Wireless	Advance by Signify , Optotronic by eldoLED
Legrand Wattstopper DLM (DLM1)	LMFC-011**	DLM	DLM	Enabled	Enabled	No	Wired	Advance by Signify , Optotronic by eldoLED
Lutron EcoSystem (LH1)	LDE1**	EcoSystem	Quantum, Energi Savr Node, Energi TriPak	Enabled	Enabled	No	Wired	Lutron Hi-Lume
Encelium CLM Connected Lighting Module (CLM1)	ZBHA-CLM-DIM-ENC*	ZigBee	Encelium X Light Management System	Enabled	Enabled	No	Wireless	Optotronic by eldoLED Advance by Signify

*Not all compatible networks may be listed. **For performance data and additional control system details please visit the connected solutions manufacturer websites. Primary drivers are listed in **bold**. To specify a particular driver please consult factory.
†Controls systems supplied by others.



EM/EC Guide

VERVE IV LED - FV4LS

DEFAULT LOCATIONS

- By default, EM/EC are located at the end (last section) of a run when one EM/EC location is specified, and at the start and end when two locations are specified.
- EM/EC illuminate entire sections from 4' to 8' in length.
- Feed location is at start of run. All EC's are fed individually at the end of each fixture segment.

1 EM/EC - END OF RUN



Ordering example: FV4LS-FL70... **1EM-WH-36ft**

2 EM/EC - START & END OF RUN



Ordering example: FV4LS-FL70... **2EM-WH-36ft**

ALTERNATE LOCATIONS AND QUANTITIES

- If more than two locations are required, or specific locations within run need to be specified, indicate in the ordering string.

ONE EM IN 3RD SECTION

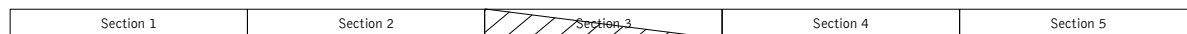

Ordering example: FV4LS-FL70... **1EM-3-WH-40ft**

THREE EM IN 1ST, 3RD AND 6TH SECTIONS

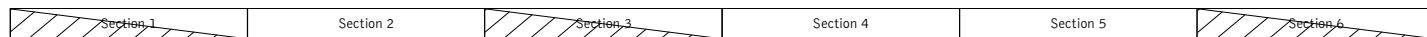

Ordering example: FV4LS-FL70... **3EM-1-3-6-WH-48ft**

CUSTOM LENGTHS

- If partial illumination of emergency section is required, indicate quantity in ordering string and partial illumination in Order Notes. Drawing required.
- Longer lead times may apply.

Run length (ft)	Housing Configuration Section Lengths
12	8 + 4
16	8 + 8
20	8 + 4 + 8
24	8 + 8 + 8
28	8 + 8 + 8 + 4

Run length (ft)	Housing Configuration Section Lengths
32	8 + 8 + 8 + 8
36	8 + 8 + 8 + 8 + 4
40	8 + 8 + 8 + 8 + 8
44	8 + 8 + 8 + 8 + 8 + 4
48	8 + 8 + 8 + 8 + 8 + 8

Standard run configurations, consult factory for custom configurations.