

# Telios™ 2x2

LED

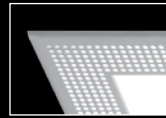

perforated frame

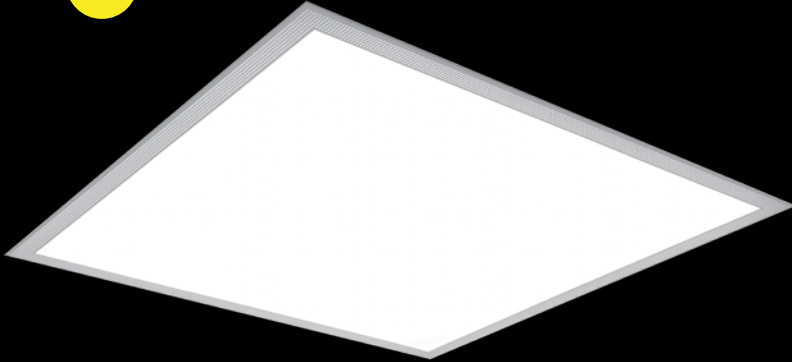

solid frame

## DIMENSIONAL DATA

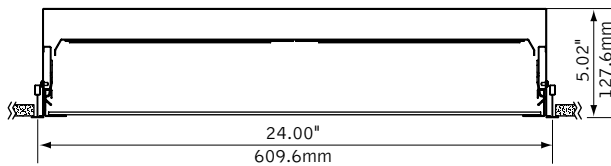

### Ceiling details

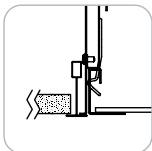

flat tile

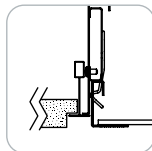

tegular tile

## FEATURES

Architectural recessed LED panel luminaire.

Simple, symmetrical and sophisticated.

The 2x2 glowing pane is framed with a 1" solid or perforated border.

Square LED panels evenly backlight a frosted acrylic lens, creating a soft and pleasant glow.

## PERFORMANCE

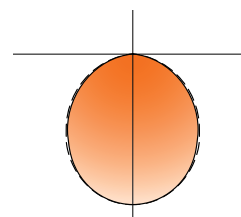

2500 Lumens

**Delivered Lumens: 2500lm**

**Total System Watts: 27W**

### PRODUCT OVERVIEW

Lumen Output:	2000-4000lm
Wattage:	21-45W
LPW:	89-95
SDCM:	3
Reported Lumen L70 @	
Maintenance:	>60,000hrs

Photometric performance is measured in accordance with IESNA LM-79. Visit [focalpointlights.com](http://focalpointlights.com) for complete photometric data.

fixture:

project:

**DETAILS**

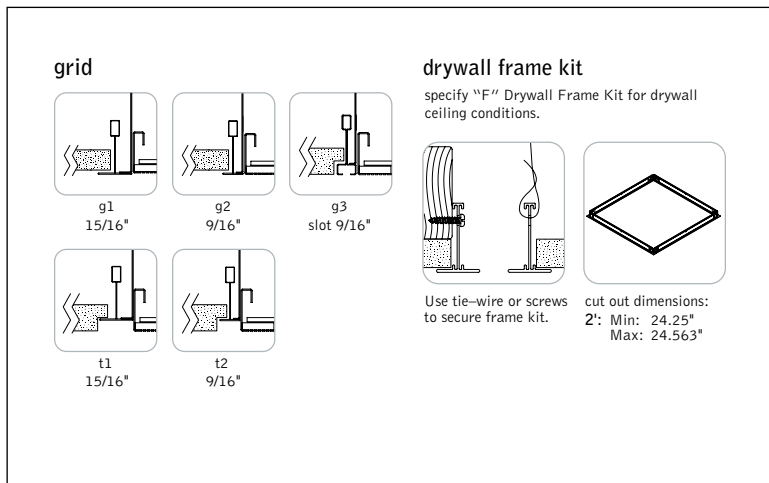

**SPECIFICATIONS**

**LED System**

Proprietary linear LED module incorporates premium LEDs on a robust platform to achieve excellent thermal management. LEDs are placed to promote a uniform appearance. Available in 3000K, 3500K or 4000K with CRI>80. 0-10V dimming driver standard. LED modules and drivers are replaceable from below. Color accuracy <3 SDCM.

**Construction**

One piece 20 Ga. steel housing. Bottom access 20 Ga. steel driver compartment. Positional brackets supplied as standard. Weight: 23 lbs.

**Optic**

.125" thick frosted white acrylic diffuser.

**Electrical**

Standard 120-277V driver includes 0-10V analog dimming, 100% - 10% range. Power factor > .9. Optional EcoSystem dimming drivers from Lutron available.

**Emergency Battery**

Bodine BSL310-CAN. Emergency output—10 watts for 90 minutes. Maximum mounting height: 18ft

**Labels**

UL and cUL listed. Suitable for Dry or Damp Locations, indoor use only.

**Finish**

Polyester powder coat applied over a multi-stage pre-treatment.

**Lumen Maintenance**

Calculated: L70 at 128,000 hours    Reported: L70 at >60,000 hours  
Derived from EPA TM-21 calculator based on 10,000 hours of test data.

**Reliability**

At Focal Point, our products are designed to stand the test of time. Each luminaire is engineered using superior components, manufactured with the utmost care and rigorously tested. Contact us for reliability data.

**Warranty**

LED system rated for operation in ambient environments up to 25°C. 5-year limited warranty.

**PERFORMANCE CHART**

Delivered Lumens	Tested System Watts	LPW
2000	21	95
2500	27	92
3000	33	91
3500	39	90
4000	45	89

\*Lumen output may vary +/- 5%. Actual wattage may vary +/- 5%

**ORDERING**

<b>Luminaire Series</b>	Telios	<b>FTEL</b>
<b>Nominal Size</b>	2' x 2'	<b>22</b>
<b>Shielding</b>	Acrylic Diffuser with Perforated Frame	ACP
	Acrylic Diffuser with Solid Frame	ACS
<b>Lumen Output</b>	2000 Lumens	2000L
	2500 Lumens	2500L
	3000 Lumens	3000L
	3500 Lumens	3500L
	4000 Lumens	4000L
<b>Color Temperature</b>	3000K	30K
	3500K	35K
	4000K	40K
<b>Circuits</b>	Single Circuit	<b>1C</b>
<b>Voltage</b>	120/277 Volt	<b>UNV</b>
<b>Driver</b>	0-10V - 10% Dimming	LD1
	Lutron A-Series	L3D
	1% EcoSystem Digital	
	<small>((2) drivers supplied with 4000L (2) EcoSystem addresses consumed)</small>	
	<small>(Consult factory for 3-wire control)</small>	
<b>Mounting</b>	15/16" Layin	G1
	9/16" Layin	G2
	9/16" Slot Tee Tegular	G3
	15/16" Tegular	T1
	9/16" Tegular	T2
	Drywall Frame Kit	F
	<small>(Cut out dimensions: Min: 24.25"/Ma: 24.563")</small>	
<b>Factory Options</b>	Chicago Plenum	CP
	Emergency Battery Pack	EM
	6' New York City Flex Whip (120V)	FNY1
	6' New York City Flex Whip (277V)	FNY2
	6' Flex Whip	FW
<b>Finish</b>	Matte White Housing	<b>WH</b>