

Seem® 4 LED Perimeter

FSM4PR | GRID/TRIMLESS DRYWALL

CONNECTEDSM
SOLUTIONS



BEFORE YOU BEGIN

- Luminaires must be installed by a qualified electrician (check with local and national codes for proper installation).
- To prevent electrical shock, disconnect electrical supply before installation or servicing.
- Contractor is responsible for adequately reinforcing walls and/or ceilings to support fixture weight.
- Focal Point, LLC accepts no responsibility for inadequately reinforced walls and/or ceilings.
- The information contained in this drawing is the sole property of Focal Point, LLC. Any reproduction in part or whole without the written permission of Focal Point, LLC is prohibited.

INSTRUCTION KEY



ATTENTION



SEE ADDITIONAL INSTRUCTIONS



POWER OFF



POWER ON

COMPONENT KEY

PARTS LIST

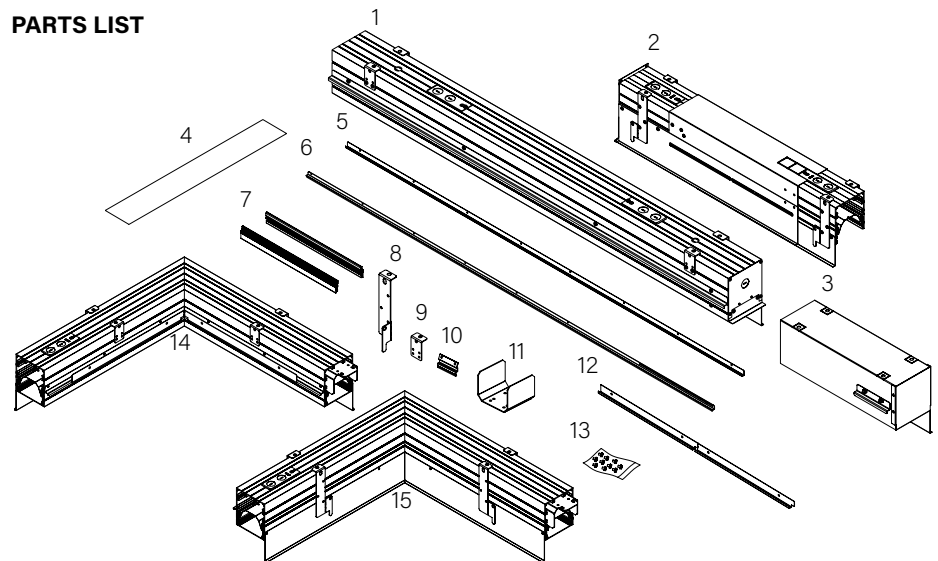

1 Housing

2 Adjustable housing

3 Sliding sleeve (ss) (shipped installed. SSB indicates a sliding sleeve at both ends)

4 Finish plate

5 J-rail

6 Z-rail

7 Housing rail kit

8 Tie-wire/grid bracket

9 Tie-wire bracket

10 Joiner bracket

11 Joiner bracket

12 Corner j-rail

13 Hardware bag

14 Outside corner

15 Inside corner

BY OTHERS:

Grid ceiling - 15/16" or 9/16" flat tee main runner required for finish edge.

HOUSING TYPES - 4' SHOWN



INDIVIDUAL (MAY INCLUDE SLIDING SLEEVES)

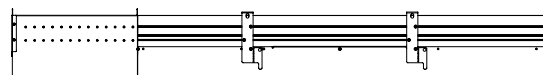

START (SHOWN WITH SLIDING SLEEVE)



INTERMEDIATE

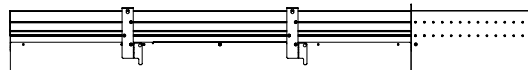

END (SHOWN WITH SLIDING SLEEVE)



ADJUSTABLE HOUSING

WALL/CEILING PREPARATION

Flush Lens Lay-In Grid

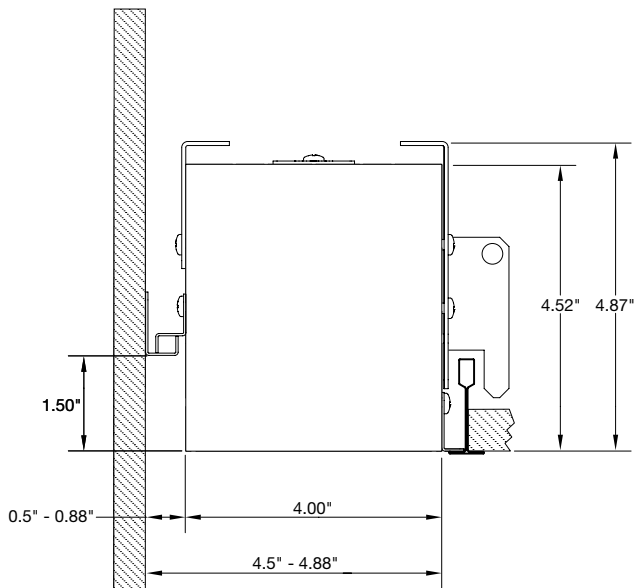

GRID CEILING - 15/16" OR 9/16" FLAT TEE MAIN
RUNNER REQUIRED FOR FINISH EDGE.

Flush Lens Slot Tee/Tegular

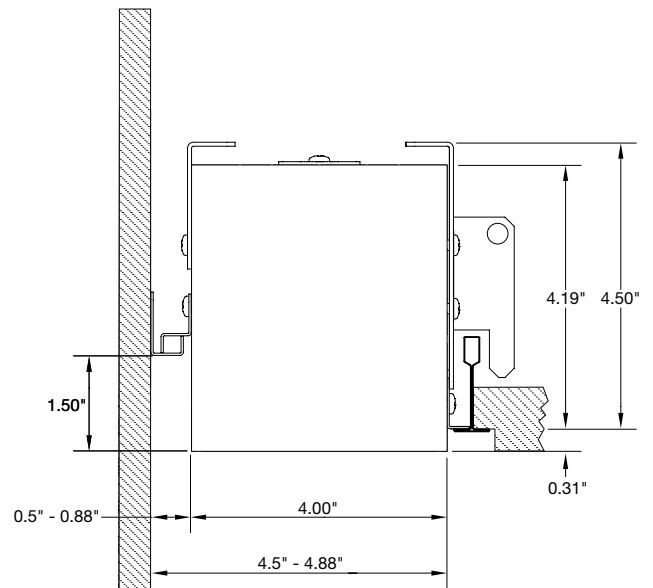

GRID CEILING - 15/16" OR 9/16" FLAT TEE MAIN
RUNNER REQUIRED FOR FINISH EDGE.

Regressed 2.5" Grid

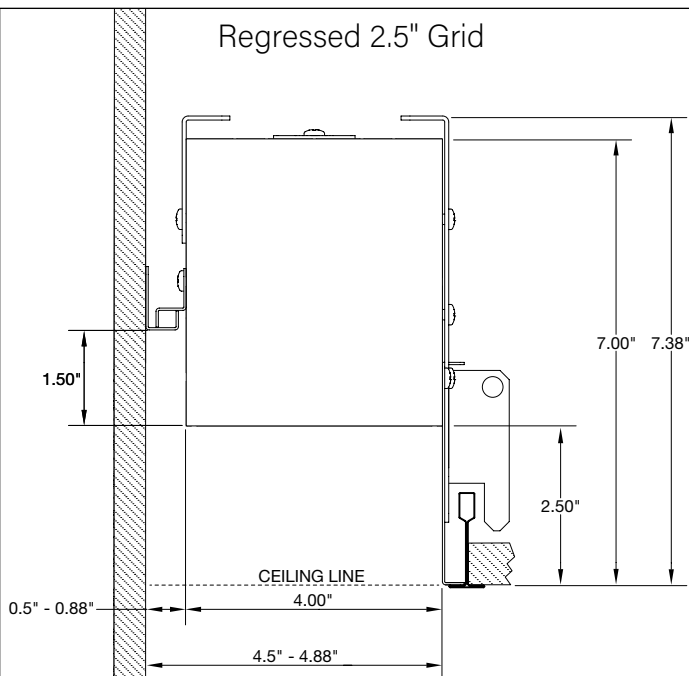

GRID CEILING - 15/16" OR 9/16" FLAT TEE MAIN
RUNNER REQUIRED FOR FINISH EDGE.

Regressed 4" Grid

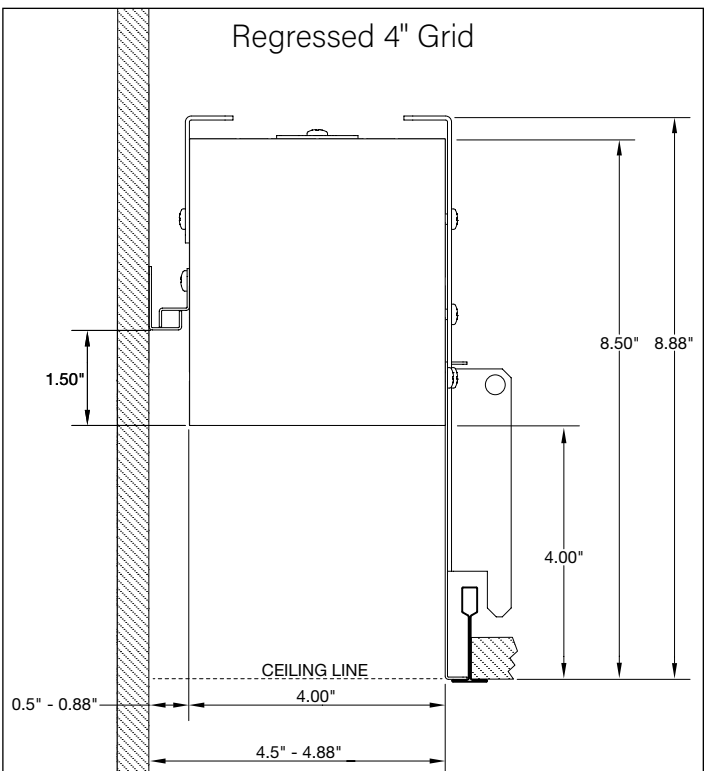

GRID CEILING - 15/16" OR 9/16" FLAT TEE MAIN
RUNNER REQUIRED FOR FINISH EDGE.

WALL/CEILING PREPARATION

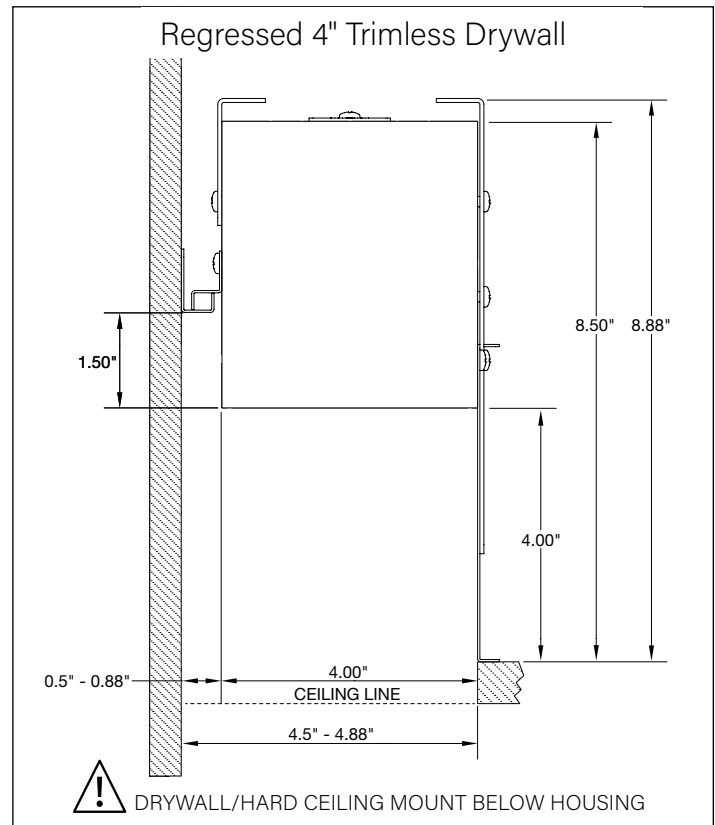
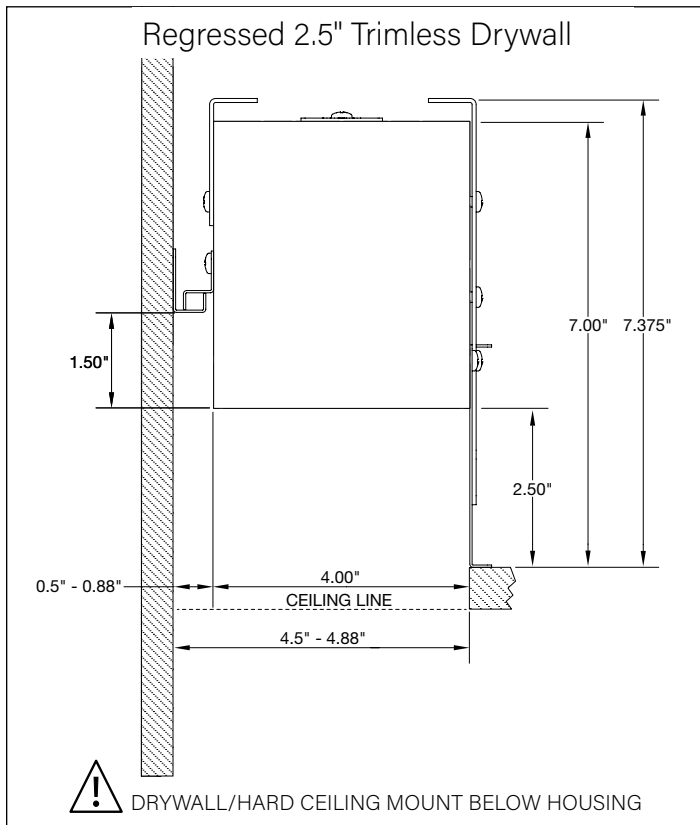

OPTIONAL

REMOVE END CAP FLANGE ON START AND/OR END OF RUN HOUSINGS WHEN FLUSH INSTALLATION AGAINST FINISHED WALL IS DESIRED

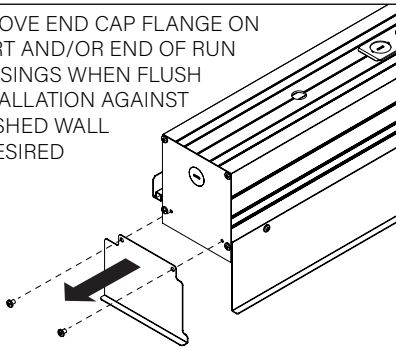

FOCAL POINT RECOMMENDS STARTING WITH CORNER INSTALLATION IF APPLICABLE

BASIC INSTALLATION, STEPS 1-13
ADJUSTABLE HOUSING, PAGE 3
SLIDING SLEEVES, PAGE 5
CORNERS, PAGE 6

SLIDING SLEEVE PAIRS (SSB) START & END WITH A SLIDING SLEEVE

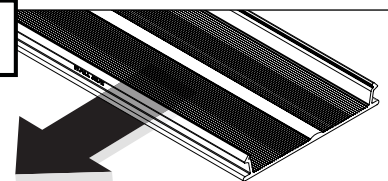

GRAZER LENS DISTRIBUTION DIRECTION

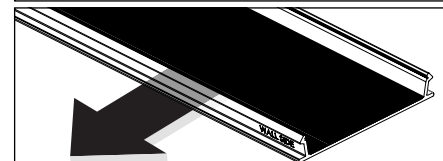

ASYMMETRIC ROOM FILL LENS DISTRIBUTION DIRECTION

BASIC INSTALLATION

1

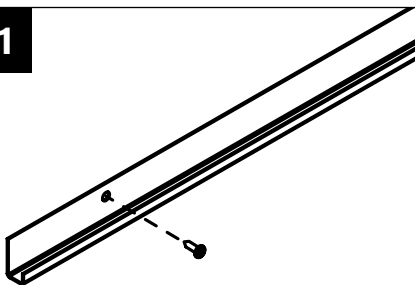

MOUNT J-RAIL TO WALL
 (HARDWARE BY OTHERS)

2

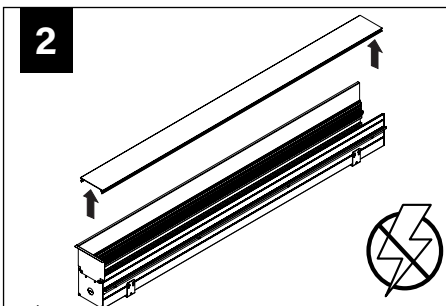

START, INTERMEDIATE, & END UNITS ONLY

3

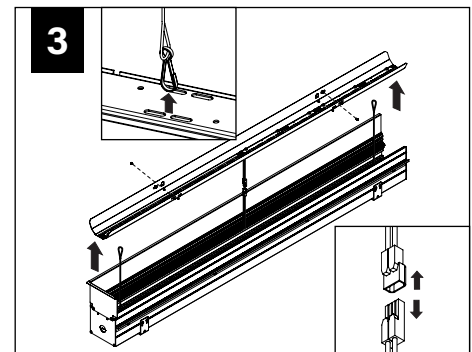

START, INTERMEDIATE, & END UNITS ONLY

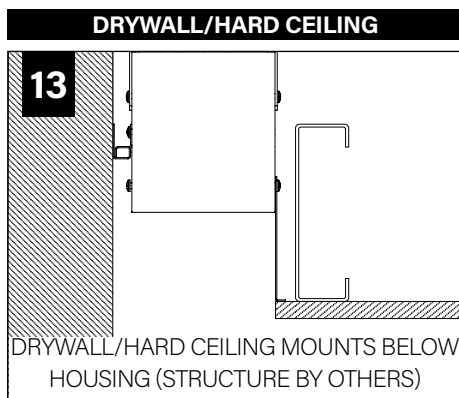
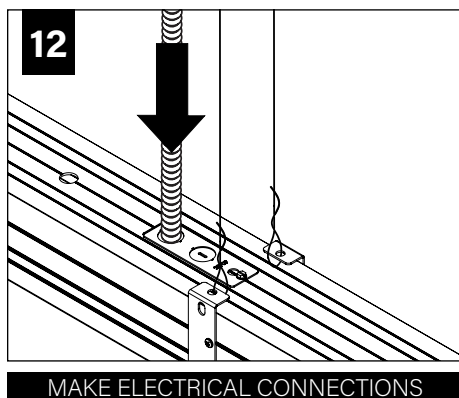
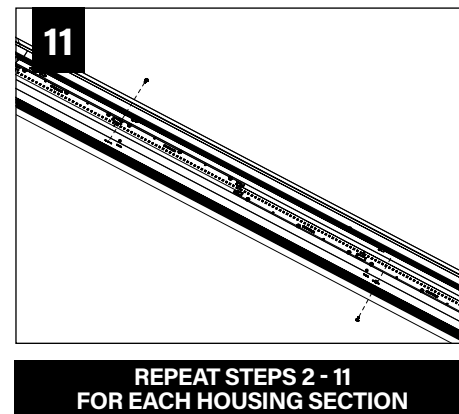
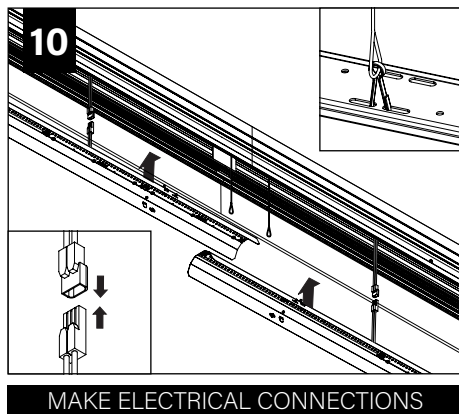
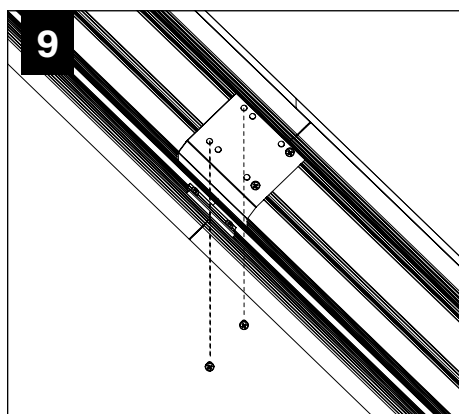
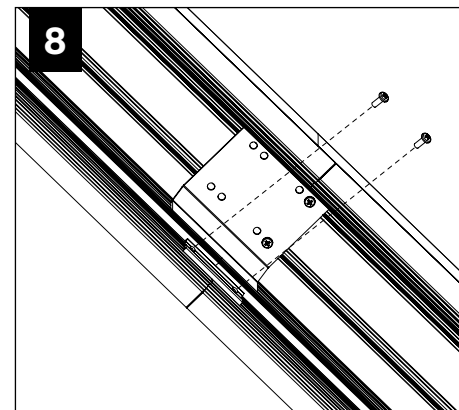
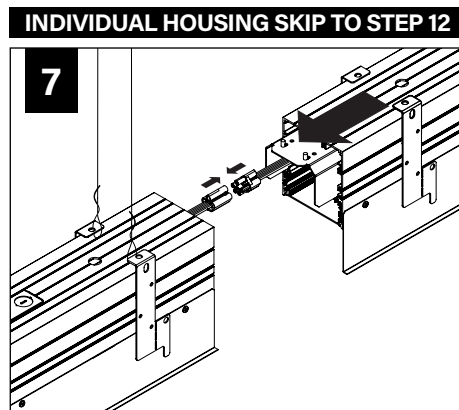
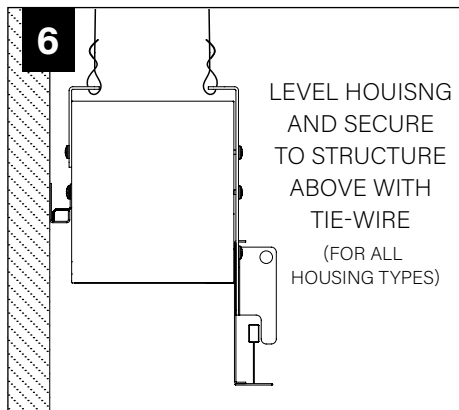
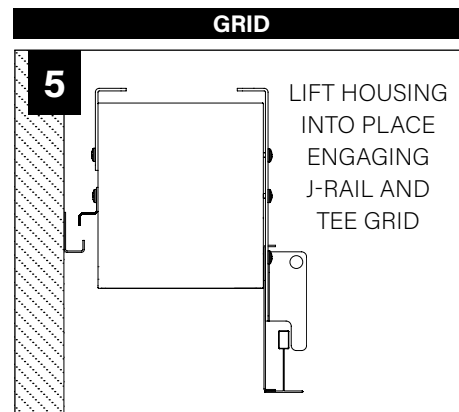
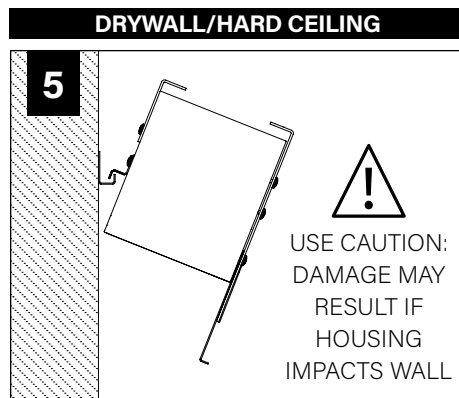
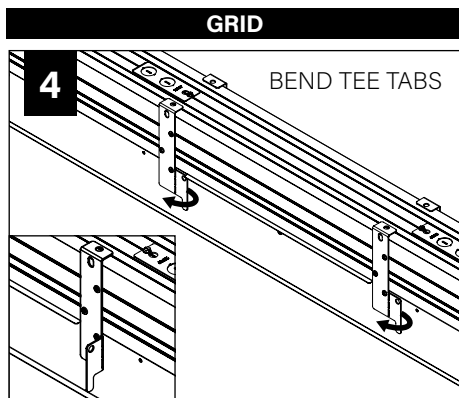

ADJUSTABLE HOUSING

IF HOUSING LENGTH IS CORRECT SKIP TO STEP 9

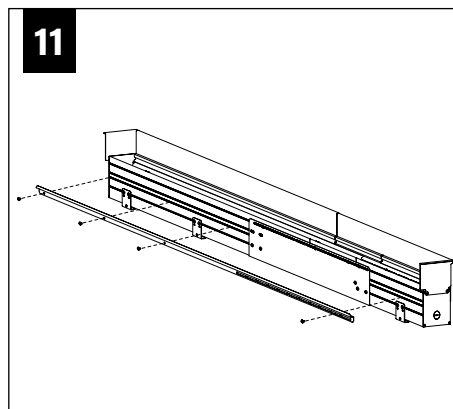
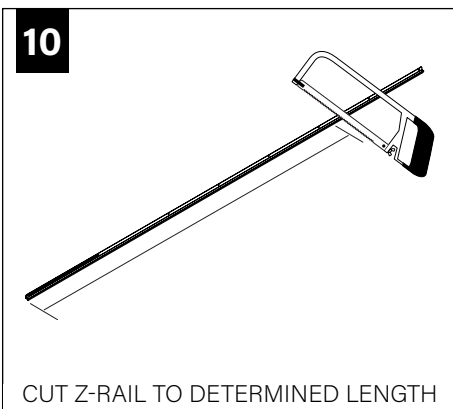
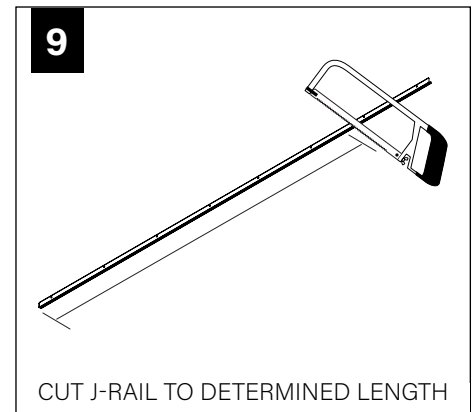
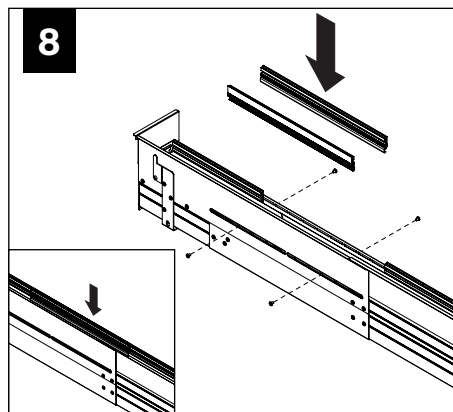
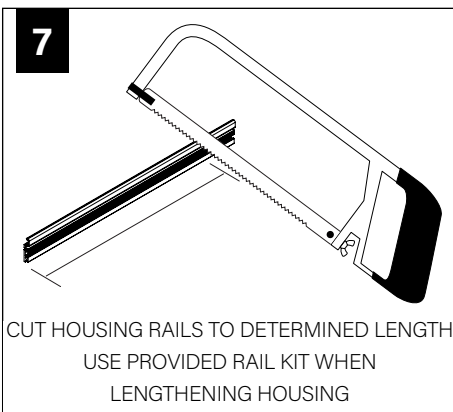
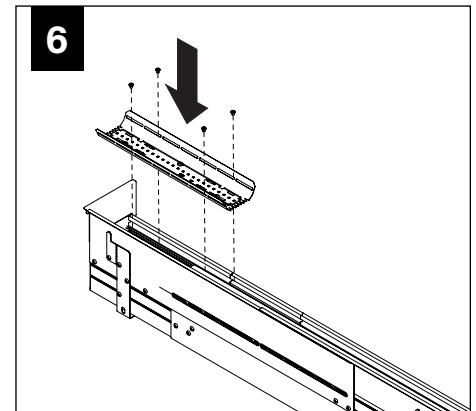
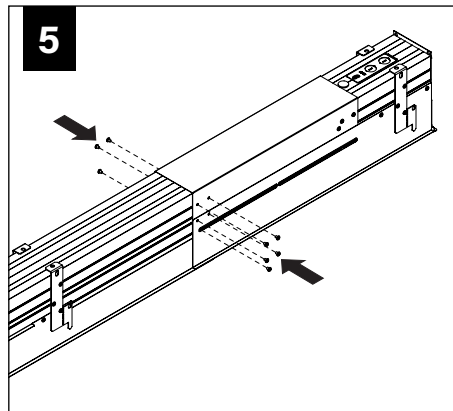
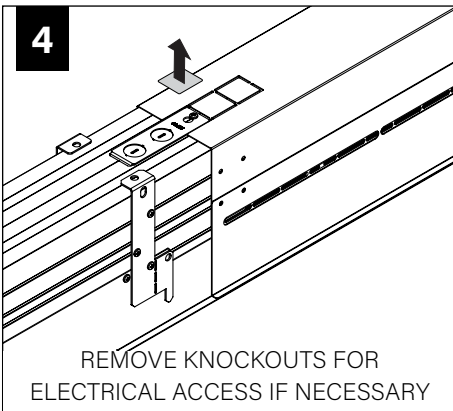
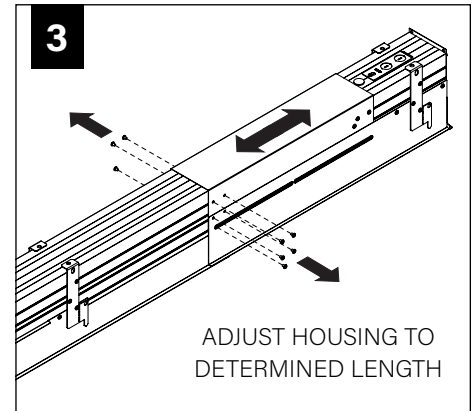
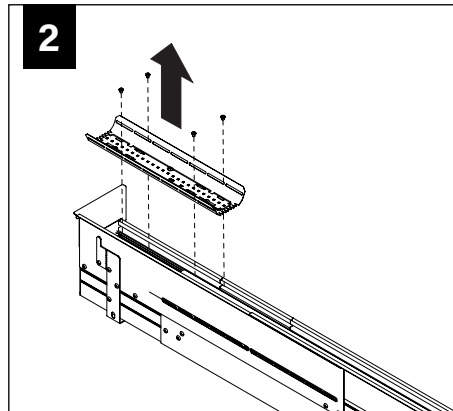
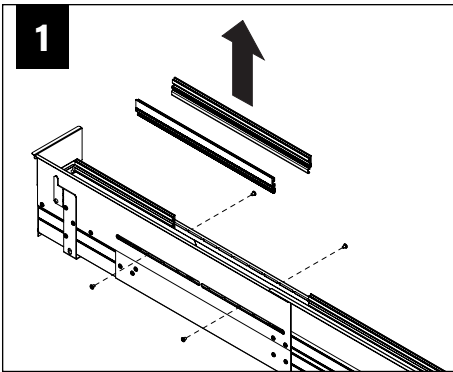

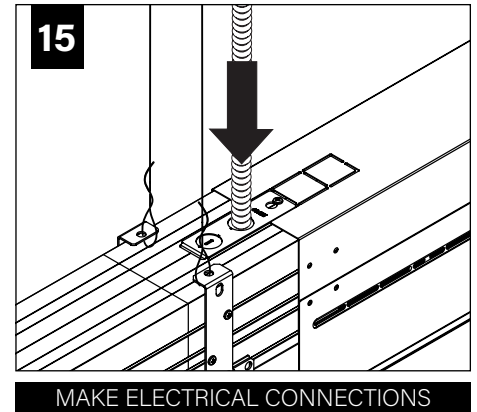
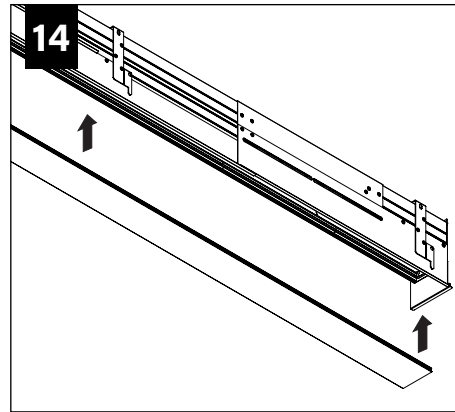
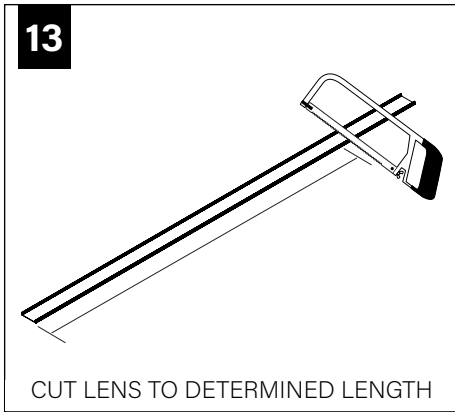

SLIDING SLEEVES



MAX LENGTH 12" PER SLEEVE



SLIDING SLEEVE DOES NOT INTEGRATE WITH ADJUSTABLE HOUSING

SINGLE SLIDING SLEEVE (SS):

EXAMPLE:
21' RUN LENGTH - 20' HOUSING = 12" SLIDING SLEEVE

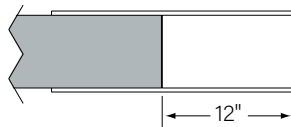

SLIDING SLEEVE PAIR (SSB):

EXAMPLE:
(21' RUN LENGTH - 20' HOUSING) / 2 = 6" SLIDING SLEEVE ON EACH END

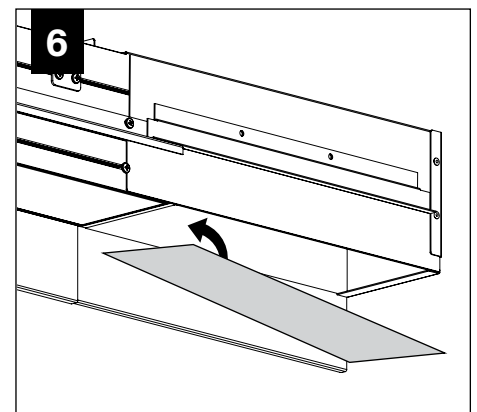
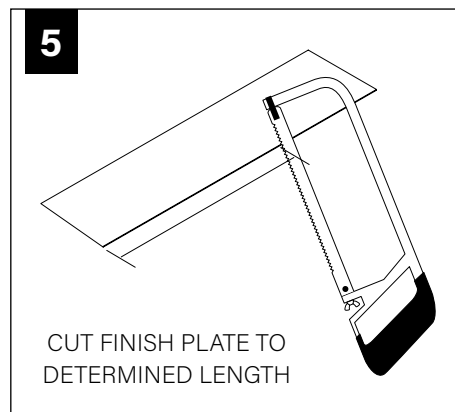
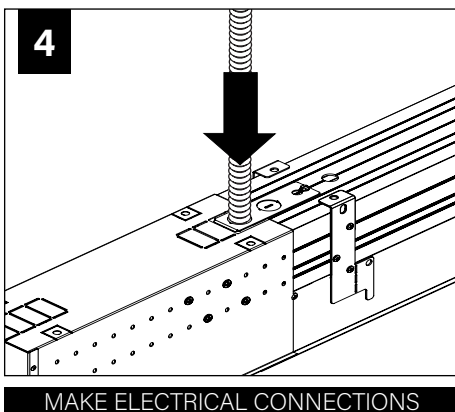
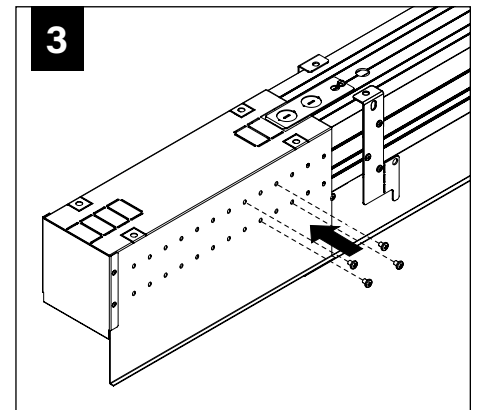
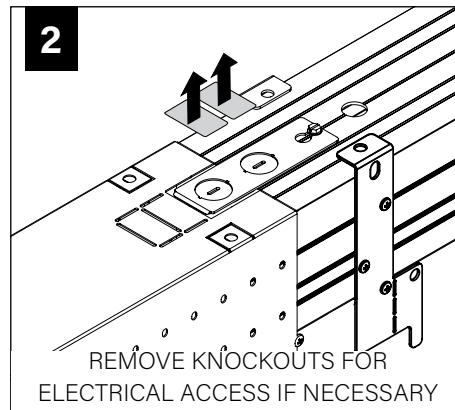
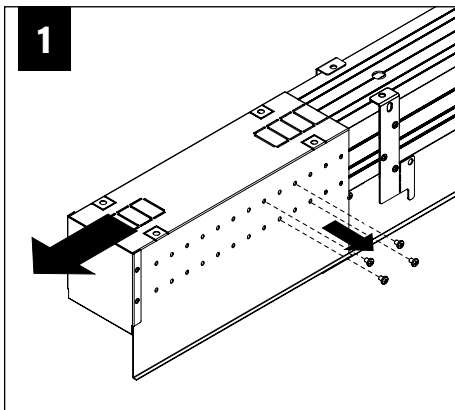
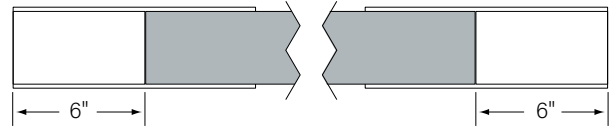

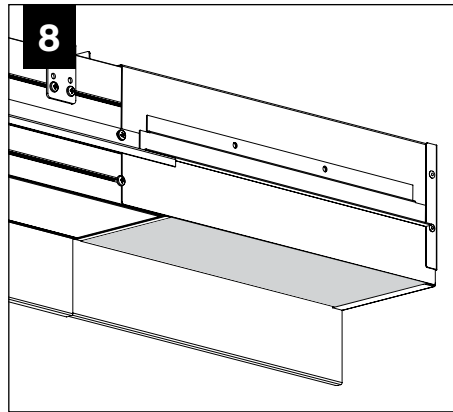
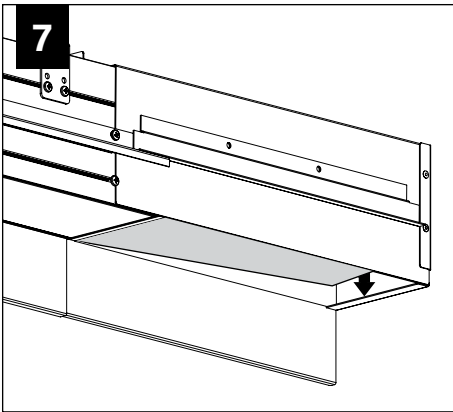

CORNERS

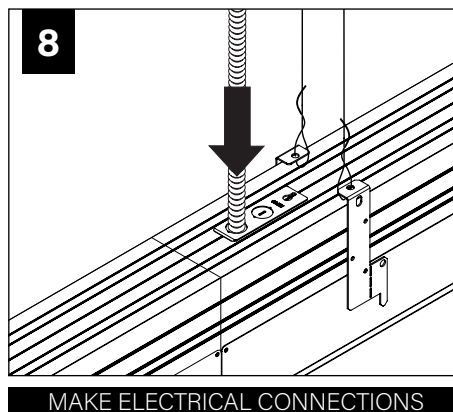
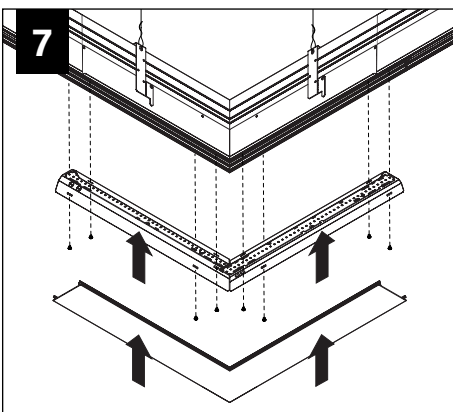
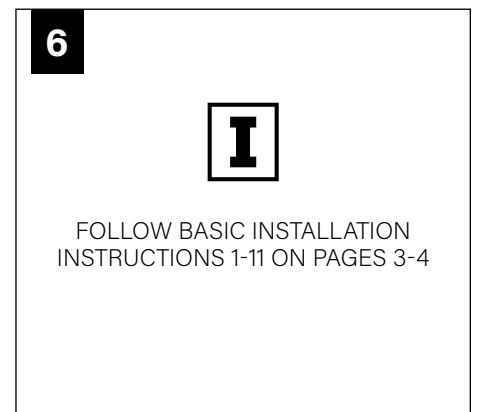
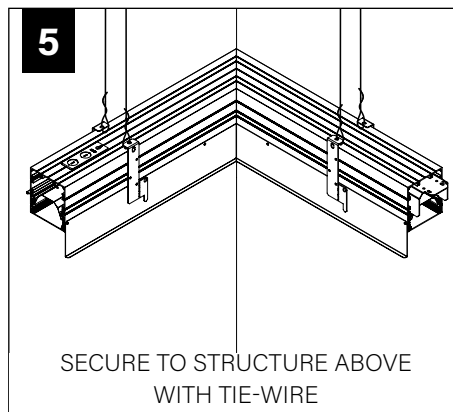
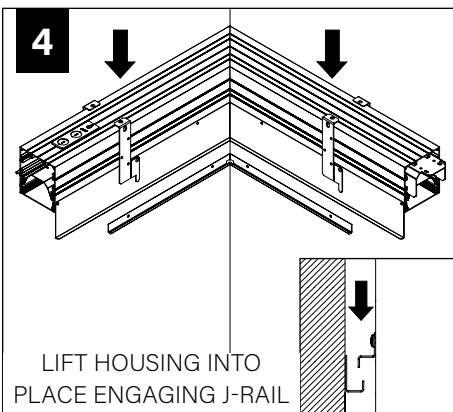
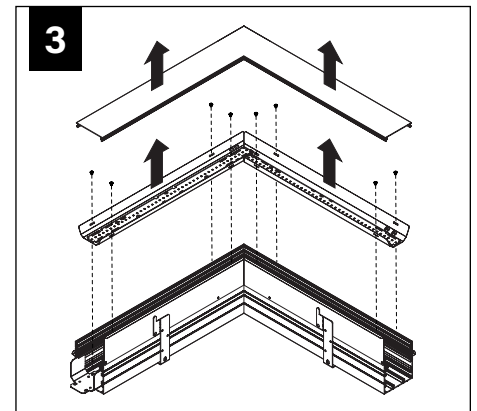
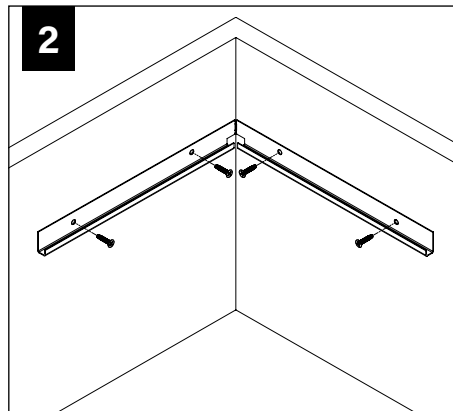
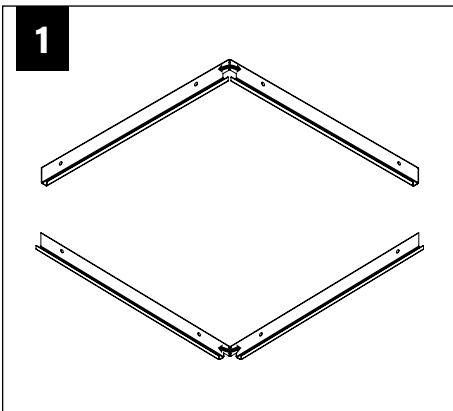

DRIVER SERVICE

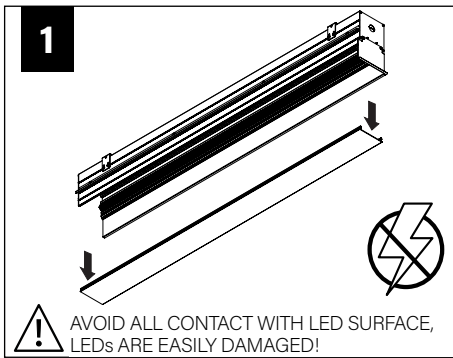

START, INTERMEDIATE, & END UNITS ONLY

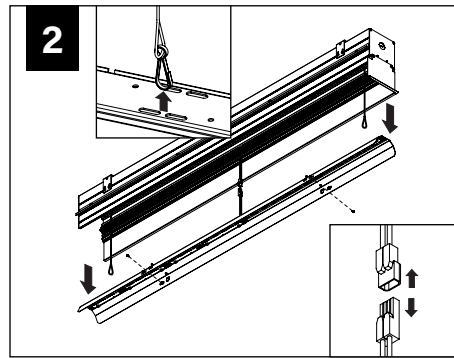

START, INTERMEDIATE, & END UNITS ONLY



GRID ONLY

WATTSTOPPER

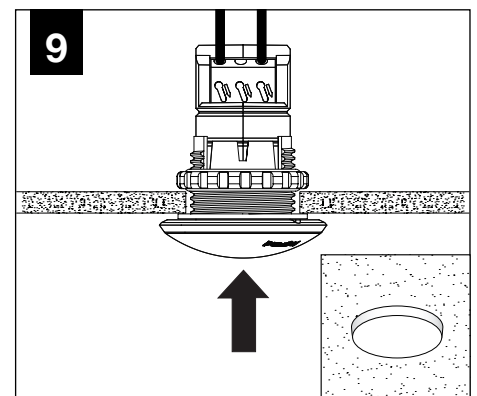
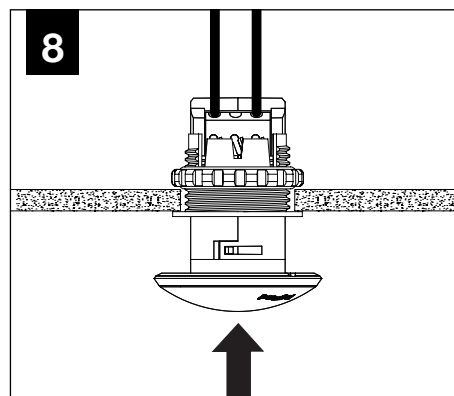
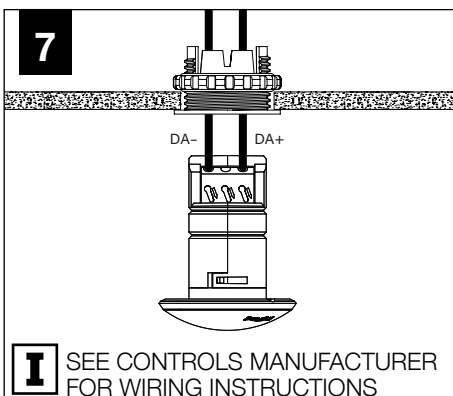
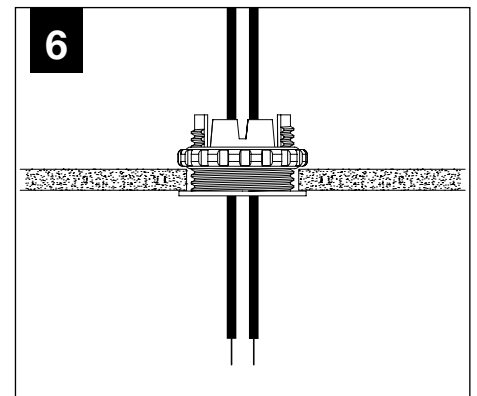
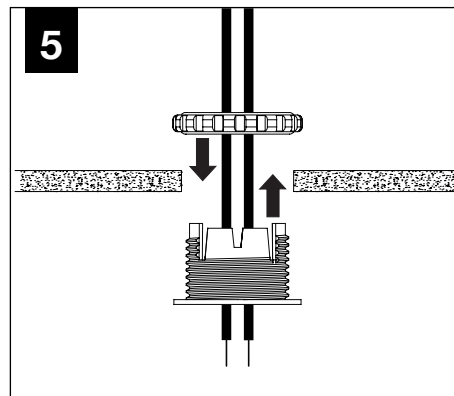
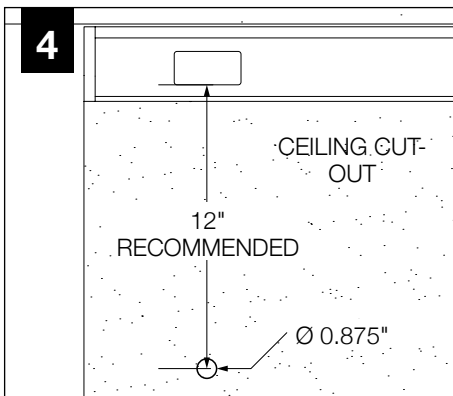
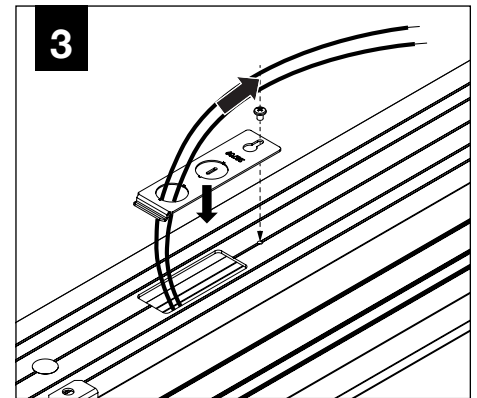
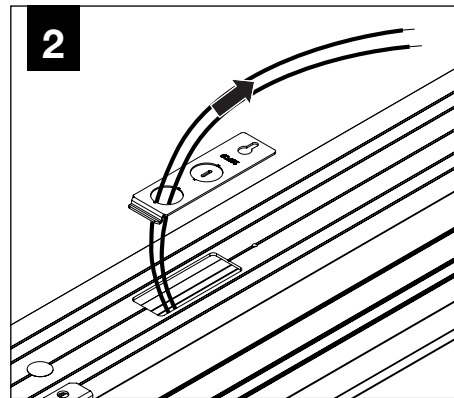
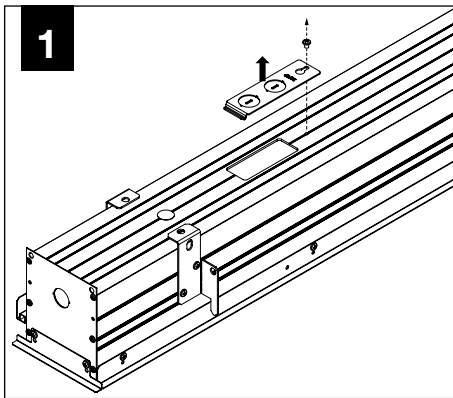

ENLIGHTENED

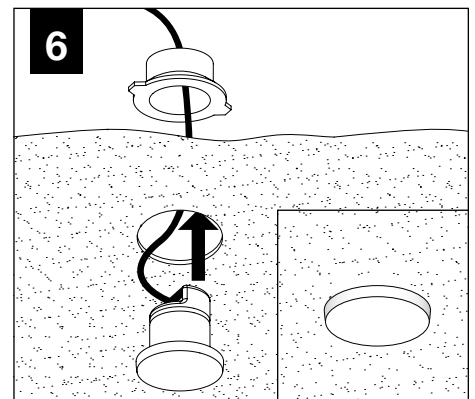
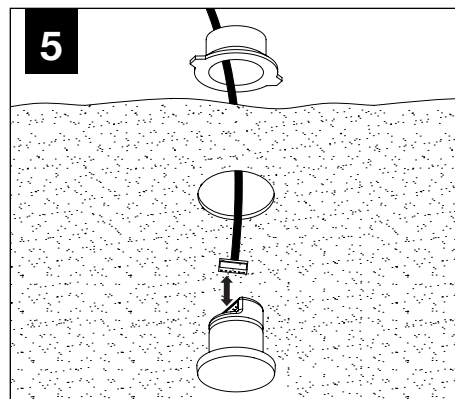
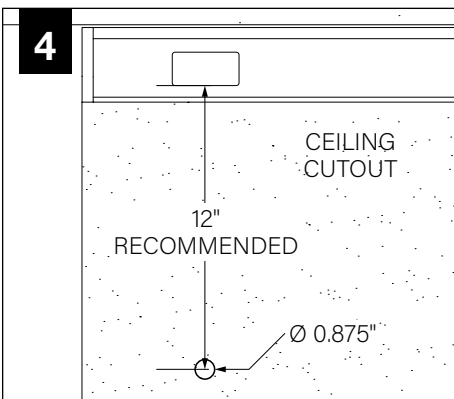
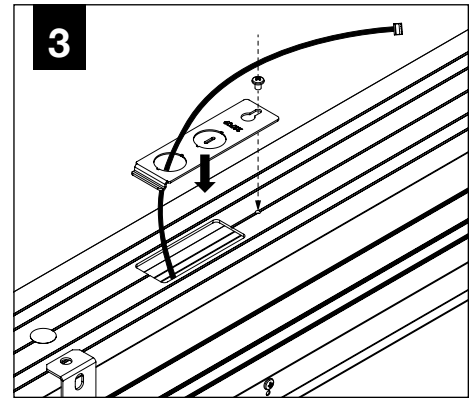
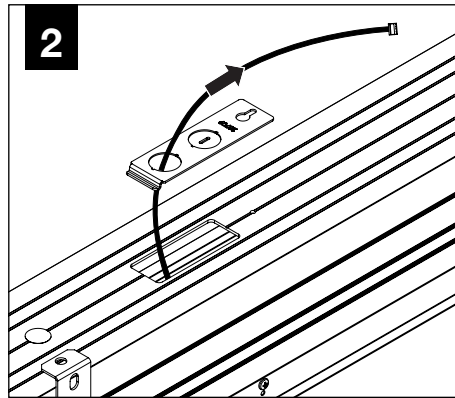
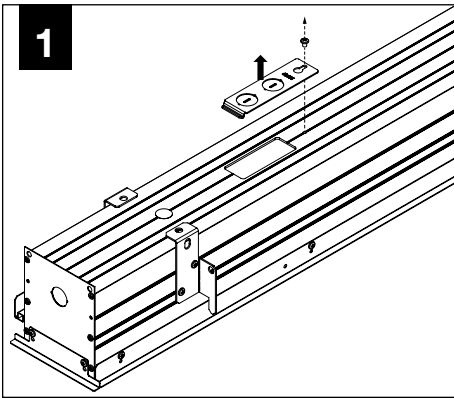

WAVELINX

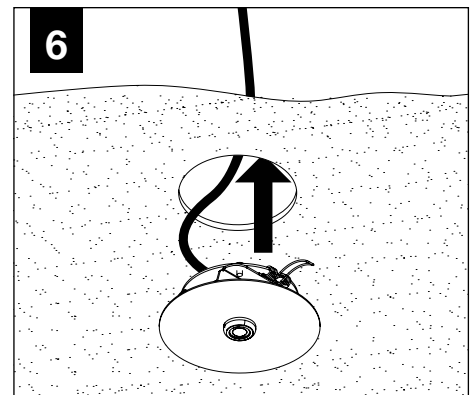
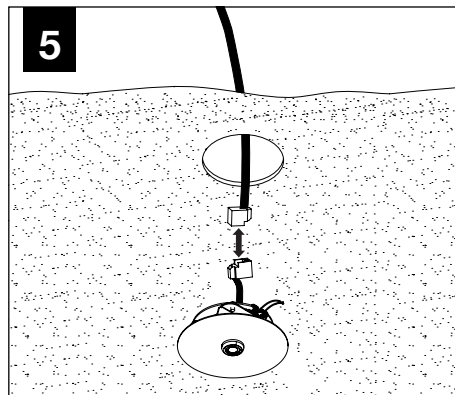
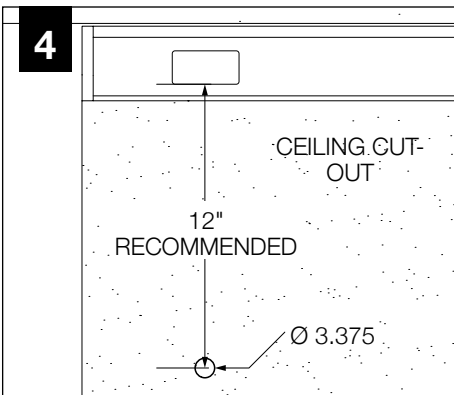
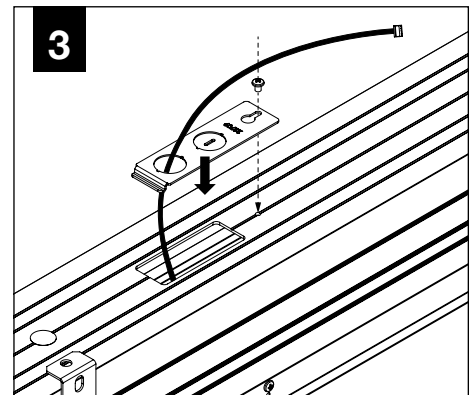
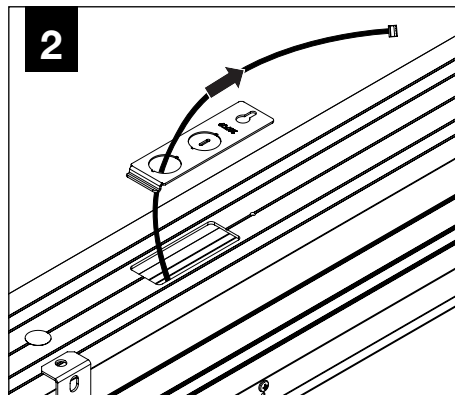
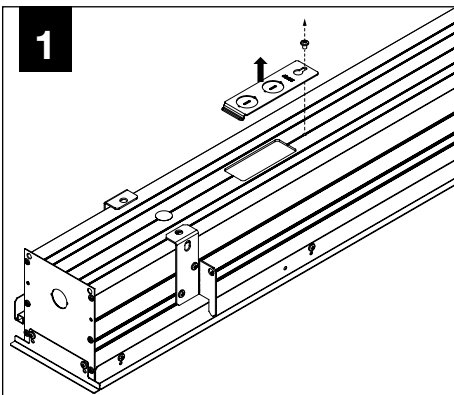

WAVELINX

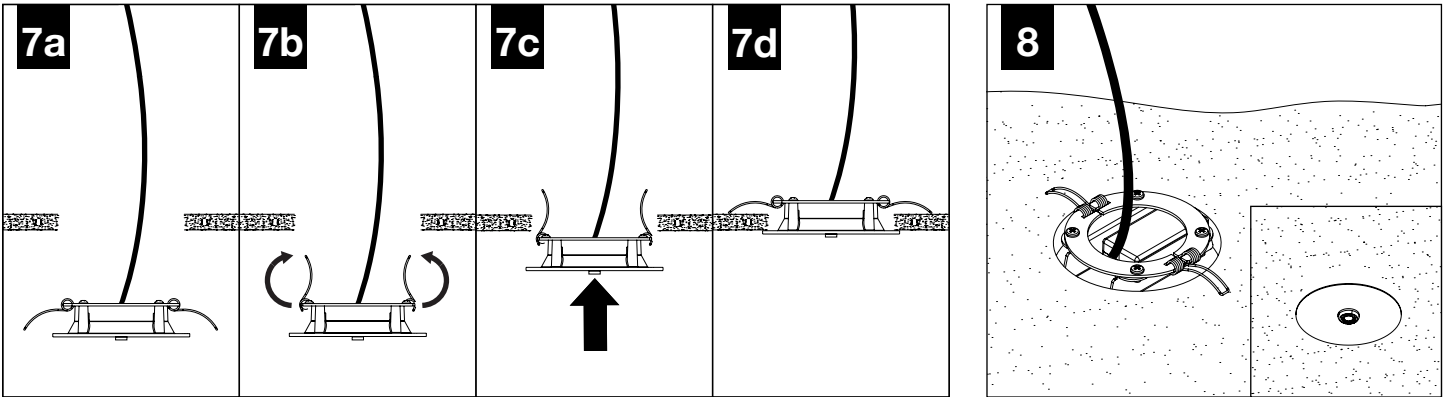

ACUITY nLIGHT

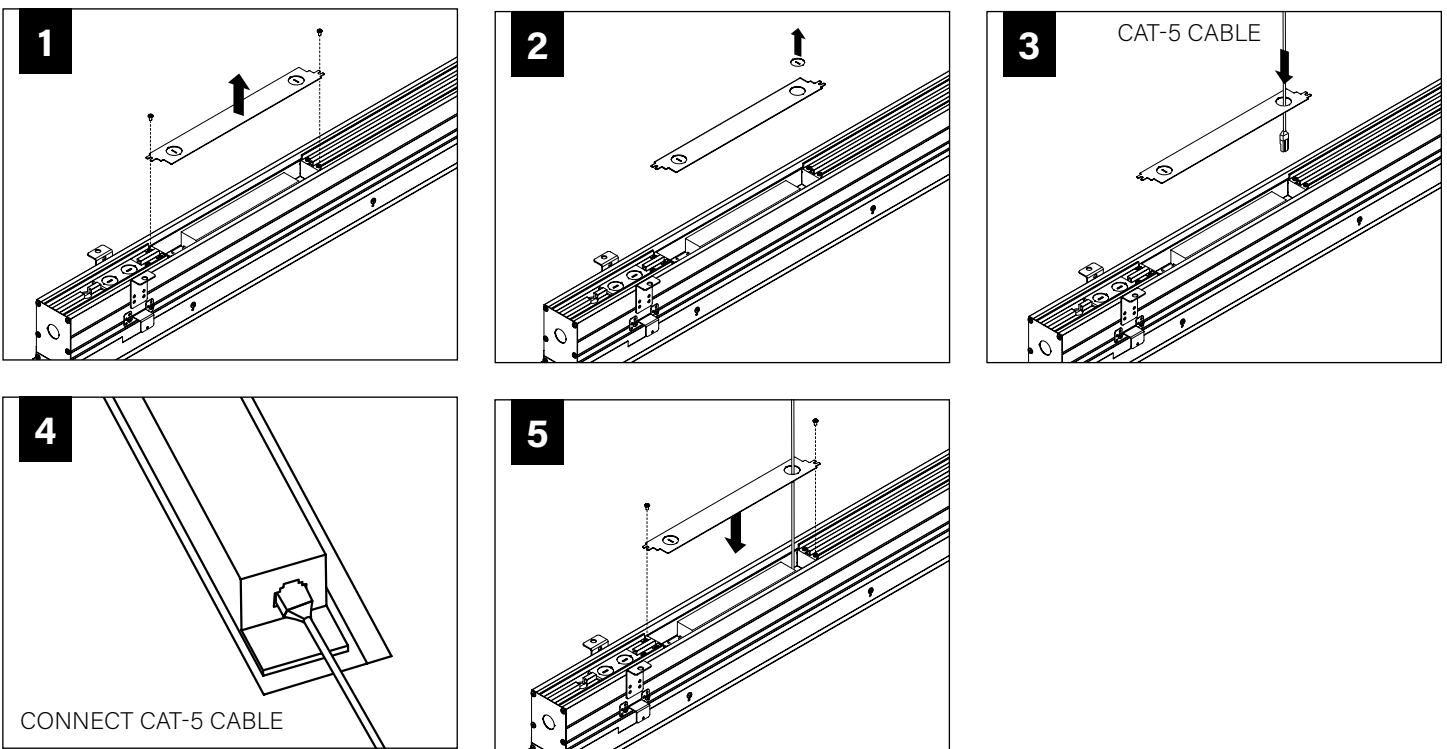

WATTSTOPPER

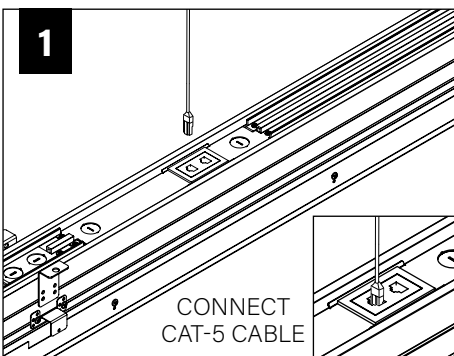

HUBBELL NX

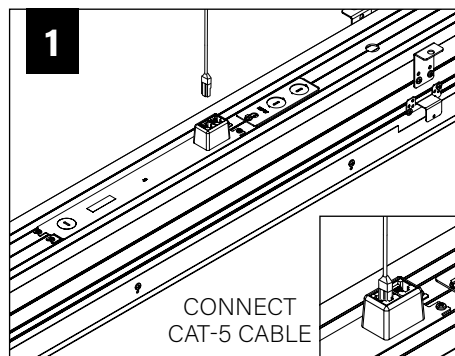

LUTRON ATHENA

