

# Seem® 4 Drywall/Hard Ceiling

LED

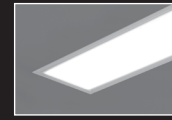

trimless mud-in



trim flange



regress lens



corner detail



wall to ceiling  
companion



grid ceiling  
companion

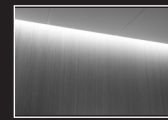

perimeter  
companion



suspended  
companion

## DIMENSIONAL DATA

### Trimless mud-in, Flush lens

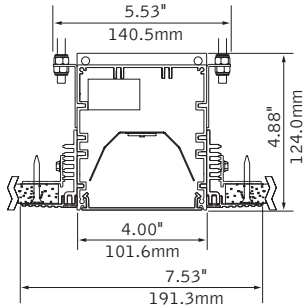

note: 0.375"min - 2.125"max ceiling thickness

### Trimless mud-in, Regress lens

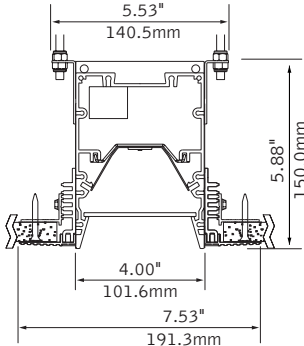

note: 0.375"min - 2.125"max ceiling thickness

### Trim flange

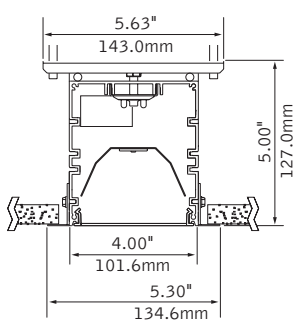

### Hard surface

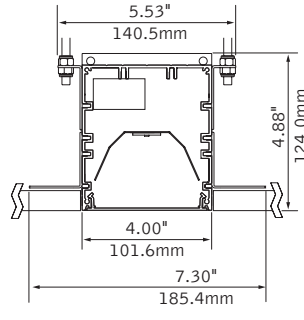

note: 0.375"min - 2.125"max ceiling thickness

## FEATURES

Extruded aluminum 4" aperture recessed slot LED integrates with drywall or hard ceilings or walls in a variety of mounting styles for a clean, unobtrusive aesthetic.

Individual units and continuous runs in 1" increments.

Frosted acrylic lens provides uninterrupted illumination, without pixels or shadows.

LED position and lens material optimized to provide the perfect blend of high performance and visual comfort.

Preferred Light: Lighting for better color rendition and human preference.

PoE compatible: Integrates with Power over Ethernet lighting systems via standard, low-voltage wires.

## DISTRIBUTIONS



project:

## DETAILS

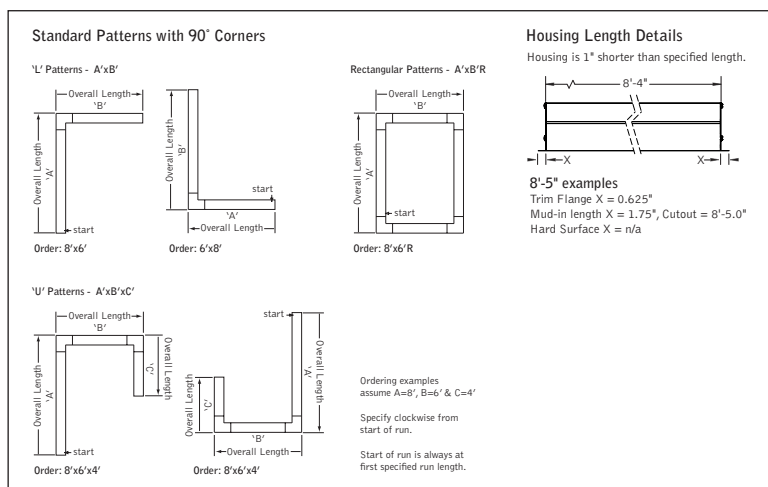

## SPECIFICATIONS

## LED System

Proprietary linear LED module incorporates premium LEDs on a robust platform to achieve excellent thermal management. LEDs are placed to promote a uniform appearance. Available in 2700K, 3000K, 3500K or 4000K with CRI>80 or CRI>90, 3 SDCM. 3500K and 4000K with CRI>90 have a cyanosis observation index (COI) of 3.3 or less. LED modules and drivers are replaceable from below.

## Construction

One piece extruded aluminum housing. 20 Ga. steel end caps. Housing for new construction applications. XFW acceptable for use with wood, consult factory for Type IC availability. 2' unit weight: 12 lbs., 3' unit weight: 16 lbs., 4' unit weight: 20 lbs., 5' unit weight: 24 lbs.

## Optic

Reflectors fabricated of 22 Ga. steel finished in High Reflectance White powder coat. Extruded acrylic lens .085" thick with satin finish, up to 8' continuous.

## Electrical

Luminaires are pre-wired with factory installed branch circuit wiring and over-molded quick connects. Standard 120-277V constant current driver includes 0-10V analog dimming. Power factor > .9. PoE compatible: Integrates with Power over Ethernet lighting systems via standard, low-voltage wires. PoE runs require an independent PoE node and power feed for each luminaire section.

## Emergency

Output - 10 watts for 90 minutes. Maximum mounting height: 19.2ft.

## Labels

UL and cUL listed. Suitable for Dry or Damp Locations, indoor use only.

## Finish

Polyester powder coat applied over a multi-stage pre-treatment.

## Lumen Maintenance

Reported: L70 > 61,000 hours                      Calculated: L70 at > 480,000 hours  
 L90 > 61,000 hours                                      L90 at > 128,000 hours  
 (Derived from EPA T-M21 calculator. Based on typical conditions, consult factory for additional data.)

## Reliability

At Focal Point, our products are designed to stand the test of time. Each luminaire is engineered using superior components, manufactured with the utmost care and rigorously tested. Contact us for reliability data.

## Warranty

LED system rated for operation in ambient environments up to 25°C. 5-year limited warranty.

#### 4' PERFORMANCE CHART

See page 3.

ORDERING		FSM4L
Luminaire Series		
Seem 4 LED	FSM4L	
Shielding		
Batwing Lens	BW	
Flush Satin Lens	FL	
Regress Lens	SR	
(Ceiling applications only)		
Regress High Performance Lens	SRXP	
(Ceiling applications only)		
Lumen Output		
275 Lumens per foot	275LF	
(Not available with LH1.)		
375 Lumens per foot	375LF	
(Not available with LH1.)		
625 Lumens per foot	625LF	
(BW, FL & SR 3' minimum with LH1. SRXP 4' minimum with LH1. Patterns not available with LH1.)		
875 Lumens per foot	875LF	
(SR & SRXP 3' minimum with LH1. SR & SRXP with LH1 not available on patterns.)		
1000 Lumens per foot	1000LF	
1125 Lumens per foot	1125LF	
1250 Lumens per foot	1250LF	
Color Temperature		
2700K, 80+ CRI or 90+ CRI	27K or 927K	
3000K, 80+ CRI or 90+ CRI	30K or 930K	
3500K, 80+ CRI or 90+ CRI	35K or 935K	
4000K, 80+ CRI or 90+ CRI	40K or 940K	
3500K, Preferred Light	P35K	
(Lenses only. 6" increments. Patterns not available.)		
Circuits & Zones		
1 Circuit, non-emergency	1C	
(Consult Ordering Guide on page 4 for multiple circuiting and zoning options)	_C_Z_DL	
Voltage		
120/277 UNV Volt	UNV	
Low Voltage	LV	
Control System & Dimming Level		
0-10V - 10% Dimming	LD1	
0-10V - 1% Dimming	L11	
Low Voltage, PoE compatible	LVN	
(Luminaire. Not available with EM or EC. LV Voltage only.)		
Lutron Hi-Lume EcoSystem (LDE1) -		
1% Dimming	LH1	
DALI 1% Dimming (1000LF max.)	D11	
Ceiling Configuration		
Trim Flange Drywall	TF	
(3' minimum with Lutron Drivers)		
Trim Flange Wood	TFW	
(3' minimum with Lutron Drivers)		
Trimless, pre-set for 1/2" Drywall	XF1	
Trimless, pre-set for 5/8" Drywall	XF2	
Trimless, set thickness in field	XFF	
(Mounting equipment assembled in field)		
Non-Drywall Hard Surface	XFN	
Hard Surface, Wood	XFW	
Factory Options		
(See Ordering Guide on page 4 for ordering details for DC, EC, EM & ECD.)		
Chicago Plenum	CP	
(Not available with Flex Whip)		
Daylight Circuit	_DC	
Emergency Circuit	_EC	
Emergency Battery Pack†	_EM	
Emergency Control Device†	_ECD	
(Minimum. 6' minimum with patterns. 120/277 Volt only. Not available at corners.)		
6' New York City Flex Whip (120V)	FN1	
6' New York City Flex Whip (277V)	FN2	
6' Flex Whip	FW	
Finish		
Matte White Housing	WH	
Luminaire Length		
Specify luminaire/row length in 1" increments	_ft_in	
(Minimum. Housing length is 1" shorter than specified. Leave blank for patterns.)		
Pattern Options		
(4" minimum length)		
'L' pattern	A' x B'	
'U' pattern	A' x B' x C'	
Rectangular pattern	A' x B' R	
(Consult factory for other pattern options)		



Options in orange qualify for the Quickship program. 1000' total, 48' maximum per pattern section. Refer to Quickship Guide for complete details including EM/EC options.

4' PERFORMANCE CHART

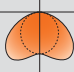
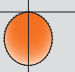
			LPW	
Lumens Output	Delivered Lumens	Tested System Watts		
			BW	FL
275	1100	10	104	100
375	1500	13	113	108
625	2500	22	112	107
875	3500	32	109	105
1000	4000	37	109	104
1125	4500	44	108	104
1250	5000	49	107	102

Based on 3500K, 80 CRI, 4' lengths. Lumen multipliers: Preferred Light = 0.65, 90+ CRI = 0.87.  
Lumen output may vary +/- 5%. Actual wattage may vary +/- 5%.

4' PERFORMANCE CHART - REGRESS

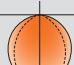
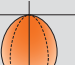
			LPW	
Lumens Output	Delivered Lumens	Tested System Watts		
			SR	SRXP
275	1100	12	79	98
375	1500	16	84	109
625	2500	26	84	110
875	3500	39	80	105
1000	4000	46	77	101
1125	4500	53	76	101
1250	5000	59	75	99

Based on 3500K, 80 CRI, 4' lengths. Lumen multipliers: Preferred Light = 0.65, 90+ CRI = 0.87.  
Lumen output may vary +/- 5%. Actual wattage may vary +/- 5%.

# Ordering Guide

## Linear Circuitry, Zones & Factory Options



### HOW TO USE THIS GUIDE

Fill out the worksheet on the following page to specify your requirements for circuitry, zones, and factory options.

Refer to the run chart for standard run configurations, consult factory for custom configurations.

Complete the Totals / Ordering Codes at the bottom of the worksheet and add to your ordering logic on the cut sheet.

Submit the worksheet along with your order.

EXAMPLE	TOTAL RUN LENGTH: <u>32ft</u>		JOB NAME: _____			FIXTURE TYPE: _____			
	HOUSING SECTION	SECTION LENGTH	SHARED ELECTRICAL FEED, NORMAL POWER			FACTORY OPTIONS			
						SEPARATE ELECTRICAL FEEDS			EM
			SWITCHING CIRCUIT	DIMMING ZONE	DAYLIGHT ZONE	DAYLIGHT CIRCUIT	EMERGENCY CIRCUIT	ECD	
	1	8	1C	1Z					1EM
	2	8	2C	2Z					
	3	8	2C	2Z					
	4	8				1DC			
	Totals / Ordering Codes		2C	2Z		1DC			1EM

ORDERING: FSM4L-FL-625LF-35K- **2C2Z** -UNV-LD1-G2- **1DC-1EM** -WH-32ft

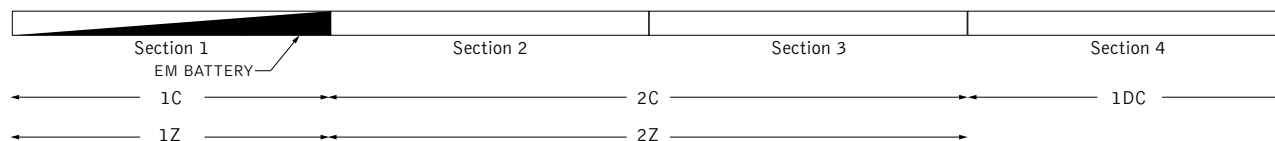

### KEY

**C = Switching Circuit**  
Switched Hot / Shared Neutral

**Z = Dimming Zone**  
Dimming Control Wires

**DL = Daylight Zone**  
Daylight Dimming Control Wires

**DC = Daylight Circuit**  
Switched Hot / Separate Neutral

**EC = Emergency Circuit**  
Switched Hot / Separate Neutral

**EM = Emergency Battery**  
Unswitched Hot / Shared Neutral

**ECD = Emergency Control Device**  
Unswitched Hot / Separate Neutral

### DEFAULTS

- Zones and Factory Options illuminate entire sections from 4' to 8' in length.
- One shared or isolated circuit and zone required per housing section.
- Limit of one EM or ECD per housing section.
- Additional electrical feed required for applications greater than three shared circuits and zones.
- Each DC, EC and ECD require an additional electrical feed.
- ECD not available in the same housing section as EC.
- Longer lead times and additional pricing may apply for custom run configurations.

### CUSTOM LENGTHS

- If partial illumination of emergency or daylight section is required, indicate in ordering guide and add "partial illumination" in Order Notes. Drawing required.
- Engineering validation required, longer lead times may apply.

# Ordering Guide Worksheet

Linear Circuitry, Zones & Factory Options



TOTAL RUN LENGTH: _____		JOB NAME: _____			FIXTURE TYPE: _____			
HOUSING SECTION	SECTION LENGTH	SHARED ELECTRICAL FEED, NORMAL POWER			FACTORY OPTIONS			
		SWITCHING CIRCUIT	DIMMING ZONE	DAYLIGHT ZONE	SEPARATE ELECTRICAL FEEDS			EM
						DAYLIGHT CIRCUIT	EMERGENCY CIRCUIT	
1								
2								
3								
4								
5								
6								
7								
8								
9								
10								
11								
12								
13								
14								
15								
16								
17								
18								
19								
20								
Totals / Ordering Codes								

Combine to create Circuits & Zones ordering code

Enter as individual Factory Options

## RUN CHART

Run length (ft)	Housing Configuration Section Lengths	Run length (ft)	Housing Configuration Section Lengths	Run length (ft)	Housing Configuration Section Lengths	Run length (ft)	Housing Configuration Section Lengths
9	5 + 4	21	8 + 8 + 5	33	8 + 8 + 8 + 5 + 4	45	8 + 8 + 8 + 8 + 8 + 5
10	6 + 4	22	8 + 8 + 6	34	8 + 8 + 8 + 6 + 4	46	8 + 8 + 8 + 8 + 8 + 6
11	7 + 4	23	8 + 8 + 7	35	8 + 8 + 8 + 7 + 4	47	8 + 8 + 8 + 8 + 8 + 7
12	8 + 4	24	8 + 8 + 8	36	8 + 8 + 8 + 8 + 4	48	8 + 8 + 8 + 8 + 8 + 8
13	8 + 5	25	8 + 8 + 5 + 4	37	8 + 8 + 8 + 8 + 5		
14	8 + 6	26	8 + 8 + 6 + 4	38	8 + 8 + 8 + 8 + 6		
15	8 + 7	27	8 + 8 + 7 + 4	39	8 + 8 + 8 + 8 + 7		
16	8 + 8	28	8 + 8 + 8 + 4	40	8 + 8 + 8 + 8 + 8		
17	8 + 5 + 4	29	8 + 8 + 8 + 5	41	8 + 8 + 8 + 8 + 5 + 4		
18	8 + 6 + 4	30	8 + 8 + 8 + 6	42	8 + 8 + 8 + 8 + 6 + 4		
19	8 + 7 + 4	31	8 + 8 + 8 + 7	43	8 + 8 + 8 + 8 + 7 + 4		
20	8 + 8 + 4	32	8 + 8 + 8 + 8	44	8 + 8 + 8 + 8 + 8 + 4		

Standard run configurations, consult factory for custom configurations.