

Seem® 4 LED

FSM4L-TF | FSM4L-NF | Trim Flange | No Flange



BEFORE YOU BEGIN

- Luminaires must be installed by a qualified electrician (check with local and national codes for proper installation).
- To prevent electrical shock, disconnect electrical supply before installation or servicing.
- Contractor is responsible for adequately reinforcing walls and/or ceilings to support fixture weight.
- Focal Point, LLC accepts no responsibility for inadequately reinforced walls and/or ceilings.
- The information contained in this drawing is the sole property of Focal Point, LLC. Any reproduction in part or whole without the written permission of Focal Point, LLC is prohibited.

INSTRUCTION KEY



ATTENTION



SEE ADDITIONAL INSTRUCTIONS



POWER OFF



POWER ON

COMPONENT KEY

FOCAL POINT

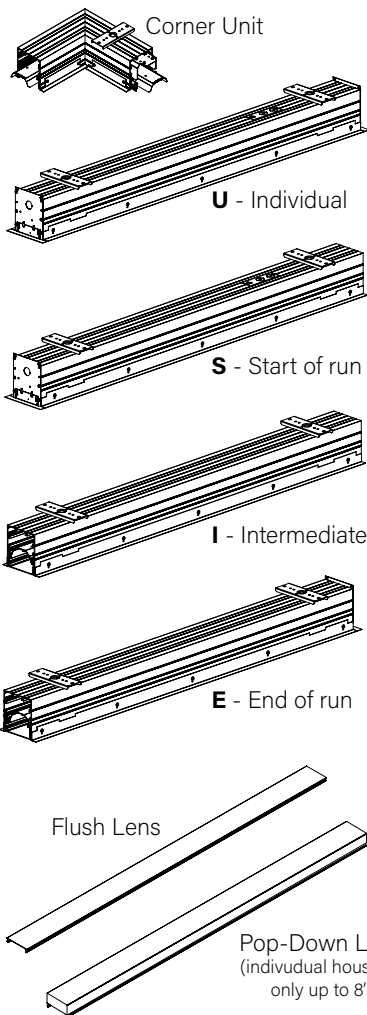

INCLUDED HARDWARE



Reflector Screw
(70008)

(6-32 X 5/16 Pan-head machine screw)

PARTS SHIPPED INSTALLED

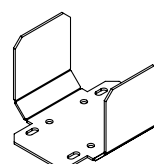

Joiner Bracket
(A08094-01)



Joiner Bracket
(11920)

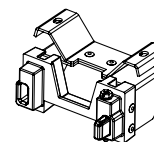

Joiner Bracket
(Regress Lens)
(A20081-01)

Mounting Bracket
Assembly

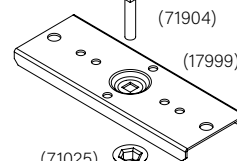

(71025)

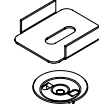

(18495)

(71024)



Alignment
Bracket screw
(regress lens)
(72029)



Alignment
Bracket
(regress lens)
(A22092-01)

! MOUNTING BRACKET MUST BE INSTALLED PRIOR TO DRYWALL/CEILING

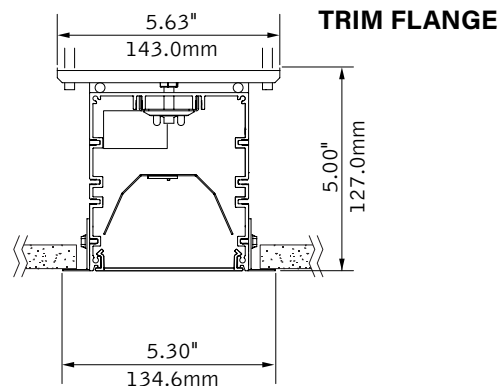

TRIM FLANGE





MOUNTING BRACKET MUST BE
SECURED TO STRUCTURE ABOVE.

1/4" - 20 CARRIAGE BOLT MAY
BE SUPPLIED BY OTHERS FOR
GREATER ADJUSTABILITY.

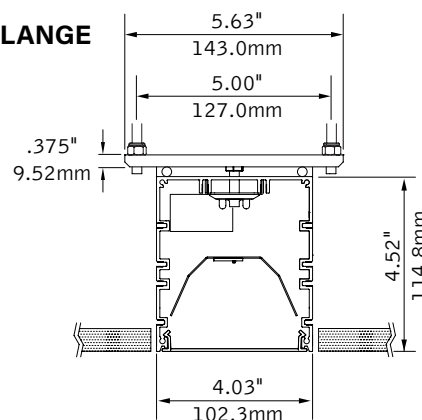
NO FLANGE

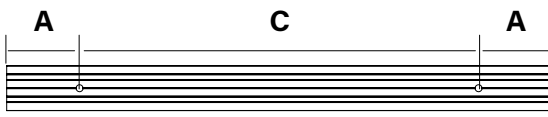

MOUNTING LOCATIONS

 <p>START OF RUN/INDIVIDUAL</p>	FLUSH LENS				REGRESS LENS			
	HOUSING LENGTH	A	B	C	HOUSING LENGTH	A	B	C
 <p>INTERMEDIATE/END OF RUN</p>	2'	3"	17"	18"	2'	1"	21"	22"
	3'	6"	23"	24"	3'	1"	33"	34"
	4'	6"	35"	36"	4'	6"	35"	36"
	5'	6"	47"	48"	5'	6"	47"	48"
	6'	6"	59"	60"	6'	6"	59"	60"
	7'	6"	71"	72"	7'	6"	71"	72"
 <p>MOUNTING LOCATION CHART IS AN APPROXIMATE GUIDE ONLY.</p>	8'	6"	83"	84"	8'	6"	83"	84"

CEILING CUTOUT - TRIM FLANGE

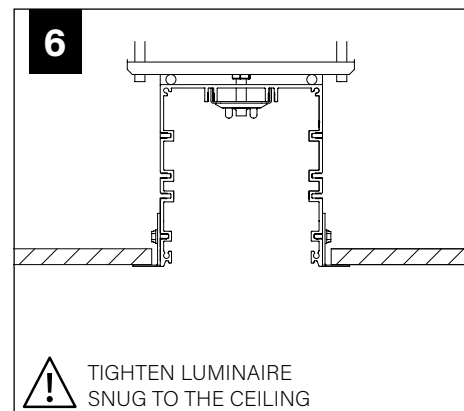
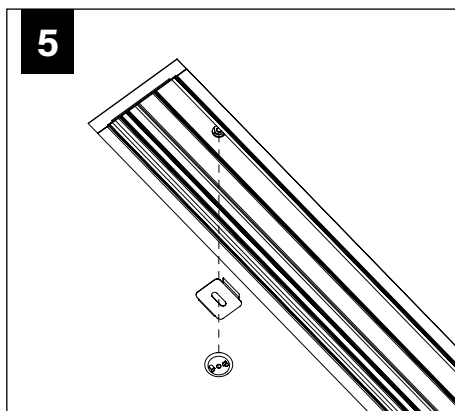
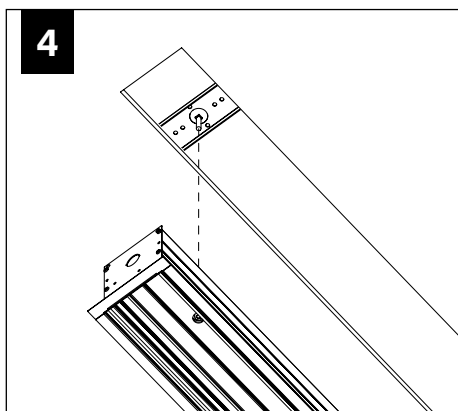
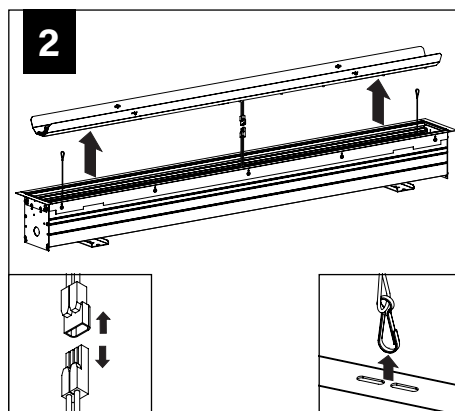
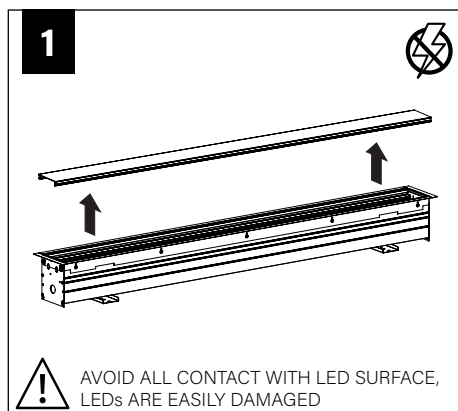
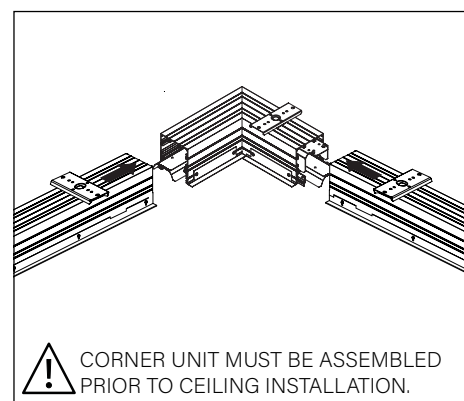
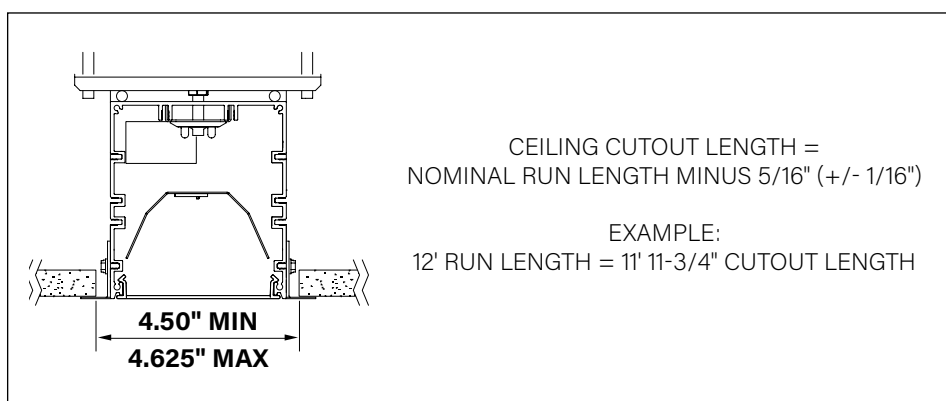

REPEAT STEPS 4-6 UNTIL ALL
UNITS ARE IN THE CEILING

INDIVIDUAL INSTALLATIONS
SKIP TO STEP 10

REGRESS LENS

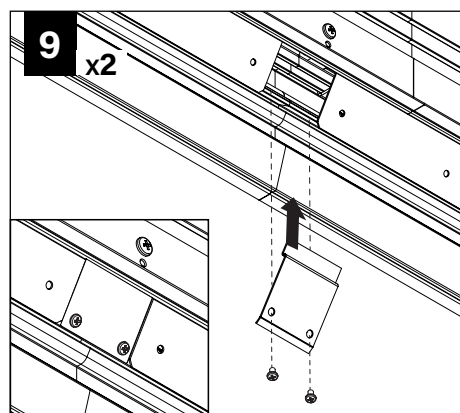
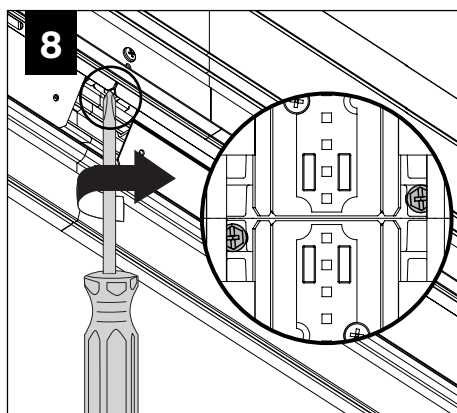
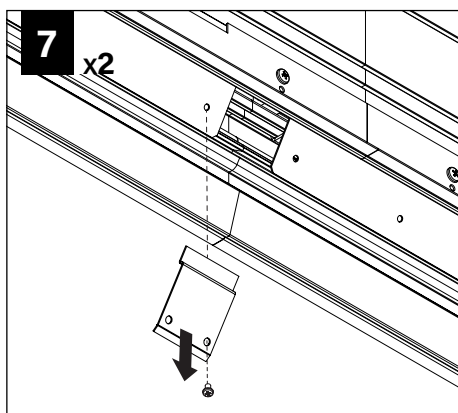

FLUSH/POP-DOWN LENS

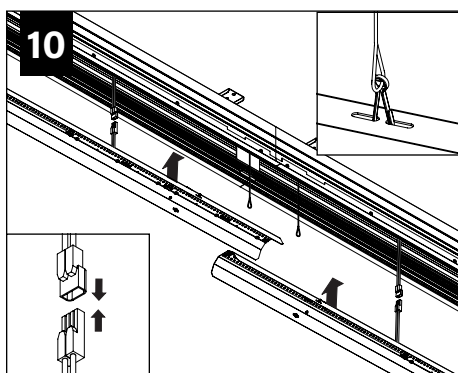
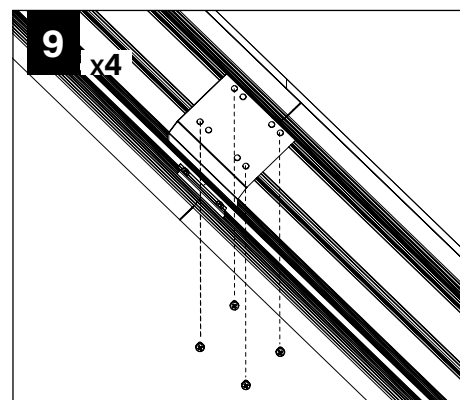
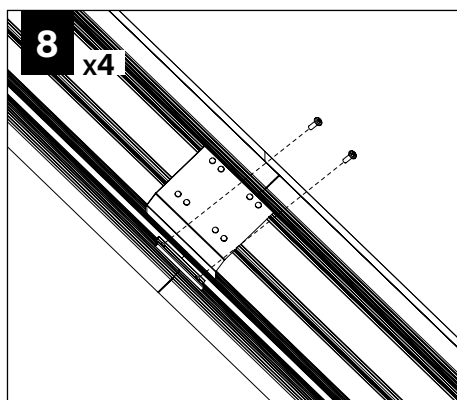
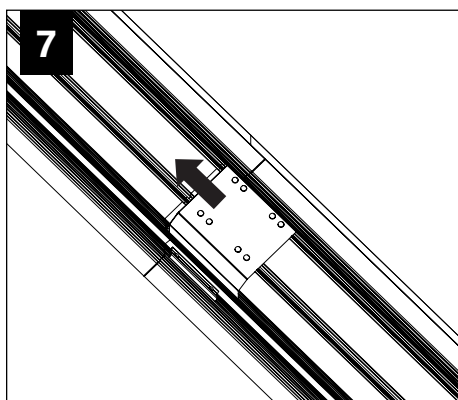

MAKE ELECTRICAL CONNECTION

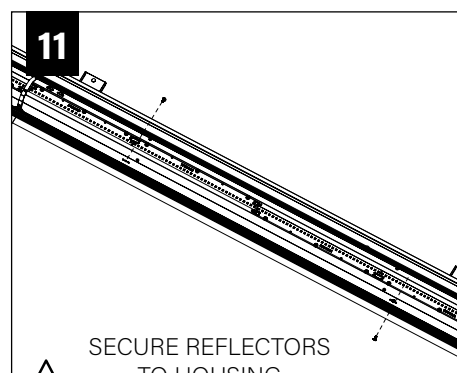

SECURE REFLECTORS
TO HOUSING
(2 SCREWS PER REFLECTOR)

FLUSH LENS

12

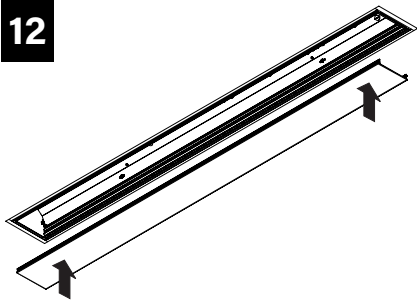

REFERENCE INSTRUCTIONS
ON INCLUDED TOOL FOR
LENS INSTALLATION.

POP-DOWN LENS

12

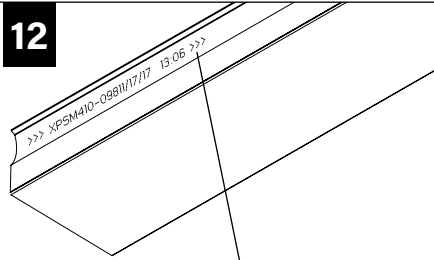

USE IMPRINT ON 0.5" POP-DOWN
LENSES TO ENSURE ALL LENSES
ARE INSTALLED FACING THE
SAME DIRECTION

13

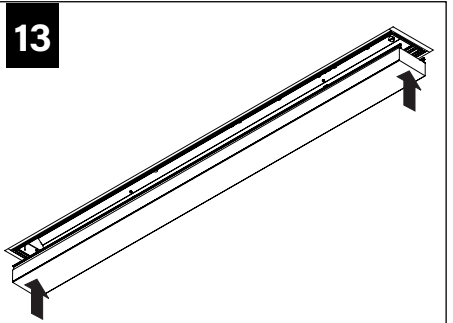

EMERGENCY



SEE BATTERY MANUFACTURER
INSTRUCTIONS

EMERGENCY MAXIMUM MOUNTING HEIGHT:
13.00'

DRIVER SERVICE

1

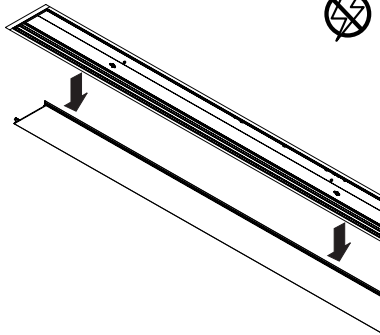

2

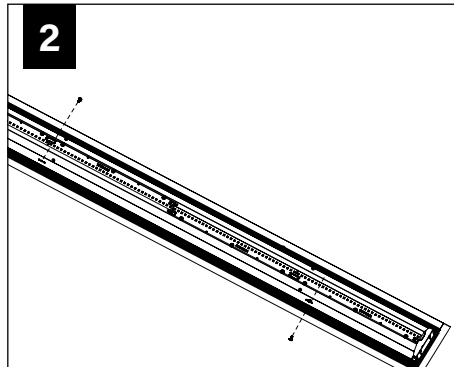

3

