

# Seem® 4 Grid Ceiling

LED WITH POP-DOWN LENS



0.5" pop-down lens



pop-down lens  
drywall companion



suspended pop-down  
lens companion



flush lens  
companion



regress lens  
companion



wall to ceiling  
companion



suspended & wall  
companion



perimeter  
companion

## DIMENSIONAL DATA

1.5" Pop-down lens, lay-in

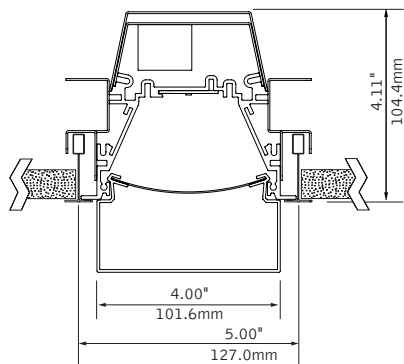

Pop-down lens,  
Tegular detail

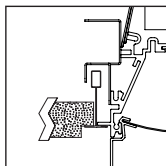

0.5" Pop-down lens, lay-in

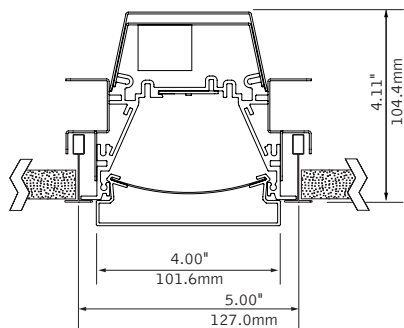

## FEATURES

4" aperture recessed LED slot with 0.5" or 1.5" Pop-Down lens integrates with grid ceilings for a clean, unobtrusive aesthetic.

Dimensional frosted acrylic lens provides uninterrupted illumination, without pixels or shadows.

LED position and lens material optimized to provide the perfect blend of high performance and visual comfort.

Preferred Light: Lighting for better color rendition and human preference.

PoE compatible: Integrates with Power over Ethernet lighting systems via standard, low-voltage wires.

## PERFORMANCE

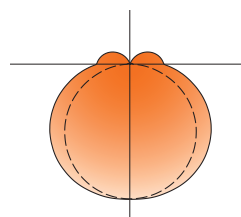

### PRODUCT OVERVIEW

Lumen Output:	1000 - 3000
Wattage:	14 - 47
LPW:	76 - 86
SDCM:	3

### 4' - 1.5" Pop-Down Lens

Nominal output:  
750 Lumens per foot

**Delivered Lumens: 3109**

**Total System Watts: 36**

Photometric performance is measured in accordance with IESNA LM-79.  
Visit [focalpointlights.com](http://focalpointlights.com) for complete photometric data.

fixture:

project:

DETAILS

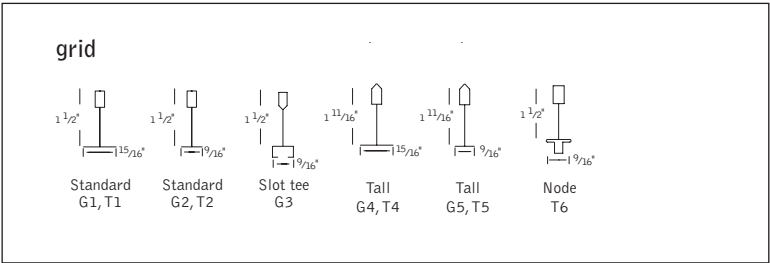

SPECIFICATIONS

LED System

Proprietary linear LED module incorporates premium LEDs on a robust platform to achieve excellent thermal management. LEDs are placed to promote a uniform appearance. Available in 2700K, 3000K, 3500K or 4000K with CRI>80 or CRI>90, 3 SDCM. 3500K and 4000K with CRI>90 have a cyanosis observation index (COI) of 3.3 or less. LED modules are replaceable from below. Drivers are replaceable from above.

Construction

One piece extruded aluminum housing, 20 Ga. steel end caps. Housing for new construction applications. 4' unit weight: 11 lbs., 8' unit weight: 22 lbs.

Optic

Reflectors fabricated of 22 Ga. steel finished in High Reflectance White powder coat. Extruded acrylic lens .06" thick with frosted finish, up to 8' continuous.

Electrical

Luminaires are pre-wired with factory installed branch circuit wiring and over-molded quick connects. Standard 120-277V constant current driver includes 0-10V analog dimming. Power factor >.9. PoE compatible: Integrates with Power over Ethernet lighting systems via standard, low-voltage wires. PoE runs require an independent PoE node and power feed for each luminaire section.

Emergency Battery

Emergency output - 10 watts for 90 minutes. Maximum mounting height: 16.2ft

Labels

UL and cUL listed. Suitable for Dry or Damp Locations, indoor use only.

Finish

Polyester powder coat applied over a multi-stage pre-treatment.

Lumen Maintenance

Reported: L70 > 61,000 hours      Calculated: L70 at > 480,000 hours  
L90 > 61,000 hours      L90 at > 128,000 hours  
(Derived from EPA TM-21 calculator. Based on typical conditions, consult factory for additional data.)

Reliability

At Focal Point, our products are designed to stand the test of time. Each luminaire is engineered using superior components, manufactured with the utmost care and rigorously tested. Contact us for reliability data.

Warranty

LED system rated for operation in ambient environments up to 25°C. 5-year limited warranty.

4' PERFORMANCE CHART

Shielding	Lumens per Foot	Delivered Lumens	Tested System Watts	LPW
0.5" Pop-Down Lens	275LF	1107	14	79
	375LF	1505	20	77
	625LF	2507	33	76
	750LF	3000	36	78
1.5" Pop-Down Lens	275LF	1107	13	83
	375LF	1502	18	85
	625LF	2518	29	86
	750LF	3000	36	85

Based on 3500K, 80 CRI, 4' lengths. Lumen multipliers: Preferred Light = 0.65, 90+ CRI = 0.87.  
Lumen output may vary +/- 5%. Actual wattage may vary +/- 5%.

ORDERING

Luminaire Series

Seem 4 LED FSM4L

Shielding

0.5" Pop-Down Lens PD05

1.5" Pop-Down Lens PD15  
(2' - 8' individual units only)

Lumen Output

275 Lumens per foot 275LF  
(Not available with Lutron Drivers.)

375 Lumens per foot 375LF  
(Not available with LH1.)

625 Lumens per foot 625LF  
(3' minimum with LH1.)

750 Lumens per foot 750LF

Color Temperature

2700K, 80+ CRI or 90+ CRI 27K or 927K

3000K, 80+ CRI or 90+ CRI 30K or 930K

3500K, 80+ CRI or 90+ CRI 35K or 935K

4000K, 80+ CRI or 90+ CRI 40K or 940K

3500K, Preferred Light P35K

Circuits & Zones

1 Circuit, non-emergency 1C

Consult Ordering Guide on page 3 for multiple circuiting and zoning options

Voltage

120/277 UNV Volt UNV

Low Voltage LV

Control System & Dimming Level

0-10V - 10% Dimming LD1

0-10V - 1% Dimming L11

Low Voltage, PoE compatible LVN

(No driver. Not available with EM or EC. LV Voltage only.)

Lutron Hi-Lume EcoSystem (LDE1) -

1% Dimming LH1

DALI 1% Dimming D11

Ceiling Configuration

Std. 15/16" Lay-in G1

Std. 15/16" Tegular T1

Std. 9/16" Lay-in G2

Std. 9/16" Tegular T2

9/16" Slot-tee Tegular G3

Tall 15/16" Lay-in G4

Tall 15/16" Tegular T4

Tall 9/16" Lay-in G5

Tall 9/16" Tegular T5

Node 9/16" Tegular T6

Factory Options

(See Ordering Guide on page 3 for ordering details for DC, EC, EM & ECD.)

Chicago Plenum CP

Daylight Circuit \_DC

Emergency Circuit \_EC

(Not available with Flex Whip)

Emergency Battery Pack<sup>†</sup> \_EM

Emergency Control Device<sup>†</sup> \_ECD

<sup>†</sup>(4' minimum, 120/277 Volt only)

6' New York City Flex Whip (120V) FNY1

6' New York City Flex Whip (277V) FNY2

6' Flex Whip FW

Finish

Matte White Housing WH

Luminaire Length

Specify luminaire/row length

in 1' increments X'

(2' minimum. 1.5" Pop-Down lens available in 2' - 8'

individual units only. Smaller increments available.

Consult factory for details.)



Options in orange qualify for the Quickship program. Run lengths in 1' increments, 1000' total. Refer to Quickship Guide for complete details including EM/EC options.

# Ordering Guide

## Linear Circuitry, Zones & Factory Options



### HOW TO USE THIS GUIDE

Fill out the worksheet on the following page to specify your requirements for circuitry, zones, and factory options.

Refer to the run chart for standard run configurations, consult factory for custom configurations.

Complete the Totals / Ordering Codes at the bottom of the worksheet and add to your ordering logic on the cut sheet.

Submit the worksheet along with your order.

EXAMPLE	TOTAL RUN LENGTH: <u>32ft</u>		JOB NAME: _____			FIXTURE TYPE: _____			
	HOUSING SECTION	SECTION LENGTH	SHARED ELECTRICAL FEED, NORMAL POWER			FACTORY OPTIONS			
						SEPARATE ELECTRICAL FEEDS			EM
			SWITCHING CIRCUIT	DIMMING ZONE	DAYLIGHT ZONE	DAYLIGHT CIRCUIT	EMERGENCY CIRCUIT	ECD	
	1	8	1C	1Z					1EM
	2	8	2C	2Z					
	3	8	2C	2Z					
	4	8				1DC			
	Totals / Ordering Codes		2C	2Z		1DC			1EM

ORDERING: FSM4L-FL-625LF-35K- **2C2Z** -UNV-LD1-G2- **1DC-1EM** -WH-32ft

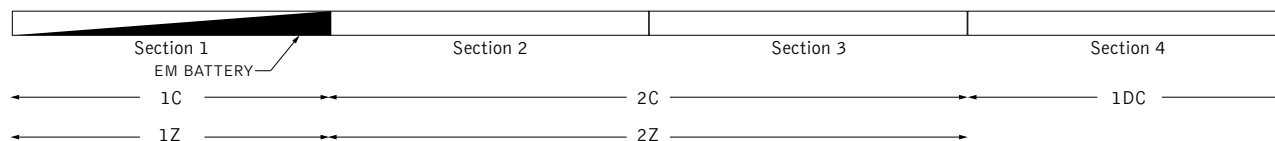

### KEY

**C = Switching Circuit**  
Switched Hot / Shared Neutral

**Z = Dimming Zone**  
Dimming Control Wires

**DL = Daylight Zone**  
Daylight Dimming Control Wires

**DC = Daylight Circuit**  
Switched Hot / Separate Neutral

**EC = Emergency Circuit**  
Switched Hot / Separate Neutral

**EM = Emergency Battery**  
Unswitched Hot / Shared Neutral

**ECD = Emergency Control Device**  
Unswitched Hot / Separate Neutral

### DEFAULTS

- Zones and Factory Options illuminate entire sections from 4' to 8' in length.
- One shared or isolated circuit and zone required per housing section.
- Limit of one EM or ECD per housing section.
- Additional electrical feed required for applications greater than three shared circuits and zones.
- Each DC, EC and ECD require an additional electrical feed.
- ECD not available in the same housing section as EC.
- Longer lead times and additional pricing may apply for custom run configurations.

### CUSTOM LENGTHS

- If partial illumination of emergency or daylight section is required, indicate in ordering guide and add "partial illumination" in Order Notes. Drawing required.
- Engineering validation required, longer lead times may apply.

# Ordering Guide Worksheet

Linear Circuitry, Zones & Factory Options



TOTAL RUN LENGTH: _____		JOB NAME: _____			FIXTURE TYPE: _____			
HOUSING SECTION	SECTION LENGTH	SHARED ELECTRICAL FEED, NORMAL POWER			FACTORY OPTIONS			
		SWITCHING CIRCUIT	DIMMING ZONE	DAYLIGHT ZONE	SEPARATE ELECTRICAL FEEDS			EM
						DAYLIGHT CIRCUIT	EMERGENCY CIRCUIT	
1								
2								
3								
4								
5								
6								
7								
8								
9								
10								
11								
12								
13								
14								
15								
16								
17								
18								
19								
20								
Totals / Ordering Codes								

Combine to create Circuits & Zones ordering code

Enter as individual Factory Options

## RUN CHART

Run length (ft)	Housing Configuration Section Lengths	Run length (ft)	Housing Configuration Section Lengths	Run length (ft)	Housing Configuration Section Lengths	Run length (ft)	Housing Configuration Section Lengths
9	5 + 4	21	8 + 8 + 5	33	8 + 8 + 8 + 5 + 4	45	8 + 8 + 8 + 8 + 8 + 5
10	6 + 4	22	8 + 8 + 6	34	8 + 8 + 8 + 6 + 4	46	8 + 8 + 8 + 8 + 8 + 6
11	7 + 4	23	8 + 8 + 7	35	8 + 8 + 8 + 7 + 4	47	8 + 8 + 8 + 8 + 8 + 7
12	8 + 4	24	8 + 8 + 8	36	8 + 8 + 8 + 8 + 4	48	8 + 8 + 8 + 8 + 8 + 8
13	8 + 5	25	8 + 8 + 5 + 4	37	8 + 8 + 8 + 8 + 5		
14	8 + 6	26	8 + 8 + 6 + 4	38	8 + 8 + 8 + 8 + 6		
15	8 + 7	27	8 + 8 + 7 + 4	39	8 + 8 + 8 + 8 + 7		
16	8 + 8	28	8 + 8 + 8 + 4	40	8 + 8 + 8 + 8 + 8		
17	8 + 5 + 4	29	8 + 8 + 8 + 5	41	8 + 8 + 8 + 8 + 5 + 4		
18	8 + 6 + 4	30	8 + 8 + 8 + 6	42	8 + 8 + 8 + 8 + 6 + 4		
19	8 + 7 + 4	31	8 + 8 + 8 + 7	43	8 + 8 + 8 + 8 + 7 + 4		
20	8 + 8 + 4	32	8 + 8 + 8 + 8	44	8 + 8 + 8 + 8 + 8 + 4		

Standard run configurations, consult factory for custom configurations.