

seem® 4led grid ceiling

FSM4L-G

CONNECTED™
SOLUTIONS

PL Preferred Light
Experience BETTER COLOR



FOCAL POINT®

! CONFIGURATIONS ARE RUN SPECIFIC, PLEASE CONSULT FACTORY DRAWINGS BEFORE BEGINNING INSTALLATION. !

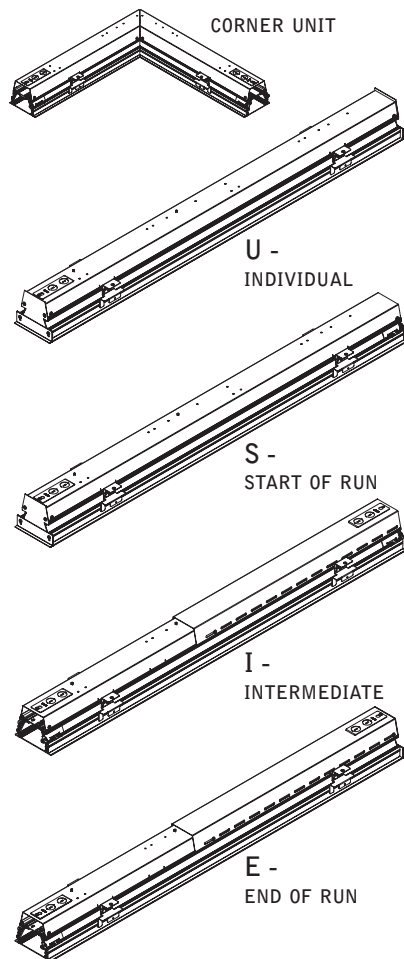
FOCAL POINT

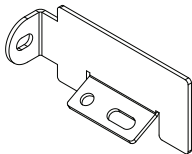
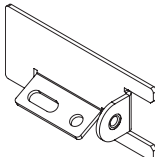

PARTS LISTS

PARTS SHIPPED INSTALLED	
	JOINER SCREW (72074)
	JOINER WASHER (700158)
	MALE JOINER BRACKET (A28051-01)
	FEMALE JOINER BRACKET (A28746-01)

KEY

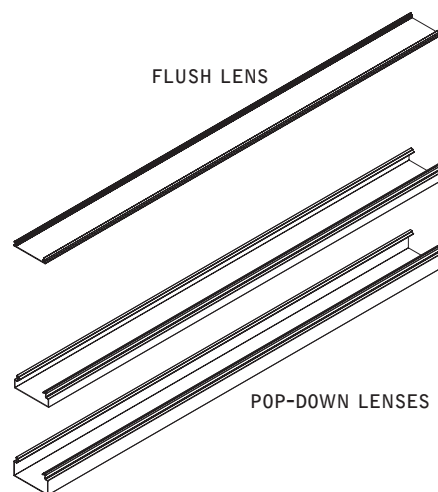

! INDIVIDUAL UNITS CANNOT BE JOINED IN THE FIELD.

! GRID MOUNT ONLY - SPACING FOR ALL GRID TYPES

Flush lens, lay-in

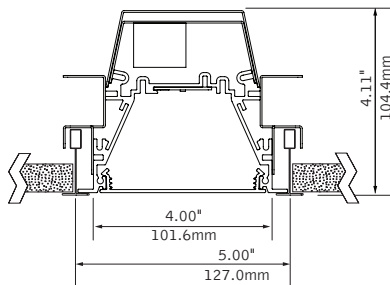

0.5" Pop-down lens, lay-in

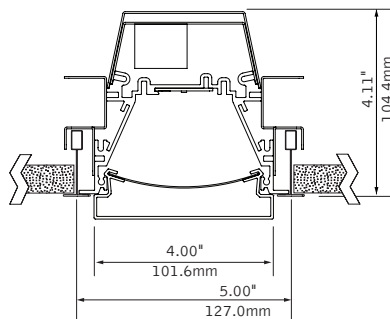

1.5" Pop-down lens, lay-in

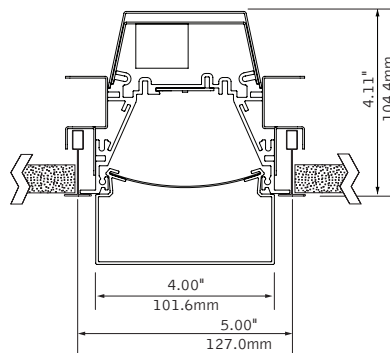

Tegular detail

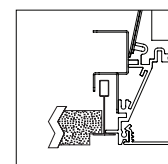

Luminaires must be installed by a qualified electrician (check with local and national codes for proper installation).
To prevent electrical shock, disconnect electrical supply before installation or servicing.

CORNER ASSEMBLY

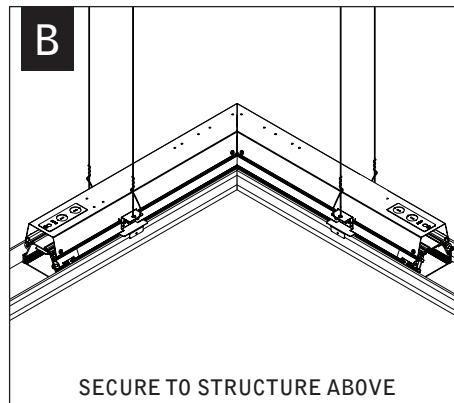
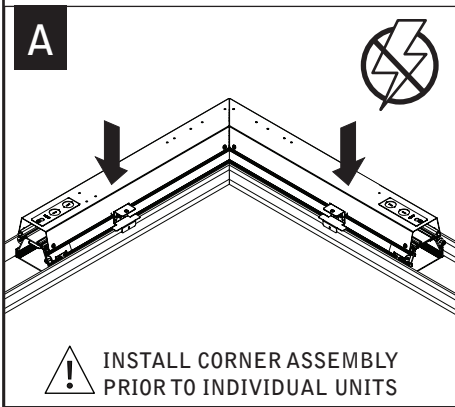

JOINING INSTALLATIONS
SKIP TO STEP 3

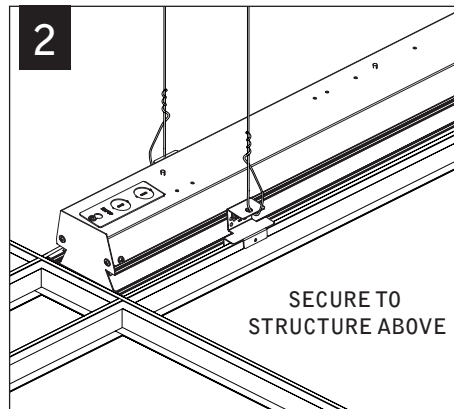
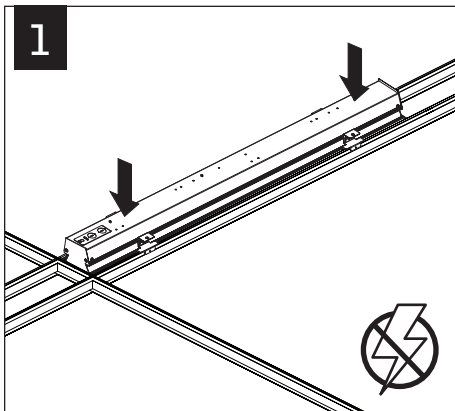

INDIVIDUAL INSTALLATIONS
SKIP TO STEP 6

NOTE: INDIVIDUAL UNITS
CANNOT BE JOINED IN THE FIELD.

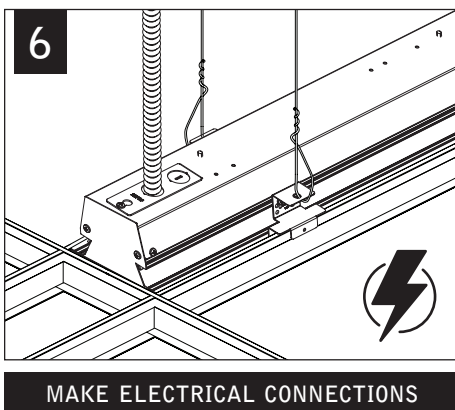
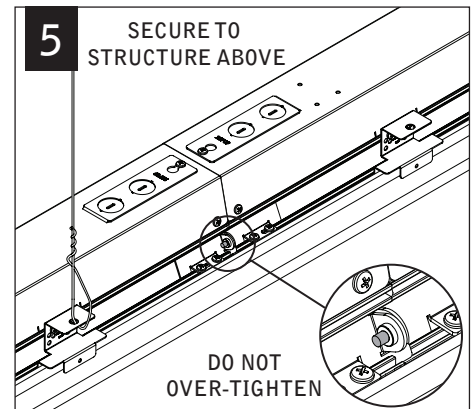
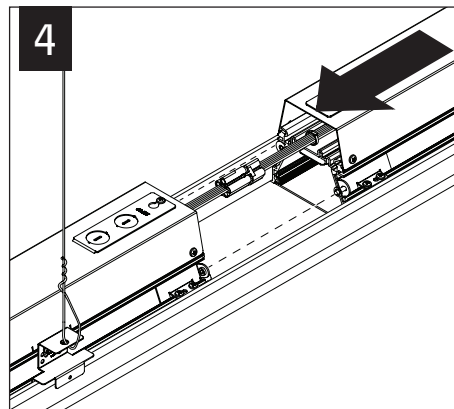
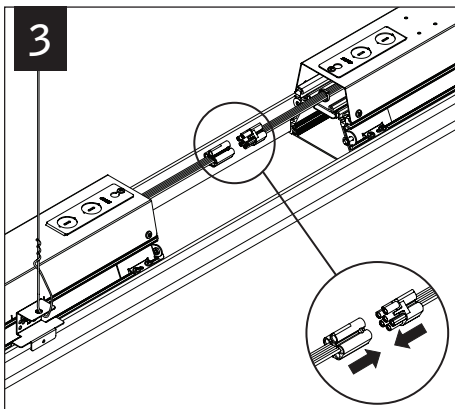

EMERGENCY



SEE BATTERY MANUFACTURER
INSTRUCTIONS

EMERGENCY MAXIMUM MOUNTING HEIGHT:
FLUSH LENS: 19.00'
1/2" POP-DOWN LENS: 16.00'

Luminaires must be installed by a qualified electrician (check with local and national codes for proper installation).
To prevent electrical shock, disconnect electrical supply before installation or servicing.

DRIVER SERVICE

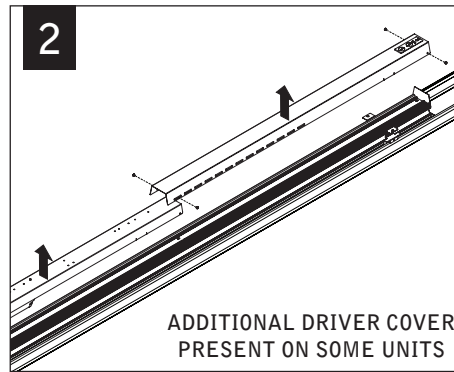
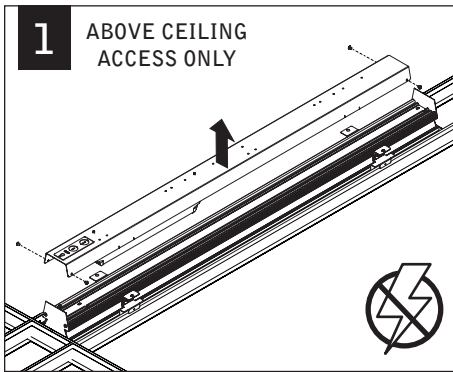

ACUITY nLIGHT

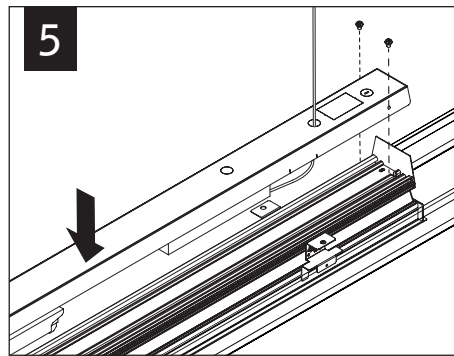
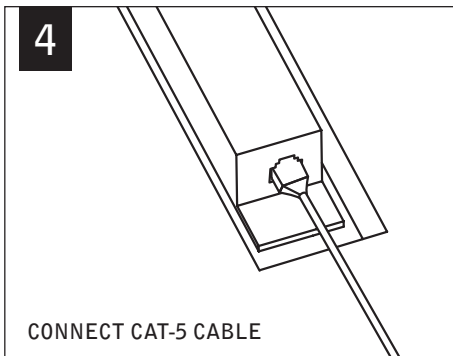
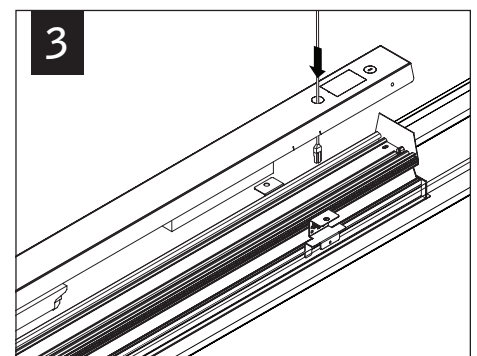
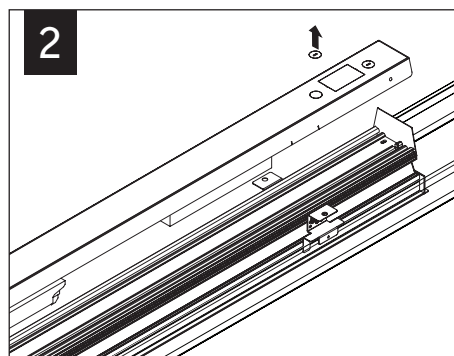
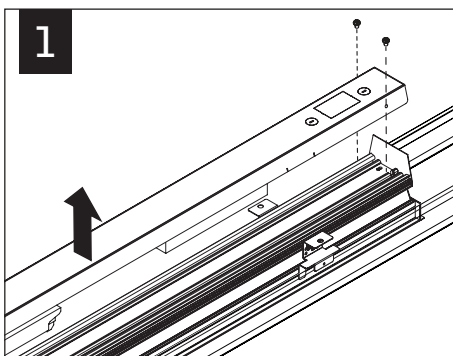

WATTSTOPPER

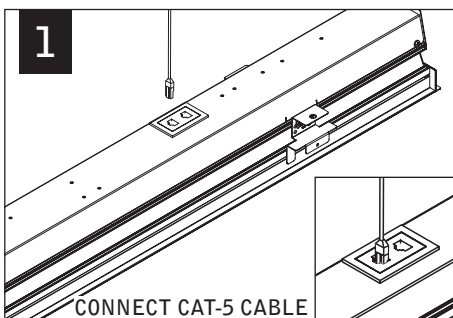

Contractor is responsible for adequately reinforcing walls and/or ceilings to support luminaire weight. Focal Point, LLC accepts no responsibility for inadequately reinforced walls and/or ceilings. The information contained in this drawing is the sole property of Focal Point, LLC. Any reproduction in part or whole without the written permission of Focal Point, LLC is prohibited.