

# Seem 4™ LED Asymmetric trim flange

FSM4AL-FFL-TF



FOCAL POINT™

## NEW CONSTRUCTION ONLY

**!** CONFIGURATIONS ARE RUN SPECIFIC, PLEASE CONSULT FACTORY DRAWINGS BEFORE BEGINNING INSTALLATION. **!**

### FOCAL POINT

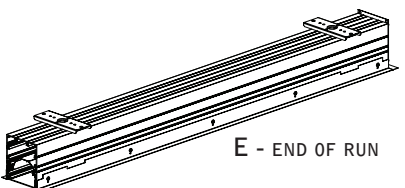
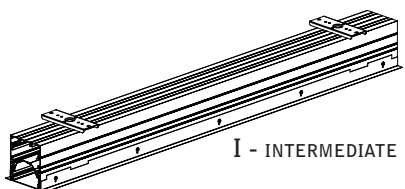
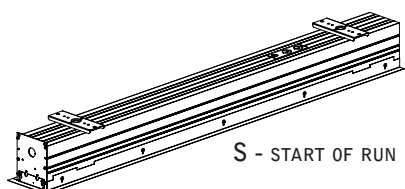
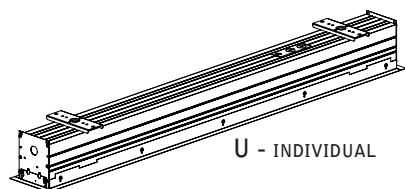

### PARTS LISTS

#### INCLUDED HARDWARE

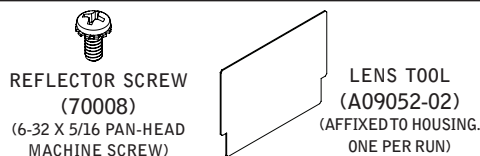

#### PARTS SHIPPED INSTALLED

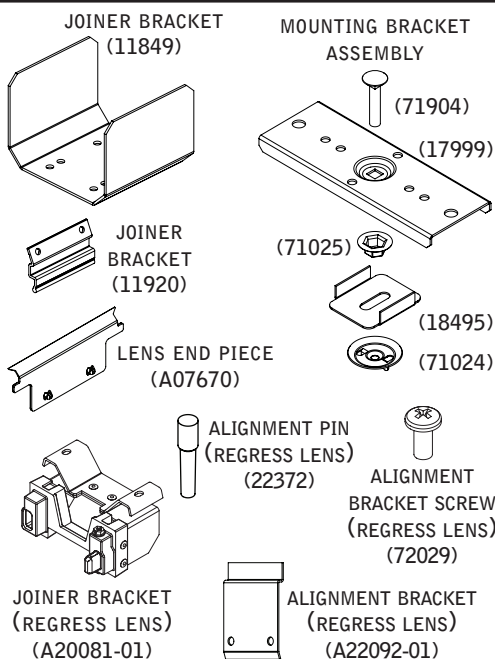

### KEY



### MOUNTING LOCATIONS

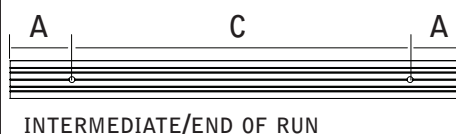

housing length	A	B	C
2'	1"	21"	22"
3'	1"	33"	34"
4'	6"	35"	36"
5'	6"	47"	48"
6'	6"	59"	60"
7'	6"	71"	72"
8'	6"	83"	84"

**!** MOUNTING LOCATION CHART IS AN APPROXIMATE GUIDE ONLY.

### MOUNTING BRACKET MUST BE INSTALLED PRIOR TO DRYWALL

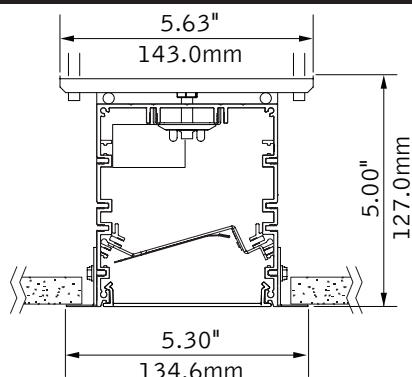

MOUNTING BRACKET MUST BE SECURED TO STRUCTURE ABOVE.

1/4" - 20 CARRIAGE BOLT MAY BE SUPPLIED BY OTHERS FOR GREATER ADJUSTABILITY.

Luminaires must be installed by a qualified electrician (check with local and national codes for proper installation).  
To prevent electrical shock, disconnect electrical supply before installation or servicing.

## CEILING CUTOUT

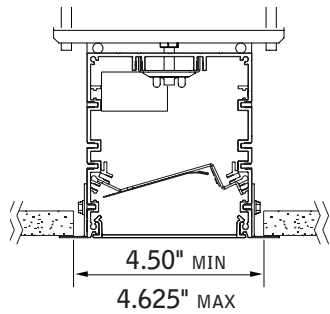

CEILING CUTOUT LENGTH =  
NOMINAL RUN LENGTH MINUS 5/16" (+/- 1/16")

EXAMPLE:

12' RUN LENGTH = 11' 11-3/4" CUTOUT LENGTH

1

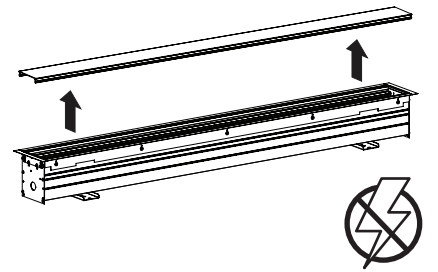

**⚠️ AVOID ALL CONTACT WITH LED SURFACE, LEDs ARE EASILY DAMAGED!**

2

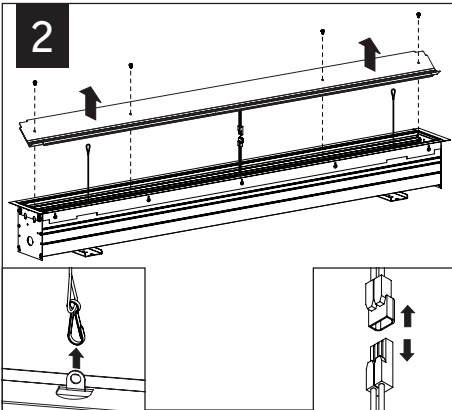

3

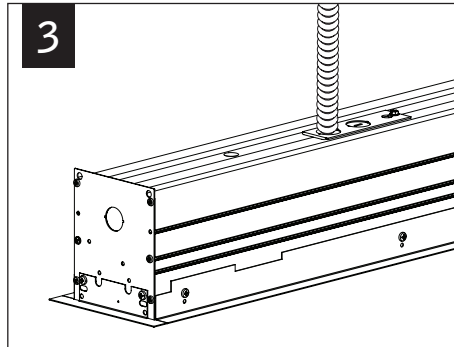

MAKE ELECTRICAL CONNECTIONS

4

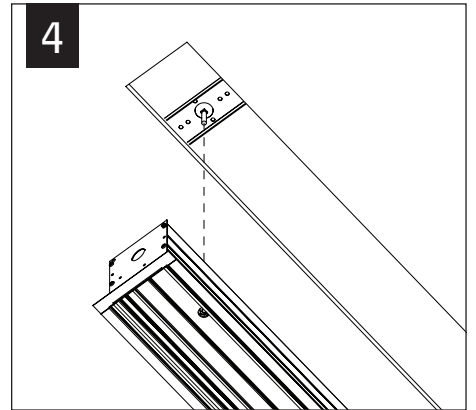

5

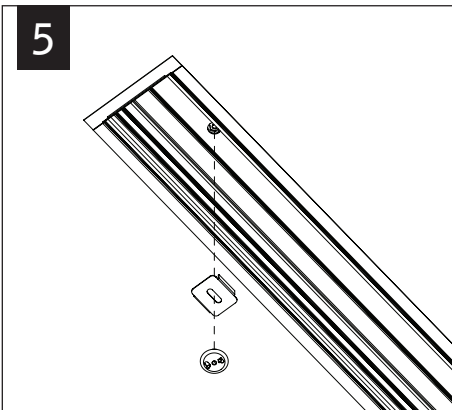

6

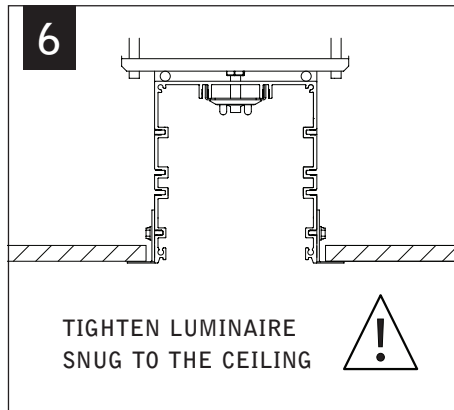

TIGHTEN LUMINAIRE  
SNUG TO THE CEILING



REPEAT STEPS 4-6  
UNTIL ALL UNITS ARE  
IN THE CEILING

INDIVIDUAL INSTALLATIONS  
SKIP TO STEP 10

7

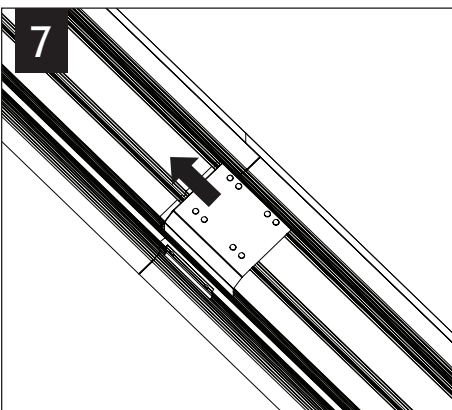

8

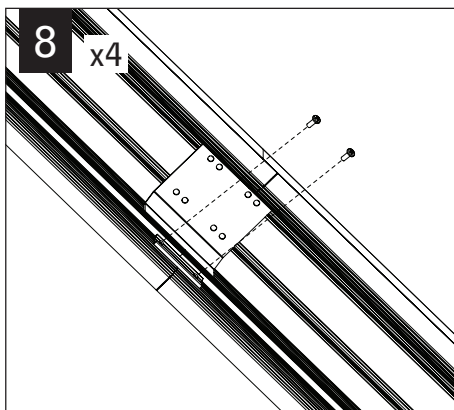

x4

9

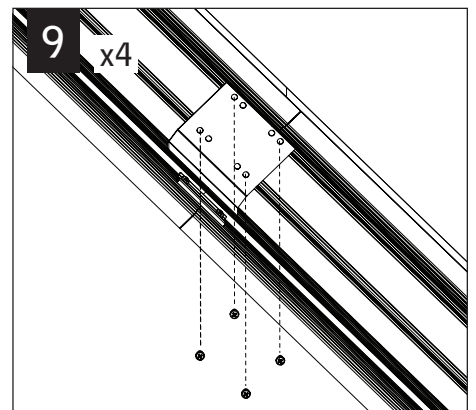

x4

Luminaires must be installed by a qualified electrician (check with local and national codes for proper installation).  
To prevent electrical shock, disconnect electrical supply before installation or servicing.

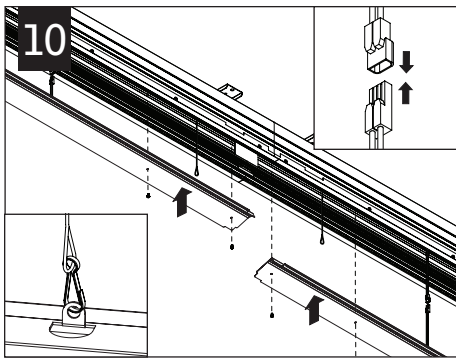

MAKE ELECTRICAL CONNECTIONS

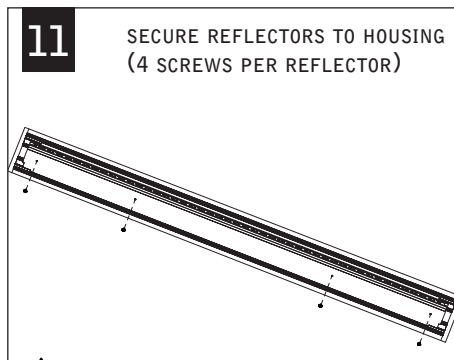

SECURE REFLECTORS TO HOUSING  
(4 SCREWS PER REFLECTOR)

⚠ AVOID ALL CONTACT WITH LED SURFACE,  
LEDs ARE EASILY DAMAGED!

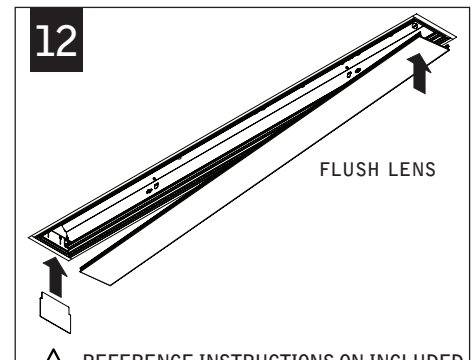

FLUSH LENS

⚠ REFERENCE INSTRUCTIONS ON INCLUDED  
TOOL FOR LENS INSTALLATION.

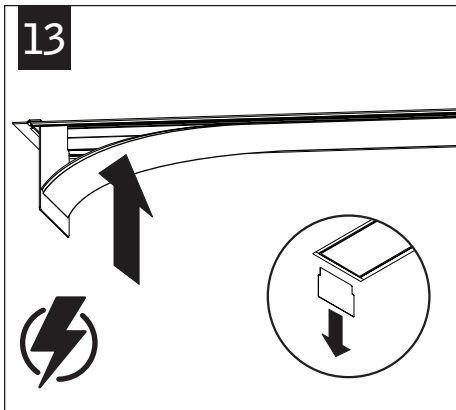

## DRIVER SERVICE

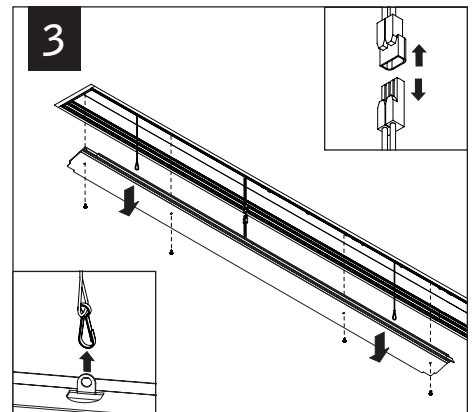
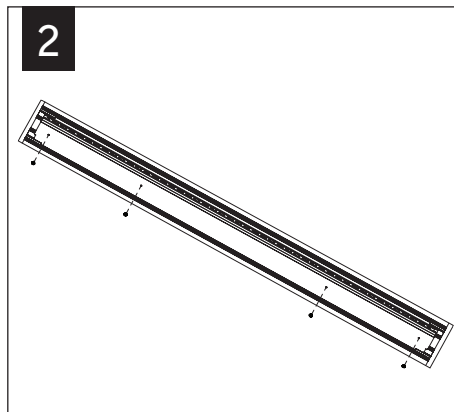
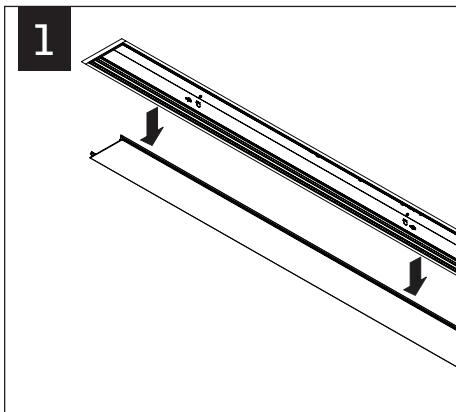

## EMERGENCY



SEE BATTERY MANUFACTURER  
INSTRUCTIONS

EMERGENCY MAXIMUM MOUNTING HEIGHT:  
18.39'