

# Seem® 2 Drywall/Hard Ceiling

LED

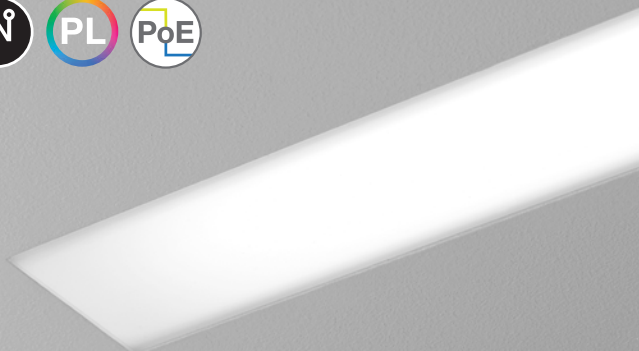

trim flange



corner detail



regress lens



wall to ceiling  
companion



perimeter  
companion



suspended & wall  
mount companions

## DIMENSIONAL DATA

trimless mud-in

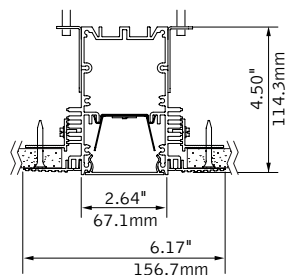

note: 0.375"min - 2.125"max ceiling thickness

trimless hard surface

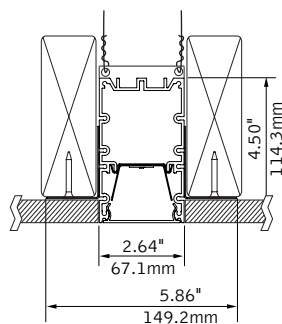

note: 0.375"min - 2.125"max ceiling thickness

trim flange

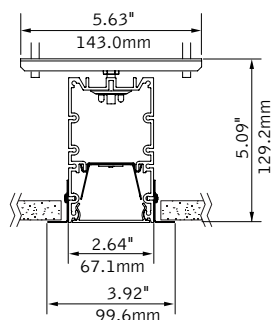

trimless mud-in - regressed

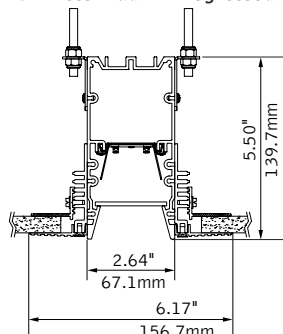

## FEATURES

Narrow extruded aluminum 2.5" aperture recessed slot LED.

Integrates with ceiling or wall in a variety of mounting styles for a clean, unobtrusive aesthetic.

Individual units and continuous runs in 1" increments.

Frosted acrylic lens provides uninterrupted illumination, without pixels or shadows.

LED position and lens material optimized to provide the perfect blend of high performance and visual comfort.

Connected Solutions: Integrates with wired and wireless building lighting control systems.

Preferred Light: Lighting for better color rendition and human preference.

PoE compatible: Integrates with Power over Ethernet lighting systems via standard, low-voltage wires.

## PERFORMANCE

### PRODUCT OVERVIEW

Lumen Output:	500-2500lm
Wattage:	7-43W
LPW:	71-89
SDCM:	3

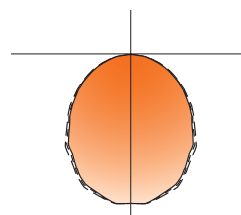

4' Flush Lens  
Nominal output:  
250 Lumens per foot

**Delivered Lumens: 1000lm**

**Total System Watts: 16W**

Photometric performance is measured in accordance with IESNA LM-79.  
Visit [focalpointlights.com](http://focalpointlights.com) for complete photometric data.

fixture:

project:

DETAILS

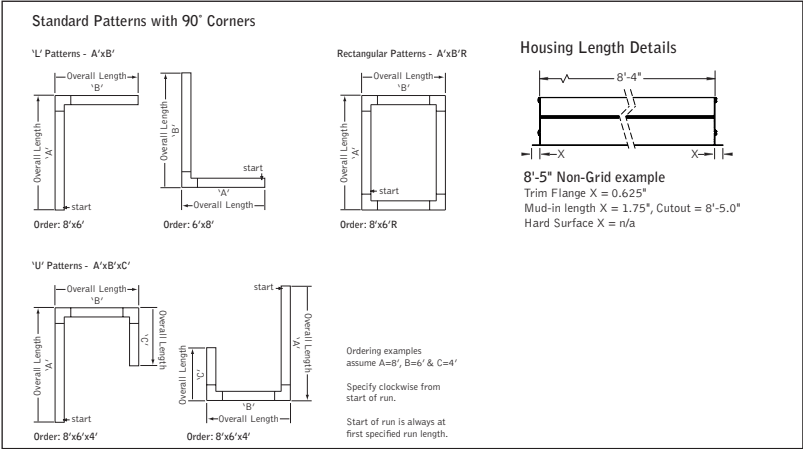

SPECIFICATIONS

LED System

Proprietary linear LED module incorporates premium LEDs on a robust platform to achieve excellent thermal management. LEDs are placed to promote a uniform appearance. Available in 2700K, 3000K, 3500K or 4000K with CRI>80 or CRI>90, 3 SDCM. 3500K and 4000K with CRI>90 have a cyanosis observation index (COI) of 3.3 or less. LED modules and drivers are replaceable from below.

Construction

One piece extruded aluminum housing. 20 Ga. steel end caps. Housing for new construction applications. 2' unit: 5.1 lbs., 3' unit: 7.6 lbs., 4' unit: 10.1 lbs., 5' unit: 12.6 lbs.

Optic

Reflectors fabricated of 22 Ga. steel finished in High Reflectance White powder coat. Extruded acrylic lens .07" thick with satin finish, up to 8' continuous.

Electrical

Luminaires are pre-wired with factory installed branch circuit wiring and over-molded quick connects. Standard 120-277V constant current driver includes 0-10V analog dimming. Power factor > .9. PoE compatible: Integrates with Power over Ethernet lighting systems via standard, low-voltage wires. PoE runs require an independent PoE node and power feed for each luminaire section.

Emergency

Emergency Battery output - 10 watts for 90 minutes. Maximum mounting height: 17.9ft. See EM/EC Guide for default locations and ordering details.

Labels

UL and cUL listed. Suitable for Dry or Damp Locations, indoor use only.

Finish

Polyester powder coat applied over a multi-stage pre-treatment.

Lumen Maintenance

Reported: L70 at >61,000 hours Calculated: L70 at 270,000 hours  
L90 at >61,000 hours L90 at 73,000 hours  
(Derived from EPA TM-21 calculator. Based on typical conditions, consult factory for additional data.)

Reliability

At Focal Point, our products are designed to stand the test of time. Each luminaire is engineered using superior components, manufactured with the utmost care and rigorously tested. Contact us for reliability data.

Warranty

LED system rated for operation in ambient environments up to 25°C. 5-year limited warranty.

4' PERFORMANCE CHART

Lumen Output	Delivered Lumens	Tested System Watts	Lumens Per Watt (LPW)		
			FL	SR	SRXP
125LF	500	7	89	72	84
250LF	1000	16	88	72	83
375LF	1500	26	88	71	84
625LF	2500	43	87	72	83

Based on 3500K, 4' length. Lumen multipliers: Preferred Light = 0.65, 90 CRI = 0.87.  
Delivered lumens may vary +/- 5%. Actual wattage may vary +/- 5%

ORDERING

Luminaire Series

Seem 2 LED FSM2L

Shielding

Flush Satin Lens FL

Regress Lens SR

(Housing height 5.5". Ceiling applications only)

Regress High Performance Lens SRXP

(Housing height 5.5". Ceiling applications only)

Lumen Output

125 Lumens per foot 125LF  
(LD1, L11 & D11 only. 4' minimum.)

250 Lumens per foot 250LF  
(Not available with LU5 & LH1. 4' minimum with D11 & FL lens)

375 Lumens per foot 375LF  
(4' minimum with LU5 & LH1 or D11 with FL lens.)

625 Lumens per foot 625LF  
(3' minimum with LU5 & LH1)

Color Temperature

2700K, 80+ CRI or 90+ CRI 27K or 927K

3000K, 80+ CRI or 90+ CRI 30K or 930K

3500K, 80+ CRI or 90+ CRI 35K or 935K

4000K, 80+ CRI or 90+ CRI 40K or 940K

3500K, Preferred Light P35K  
(Flush Lens only. 6" increments.  
Not available with Emergency Battery or patterns.)

Circuit

Single Circuit 1C

Voltage

UNV 120/277 Volt UNV  
Low voltage LV

Control System & Dimming Level

0-10V - 10% Dimming LD1

0-10V - 1% Dimming L11

Low-voltage, PoE compatible LVN

(No driver. Not available with EM or EC. LV Voltage only.)

Lutron Hi-Lume EcoSystem (LDE1) - 1% Dimming LH1

Lutron 5-Series EcoSystem (LDE5) - 5% Dimming LU5

DALI 1% Dimming D11

Ceiling Configuration

Trim Flange Drywall TF

Trim Flange Wood TFW

Mud-in Trimless, pre-set for 1/2" Drywall XF1

Mud-in Trimless, pre-set for 5/8" Drywall XF2

Mud-in Trimless, set thickness in field XFF

(Mounting equipment assembled in field)

Non-Drywall Hard Surface XFN

Hard Surface, Wood XFW

Factory Options

Chicago Plenum CP

(Not available with Flex Whip)

Emergency Circuit\* \_EC  
(4' minimum.)

Emergency Battery Pack\* \_EM  
(4' minimum. Not available at corners.  
See EM/EC Guide for default locations and ordering details.)

6' New York City Flex Whip (120V) FNY1

6' New York City Flex Whip (277V) FNY2

6' Flex Whip FW

Finish

Matte White Housing WH

Luminaire Length

Specify luminaire/row length in 1" increments \_ft \_in  
(2' minimum, lengths are nominal 1" increments based on T-centers.  
Housing length is 1" shorter than specified. Leave blank for patterns.  
Smaller increments available, consult factory.)

Pattern Options

(3' minimum length)

'L' pattern A' x B'

'U' pattern A' x B' x C'

Rectangular pattern A' x B' R

(Consult factory for other pattern options)



Options in orange qualify for the Quickship program. 1000' total, 48" maximum per pattern section. Refer to Quickship Guide for complete details including EM/EC options.