

# Seem<sup>®</sup> 2

LED WITH POP-DOWN LENS



1.5" Pop-down trimless mud-in



suspended pop-down lens companion



flush lens companion

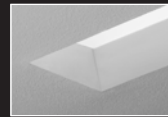

regress lens companion

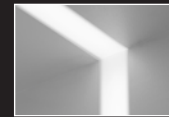

wall to ceiling companion



suspended & wall mount companions



perimeter companion

## DIMENSIONAL DATA

0.5" Pop-Down - trimless mud-in

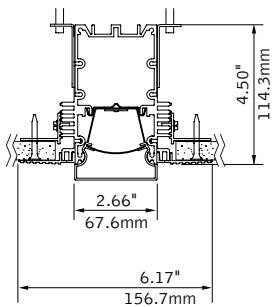

note: 0.375"min - 2.125"max ceiling thickness

1.5" Pop-Down - trimless mud-in

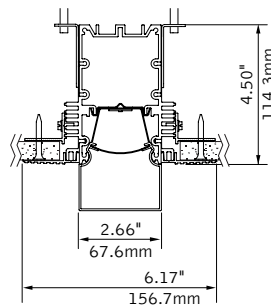

note: 0.375"min - 2.125"max ceiling thickness

1.5" Pop-Down - trim flange

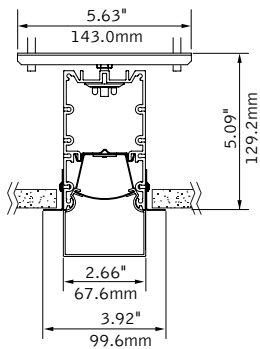

1.5" Pop-Down - hard surface

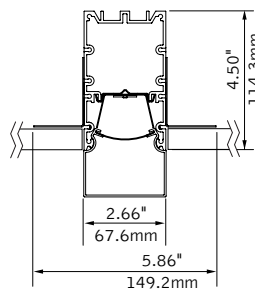

note: 0.375"min - 2.125"max ceiling thickness

## FEATURES

- 2.5" aperture recessed LED slot with 0.5" or 1.5" pop-down lens.
- Integrates with ceiling in a variety of mounting styles for a clean aesthetic.
- Dimensional frosted acrylic lens provides uninterrupted illumination, without pixels or shadows.
- LED position and lens material optimized to provide the perfect blend of high performance and visual comfort.
- Preferred Light: Lighting for better color rendition and human preference.
- PoE compatible: Integrates with Power over Ethernet lighting systems via standard, low-voltage wires.

## PERFORMANCE

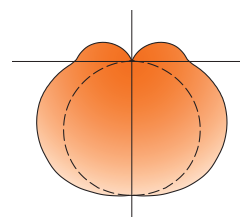

### PRODUCT OVERVIEW

Lumen Output:	500-2500lm
Wattage:	5-41W
LPW:	58-90
SDCM:	3

4' - 1.5" Pop-Down Lens

Nominal output:  
625 Lumens per foot

**Delivered Lumens: 2500lm**

**Total System Watts: 33W**

Photometric performance is measured in accordance with IESNA LM-79. Visit focalpointlights.com for complete photometric data.

fixture:

project:

**SPECIFICATIONS**

**LED System**

Proprietary linear LED module incorporates premium LEDs on a robust platform to achieve excellent thermal management. LEDs are placed to promote a uniform appearance. Available in 2700K, 3000K, 3500K or 4000K with CRI>80 or CRI>90, 3 SDCM. 3500K and 4000K with CRI>90 have a cyanosis observation index (COI) of 3.3 or less. LED modules and drivers are replaceable from below.

**Construction**

One piece extruded aluminum housing. 20 Ga. steel end caps. Housing for new construction applications. 2' unit weight: 5.1 lbs., 3' unit weight: 7.6 lbs., 4' unit weight: 10.1 lbs., 5' unit weight: 12.6 lbs.

**Optic**

Reflectors fabricated of 22 Ga. steel finished in High Reflectance White powder coat. Extruded acrylic lens .06" thick with frosted finish, up to 8' continuous.

**Electrical**

Luminaires are pre-wired with factory installed branch circuit wiring and over-molded quick connects. Standard 120-277V constant current driver includes 0-10V analog dimming. Power factor > .9. PoE compatible: Integrates with Power over Ethernet lighting systems via standard, low-voltage wires. PoE runs require an independent PoE node and power feed for each luminaire section.

**Emergency Battery**

IOTA CP-10. Emergency output - 10 watts for 90 minutes.

**Labels**

UL and cUL listed. Suitable for Dry or Damp Locations, indoor use only.

**Finish**

Polyester powder coat applied over a multi-stage pre-treatment.

**Lumen Maintenance**

Reported: L70 > 61,000 hours                      Calculated: L70 at > 480,000 hours  
 L90 > 61,000 hours                                  L90 at > 125,000 hours (Derived from  
 EPA TM-21 calculator. Based on typical conditions, consult factory for additional data.)

**Reliability**

At Focal Point, our products are designed to stand the test of time. Each luminaire is engineered using superior components, manufactured with the utmost care and rigorously tested. Contact us for reliability data.

**Warranty**

LED system rated for operation in ambient environments up to 25°C. 5-year limited warranty.

**4' PERFORMANCE CHART**

Shielding	Lumens per Foot	Delivered Lumens	Tested System Watts	LPW
0.5" Pop-Down Lens	125LF	500	9	58
	250LF	1000	16	61
	375LF	1500	23	64
	625LF	2500	41	61
1.5" Pop-Down Lens	125LF	500	5	90
	250LF	1000	13	75
	375LF	1500	19	74
	625LF	2500	33	71

Based on 3500K, 80 CRI, 4' lengths. Lumen multipliers: Preferred Light = 0.65, 90+ CRI = 0.87. Lumen output may vary +/- 5%. Actual wattage may vary +/- 5%.

**ORDERING**

**Luminaire Series**

Seem 2 LED **FSM2L**

**Shielding**

0.5" Pop-Down Lens **PD05**  
 1.5" Pop-Down Lens **PD15**  
(2' - 8' individual units only)

**Lumen Output**

125 Lumens per foot **125LF**  
(LD1, L11 & D11 only, 4' minimum.)  
 250 Lumens per foot **250LF**  
(Not available with LH1, 4' minimum with D11.)  
 375 Lumens per foot **375LF**  
(4' minimum with LH1 & D11.)  
 625 Lumens per foot **625LF**  
(3' minimum with LH1.)

**Color Temperature**

2700K, 80+ CRI or 90+ CRI **27K or 927K**  
 3000K, 80+ CRI or 90+ CRI **30K or 930K**  
 3500K, 80+ CRI or 90+ CRI **35K or 935K**  
 4000K, 80+ CRI or 90+ CRI **40K or 940K**  
 3500K, Preferred Light **P35K**  
(Not available with Emergency Battery)

**Circuits & Zones**

1 Circuit, non-emergency **1C**  
 Consult Ordering Guide on page 3 for multiple circuiting and zoning options **\_C\_Z\_DL**

**Voltage**

120/277 UNV Volt **UNV**  
 Low Voltage **LV**

**Control System & Dimming Level**

0-10V - 10% Dimming **LD1**  
 0-10V - 1% Dimming **L11**  
 Lutron Hi-Lume EcoSystem (LDE1) - 1% Dimming **LH1**  
 Low Voltage, PoE compatible **LVN**  
(No driver. Not available with EM or EC. LV Voltage only.)  
 DALI 1% Dimming **D11**

**Ceiling Configuration**

Trim Flange Drywall **TF**  
 Trim Flange Wood **TFW**  
 Mud-in Trimless, pre-set for 1/2" Drywall **XF1**  
 Mud-in Trimless, pre-set for 5/8" Drywall **XF2**  
 Mud-in Trimless, set thickness in field **XFF**  
(Mounting equipment assembled in field)  
 Non-Drywall Hard Surface **XFN**  
 Hard Surface, Wood **XFW**

**Factory Options**

(See Ordering Guide on page 3 for ordering details for DC, EC, EM & ECD.)  
 Chicago Plenum **CP**  
(Not available with Flex Whip)  
 Daylight Circuit **\_DC**  
 Emergency Circuit **\_EC**  
 Emergency Battery Pack† **\_EM**  
 Emergency Control Device† **\_ECD**  
(4' minimum, 120/277 Volt only.)  
 6' New York City Flex Whip (120V) **FNY1**  
 6' New York City Flex Whip (277V) **FNY2**  
 6' Flex Whip **FW**

**Finish**

Matte White Housing **WH**

**Luminaire Length**

Specify luminaire/row length in 1' increments **X'**  
(2' minimum, 1.5" Pop-down lens available in 2' - 8' individual units only. Smaller increments available. Consult factory for details.)



Options in orange qualify for the Quickship program. 1000' total. Refer to Quickship Guide for complete details including EM/EC options.

# Ordering Guide

## Linear Circuitry, Zones & Factory Options



### HOW TO USE THIS GUIDE

Fill out the worksheet on the following page to specify your requirements for circuitry, zones, and factory options.

Refer to the run chart for standard run configurations, consult factory for custom configurations.

Complete the Totals / Ordering Codes at the bottom of the worksheet and add to your ordering logic on the cut sheet.

Submit the worksheet along with your order.

TOTAL RUN LENGTH: <u>32ft</u>		JOB NAME: _____			FIXTURE TYPE: _____			
HOUSING SECTION	SECTION LENGTH	SHARED ELECTRICAL FEED, NORMAL POWER			FACTORY OPTIONS			
		SWITCHING CIRCUIT	DIMMING ZONE	DAYLIGHT ZONE	SEPARATE ELECTRICAL FEEDS			EM
					DAYLIGHT CIRCUIT	EMERGENCY CIRCUIT	ECD	
1	8	1C	1Z					1EM
2	8	2C	2Z					
3	8	2C	2Z					
4	8				1DC			
<b>Totals / Ordering Codes</b>		<b>2C</b>	<b>2Z</b>		<b>1DC</b>			<b>1EM</b>

ORDERING: FSM4L-FL-625LF-35K- **2C2Z** -UNV-LD1-G2- **1DC-1EM** -WH-32ft

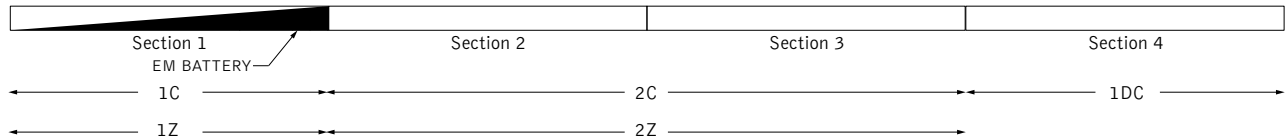

KEY	
<b>C = Switching Circuit</b> Switched Hot / Shared Neutral	<b>DC = Daylight Circuit</b> Switched Hot / Separate Neutral
<b>Z = Dimming Zone</b> Dimming Control Wires	<b>EC = Emergency Circuit</b> Switched Hot / Separate Neutral
<b>DL = Daylight Zone</b> Daylight Dimming Control Wires	<b>EM = Emergency Battery</b> Unswitched Hot / Shared Neutral
	<b>ECD = Emergency Control Device</b> Unswitched Hot / Separate Neutral

### DEFAULTS

- Zones and Factory Options illuminate entire sections from 4' to 8' in length.
- One shared or isolated circuit and zone required per housing section.
- Limit of one EM or ECD per housing section.
- Additional electrical feed required for applications greater than three shared circuits and zones.
- Each DC, EC and ECD require an additional electrical feed.
- ECD not available in the same housing section as EC.
- Longer lead times and additional pricing may apply for custom run configurations.

### CUSTOM LENGTHS

- If partial illumination of emergency or daylight section is required, indicate in ordering guide and add "partial illumination" in Order Notes. Drawing required.
- Engineering validation required, longer lead times may apply.

# Ordering Guide Worksheet

Linear Circuitry, Zones & Factory Options



TOTAL RUN LENGTH: _____		JOB NAME: _____			FIXTURE TYPE: _____			
HOUSING SECTION	SECTION LENGTH	SHARED ELECTRICAL FEED, NORMAL POWER			FACTORY OPTIONS			EM
		SWITCHING CIRCUIT	DIMMING ZONE	DAYLIGHT ZONE	SEPARATE ELECTRICAL FEEDS			
DAYLIGHT CIRCUIT	EMERGENCY CIRCUIT				ECD			
1								
2								
3								
4								
5								
6								
7								
8								
9								
10								
11								
12								
13								
14								
15								
16								
17								
18								
19								
20								
<b>Totals / Ordering Codes</b>								

WORKSHEET

Combine to create Circuits & Zones ordering code

Enter as individual Factory Options

## RUN CHART

Run length (ft)	Housing Configuration Section Lengths	Run length (ft)	Housing Configuration Section Lengths	Run length (ft)	Housing Configuration Section Lengths	Run length (ft)	Housing Configuration Section Lengths
9	5 + 4	21	8 + 8 + 5	33	8 + 8 + 8 + 5 + 4	45	8 + 8 + 8 + 8 + 8 + 5
10	6 + 4	22	8 + 8 + 6	34	8 + 8 + 8 + 6 + 4	46	8 + 8 + 8 + 8 + 8 + 6
11	7 + 4	23	8 + 8 + 7	35	8 + 8 + 8 + 7 + 4	47	8 + 8 + 8 + 8 + 8 + 7
12	8 + 4	24	8 + 8 + 8	36	8 + 8 + 8 + 8 + 4	48	8 + 8 + 8 + 8 + 8 + 8
13	8 + 5	25	8 + 8 + 5 + 4	37	8 + 8 + 8 + 8 + 5		
14	8 + 6	26	8 + 8 + 6 + 4	38	8 + 8 + 8 + 8 + 6		
15	8 + 7	27	8 + 8 + 7 + 4	39	8 + 8 + 8 + 8 + 7		
16	8 + 8	28	8 + 8 + 8 + 4	40	8 + 8 + 8 + 8 + 8		
17	8 + 5 + 4	29	8 + 8 + 8 + 5	41	8 + 8 + 8 + 8 + 5 + 4		
18	8 + 6 + 4	30	8 + 8 + 8 + 6	42	8 + 8 + 8 + 8 + 6 + 4		
19	8 + 7 + 4	31	8 + 8 + 8 + 7	43	8 + 8 + 8 + 8 + 7 + 4		
20	8 + 8 + 4	32	8 + 8 + 8 + 8	44	8 + 8 + 8 + 8 + 8 + 4		

Standard run configurations, consult factory for custom configurations.