

Seem® 2 Drywall/Hard/Specialty Ceiling

LED



trim flange



corner detail



regress lens



wall to ceiling
companion



perimeter
companion



suspended & wall
mount companions

DIMENSIONAL DATA

Trimless mud-in

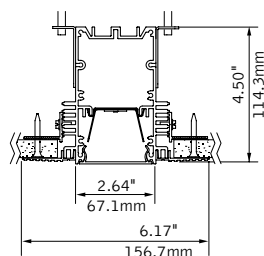

note: 0.375"min - 2.125"max ceiling thickness

Trimless hard surface

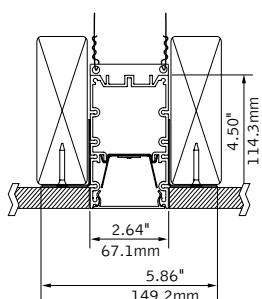

note: 0.375"min - 2.125"max ceiling thickness

Trimless mud-in - regressed

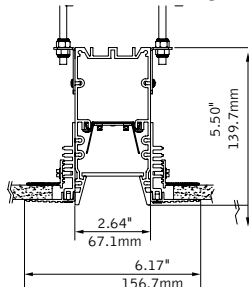

Trim flange

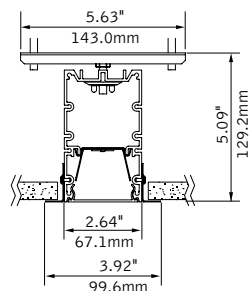

No Flange

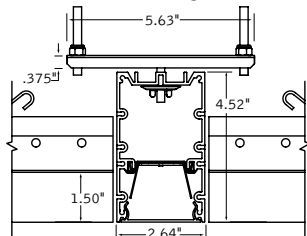

Specialty ceiling examples

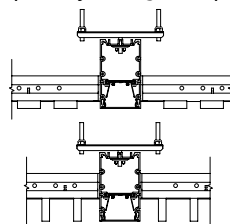

FEATURES

Narrow extruded aluminum 2.5" aperture recessed slot LED.

Integrates with ceiling or wall in a variety of mounting styles for a clean, unobtrusive aesthetic.

Individual units and continuous runs in 1" increments.

Frosted acrylic lens provides uninterrupted illumination, without pixels or shadows.

LED position and lens material optimized to provide the perfect blend of high performance and visual comfort.

Connected Solutions: Integrates with wired and wireless building lighting control systems.

PoE compatible: Integrates with Power over Ethernet lighting systems via standard, low-voltage wires.

DISTRIBUTIONS

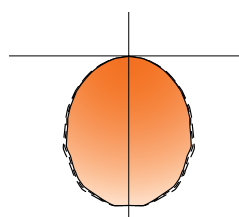

Flush Lens

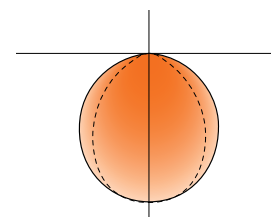

Regress Lens

Photometric performance is measured in accordance with IESNA LM-79.
Visit focalpointlights.com for complete photometric data.

fixture:

project:

DETAILS

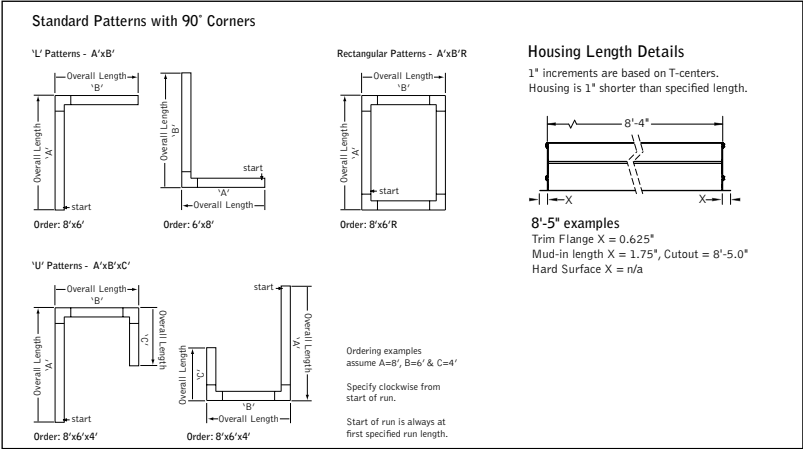

SPECIFICATIONS

LED System

Proprietary linear LED module incorporates premium LEDs on a robust platform to achieve excellent thermal management. LEDs are placed to promote a uniform appearance. Available in 2700K, 3000K, 3500K or 4000K with CRI>80 or CRI>90, 3 SDCM. 3500K and 4000K with CRI>90 have a cyanosis observation index (COI) of 3.3 or less. LED modules and drivers are replaceable from below.

Construction

One piece extruded aluminum housing. 20 Ga. steel end caps. Housing for new construction applications. 2' unit: 5.1 lbs., 3' unit: 7.6 lbs., 4' unit: 10.1 lbs., 5' unit: 12.6 lbs.

Optic

Reflectors fabricated of 22 Ga. steel finished in High Reflectance White powder coat. Extruded acrylic lens .07" thick with satin finish, up to 8' continuous.

Electrical

Luminaires are pre-wired with factory installed branch circuit wiring and over-molded quick connects. Standard 120-277V constant current driver includes 0-10V analog dimming. Power factor > .9. PoE compatible: Integrates with Power over Ethernet lighting systems via standard, low-voltage wires. PoE runs require an independent PoE node and power feed for each luminaire section.

Emergency

Emergency Battery output - 10 watts for 90 minutes. Maximum mounting height: 17.9ft. Emergency Circuit with Connected Solutions (LMFS1, LMFS1, ENL1, WLXP) shipped standard with leads to connect UL924 compliant device, by others.

Labels

UL and cUL listed. Suitable for Dry or Damp Locations, indoor use only.

Finish

Polyester powder coat applied over a multi-stage pre-treatment.

Lumen Maintenance

Reported: L70 at >61,000 hours Calculated: L70 at 270,000 hours
L90 at >61,000 hours L90 at 73,000 hours
(Derived from EPA TM-21 calculator. Based on typical conditions, consult factory for additional data.)

Reliability

At Focal Point, our products are designed to stand the test of time. Each luminaire is engineered using superior components, manufactured with the utmost care and rigorously tested. Contact us for reliability data.

Warranty

LED system rated for operation in ambient environments up to 25°C. 5-year limited warranty.

4' PERFORMANCE CHART

Lumen Output	Delivered Lumens	FL		SR		SRXP	
		Watts	LPW	Watts	LPW	Watts	LPW
125LF	500	5.3	95.8	7.4	77.4	5.5	90.3
250LF	1000	13.5	95.1	16.2	78.0	12.9	89.9
375LF	1500	18.2	94.9	25.6	76.8	18.8	90.2
625LF	2500	31.0	94.1	43.1	77.9	32.6	89.8

Based on 3500K, 4' length. Lumen multipliers: 90+ CRI = 0.87. Delivered lumens may vary +/- 5%. Actual wattage may vary +/- 5%

Focal Point LLC reserves the right to change specifications for product improvement without notification.





ORDERING

Luminaire Series	FSM2L	FSM2L
Seem 2 LED	FSM2L	
Shielding		
Flush Satin Lens	FL	
Regress Lens	SR	
(Housing height 5.5' Ceiling applications only)		
Regress High Performance Lens	SRXP	
(Housing height 5.5' Ceiling applications only)		
Lumen Output		
125 Lumens per foot	125LF	
(LD1, L11 & D11 driver only. 4' minimum. Not available on patterns.)		
250 Lumens per foot	250LF	
(Not available with LH1. 4' minimum with D11 & FL shielding.)		
375 Lumens per foot	375LF	
(4' minimum with LH1 or D11 with FL shielding.)		
625 Lumens per foot	625LF	
(3' minimum with LH1.)		
Color Temperature		
2700K, 80+ CRI or 90+ CRI	27K or 927K	
3000K, 80+ CRI or 90+ CRI	30K or 930K	
3500K, 80+ CRI or 90+ CRI	35K or 935K	
4000K, 80+ CRI or 90+ CRI	40K or 940K	
Circuits & Zones		
1 Circuit, non-emergency	1C	
Consult Ordering Guide on page 3 for multiple circuiting and zoning options	_C_Z_DL	
Voltage		
120/277 UNV Volt	UNV	
Low voltage	LV	
Control System & Dimming Level		
0-10V - 10% Dimming	LD1	
0-10V - 1% Dimming	L11	
Low Voltage, PoE compatible	LVN	
(No driver. Not available with EM or EC. LV Voltage only.)		
Lutron Hi-Lume EcoSystem (LDE1) -*	LH1	
1% Dimming		
DALI 1% Dimming*	D11	
*(Not available with patterns.)		
Wattstopper Fixture Sensor**	LMFS1	
Low Density - 1% Dimming		
Wattstopper Fixture Sensor**	LMFSD	
High Density - 1% Dimming		
Lutron Athena Wireless Sensor**	LAWS	
Enlighted Smart Sensor - 1% Dimming**	ENL1	
WaveLinx Pro - 1% Dimming**	WLXP	
** (3' minimum length. 7' minimum with ECD/EM. XF1, XF2 and XFF only. See sensor layout guide)		
Ceiling Configuration		
No Flange for specialty ceilings	NF	
(Ex. slat, panel, cloud systems.)		
Trim Flange Drywall	TF	
Trim Flange Wood	TFW	
Mud-in Trimless, pre-set for 1/2" Drywall	XF1	
Mud-in Trimless, pre-set for 5/8" Drywall	XF2	
Mud-in Trimless, set thickness in field	XFF	
(Mounting equipment assembled in field)		
Non-Drywall Hard Surface	XFN	
Hard Surface, Wood	XFW	
Factory Options		
(See Ordering Guide for ordering details for DC, EC, EM & ECD.)		
Chicago Plenum	CP	
(Not available with Flex Whip)		
Daylight Circuit	_DC	
Emergency Circuit	_EC	
Emergency Battery Pack†	_EM	
Emergency Control Device†	_ECD	
† (4' minimum. 6' minimum with patterns. 120/277 Volt only. Not available at corners.)		
6' New York City Flex Whip (120V)	FN1	
6' New York City Flex Whip (277V)	FN2	
6' Flex Whip	FW	
Finish		
Matte White Housing	WH	
Luminaire Length		
Specify luminaire/row length in 1" increments	_ft _in	
(2' minimum. Housing length is 1" shorter than specified. Leave blank for patterns.)		
Pattern Options		
(4' minimum length)		
'L' pattern	A' x B'	
'U' pattern	A' x B' x C'	
Rectangular pattern	A' x B' R	
(Consult factory for other pattern options)		



Options in orange qualify for the Quickship program. 1000' total, 48" maximum per pattern section. Refer to Quickship Guide for complete details including EM/EC options.

Focal Point provides flexibility in meeting the needs of each project by integrating with several building lighting control systems. A variety of sensors, drivers and other components can be specified that allow the luminaires to communicate with wired and wireless networks. All zoning can be digitally reconfigured through the application software. Daylight harvesting, occupancy sensing, integration with HVAC systems, and individual controls enable the monitoring and modulating of light levels and temperature in order to save energy, reduce costs and maximize occupants' comfort. All Connected Solutions luminaires require a compatible building control system.†

Connected Solution	Ordering Code	Model #**	Protocol	Compatible Networks*	Occupancy & Daylight	Temperature Reporting	Communication to Luminaire	Drivers
 legrand [®] WATTSTOPPER [®]	LMFS1	LMFS-601 & LMFI-111	DLM Wireless	DLM	Enabled	No	Wireless	Advance by Signify
	LMFSD	LMFS-601						Optotronic by eldoLED (Dexal)
 COOPER Lighting Solutions	WLXP	OEM-WAA	WaveLinx Wireless	WaveLinx Pro Trellix	Enabled	No	Wireless (WaveLinx Pro Wireless Area Controller)	Advance by Signify
 CRESTRON	D11	Specified Driver	DALI	Crestron Züm Wireless & SpaceBuilder	Enabled	No	Wired	eldoLED ECOdrive
 Enlighted	ENL1	SU-5E-IOT	Enlighted RF	Enlighted	Integrated	Yes	Wireless	Advance by Signify
 LUTRON	LAWS	A-WN-D01-OCC-WH	DALI, 0-10V	Athena Wireless	Integrated	No	Wireless	Advance by Signify
	LH1	LDE1	EcoSystem	Quantum, Energi Savr Node, Energi TriPak	Enabled	No	Wired	Lutron Hi-Lume

*Not all compatible networks may be listed. **For performance data and additional control system details please visit the connected solutions manufacturer websites. Primary drivers are listed in **bold**. To specify a particular driver please consult factory.
†Controls systems supplied by others.