

Seem® 2 LED

Suspended | FSM2LS

CONNECTEDTM
SOLUTIONS

PL Preferred Light
Experience BETTER COLOR

FOCAL POINT®



BEFORE YOU BEGIN

- Luminaires must be installed by a qualified electrician (check with local and national codes for proper installation).
- To prevent electrical shock, disconnect electrical supply before installation or servicing.
- Contractor is responsible for adequately reinforcing walls and/or ceilings to support fixture weight.
- Focal Point, LLC accepts no responsibility for inadequately reinforced walls and/or ceilings.
- The information contained in this drawing is the sole property of Focal Point, LLC. Any reproduction in part or whole without the written permission of Focal Point, LLC is prohibited.

INSTRUCTION KEY



ATTENTION



SEE ADDITIONAL INSTRUCTIONS



POWER OFF



POWER ON

COMPONENT KEY

FOCAL POINT

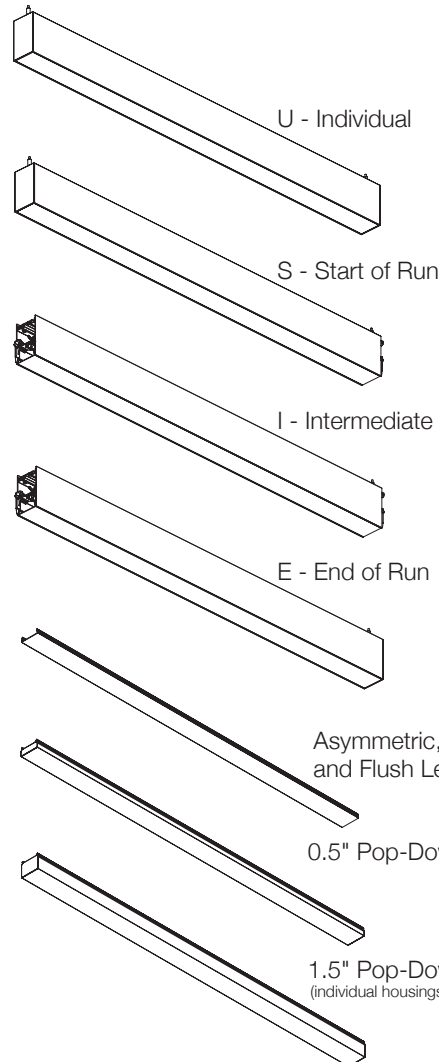

SHIPPED INSTALLED

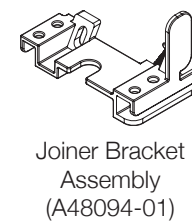
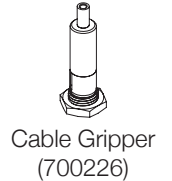

SHIPPED IN HARDWARE BAG

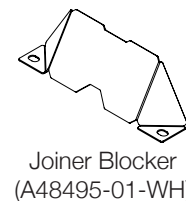

INDIVIDUAL UNIT INSTALLATION FOLLOW STEPS 1, 2, 9 & 10

1



FOLLOW FOCAL POINT
INSTRUCTIONS FOR UNIVERSAL
SUSPENSION SYSTEM ASSEMBLY.
SEE IS0166

2

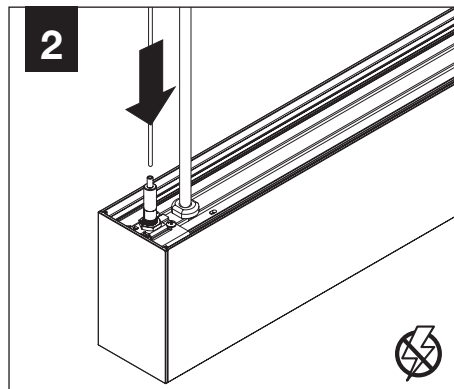

3

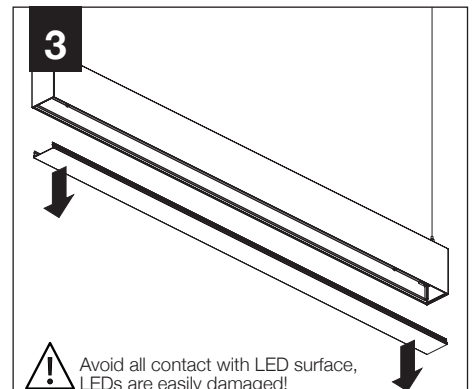

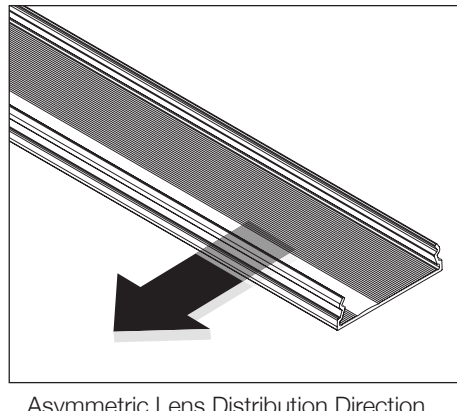
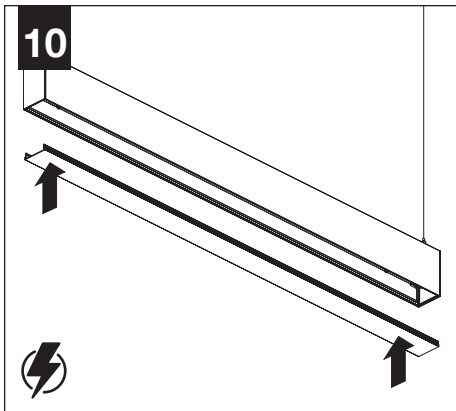
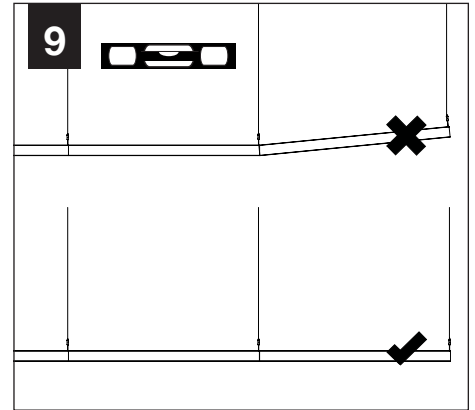
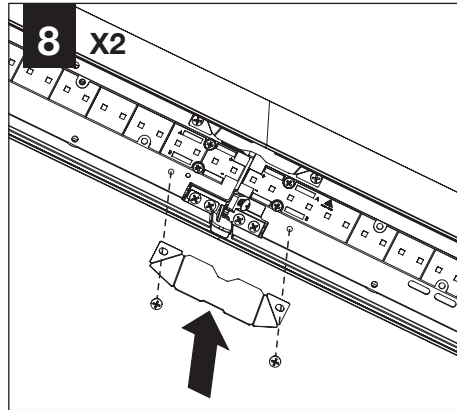
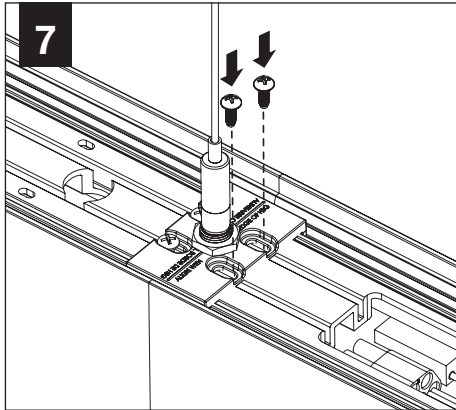
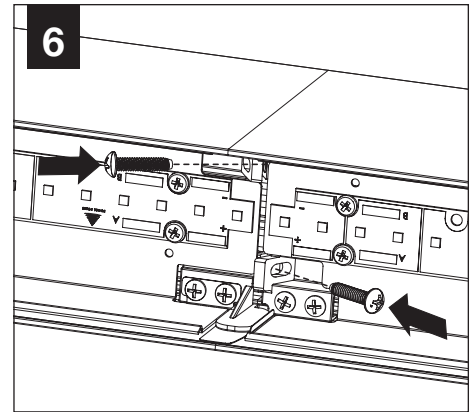
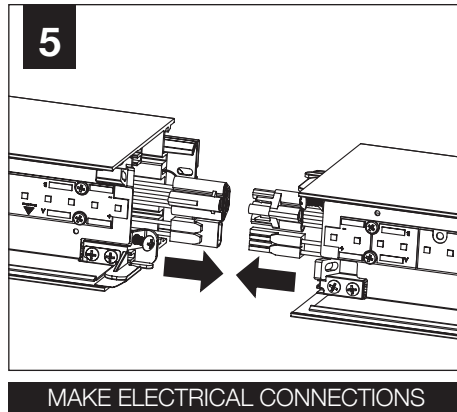
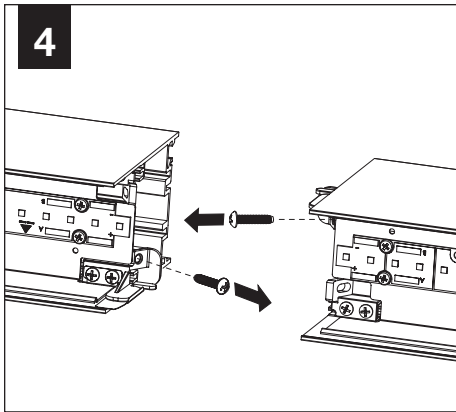

DRIVER SERVICE

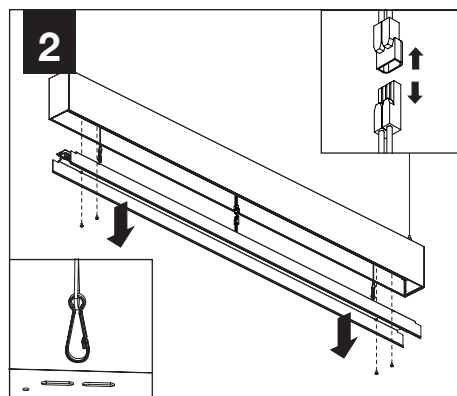
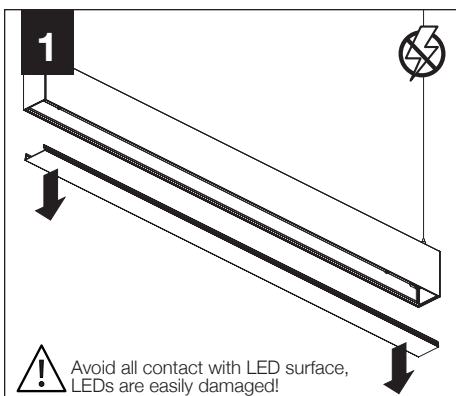

CONNECTED SOLUTIONS

ACUITY nLIGHT

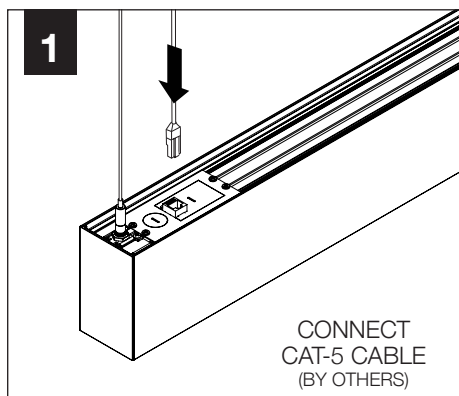

WATTSTOPPER

