

# Seem® 2 LED

Direct/Indirect Suspended | FSM2BS

CONNECTED™  
SOLUTIONS

PL Preferred Light  
Experience BETTER COLOR

FOCAL POINT®



## BEFORE YOU BEGIN

- Luminaires must be installed by a qualified electrician (check with local and national codes for proper installation).
- To prevent electrical shock, disconnect electrical supply before installation or servicing.
- Contractor is responsible for adequately reinforcing walls and/or ceilings to support fixture weight.
- Focal Point, LLC accepts no responsibility for inadequately reinforced walls and/or ceilings.
- The information contained in this drawing is the sole property of Focal Point, LLC. Any reproduction in part or whole without the written permission of Focal Point, LLC is prohibited.

## INSTRUCTION KEY



ATTENTION



SEE ADDITIONAL INSTRUCTIONS



POWER OFF



POWER ON

## COMPONENT KEY

### FOCAL POINT

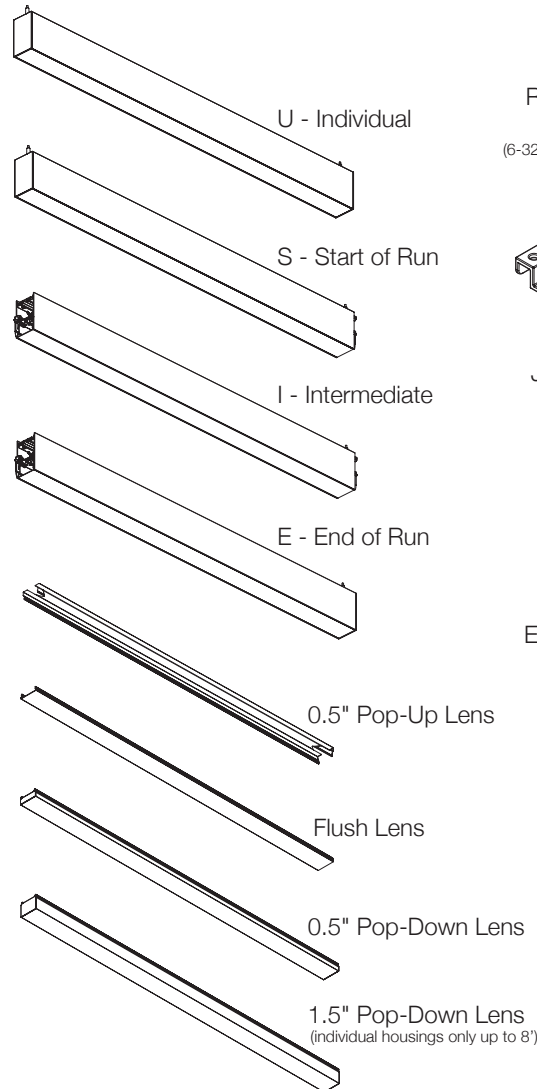

### SHIPPED INSTALLED

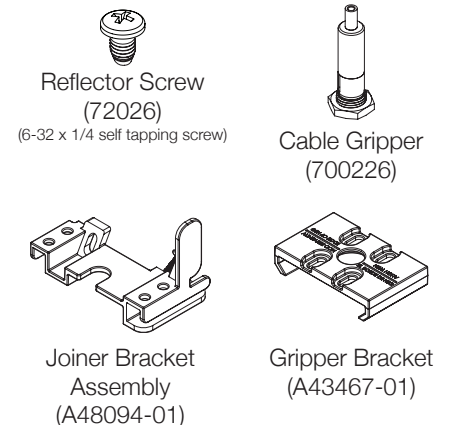

### SHIPPED IN HARDWARE BAG

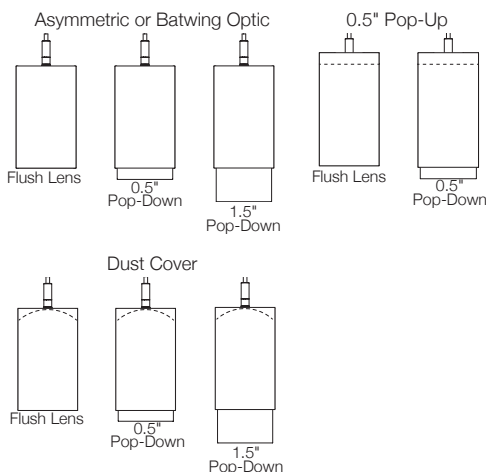
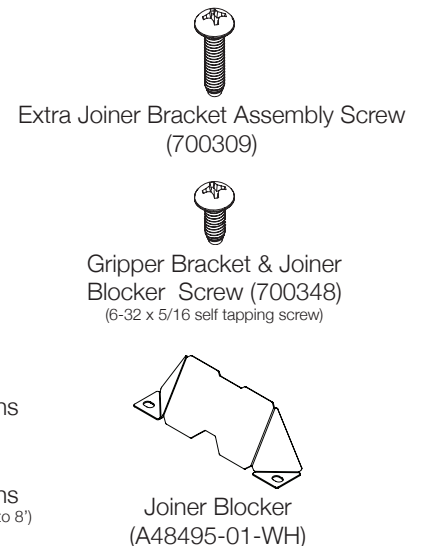

## INDIRECT ASYMMETRIC OPTIC

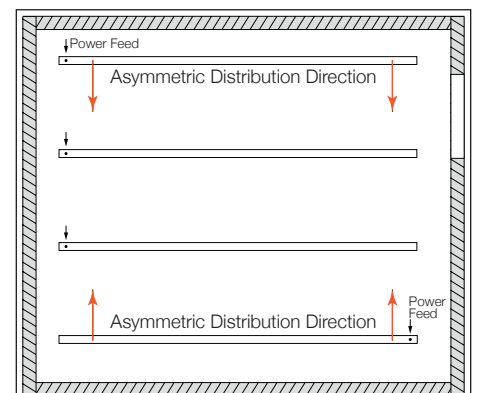
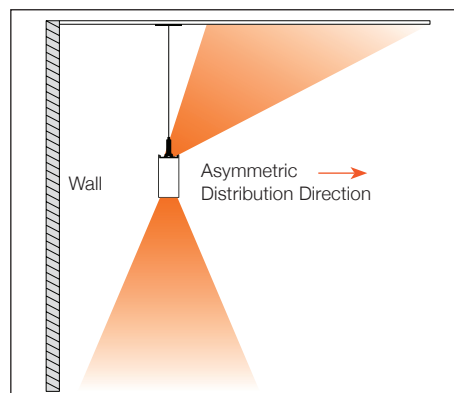

**⚠️ INDIVIDUAL UNIT INSTALLATION FOLLOW STEPS 1, 2, 3, 10, 11 & 12**

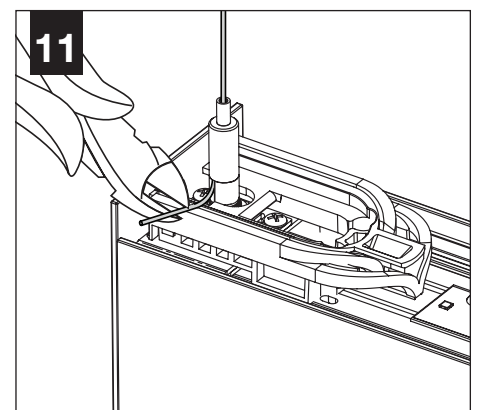
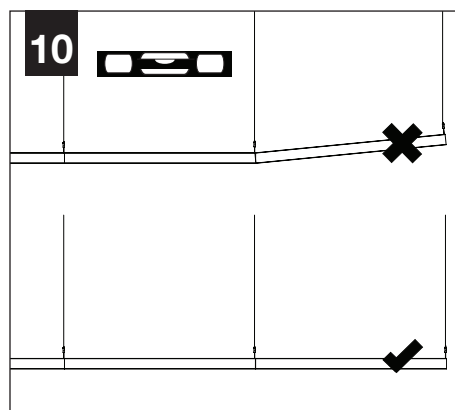
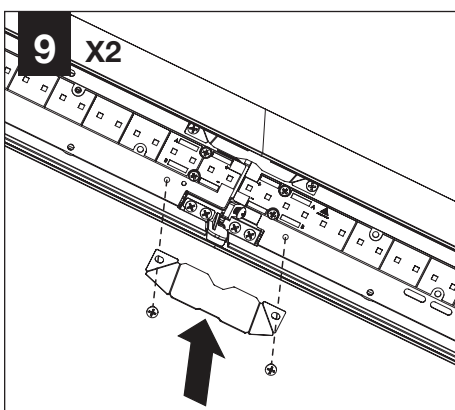
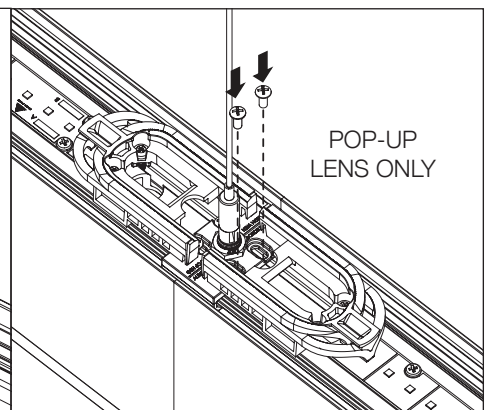
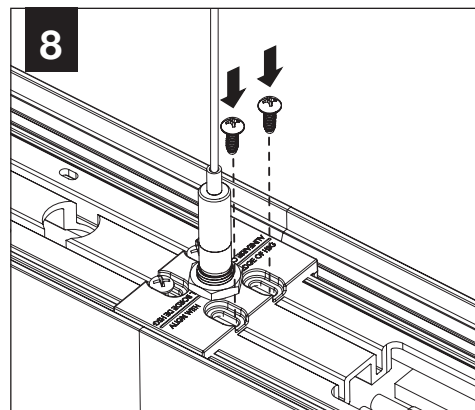
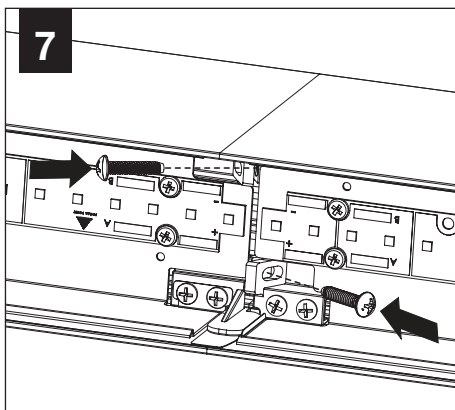
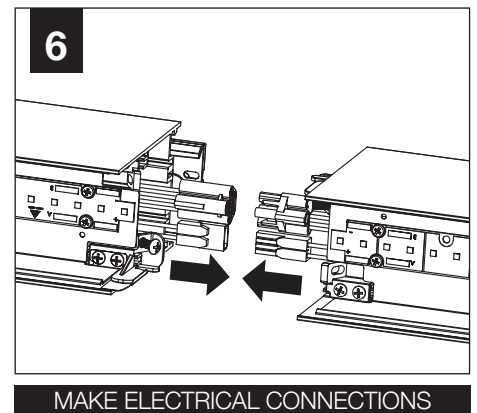
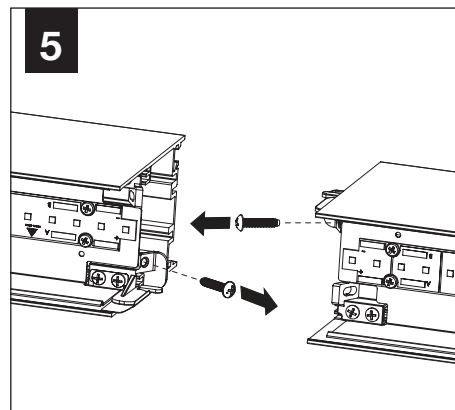
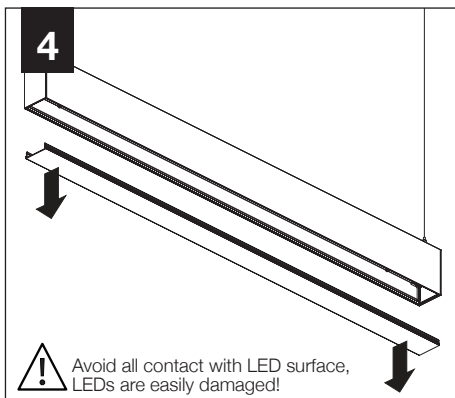
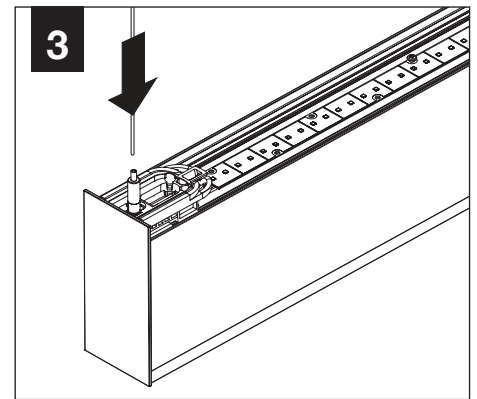
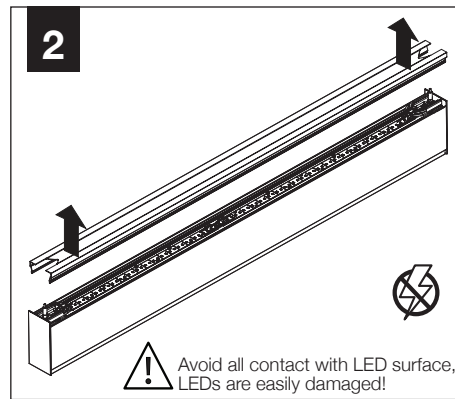
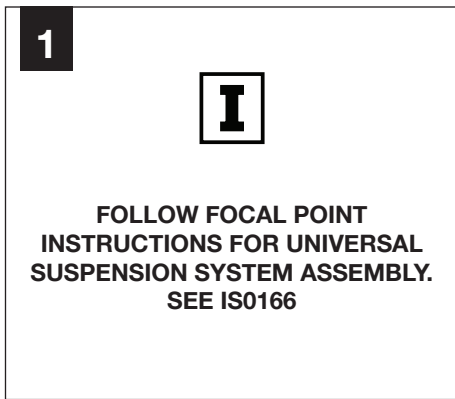

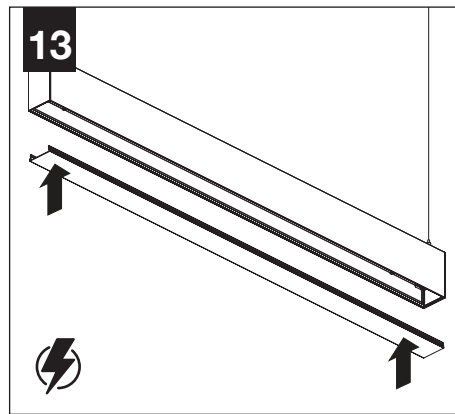
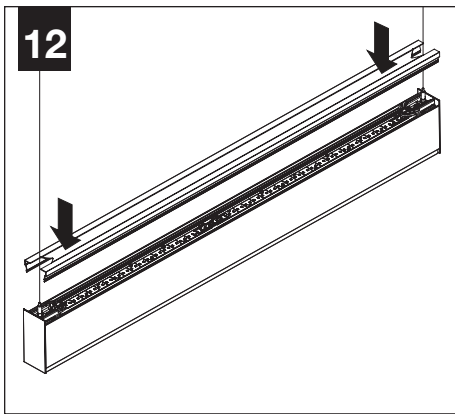

## PATTERNS

### I Pattern mounting locations

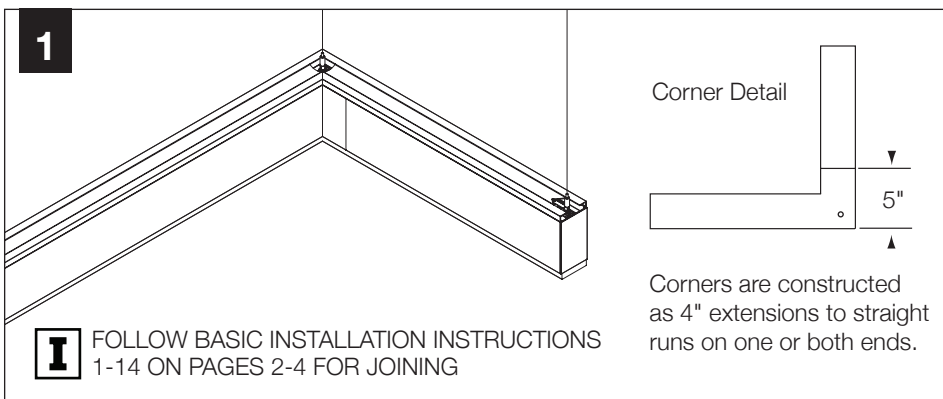
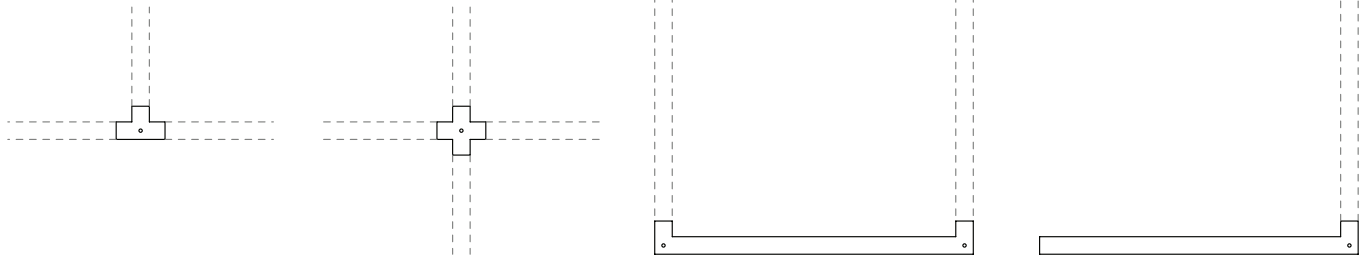

**I** FOLLOW BASIC INSTALLATION INSTRUCTIONS 1-14 ON PAGES 2-4 FOR JOINING

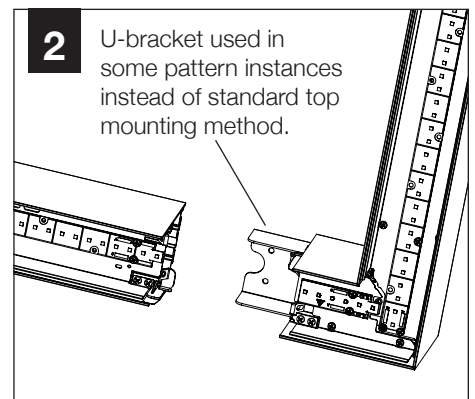

## DRIVER SERVICE

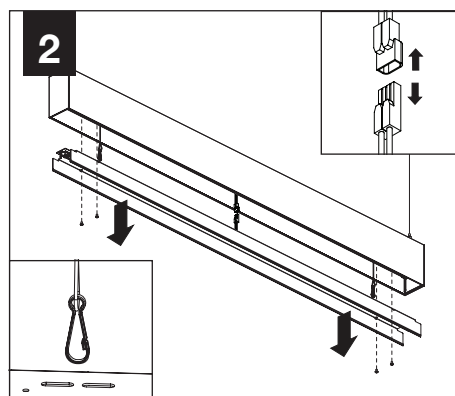
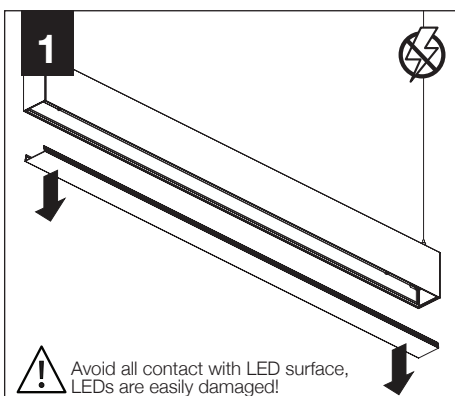

ACUITY nLIGHT

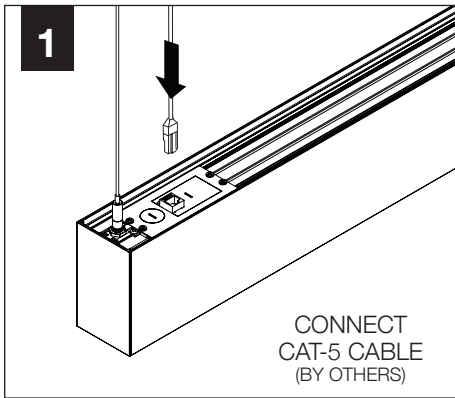

WATTSTOPPER

