

Seem™ 1 surface mount

FSM1-SM

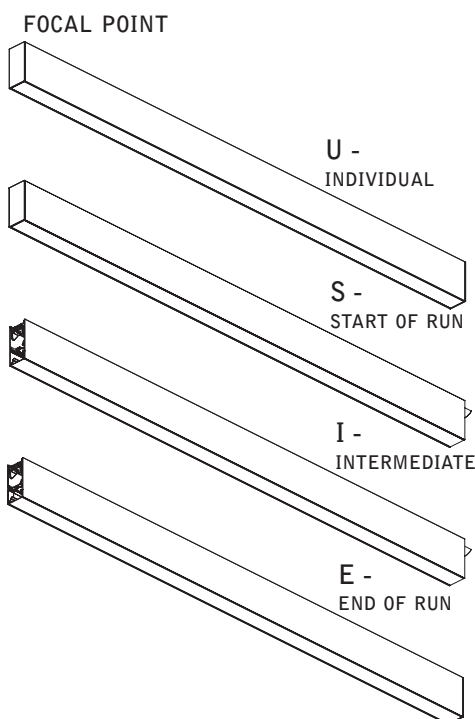

! CONFIGURATIONS ARE RUN SPECIFIC, PLEASE CONSULT FACTORY DRAWINGS BEFORE BEGINNING INSTALLATION. !



KEY



POWER OFF



ATTENTION



POWER ON



SEE ADDITIONAL INSTRUCTIONS



INDIVIDUAL
INSTALLATIONS FOLLOW
STEPS 1-3 & 6-9

MOUNTING

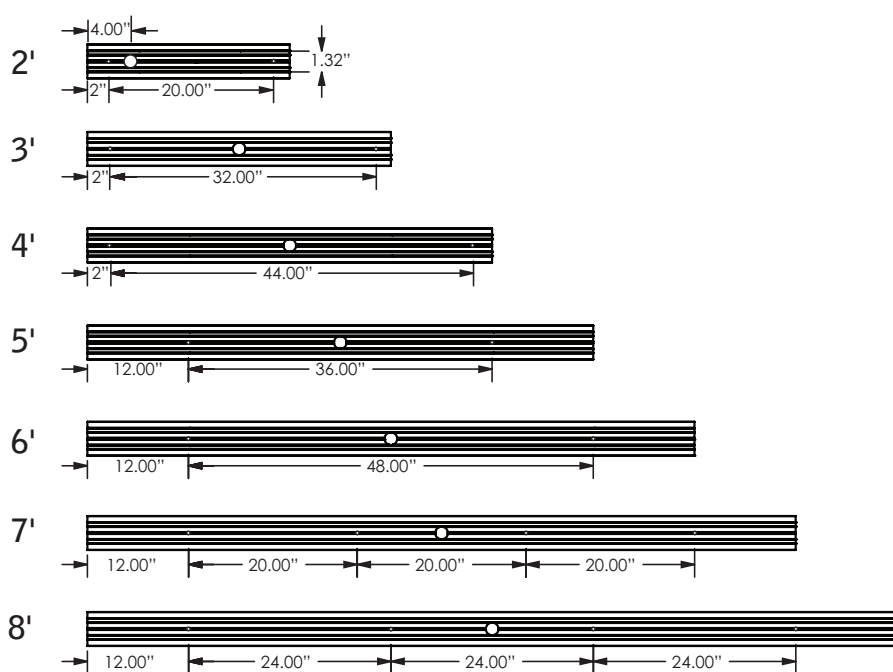

FEED LOCATION IS ALWAYS CENTERED IN HOUSING, WITH THE EXCEPTION OF THE 2' HOUSING.
USE SINGLE DEVICE COVER OR SINGLE GANG HANDY BOX AND MOUNTING HARDWARE (BY OTHERS)

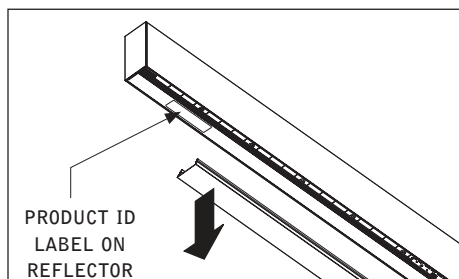

PRODUCT ID LOCATION

PARTS LISTS

SHIPPED INSTALLED

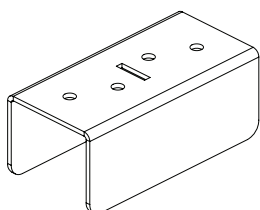

JOINER
BRACKET
(A37351-01)



(700192)

SHIPPED IN HARDWARE BAG



MOUNTING SCREW
(72007)
(2 PER LUMINAIRE)

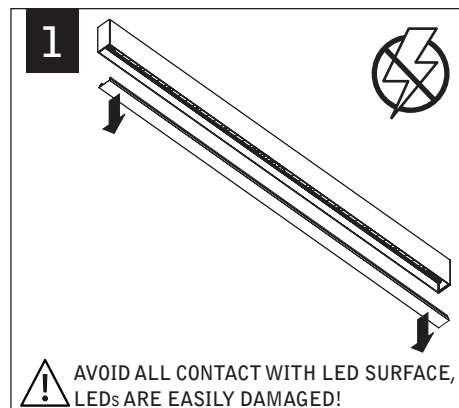
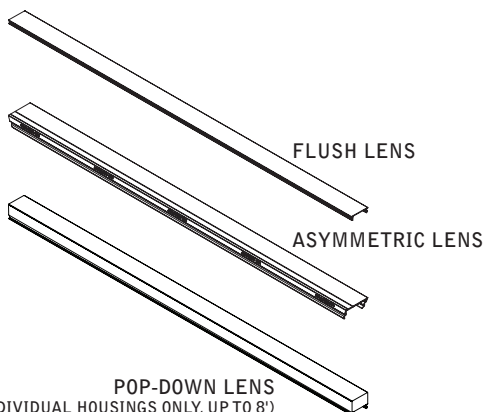

! AVOID ALL CONTACT WITH LED SURFACE, LEDs ARE EASILY DAMAGED!

Luminaires must be installed by a qualified electrician (check with local and national codes for proper installation).
To prevent electrical shock, disconnect electrical supply before installation or servicing.

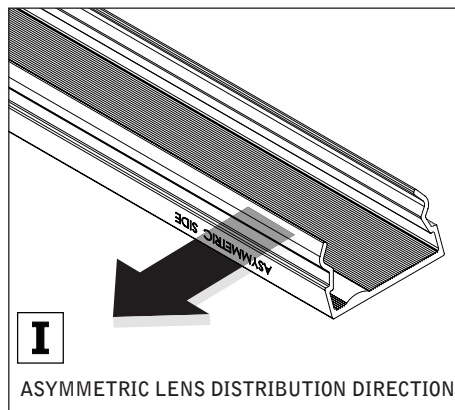
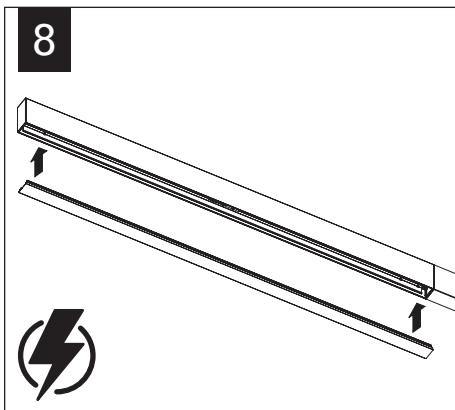
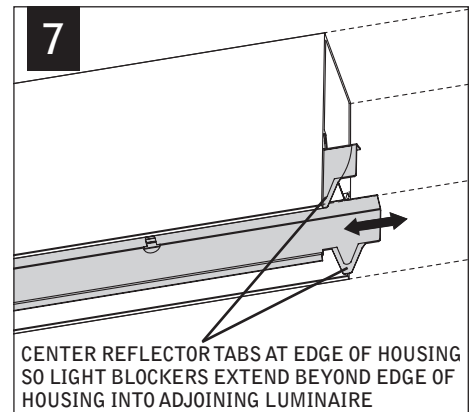
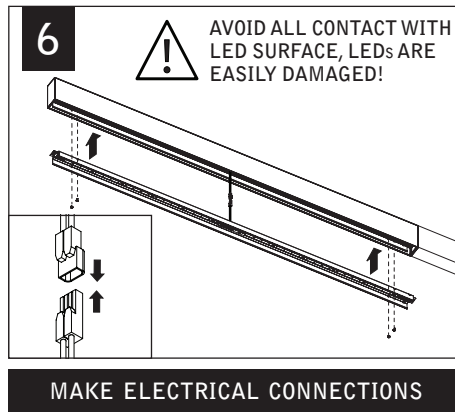
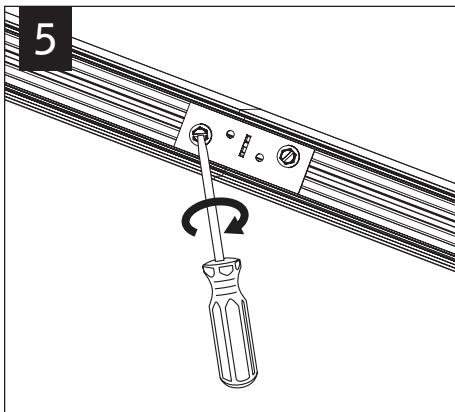
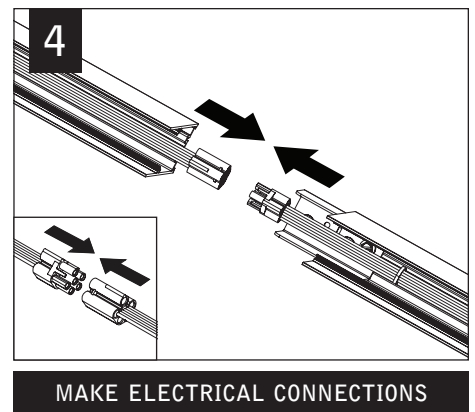
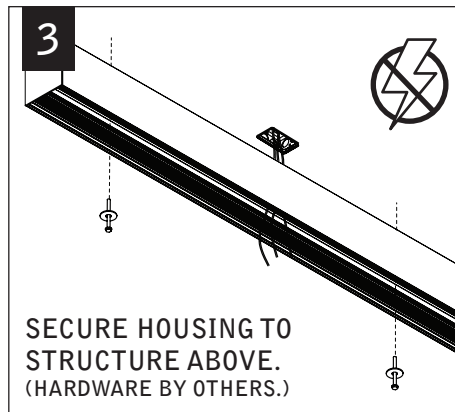
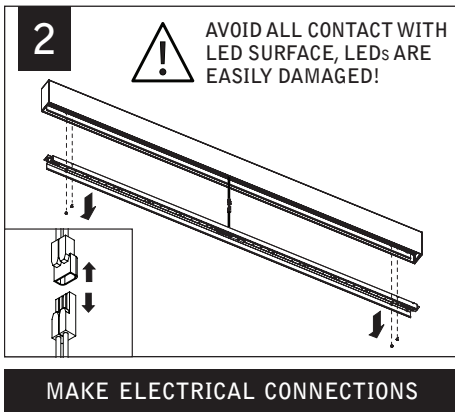

DRIVER SERVICE

