

# skydome™ led suspended

FSDL-22|33|44-CS

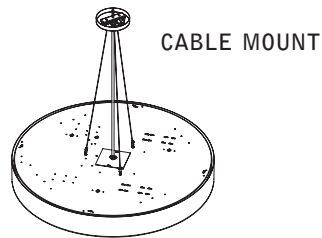

FOCAL POINT

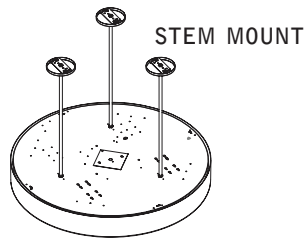

WEIGHTS: 2' - 23LBS  
3' - 50LBS  
4' - 72LBS

KEY



POWER OFF



POWER ON



ATTENTION

## STEM MOUNT

2' DIAMETER

1

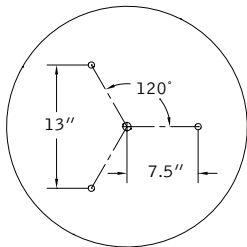

2

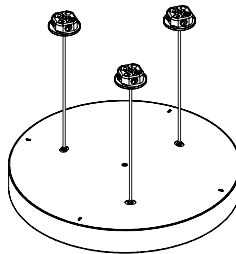

3' DIAMETER

1

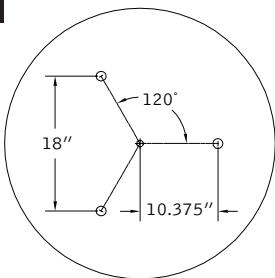

2

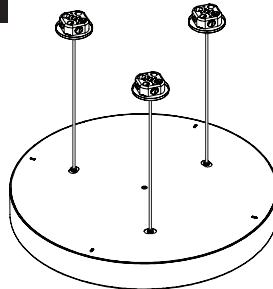

4' DIAMETER

1

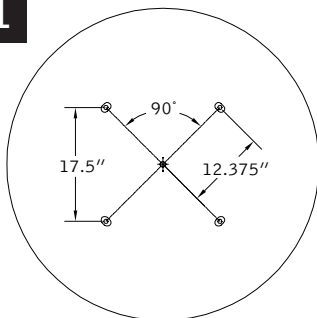

2

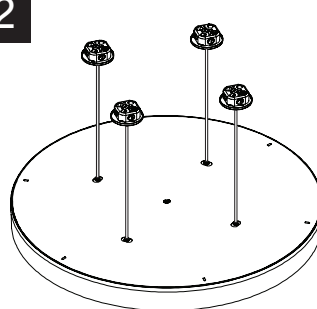

3

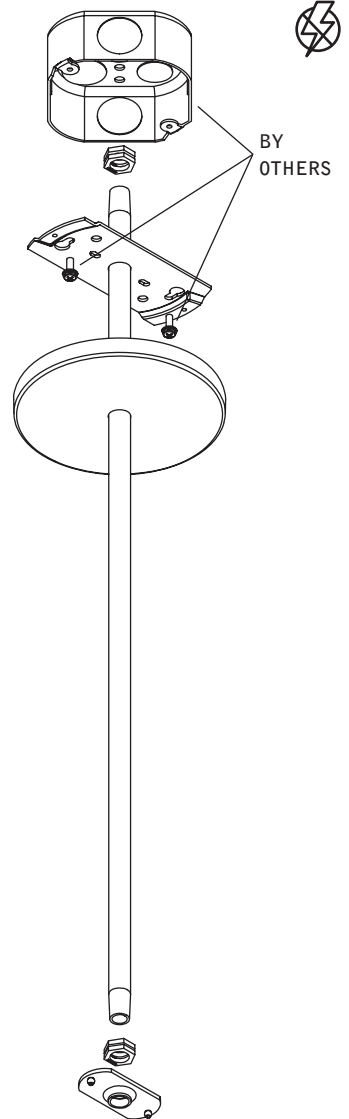

MAKE ELECTRICAL CONNECTIONS

Luminaires must be installed by a qualified electrician (check with local and national codes for proper installation).  
To prevent electrical shock, disconnect electrical supply before installation or servicing.

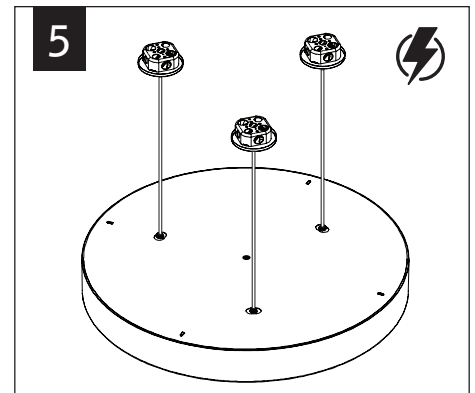
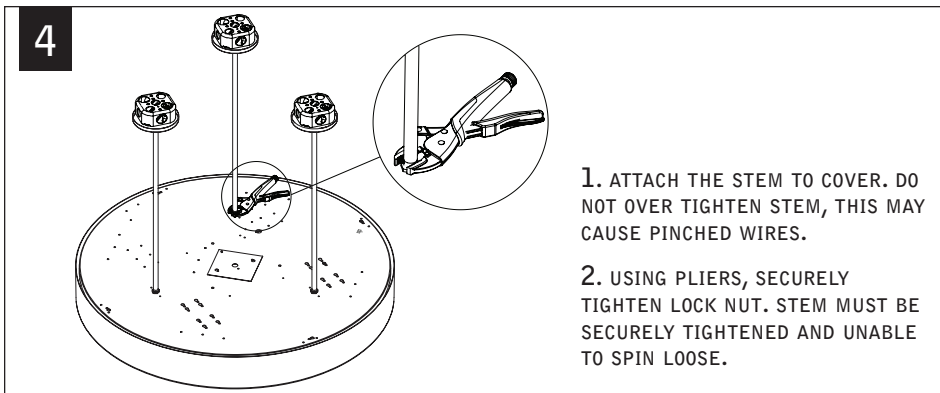

## CABLE MOUNT

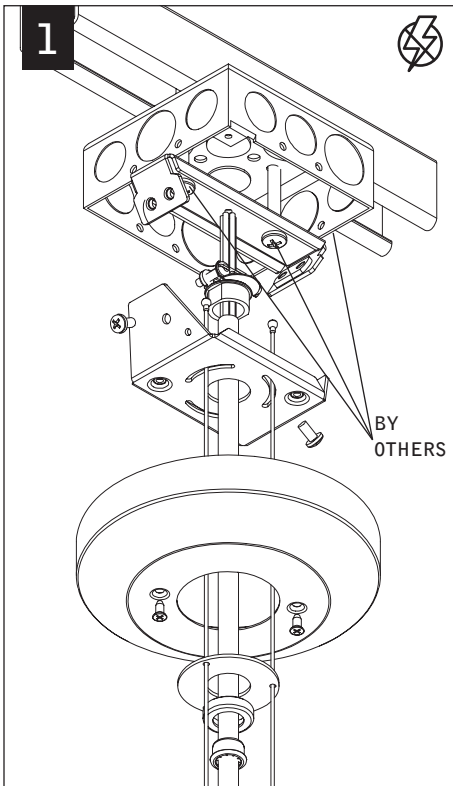

MAKE ELECTRICAL CONNECTIONS

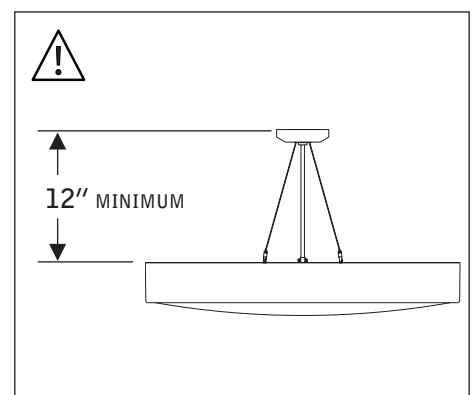
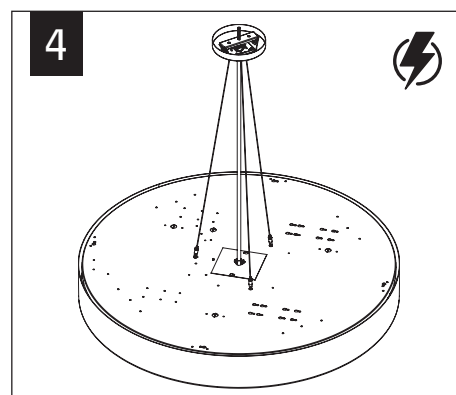
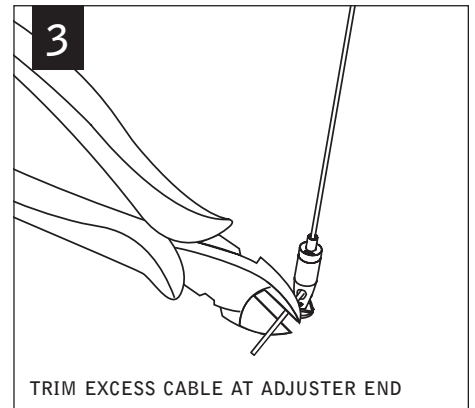
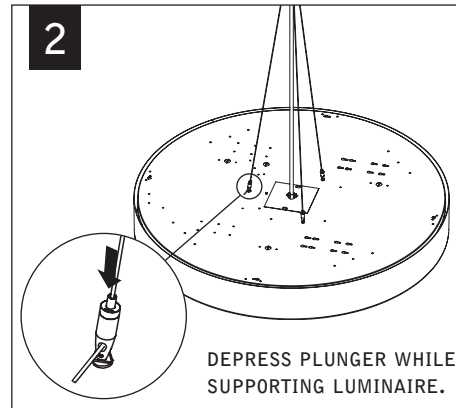

## DRIVER SERVICE

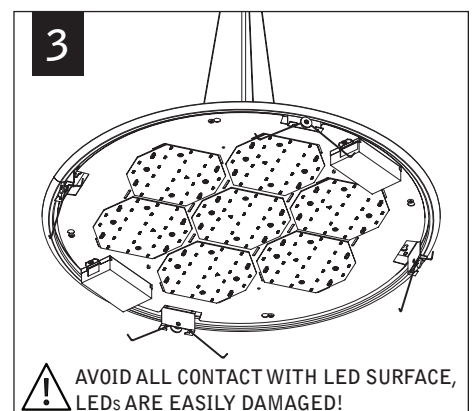
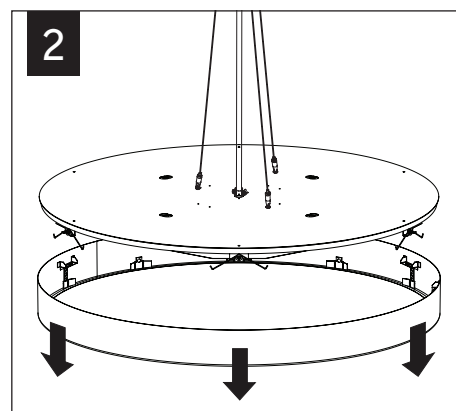
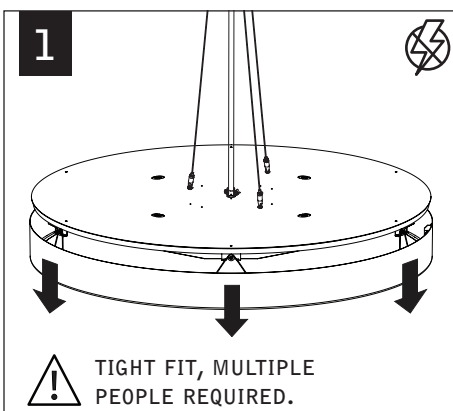

Luminaires must be installed by a qualified electrician (check with local and national codes for proper installation).  
To prevent electrical shock, disconnect electrical supply before installation or servicing.

## EMERGENCY



SEE BATTERY MANUFACTURER  
INSTRUCTIONS

EMERGENCY MAXIMUM MOUNTING HEIGHT:  
16.00'