

Polina™ Indirect Pendant

PENDANT | FPOLP-SHX-10-MPC



FOCAL POINT®



BEFORE YOU BEGIN

- Luminaires must be installed by a qualified electrician (check with local and national codes for proper installation).
- To prevent electrical shock, disconnect electrical supply before installation or servicing.
- Contractor is responsible for adequately reinforcing walls and/or ceilings to support fixture weight.
- Focal Point, LLC accepts no responsibility for inadequately reinforced walls and/or ceilings.
- The information contained in this drawing is the sole property of Focal Point, LLC. Any reproduction in part or whole without the written permission of Focal Point, LLC is prohibited.

INSTRUCTION KEY



ATTENTION



SEE ADDITIONAL INSTRUCTIONS



POWER OFF



POWER ON

HANDLING & CLEANING



Use can of compressed air to remove dust and debris from dust cover.



Lighty wipe dust cover with damp cloth. Do not leave excess moisture on surface.

COMPONENT KEY

LIGHT ENGINE

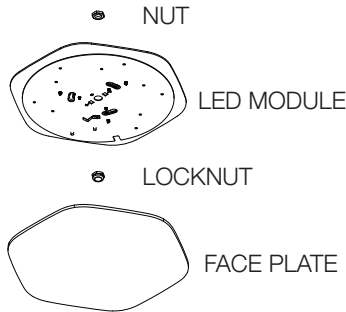

SHIPPED INSTALLED



STEM MOUNT

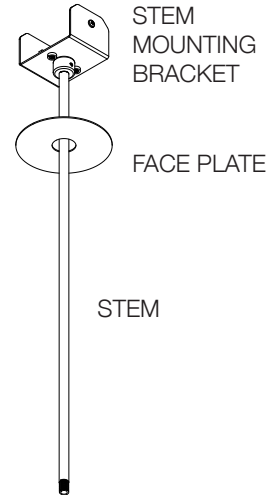

MINI POWER CANOPY

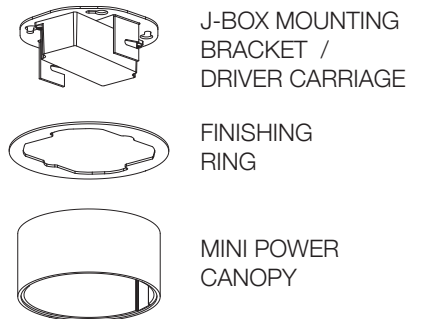

4" OCTAGONAL J-BOX REQUIRED

J-BOX BY OTHERS

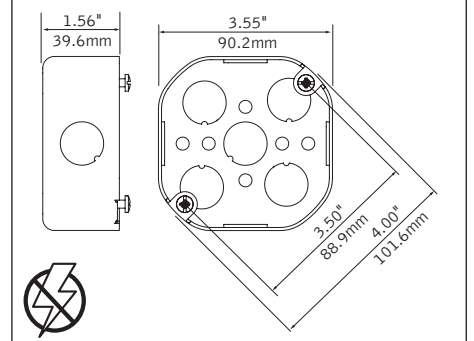

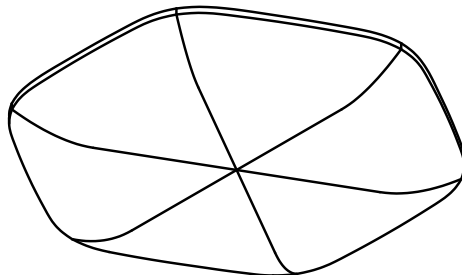
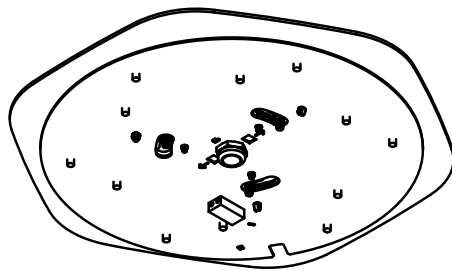
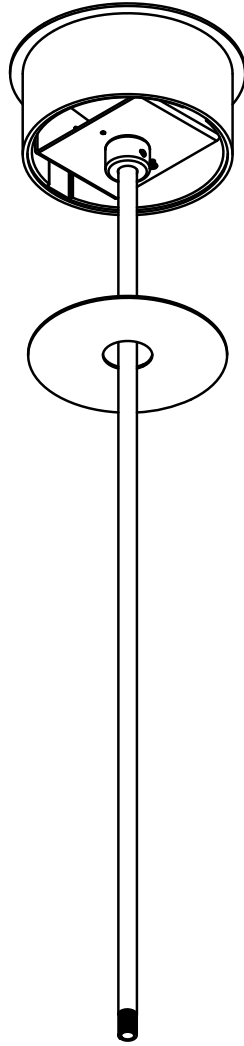

FIELD CUTTABLE STEM (OPTIONAL)

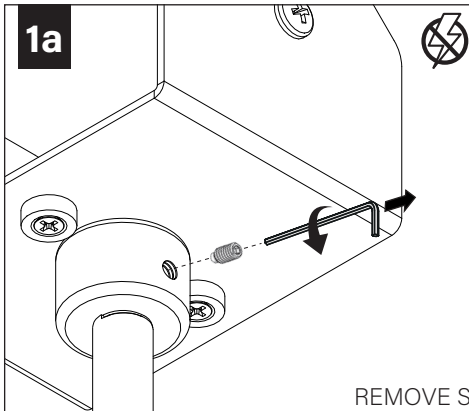

REMOVE SET SCREWS

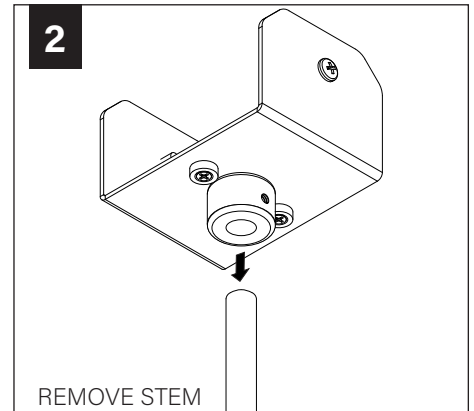
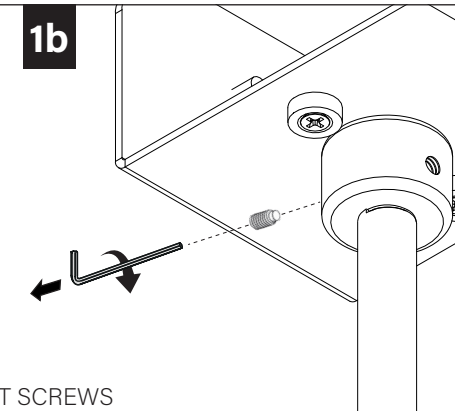

REMOVE STEM

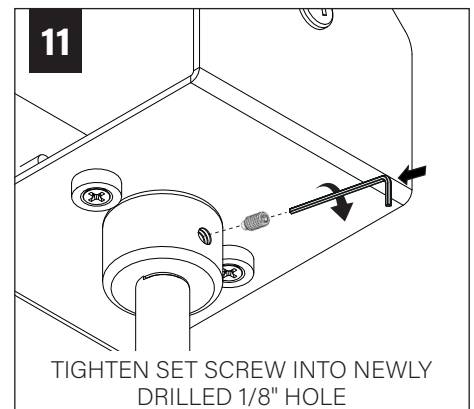
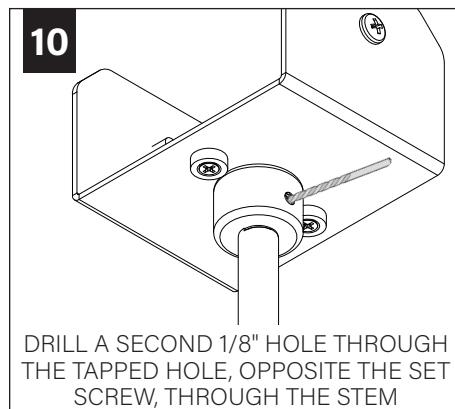
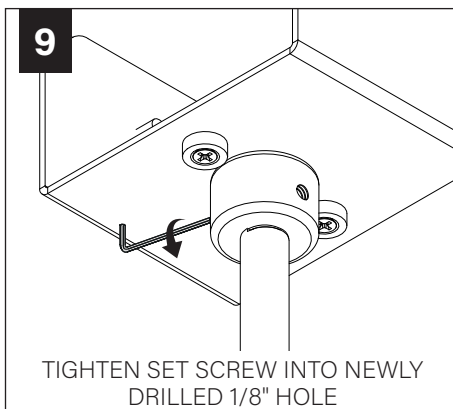
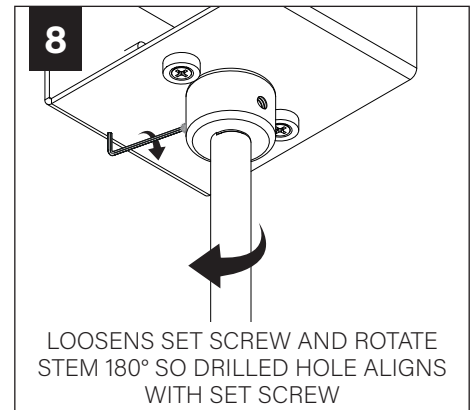
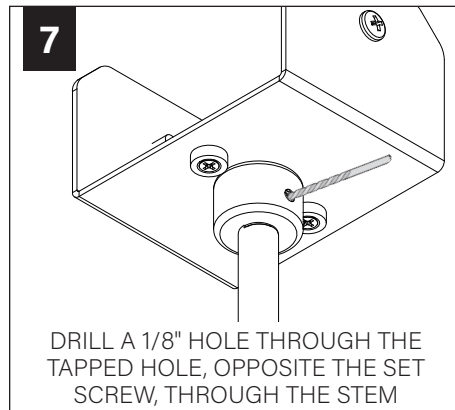
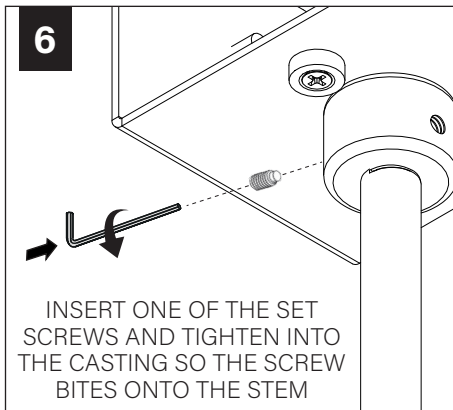
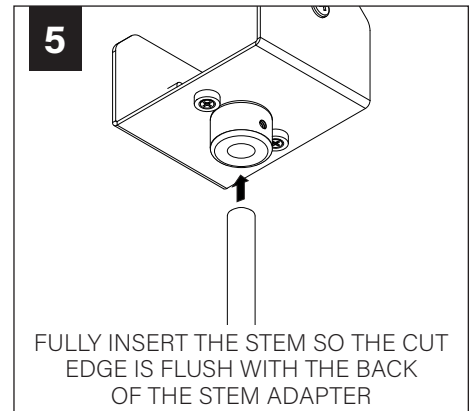
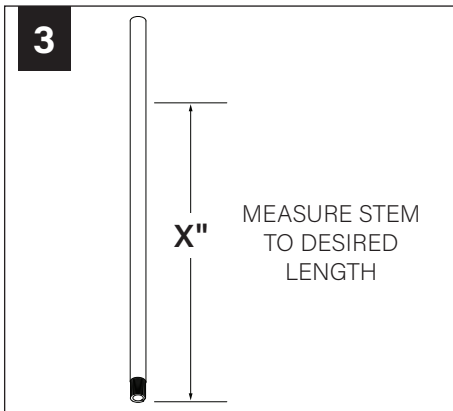

MINI POWER CANOPY INSTALLATION

1

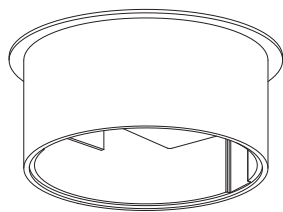

CANOPY ASSEMBLY SHIPS ASSEMBLED

2

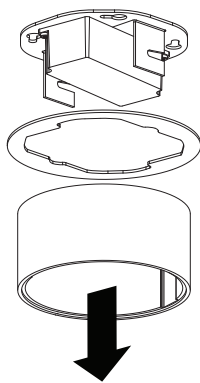

3

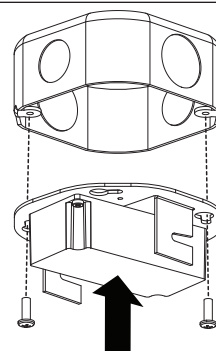

HARDWARE
BY OTHERS

MAKE ELECTRICAL CONNECTION

4

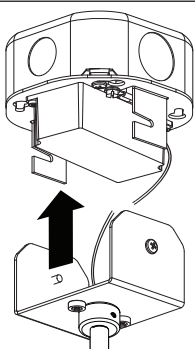

MAKE ELECTRICAL CONNECTION

5

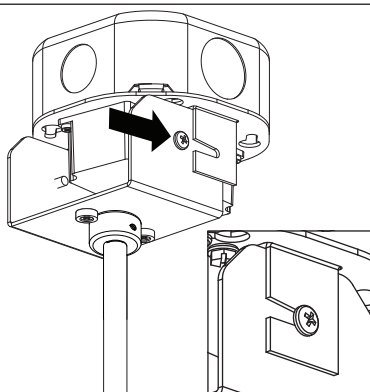

6

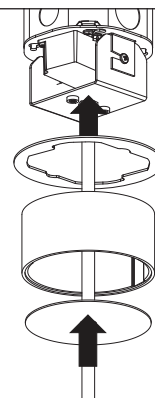

INSTALL CANOPY
ASSEMBLY PARTS
SIMULTANEOUSLY

7

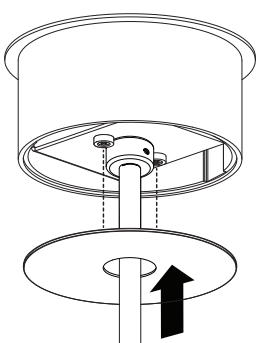

FACE PLATE HELD IN PLACE MAGNETICALLY

DRIVER SERVICE



TURN OFF POWER SOURCE
PRIOR TO DRIVER SERVICE

1

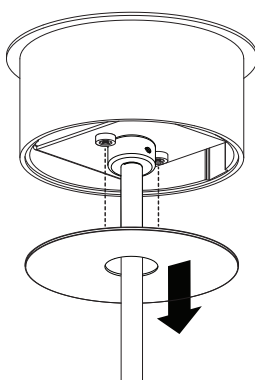

2

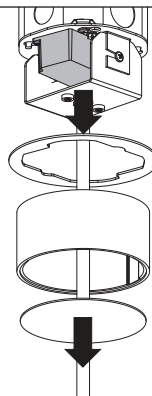

LED MODULE

1a



TIGHTEN SPACING
NUT TO STEM

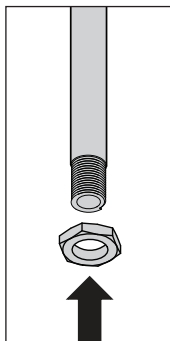
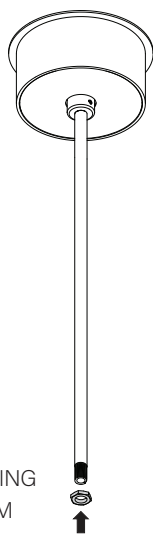

1b

TIGHTEN BY HAND.
DO NOT OVERTIGHTEN.

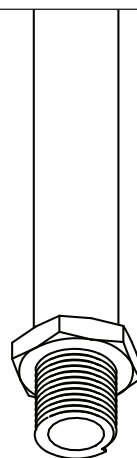

2

IF LENS
POPS OFF,
RE-INSTALL
WITH SHINY
SIDE UP

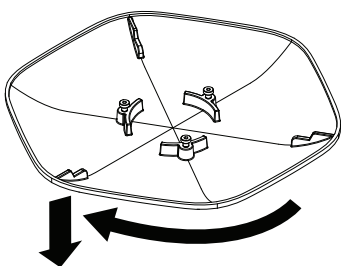
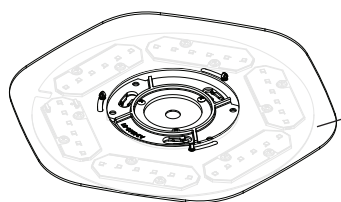

TWIST TO UNLOCK AND REMOVE
FACEPLATE FROM LED MODULE

3

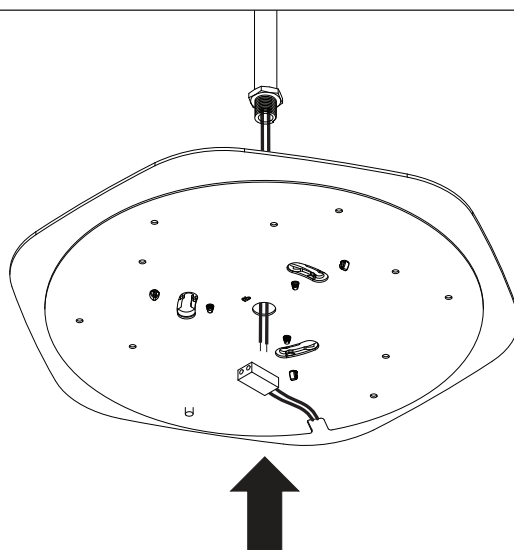

4

FEED WIRES
THROUGH
LOCKNUT

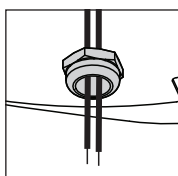
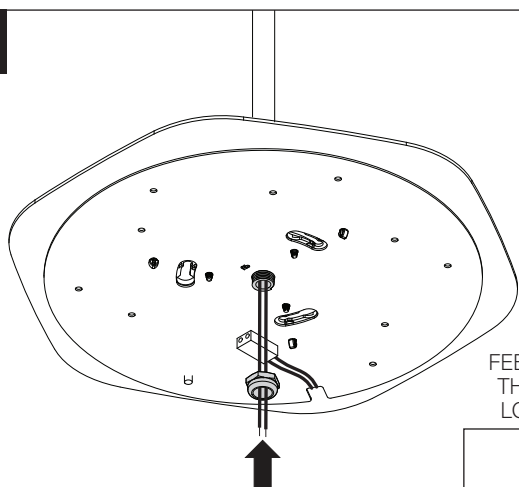

5

IF THREADED ROD
PROTRUDES MORE THAN
TWO THREADS BEYOND
THE LOCKNUT, RETURN TO
STEP 2B AND READJUST
SPACING NUT

