

# ID+ Cylinder Surface Mount

FLCY3 | FLCY4



FOCAL POINT®



## BEFORE YOU BEGIN

- Luminaires must be installed by a qualified electrician (check with local and national codes for proper installation).
- To prevent electrical shock, disconnect electrical supply before installation or servicing.
- Contractor is responsible for adequately reinforcing walls and/or ceilings to support fixture weight.
- Focal Point, LLC accepts no responsibility for inadequately reinforced walls and/or ceilings.
- The information contained in this drawing is the sole property of Focal Point, LLC. Any reproduction in part or whole without the written permission of Focal Point, LLC is prohibited.

## INSTRUCTION KEY



ATTENTION



SEE ADDITIONAL INSTRUCTIONS



POWER OFF



POWER ON



LEVEL

## COMPONENT KEY

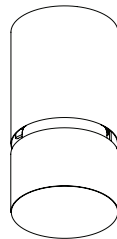

### SHALLOW CANOPY

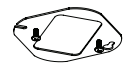

J-BOX  
MOUNTING  
BRACKET

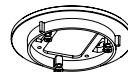

SHALLOW  
CANOPY

### POWER CANOPY

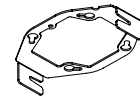

J-BOX  
MOUNTING  
BRACKET

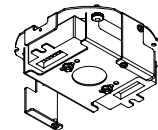

DRIVER  
CARRIAGE

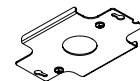

POWER CORD  
MOUNTING  
BRACKET

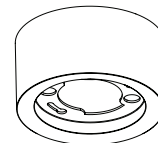

POWER  
CANOPY

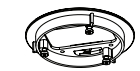

MOUNTING  
BRACKET



LUMINAIRE MUST BE INSTALLED PRIOR TO DRYWALL CEILING.  
ALL GRID LUMINAIRE MUST BE SECURED TO STRUCTURE ABOVE.

## INSTALL 4" OCTAGONAL J-BOX (BY OTHERS)

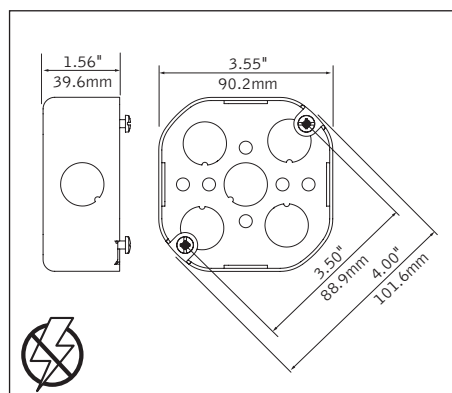

## EMERGENCY



PRIOR TO LUMINAIRE INSTALLATION,  
SEE **PAGE 5** FOR EMERGENCY  
INSTALLATION INSTRUCTIONS.

## SHALLOW CANOPY INSTALLATION

### 3.5" CYLINDER

1a

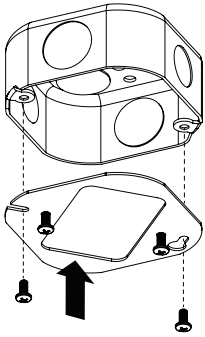

1b

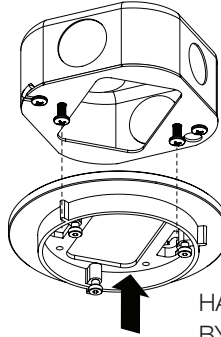

HARDWARE  
BY OTHERS

### 4.5" CYLINDER

2

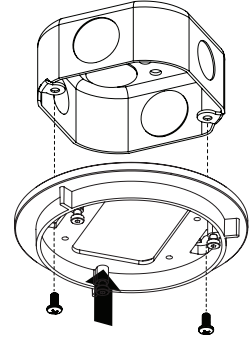

3

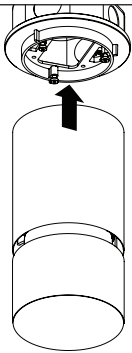

MAKE ELECTRICAL CONNECTION

4

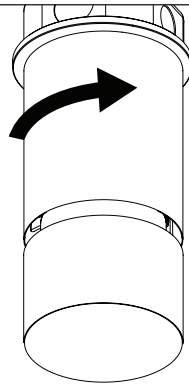

5

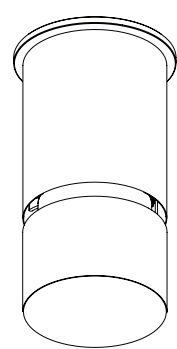

## SHALLOW CANOPY DRIVER SERVICE

1

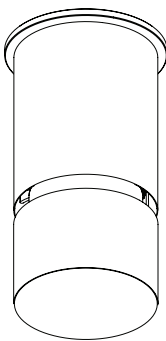

2

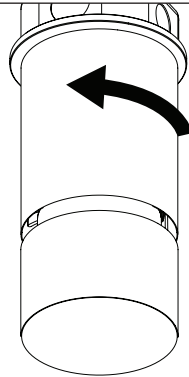

3

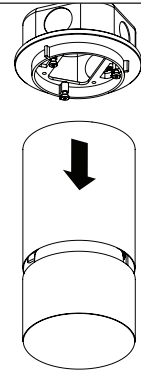

4

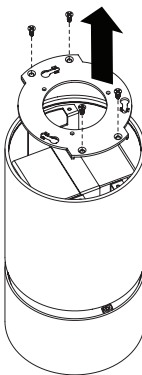

5

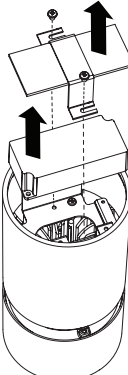

## POWER CANOPY INSTALLATION

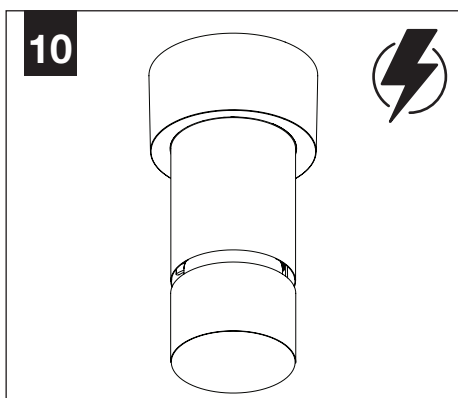
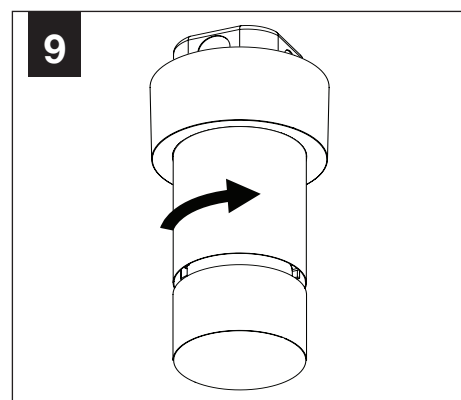
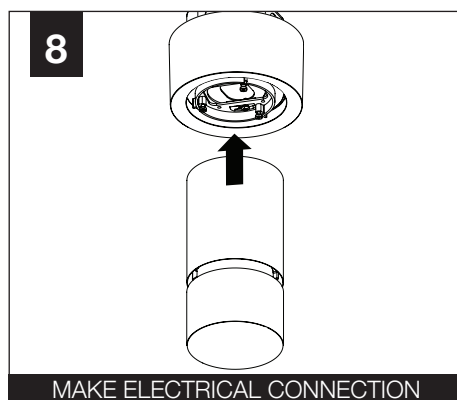
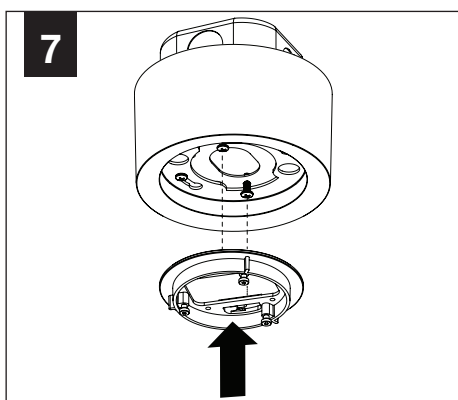
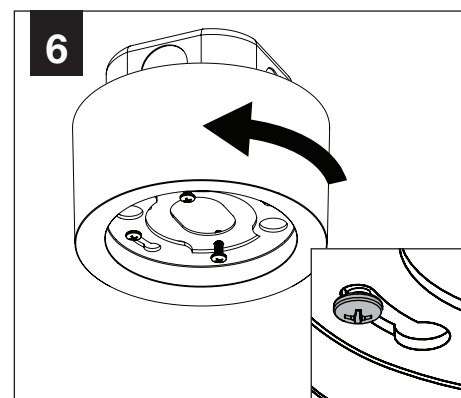
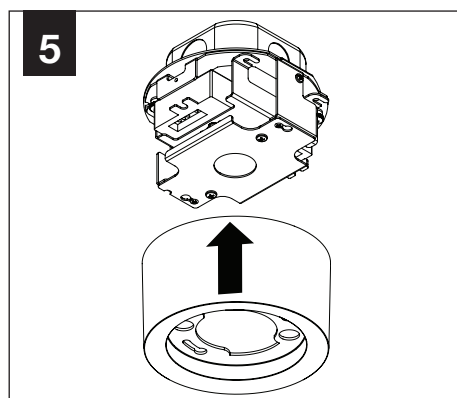
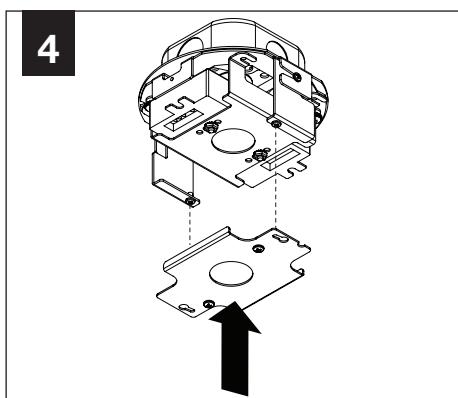
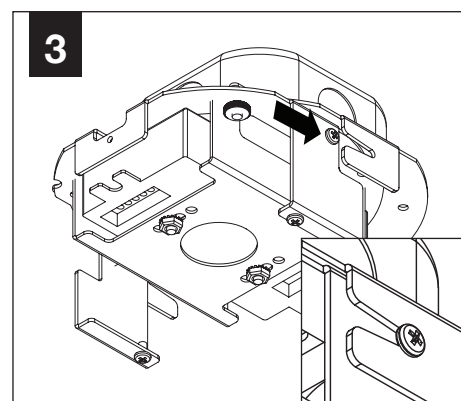
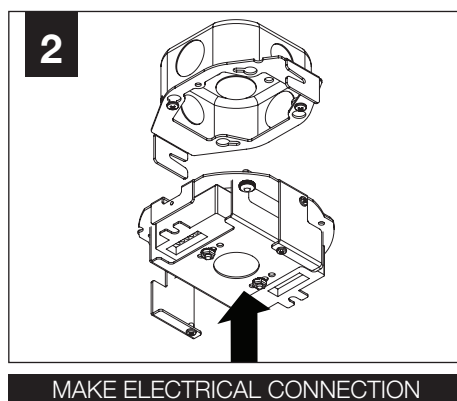
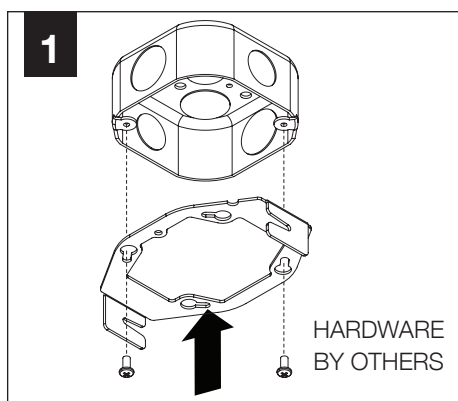

## POWER CANOPY DRIVER SERVICE

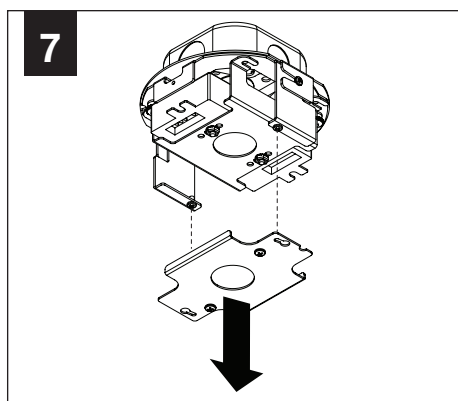
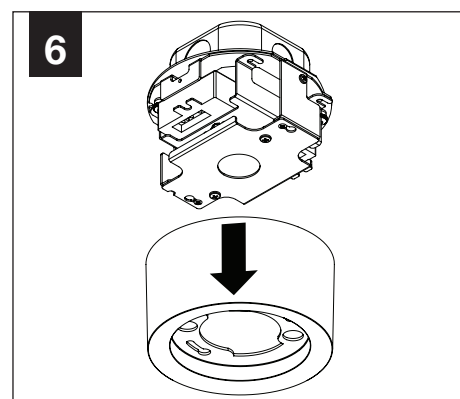
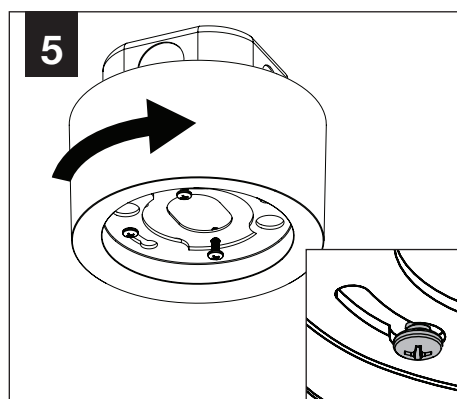
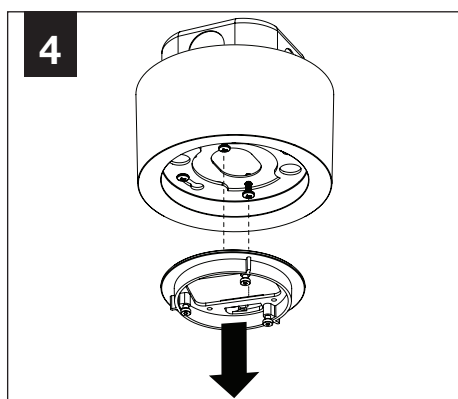
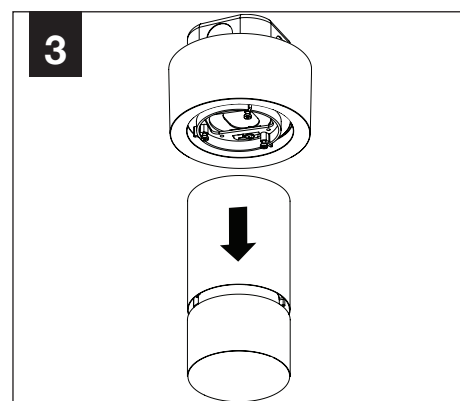
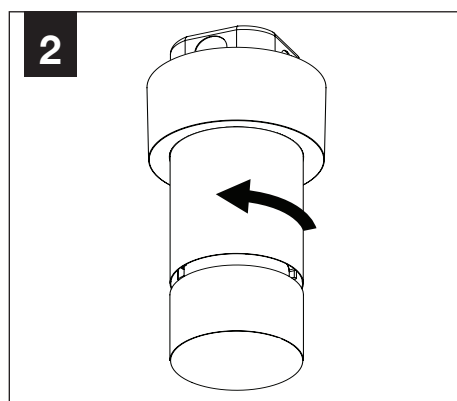
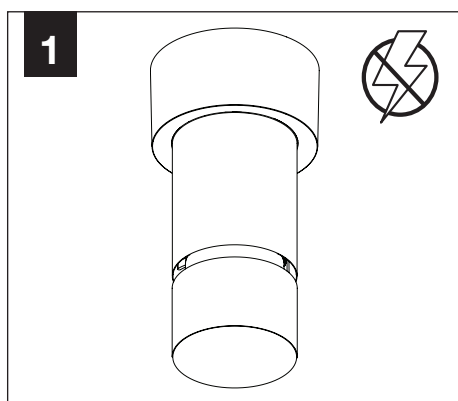

## OPTIC SERVICE

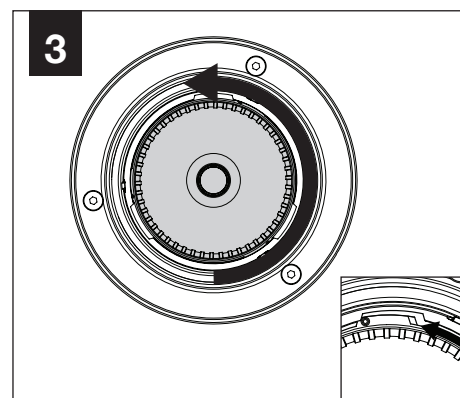
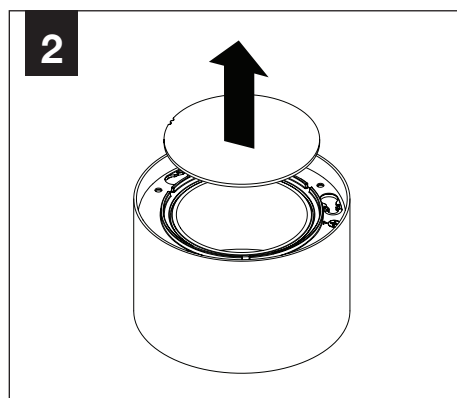
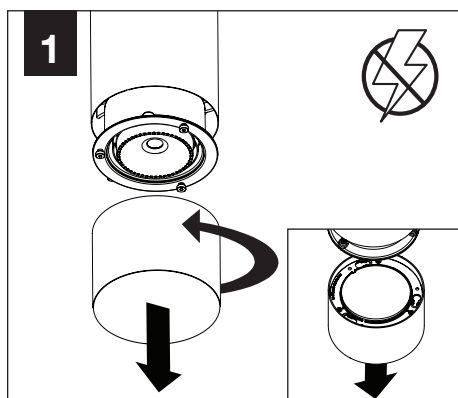

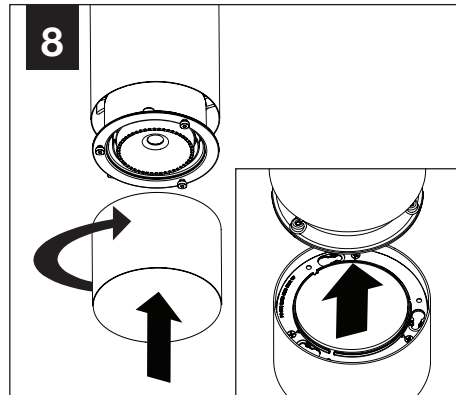
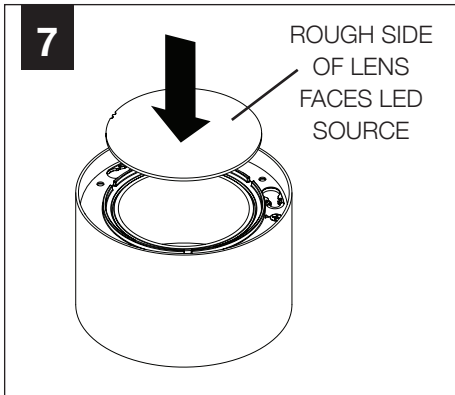
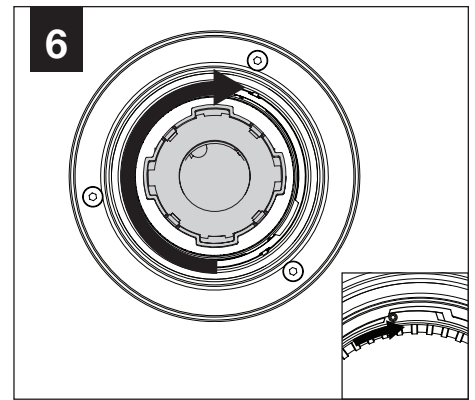
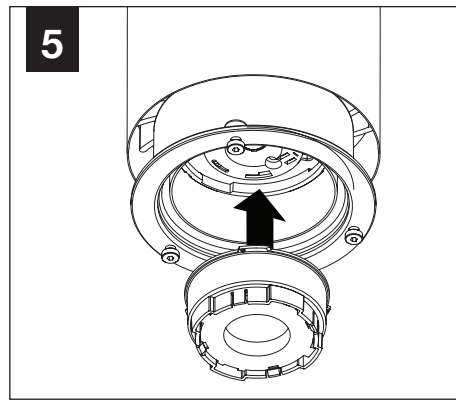
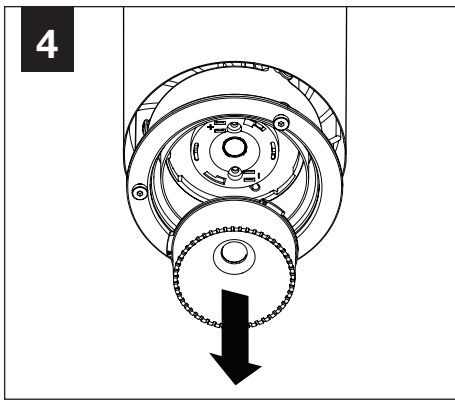

## EMERGENCY



SEE BATTERY MANUFACTURER  
INSTRUCTIONS

**EMERGENCY MAXIMUM MOUNTING HEIGHT:**

**3.5" CYLINDERS - 16.98'**

**4.5" CYLINDERS - 16'**

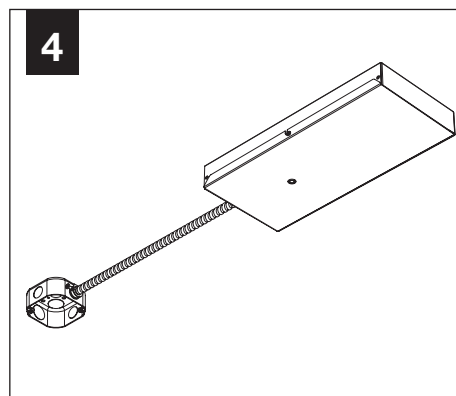
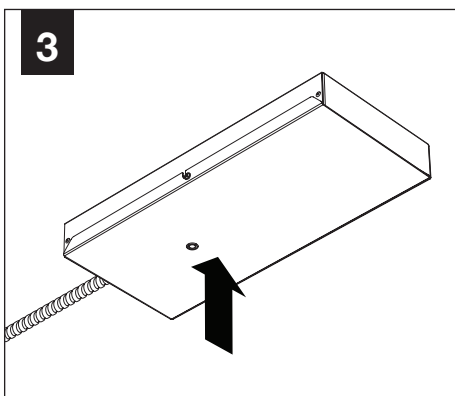
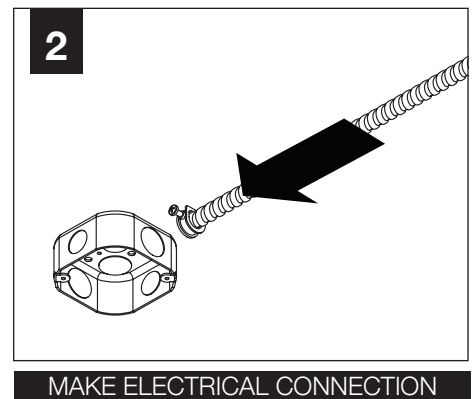
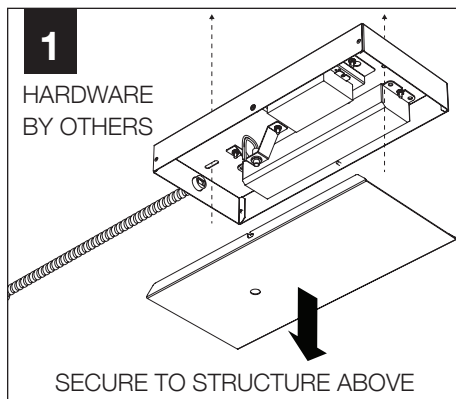

PROCEED TO  
LUMINAIRE INSTALLATION  
**SHALLOW CANOPY, PAGE 2**  
**POWER CANOPY, PAGE 3**