

ID⁺ 3.5" Pure Cylinder - Surface Mount

FLCY3N-RD-7H - Shallow Canopy



FOCAL POINT®



BEFORE YOU BEGIN

- Luminaires must be installed by a qualified electrician (check with local and national codes for proper installation).
- To prevent electrical shock, disconnect electrical supply before installation or servicing.
- Contractor is responsible for adequately reinforcing walls and/or ceilings to support fixture weight.
- Focal Point, LLC accepts no responsibility for inadequately reinforced walls and/or ceilings.
- The information contained in this drawing is the sole property of Focal Point, LLC. Any reproduction in part or whole without the written permission of Focal Point, LLC is prohibited.

INSTRUCTION KEY



ATTENTION



SEE ADDITIONAL INSTRUCTIONS



POWER OFF



POWER ON

COMPONENT KEY

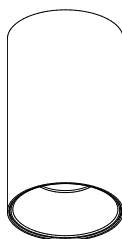

SHALLOW CANOPY



J-BOX
MOUNTING
BRACKET



SHALLOW
CANOPY

DECORATIVE SHALLOW CANOPY

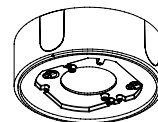

DECORATIVE
J-BOX COVER



SHALLOW
CANOPY



MOUNTING
SCREWS
#72009



LUMINAIRE MUST BE INSTALLED PRIOR TO DRYWALL CEILING.
ALL GRID LUMINAIRE MUST BE SECURED TO STRUCTURE ABOVE.

4" OCTAGONAL J-BOX REQUIRED

J-BOX BY OTHERS

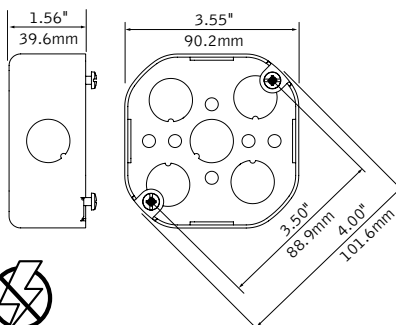

EMERGENCY



PRIOR TO LUMINAIRE INSTALLATION,
SEE **PAGE 5** FOR EMERGENCY
INSTALLATION INSTRUCTIONS.

SHALLOW CANOPY

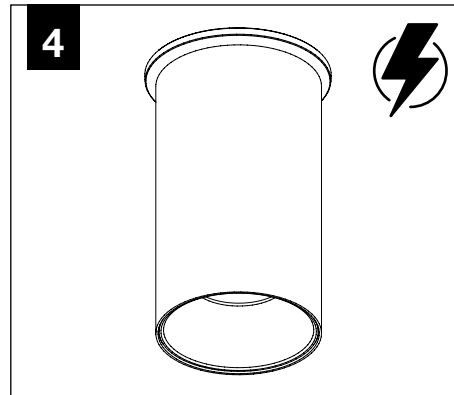
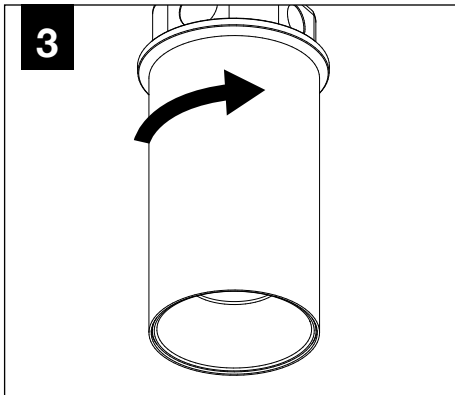
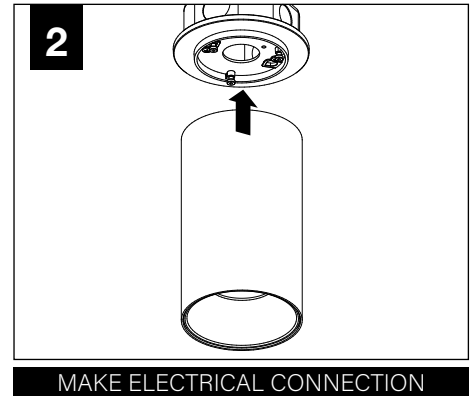
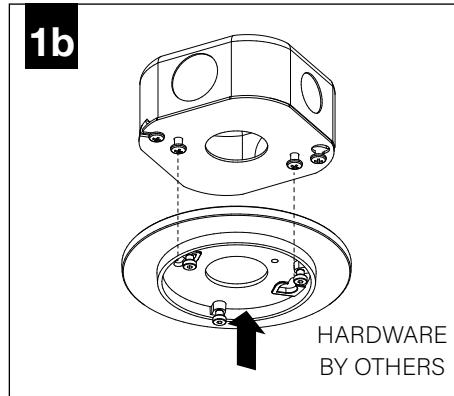
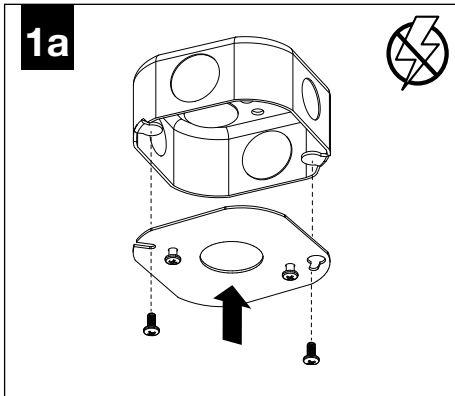

DECORATIVE SHALLOW CANOPY

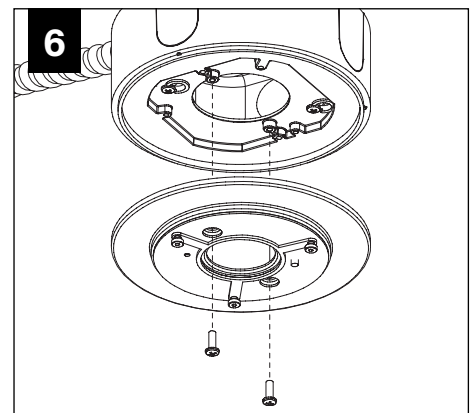
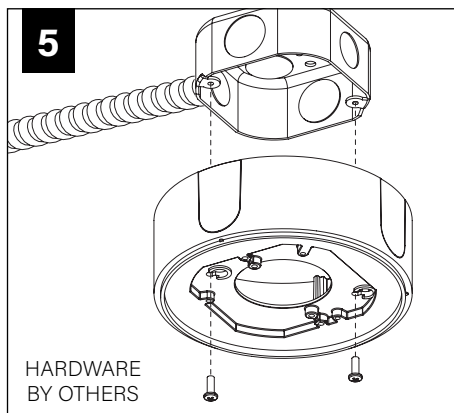
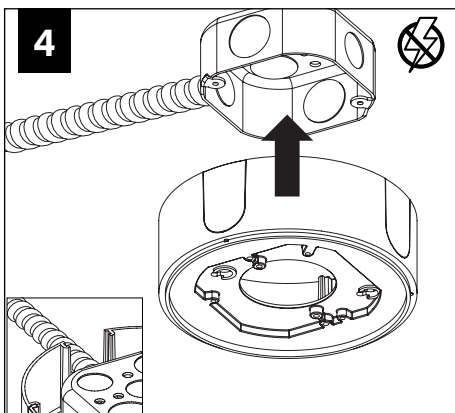
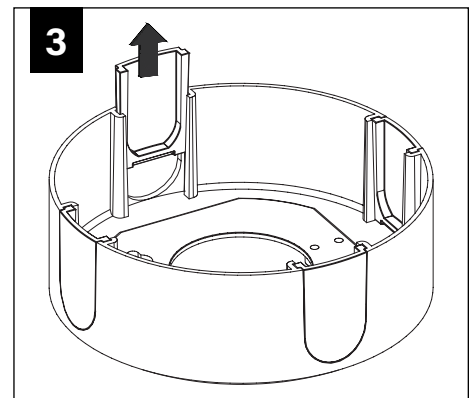
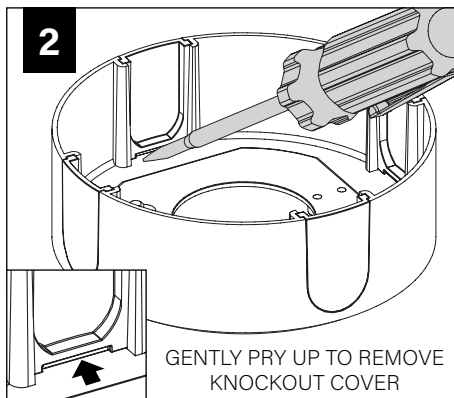
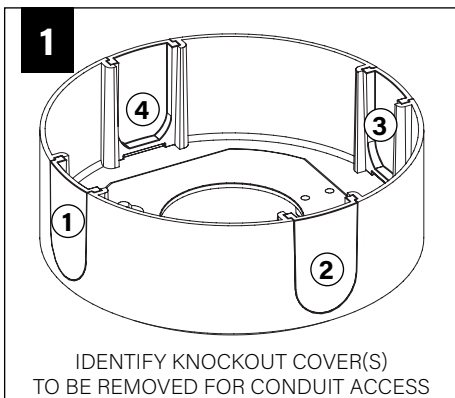

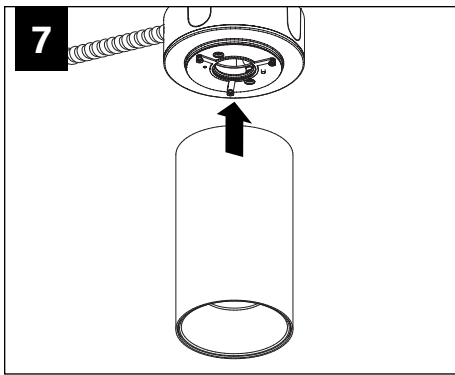

MAKE ELECTRICAL CONNECTION

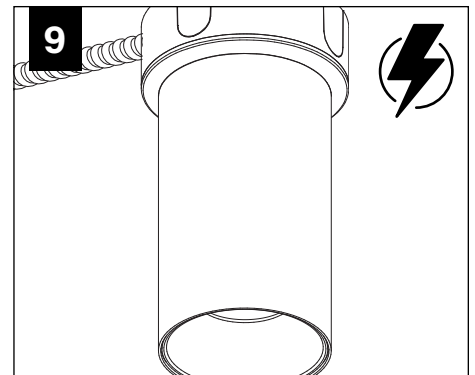
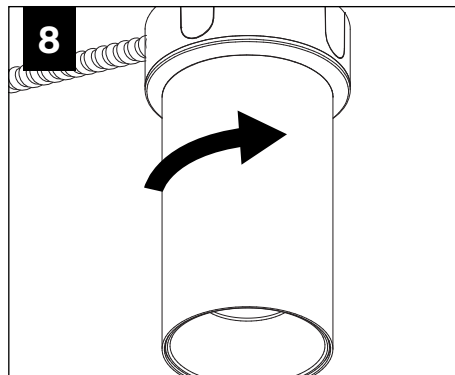

DRIVER SERVICE



TURN OFF POWER SOURCE
PRIOR TO DRIVER SERVICE

1

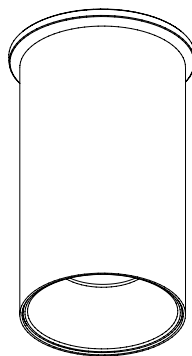

2

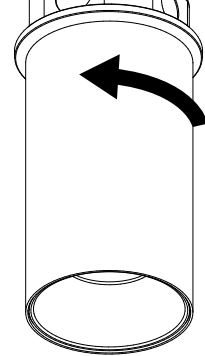

3

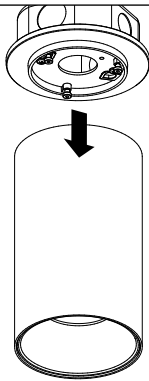

4

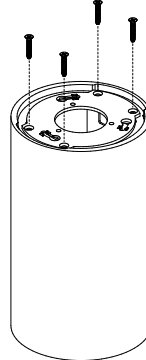

5

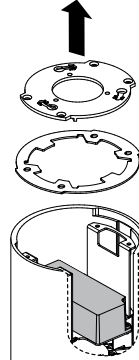

OPTIC SERVICE

1

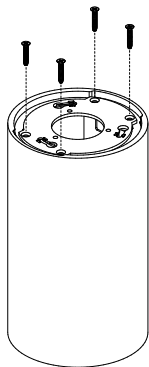

2

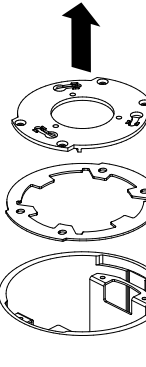

3

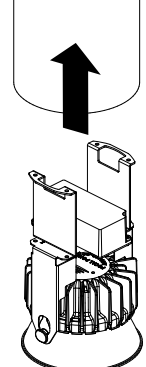
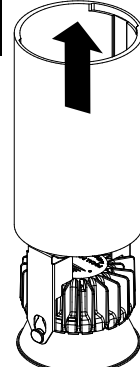

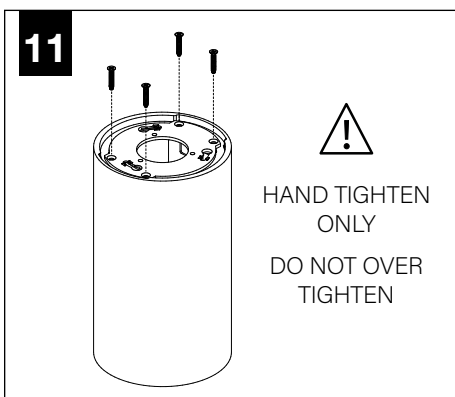
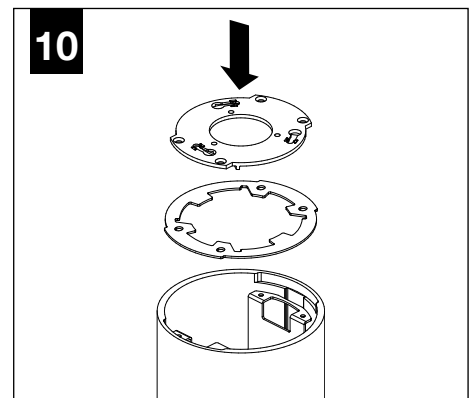
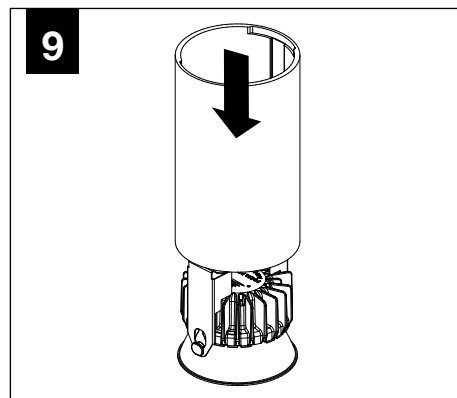
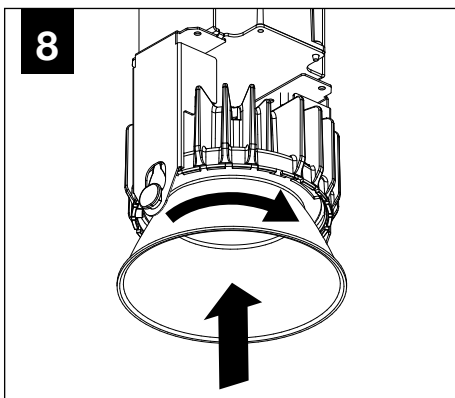
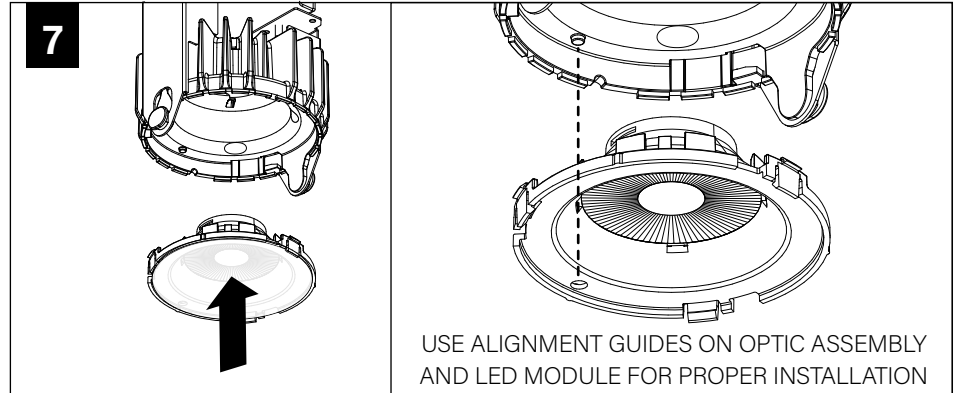
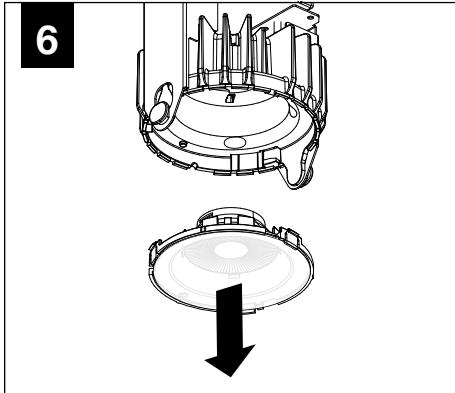
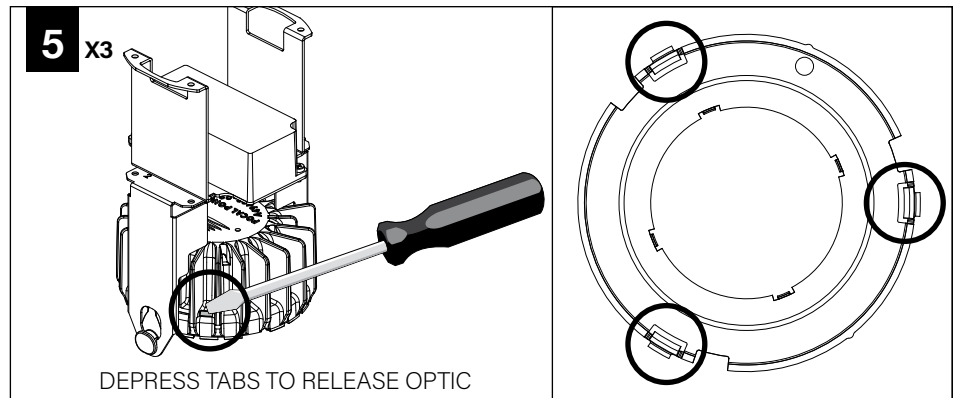
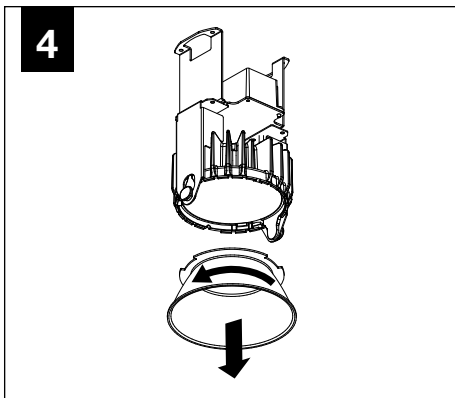

EMERGENCY



SEE BATTERY MANUFACTURER
INSTRUCTIONS

EMERGENCY MAXIMUM MOUNTING HEIGHT:

CD & WH REFLECTORS - 17.1'

WD & BK REFLECTORS - 15.1'

1

HARDWARE
BY OTHERS

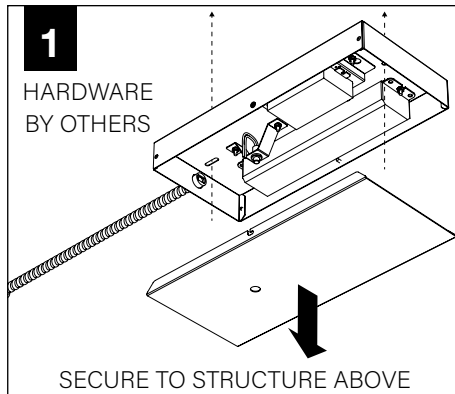

SECURE TO STRUCTURE ABOVE

2

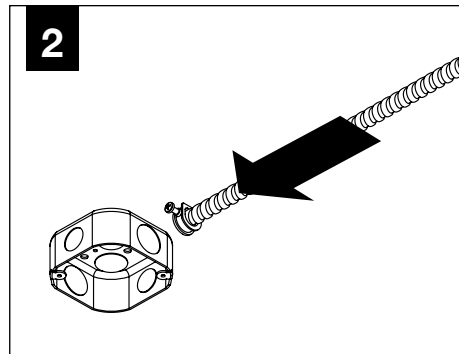

MAKE ELECTRICAL CONNECTION

3

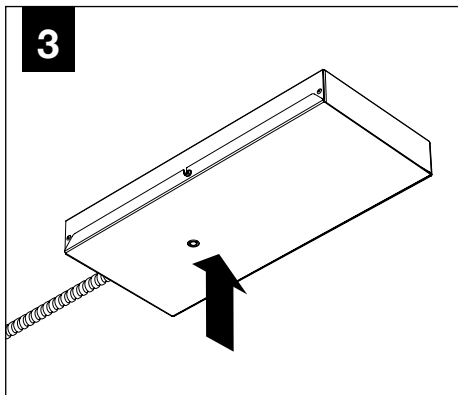

4

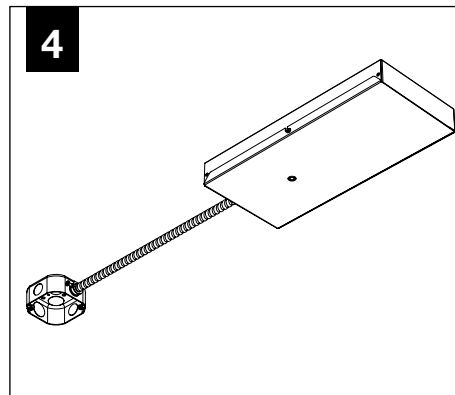

PROCEED TO
LUMINAIRE INSTALLATION