

ID+ 3.5" Pure Cylinder - Surface Mount

FLCY3N-RD-4H | FLCY3N-RD-7H - Mini Power Canopy



FOCAL POINT®

BEFORE YOU BEGIN

- Luminaires must be installed by a qualified electrician (check with local and national codes for proper installation).
- To prevent electrical shock, disconnect electrical supply before installation or servicing.
- Contractor is responsible for adequately reinforcing walls and/or ceilings to support fixture weight.
- Focal Point, LLC accepts no responsibility for inadequately reinforced walls and/or ceilings.
- The information contained in this drawing is the sole property of Focal Point, LLC. Any reproduction in part or whole without the written permission of Focal Point, LLC is prohibited.

COMPONENT KEY

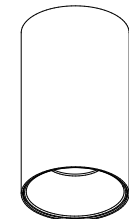

7" HOUSING HEIGHT

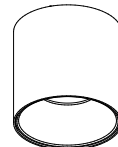

4" HOUSING HEIGHT

MINI POWER CANOPY

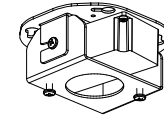

J-BOX MOUNTING BRACKET / DRIVER CARRIAGE

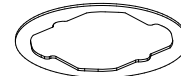

FINISHING RING

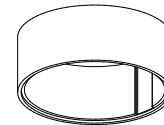

MINI POWER CANOPY

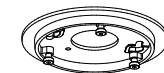

MOUNTING BRACKET

INSTRUCTION KEY



ATTENTION



SEE ADDITIONAL INSTRUCTIONS



POWER OFF



POWER ON



LUMINAIRE MUST BE INSTALLED PRIOR TO DRYWALL CEILING. ALL GRID LUMINAIRE MUST BE SECURED TO STRUCTURE ABOVE.

4" OCTAGONAL J-BOX REQUIRED

J-BOX BY OTHERS

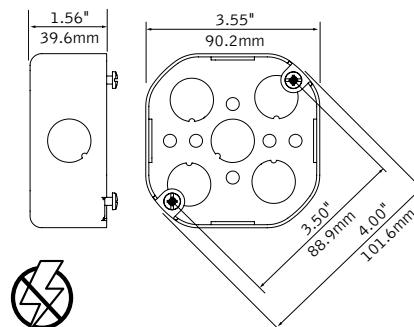

EMERGENCY



PRIOR TO LUMINAIRE INSTALLATION, SEE **PAGE 4** FOR EMERGENCY INSTALLATION INSTRUCTIONS.

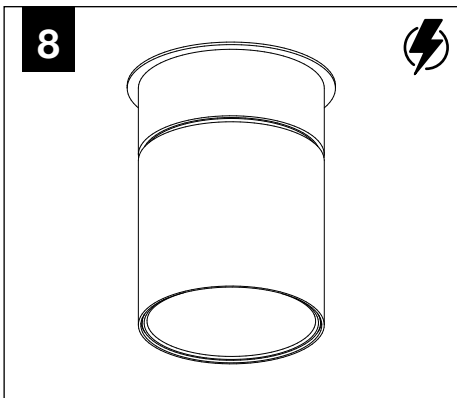
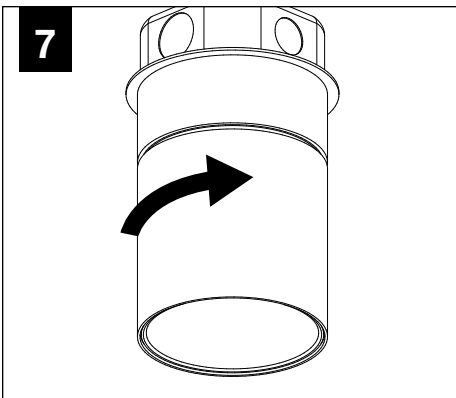
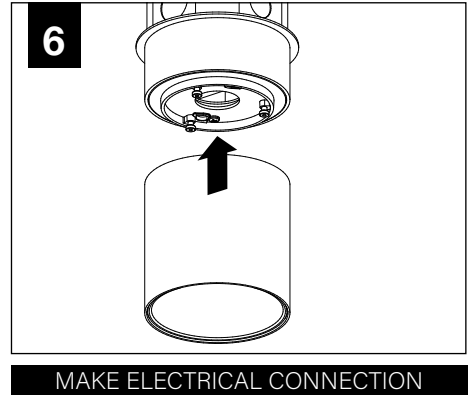
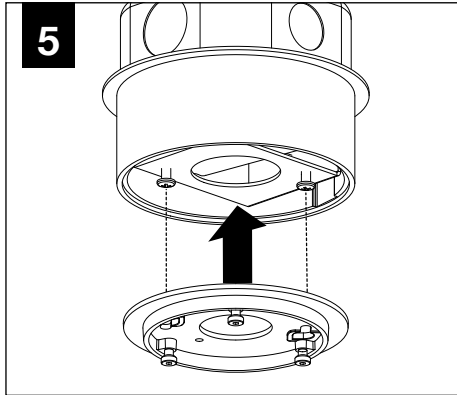
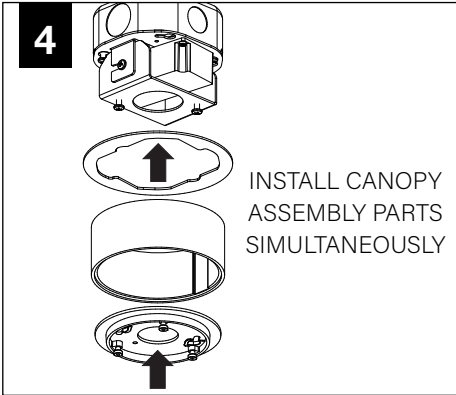
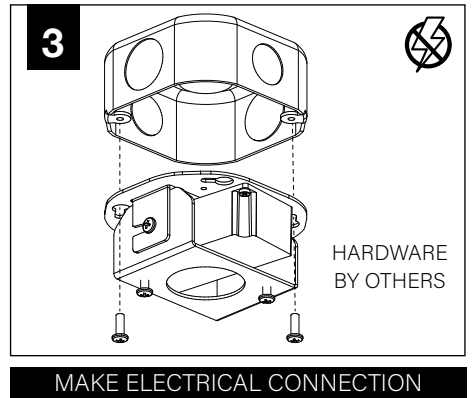
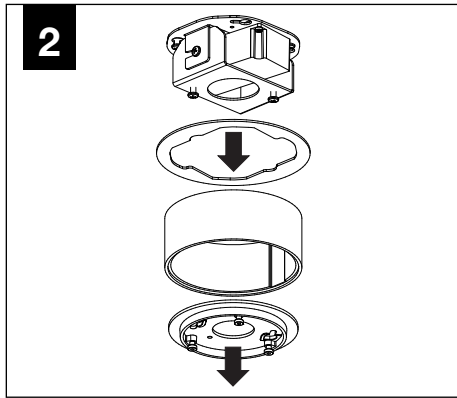
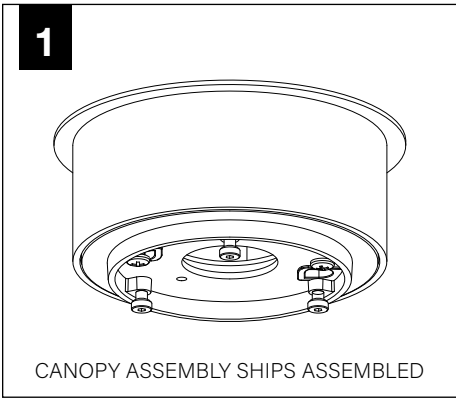

DRIVER SERVICE

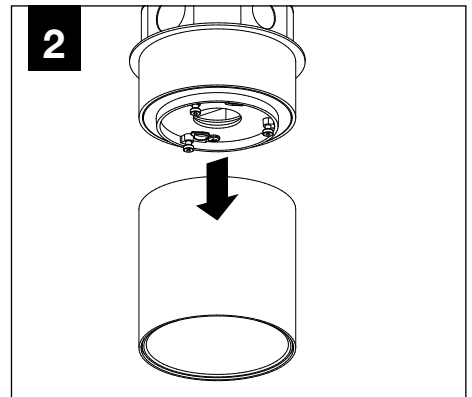
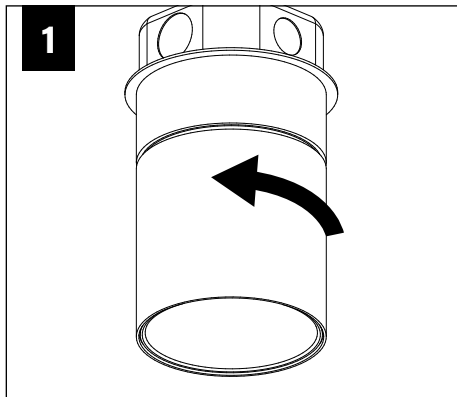
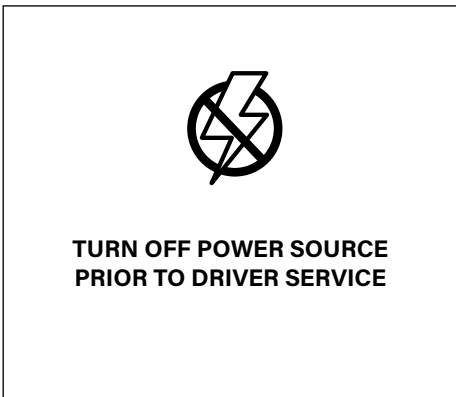

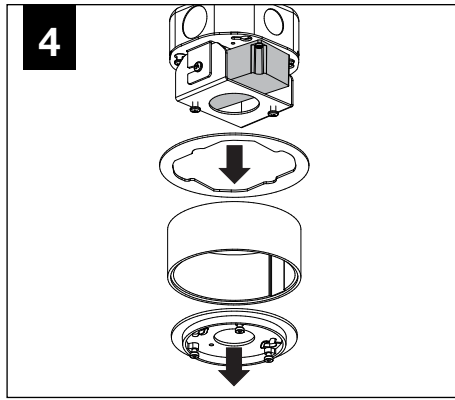
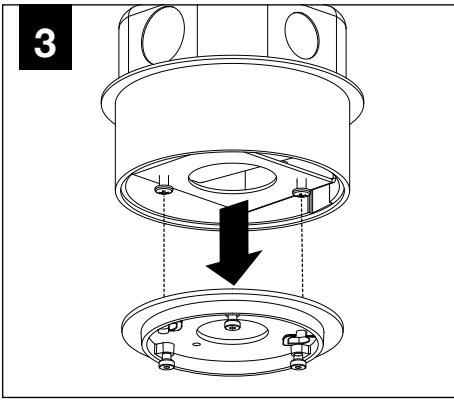

OPTIC SERVICE

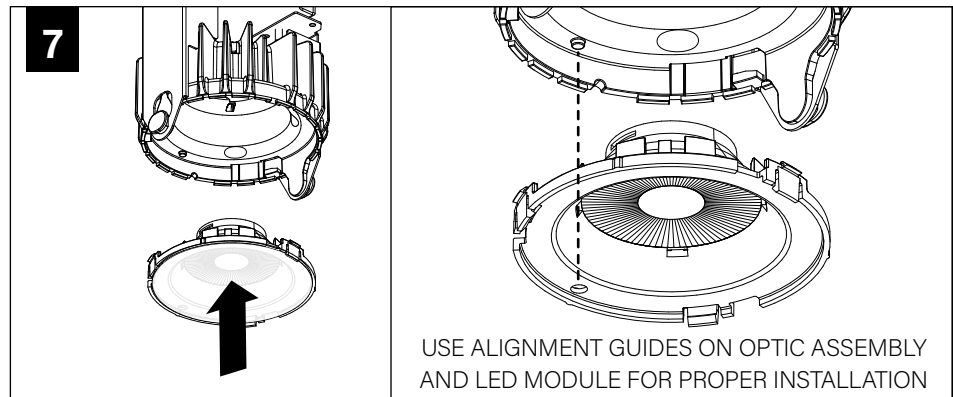
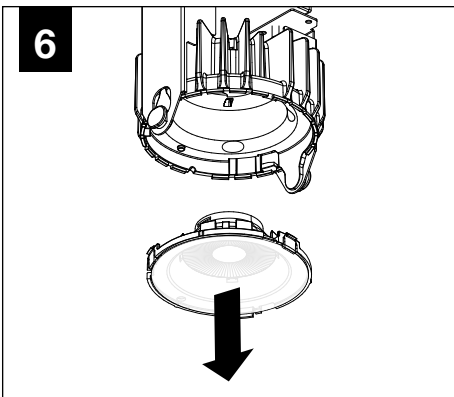
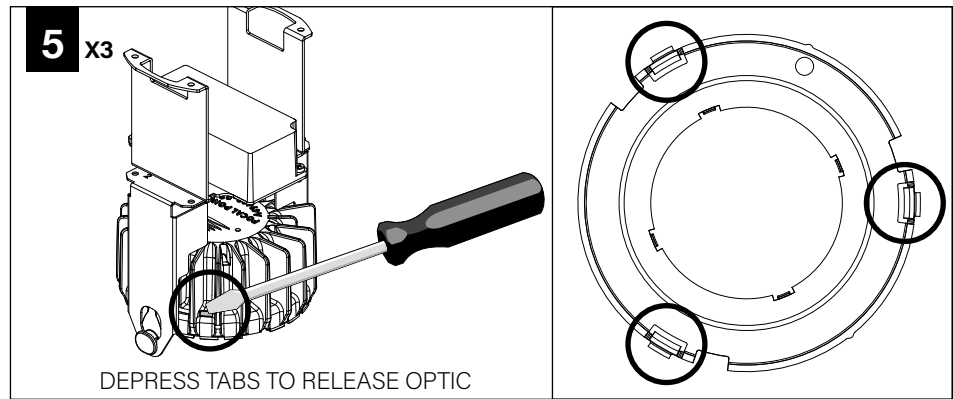
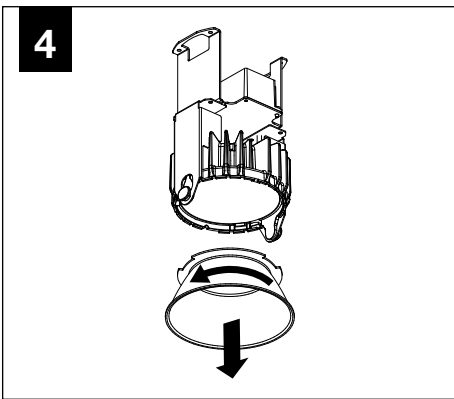
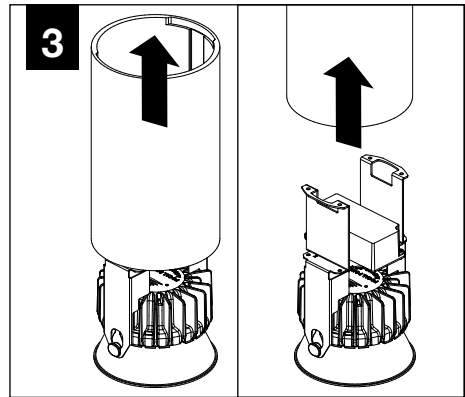
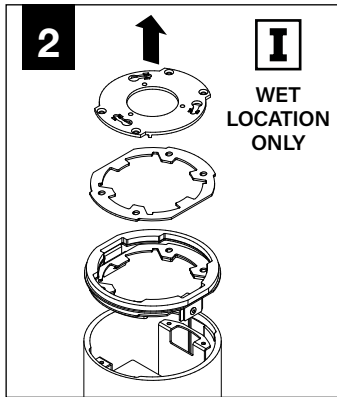
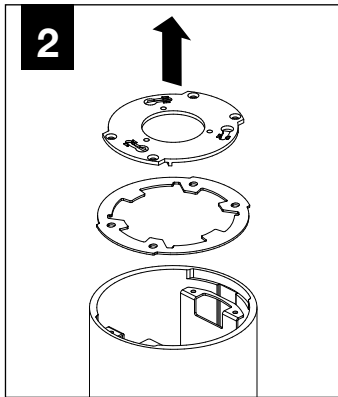
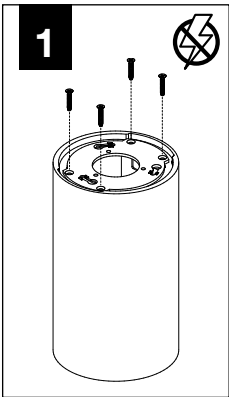

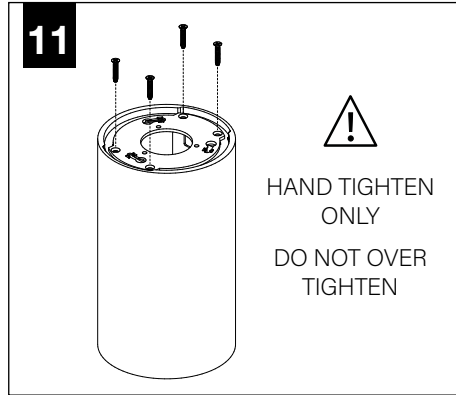
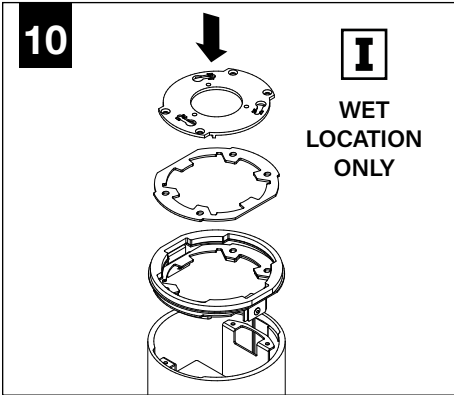
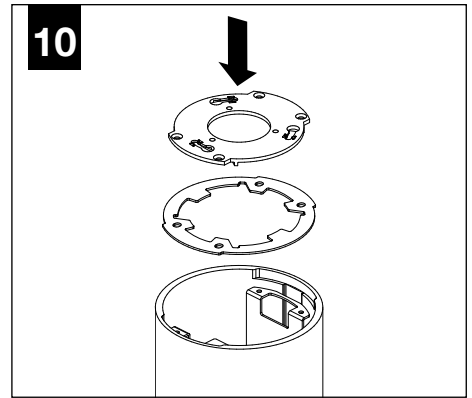
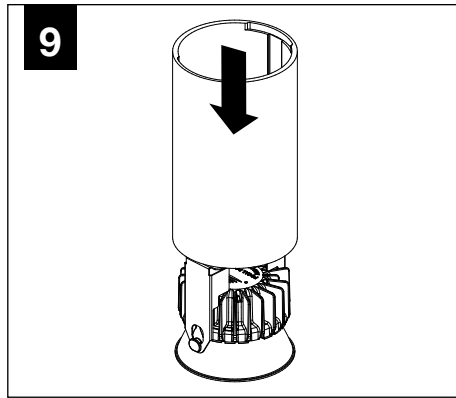
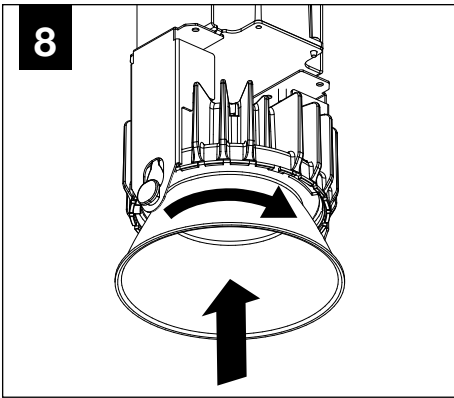

EMERGENCY

