

# ID+ Cylinder Pendant

FLCY3 | FLCY4



FOCAL POINT®



## BEFORE YOU BEGIN

- Luminaires must be installed by a qualified electrician (check with local and national codes for proper installation).
- To prevent electrical shock, disconnect electrical supply before installation or servicing.
- Contractor is responsible for adequately reinforcing walls and/or ceilings to support fixture weight.
- Focal Point, LLC accepts no responsibility for inadequately reinforced walls and/or ceilings.
- The information contained in this drawing is the sole property of Focal Point, LLC. Any reproduction in part or whole without the written permission of Focal Point, LLC is prohibited.

## INSTRUCTION KEY



ATTENTION



SEE ADDITIONAL INSTRUCTIONS



POWER OFF



POWER ON

## COMPONENT KEY

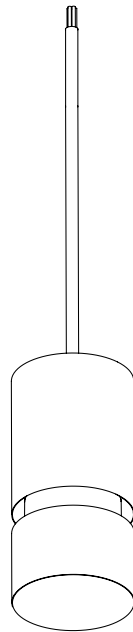

### SHALLOW CANOPY

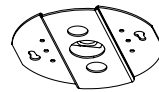

J-BOX  
MOUNTING BRACKET

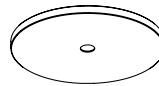

SHALLOW CANOPY

### POWER CANOPY

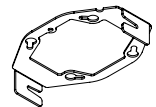

J-BOX  
MOUNTING BRACKET

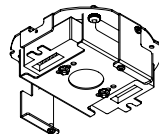

DRIVER  
CARRIAGE

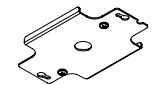

POWER CORD  
MOUNTING  
BRACKET

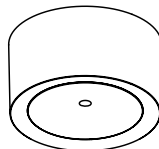

POWER  
CANOPY

### SWIVEL STEM MOUNT

Shipped Assembled

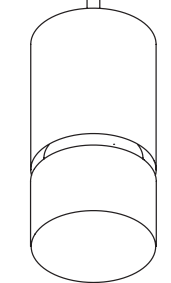

## INSTALL 4" OCTAGONAL J-BOX (BY OTHERS)

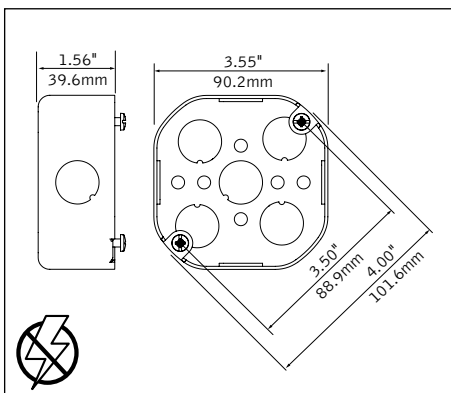

## EMERGENCY



PRIOR TO LUMINAIRE INSTALLATION,  
SEE **PAGE 6** FOR EMERGENCY  
INSTALLATION INSTRUCTIONS.

## MOUNTING TYPE



PROCEED TO  
LUMINAIRE INSTALLATION  
**SHALLOW CANOPY, PAGE 2**  
**POWER CANOPY, PAGE 3**  
**SWIVEL STEM, PAGE 4**

## SHALLOW CANOPY INSTALLATION

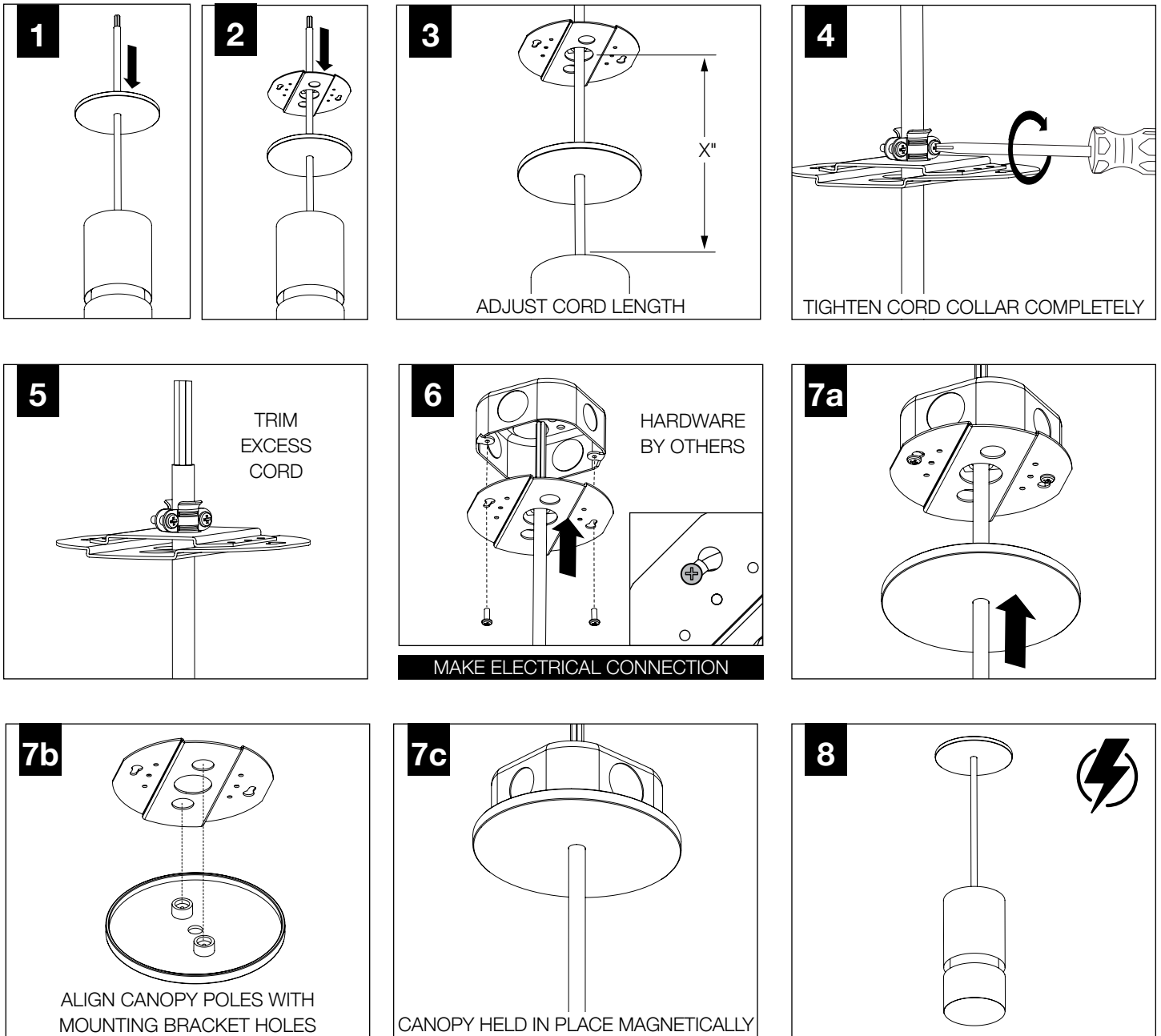

## SHALLOW CANOPY DRIVER SERVICE

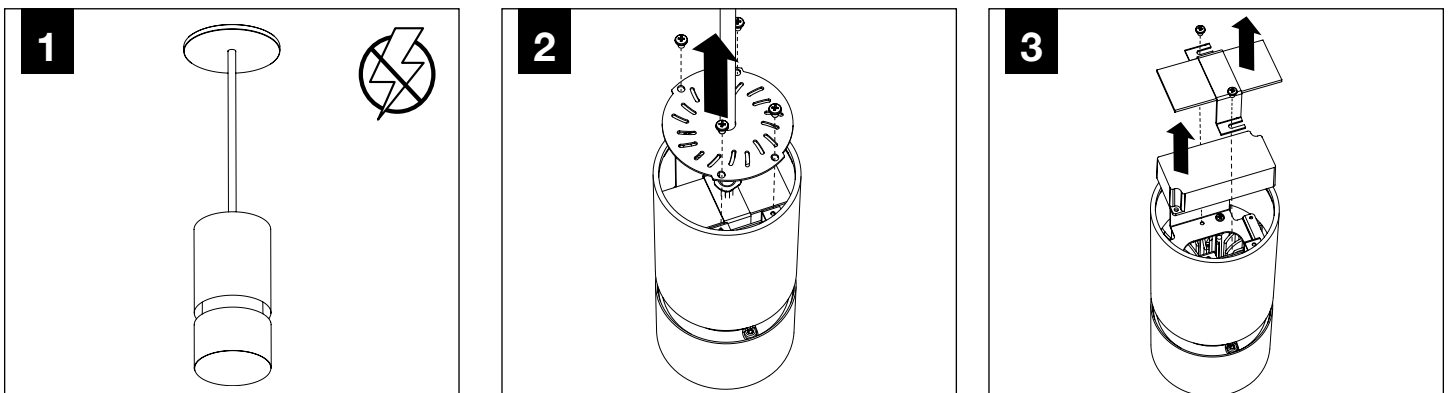

# POWER CANOPY INSTALLATION

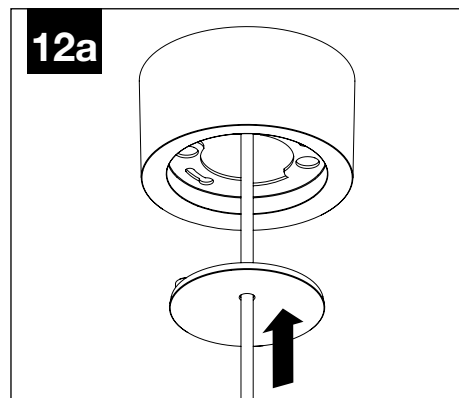
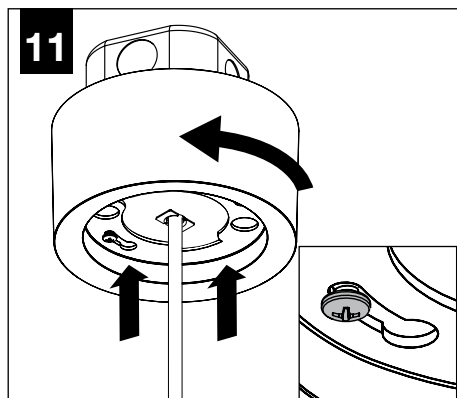
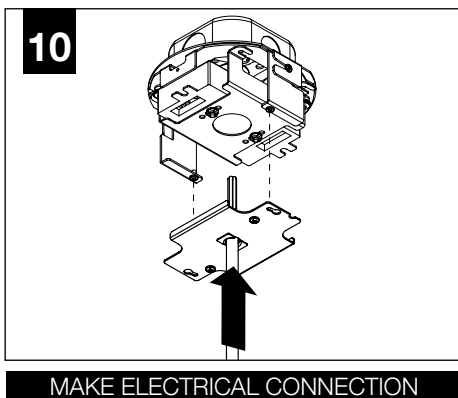
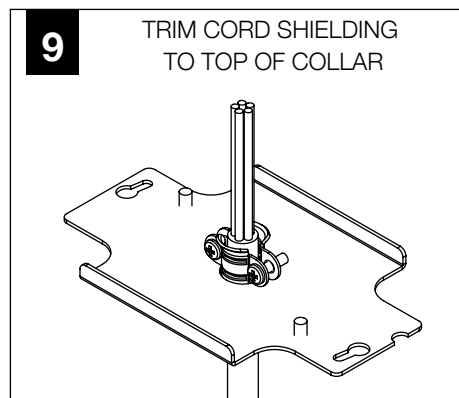
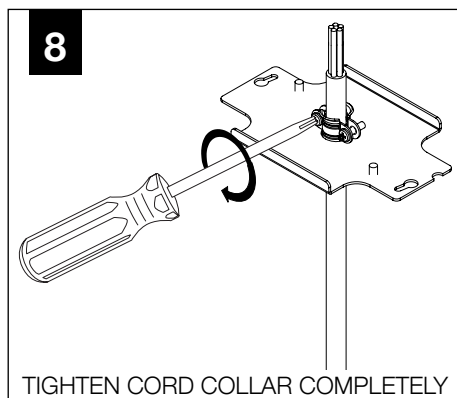
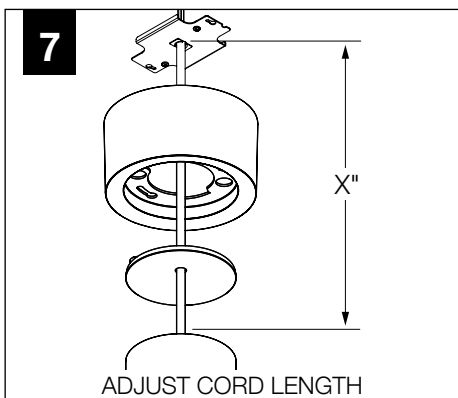
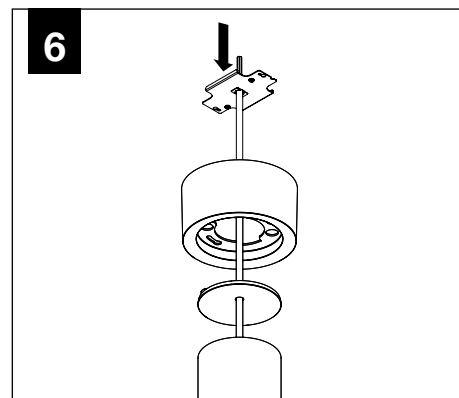
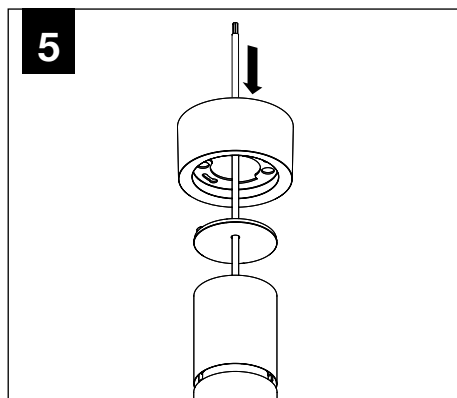
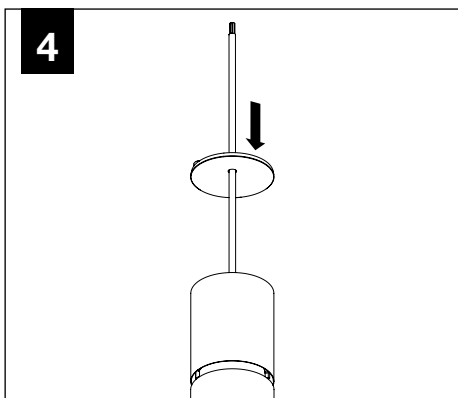
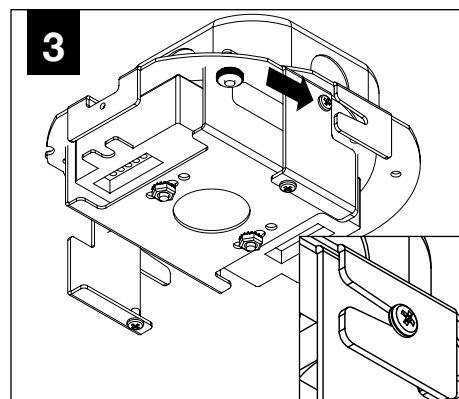
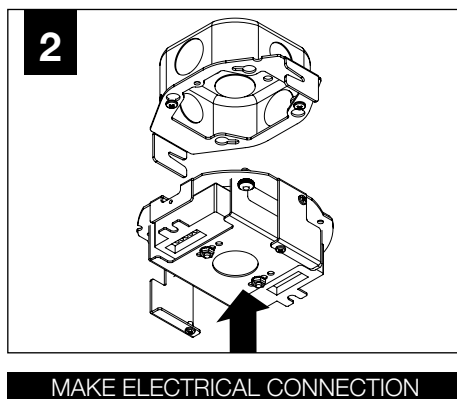
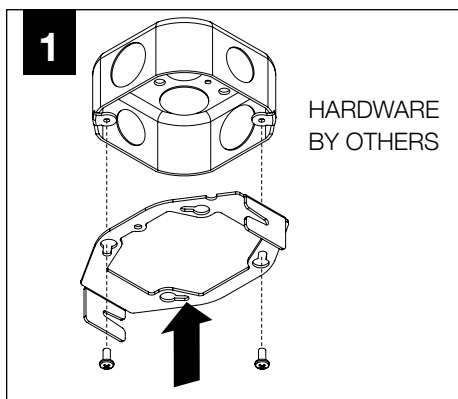

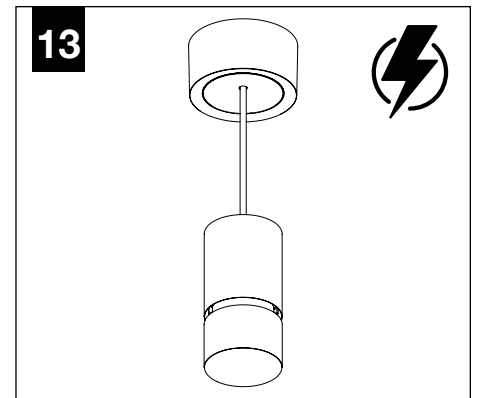
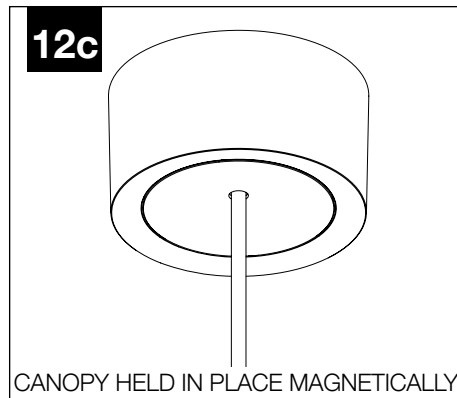
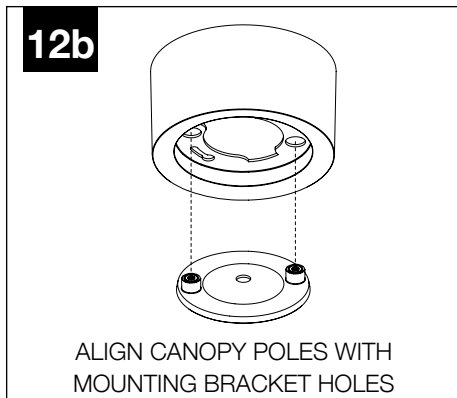

## POWER CANOPY DRIVER SERVICE

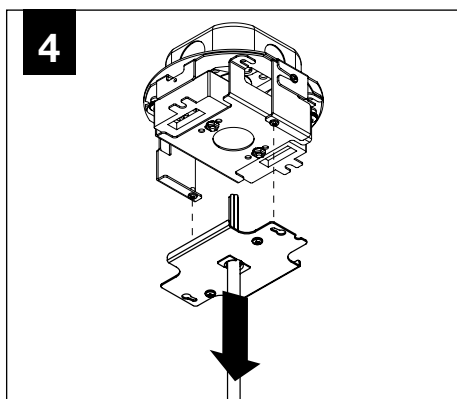
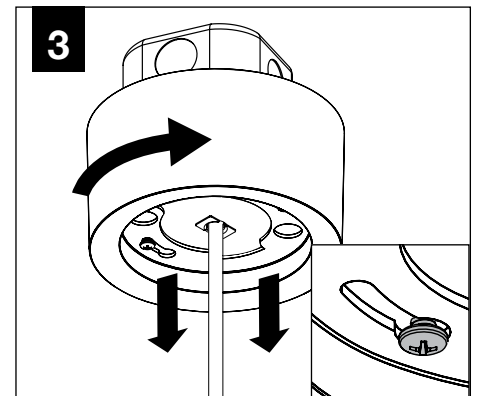
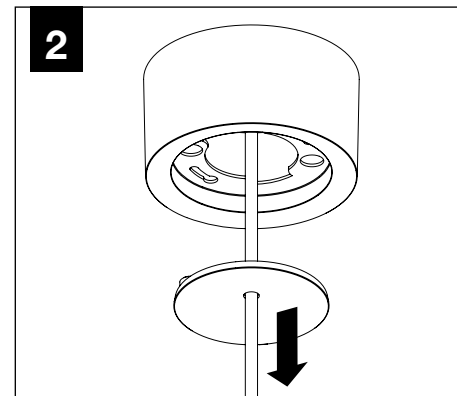
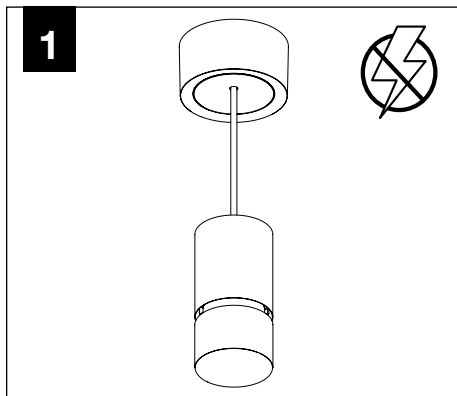

## SWIVEL STEM INSTALLATION

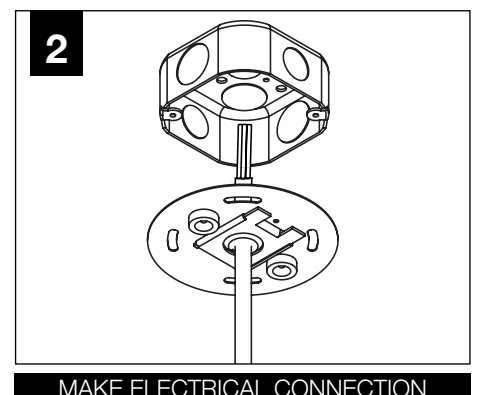
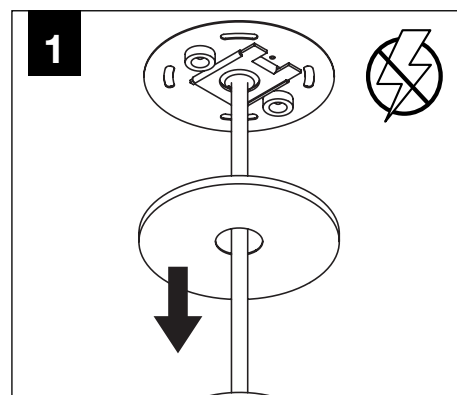
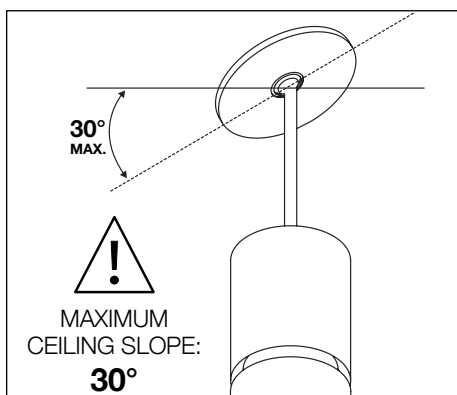

MAKE ELECTRICAL CONNECTION

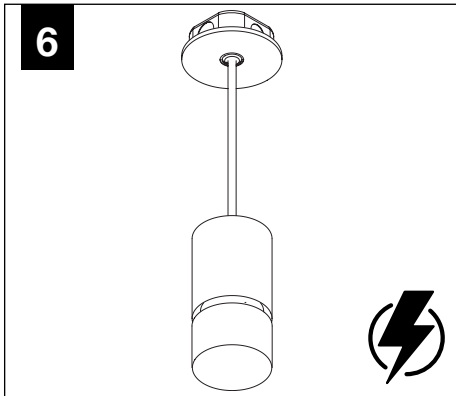
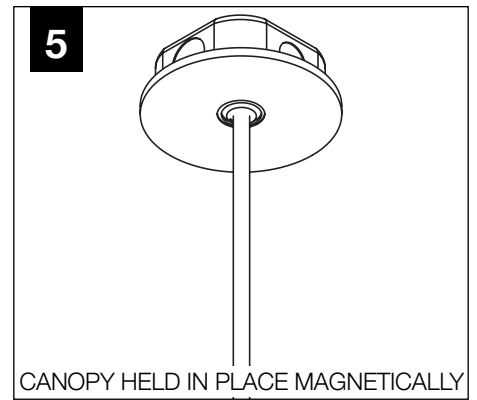
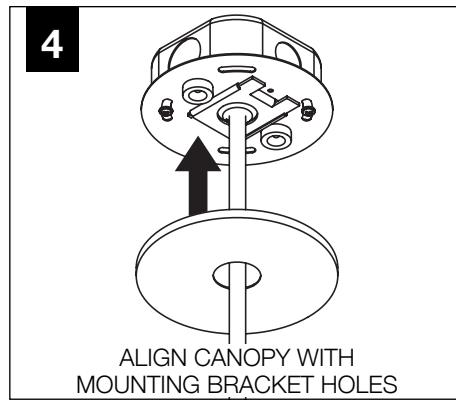
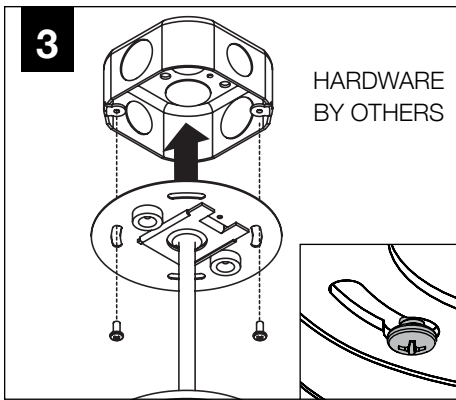

## OPTIC SERVICE

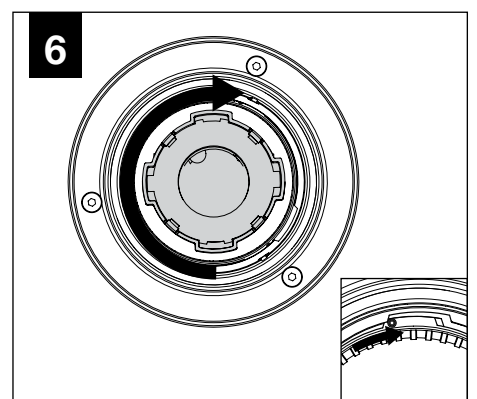
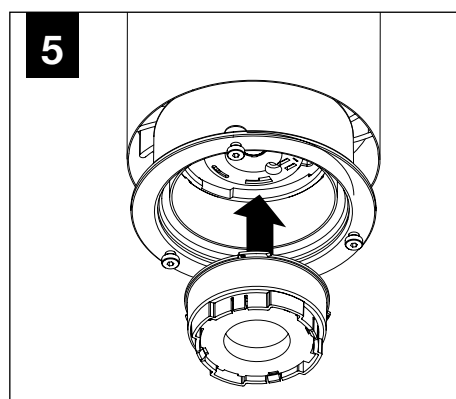
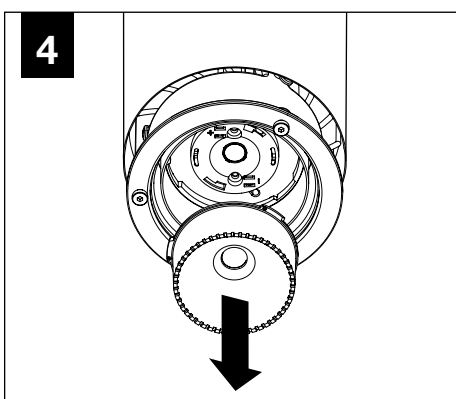
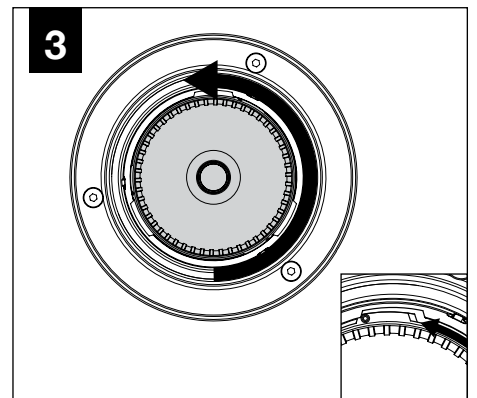
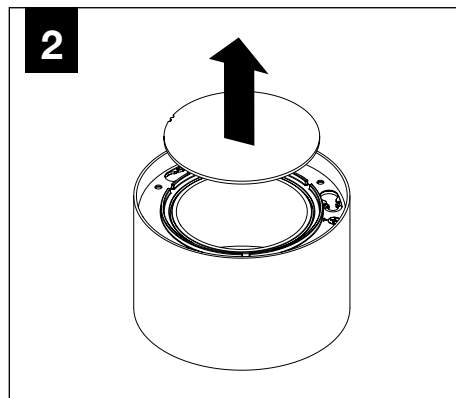
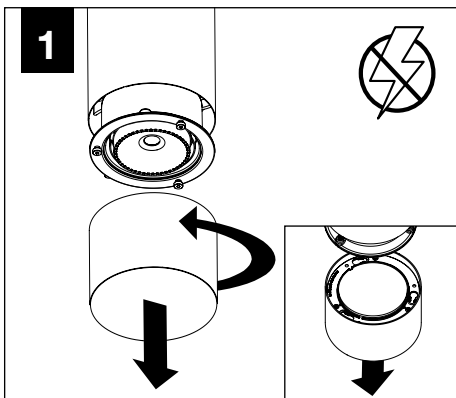

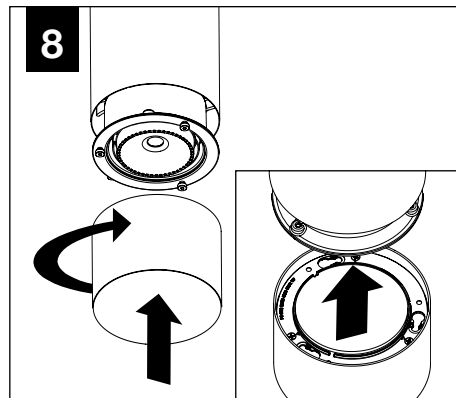
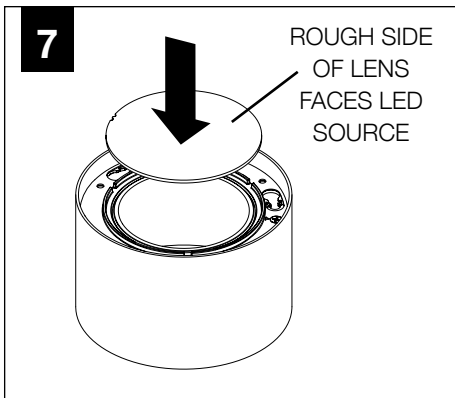

## EMERGENCY



SEE BATTERY MANUFACTURER  
INSTRUCTIONS

**EMERGENCY MAXIMUM MOUNTING HEIGHT:**

**3.5" CYLINDERS - 16.98'**

**4.5" CYLINDERS - 16'**

**1**

HARDWARE  
BY OTHERS

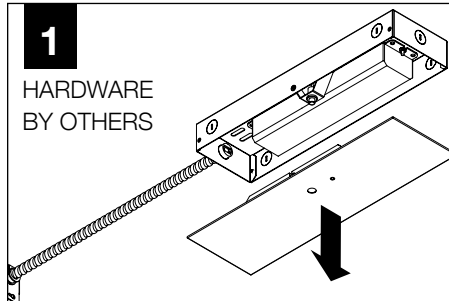

SECURE TO STRUCTURE ABOVE

**2**

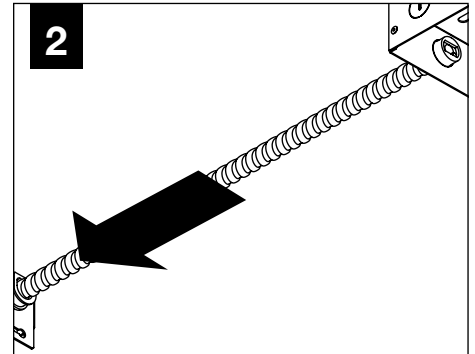

MAKE ELECTRICAL CONNECTION

**3**

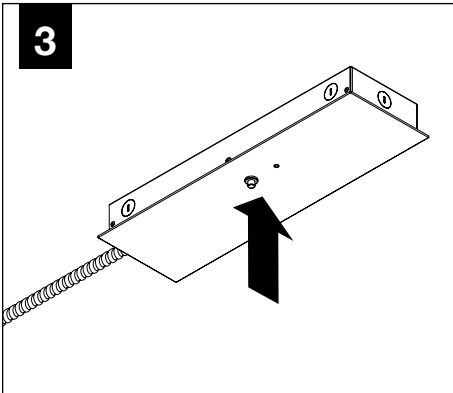

**4**

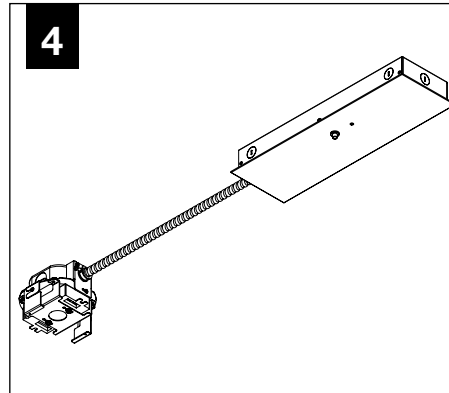

PROCEED TO  
LUMINAIRE INSTALLATION  
**SHALLOW CANOPY, PAGE 2**  
**POWER CANOPY, PAGE 3**  
**SWIVEL STEM, PAGE 4**