

# ID+ 2" Cylinder

LED SURFACE MOUNT WITH DECORATIVE REVEAL

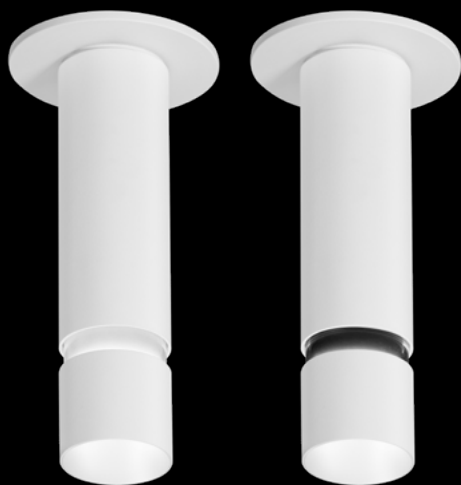

## DIMENSIONAL DATA (continued on page 3)

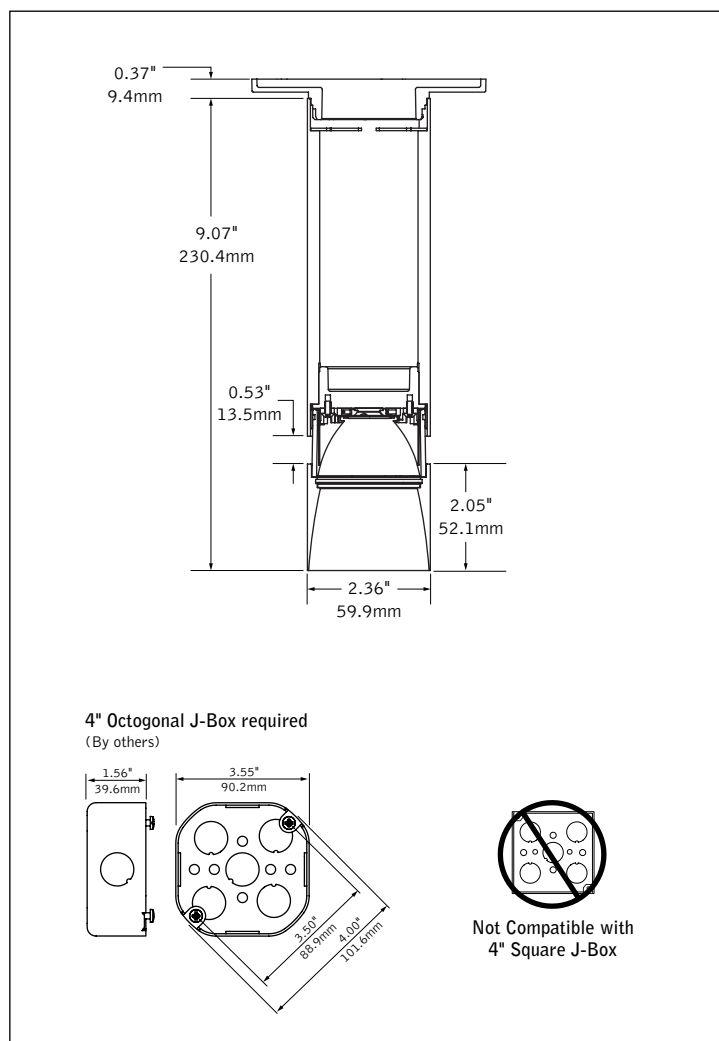

## FEATURES

2" surface mount cylinder with decorative reveal.

Decorative reveal available with or without glow.

Black, white and custom color option for glowing reveal.

One-piece die-cast reflector with a knife edge for a modern aesthetic.

Reflectors with 50° cut-off or super short cone with Solite lens.

Wet location for indoor applications.

Warm Dim: Lighting that enhances spaces with a warm glow, reminiscent of incandescent or halogen light sources.

PoE compatible: Integrates with Power over Ethernet lighting systems via standard, low-voltage wires.

## DISTRIBUTIONS

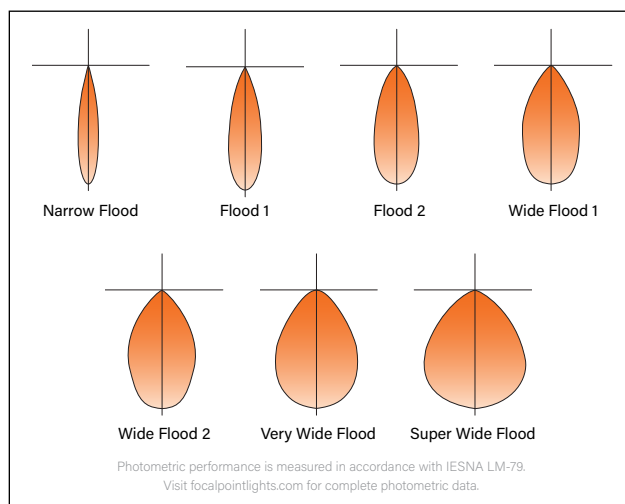

fixture:

project:

SPECIFICATIONS

LED System

Proprietary LED module with single light emitting source. May be specified in 2700K, 3000K, 3500K or 4000K in CRI>80, CRI>90 or CRI 97. 3500K and 4000K with CRI of 90 have a cyanosis observation index (COI) of 3.3 or less. Color accuracy within 2 SDCM; Warm Dim 3-5 SDCM. Aluminum heat sink provides appropriate thermal management.

Construction

Upper housing is extruded aluminum. Lower reflector is die-cast aluminum. Twist & lock construction leaves no visible fasteners within the knife edge trim. Fixture will not exceed 5 lb.

Optics

Beam spreads achieved with optics that may be easily changed in field without the need of tools.

Optic	Distribution Beam Spread   Spacing Criteria						
	NFL	FL1	FL2	WFL1	WFL2	VWFL	SWFL
DNT	<div>19.4° 0.34</div>	<div>29.9° 0.52</div>	<div>42.1° 0.68</div>	<div>55.9° 0.84</div>	<div>65.8° 0.94</div>	—	—
DSS	<div>21.2° 0.36</div>	<div>29.7° 0.50</div>	<div>39.2° 0.64</div>	<div>53.1° 0.80</div>	<div>63.9° 0.92</div>	<div>75.9° 1.06</div>	<div>89.5° 1.24</div>

Electrical

Choice of constant current dimming drivers. Power factor > .9 typical. PoE compatible: Integrates with Power over Ethernet lighting systems via standard, low-voltage wires. Integral Driver not Right Light as standard, consult factory.

Emergency

Emergency output —7W for 90 minutes. Maximum mounting height: 14.5 ft. J-box cannot be recessed above the ceiling with Emergency Battery.

Labels

UL and cUL listed. Suitable for Dry or Damp Locations, indoor use only. Wet Location standard, indoor use only.

Finish

Polyester powder coat applied over a multi-stage pre-treatment.

Lumen Maintenance

Reported: L70 > 55,000 hours  
L80 > 55,000 hours

Calculated: L70 > 200,000 hours  
L80 > 124,000 hours

(Derived from EPA TM-21 calculator. Based on typical conditions, consult factory for additional data.)

Reliability

At Focal Point, our products are designed to stand the test of time. Each luminaire is engineered using superior components, manufactured with the utmost care and rigorously tested. Contact us for reliability data.

Warranty

LED system rated for operation in ambient environments up to 25°C. 5 year limited warranty.

PERFORMANCE TABLE

Lumen Output	Delivered Lumens	System Watts	LPW
700L	727	9.0	80.8
 700L	736	14.5	51.0
900L	934	11.8	79.2
1100L	1142	14.5	78.8
1300L	1350	17.4	77.6

3500K, 80CRI, Clear Diffuse, DNT, Flood 2 Distribution. Warm Dim based on 3000 - 1800K, 90 CRI. Lumen output may vary +/- 5%. Actual wattage may vary +/- 5%.

ORDERING

Luminaire Series	FLCY2	FLCY2
ID+ 2" Round Cylinder	FLCY2	
Trim Type		RD
Round	RD	
Decorative Reveal		
White Non-Glow Reveal	WHR	
Black Non-Glow Reveal	BKR	
White Glowing Reveal	WHG	
Black Glowing Reveal	BKG	
Clear Diffuse Glowing Reveal	CDG	
Warm Diffuse Glowing Reveal	WDG	
Custom Color Glowing Reveal (Specify your RAL color value. Extended lead time consult factory.)	RAL_ _ _ _	
Lumen Output		
700 Lumens	700L	
900 Lumens	900L	
1100 Lumens	1100L	
1300 Lumens	1300L	
Color Temperature		
(Add 9 for 90 CRI or H for 97 CRI. Leave blank for 80 CRI. Examples: 2700K, 97 CRI = H27K. 2700K, 80 CRI = 27K.)		
2700K, 80/90/97+ CRI _27K	_27K	
3000K, 80/90/97+ CRI _30K	_30K	
3500K, 80/90/97+ CRI _35K	_35K	
4000K, 80/90/97+ CRI _40K	_40K	
Warm Dim: 2700-1800K, 90+ CRI*	92718W	
Warm Dim: 3000-1800K, 90+ CRI*	93018W	
*(700L only. Not available with EMR or LV.)		
Circuit		1C
Single Circuit	1C	
Voltage		
120 Volt	120	
277 Volt	277	
Low Voltage	LV	
Canopy Configuration		
Shallow Canopy, Integral Driver	SC	
Decorative Shallow Canopy, Integral Driver	DSC	
Control System & Dimming Level		
0-10V - 5% Dimming (120V only)	LD5	
0-10V - 10% Dimming (277V only)	LD1	
Low Voltage, PoE compatible (No driver. Not available with EMR or Warm Dimming. LV voltage only.)	LVN	
Phase Dimming (120V only. Consult factory for recommended dimmers.)	LFP	
Mounting		SM
Surface Mount	SM	
Optic		
50° Cut-off Cone (Not available with VWFL or SWFL distribution.)	DNT	
Super Short Cone with Solite Lens	DSS	
Distribution		
Narrow Flood	NFL	
Flood 1	FL1	
Flood 2	FL2	
Wide Flood 1	WFL1	
Wide Flood 2	WFL2	
Very Wide Flood (DSS optic only)	VWFL	
Super Wide Flood (DSS optic only)	SWFL	
Factory Options		
Emergency Battery (Not available with Warm Dim or Low Voltage. J-box cannot be recessed above the ceiling. Remote test switch.)	EMR	
Reflector Color		
Clear Diffuse	CD	
Warm Diffuse	WD	
Luminaire Finish		
(Cylinder and canopy finish match)		
Black	BK	
White	WH	

**DISTRIBUTION KITS** INCLUDE AN  
OPTIC AND REFLECTOR ASSEMBLY.

**BOTH ITEMS MUST BE REPLACED**  
TO ACHIEVE SPECIFIED  
DISTRIBUTION.

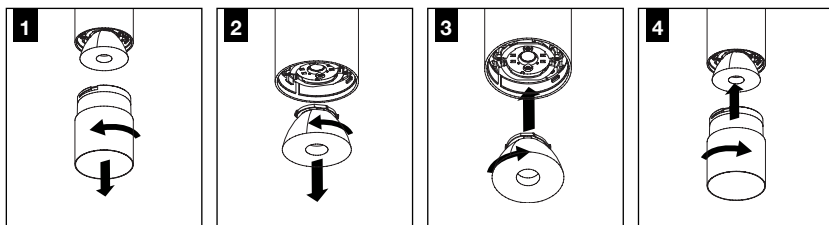
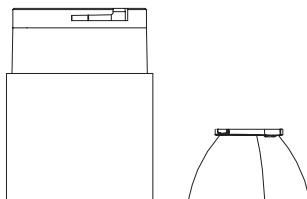

## ACCESSORIES ORDERING

**Luminaire Series**  
ID+ 2" Round Cylinder KIT-FLCY2

**Trim Type**  
Round RD

**Decorative Reveal**  
(Non-Glow may not be changed to Glowing Reveal in the field)

White Non-Glow Reveal WHR  
Black Non-Glow Reveal BKR  
Any Glowing Reveal GLO

**Optic**  
50° Cut-off Cone DNT  
(Not available with VWFL or SWFL distribution.)

Super Short Cone with Solite Lens DSS  
Wall Wash\* WW

**Distribution**  
(For Wall Wash Optic leave Distribution blank)

Narrow Flood NFL  
Flood 1 FL1  
Flood 2 FL2  
Wide Flood 1 WFL1  
Wide Flood 2 WFL2  
Very Wide Flood (DSS optic only) VWFL  
Super Wide Flood (DSS optic only) SWFL

**Reflector Color**  
Clear Diffuse CD  
Warm Diffuse WD

**Luminaire Finish**  
Black BK  
White WH

**KIT-FLCY2**

**RD**

\*Changing to a Wall wash from a Downlight will result in a step lower nominal lumen than originally specified. Please use lumen multiplier formula to determine delivered lumen output. [Download the dedicated Wall Wash cut sheet.](#)

## DIMENSIONAL DATA CONTINUED

### SC - Shallow Canopy, Integral Driver

Indicates Driver Location

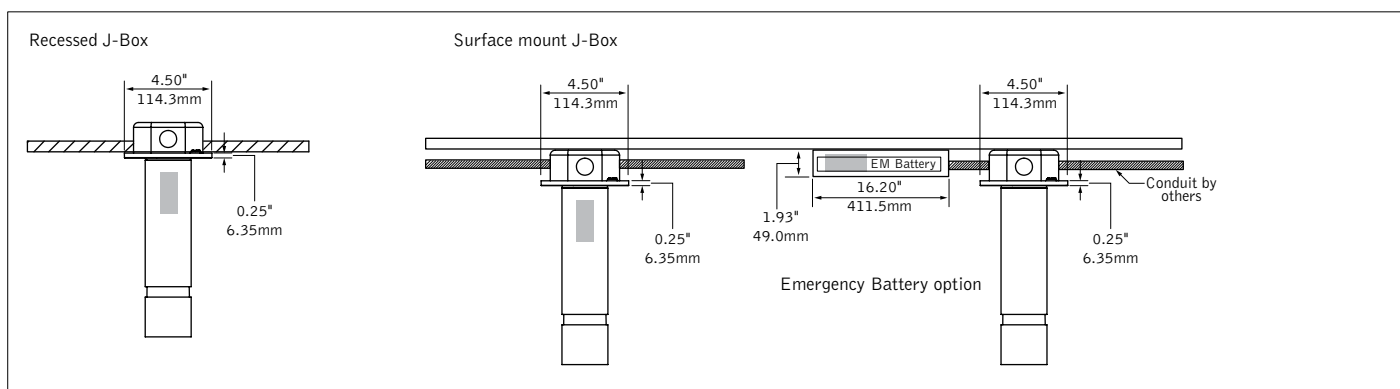

### DSC - Decorative Shallow Canopy, Integral Driver

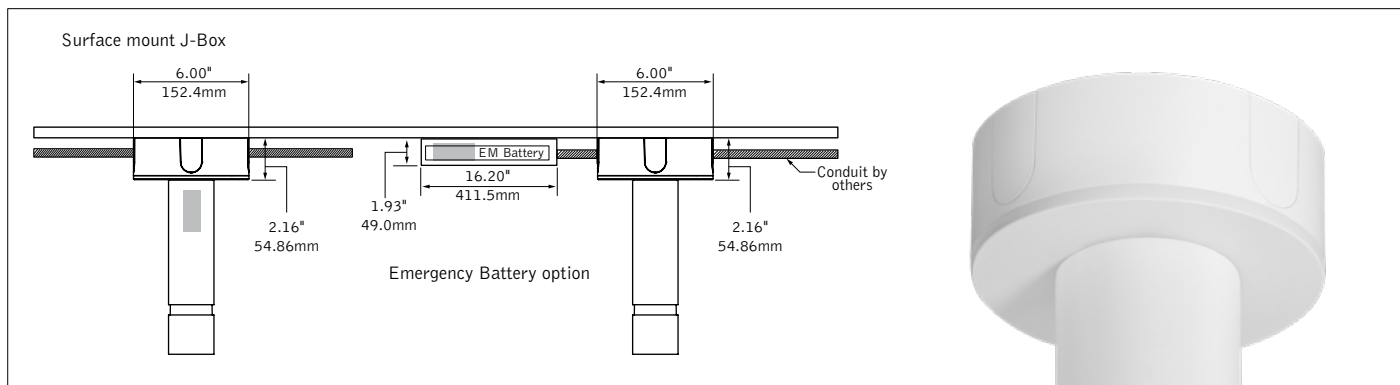

2" CYLINDER LUMEN MULTIPLIER TABLE

Color Temperature & CRI

Trim Type	Optic	Color Temperature	Multiplier
Round [RD]	ALL	2700K, 80+ CRI [27K]	0.92
		2700K, 90+ CRI [927K]	0.79
		2700K, 97+ CRI [H27K]	0.67
		3000K, 80+ CRI [30K]	0.98
		3000K, 90+ CRI [930K]	0.83
		3000K, 97+ CRI [H30K]	0.72
		3500K, 80+ CRI [35K]	1.00
		3500K, 90+ CRI [935K]	0.82
		3500K, 97+ CRI [H35K]	0.73
		4000K, 80+ CRI [40K]	1.01
		4000K, 90+ CRI [940K]	0.84
		4000K, 97+ CRI [H40K]	0.76
		2700-1800K, 90+ CRI [92718W]	1.00
		3000-1800K, 90+ CRI [93018W]	1.05

Optic & Distribution

Trim Type	Optic	Distribution	Multiplier
Round [RD]	Tall Cone, 50° cut-off [DNT]	Narrow Flood (19.4°) [NFL]	1.27
		Flood 1 (29.9°) [FL1]	1.19
		Flood 2 (42.1°) [FL2]	1.04
		Wide Flood 1 (55.9°) [WFL1]	0.96
		Wide Flood 2 (65.8°) [WFL2]	0.89
	Super Short Cone with Solite lens [DSS]	Narrow Flood (21.2°) [NFL]	1.08
		Flood 1 (29.7°) [FL1]	0.96
		Flood 2 (39.2°) [FL2]	0.94
		Wide Flood 1 (53.1°) [WFL1]	0.89
		Wide Flood 2 (63.9°) [WFL2]	0.88
		Very Wide Flood (75.9°) [VWFL]	0.85
		Super Wide Flood (89.5°) [SWFL]	0.75

Color

Trim Type	Optic	Color	Multiplier
ALL	Tall Cone, 50° cut-off [DNT]	Clear Diffuse [CD]	1.00
		Warm Diffuse [WD]	1.00
	Super Short Cone with Solite lens [DSS]	Clear Diffuse [CD]	1.00
		Warm Diffuse [WD]	1.00

Multiplier tables are provided to aid with estimation of lumen levels across options. Apply multipliers against ordered Lumen Output to estimate Delivered Lumens. Refer to IES files for most accurate photometric information.

How To Use Lumen Multipliers

Formula: (Lumen Output Value) x (Color Temperature & CRI) x (Optic & Distribution) x (Color)

Example: FLCY2-RD-1100L-935K-DNT-FL1-WD  
(1100) x (0.82) x (1.19) x (1.00) ≈ 1073.4 lm (estimated delivered lumens)