

ID+ 2" Cylinder

LED SURFACE MOUNT WITH DECORATIVE REVEAL

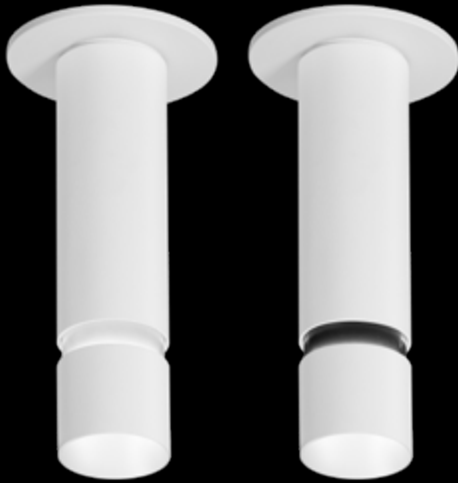

DIMENSIONAL DATA (continued on page 3)

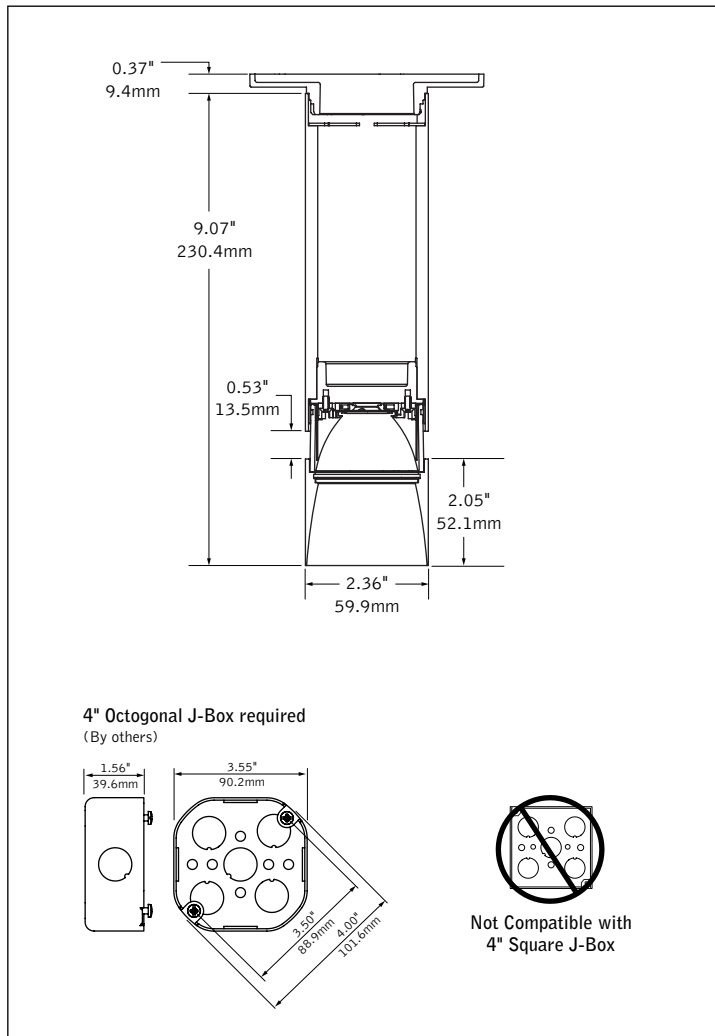

FEATURES

2" surface mount cylinder with decorative reveal.

Decorative reveal available with or without glow.

Black, white and custom color option for glowing reveal.

One-piece die-cast reflector with a knife edge for a modern aesthetic.

Reflectors with 50° cut-off or super short cone with Solite lens.

Wet location for indoor applications.

Warm Dim: Lighting that enhances spaces with a warm glow, reminiscent of incandescent or halogen light sources.

PoE compatible: Integrates with Power over Ethernet lighting systems via standard, low-voltage wires.

DISTRIBUTIONS

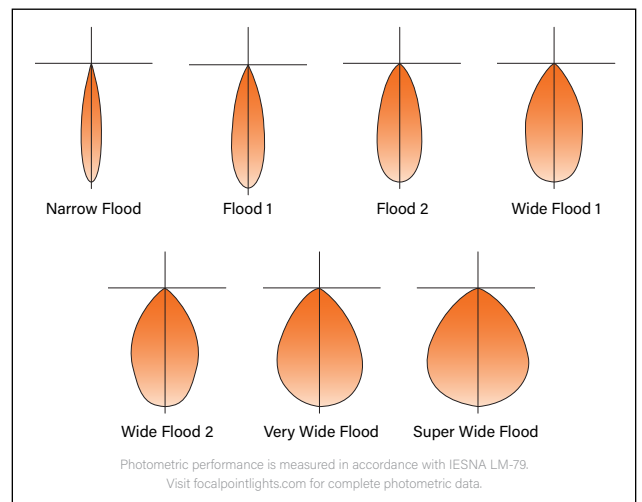

fixture:

project:

SPECIFICATIONS

LED System

Proprietary LED module with single light emitting source. May be specified in 2700K, 3000K, 3500K or 4000K in CRI>80, CRI>90 or CRI 97. 3500K and 4000K with CRI of 90 have a cyanosis observation index (COI) of 3.3 or less. Color accuracy within 2 SDCM; Warm Dim 3-5 SDCM. Aluminum heat sink provides appropriate thermal management.

Construction

Upper housing is extruded aluminum. Lower reflector is die-cast aluminum. Twist & lock construction leaves no visible fasteners within the knife edge trim. Fixture will not exceed 5 lb.

Optics

Beam spreads achieved with optics that may be easily changed in field without the need of tools.

| Optic | Distribution Beam Spread Spacing Criteria | | | | | | |
|-------|---|---------------------------|---------------------------|---------------------------|---------------------------|---------------------------|---------------------------|
| | NFL | FL1 | FL2 | WFL1 | WFL2 | VWFL | SWFL |
| DNT | <div>19.4° 0.34</div> | <div>29.9° 0.52</div> | <div>42.1° 0.68</div> | <div>55.9° 0.84</div> | <div>65.8° 0.94</div> | — | — |
| DSS | <div>21.2° 0.36</div> | <div>29.7° 0.50</div> | <div>39.2° 0.64</div> | <div>53.1° 0.80</div> | <div>63.9° 0.92</div> | <div>75.9° 1.06</div> | <div>89.5° 1.24</div> |

Electrical

Choice of constant current dimming drivers. Power factor > .9 typical. PoE compatible: Integrates with Power over Ethernet lighting systems via standard, low-voltage wires. Integral Driver not Right Light as standard, consult factory.

Emergency

Emergency output —7W for 90 minutes. Maximum mounting height: 14.5 ft. J-box cannot be recessed above the ceiling with Emergency Battery.

Labels

UL and cUL listed. Suitable for Dry or Damp Locations, indoor use only. Wet Location standard, indoor use only.

Finish

Polyester powder coat applied over a multi-stage pre-treatment.

Lumen Maintenance

Reported: L70 > 55,000 hours
L80 > 55,000 hours

Calculated: L70 > 200,000 hours
L80 > 124,000 hours

(Derived from EPA TM-21 calculator. Based on typical conditions, consult factory for additional data.)

Reliability

At Focal Point, our products are designed to stand the test of time. Each luminaire is engineered using superior components, manufactured with the utmost care and rigorously tested. Contact us for reliability data.

Warranty

LED system rated for operation in ambient environments up to 25°C. 5 year limited warranty.

PERFORMANCE TABLE

| Lumen Output | Delivered Lumens | System Watts | LPW |
|--|------------------|--------------|------|
| 700L | 727 | 9.0 | 80.8 |
|  700L | 736 | 14.5 | 51.0 |
| 900L | 934 | 11.8 | 79.2 |
| 1100L | 1142 | 14.5 | 78.8 |
| 1300L | 1350 | 17.4 | 77.6 |

3500K, 80CRI, Clear Diffuse, DNT, Flood 2 Distribution. Warm Dim based on 3000 - 1800K, 90 CRI. Lumen output may vary +/- 5%. Actual wattage may vary +/- 5%.

ORDERING

| Luminaire Series | | FLCY2 |
|---|--|------------|
| ID+ 2" Round Cylinder | | FLCY2 |
| Trim Type | | RD |
| Round | | RD |
| Decorative Reveal | | |
| White Non-Glow Reveal | | WHR |
| Black Non-Glow Reveal | | BKR |
| White Glowing Reveal | | WHG |
| Black Glowing Reveal | | BKG |
| Clear Diffuse Glowing Reveal | | CDG |
| Warm Diffuse Glowing Reveal | | WDG |
| Custom Color Glowing Reveal <small>(Specify your RAL color value. Extended lead time consult factory.)</small> | | RAL_ _ _ _ |
| Lumen Output | | |
| 700 Lumens | | 700L |
| 900 Lumens | | 900L |
| 1100 Lumens | | 1100L |
| 1300 Lumens | | 1300L |
| Color Temperature | | |
| <small>(Add 9 for 90 CRI or H for 97 CRI. Leave blank for 80 CRI. Examples: 2700K, 97 CRI = H27K. 2700K, 80 CRI = 27K.)</small> | | |
| 2700K, 80/90/97+ CRI _27K | | _27K |
| 3000K, 80/90/97+ CRI _30K | | _30K |
| 3500K, 80/90/97+ CRI _35K | | _35K |
| 4000K, 80/90/97+ CRI _40K | | _40K |
| Warm Dim: 2700-1800K, 90+ CRI* | | 92718W |
| Warm Dim: 3000-1800K, 90+ CRI* | | 93018W |
| <small>*(700L only. Not available with EMR or LV.)</small> | | |
| Circuit | | 1C |
| Single Circuit | | 1C |
| Voltage | | |
| 120 Volt | | 120 |
| 277 Volt | | 277 |
| Low Voltage | | LV |
| Canopy Configuration | | |
| Shallow Canopy, Integral Driver | | SC |
| Decorative Shallow Canopy, Integral Driver | | DSC |
| Control System & Dimming Level | | |
| 0-10V - 5% Dimming <small>(120V only)</small> | | LD5 |
| 0-10V - 10% Dimming <small>(277V only)</small> | | LD1 |
| Low Voltage, PoE compatible <small>(No driver. Not available with EMR or Warm Dimming. LV voltage only.)</small> | | LVN |
| Phase Dimming <small>(120V only. Consult factory for recommended dimmers.)</small> | | LFP |
| Mounting | | SM |
| Surface Mount | | SM |
| Optic | | |
| 50° Cut-off Cone <small>(Not available with VWFL or SWFL distribution.)</small> | | DNT |
| Super Short Cone with Solite Lens | | DSS |
| Distribution | | |
| Narrow Flood | | NFL |
| Flood 1 | | FL1 |
| Flood 2 | | FL2 |
| Wide Flood 1 | | WFL1 |
| Wide Flood 2 | | WFL2 |
| Very Wide Flood <small>(DSS optic only.)</small> | | VWFL |
| Super Wide Flood <small>(DSS optic only.)</small> | | SWFL |
| Factory Options | | |
| Emergency Battery <small>(Not available with Warm Dim or Low Voltage. J-box cannot be recessed above the ceiling. Remote test switch.)</small> | | EMR |
| Reflector Color | | |
| Clear Diffuse | | CD |
| Warm Diffuse | | WD |
| Luminaire Finish | | |
| <small>(Cylinder and canopy finish match)</small> | | |
| Black | | BK |
| White | | WH |

DISTRIBUTION KITS INCLUDE AN
OPTIC AND REFLECTOR ASSEMBLY.

BOTH ITEMS MUST BE REPLACED
TO ACHIEVE SPECIFIED
DISTRIBUTION.

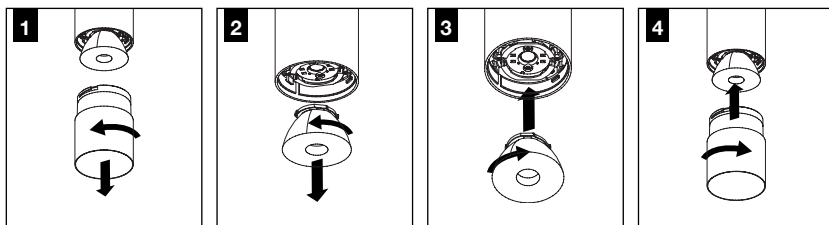
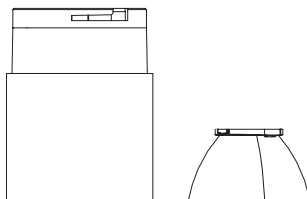

ACCESSORIES ORDERING

| Luminaire Series | | KIT-FLCY2 |
|--|------|-----------|
| ID+ 2" Round Cylinder | | |
| Trim Type | | RD |
| Round | RD | |
| Decorative Reveal | | |
| (Non-Glow may not be changed to Glowing Reveal in the field) | | |
| White Non-Glow Reveal | WHR | |
| Black Non-Glow Reveal | BKR | |
| Any Glowing Reveal | GLO | |
| (Glowing reveal color may not be changed in field) | | |
| Optic | | |
| 50° Cut-off Cone | DNT | |
| (Not available with VWFL or SWFL distribution.) | | |
| Super Short Cone with Solite Lens | DSS | |
| Wall Wash* WW | WW | |
| Distribution | | |
| (For Wall Wash Optic leave Distribution blank) | | |
| Narrow Flood | NFL | |
| Flood 1 | FL1 | |
| Flood 2 | FL2 | |
| Wide Flood 1 | WFL1 | |
| Wide Flood 2 | WFL2 | |
| Very Wide Flood (DSS optic only) | VWFL | |
| Super Wide Flood (DSS optic only) | SWFL | |
| Reflector Color | | |
| Clear Diffuse | CD | |
| Warm Diffuse | WD | |
| Luminaire Finish | | |
| Black | BK | |
| White | WH | |

*Changing to a Wall wash from a Downlight will result in a step lower nominal lumen than originally specified. Please use lumen multiplier formula to determine delivered lumen output. [Download the dedicated Wall Wash cut sheet.](#)

DIMENSIONAL DATA CONTINUED

SC - Shallow Canopy, Integral Driver

Indicates Driver Location

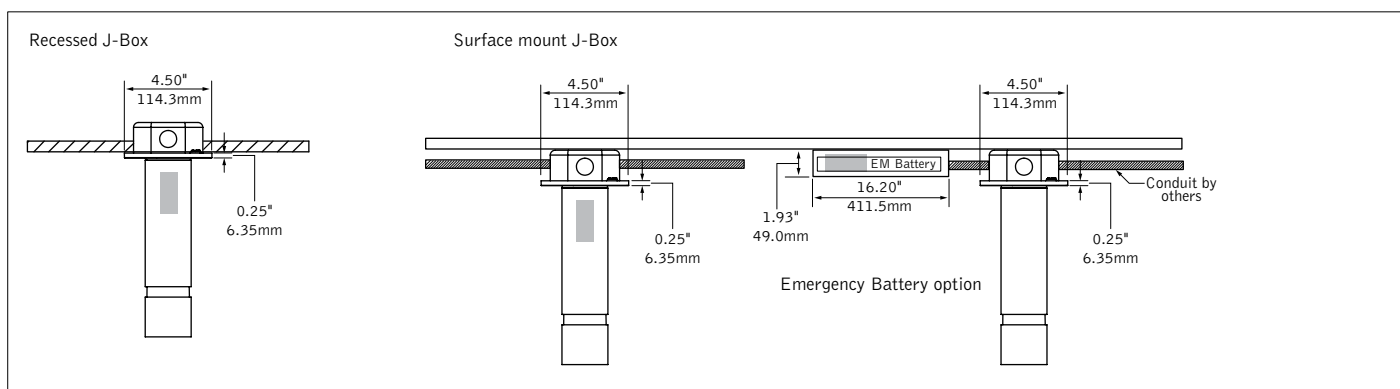

DSC - Decorative Shallow Canopy, Integral Driver

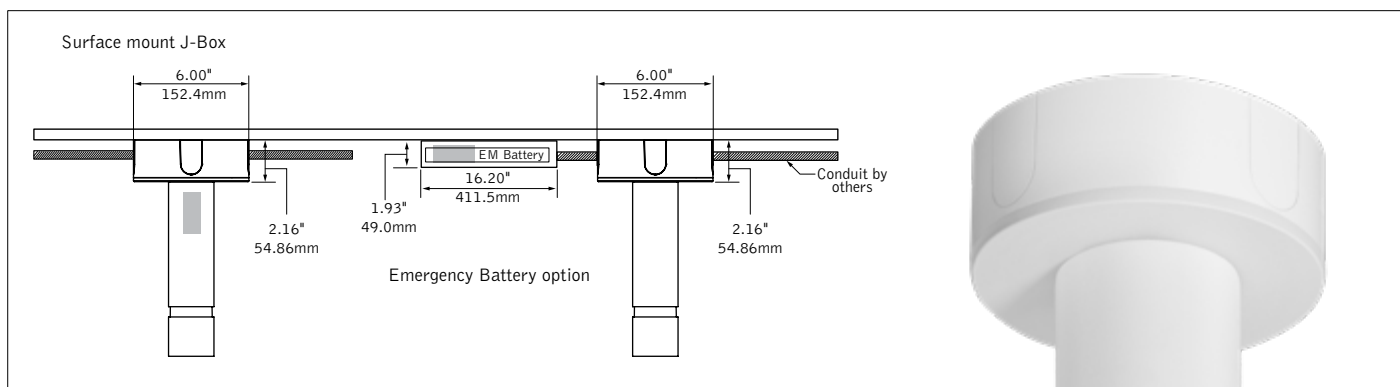

2" CYLINDER LUMEN MULTIPLIER TABLE

Color Temperature & CRI

| Trim Type | Optic | Color Temperature | Multiplier |
|------------|-------|------------------------------|------------|
| Round [RD] | ALL | 2700K, 80+ CRI [27K] | 0.92 |
| | | 2700K, 90+ CRI [927K] | 0.79 |
| | | 2700K, 97+ CRI [H27K] | 0.67 |
| | | 3000K, 80+ CRI [30K] | 0.98 |
| | | 3000K, 90+ CRI [930K] | 0.83 |
| | | 3000K, 97+ CRI [H30K] | 0.72 |
| | | 3500K, 80+ CRI [35K] | 1.00 |
| | | 3500K, 90+ CRI [935K] | 0.82 |
| | | 3500K, 97+ CRI [H35K] | 0.73 |
| | | 4000K, 80+ CRI [40K] | 1.01 |
| | | 4000K, 90+ CRI [940K] | 0.84 |
| | | 4000K, 97+ CRI [H40K] | 0.76 |
| | | 2700-1800K, 90+ CRI [92718W] | 1.00 |
| | | 3000-1800K, 90+ CRI [93018W] | 1.05 |

Optic & Distribution

| Trim Type | Optic | Distribution | Multiplier |
|------------|---|---------------------------------|------------|
| Round [RD] | Tall Cone, 50° cut-off [DNT] | Narrow Flood (19.4°) [NFL] | 1.27 |
| | | Flood 1 (29.9°) [FL1] | 1.19 |
| | | Flood 2 (42.1°) [FL2] | 1.04 |
| | | Wide Flood 1 (55.9°) [WFL1] | 0.96 |
| | | Wide Flood 2 (65.8°) [WFL2] | 0.89 |
| | Super Short Cone with Solite lens [DSS] | Narrow Flood (21.2°) [NFL] | 1.08 |
| | | Flood 1 (29.7°) [FL1] | 0.96 |
| | | Flood 2 (39.2°) [FL2] | 0.94 |
| | | Wide Flood 1 (53.1°) [WFL1] | 0.89 |
| | | Wide Flood 2 (63.9°) [WFL2] | 0.88 |
| | | Very Wide Flood (75.9°) [VWFL] | 0.85 |
| | | Super Wide Flood (89.5°) [SWFL] | 0.75 |

Color

| Trim Type | Optic | Color | Multiplier |
|-----------|---|--------------------|------------|
| ALL | Tall Cone, 50° cut-off [DNT] | Clear Diffuse [CD] | 1.00 |
| | | Warm Diffuse [WD] | 1.00 |
| | Super Short Cone with Solite lens [DSS] | Clear Diffuse [CD] | 1.00 |
| | | Warm Diffuse [WD] | 1.00 |

Multiplier tables are provided to aid with estimation of lumen levels across options. Apply multipliers against ordered Lumen Output to estimate Delivered Lumens. Refer to IES files for most accurate photometric information.

How To Use Lumen Multipliers

Formula: (Lumen Output Value) x (Color Temperature & CRI) x (Optic & Distribution) x (Color)

Example: FLCY2-RD-1100L-935K-DNT-FL1-WD
(1100) x (0.82) x (1.19) x (1.00) ≈ 1073.4 lm (estimated delivered lumens)