

# ID+ 3.5" Adjustable

Round Trimless | FLCS3



**LUMINAIRE MUST BE INSTALLED PRIOR TO DRYWALL CEILING.  
ALL GRID LUMINAIRES MUST BE SECURED TO STRUCTURE ABOVE.**



NON-EMERGENCY - THERMALLY PROTECTED, NON-IC

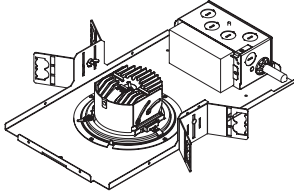

OPTIONAL - BAR HANGERS SOLD SEPARATELY

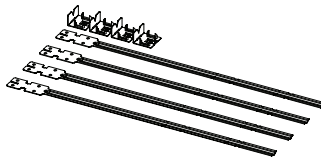

KEY



POWER OFF



POWER ON



ATTENTION



LEVEL



SEE ADDITIONAL  
INSTRUCTIONS

IC/CP

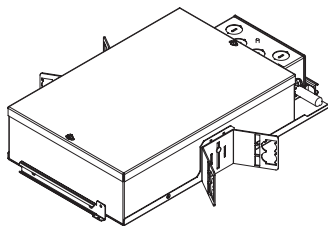

TRIM

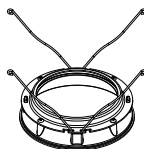

SOLITE LENS

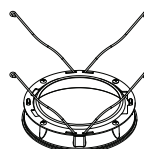

SPOT OPTIC,  
NO LENS  
0°-10° TILT



SPOT OPTIC,  
NO LENS  
10°-20° TILT



SPOT OPTIC,  
NO LENS  
20°-35° TILT

1

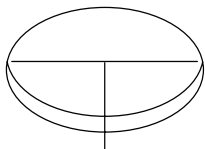

4 1/8"

ceiling cutout

2

x2

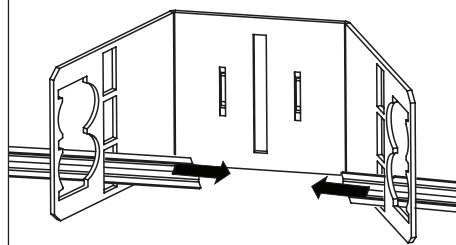

3

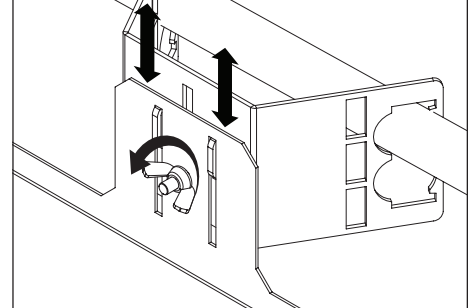

## WOOD STUDS

2a

x4

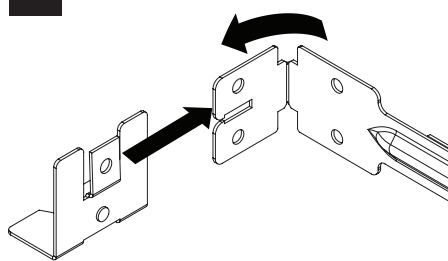

2b

x4

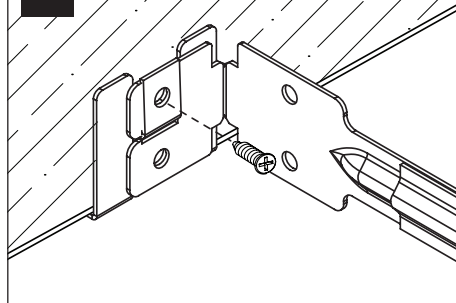

## METAL STUDS

3

x4

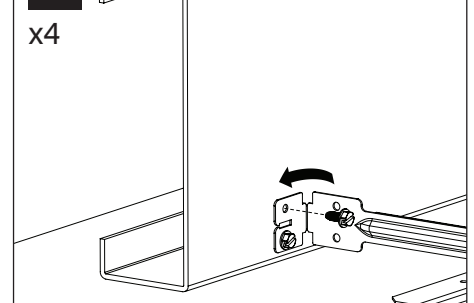

Luminaires must be installed by a qualified electrician (check with local and national codes for proper installation).  
To prevent electrical shock, disconnect electrical supply before installation or servicing.

4



minimum ceiling thickness: 1/2"

maximum ceiling thickness: 1"

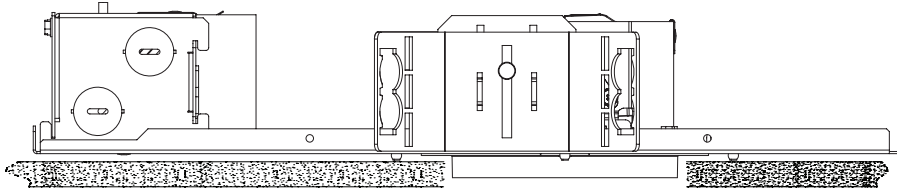

5

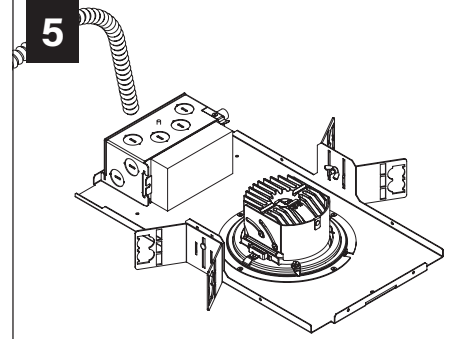

MAKE ELECTRICAL CONNECTIONS

## MUD-IN

1

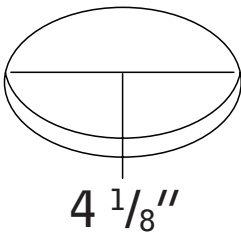

4 1/8"

CLEAN CEILING SURFACE  
FREE OF DUST AND DEBRIS

2

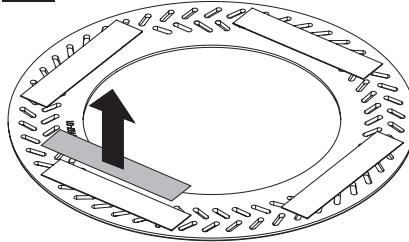
REMOVE ADHESIVE BACKING  
FROM MUD RING

3

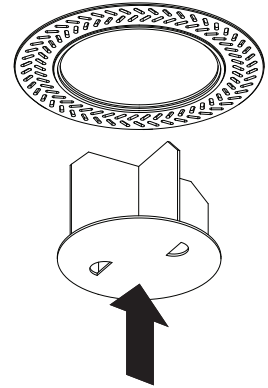

4

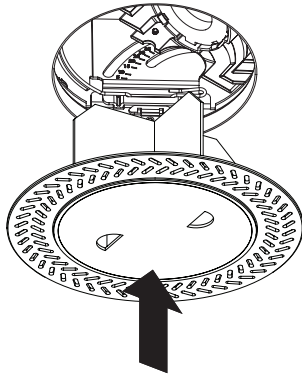

5

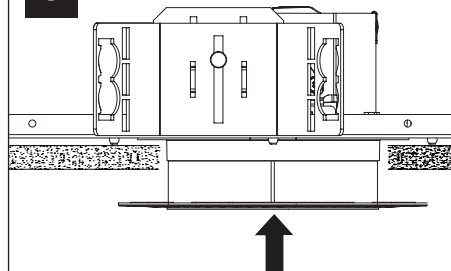
USE DUST COVER TO ALIGN MUD RING  
WITH HOUSING COLLAR OPENING

6

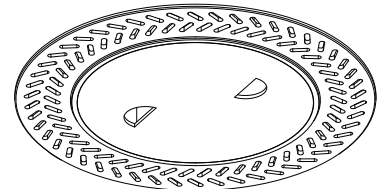
DO NOT REMOVE DUST  
COVER UNTIL TAPE AND  
MUD-IN COMPLETE

7

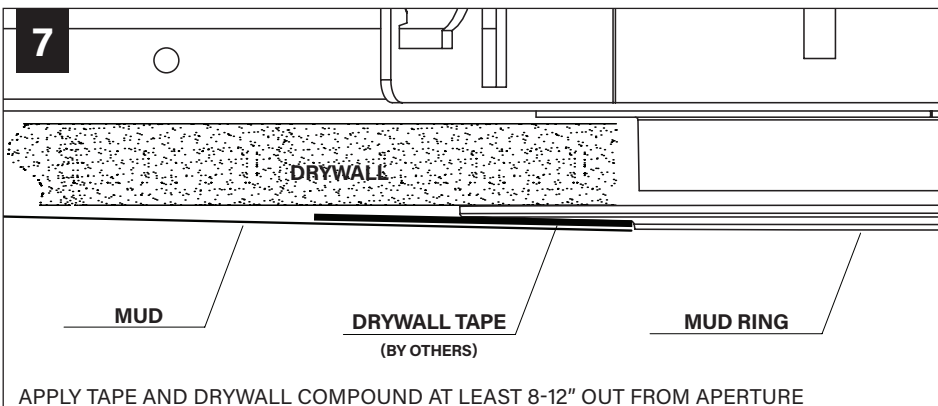

8

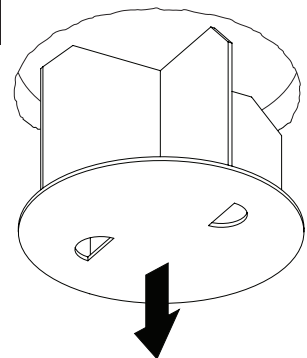

Fixtures must be installed by a qualified electrician (check with local and national codes for proper installation).  
To prevent electrical shock, disconnect electrical supply before installation or servicing.

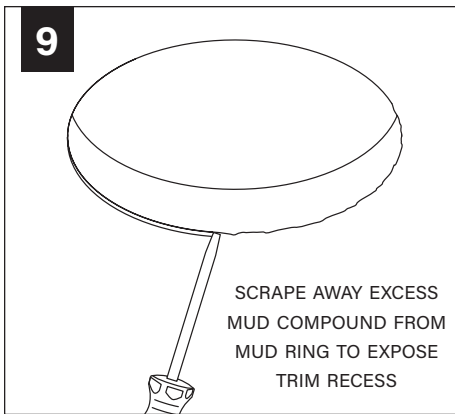

## WOOD CEILING

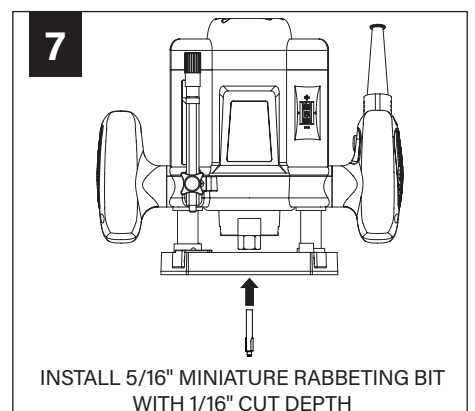
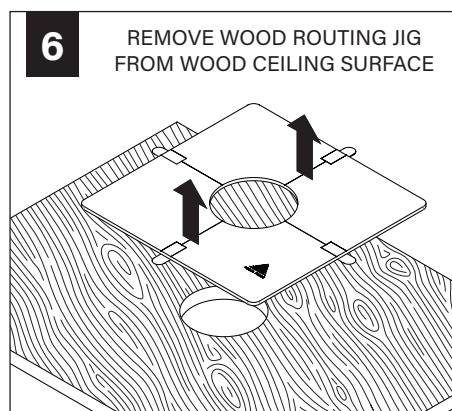
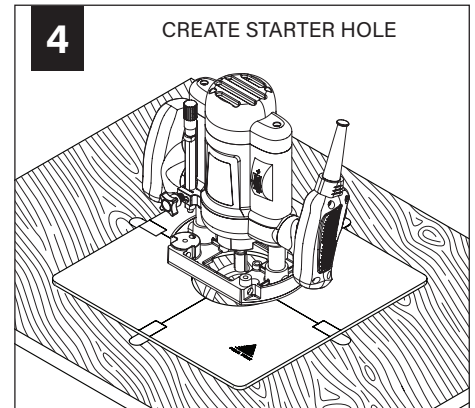
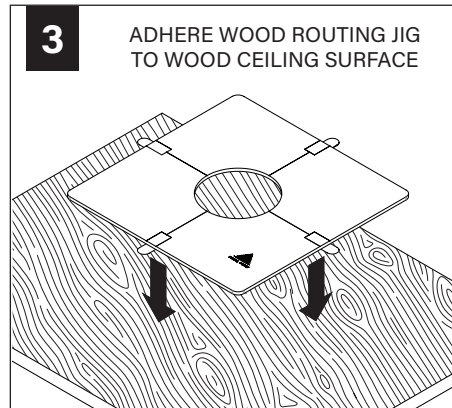
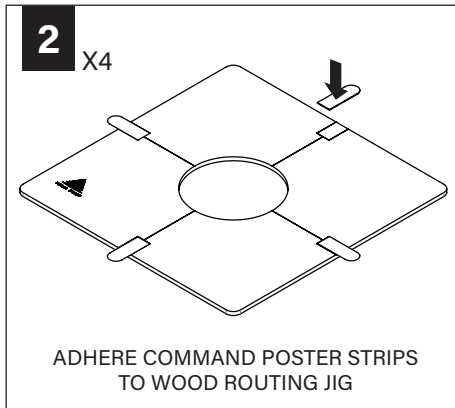
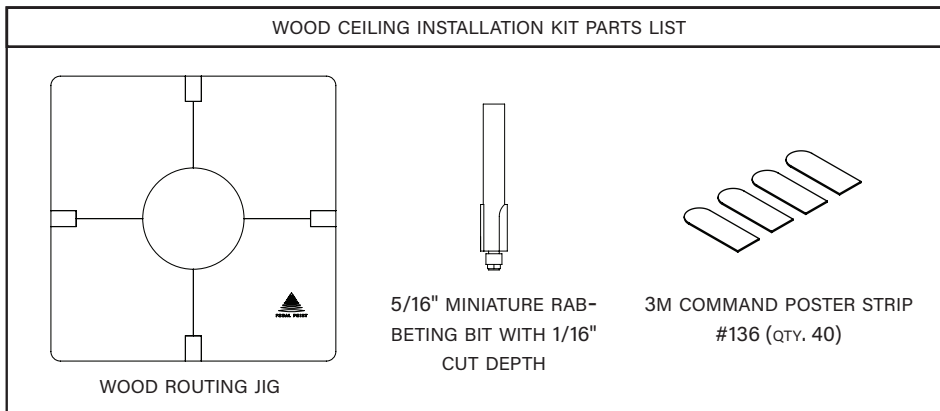

Fixtures must be installed by a qualified electrician (check with local and national codes for proper installation).  
To prevent electrical shock, disconnect electrical supply before installation or servicing.

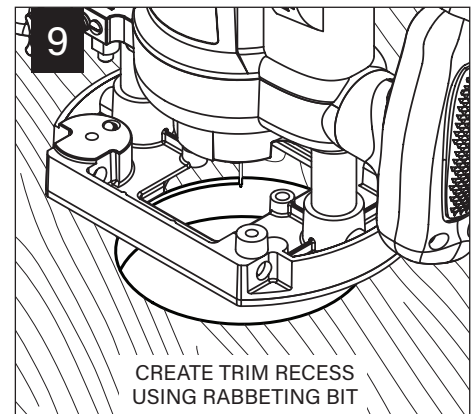
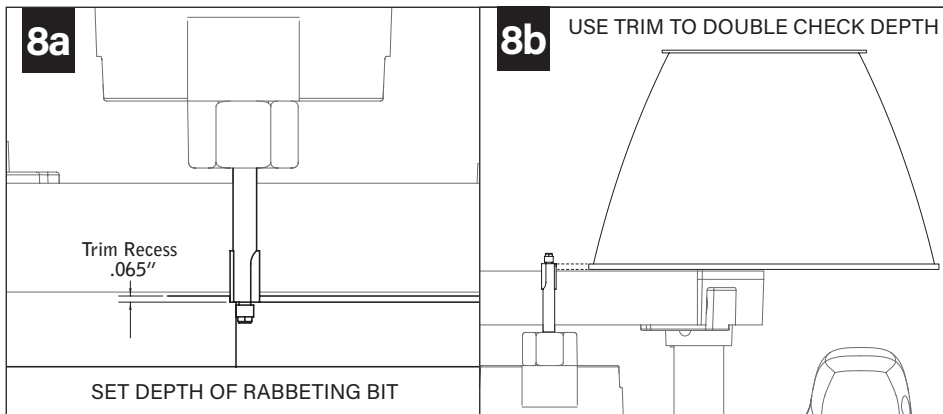

## ROTATE

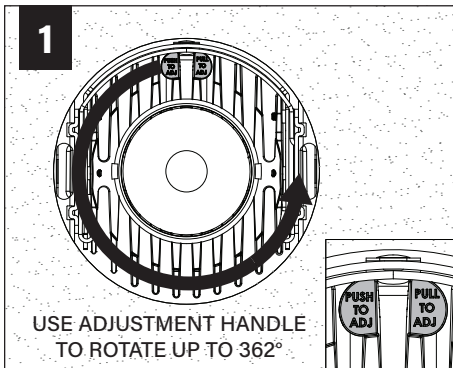

## TILT

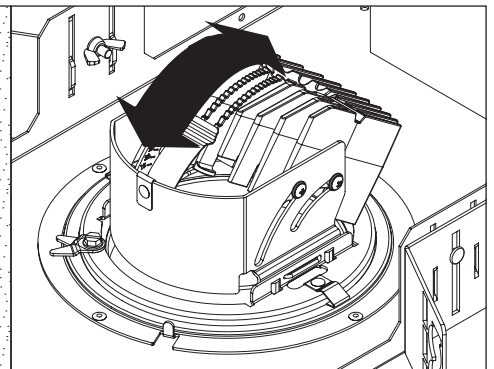
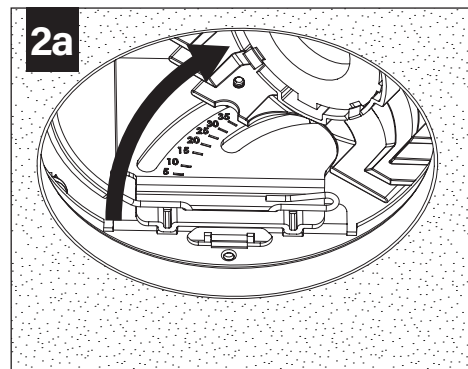
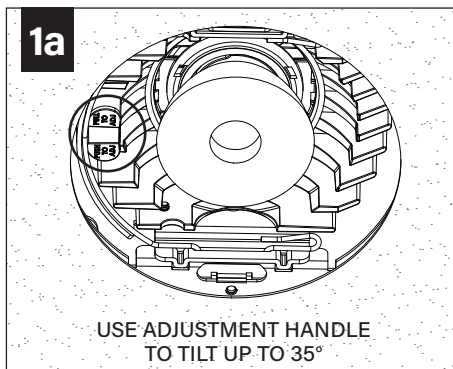

## OPTIC SERVICE

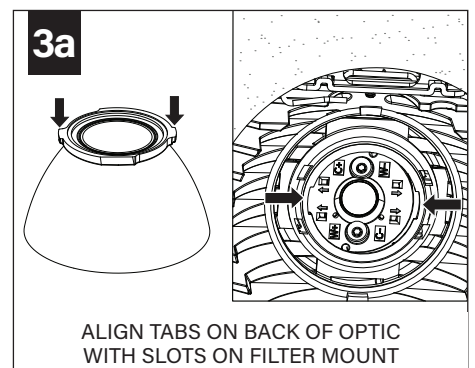
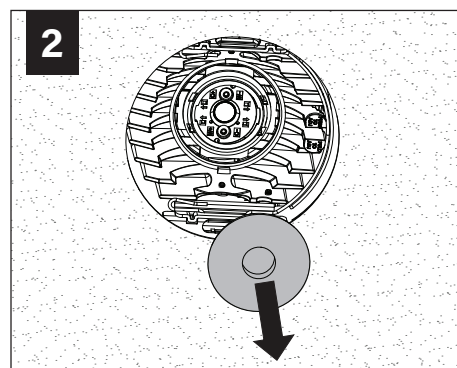
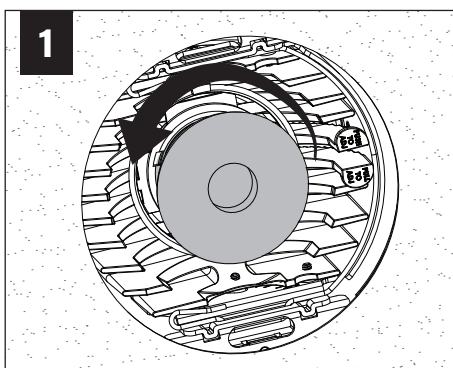

Fixtures must be installed by a qualified electrician (check with local and national codes for proper installation).  
To prevent electrical shock, disconnect electrical supply before installation or servicing.

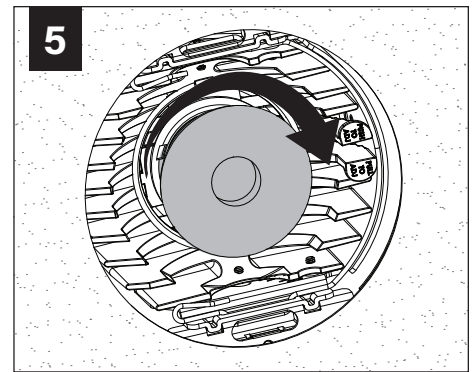
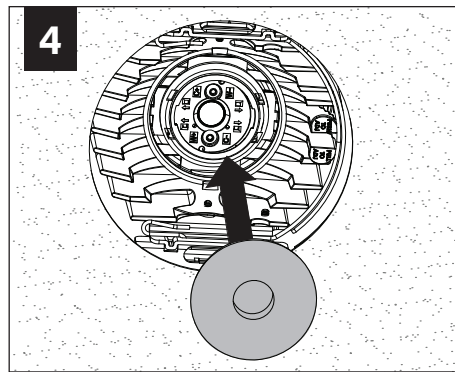
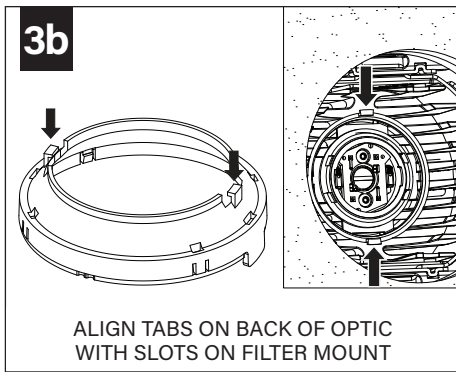

## TRIM INSTALLATION

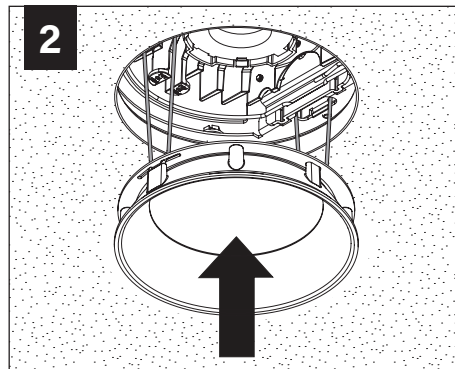
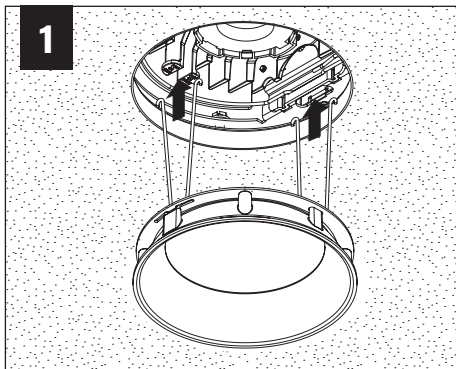

## DRIVER SERVICE



TO PREVENT ELECTRICAL SHOCK,  
DISCONNECT ELECTRICAL SUPPLY  
BEFORE SERVICING

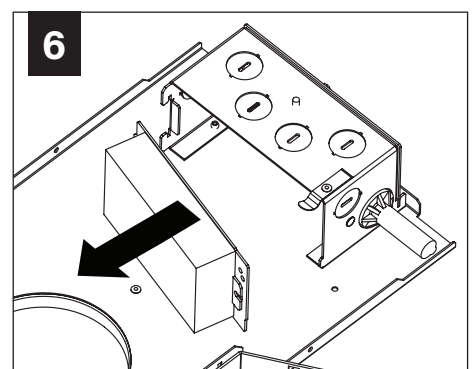
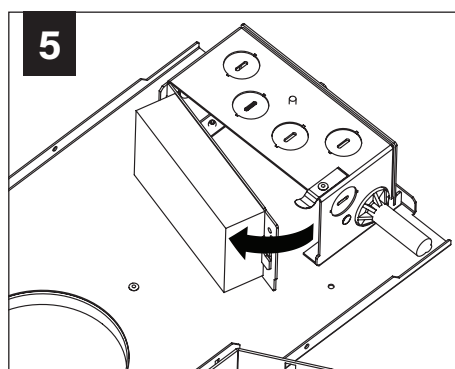
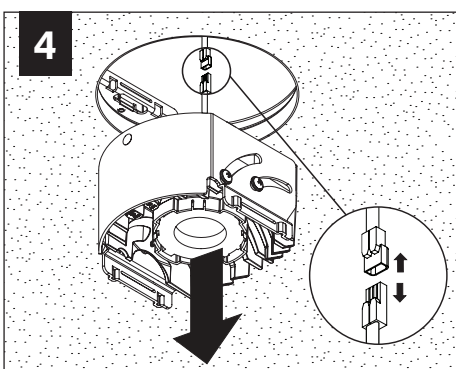
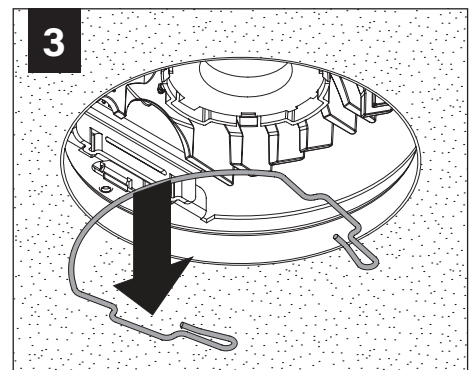
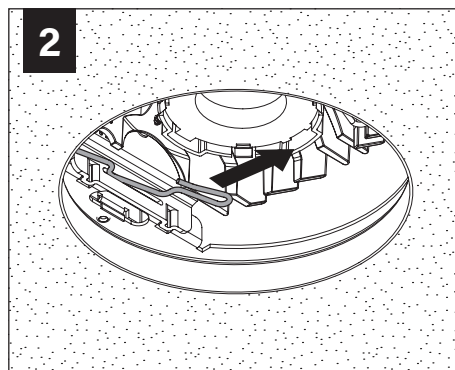
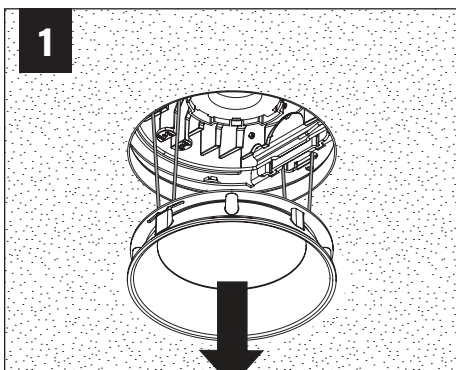

Contractor is responsible for adequately reinforcing walls and/or ceilings to support fixture weight. Focal Point, LLC accepts no responsibility for inadequately reinforced walls and/or ceilings. The information contained in this drawing is the sole property of Focal Point, LLC. Any reproduction in part or whole without the written permission of Focal Point, LLC is prohibited.



## SPOT OPTIC TILT KIT (SOLD SEPARATELY)



**SP10 & SP20 SHIP WITH SHROUDS INSTALLED.**

SPOT OPTICS KITS ARE AVAILABLE AS REPLACEMENTS OR IF TILT ANGLE CHANGES FROM WHAT WAS SPECIFIED.

### Distribution: Spot (SP)

Optic	Description	Tilt Range
<b>SL*</b>	Solite Lens	0° – 35°
<b>SP00*</b>	Spot Optic, No Lens	0° – 10°
<b>SP10</b>	Spot Optic, No Lens	10° – 20°
<b>SP20</b>	Spot Optic, No Lens	20° – 35°

\*Shroud not required

**A**

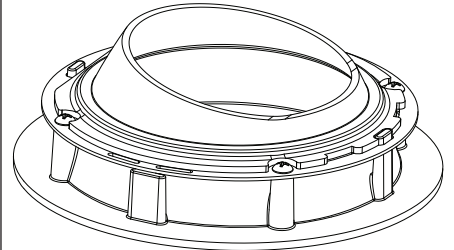

**SP10: 10° – 20°**

**B**

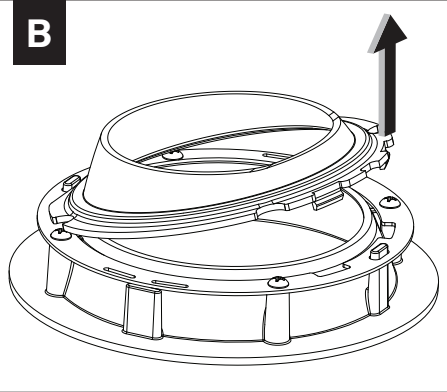

**C**

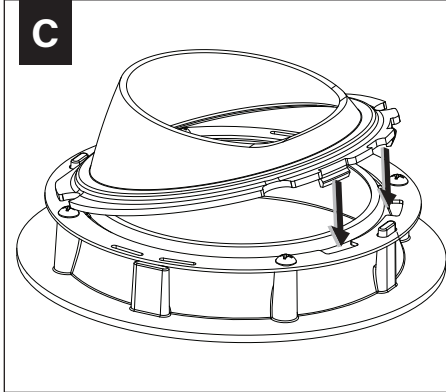

**D**

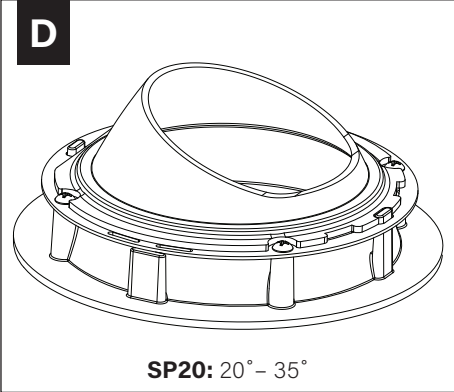

**SP20: 20° – 35°**