

id⁺ 4.5" & 6" square housing

FLC44D | FLC44W | FLC66D | FLC66W



**LUMINAIRE MUST BE INSTALLED PRIOR TO DRYWALL CEILING.
ALL GRID LUMINAIRES MUST BE SECURED TO STRUCTURE ABOVE.**



NON-EMERGENCY - THERMALLY PROTECTED, NON-IC

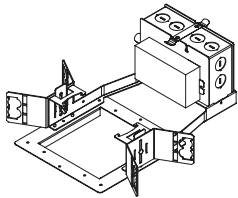

FLC44D | FLC44W

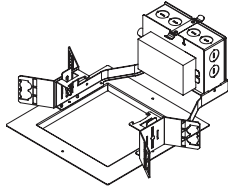

FLC66D | FLC66W



OPTIONAL
BAR HANGERS SOLD SEPARATELY

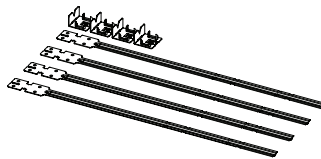

KEY



POWER OFF



POWER ON



LEVEL



ATTENTION



SEE ADDITIONAL INSTRUCTIONS

EMERGENCY - INTEGRAL TEST SWITCH

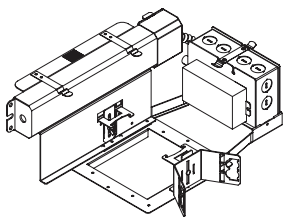

FLC44D | FLC44W

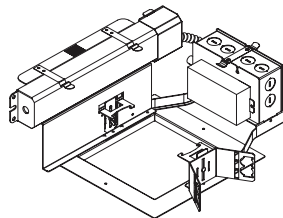

FLC66D | FLC66W

CP - EMERGENCY/NON-EMERGENCY

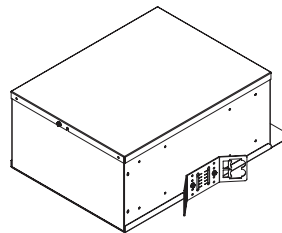

FLC44D | FLC44W | FLC66D | FLC66W

A



TO SET CEILING
THICKNESS SEE FOCAL
POINT INSTRUCTION SHEET
IS0586

1

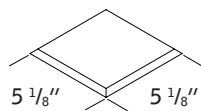

4.5" overlap

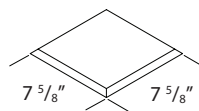

4.5" flush

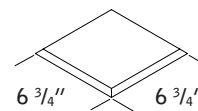

6" overlap

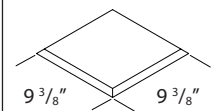

6" flush



GRID - 1/2" CONDUIT & CLIP (BY OTHERS)

2 x2

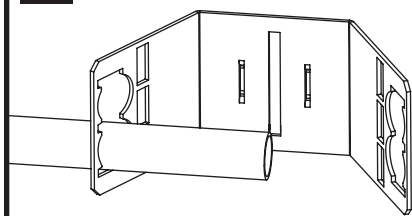

3

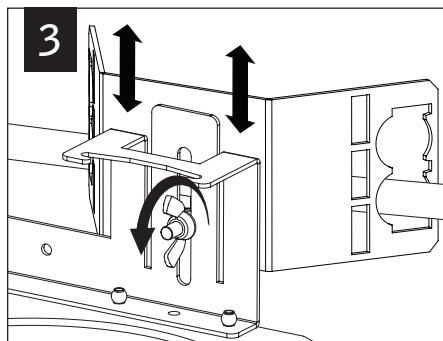

4 x4

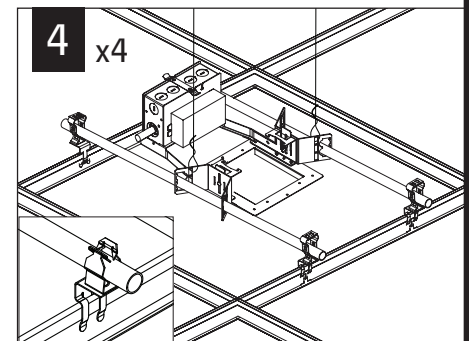

Luminaires must be installed by a qualified electrician (check with local and national codes for proper installation).
To prevent electrical shock, disconnect electrical supply before installation or servicing.

GRID - BAR HANGERS (SOLD SEPARATELY)

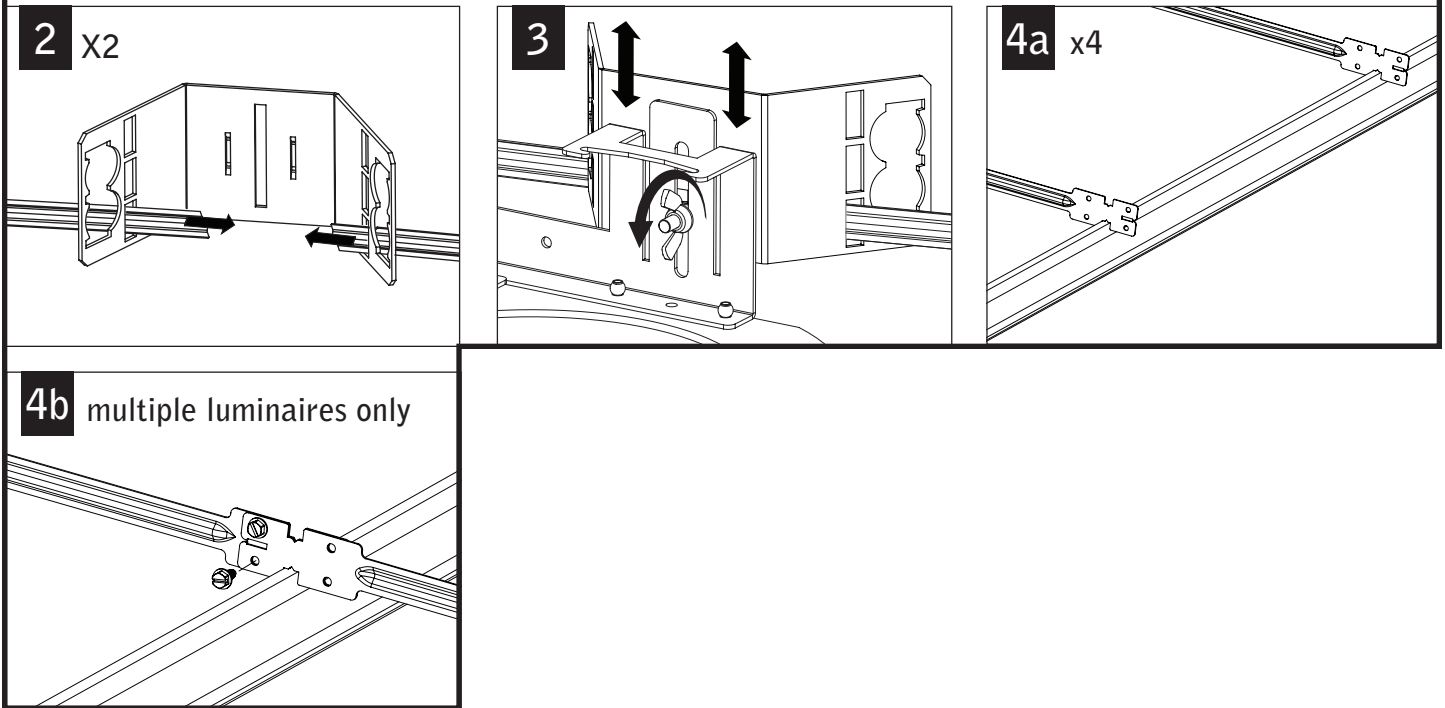

DRYWALL - BAR HANGERS

WOOD STUDS

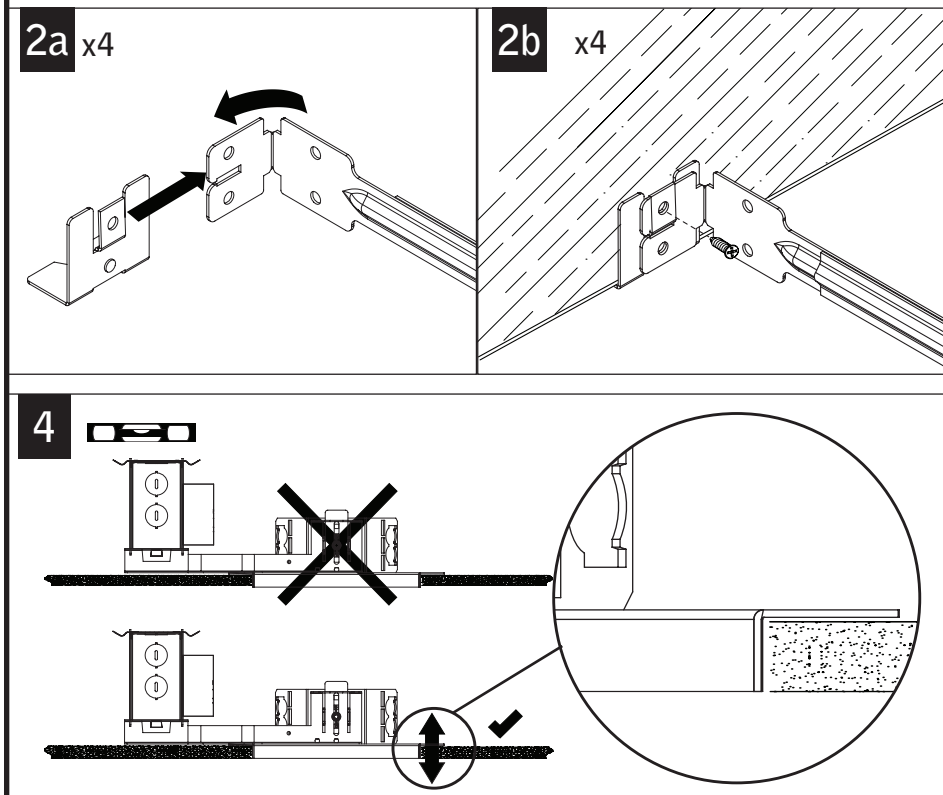

METAL STUDS

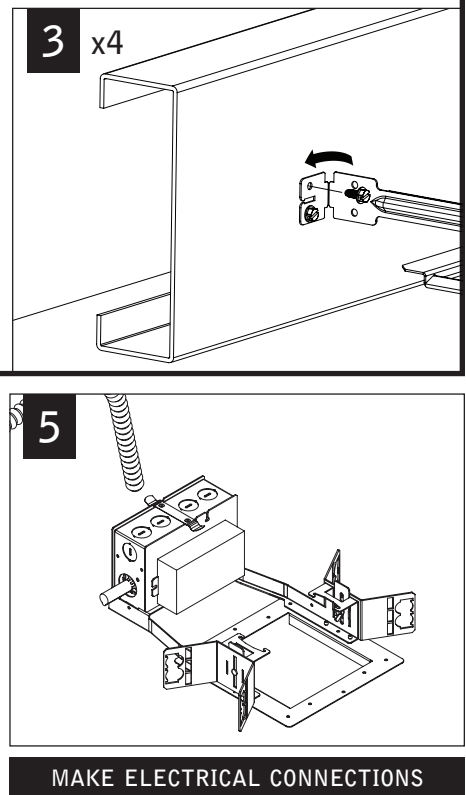

Fixtures must be installed by a qualified electrician (check with local and national codes for proper installation).
To prevent electrical shock, disconnect electrical supply before installation or servicing.

FLUSH TRIM MUD-IN

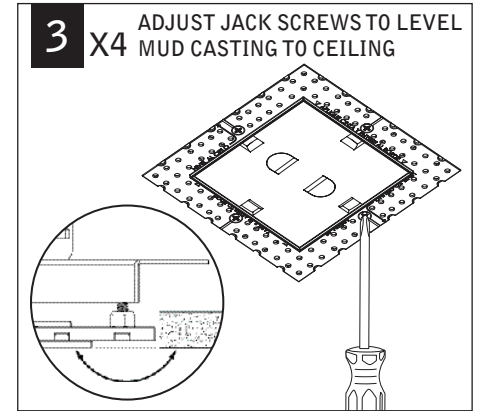
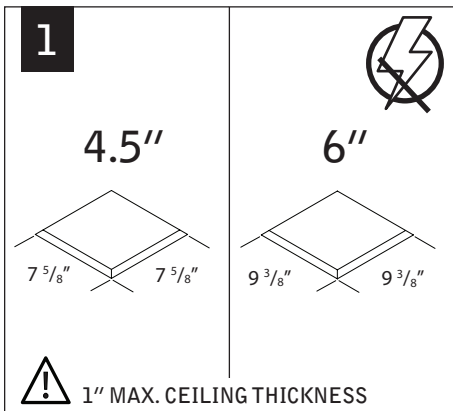

EMERGENCY - INTEGRAL TEST SWITCH

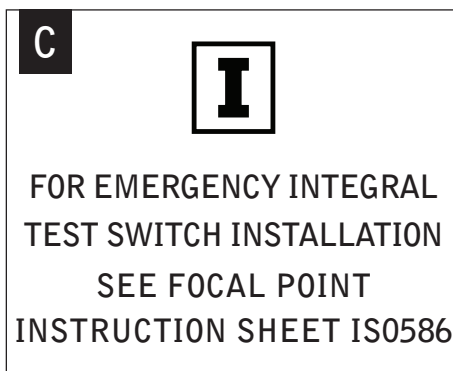
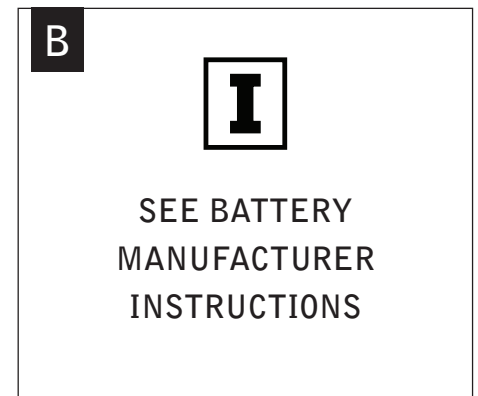
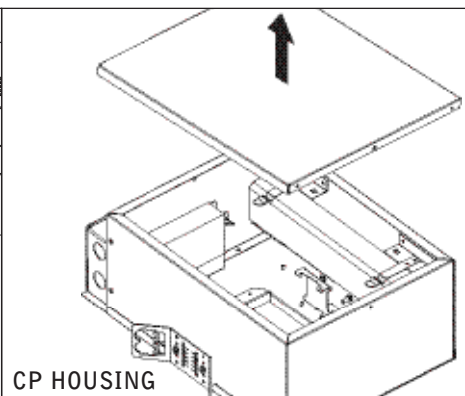
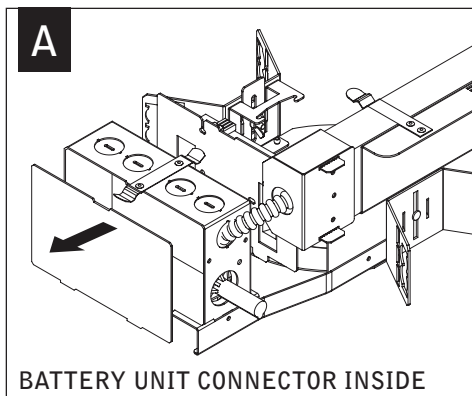

DRIVER SERVICE

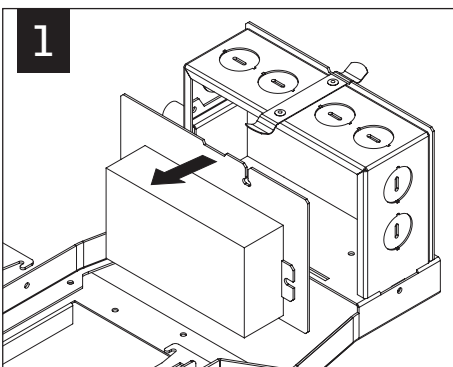

Contractor is responsible for adequately reinforcing walls and/or ceilings to support fixture weight. Focal Point, LLC accepts no responsibility for inadequately reinforced walls and/or ceilings. The information contained in this drawing is the sole property of Focal Point, LLC. Any reproduction in part or whole without the written permission of Focal Point, LLC is prohibited.