

id+ 3.5" round trimless housing

FLC3D | FLC3W



FOCAL POINT™



LUMINAIRE MUST BE INSTALLED PRIOR TO DRYWALL CEILING.



NON-EMERGENCY - THERMALLY PROTECTED, NON-IC

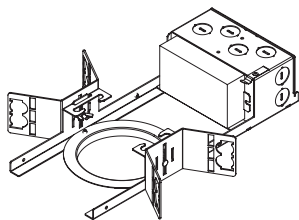

FLC3D | FLC3W



OPTIONAL - BAR HANGERS SOLD SEPARATELY

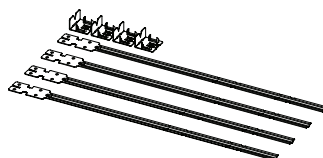

KEY



POWER OFF



POWER ON



ATTENTION



LEVEL



SEE ADDITIONAL INSTRUCTIONS

IC/CP

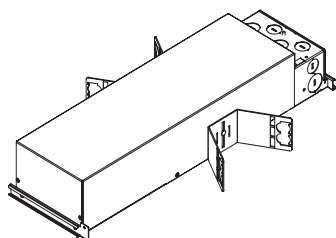

FLC3D | FLC3W

WALL WASH ORIENTATION

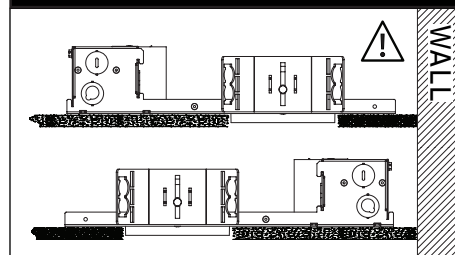

KEEP SHADED AREA FREE FROM OBSTRUCTION ABOVE CEILING

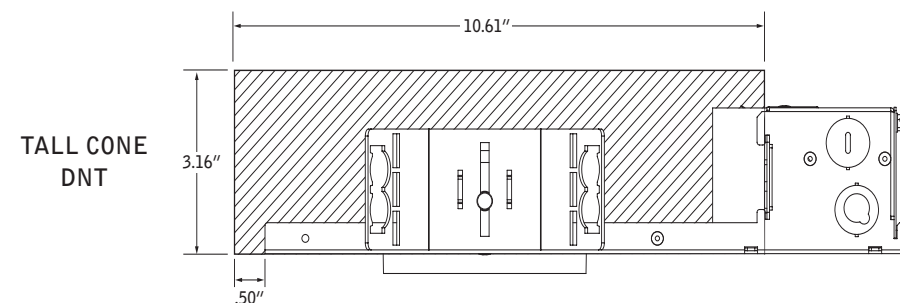
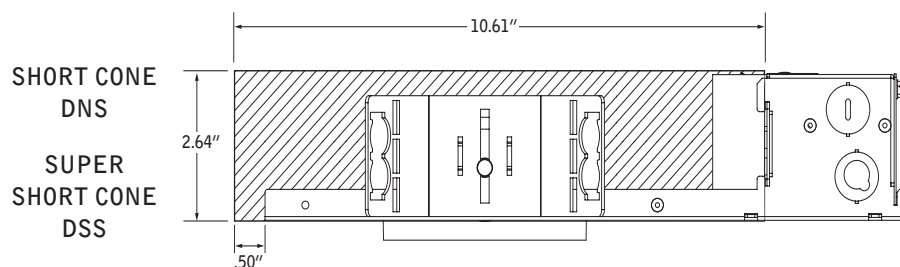

1 x2

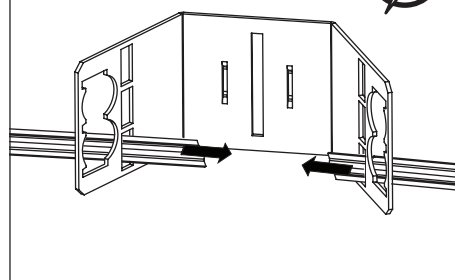

2

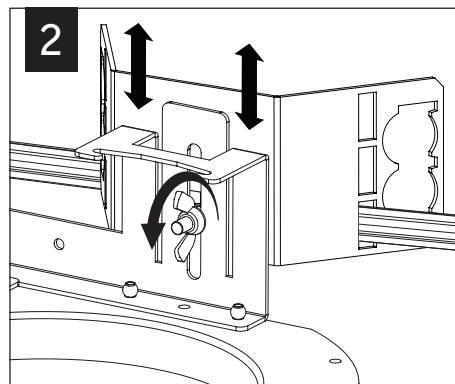

Luminaires must be installed by a qualified electrician (check with local and national codes for proper installation).
To prevent electrical shock, disconnect electrical supply before installation or servicing.

WOOD STUDS

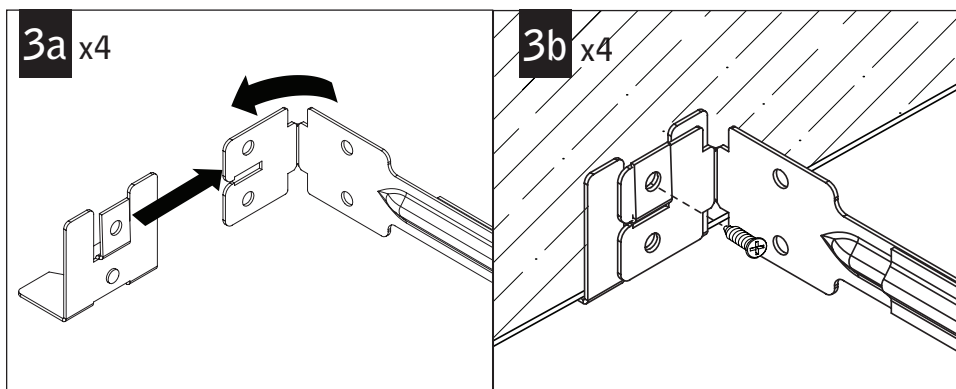

METAL STUDS

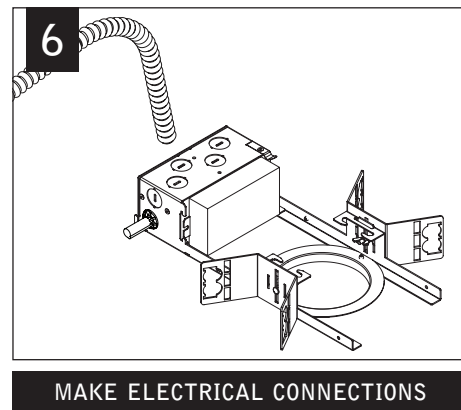
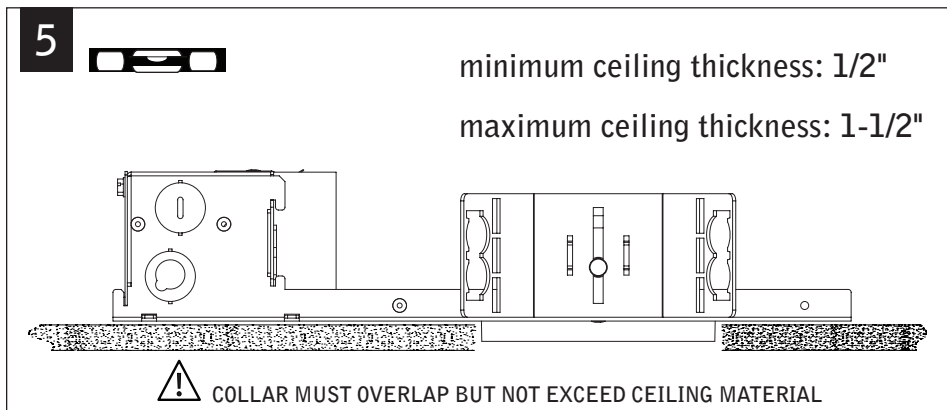
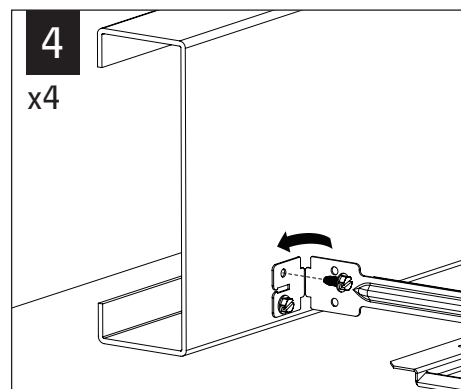

MUD-IN

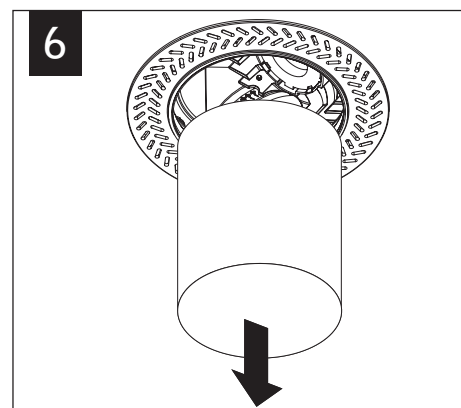
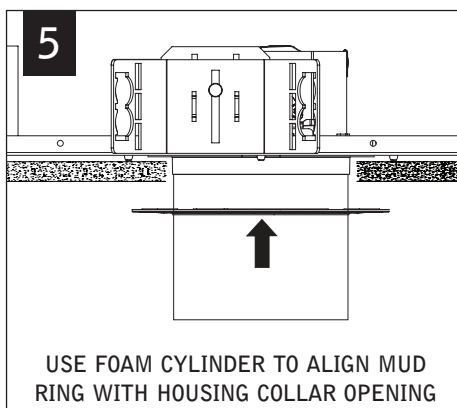
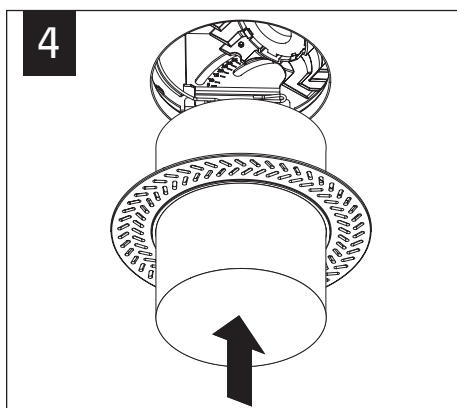
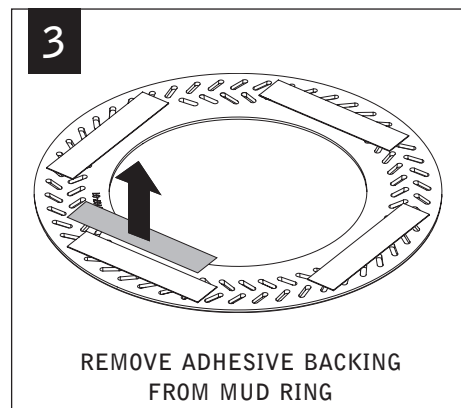
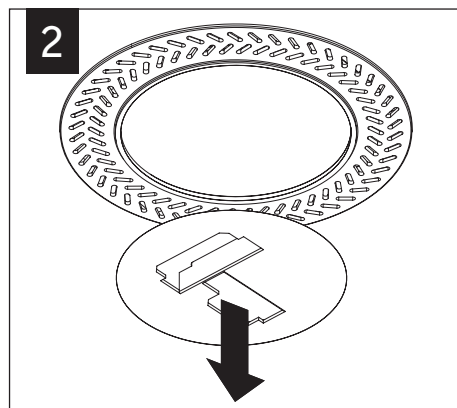
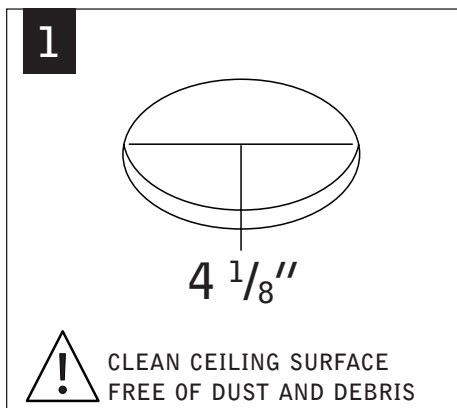

Fixtures must be installed by a qualified electrician (check with local and national codes for proper installation).
To prevent electrical shock, disconnect electrical supply before installation or servicing.

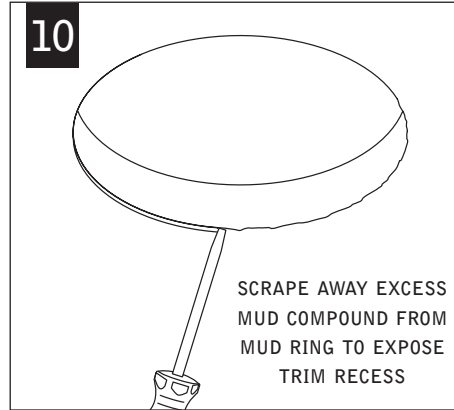
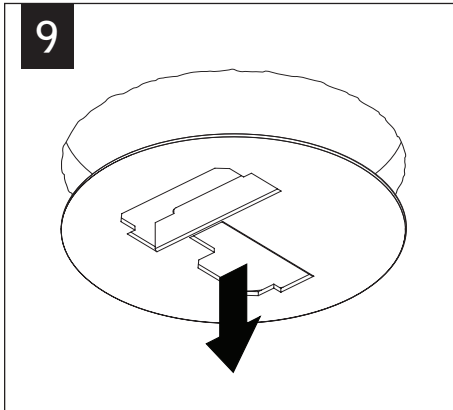
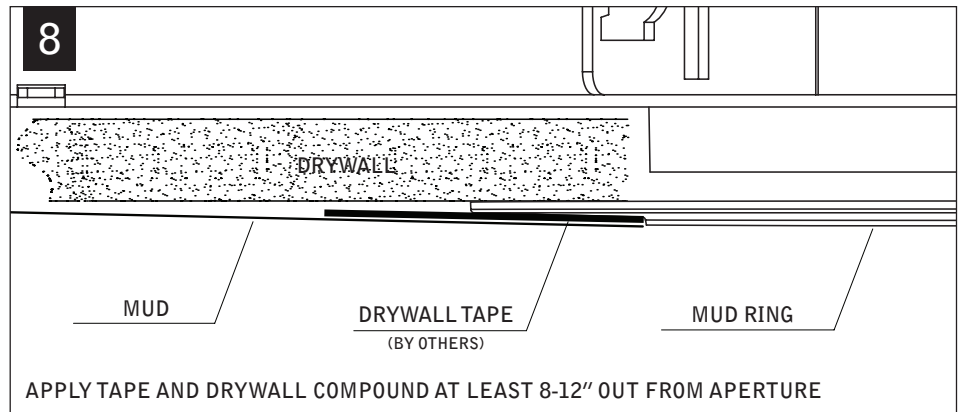

WOOD CEILING

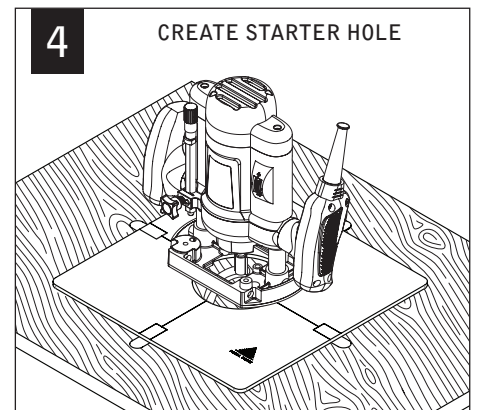
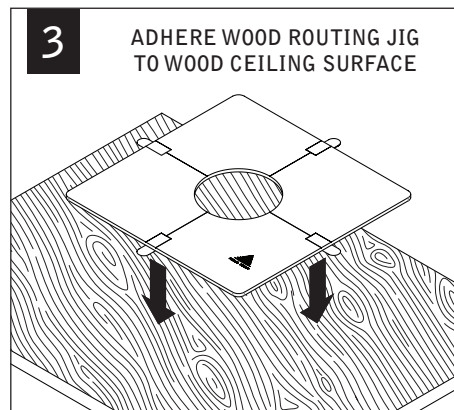
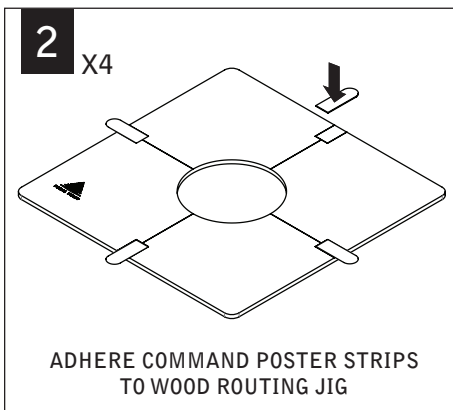
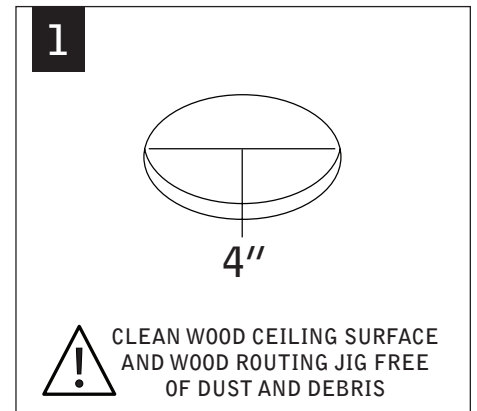
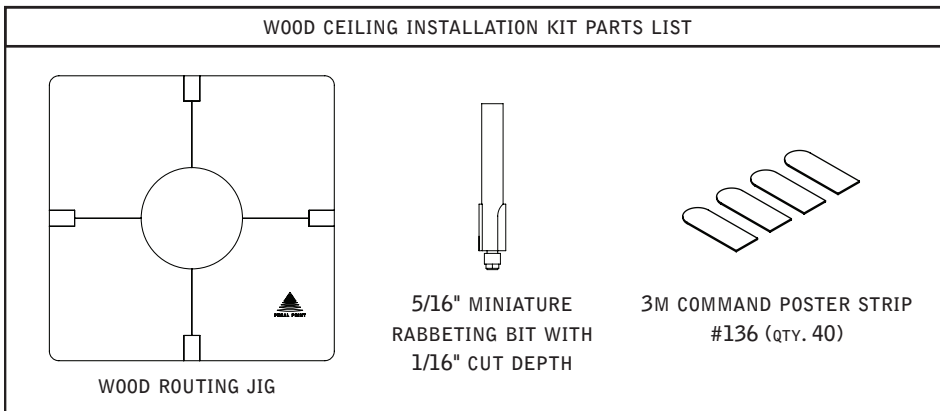

Fixtures must be installed by a qualified electrician (check with local and national codes for proper installation).
To prevent electrical shock, disconnect electrical supply before installation or servicing.

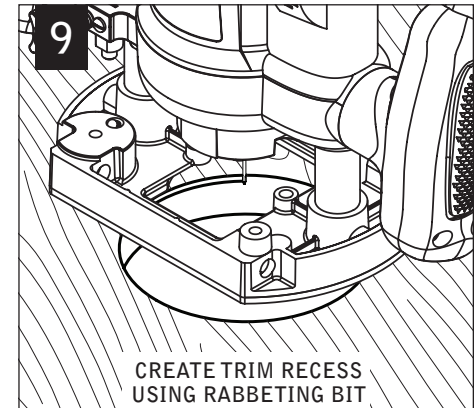
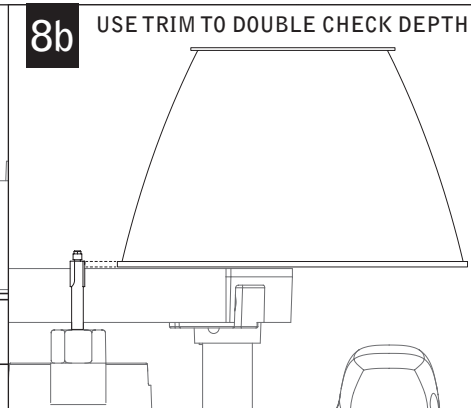
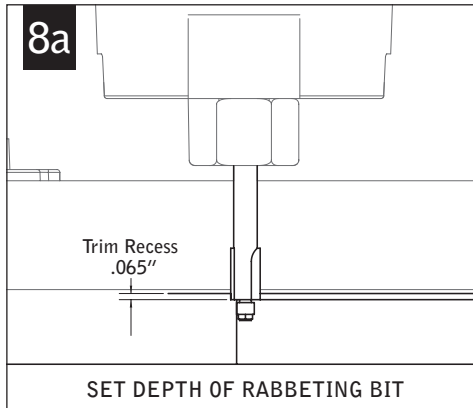
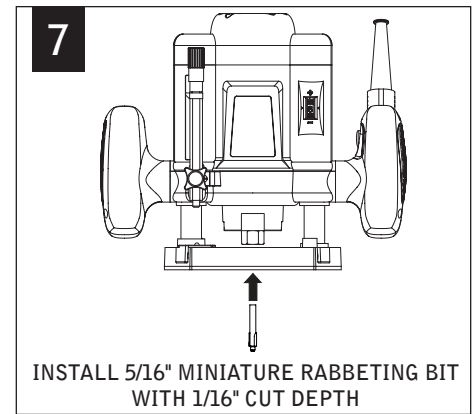
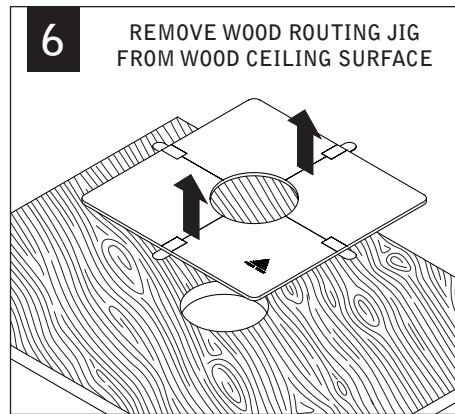
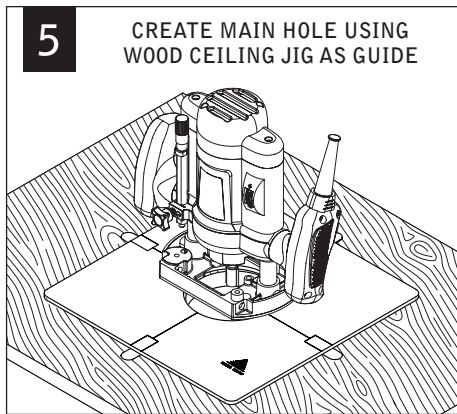

DRIVER SERVICE

