

ID+ 8"

LED HIGH CEILING DOWNLIGHT

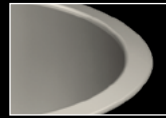

non-painted trim



white painted trim

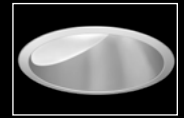

wall wash companion

DIMENSIONAL DATA

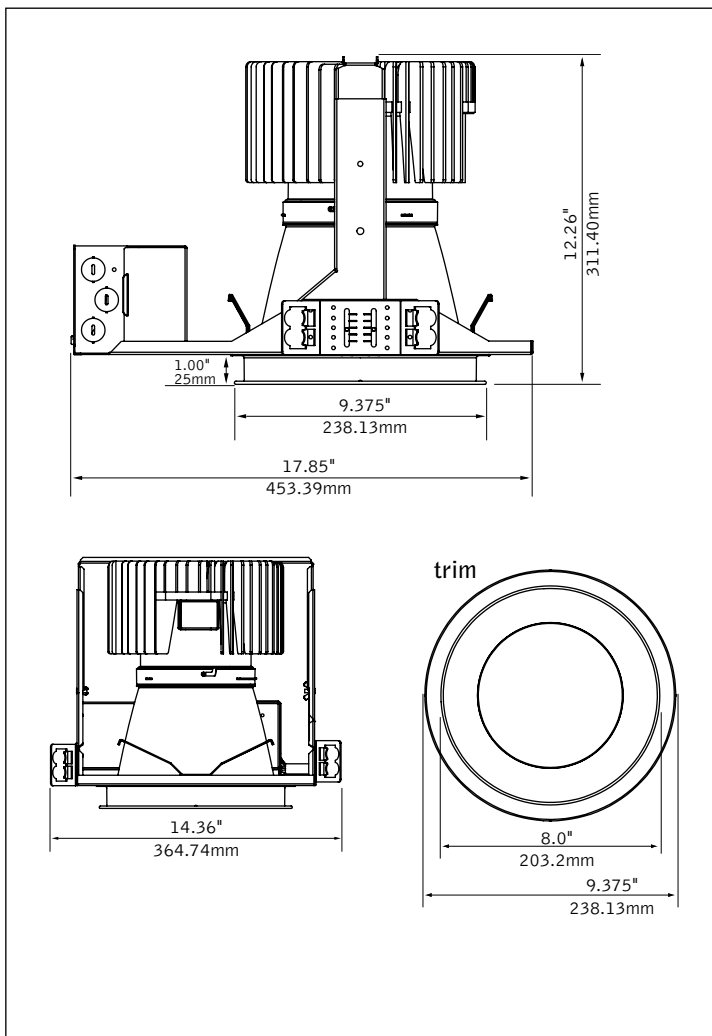

FEATURES

High ceiling downlight with a choice of beamspreads is ideal for lobbies, atriums and convention centers.

Optical design creates homogenous light source appearance. Field changeable 30°, 40°, 50° and 60° beams offer design flexibility.

Selection of dimming drivers available.

Passive cooling allows silent operation.

Self-flanged Clear Diffuse reflector cone features superior brightness control and 50-degree cutoff to light source and its image.

Sloped ceiling adaptor available in 10°, 15°, 20°, 25°, 30° and 35° slopes.

PERFORMANCE

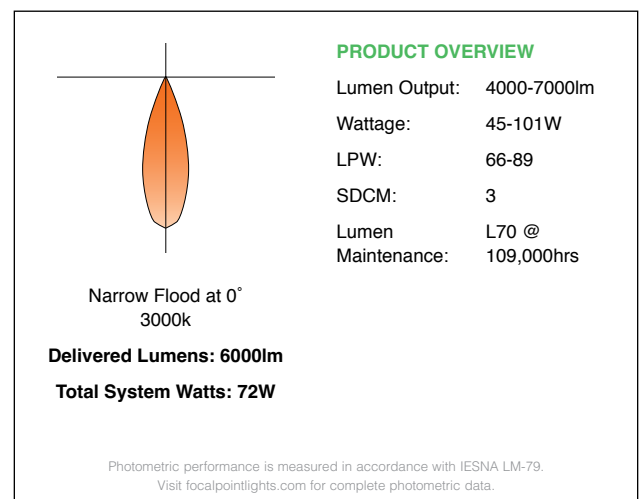

fixture:

project:

HOUSING DETAILS

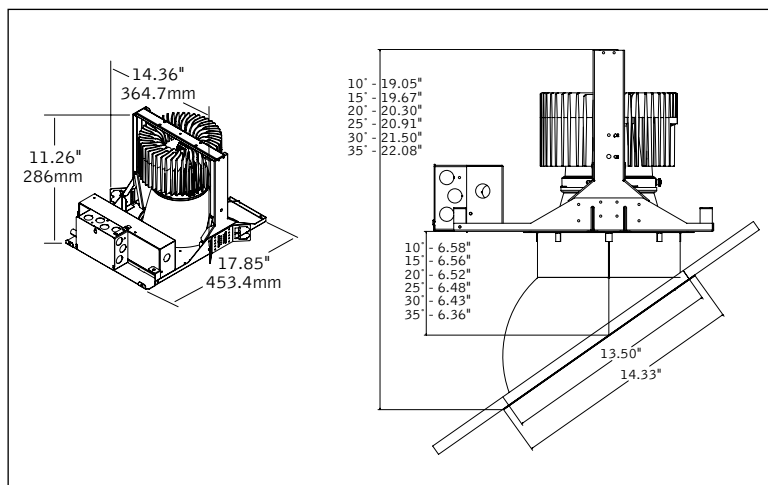

HOUSING SPECIFICATIONS

LED System

Proprietary array incorporates premium LEDs on a robust platform. Aluminum heat sink provides appropriate thermal management.

LED Module

Module may be specified in 3000K, 3500K or 4000K, CRI>80. Color accuracy within 2 SDCM. Cree LED features EasyWhite technology for maximum efficacy, color consistency and optical control.

Construction

Thermally protected housing for new construction applications. Insulation to be kept 3" away from housing. Butterfly brackets allow mounting to 1/2 emt. Die-cast aluminum heat sink designed for maximum thermal dissipation. Die-formed housing and integral junction box with (7) 1/2" pry outs. Standard accommodates ceiling thicknesses up to 1" standard, field adjustable up to 3" thickness. Sloped Ceiling accommodates ceiling thicknesses up to 1". For thicker ceiling consult factory. 18" O.C. fixture to wall and 36" O.C. fixture to fixture spacing required. Unit weight: 17.4 lbs.

Electrical

Choice of constant current dimming drivers. Power factor > .9 typical.

Emergency Battery

Bodine BSL17-C2. Emergency output—7W for 90 minutes for all available models.

Labels

UL and cUL listed. Suitable for Dry or Damp Locations, indoor use only.

Lumen Maintenance

Calculated: L70 at 109,000 hours
Derived from EPA TM-21 calculator

Reported: L70 at >37,000 hours

Warranty

LED System rated for operation in ambient environments up to 45°C. 5-year limited warranty.

TRIM SPECIFICATIONS

Aesthetics

Parabolic reflector cone ensures glare free optics. Reflector is .050 spun aluminum. Torsion springs pull trim tight to the ceiling with no visible fasteners within the trim. Trims are self-flanged. Non-painted trim matches reflector finish. White painted flange may also be specified. Sloped Ceiling adaptor is .055 spun aluminum self-flanged painted white.

Optics

50-degree cut-off to light source and its image.

PERFORMANCE CHART

See page 3

HOUSING ORDERING

Housing Series		FL8H
ID+ 8" Round	FL8H	
Trim Type		RO
Round Overlap	RO	
Lumen Output		
4000 Lumens	4000L	
5000 Lumens	5000L	
6000 Lumens	6000L	
7000 Lumens	7000L	
Color Temperature		
3000K	30K	
3500K	35K	
4000K	40K	
Distribution		
Narrow Flood	NFL	
Flood	FL	
Wide Flood	WFL	
Very Wide Flood	VWFL	
Voltage		
120V	120	
277V	277	
Driver		
0-10V - 1% Dimming	L11	
0-10V - 0% Dimming	LZ1	
DALI - 1% Dimming	D11	
DMX/RDM - 1% Dimming	X11	
Housing Type		T
Thermally Protected, Non-IC	T	
Factory Options		
Chicago Plenum	CP	
Emergency Battery Pack with Remote Test Switch	EMR	
(Above ceiling access only, Not available with Sloped Ceiling Kits.)		
TRIM ORDERING		
Aperture		L8H
8" Round Reflector	L8H	
Trim Type		RD
Round	RD	
Optic		DN
Downlight	DN	
Color		CD
Clear Diffuse	CD	
Flange Finish		
Non-Painted	NP	
White Painted	WP	

ACCESSORIES

(Leave blank for standard ceiling applications)

10° Sloped Ceiling Kit	FL8H-10SC
15° Sloped Ceiling Kit	FL8H-15SC
20° Sloped Ceiling Kit	FL8H-20SC
25° Sloped Ceiling Kit	FL8H-25SC
30° Sloped Ceiling Kit	FL8H-30SC
35° Sloped Ceiling Kit	FL8H-35SC

A complete unit consists of two or three line items, housing, trim and optional accessories
Example: FL8H-RO-6000L-30K-NFL-120-L11-T | L8H-RD-DN-CD-NP | FL8H-25SC

PERFORMANCE CHART

Optic	Delivered Lumens	System Watts	Distribution	Beamspread	Center Beam Candlepower (CBCP)
Downlight	4000 Lumens	45	NFL	30°	12553
		48	FL	40°	6665
		51	WFL	50°	5298
		52	VWFL	60°	4565
	5000 Lumens	58	NFL	30°	15503
		62	FL	40°	8328
		66	WFL	50°	6615
		67	VWFL	60°	5704
	6000 Lumens	72	NFL	30°	18120
		76	FL	40°	10003
		82	WFL	50°	7942
		83	VWFL	60°	6844
	7000 Lumens	87	NFL	30°	21154
		92	FL	40°	11631
		99	WFL	50°	9278
		101	VWFL	60°	7967

*Tested with 3000K, Clear Diffuse Reflector. Lumen output may vary +/- 5%. Actual wattage may vary +/- 5%