

# Equation™ 2 1x4

LED

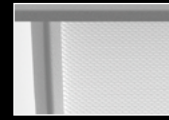

opal acrylic lens



MicroGlow lens

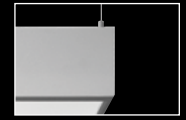

suspended or surface mount

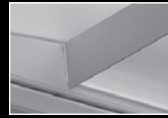

air return

## DIMENSIONAL DATA

2000 - 5000 Lumens

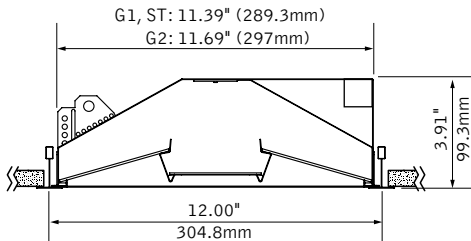

5500 - 6500 Lumens  
thermal protector required

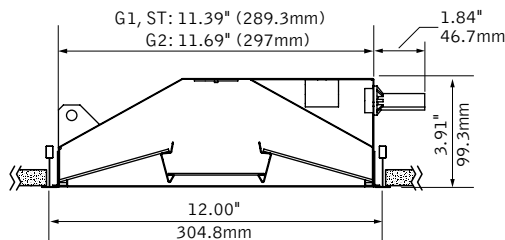

Overall height of luminaire with air return is 4.62"– 4.89"

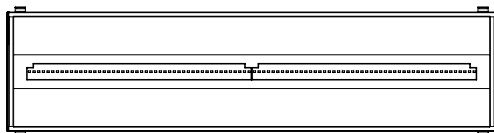

2 LED boards

## FEATURES

Equation™ 2 blends sleek aesthetics with uniform diffuse illumination.

Center diffuser features MicroGlow prismatic lens for brightness control and visual comfort. Opal acrylic center lens may also be specified.

Premium LEDs operate efficiently to achieve excellent thermal management and reliable operation.

Connected Solutions: Integrates with wired and wireless building lighting control systems.

Preferred Light: Lighting for better color rendition and human preference.

PoE compatible: Integrates with Power over Ethernet lighting systems via standard, low-voltage wires.

## PERFORMANCE

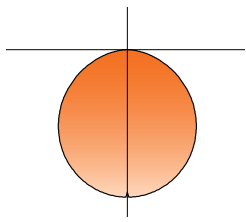

**PRODUCT OVERVIEW**

Lumen Output: 2000-6500lm

Wattage: 19-68W

LPW: 89-109

SDCM: 3

Opal Acrylic Lens

**Delivered Lumens: 3500lm**

**Total System Watts: 37W**

Photometric performance is measured in accordance with IESNA LM-79. Visit focalpointlights.com for complete photometric data.

fixture:

project:

**MOUNTING INFORMATION**

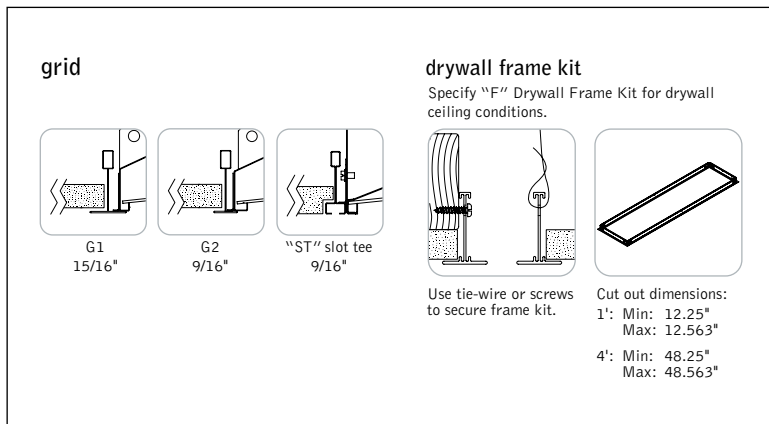

**SPECIFICATIONS**

**LED System**

Proprietary linear LED module incorporates premium LEDs on a robust platform to achieve excellent thermal management. LEDs are placed to promote a uniform appearance. Available in 2700K, 3000K, 3500K or 4000K with CRI>80 or CRI>90, 3SDCM. 3500K and 4000K with CRI>90 have a cyanosis observation index (COI) of 3.3 or less. Contact factory for additional color temperature and CRI options. 0-10V dimming driver standard. LED modules and drivers are replaceable from below.

**Construction**

One-piece 24 Ga. steel reflector and housing. Bottom access 24 Ga. steel driver compartment. Positional brackets supplied as standard. Standard weight: 19.4 lbs. Surface-mount/suspended weight: 24.2 lbs.

**Optic**

24 Ga. steel reflectors finished in matte satin white powder coat. .080" thick frosted white acrylic diffusers. Center shielding options include .080" thick opal acrylic lens or MicroGlow prismatic lens with optical filter overlay.

**Electrical**

Standard 120-277V driver includes 0-10V analog dimming. Power factor > .9. Optional DALI, Lutron EcoSystem or Step-dimming drivers available. PoE compatible: Integrates with Power over Ethernet lighting systems via standard, low-voltage wires.

**Emergency**

Emergency battery output—10 watts for 90 minutes. Emergency Circuit with Connected Solutions (NLT1, ENL1, CLM1, DLM1) requires a UL924 compliant device, consult factory.

**Labels**

UL and cUL listed. Suitable for Dry or Damp Locations, indoor use only.

**Finish**

Polyster powder coat applied over a multi-stage pre-treatment.

**Lumen Maintenance**

Reported: L70 at >61,000 hours      Calculated: L70 at 480,000 hours  
L80 at >61,000 hours                  L80 at 285,000 hours  
(Derived from EPA TM-21 calculator. Based on typical conditions, consult factory for additional data.)

**Reliability**

At Focal Point, our products are designed to stand the test of time. Each luminaire is engineered using superior components, manufactured with the utmost care and rigorously tested. Contact us for reliability data.

**Warranty**

LED system rated for operation in ambient environments up to 25°C. 5-year limited warranty.

**PERFORMANCE CHART**

Lumen Output	Tested System Watts	LPW	Lumen Output	Tested System Watts	LPW
2000	17	113	4500	41	107
2500	22	111	5000	46	107
3000	27	110	5500	60	92
3500	32	109	6000	67	89
4000	36	108	6500	76	86

Based on 3500K, 80 CRI, Opal Acrylic Lens. Lumen multipliers: Preferred Light = 0.65, 90+ CRI = 0.87, MicroGlow Prismatic Lens = 0.95. Lumen output may vary +/- 5%. Actual wattage may vary +/- 5%.

**ORDERING**

**Luminaire Series**

Equation 2 FEQ2

**Nominal Size**

1' x 4' 14

**Shielding**

Opal Acrylic Lens AC

MicroGlow Prismatic Lens MG

**Lumen Output**

2000 Lumens 2000L

2500 Lumens 2500L

3000 Lumens 3000L

3500 Lumens 3500L

4000 Lumens 4000L

4500 Lumens 4500L

5000 Lumens 5000L

5500 Lumens\* 5500L

6000 Lumens\* 6000L

6500 Lumens\* 6500L

(\*Grid, Slot Tee Only)

**Color Temperature**

2700K, 80+ CRI or 90+ CRI 27K or 927K

3000K, 80+ CRI or 90+ CRI 30K or 930K

3500K, 80+ CRI or 90+ CRI 35K or 935K

4000K, 80+ CRI or 90+ CRI 40K or 940K

3500K, Preferred Light P35K

**Circuit**

Single Circuit 1C

**Voltage**

UNV 120/277 Volt UNV

(Not available with 5500L, 6000L & 6500L)

120 Volt 120

277 Volt 277

347 Volt 347

(Not available with SD5, DLM1 or NLT1.

ENL1, CLM1 recessed grid only.

Transformer required for all drivers except LD1.)

Low Voltage LV

**Control System & Dimming Level**

0-10V - 10% Dimming LD1

0-10V - 1% Dimming L11

Low Voltage, PoE compatible LVN

(No driver. Not available with EM, LV Voltage only)

Lutron Hi-Lume EcoSystem (LDE1) -

1% Dimming LH1

Step Dimming SD5

DALI - 1% Dimming D11

Acuity nLight - 1% Dimming NLT1

(Not available with EM or CP)

Enlighted Smart Sensor - 1% Dimming ENL1

(Cannot combine with 347V & EM.)

Encelium CLM Connected Lighting

Module - 1% Dimming CLM1

(Compatible with Encelium X Light Management System.

Cannot combine with 347V & EM.)

Wattstopper DLM - 1% Dimming DLM1

**Mounting**

24" Aircraft Cable C24

48" Aircraft Cable C48

96" Aircraft Cable C96

Drywall Frame Kit F

(NLT1, ENL1, CLM1 & DLM1 not available)

(Cut out dimensions: Min: 12.25"/Max: 12.563"

15/16" Grid G1

9/16" Grid G2

Slot Tee ST

Surface Mount SM

(NLT1 & DLM1 not available)

**Factory Options**

Air Return AR

(Overall height with Air Return is 4.62"-4.89")

Chicago Plenum CP

Emergency Battery

with Integral Test Switch EM

(Cannot combine with 347V)

6' New York City Flex Whip (120V) FNY1

6' New York City Flex Whip (277V) FNY2

6' Flex Whip FW

**Finish**

Matte Satin White WH



Options in orange qualify for the Quickship program. 5-day up to 50 pieces, 10-day up to 150 pieces. Refer to Quickship Guide for complete details.

Focal Point provides flexibility in meeting the needs of each project by integrating with several building lighting control systems. A variety of sensors, drivers and other components can be specified that allow the luminaires to communicate with wired and wireless networks. All zoning can be digitally reconfigured through the application software. Daylight harvesting, occupancy sensing, integration with HVAC systems, and individual controls enable the monitoring and modulating of light levels and temperature in order to save energy, reduce costs and maximize occupants' comfort. All Connected Solutions luminaires require a compatible building control system.†

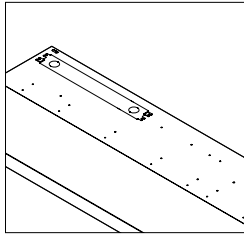

nLight® provides a two-way wired digital lighting system allowing for on/off and dimming functionality, occupancy sensing, and multi-zone daylight harvesting.

Acuity nLight - 1% Dimming (NLT1)  
Acuity Model #nEPS-60-IO

CAT-5 Cable provided by others. Serial labels will be provided on outside of luminaires and control unit.



Enlighted smart sensor allows for occupancy sensing, daylight harvesting, energy usage, temperature and light level control. Communicates wirelessly with the Enlighted network.

Enlighted Smart Sensor - 1% Dimming (ENL1)  
Enlighted Model #SU-5E-IOT



Encelium's Connected Lighting Module (CLM) is fully compatible with the Encelium X Light Management System, as well as with 0-10V and DALI based LED drivers to allow for individual luminaire control, including on/off and dimming functionalities, occupancy sensing, and multi-zone daylight harvesting.

Encelium CLM - 1% Dimming (CLM1)  
Encelium Model #ZBHA-CLM-DIM-ENC

Serial labels will be provided on outside of luminaires and control unit.

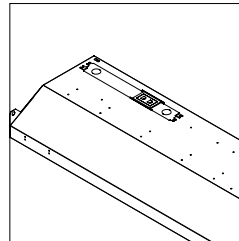

A Digital Lighting Management (DLM) system that provides two-way wired communication between networked luminaires and control system to allow for on/off and dimming functionality, occupancy sensing and multi-zone daylight harvesting.

Wattstopper DLM - 1% Dimming (DLM1)  
Wattstopper Model #LMFC-011

CAT-5 Cable provided by others. Serial labels will be provided on outside of luminaires and control unit.

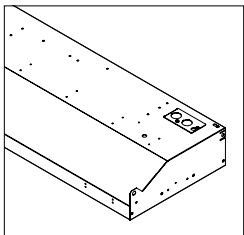

A two-way digital network that enables on/off and dimming functionality, occupancy sensing, and multi-zone daylight harvesting working with Quantum®, Energi Savr Node™, and Energi TriPak® using EcoSystem® communication protocol.

Lutron Hi-Lume EcoSystem - 1% Dimming (LH1)  
Lutron Model #LDE1

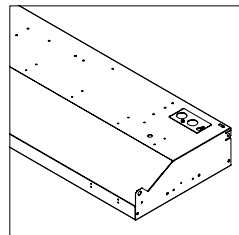

A two-way digital network that enables on/off and dimming functionality, occupancy sensing, and multi-zone daylight harvesting. Communicates with Züm wireless and SpaceBuilder working with Züm hub scheduling or FUSION management.

DALI - 1% Dimming (D11)  
0-10V - 1% Dimming (L11)

Note: 0-10V is not a digital network but is compatible with Creston Züm™ system.

## CONNECTED SOLUTIONS DETAILS

Connected Solution	Model #	Protocol	Compatible Networks*	Occupancy	Daylight	Temperature Reporting	Communication to Luminaire	Drivers
Acuity nLight (NLT1)	nEPS-60-IO**	nLight	nLight	Enabled	Enabled	No	Wired	<b>eldoLED ECOdrive</b> , eldoLED SOLOdrive
Crestron (D11, L11)	Specified Driver	DALI 0-10V	Crestron Züm Wireless & SpaceBuilder	Enabled	Enabled	No	Wired	<b>eldoLED ECOdrive (DALI)</b> , <b>Advance by Signify (0-10V)</b>
Enlighted Smart Sensor (ENL1)	SU-5E-IOT**	Enlighted RF	Enlighted	Integrated	Integrated	Yes	Wireless	<b>Advance by Signify</b>
Legrand Wattstopper DLM (DLM1)	LMFC-011**	DLM	DLM	Enabled	Enabled	No	Wired	<b>Advance by Signify</b> , Optotronic by eldoLED
Lutron EcoSystem (LH1)	LDE1**	EcoSystem	Quantum, Energi Savr Node, Energi TriPak	Enabled	Enabled	No	Wired	<b>Lutron Hi-Lume</b>
Encelium CLM Connected Lighting Module (CLM1)	ZBHA-CLM-DIM-ENC*	ZigBee	Encelium X Light Management System	Enabled	Enabled	No	Wireless	<b>Optotronic by eldoLED</b> Advance by Signify

\*Not all compatible networks may be listed. \*\*For performance data and additional control system details please visit the connected solutions manufacturer websites. Primary drivers are listed in bold. To specify a particular driver please consult factory. †Controls systems supplied by others.