

FOCAL POINT - GRID

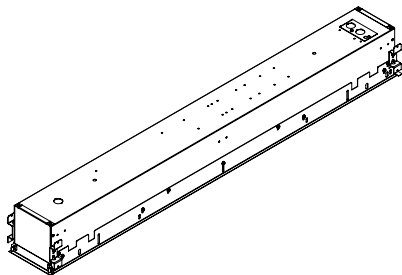

FOCAL POINT - DRYWALL

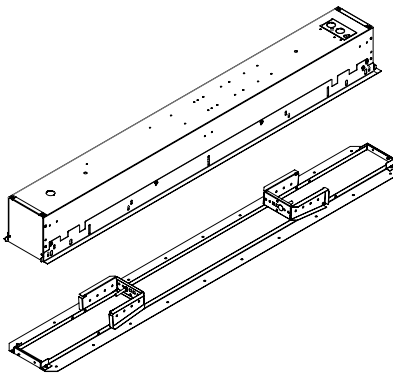

KEY



POWER OFF



POWER ON



ATTENTION

GRID INSTALLATION (SEE PAGE 3 FOR DRYWALL INSTALLATION)



4FT LUMINAIRE WEIGHT: 20LBS

5FT LUMINAIRE WEIGHT: 25LBS

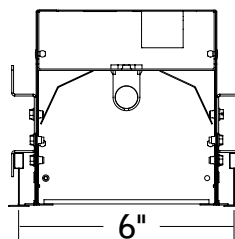

AVENUE 6 IS COMPATIBLE WITH ARMSTRONG® TECHZONE® AND OTHER SPECIALTY 6" CEILING SYSTEMS. TEE SPACING SHOULD BE 6" ON CENTER FOR ALL CEILING SYSTEMS.

RAIL & CLIP GUIDE



CHECK RAIL & CLIP POSITIONS BEFORE INSTALLATION. ARROWS INDICATE SCREW POSITIONS. TO CHANGE IN THE FIELD REMOVE AND REINSTALL ACCORDING TO DIAGRAMS BELOW.

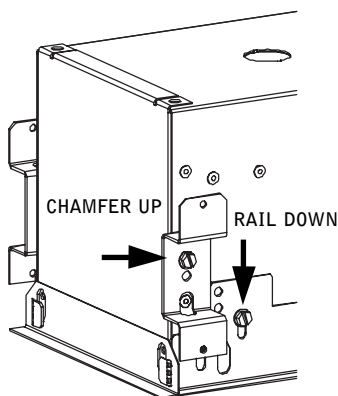

G1: STD 15/16" LAY-IN TILE
G2: STD 9/16" LAY-IN TILE

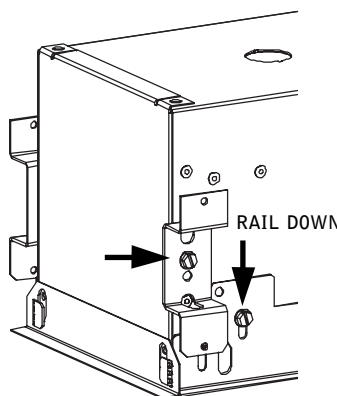

G4: TALL 15/16" LAY-IN TILE
G5: TALL 9/16" LAY-IN TILE

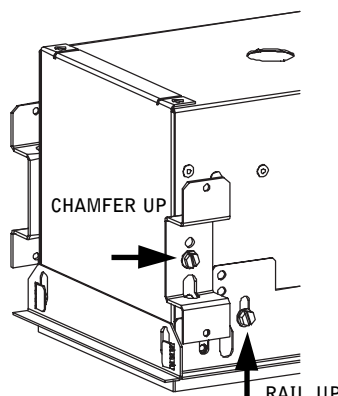

G3: 9/16" SLOT-TEE TEGULAR TILE
T1: STD 15/16" TEGULAR TILE
T2: STD 9/16" TEGULAR TILE
T6: 9/16" NODE TEGULAR TILE

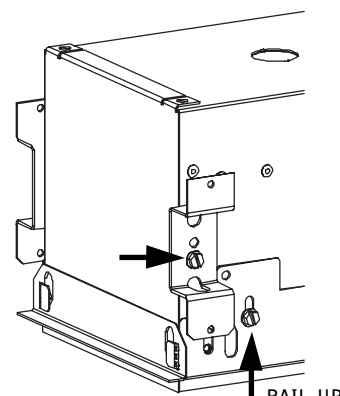

T4: TALL 15/16" TEGULAR TILE
T5: TALL 9/16" TEGULAR TILE



STD = 1-1/2" TEE HEIGHT, TALL = 1-11/16" TEE HEIGHT

Luminaires must be installed by a qualified electrician (check with local and national codes for proper installation).
To prevent electrical shock, disconnect electrical supply before installation or servicing.

GRID INSTALLATION (CONTINUED)

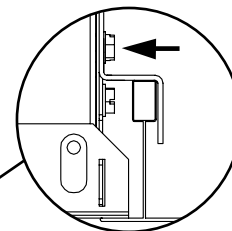
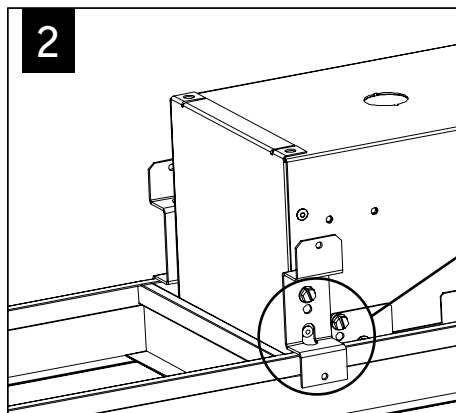
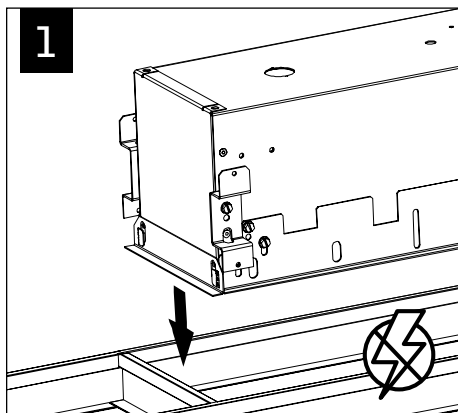

IF LUMINAIRE DOES NOT SIT FLUSH,
LOOSEN SCREWS TO ADJUST

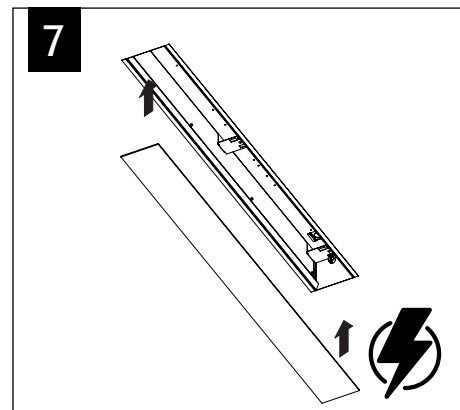
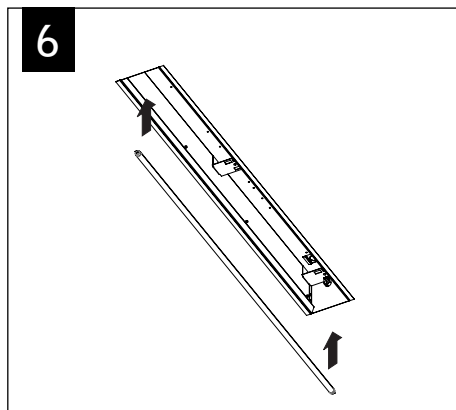
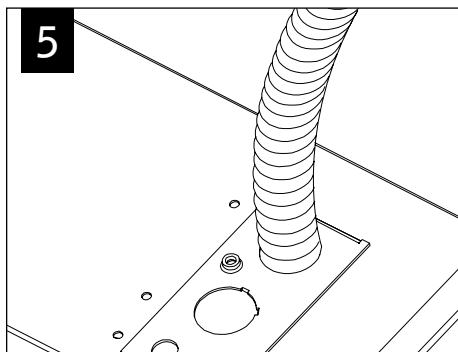
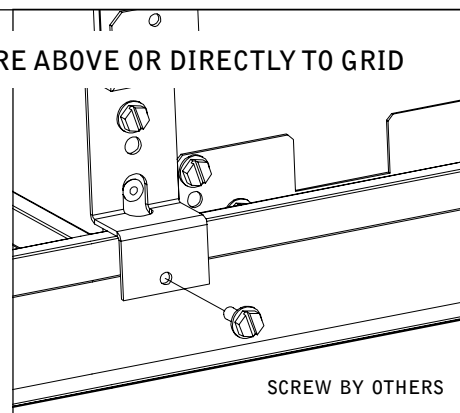
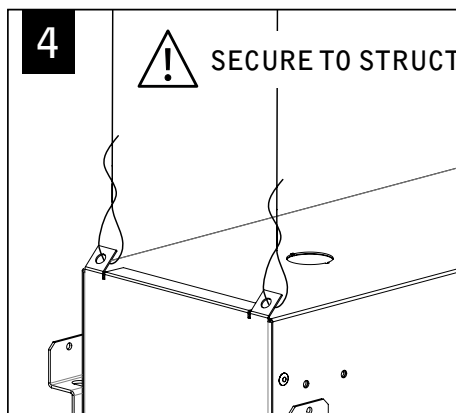
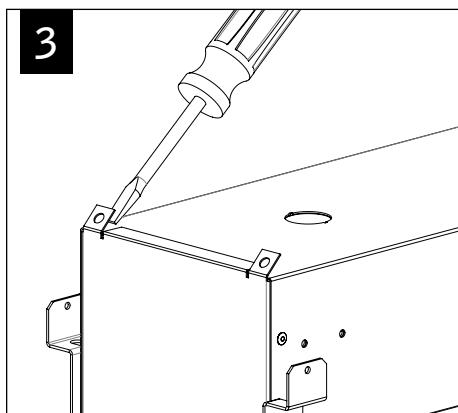

Luminaires must be installed by a qualified electrician (check with local and national codes for proper installation).
To prevent electrical shock, disconnect electrical supply before installation or servicing.

DRYWALL INSTALLATION



YOKE MUST BE
INSTALLED PRIOR
TO DRYWALL

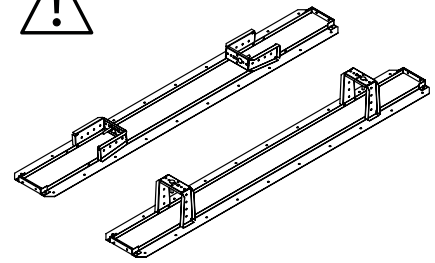
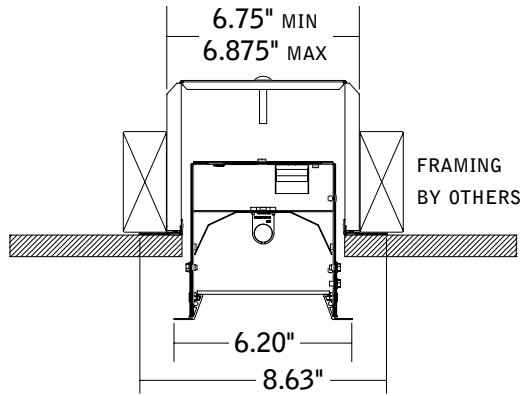

UNFOLD YOKES PRIOR TO INSTALLATION

1

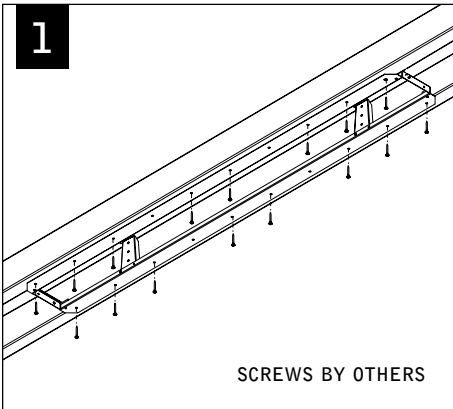

SCREWS BY OTHERS

ROW MOUNT (T5/T5HO LAMPS ONLY)

2

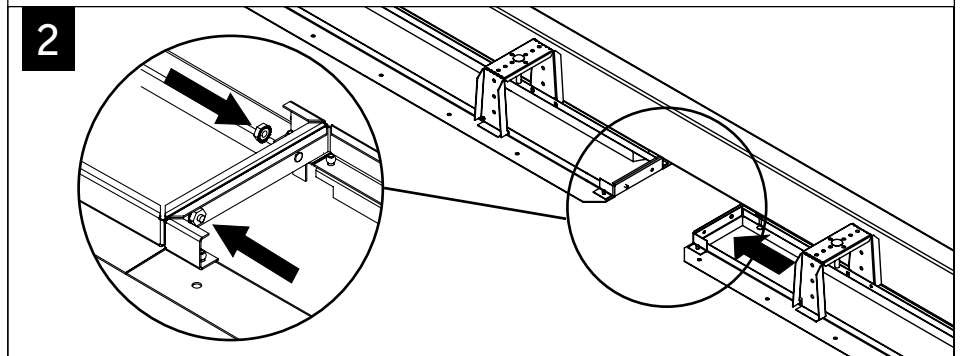

3

DRYWALL INSTALLATION

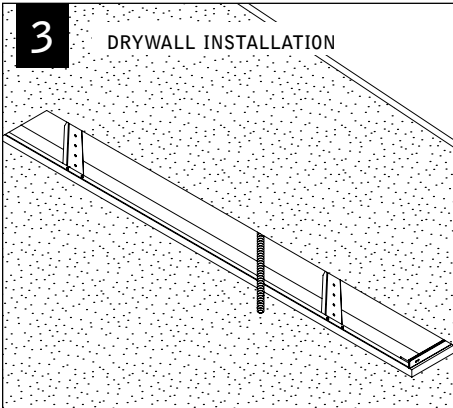

4

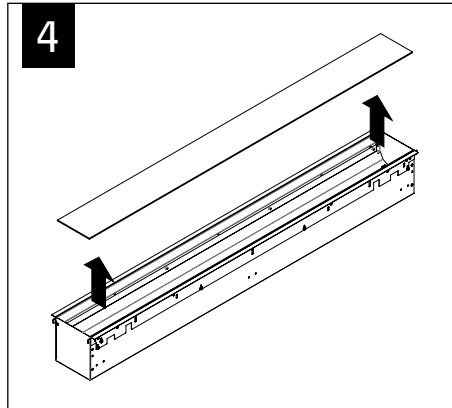

5

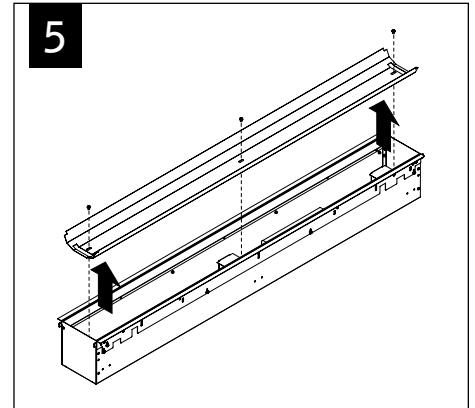

6

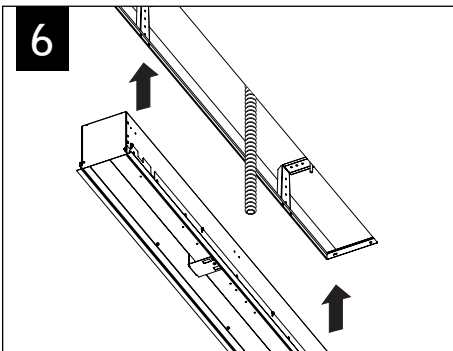

MAKE ELECTRICAL CONNECTIONS

7

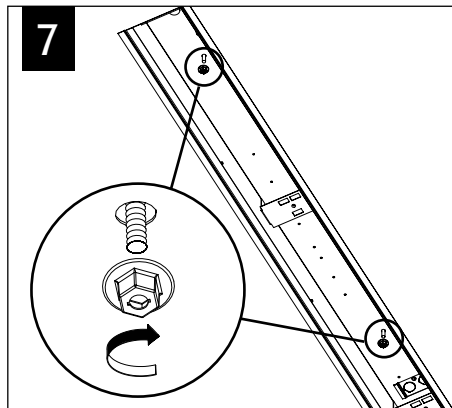

8

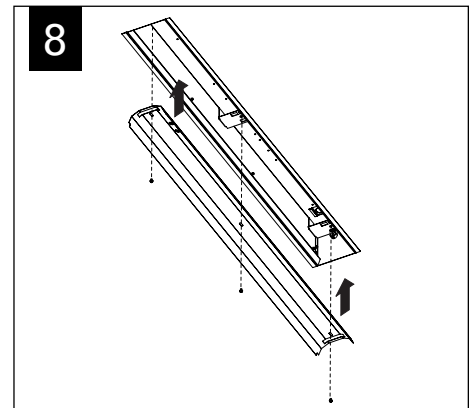

Luminaires must be installed by a qualified electrician (check with local and national codes for proper installation).
To prevent electrical shock, disconnect electrical supply before installation or servicing.

DRYWALL INSTALLATION (CONTINUED)

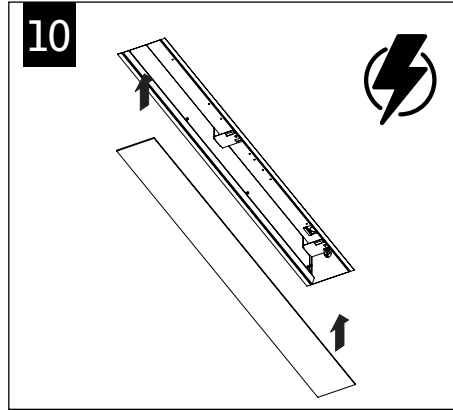
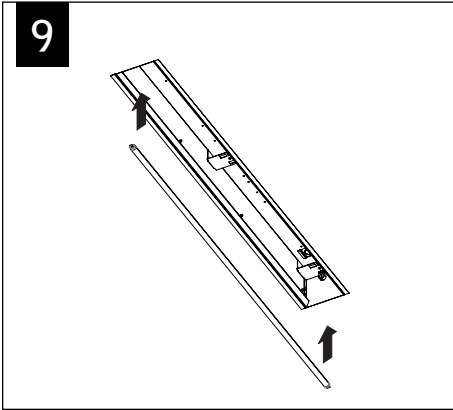

BALLAST SERVICE

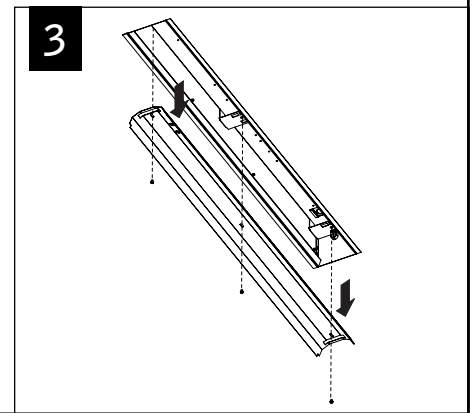
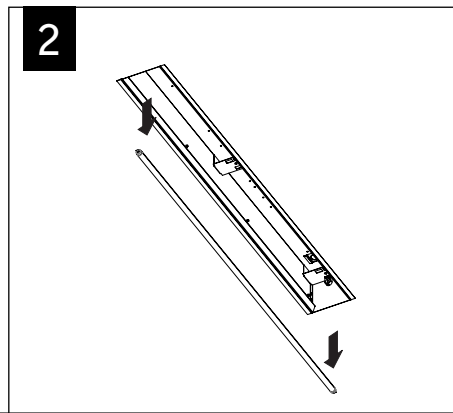
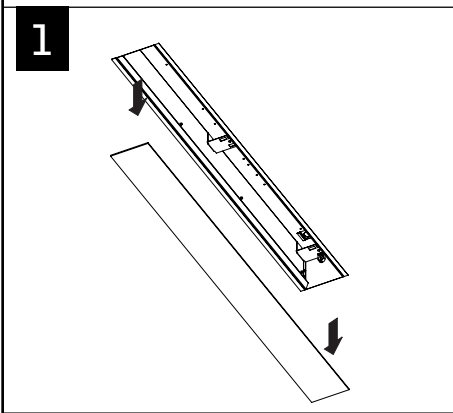

Contractor is responsible for adequately reinforcing walls and/or ceilings to support luminaire weight. Focal Point, LLC accepts no responsibility for inadequately reinforced walls and/or ceilings. The information contained in this drawing is the sole property of Focal Point, LLC. Any reproduction in part or whole without the written permission of Focal Point, LLC is prohibited.