

# avenue® 6 led

FAV6L

CONNECTED™  
SOLUTIONS



**⚠️ AVOID ALL CONTACT WITH LED SURFACE, LEDs ARE EASILY DAMAGED!**

FOCAL POINT - GRID

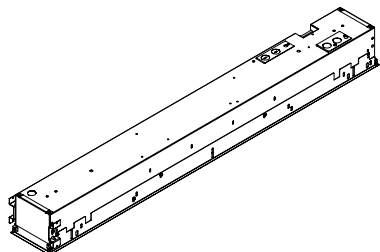

FOCAL POINT - DRYWALL

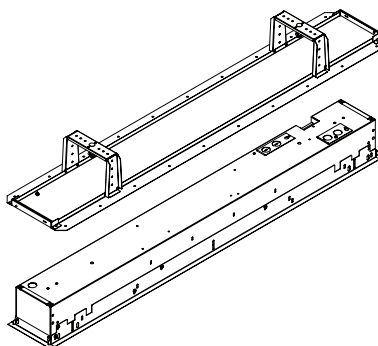

KEY



POWER OFF



POWER ON



ATTENTION

## GRID INSTALLATION (SEE PAGE 3 FOR DRYWALL INSTALLATION)



4FT LUMINAIRE WEIGHT: 20LBS

5FT LUMINAIRE WEIGHT: 25LBS

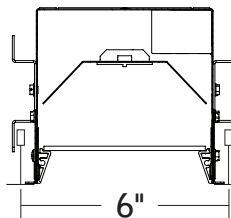

AVENUE 6 IS COMPATIBLE WITH ARMSTRONG® TECHZONE® AND OTHER SPECIALTY 6" CEILING SYSTEMS. TEE SPACING SHOULD BE 6" ON CENTER FOR ALL CEILING SYSTEMS.

## RAIL & CLIP GUIDE



CHECK RAIL & CLIP POSITIONS BEFORE INSTALLATION. ARROWS INDICATE SCREW POSITIONS. TO CHANGE IN THE FIELD REMOVE AND REINSTALL ACCORDING TO DIAGRAMS BELOW.

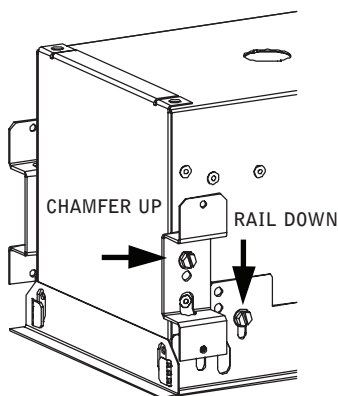

G1: STD 15/16" LAY-IN TILE  
G2: STD 9/16" LAY-IN TILE

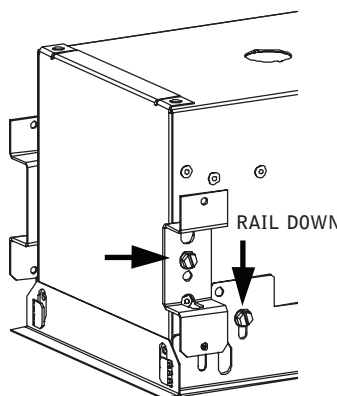

G4: TALL 15/16" LAY-IN TILE  
G5: TALL 9/16" LAY-IN TILE

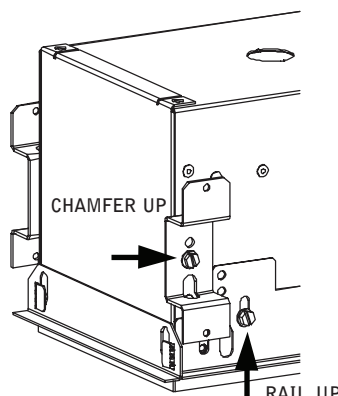

G3: 9/16" SLOT-TEE TEGULAR TILE  
T1: STD 15/16" TEGULAR TILE  
T2: STD 9/16" TEGULAR TILE  
T6: 9/16" NODE TEGULAR TILE

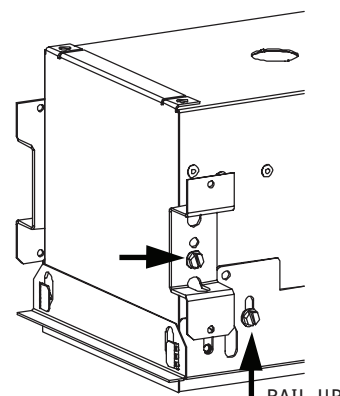

T4: TALL 15/16" TEGULAR TILE  
T5: TALL 9/16" TEGULAR TILE



STD = 1-1/2" TEE HEIGHT, TALL = 1-11/16" TEE HEIGHT

Luminaires must be installed by a qualified electrician (check with local and national codes for proper installation).  
To prevent electrical shock, disconnect electrical supply before installation or servicing.

## GRID INSTALLATION (CONTINUED)

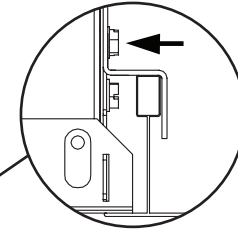
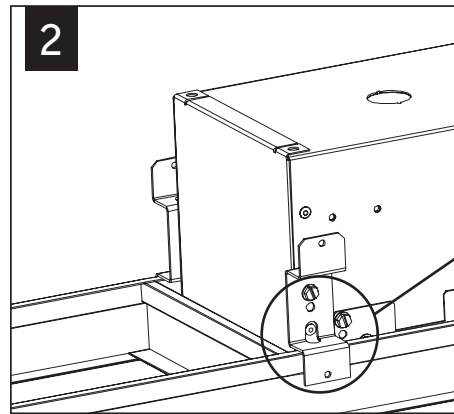
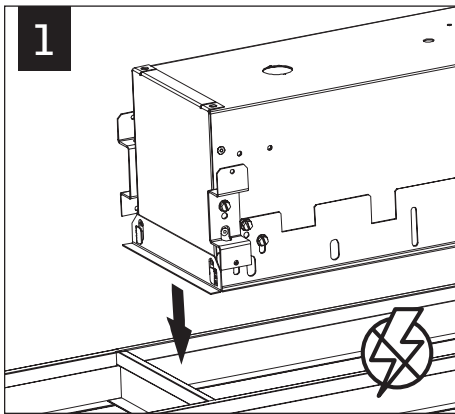

IF LUMINAIRE DOES NOT SIT FLUSH,  
LOOSEN SCREWS TO ADJUST

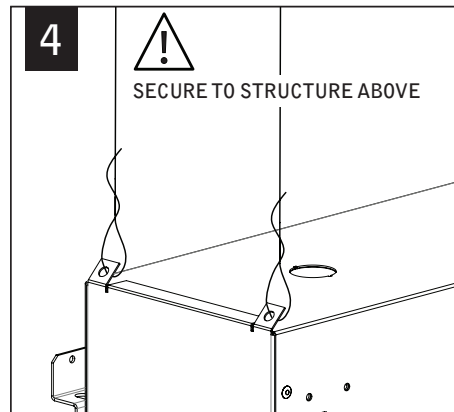
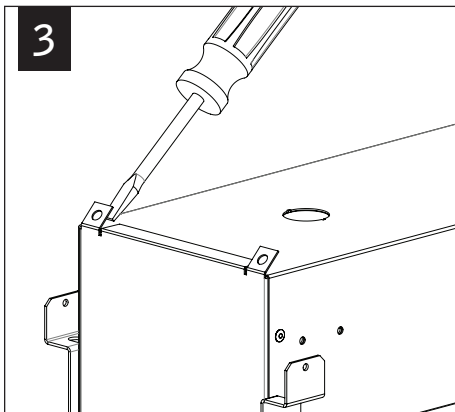

SECURE TO STRUCTURE ABOVE

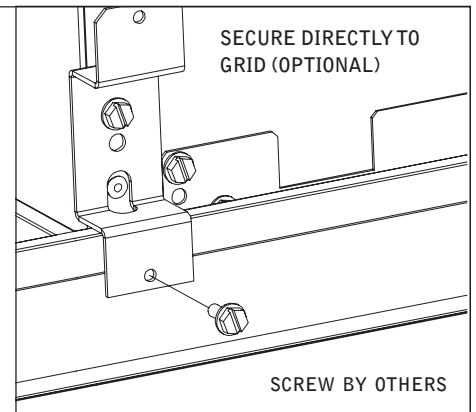

SECURE DIRECTLY TO  
GRID (OPTIONAL)

SCREW BY OTHERS

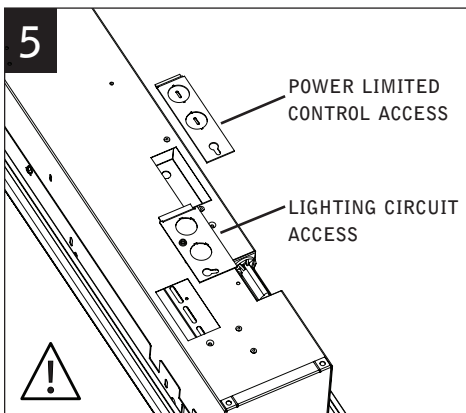

POWER LIMITED  
CONTROL ACCESS

LIGHTING CIRCUIT  
ACCESS

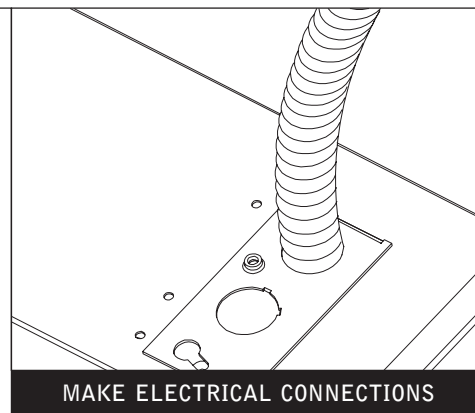

MAKE ELECTRICAL CONNECTIONS

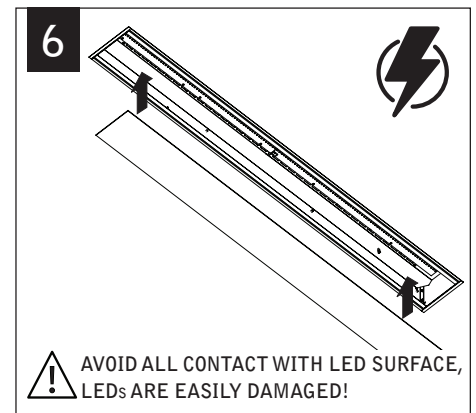

AVOID ALL CONTACT WITH LED SURFACE,  
LEDs ARE EASILY DAMAGED!

Luminaires must be installed by a qualified electrician (check with local and national codes for proper installation).  
To prevent electrical shock, disconnect electrical supply before installation or servicing.

# DRYWALL INSTALLATION



YOKE MUST BE  
INSTALLED PRIOR  
TO DRYWALL

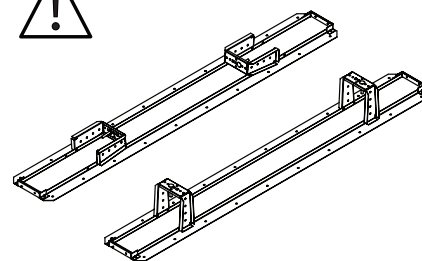
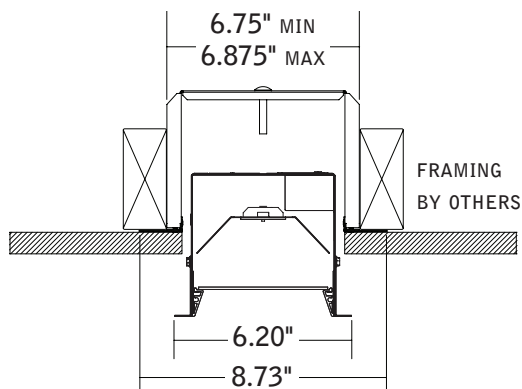

UNFOLD YOKES PRIOR TO INSTALLATION

1

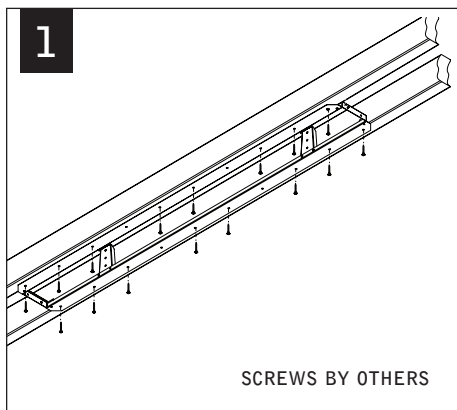

SCREWS BY OTHERS

2

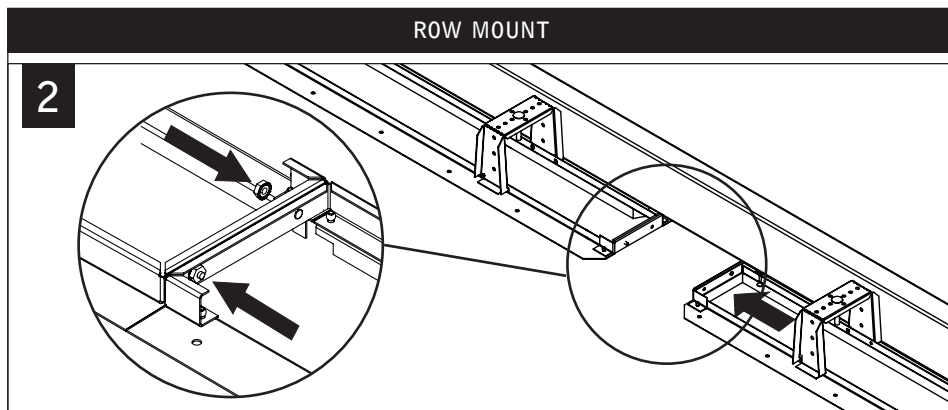

ROW MOUNT

3

DRYWALL INSTALLATION

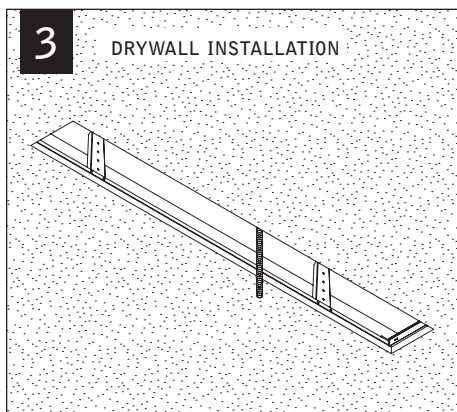

4

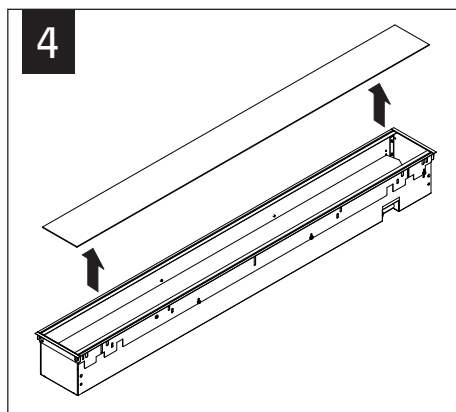

5

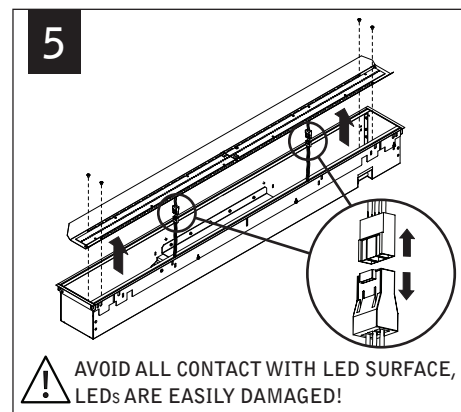

AVOID ALL CONTACT WITH LED SURFACE,  
LEDs ARE EASILY DAMAGED!

6

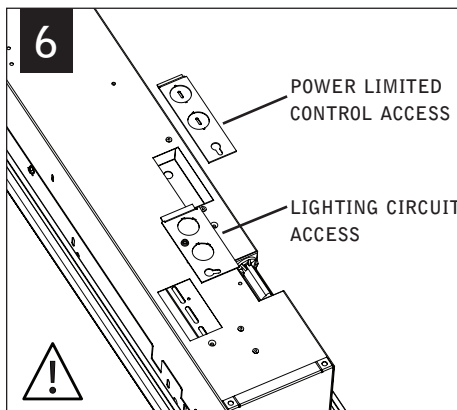

POWER LIMITED  
CONTROL ACCESS

LIGHTING CIRCUIT  
ACCESS

7

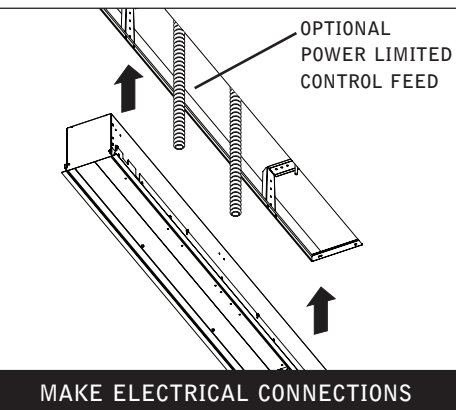

OPTIONAL  
POWER LIMITED  
CONTROL FEED

MAKE ELECTRICAL CONNECTIONS

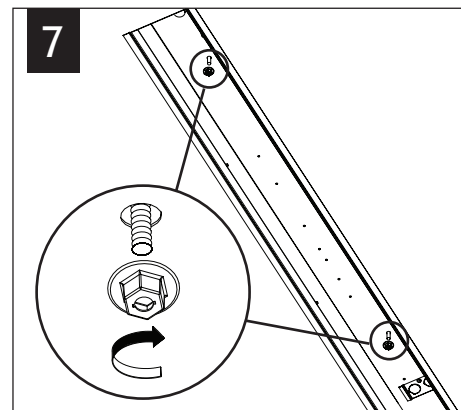

Luminaires must be installed by a qualified electrician (check with local and national codes for proper installation).  
To prevent electrical shock, disconnect electrical supply before installation or servicing.

## DRYWALL INSTALLATION (CONTINUED)

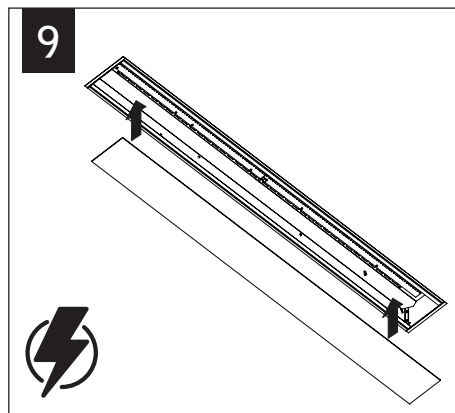
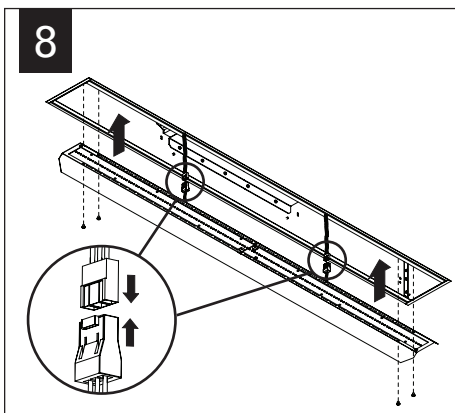

## DRIVER SERVICE

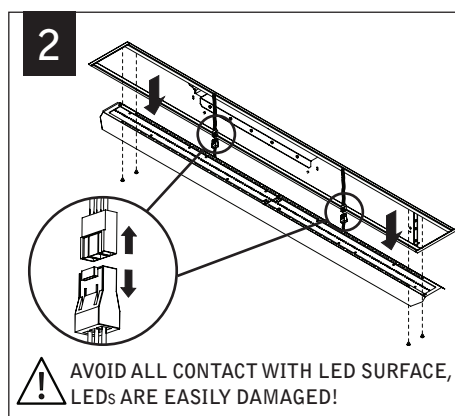
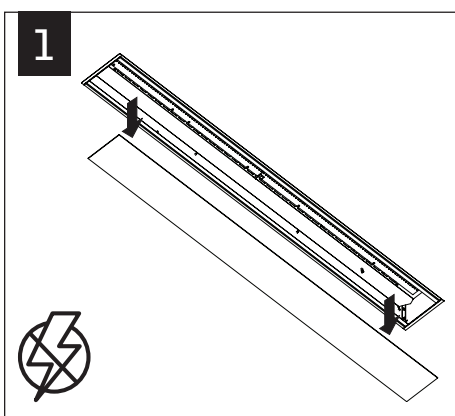

## EMERGENCY



SEE BATTERY MANUFACTURER  
INSTRUCTIONS

EMERGENCY MAXIMUM MOUNTING HEIGHT:  
20.00'

Luminaires must be installed by a qualified electrician (check with local and national codes for proper installation).  
To prevent electrical shock, disconnect electrical supply before installation or servicing.

## ACUITY nLIGHT

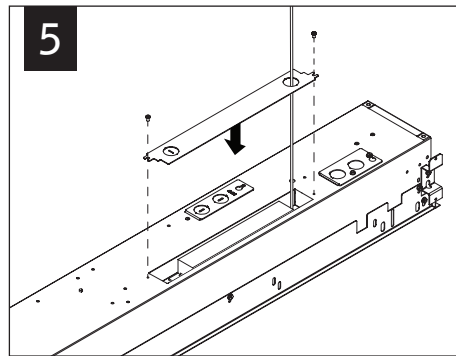
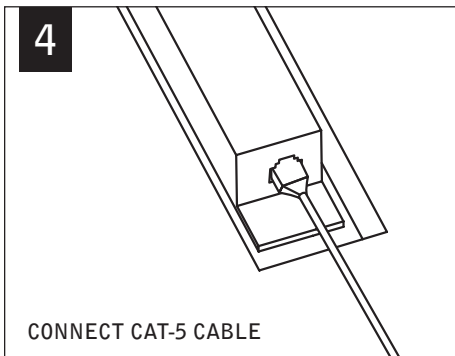
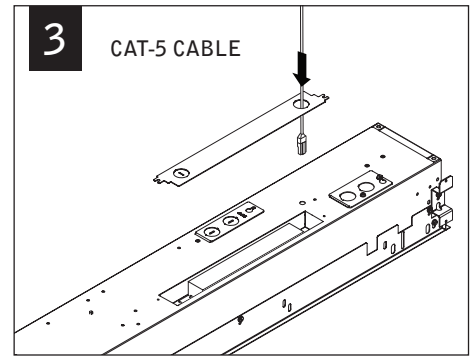
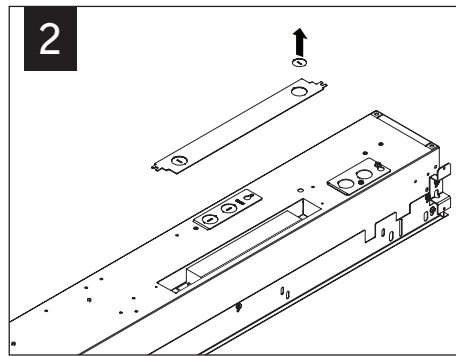
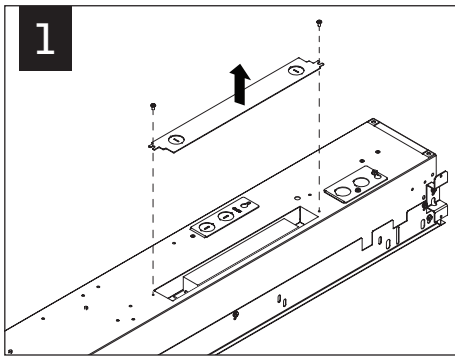

## WATTSTOPPER

