

⚠ AVOID ALL CONTACT WITH LED SURFACE, LEDs ARE EASILY DAMAGED!

FOCAL POINT

FLAT TEE (G1, G2)

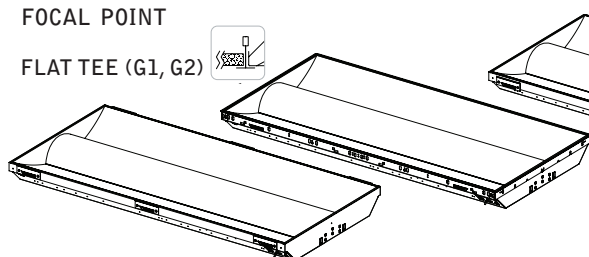

SLOT TEE (G3)

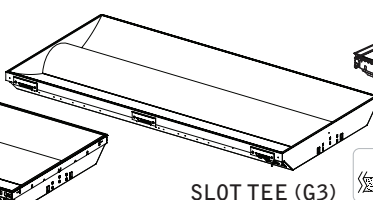

AIR RETURN (AR)

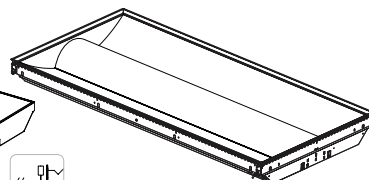

KEY



POWER OFF



POWER ON



ATTENTION

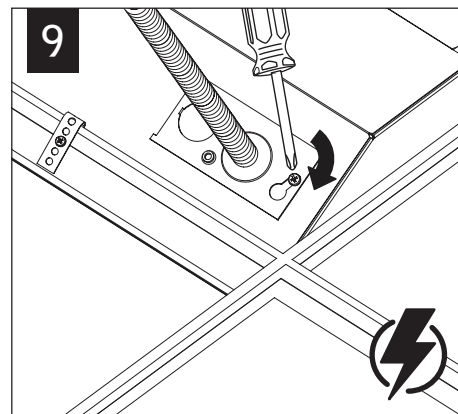
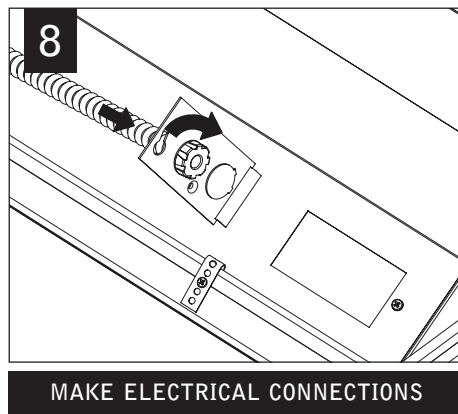
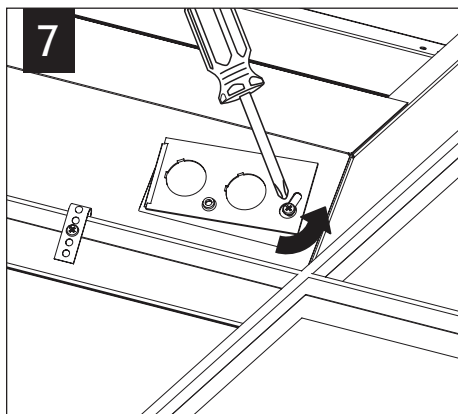
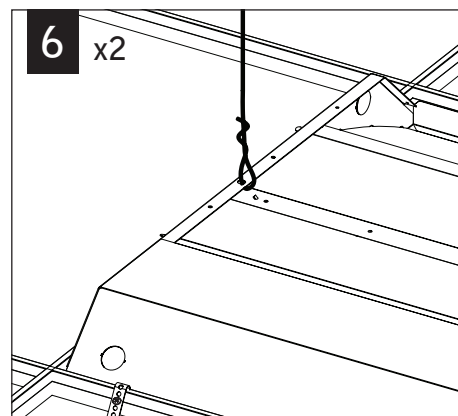
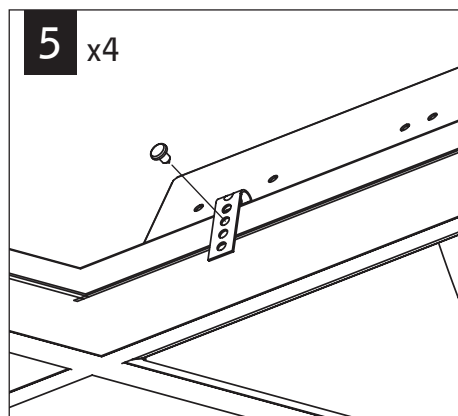
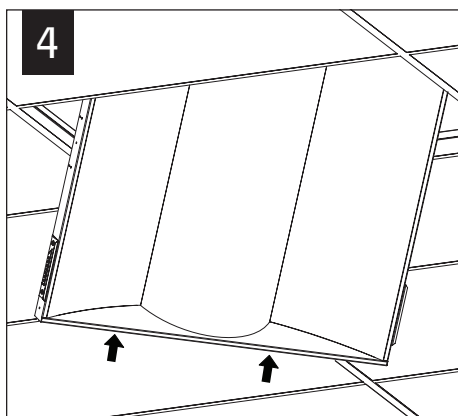
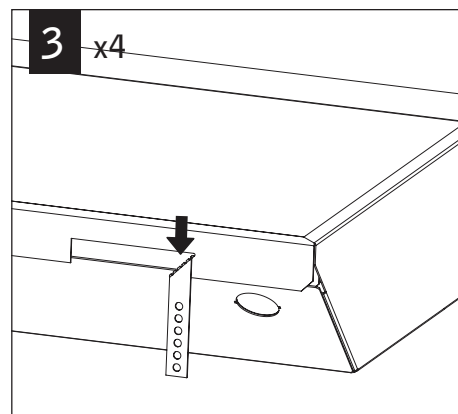
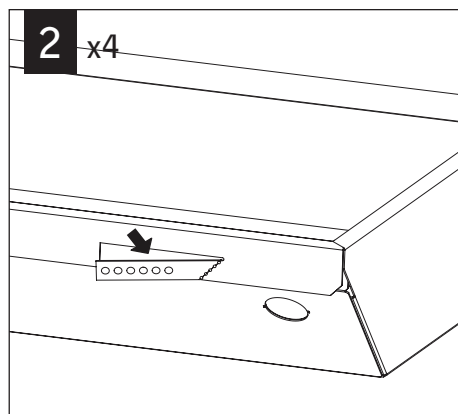
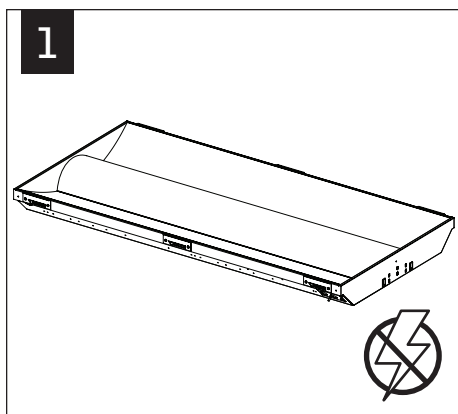

MAKE ELECTRICAL CONNECTIONS

Luminaires must be installed by a qualified electrician (check with local and national codes for proper installation).
To prevent electrical shock, disconnect electrical supply before installation or servicing.

SERVICE

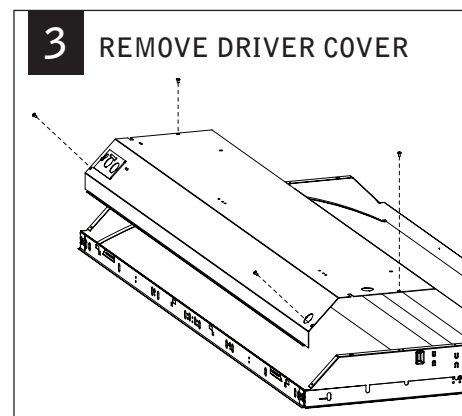
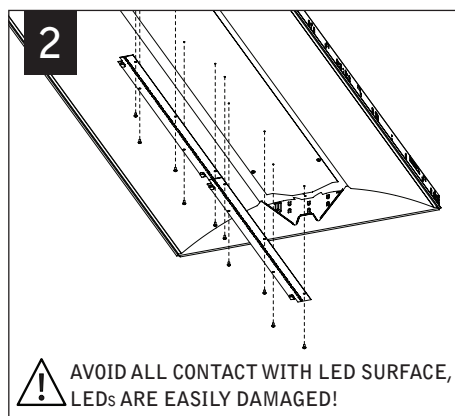
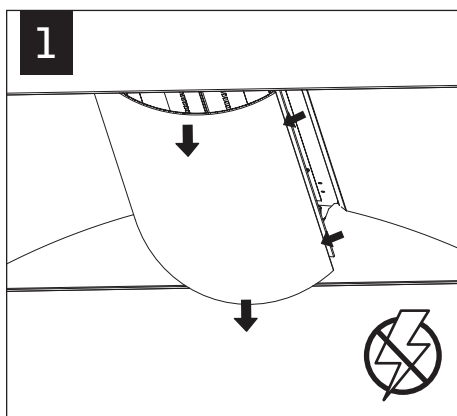

AIR RETURN INSTALLATION

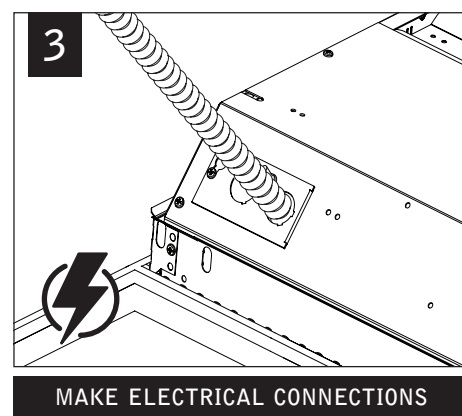
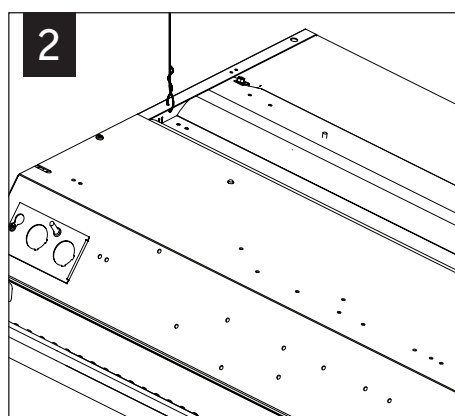
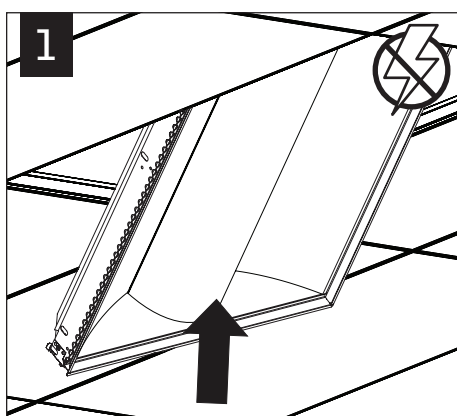

0-10V DIMMING & NON-DIMMING STANDARD WIRING

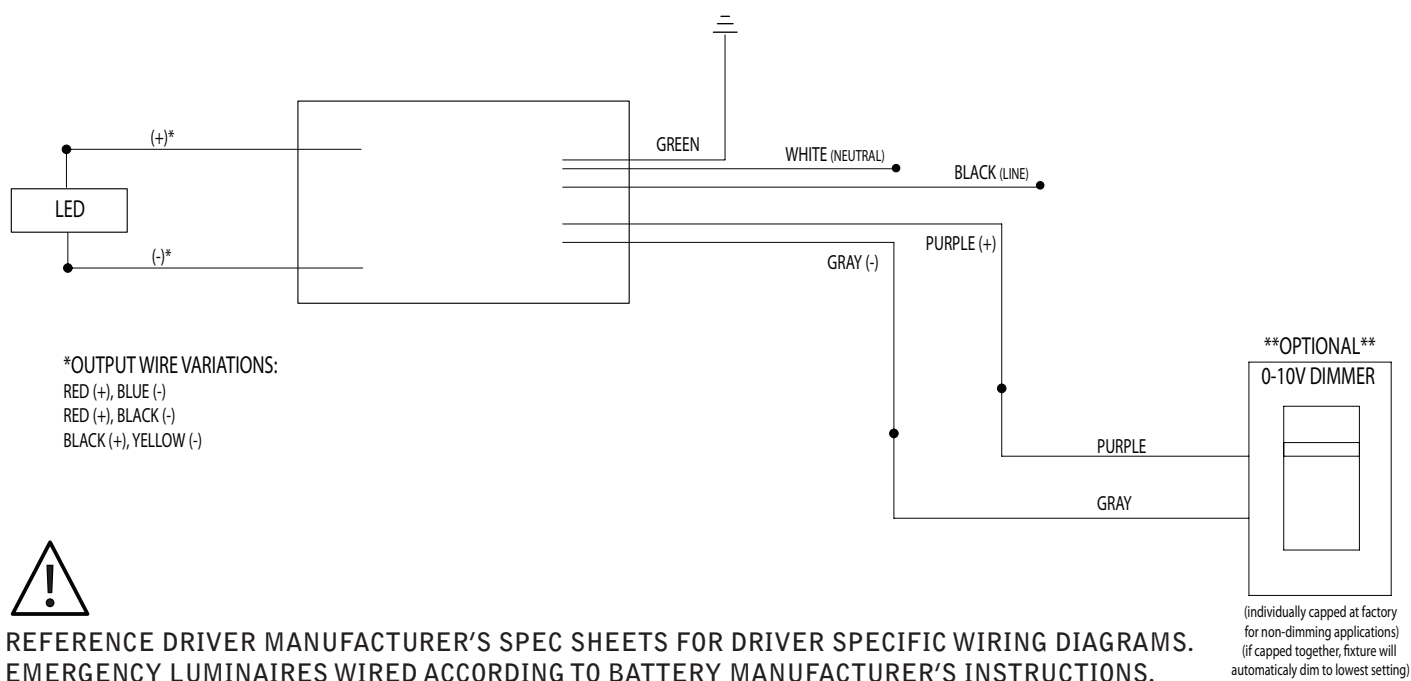

Contractor is responsible for adequately reinforcing walls and/or ceilings to support luminaire weight. Focal Point, LLC accepts no responsibility for inadequately reinforced walls and/or ceilings. The information contained in this drawing is the sole property of Focal Point, LLC. Any reproduction in part or whole without the written permission of Focal Point, LLC is prohibited.