

# Seem® 4

LED WALL TO CEILING CORNER

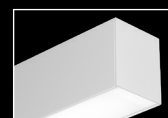

recessed  
companion



wall mount  
companion

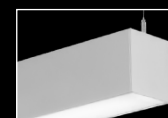

suspended  
companion



perimeter  
companion

## DIMENSIONAL DATA

### trimless mud-in

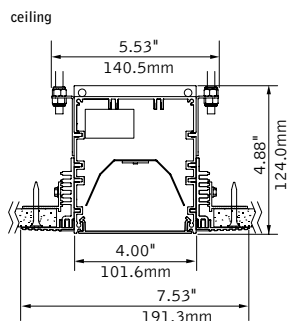

### hard surface

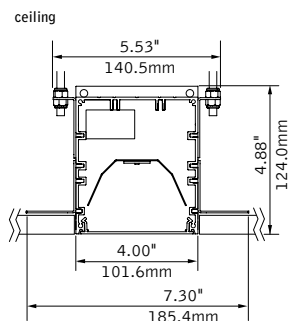

### wall mount

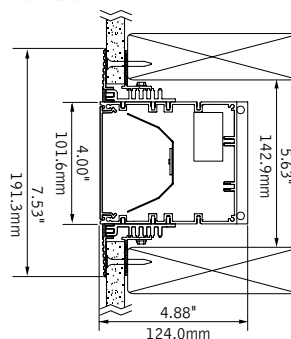

### wall mount

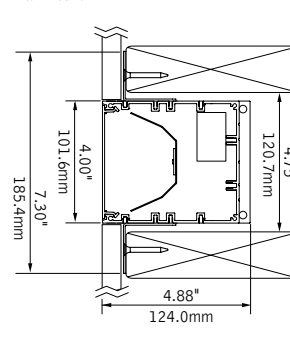

notes: designed for 2"x6" construction  
0.375"min - 2.125"max material thickness

## FEATURES

Narrow extruded aluminum 4" aperture recessed slot LED that transitions from wall to ceiling.

Clean and minimal trimless drywall mounting.

Frosted acrylic lens provides uninterrupted illumination, without pixels or shadows.

LED position and lens material optimized to provide the perfect blend of high performance and visual comfort.

Choice of output levels to meet a wide variety of application needs.

Tunable White: Supports human activity, well-being, and preferences with a light quality that evolves throughout the day.

## PERFORMANCE

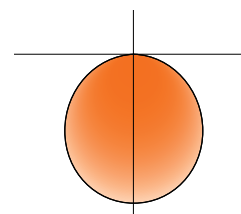

Flush Lens

Photometric performance is measured in accordance with IESNA LM-79.  
Visit [focalpointlights.com](http://focalpointlights.com) for complete photometric data.

fixture:

project:

DETAILS

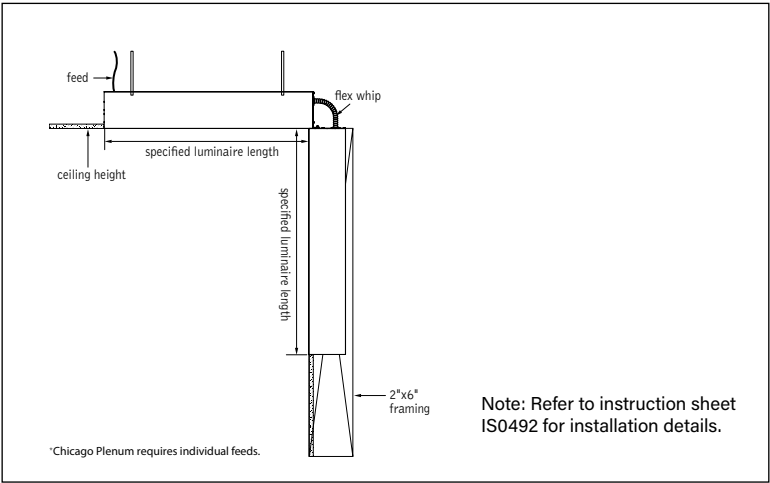

SPECIFICATIONS

LED System

Proprietary linear LED module incorporates premium LEDs on a robust platform to achieve excellent thermal management. LEDs are placed to promote a uniform appearance. Available in 2700K, 3000K, 3500K or 4000K with CRI>80 or CRI>90, 3 SDCM or Tunable White (2700K-6500K), CRI>80, >90. LED modules and drivers are replaceable from below.

Construction

One piece extruded aluminum housing, 20 Ga. steel end caps. Housing for new construction applications. XFW acceptable for use with wood, consult factory for Type IC availability. 2' unit weight: 18 lbs., 3' unit weight: 24 lbs., 4' unit weight: 30 lbs., 5' unit weight: 36 lbs.

Optic

Reflectors fabricated of 22 Ga. steel finished in High Reflectance White powder coat. Extruded acrylic lens .085" thick with satin finish, up to 8' continuous.

Electrical

Luminaires are pre-wired with factory installed branch circuit wiring and over-molded quick connects. Standard 120-277V constant current driver includes 0-10V analog dimming. Dimming range 100% to 10%.Power factor > .9.

Emergency

Output - 10 watts for 90 minutes. Maximum mounting height: 19.2ft. See EM/EC Guide for default locations and ordering details.

Labels

UL and cUL listed. Suitable for Dry or Damp Locations, indoor use only.

Finish

Polyester powder coat applied over a multi-stage pre-treatment.

Lumen Maintenance

Reported: L70 > 61,000 hours Calculated: L70 at > 480,000 hours  
L90 > 61,000 hours L90 at > 128,000 hours  
(Derived from EPA TM-21 calculator. Based on typical conditions, consult factory for additional data.)

Reliability

At Focal Point, our products are designed to stand the test of time. Each luminaire is engineered using superior components, manufactured with the utmost care and rigorously tested. Contact us for reliability data.

Warranty

LED system rated for operation in ambient environments up to 25°C. 5-year limited warranty.

4' PERFORMANCE CHART

Shielding	Lumen Output	Nominal Lumens	Tested System Watts	LPW
Flush Lens	275LF	1100	9.1	121
	375LF	1500	11.7	129
	625LF	2500	19.9	126
	875LF	3500	27.9	125
	1000LF	4000	32.2	124
	1125LF	4500	36.6	123
	1250LF	5000	41.2	121

Based on 3500K, 80 CRI, 4' lengths. Lumen multiplier: 90+ CRI = 0.87. Lumen output may vary +/- 5%. Actual wattage may vary +/- 5%

Focal Point LLC reserves the right to change specifications for product improvement without notification.

STANDARD WHITE		
Luminaire Series		FSM4L
Seem 4 LED	FSM4L	
Shielding		FL
Flush Satin Lens	FL	
Lumen Output		
275 Lumens per foot <small>(Not available with Lutron Drivers)</small>	275LF	
375 Lumens per foot <small>(Not available with LH1.)</small>	375LF	
625 Lumens per foot <small>(3' minimum with LH1.)</small>	625LF	
875 Lumens per foot	875LF	
1000 Lumens per foot	1000LF	
1125 Lumens per foot	1125LF	
1250 Lumens per foot	1250LF	
Color Temperature		
2700K, 80+ CRI <b>or</b> 90+ CRI	27K <b>or</b> 927K	
3000K, 80+ CRI <b>or</b> 90+ CRI	30K <b>or</b> 930K	
3500K, 80+ CRI <b>or</b> 90+ CRI	35K <b>or</b> 935K	
4000K, 80+ CRI <b>or</b> 90+ CRI	40K <b>or</b> 940K	
Circuit		1C
Single Circuit	1C	
Voltage		UNV
UNV 120/277 Volt	UNV	
Control System & Dimming Level		
0-10V - 10% Dimming	LD1	
0-10V - 1% Dimming	L11	
Lutron Hi-Lume EcoSystem (LDE1)		
- 1% Dimming	LH1	
DALI - 1% Dimming <small>(1000LF max.)</small>	D11	
Mounting		
Wall to Ceiling Corner, pre-set for 1/2" Drywall	CXF1	
Wall to Ceiling Corner, pre-set for 5/8" Drywall	CXF2	
Wall to Ceiling Corner, set drywall thickness in field <small>(Mounting equipment assembled in field)</small>	CXFF	
Wall to Ceiling Corner, non-drywall hard surface	CXFN	
Wall to Ceiling Corner, wood	CXFW	
Factory Options		
Chicago Plenum	CP	
Emergency Circuit	_EC	
Emergency Battery Pack	_EM	
<small>(4' minimum. See EM/EC Guide for default locations and ordering details.)</small>		
6' New York City Flex Whip (120V)	FNY1	
6' New York City Flex Whip (277V)	FNY2	
6' Flex Whip	FW	
Finish		WH
Matte White Housing	WH	
Luminaire Length		
<small>(Lengths are nominal)</small>		
Specify luminaire/row length in 1' increments	X'CX'W	
<small>Example: 12C6W= 12' in ceiling, 6' in wall</small>		

fixture:

project:

DETAILS

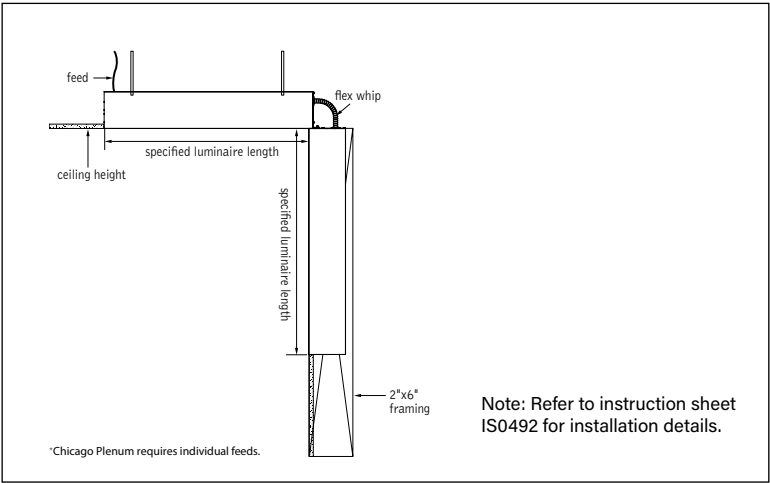

TW 4' PERFORMANCE CHART

Shielding	Lumen Output	Nominal Lumens	Tested System Watts	LPW
Flush Lens	275LF	1100	13.30	83.2
	375LF	1500	17.34	86.5
	625LF	2500	27.84	89.5
	875LF	3500	37.22	94.2
	1000LF	4000	42.39	94.4
	1125LF	4500	50.27	89.4

Based on 2700K, 80CRI, 4' lengths. Lumen output may vary +/- 5%. Actual wattage may vary +/- 5%.

Lumen Multipliers

CRI	Multiplier
80+	1.00
90+	0.89

Wattage Multipliers

CCT	Multiplier
2700K	1.00
3000K	0.92
3500K	0.88
4000K	0.86
5000K	0.85
5700K	0.87
6500K	0.90



TUNABLE WHITE

<b>Luminaire Series</b>	<b>FSM4L</b>
Seem 4 LED	
<b>Shielding</b>	<b>FL</b>
Flush Satin Lens	
<b>Lumen Output</b>	
275 Lumens per foot (3' min. with DITW, 4' min. with LT1)	275LF
375 Lumens per foot (3' min. with LT1)	375LF
625 Lumens per foot	625LF
875 Lumens per foot	875LF
1000 Lumens per foot	1000LF
1125 Lumens per foot	1125LF
<b>Color Temperature</b>	
Tunable White: 2700-6500K, 80+ CRI	2765T
Tunable White: 2700-6500K, 90+ CRI	92765T
<b>Circuit</b>	<b>1C</b>
Single Circuit	1C
<b>Voltage</b>	<b>UNV</b>
UNV 120/277 Volt	UNV
<b>Control System &amp; Dimming Level</b>	
Lutron T-Series - 1% Dimming	LT1
DALI - 1% Dimming	D1TW
(DT6 control. Requires two addresses, one for intensity & one for CCT tuning. Consult factory for DT8.)	
<b>Mounting</b>	
Wall to Ceiling Corner, pre-set for 1/2" Drywall	CXF1
Wall to Ceiling Corner, pre-set for 5/8" Drywall	CXF2
Wall to Ceiling Corner, set drywall thickness in field (Mounting equipment assembled in field)	CXFF
Wall to Ceiling Corner, non-drywall hard surface	CXFN
Wall to Ceiling Corner, wood	CXFW
<b>Factory Options</b>	
Chicago Plenum	CP
Emergency Circuit	_EC
Emergency Battery Pack (Consult factory)	_EM
6' New York City Flex Whip (120V)	FN1
6' New York City Flex Whip (277V)	FN2
6' Flex Whip	FW
<b>Finish</b>	<b>WH</b>
Matte White Housing	WH
<b>Luminaire Length</b>	
(Lengths are nominal)	
Specify luminaire/row length in 1' increments	X'CX'W
Example: 12C6W= 12' in ceiling, 6' in wall	