

AirCore Bridge™

AUABG

PL Preferred Light
Experience BETTER COLOR



BEFORE YOU BEGIN

- Configurations are run specific, please consult factory drawings before beginning installation.
- Luminaires must be installed by a qualified electrician (check with local and national codes for proper installation).
- To prevent electrical shock, disconnect electrical supply before installation or servicing.
- Contractor is responsible for adequately reinforcing walls and/or ceilings to support fixture weight.
- Focal Point, LLC accepts no responsibility for inadequately reinforced walls and/or ceilings.
- The information contained in this drawing is the sole property of Focal Point, LLC. Any reproduction in part or whole without the written permission of Focal Point, LLC is prohibited.

INSTRUCTION KEY



ATTENTION



SEE ADDITIONAL INSTRUCTIONS



POWER OFF



POWER ON

COMPONENT KEY

FOCAL POINT

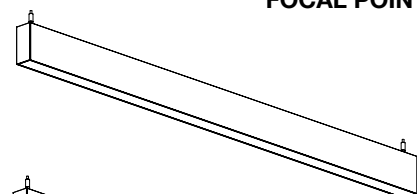

U - Individual

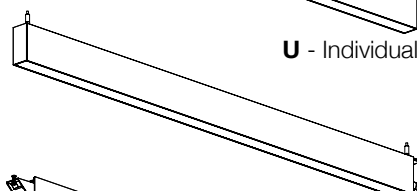

S - Start of run

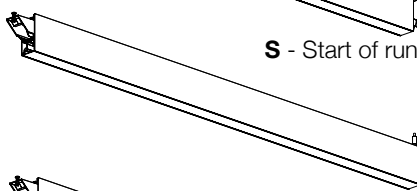

I - Intermediate

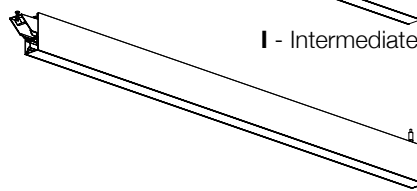

E - End of run



Flush Lens



Pop-Down Lens

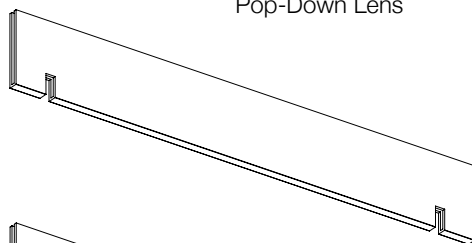

AirCore Blade - Truss

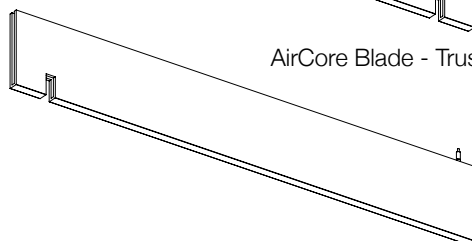

AirCore Blade - Cantilever

SHIPPED INSTALLED

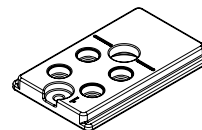

Alignment Plate
(A46949-01)

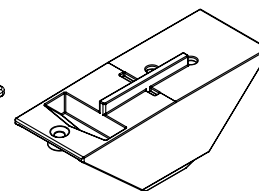

Joiner
(A46895-01)



Alignment Plate Screw
8-32 x 7/8"
(700366)



Joiner Screw
10-32 x 3/4"
(700365)

SHIPPED IN HARDWARE BAG

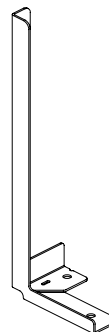

Blade Mounting Bracket
8" - (A55758-01)
12" - (A55758-02)
16" - (A55758-03)



Blade Mounting
Bracket Screw
6-20 x 1/4"
(72026)

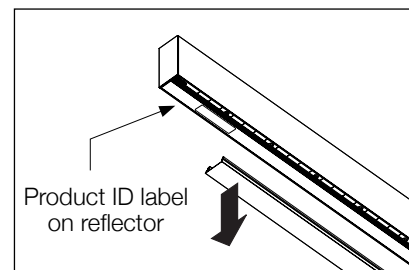

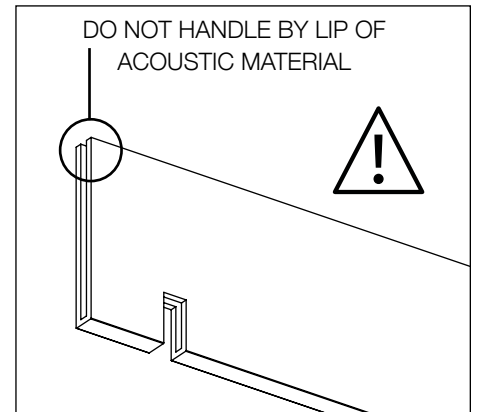
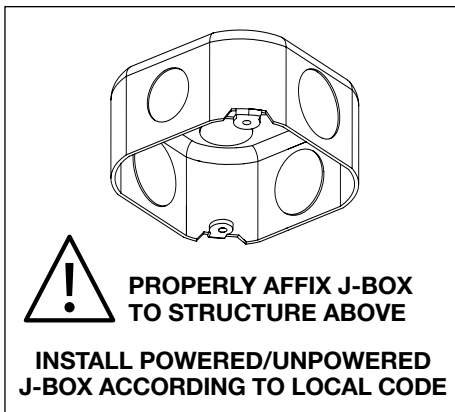

SEEM 1 INSTALLATION

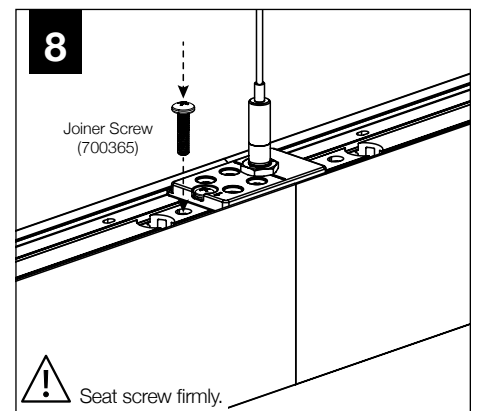
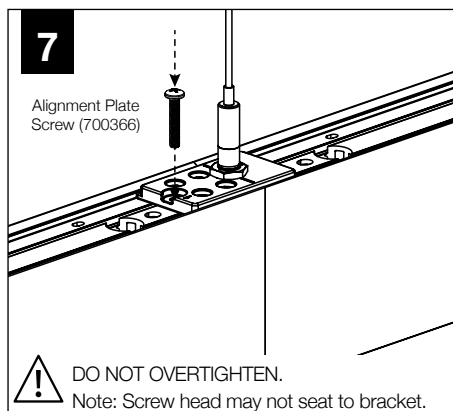
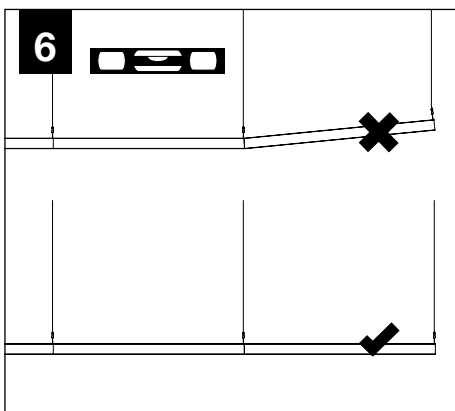
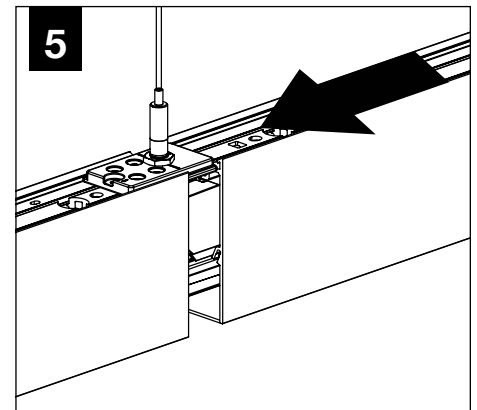
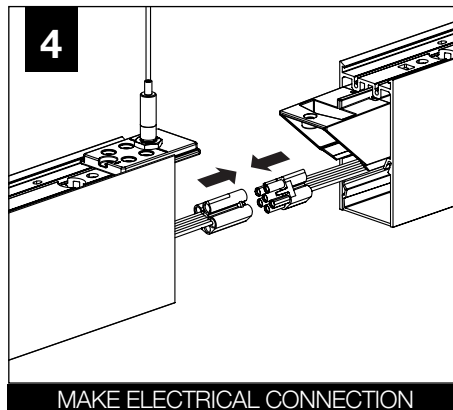
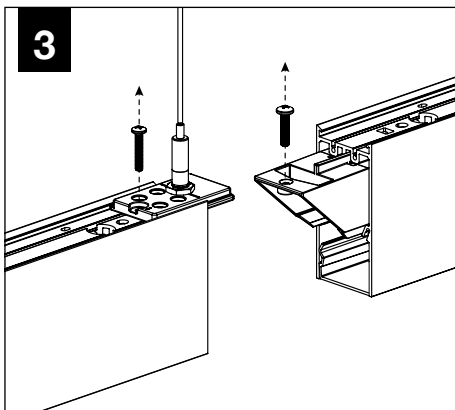
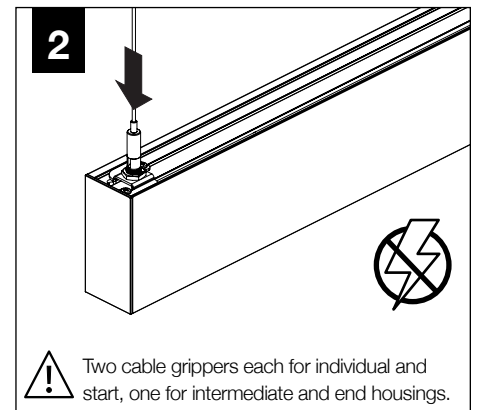
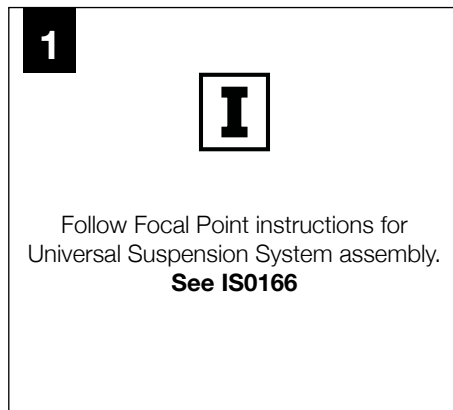

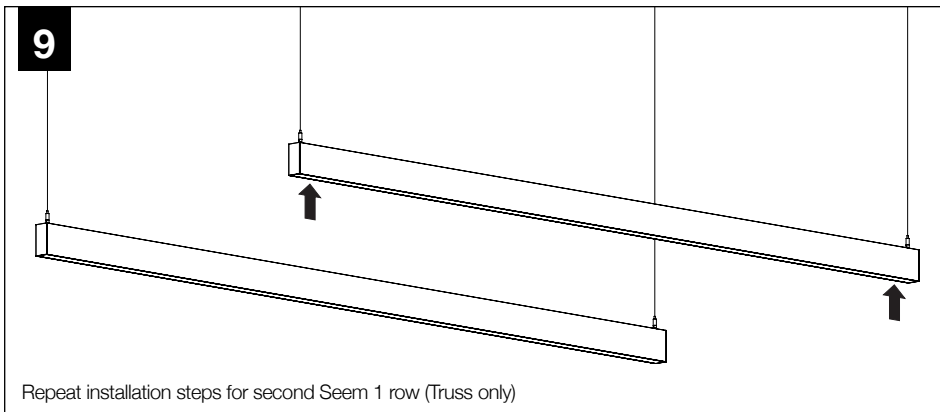

DRIVER SERVICE

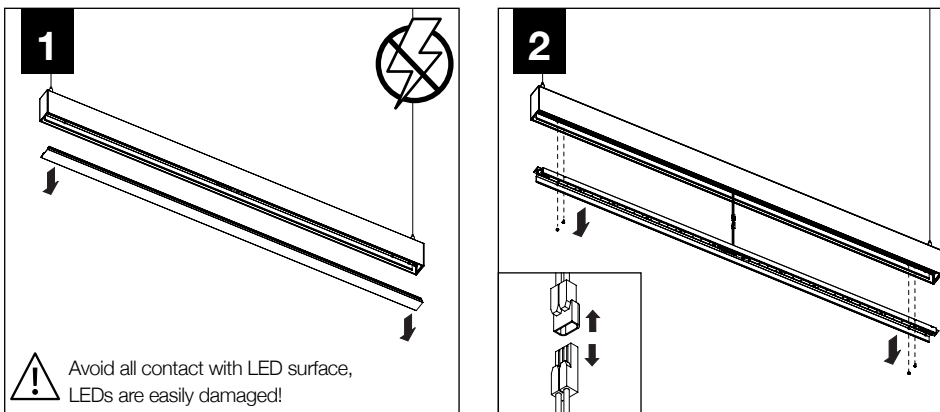

AIRCORE BRIDGE TRUSS INSTALLATION

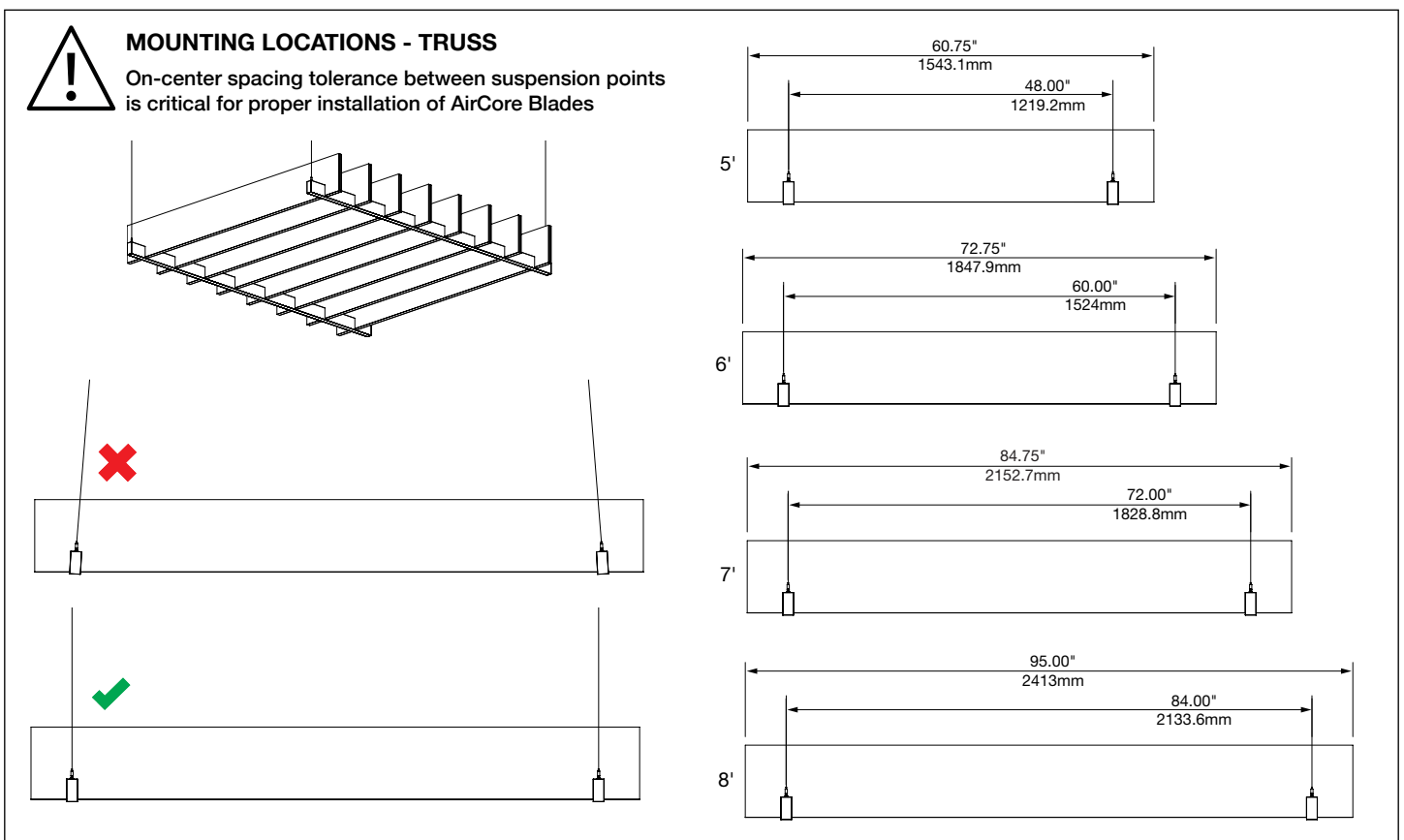

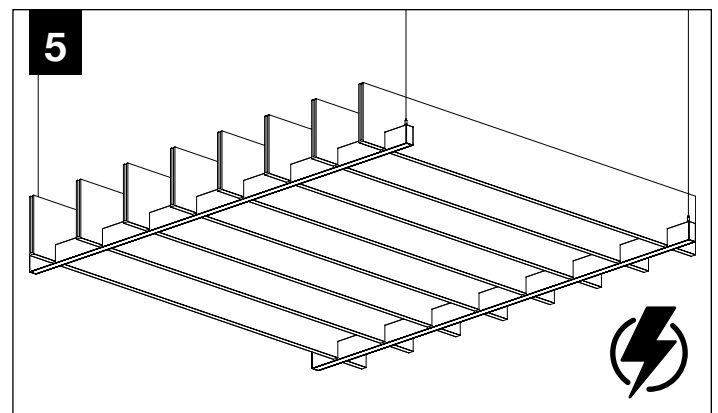
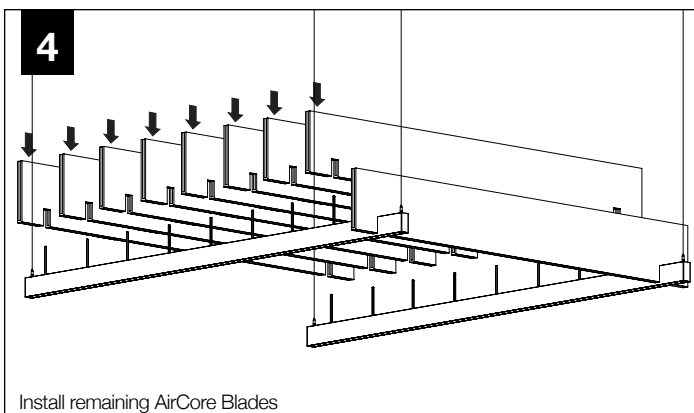
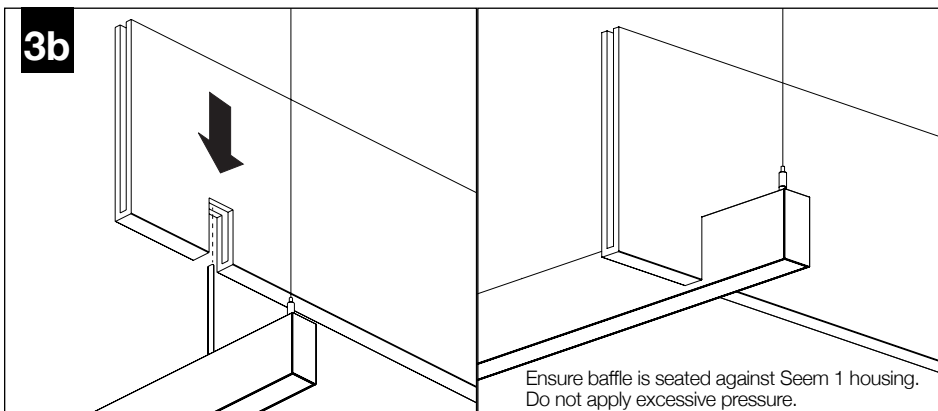
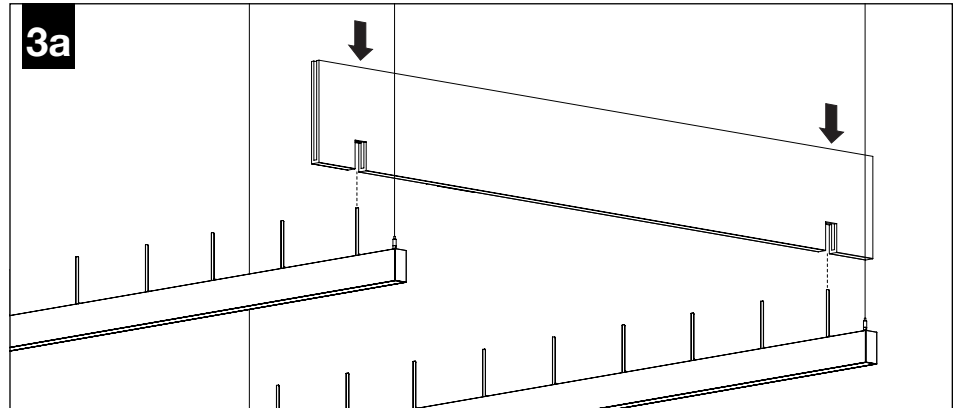
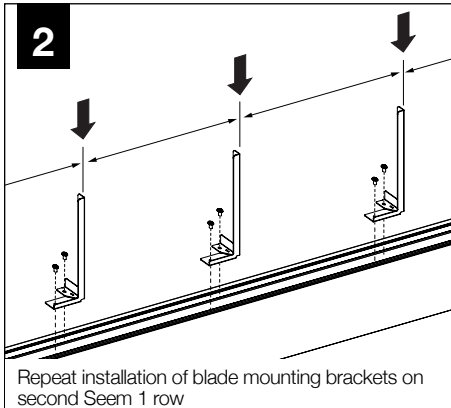
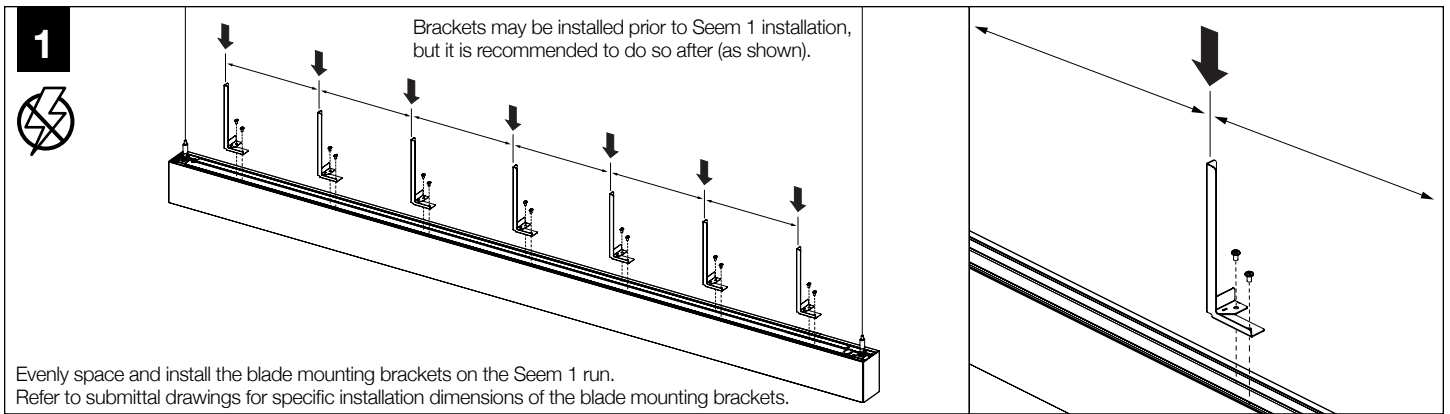

AIRCORE BRIDGE CANTILEVER/ CANTILEVER WAVE INSTALLATION



MOUNTING LOCATIONS - CANTILEVER

On-center spacing tolerance between suspension points is critical for proper installation of AirCore Blades

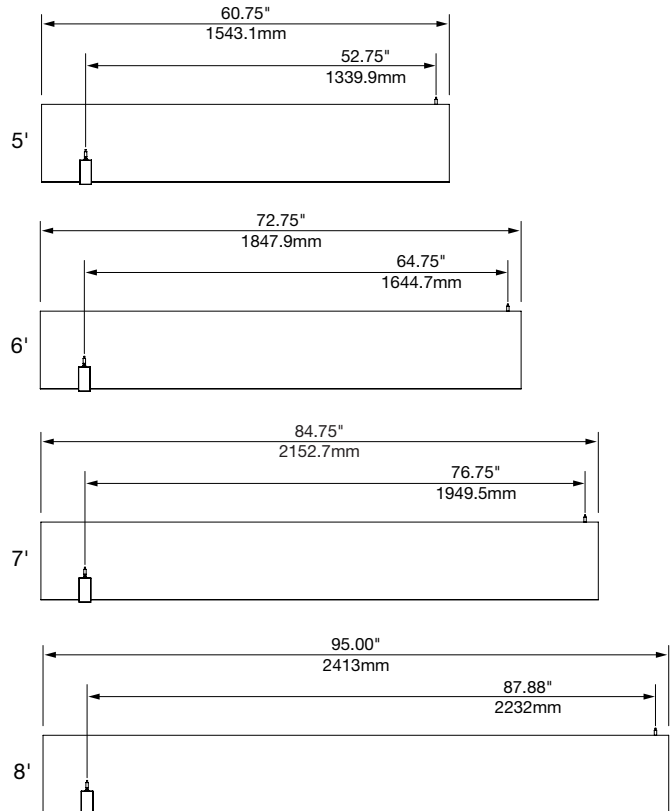
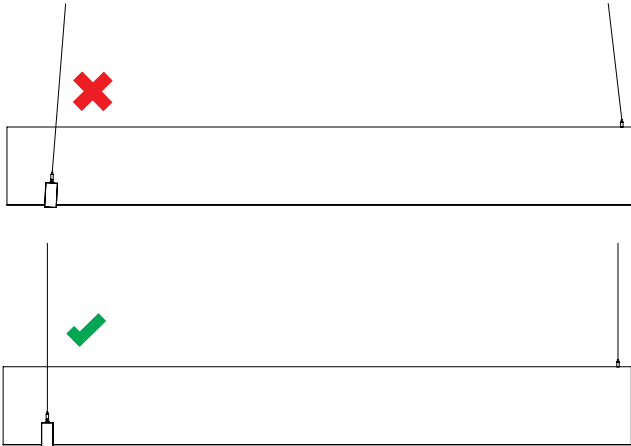
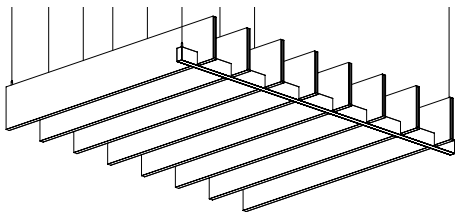

MOUNTING LOCATIONS - CANTILEVER WAVE

On-center spacing tolerance between suspension points is critical for proper installation of AirCore Blades

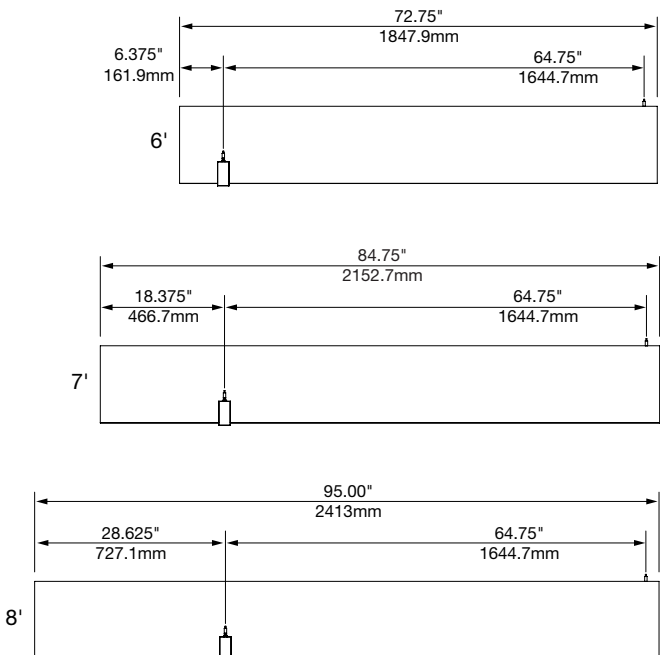
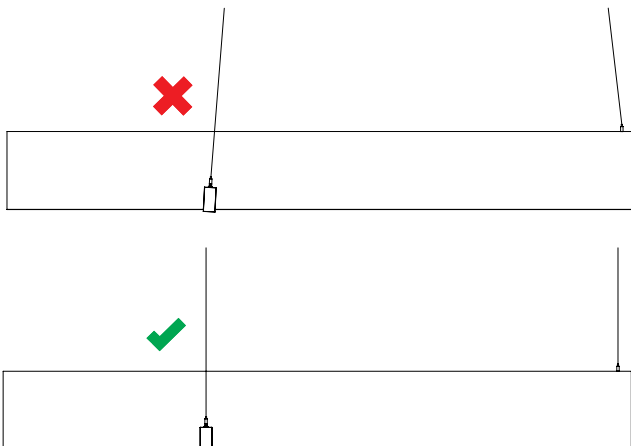
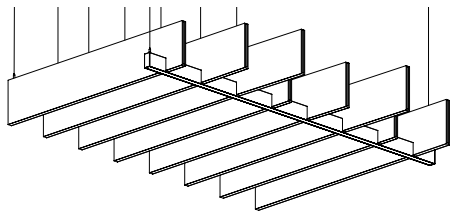

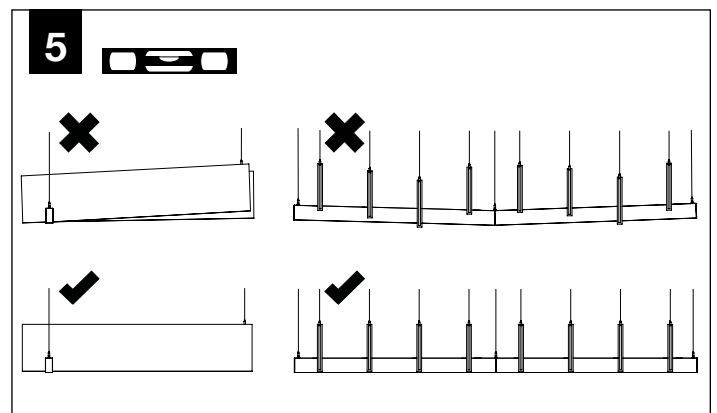
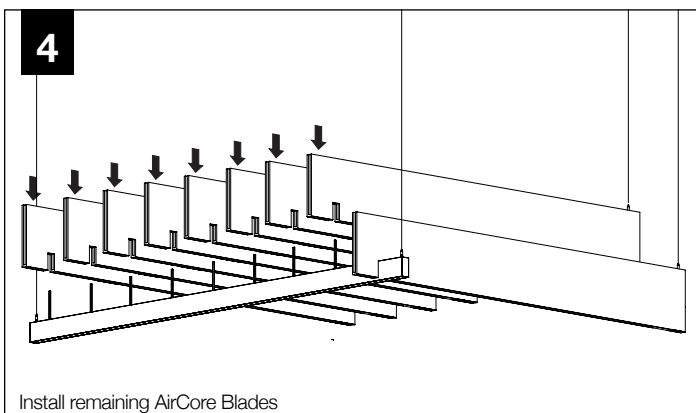
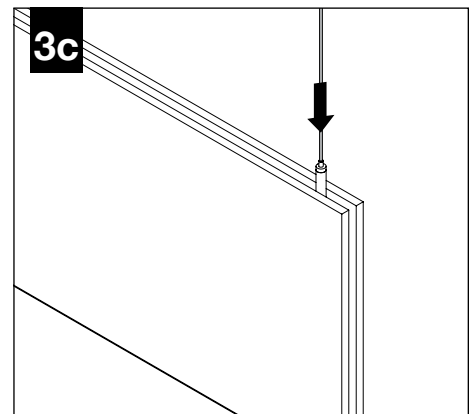
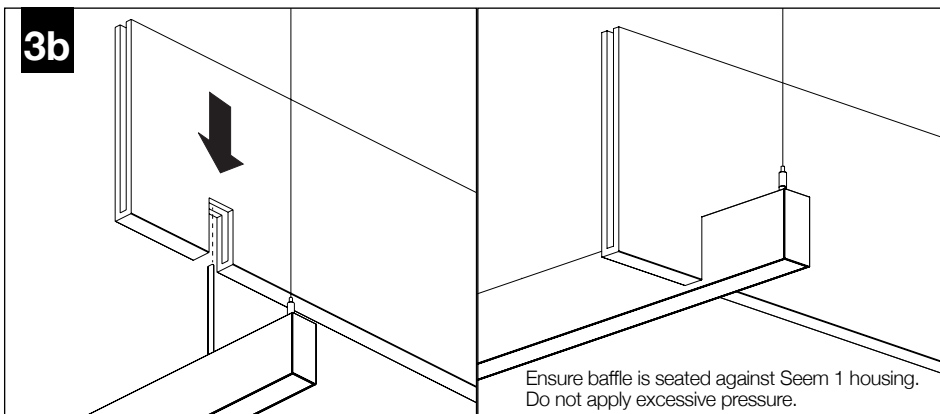
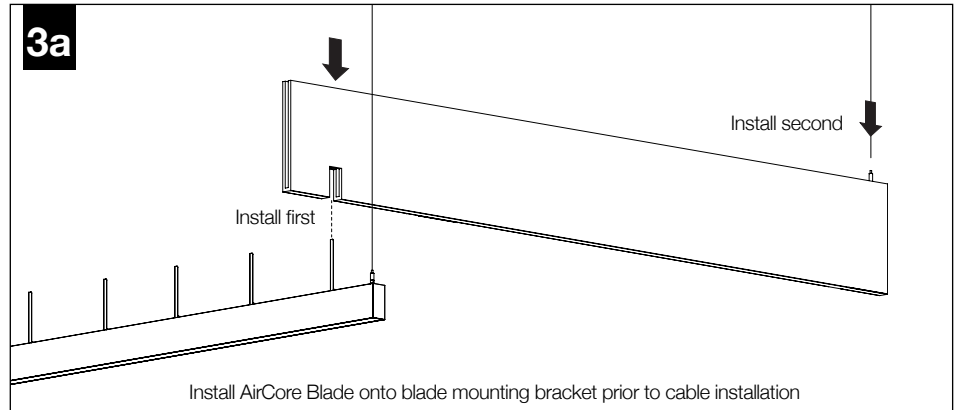
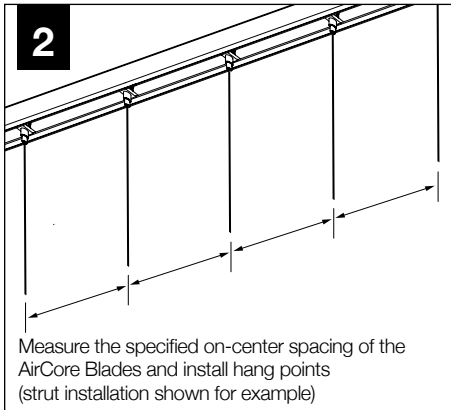
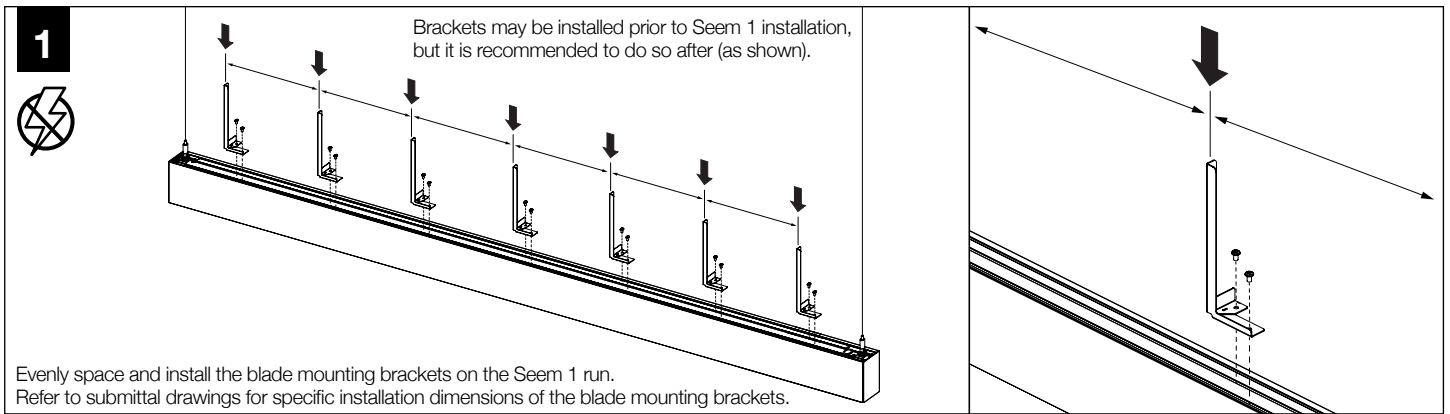

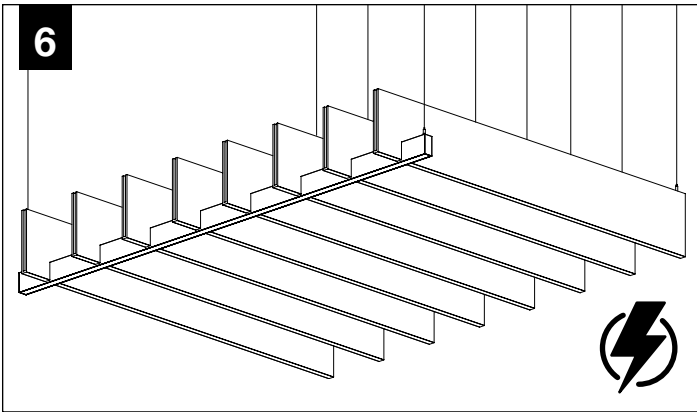

CEILING STRUT INSTALLATION

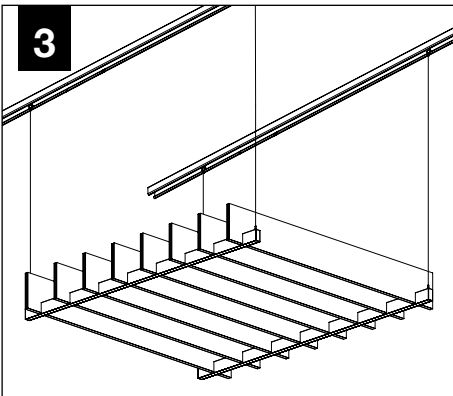
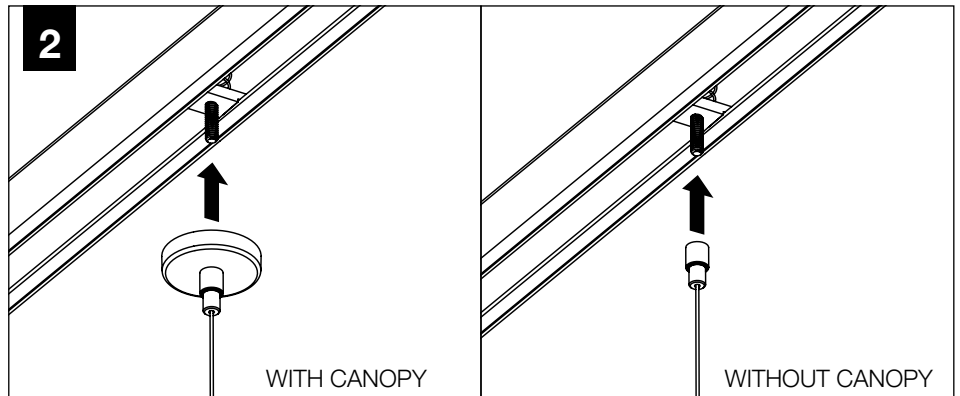
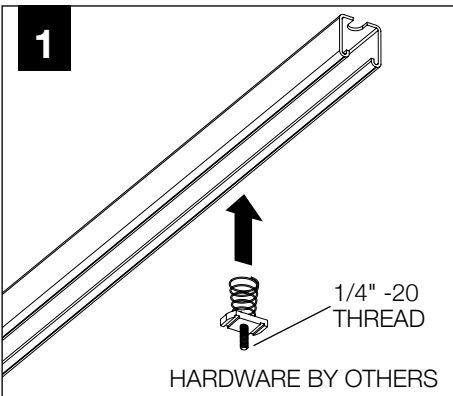

DRYWALL/HARD SURFACE CEILING INSTALLATION

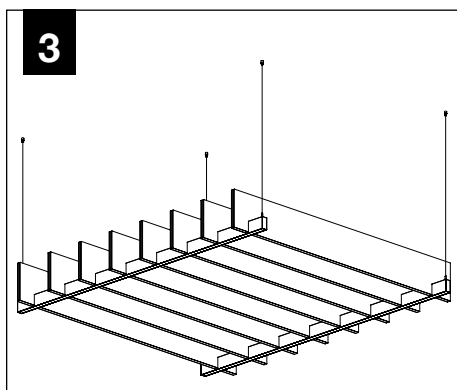
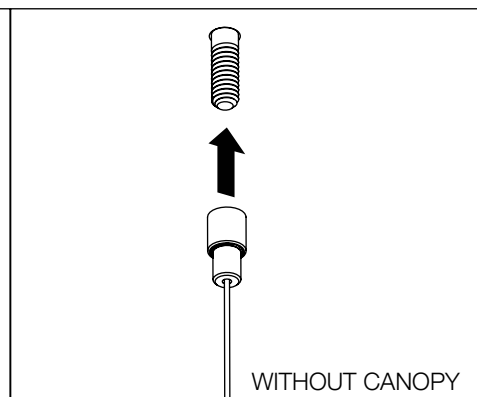
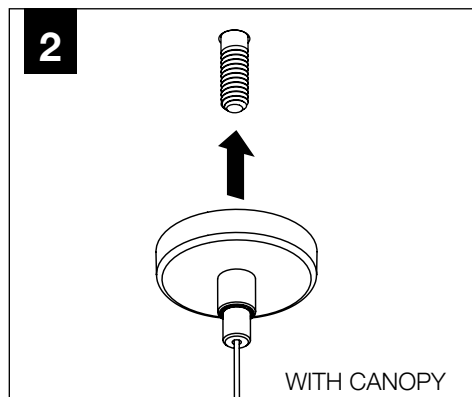
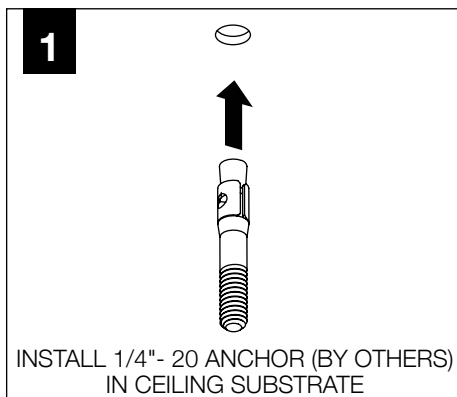

GRID CEILING INSTALLATION

