

# Seem® 1 & Seem® 2 Acoustic

ASM1S | ASM1BS | AUSM1S | ASM2S | ASM2BS | AUSM2S | ASM2IS

AirCore Technology™



## BEFORE YOU BEGIN

- Configurations are run specific, please consult factory drawings before beginning installation.
- Luminaires must be installed by a qualified electrician (check with local and national codes for proper installation).
- To prevent electrical shock, disconnect electrical supply before installation or servicing.
- Contractor is responsible for adequately reinforcing walls and/or ceilings to support fixture weight.
- Focal Point, LLC accepts no responsibility for inadequately reinforced walls and/or ceilings.
- The information contained in this drawing is the sole property of Focal Point, LLC. Any reproduction in part or whole without the written permission of Focal Point, LLC is prohibited.

## INSTRUCTION KEY



ATTENTION



SEE ADDITIONAL INSTRUCTIONS



POWER OFF



POWER ON

## COMPONENT KEY

### FOCAL POINT

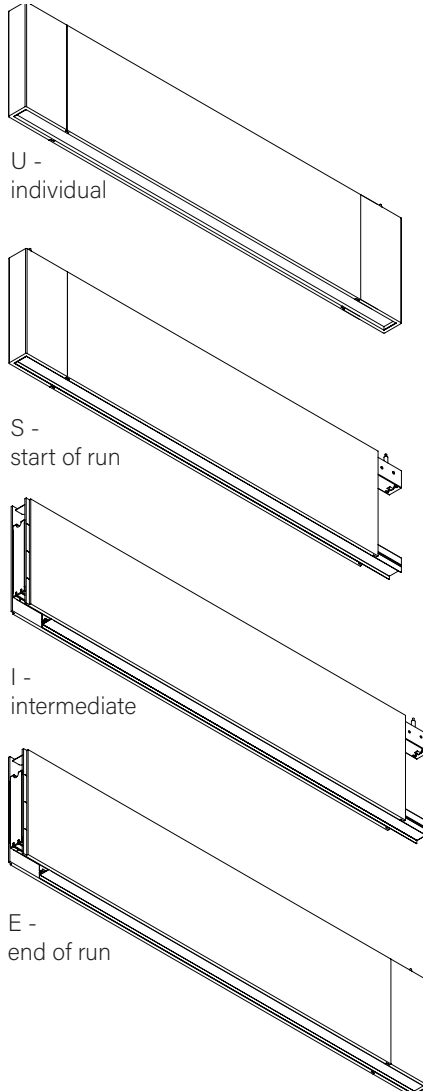

### SHIPPED INSTALLED



Access Cover Screw  
(72026)

### SHIPPED IN HARDWARE BAG



Seem 1 Acoustic Joiner Screw  
(700295)



Seem 2 Acoustic Joiner Screw  
(72026)



INDIVIDUAL INSTALLATIONS  
FOLLOW STEPS 1, 2, 8, 12 & 13



#1 PHILLIPS DRIVER BIT NECESSARY FOR  
INSTALLATION OF SEEM 1 ACOUSTIC JOINED RUNS

#2 PHILLIPS DRIVER BIT NECESSARY FOR  
INSTALLATION OF SEEM 2 ACOUSTIC JOINED RUNS

FOR ALTERNATE CEILING INSTALLATIONS SEE PAGES 3-4

INDIVIDUAL UNITS CANNOT BE JOINED IN THE FIELD

UNITS CANNOT BE CUT TO LENGTH IN THE FIELD

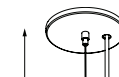

7.5"  
Minimum mounting  
distance from ceiling\*

\*Direct/Indirect & Indirect  
only illuminated baffles

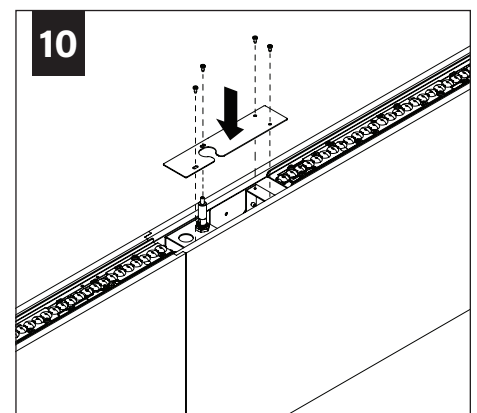
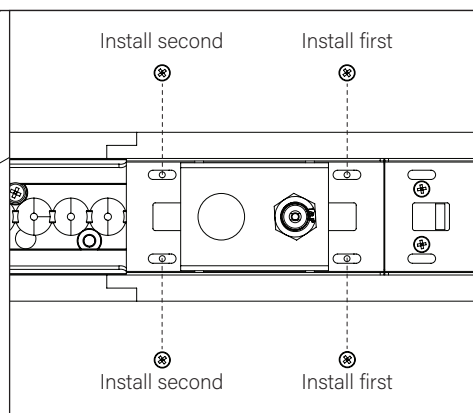
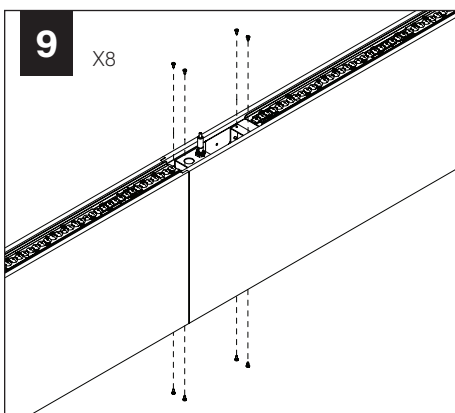
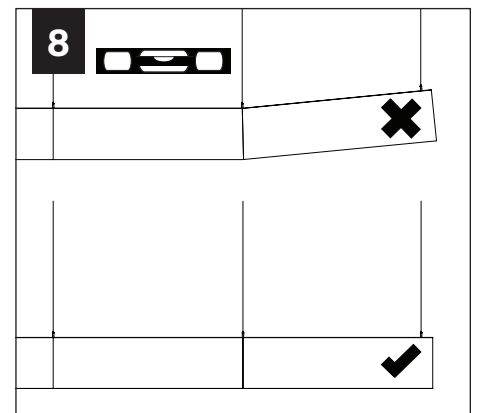
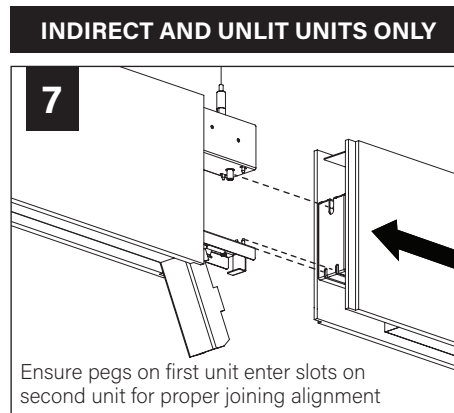
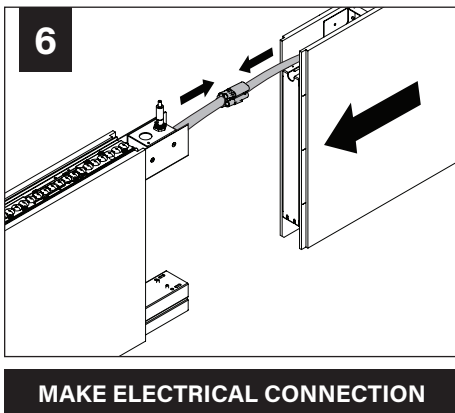
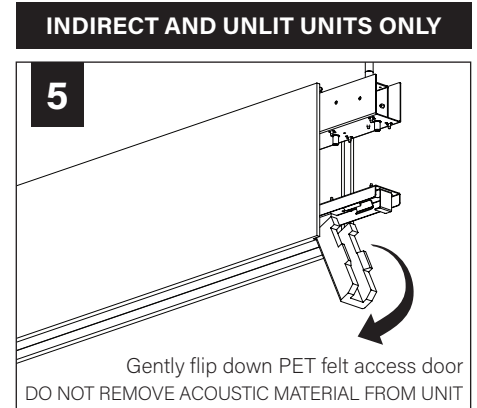
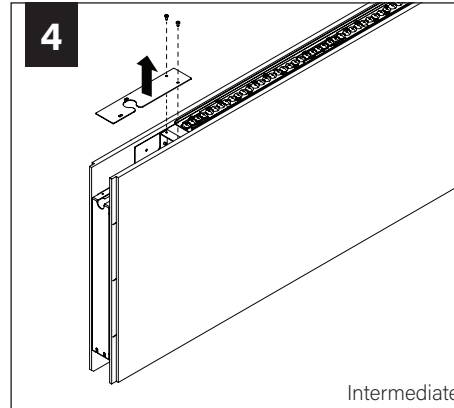
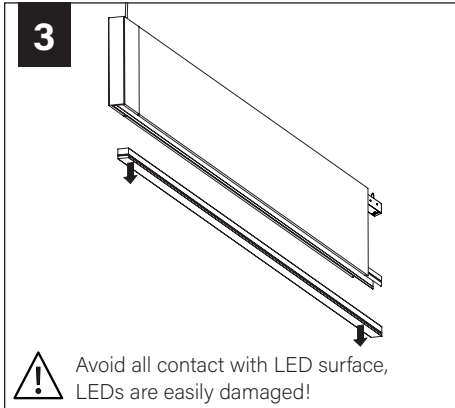
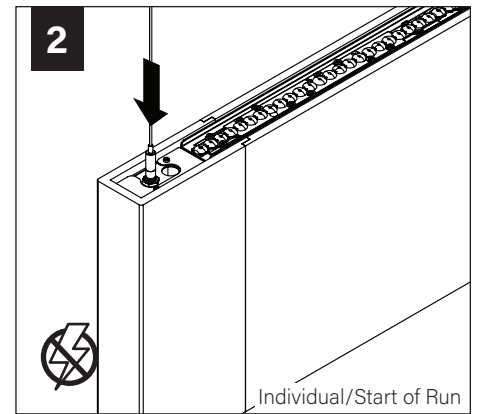
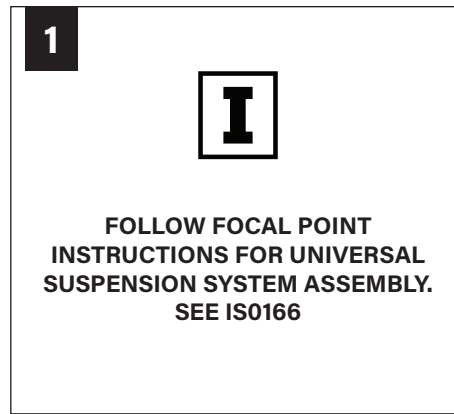
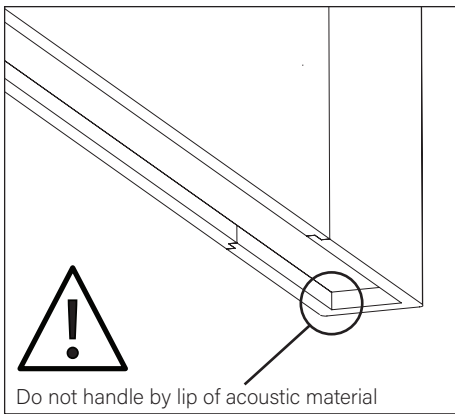

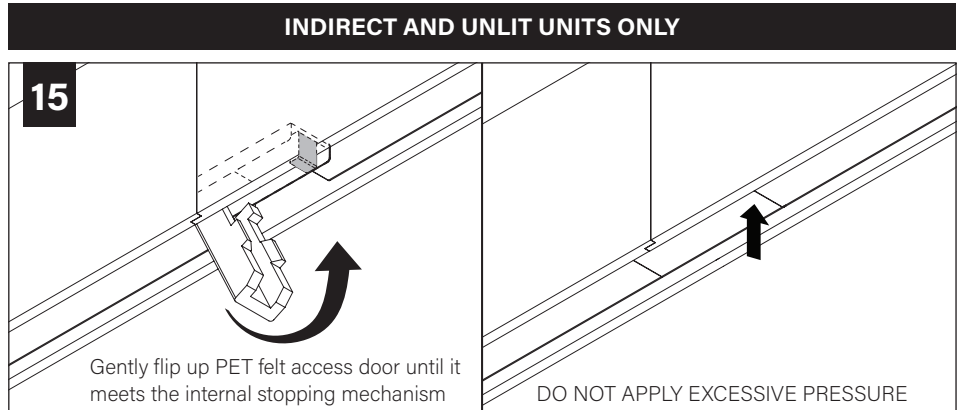
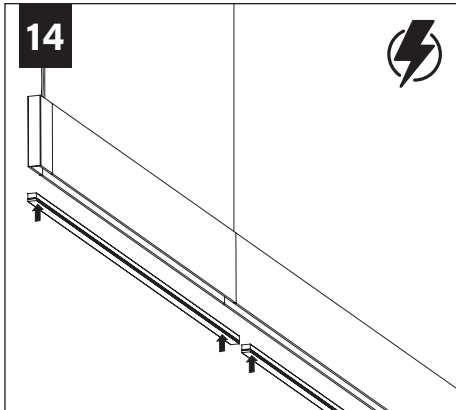
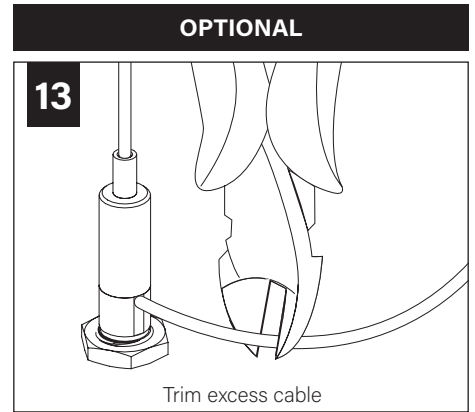
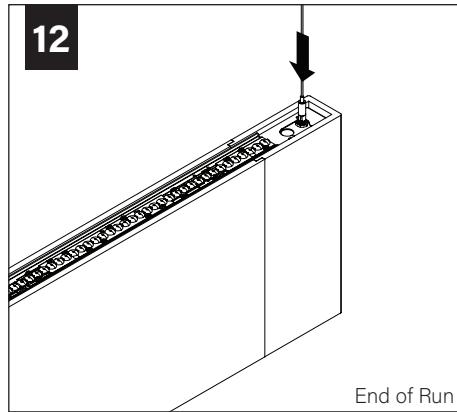
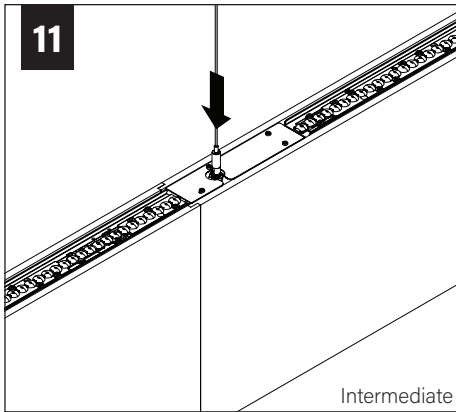

## CEILING STRUT INSTALLATION

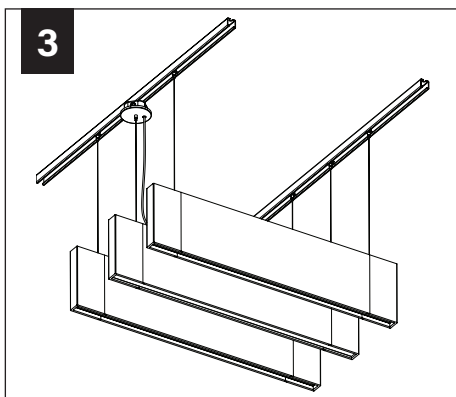
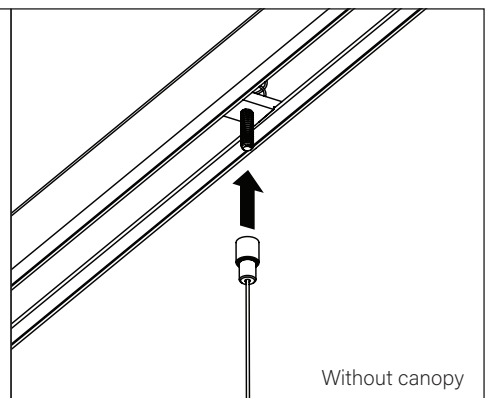
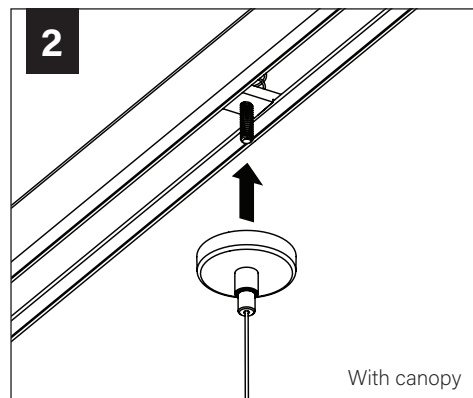
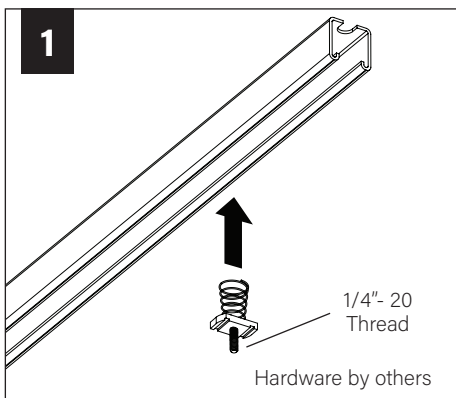

## DRYWALL/HARD SURFACE CEILING INSTALLATION

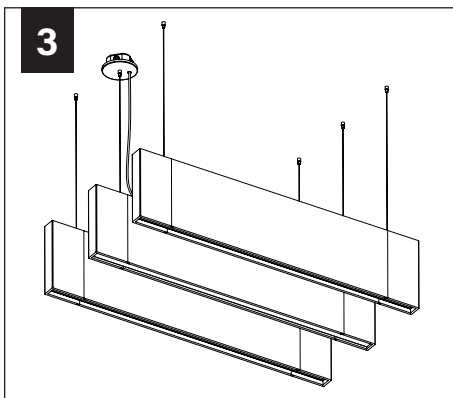
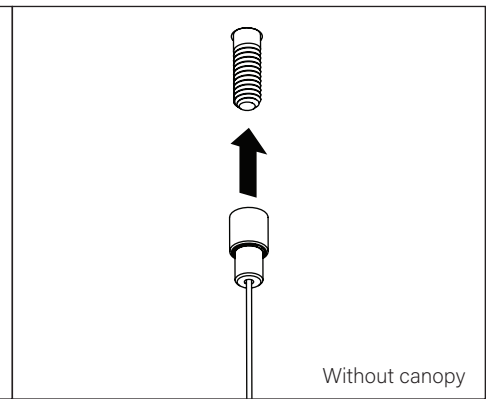
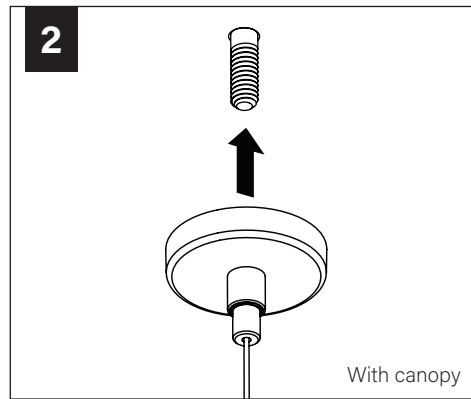
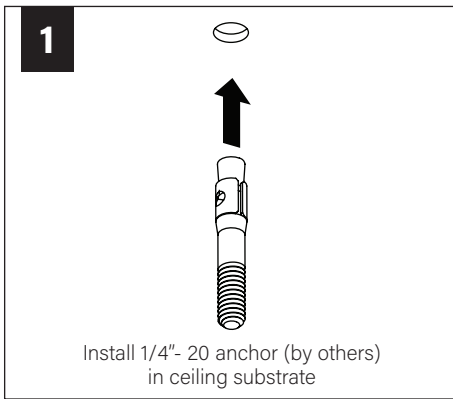

## GRID CEILING INSTALLATION

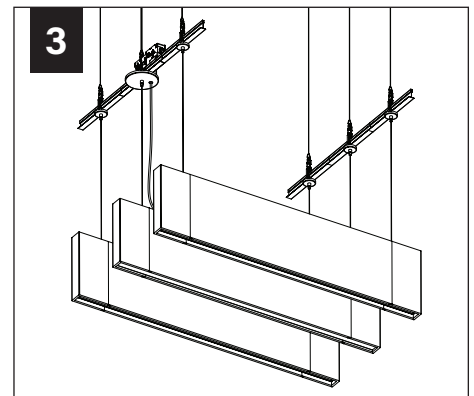
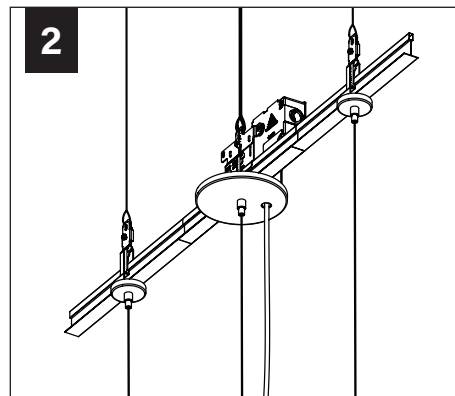
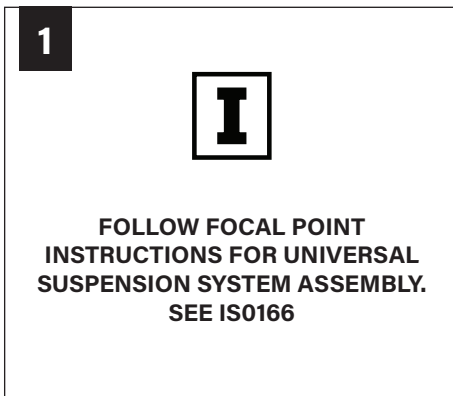

## DRIVER SERVICE

