

Seem® 1 Acoustic

ASM1S | AUSM1S - Direct To Strut, Direct To Grid

AirCore Technology™



FOCAL POINT®



BEFORE YOU BEGIN

- Luminaires must be installed by a qualified electrician (check with local and national codes for proper installation).
- To prevent electrical shock, disconnect electrical supply before installation or servicing.
- Contractor is responsible for adequately reinforcing walls and/or ceilings to support fixture weight.
- Focal Point, LLC accepts no responsibility for inadequately reinforced walls and/or ceilings.
- The information contained in this drawing is the sole property of Focal Point, LLC. Any reproduction in part or whole without the written permission of Focal Point, LLC is prohibited.

INSTRUCTION KEY



ATTENTION



SEE ADDITIONAL INSTRUCTIONS



POWER OFF



POWER ON



POWER CABLE LENGTH 30"

#1 PHILLIPS DRIVER BIT
REQUIRED FOR INSTALLATION
OF JOINED RUNS

INDIVIDUAL UNITS
CANNOT BE JOINED
IN THE FIELD

SEEM 1 ACOUSTIC UNITS
CANNOT BE CUT TO LENGTH
IN THE FIELD



DIRECT TO GRID
RUN LENGTHS
ARE LIMITED TO 16FT.

RUNS SHOULD BE JOINED
ON A FLAT SURFACE **BEFORE**
MOUNTING TO GRID.



DO NOT HANDLE BY LIP OF ACOUSTIC MATERIAL

COMPONENT KEY

FOCAL POINT

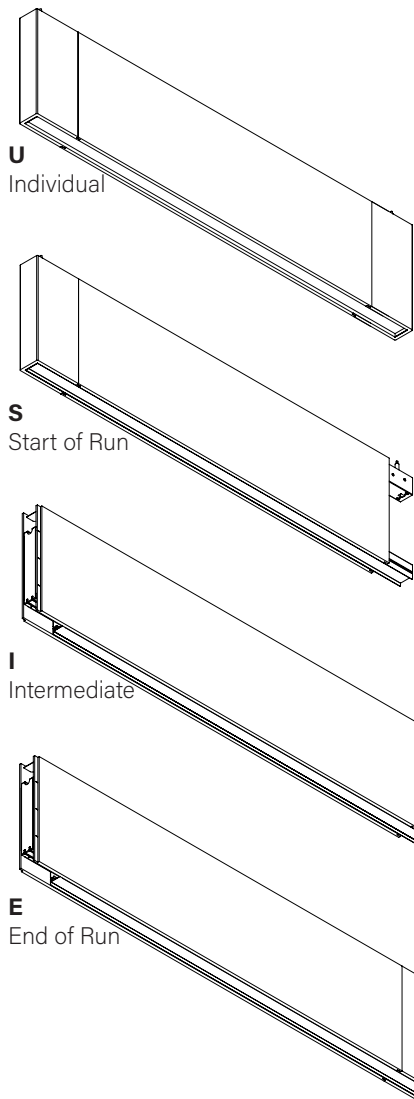

SHIPPED INSTALLED



Access Cover Screw
(72026)

SHIPPED IN HARDWARE BAG



Joiner Screw
(700295)

DIRECT TO STRUT BAGGED HARDWARE

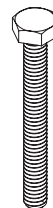

Bolt
1/4-20 x 2.75"
(700388)

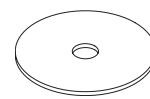

Flat Washer
1.5" x .281" x .062"
(75221)

DIRECT TO GRID BAGGED HARDWARE

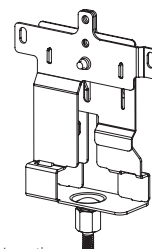

Feed Location
5" Grid Bracket
Assembly
(14470 & 700389)



Non-Feed Location
2" Grid Bracket
Assembly
(14469 & 700389)

Feed Location
Splice Box
Assembly
if required by code
(16102 & 72001)

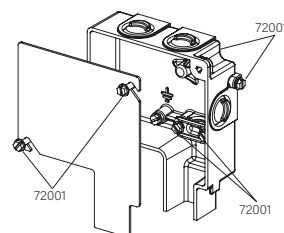



CONFIGURATIONS ARE RUN SPECIFIC, PLEASE CONSULT FACTORY DRAWINGS BEFORE BEGINNING INSTALLATION.



DIRECT TO STRUT INSTALLATION

I

FOR INDIVIDUAL UNITS FOLLOW
STEPS 1, 4 & 11

FOR RUNS START AT
STEP 2

1

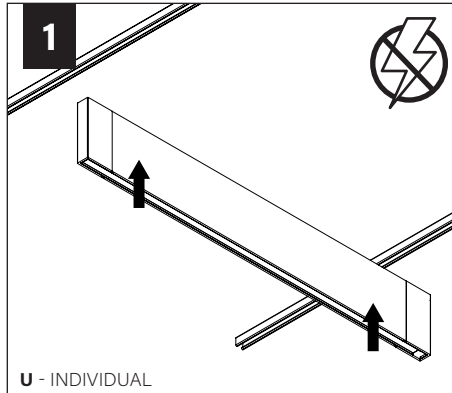

2

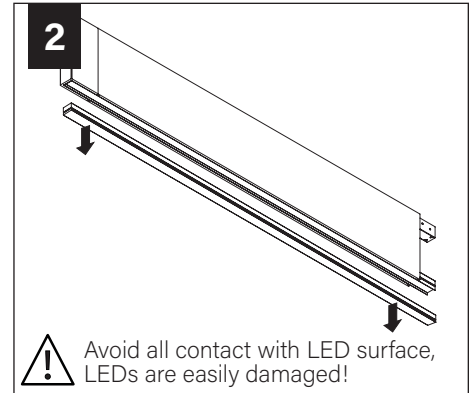

3

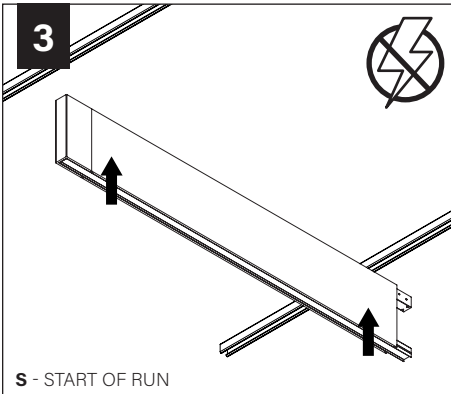

4a

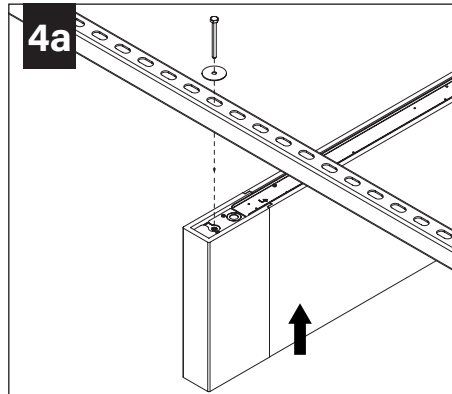

4b

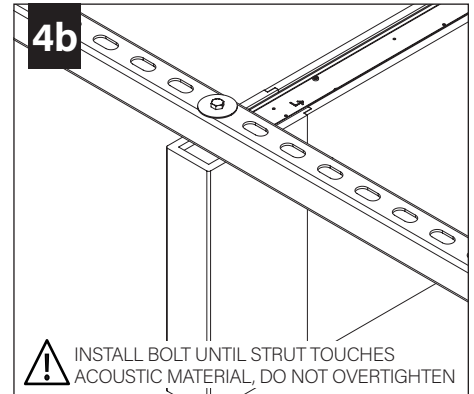

5a

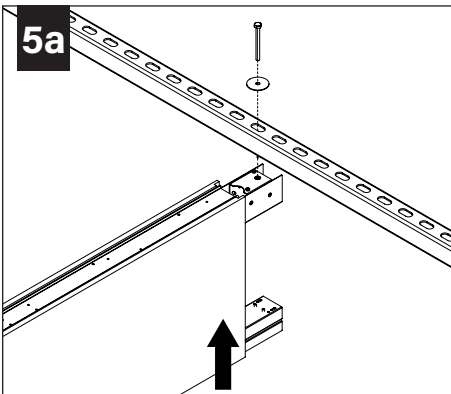

5b

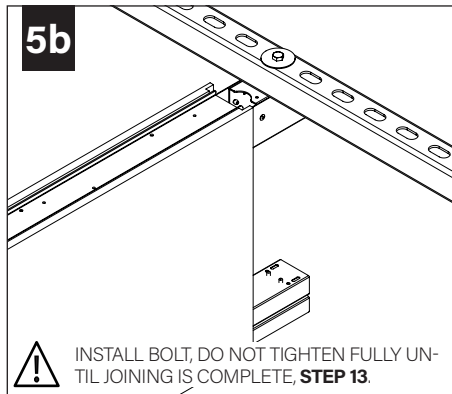

INDIRECT AND UNLIT UNITS ONLY

6

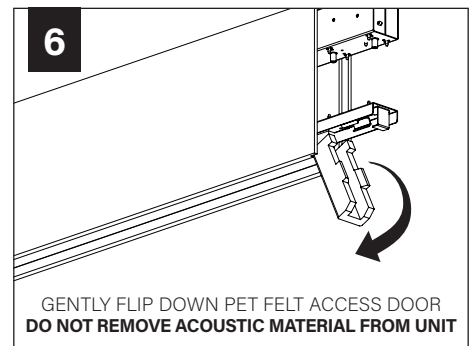

7

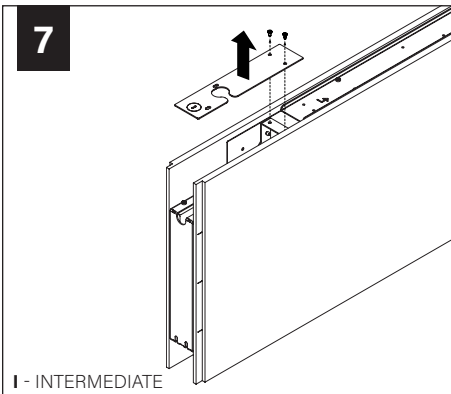

8

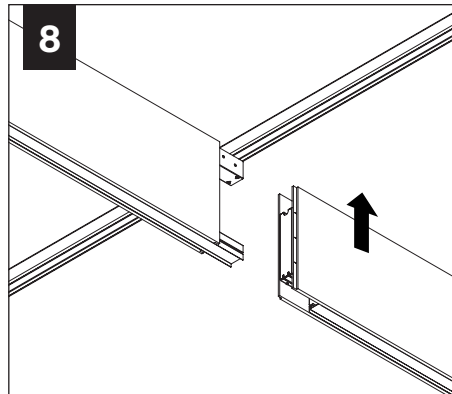

9

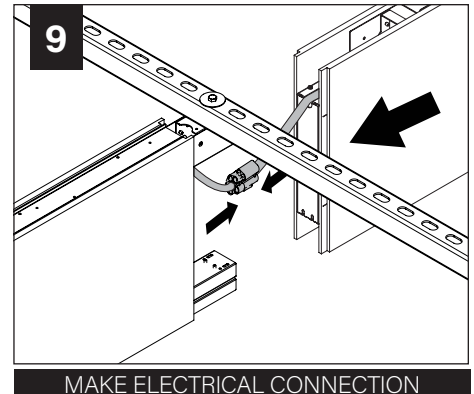

INDIRECT AND UNLIT UNITS ONLY

10

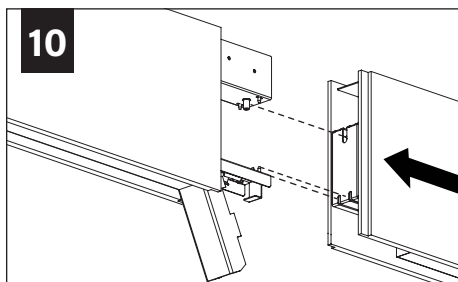

ENSURE PEGS ON FIRST UNIT ENTER SLOTS ON SECOND UNIT FOR PROPER JOINING ALIGNMENT

11a

U - INDIVIDUAL
E - END OF RUN
I - INTERMEDIATE, SEE STEP 5

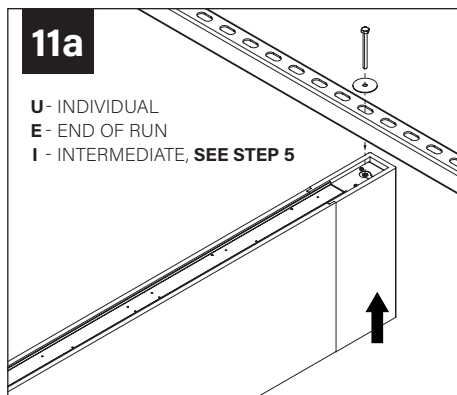

11b

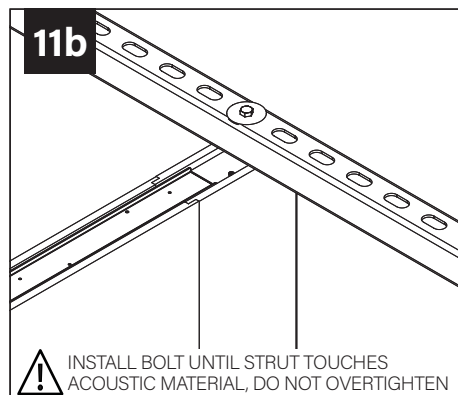

12 x6

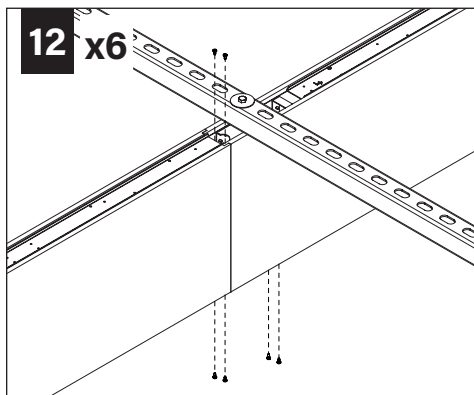

Joiner Screw
(700295)

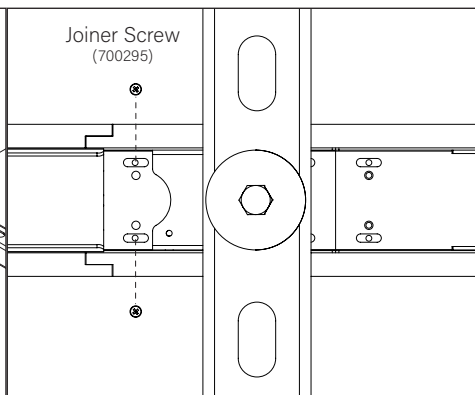

INDIRECT AND UNLIT UNITS ONLY

13

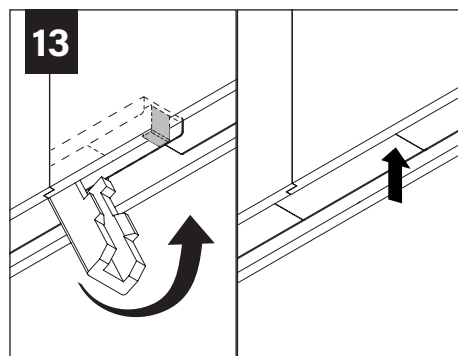

GENTLY FLIP UP PET FELT ACCESS DOOR UNTIL IT MEETS THE INTERNAL STOPPING MECHANISM
DO NOT APPLY EXCESSIVE PRESSURE

14a

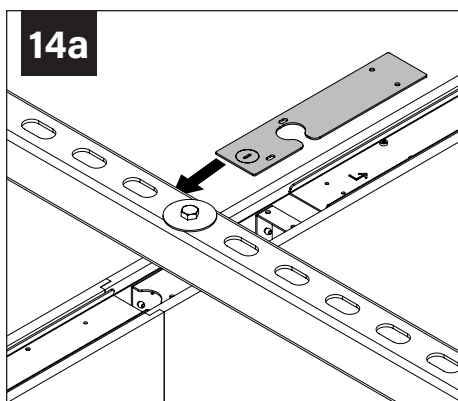

14b

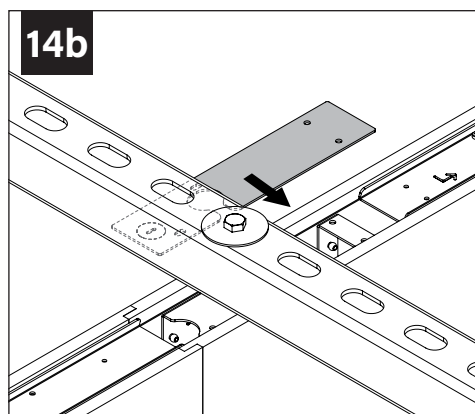

ALIGN COVER WITH
THREADED HOLES BELOW

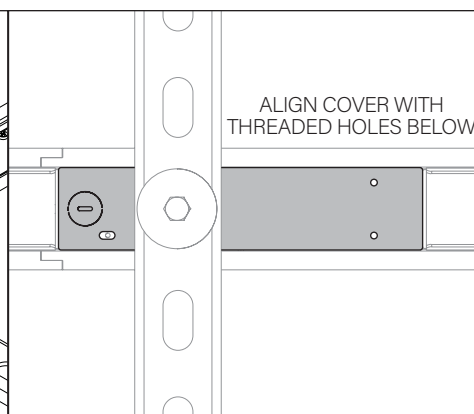

15

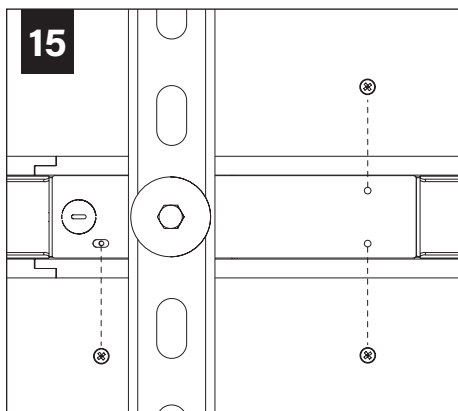

16

TIGHTEN BOLT UNTIL STRUT
TOUCHES ACOUSTIC MATERIAL

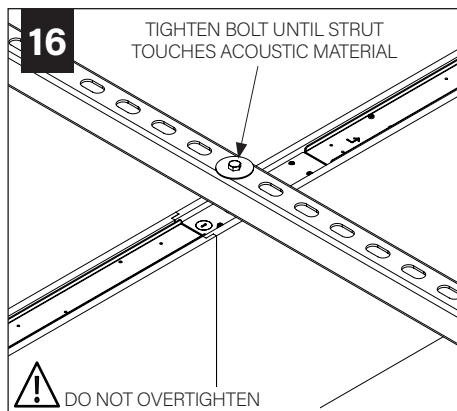

17

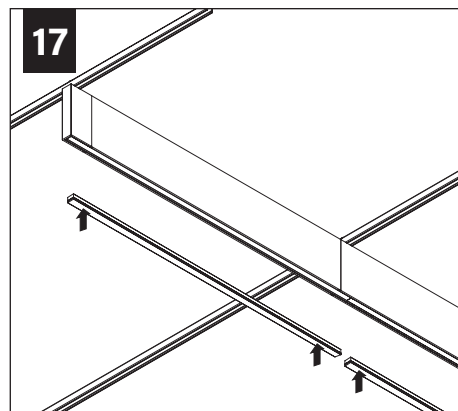

DIRECT TO STRUT - DRIVER SERVICE



HARDWARE PROVIDED FOR 1-5/8" STRUT HEIGHT.

CONTACT FOCAL POINT IF DIFFERENT HARDWARE IS REQUIRED FOR INSTALLATION.

Strut Height	Bolt: 1/4-20 x
13/16"	2.0"
7/8"	2.0"
1"	2.25"
1-3/8"	2.50"
1-5/8"	2.75"
2-7/16"	3.50"
3-1/4"	4.50"

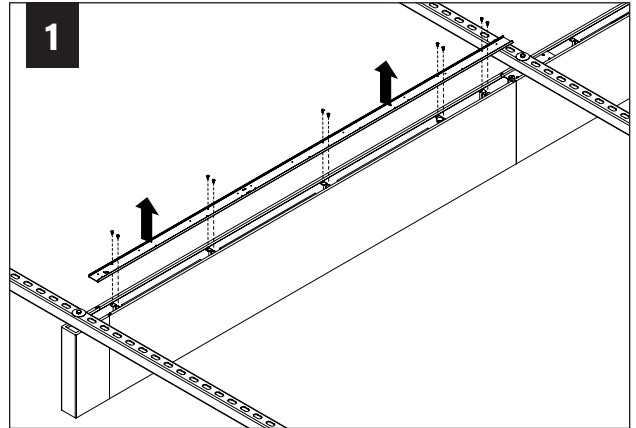

DIRECT TO GRID INSTALLATION



DIRECT TO GRID
RUN LENGTHS
ARE LIMITED TO 16FT.

RUNS SHOULD BE JOINED
ON A FLAT SURFACE **BEFORE**
MOUNTING TO GRID.



FOR INDIVIDUAL UNITS FOLLOW
STEPS 9-18

1



REMOVE LENS
FROM RUN SEGMENTS



Avoid all contact with LED surface,
LEDs are easily damaged!

INDIRECT AND UNLIT UNITS ONLY

2

GENTLY FLIP DOWN PET FELT ACCESS DOOR
DO NOT REMOVE ACOUSTIC MATERIAL FROM UNIT

3

E - END OF RUN

4

MAKE ELECTRICAL CONNECTION

INDIRECT AND UNLIT UNITS ONLY

5

ENSURE PEGS ON FIRST UNIT ENTER SLOTS ON
SECOND UNIT FOR PROPER JOINING ALIGNMENT

6 x8

6 detail view

INSTALL SECOND

INSTALL FIRST

INSTALL SECOND

INSTALL FIRST

INDIRECT AND UNLIT UNITS ONLY

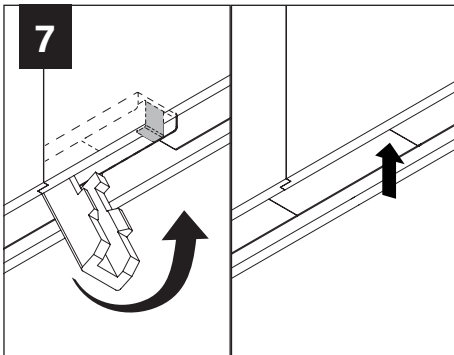

GENTLY FLIP UP PET FELT ACCESS DOOR UNTIL IT MEETS THE INTERNAL STOPPING MECHANISM
DO NOT APPLY EXCESSIVE PRESSURE

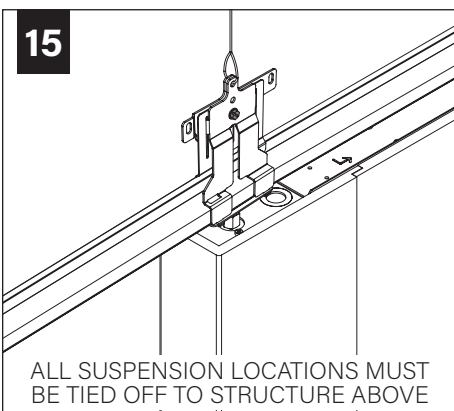
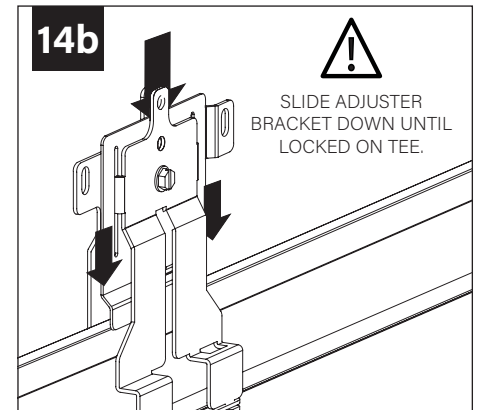
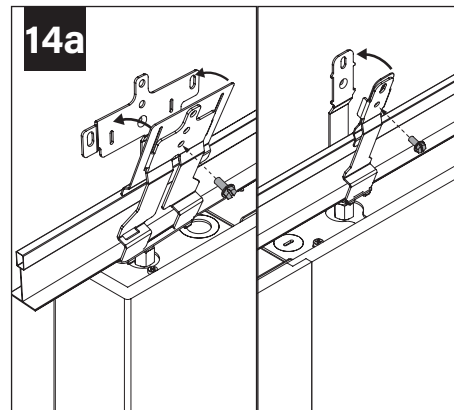
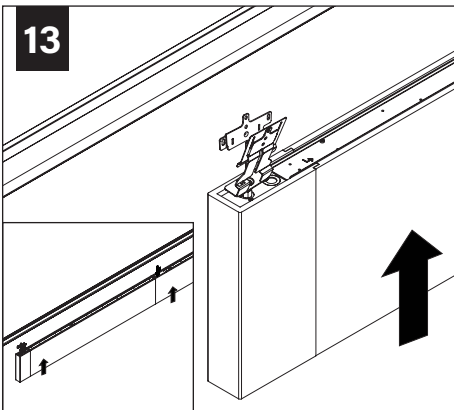
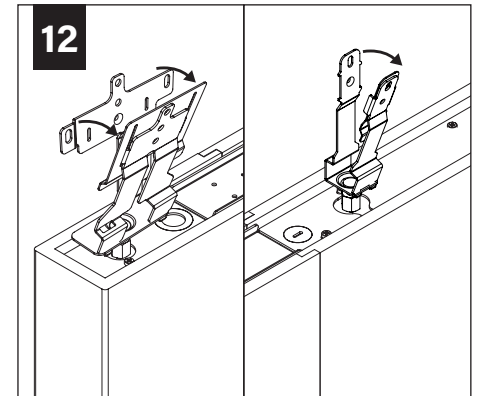
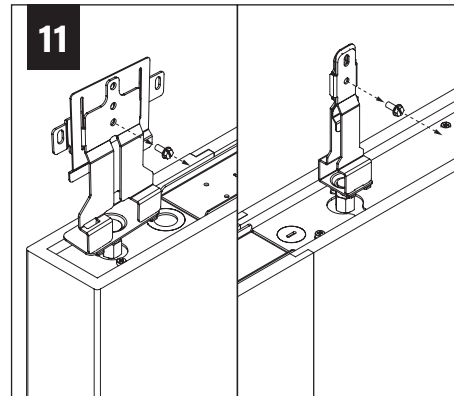
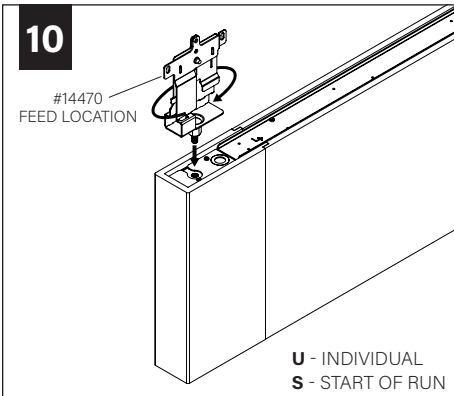
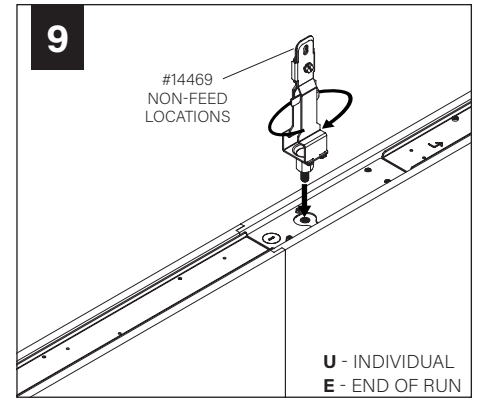
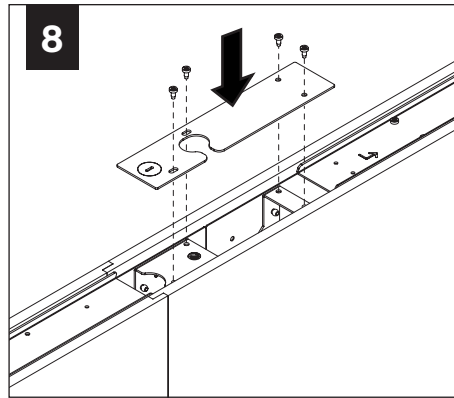

ALL SUSPENSION LOCATIONS MUST BE TIED OFF TO STRUCTURE ABOVE

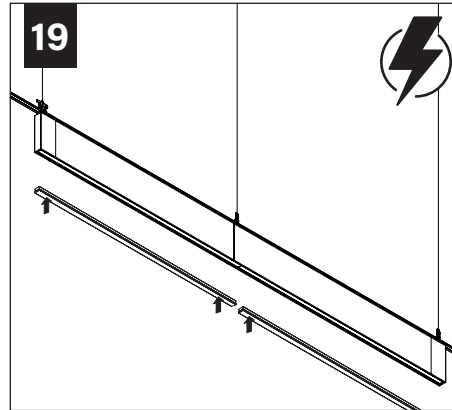
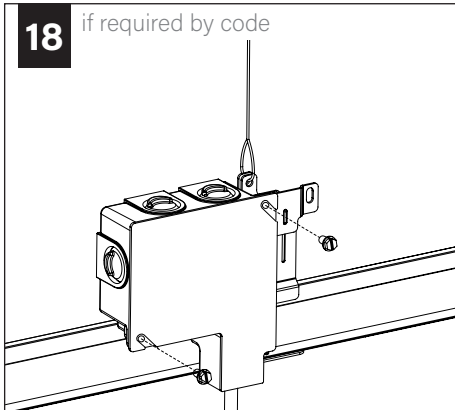
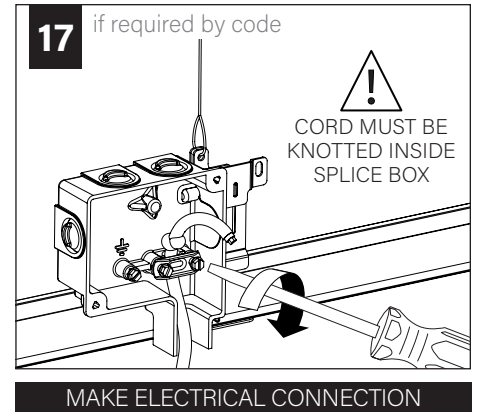
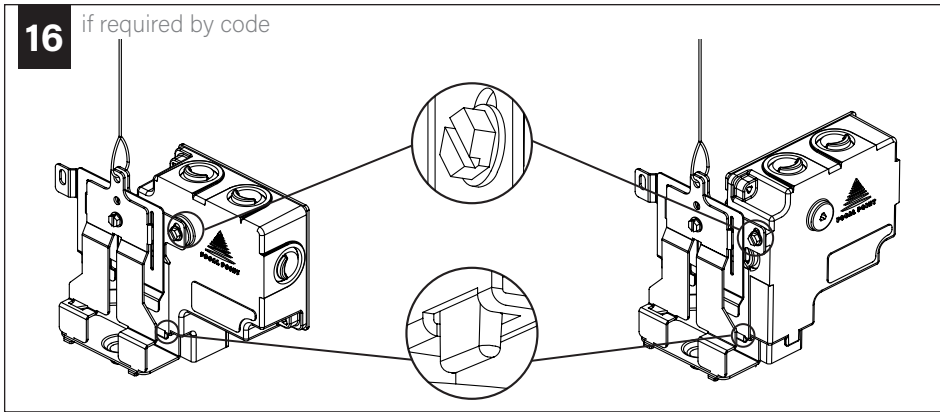

DRIVER SERVICE

