

# Seem® 1 & Seem® 2 Acoustic

ASM1S | AUSM1S | ASM2S | AUSM2S - Direct To Strut, Direct To Grid

AirCore Technology™



## BEFORE YOU BEGIN

- Luminaires must be installed by a qualified electrician (check with local and national codes for proper installation).
- To prevent electrical shock, disconnect electrical supply before installation or servicing.
- Contractor is responsible for adequately reinforcing walls and/or ceilings to support fixture weight.
- Focal Point, LLC accepts no responsibility for inadequately reinforced walls and/or ceilings.
- The information contained in this drawing is the sole property of Focal Point, LLC. Any reproduction in part or whole without the written permission of Focal Point, LLC is prohibited.

## INSTRUCTION KEY



**ATTENTION**



**SEE ADDITIONAL INSTRUCTIONS**



**POWER OFF**



**POWER ON**



**POWER CABLE LENGTH 30"**

**#1 PHILLIPS DRIVER BIT**  
REQUIRED FOR INSTALLATION  
OF JOINED RUNS

INDIVIDUAL UNITS  
**CANNOT BE JOINED**  
IN THE FIELD

SEEM 1 ACOUSTIC UNITS  
**CANNOT BE CUT TO LENGTH**  
IN THE FIELD



DIRECT TO GRID  
**RUN LENGTHS**  
**ARE LIMITED TO 16FT.**

RUNS SHOULD BE JOINED  
ON A FLAT SURFACE **BEFORE**  
MOUNTING TO GRID.



DO NOT HANDLE BY LIP OF ACOUSTIC MATERIAL

## COMPONENT KEY

### FOCAL POINT

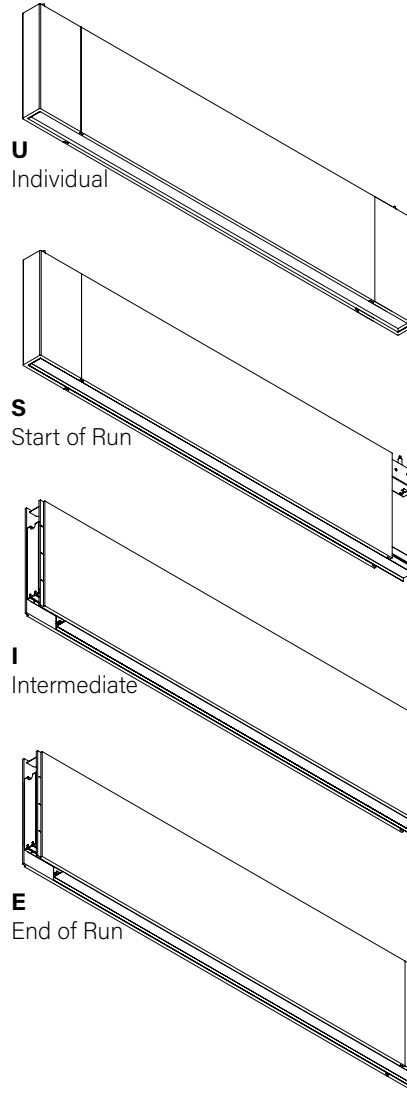

### SHIPPED INSTALLED



Access Cover Screw  
(72026)

### SHIPPED IN HARDWARE BAG



Joiner Screw  
(700295)

### DIRECT TO STRUT BAGGED HARDWARE

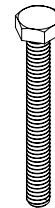

Bolt  
1/4-20 x 2.75"  
(700388)

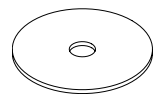

Flat Washer  
1.5" x .281" x .062"  
(75221)

### DIRECT TO GRID BAGGED HARDWARE

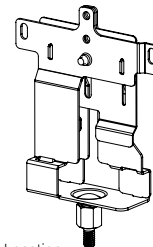

Feed Location  
5" Grid Bracket  
Assembly  
(14470 & 700389)

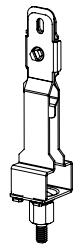

Non-Feed Location  
2" Grid Bracket  
Assembly  
(14469 & 700389)

Feed Location  
Splice Box  
Assembly  
if required by code  
(16102 & 72001)

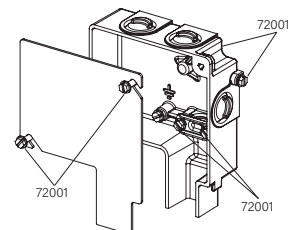



CONFIGURATIONS ARE RUN SPECIFIC, PLEASE CONSULT FACTORY DRAWINGS BEFORE BEGINNING INSTALLATION.



## DIRECT TO STRUT INSTALLATION

**I**

FOR INDIVIDUAL UNITS FOLLOW  
**STEPS 1, 4 & 11**

FOR RUNS START AT  
**STEP 2**

**1**

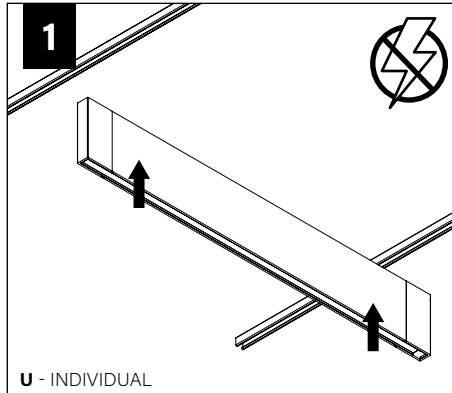

**2**

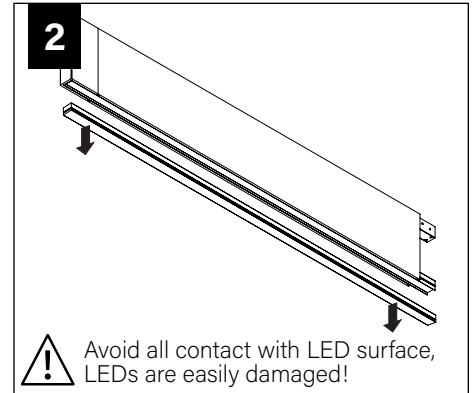

**3**

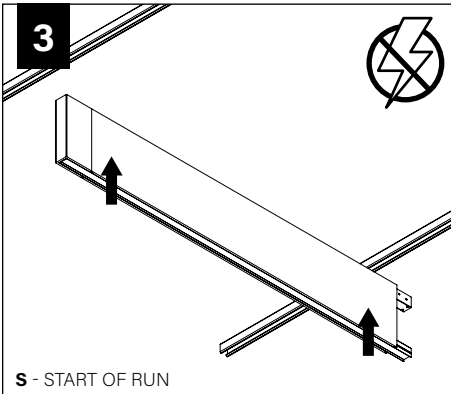

**4a**

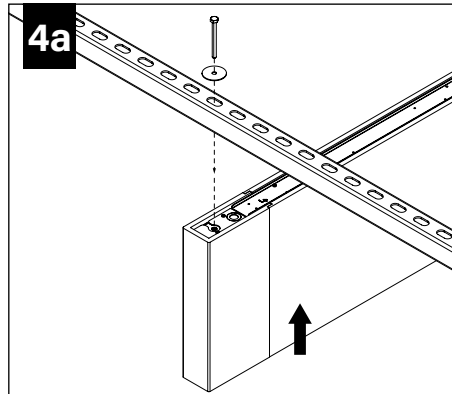

**4b**

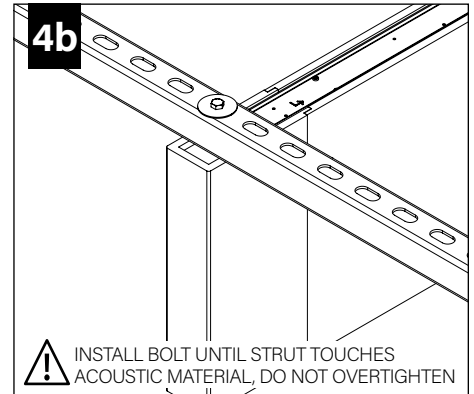

**5a**

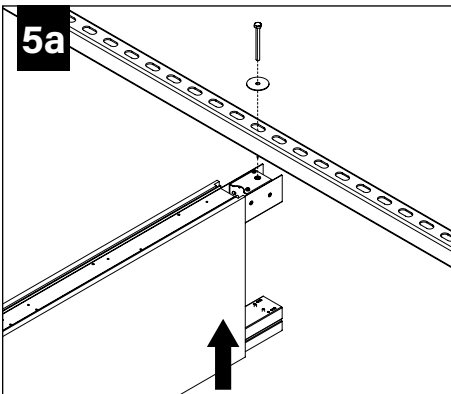

**5b**

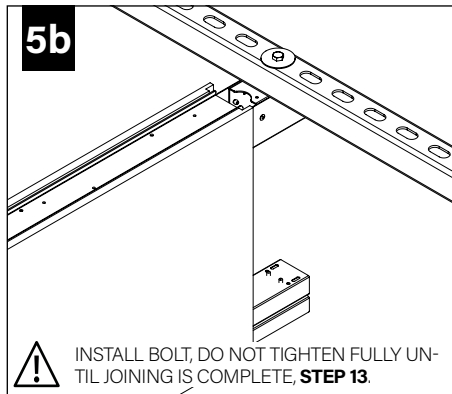

### INDIRECT AND UNLIT UNITS ONLY

**6**

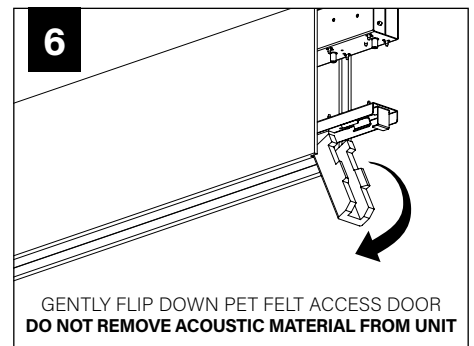

**7**

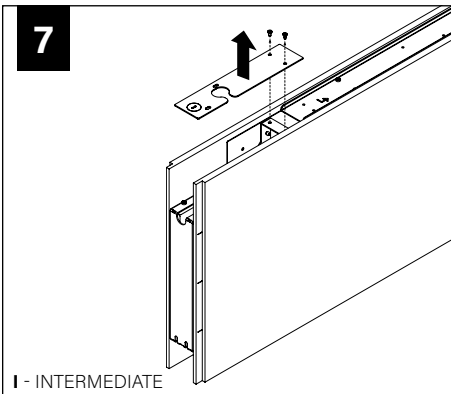

**8**

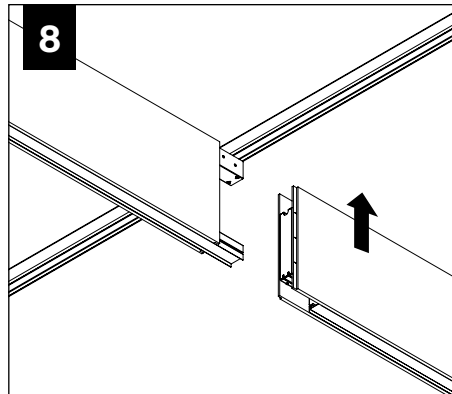

**9**

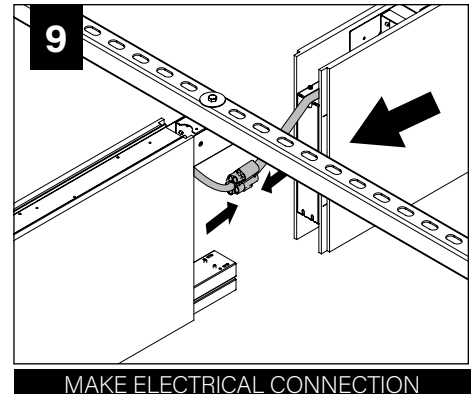

**INDIRECT AND UNLIT UNITS ONLY**

**10**

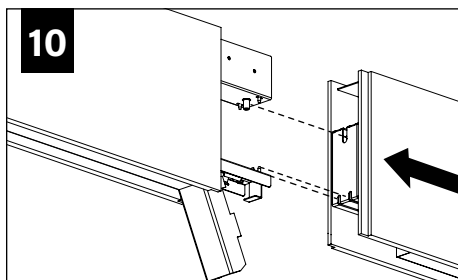

ENSURE PEGS ON FIRST UNIT ENTER SLOTS ON SECOND UNIT FOR PROPER JOINING ALIGNMENT

**11a**

U - INDIVIDUAL  
E - END OF RUN  
I - INTERMEDIATE, SEE STEP 5

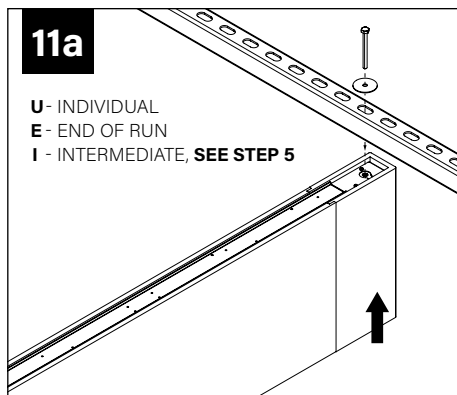

**11b**

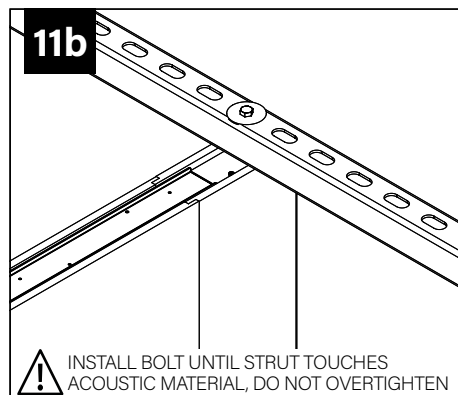

⚠️ INSTALL BOLT UNTIL STRUT TOUCHES ACOUSTIC MATERIAL, DO NOT OVERTIGHTEN

**12** x6

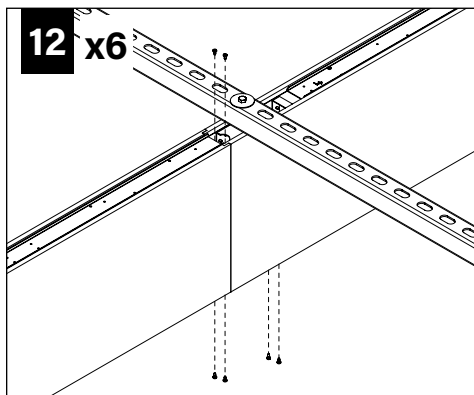

Joiner Screw  
(700295)

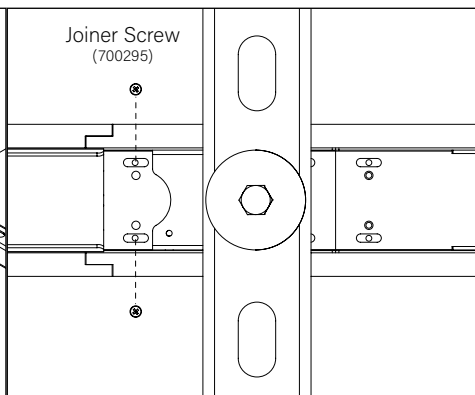

**INDIRECT AND UNLIT UNITS ONLY**

**13**

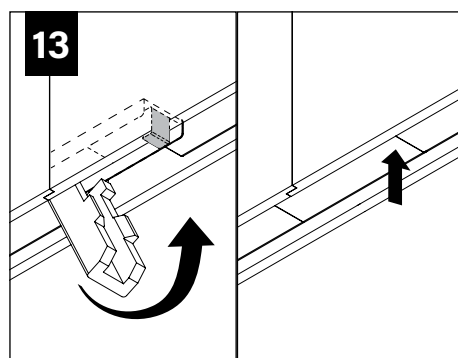

GENTLY FLIP UP PET FELT ACCESS DOOR UNTIL IT MEETS THE INTERNAL STOPPING MECHANISM  
**DO NOT APPLY EXCESSIVE PRESSURE**

**14a**

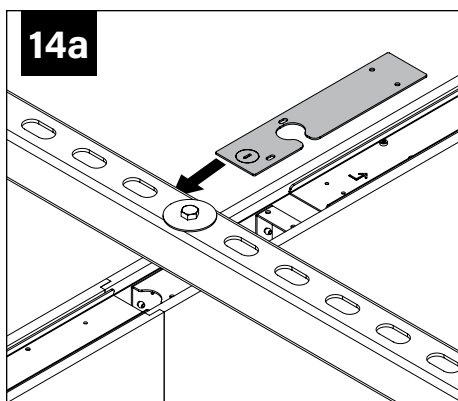

**14b**

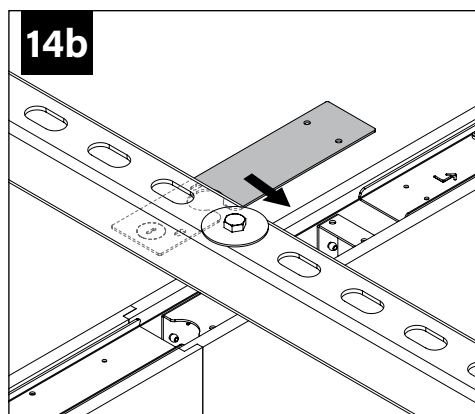

ALIGN COVER WITH  
THREADED HOLES BELOW

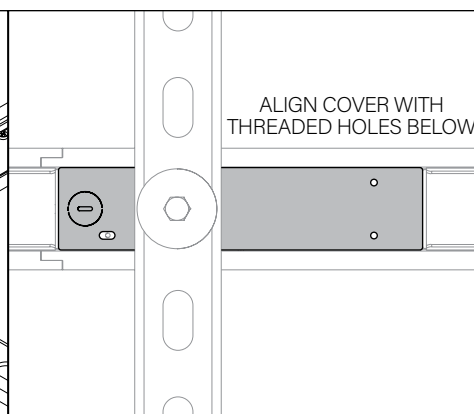

**15**

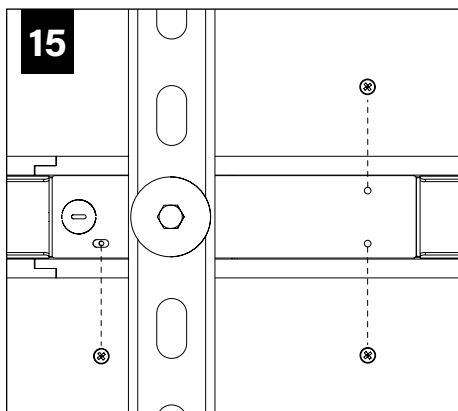

**16**

TIGHTEN BOLT UNTIL STRUT  
TOUCHES ACOUSTIC MATERIAL

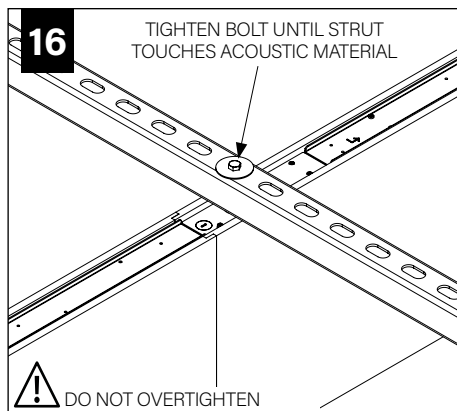

⚠️ DO NOT OVERTIGHTEN

**17**

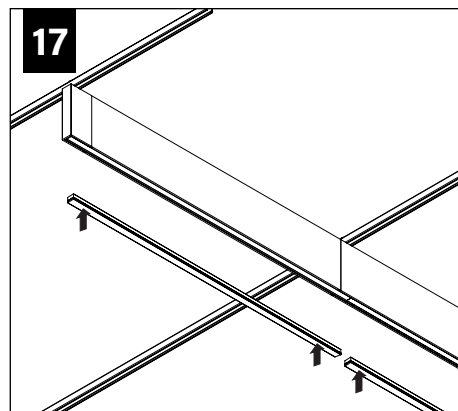

## DIRECT TO STRUT - DRIVER SERVICE



### HARDWARE PROVIDED FOR 1-5/8" STRUT HEIGHT.

CONTACT FOCAL POINT IF DIFFERENT HARDWARE IS REQUIRED FOR INSTALLATION.

Strut Height	Bolt: 1/4-20 x
13/16"	2.0"
7/8"	2.0"
1"	2.25"
1-3/8"	2.50"
<b>1-5/8"</b>	<b>2.75"</b>
2-7/16"	3.50"
3-1/4"	4.50"

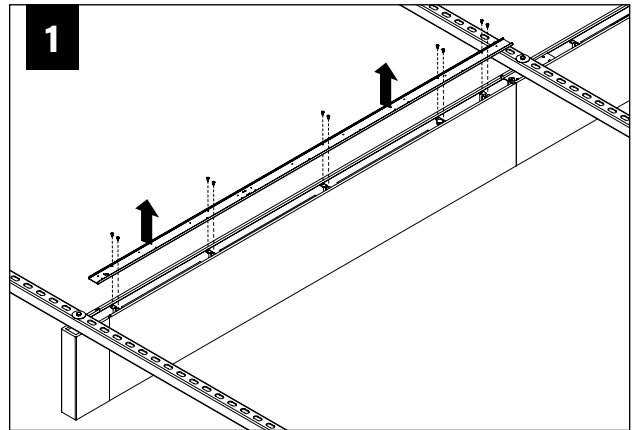

## DIRECT TO GRID INSTALLATION



DIRECT TO GRID  
**RUN LENGTHS  
ARE LIMITED TO 16FT.**

RUNS SHOULD BE JOINED  
ON A FLAT SURFACE **BEFORE**  
MOUNTING TO GRID.



FOR INDIVIDUAL UNITS FOLLOW  
**STEPS 9-18**

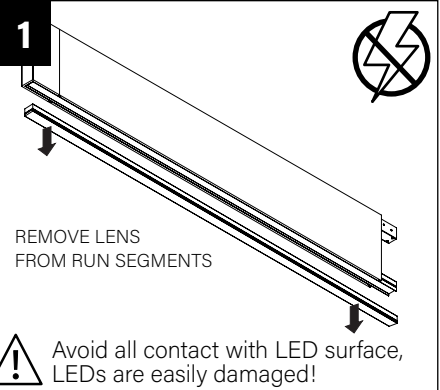

### INDIRECT AND UNLIT UNITS ONLY

**2**

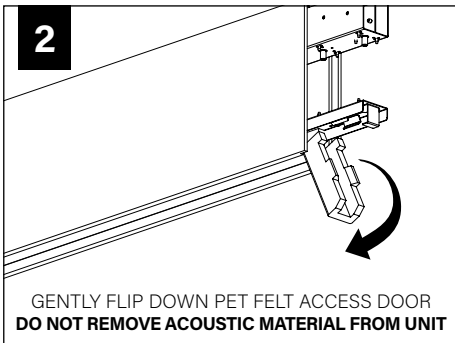

**3**

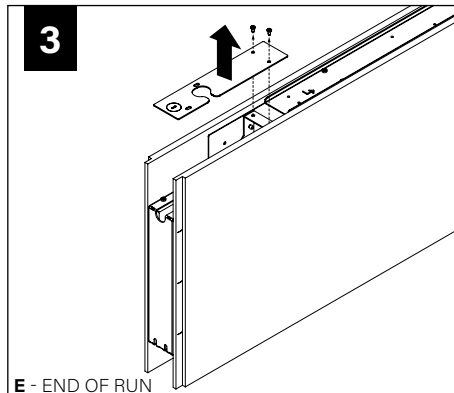

**4**

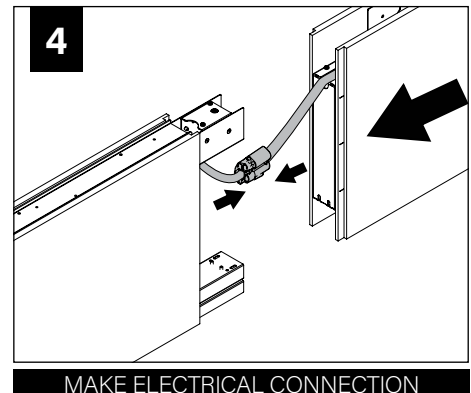

### INDIRECT AND UNLIT UNITS ONLY

**5**

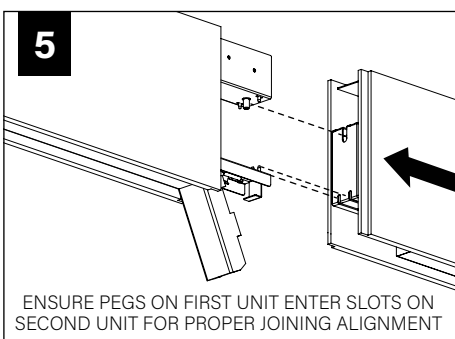

**6 x8**

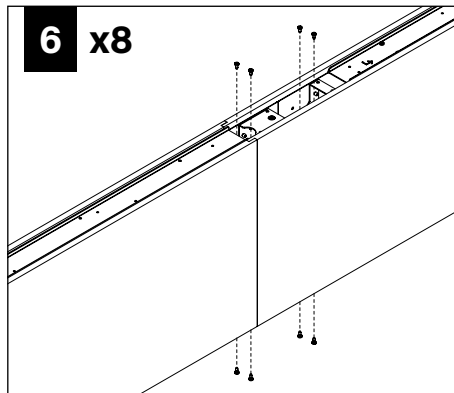

**6 detail view**

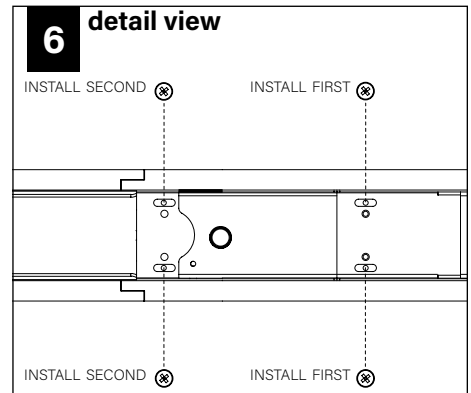

**INDIRECT AND UNLIT UNITS ONLY**

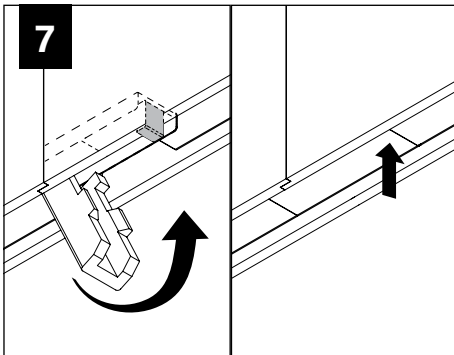

GENTLY FLIP UP PET FELT ACCESS DOOR UNTIL IT MEETS THE INTERNAL STOPPING MECHANISM  
**DO NOT APPLY EXCESSIVE PRESSURE**

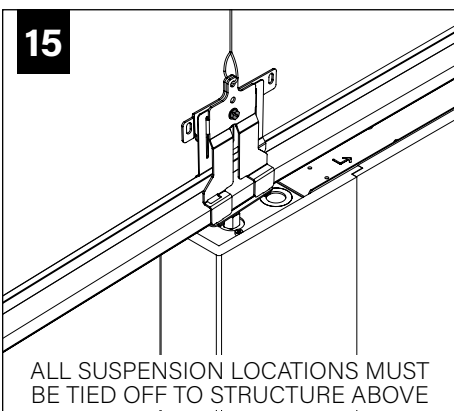
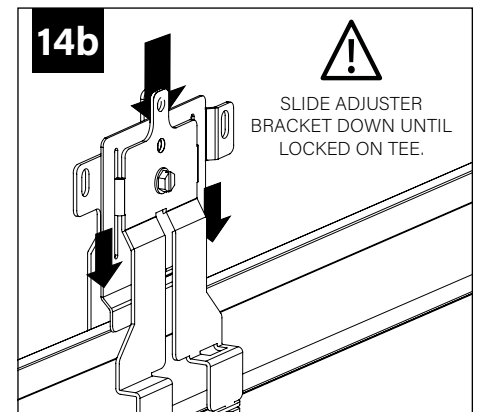
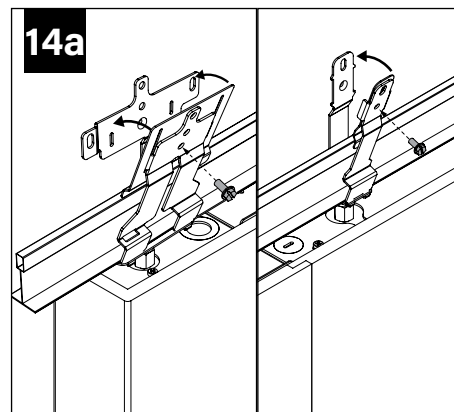
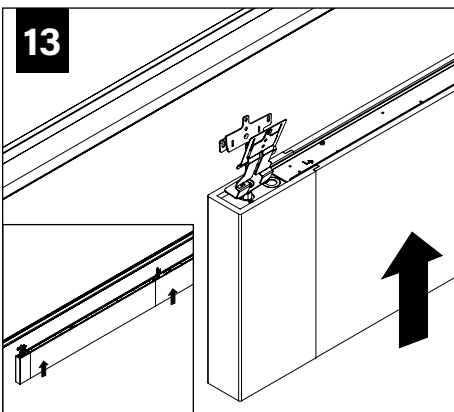
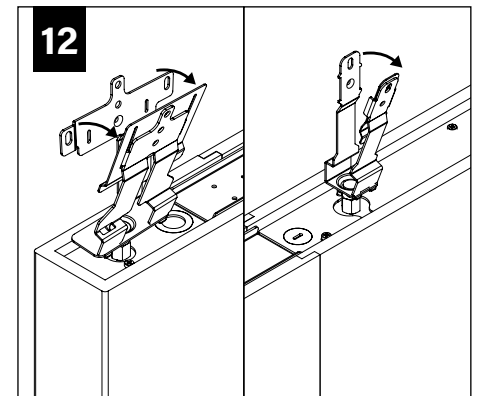
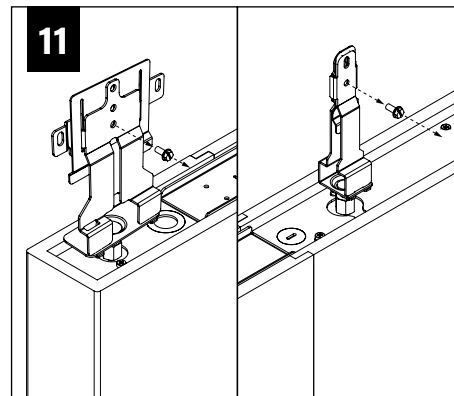
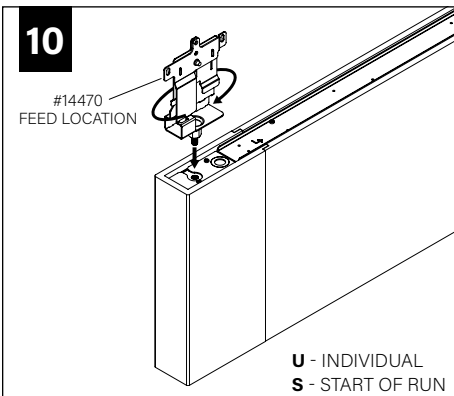
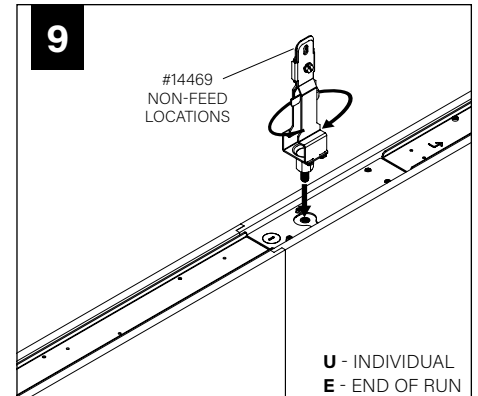
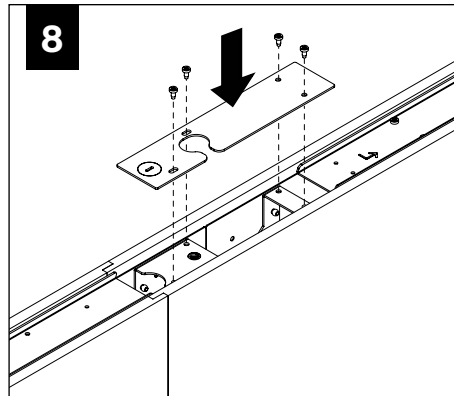

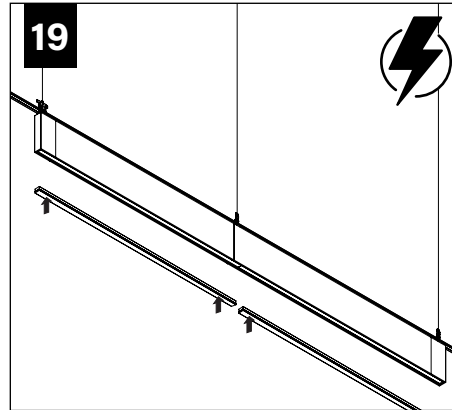
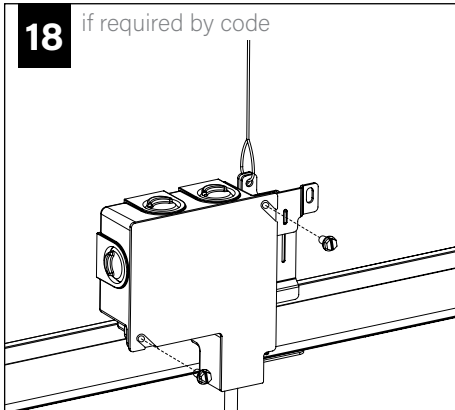
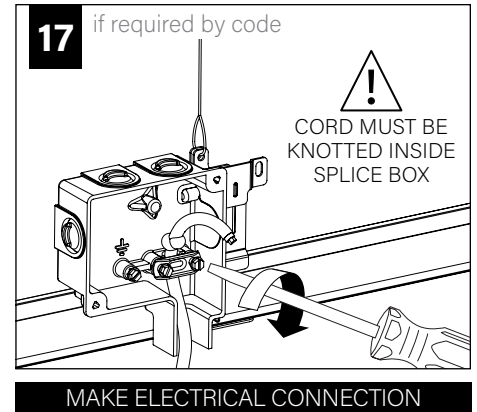
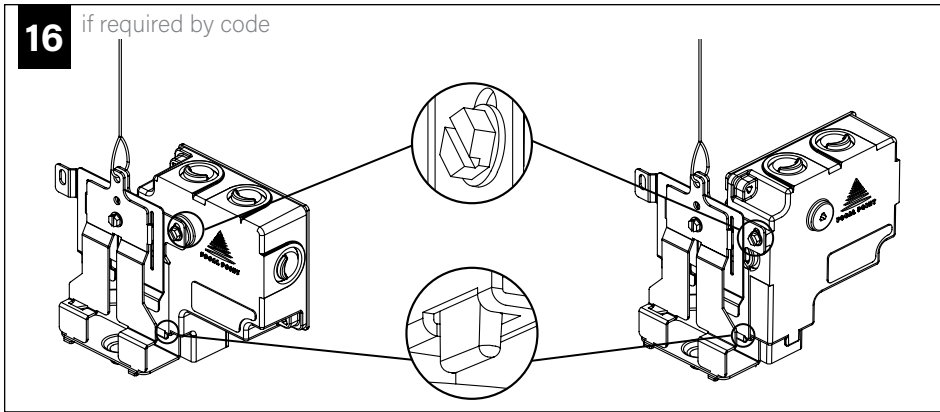

## DRIVER SERVICE

