

Seem[®] 4 LED Asymmetric Angled Lens

mud-in-drywall

FSM4AL-XF



FOCAL POINT[™]

! LUMINAIRE MUST BE INSTALLED PRIOR TO DRYWALL. !

! CONFIGURATIONS ARE RUN SPECIFIC, PLEASE CONSULT FACTORY DRAWINGS BEFORE BEGINNING INSTALLATION. !

FOCAL POINT

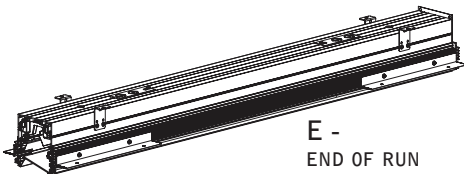
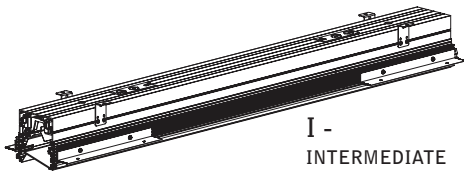
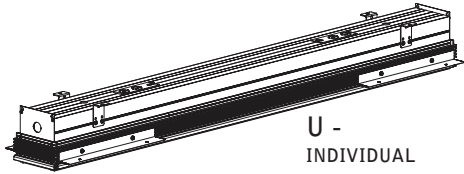

PARTS LISTS

PARTS SHIPPED INSTALLED

**TIE-WIRE BRACKET
SCREW (72010)**
(8-18 x 1/4 SELF TAPPING
SCREW)

**TIE-WIRE BRACKET
(12547)**

**JOINER BRACKET
(A16274-01)**

**JOINER FILLER
(A15524-01)**

**LOWER JOINER
BRACKET
(11920)**

SHIELDING SHIPPED LOOSE

FROSTED LENS

KEY

POWER ON **ATTENTION**

POWER OFF

**BACKER FLANGE
(SHIPPED LOOSE
XF1/XF2 PRE-INSTALLED)**

**MUD FLANGE
(SHIPPED LOOSE)**

! ORIENTATION

WALL

BACKER FLANGE PLACEMENT GUIDE

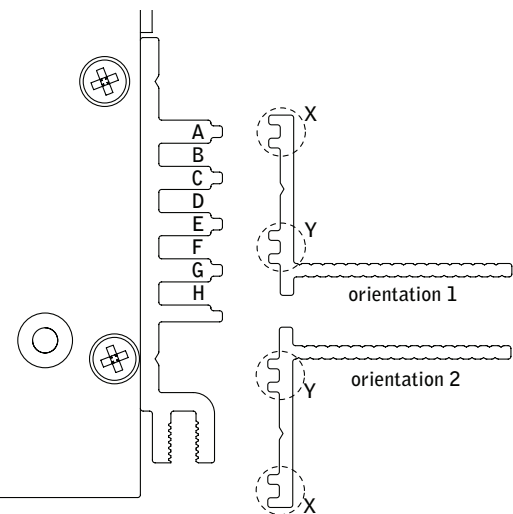

DRYWALL THICKNESS	ORIENTATION	GUIDE POINT	POSITION
3/8"	1	X	F
1/2"	1	X	E
5/8"	1	X	D
3/4"	1	X	C
7/8"	1	X	B
1"	1	X	A
1 1/8"	1	Y	G
1 1/4"	2	Y	F
1 3/8"	2	Y	E
1 1/2"	2	Y	D
1 5/8"	2	Y	C
1 3/4"	2	Y	B
1 7/8"	2	Y	A
2"	2	X	E
2 1/8"	2	X	D

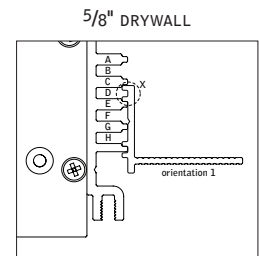
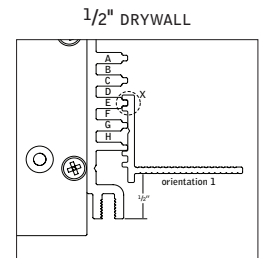

Luminaires must be installed by a qualified electrician (check with local and national codes for proper installation).
To prevent electrical shock, disconnect electrical supply before installation or servicing.

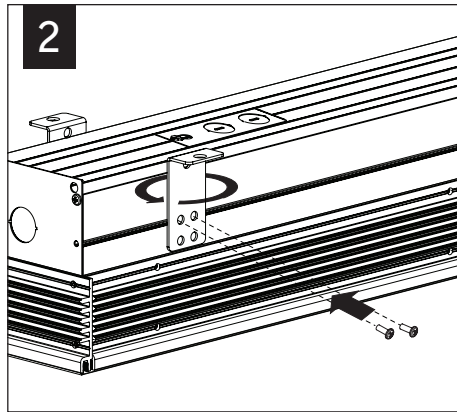
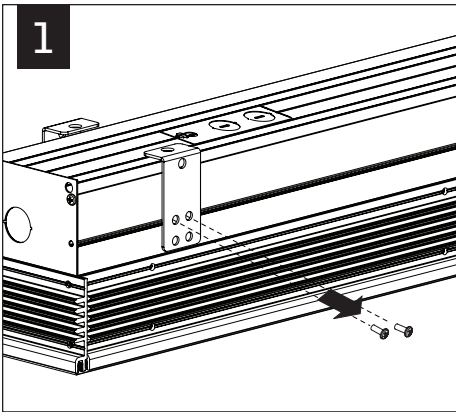

3 USING THE BACKER FLANGE
PLACEMENT GUIDE FROM
PAGE 1 DETERMINE THE
PROPER PLACEMENT OF THE
BACKER FLANGE FOR YOUR
DRYWALL THICKNESS.

**IF BACKER FLANGES WERE
PRE-INSTALLED SKIP TO STEP 5**

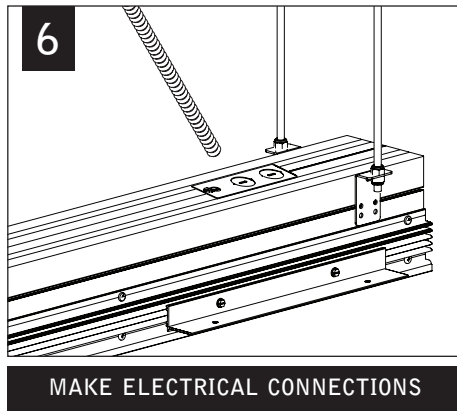
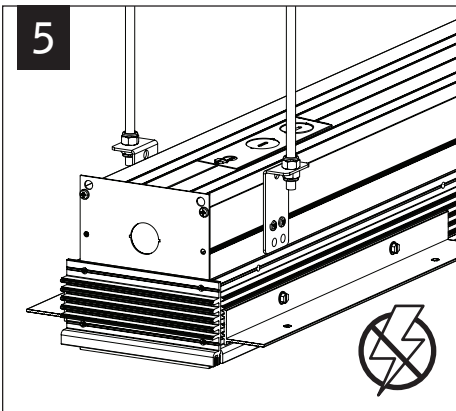
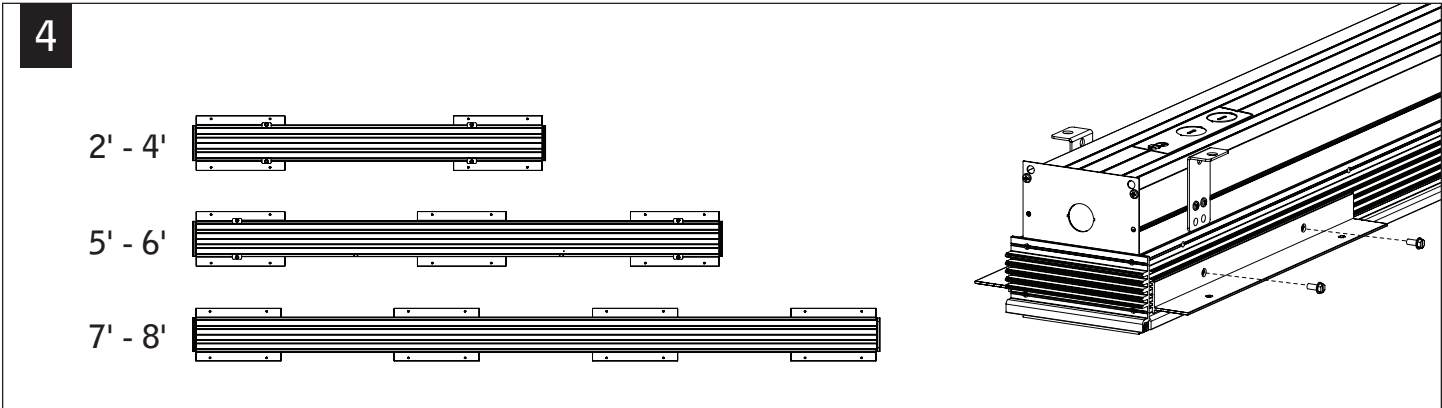

**INDIVIDUAL INSTALLATIONS
SKIP TO STEP 13**

**ROW MOUNT INSTALLATIONS
REPEAT STEPS 7-12 UNTIL
ALL UNITS ARE INSTALLED**

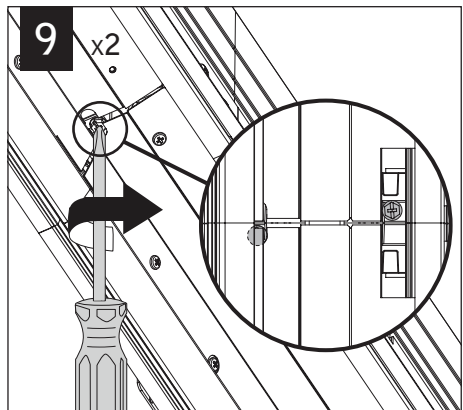
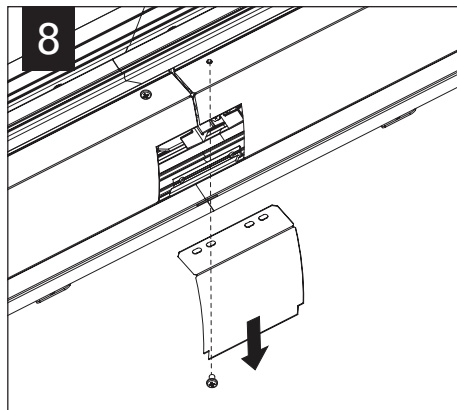
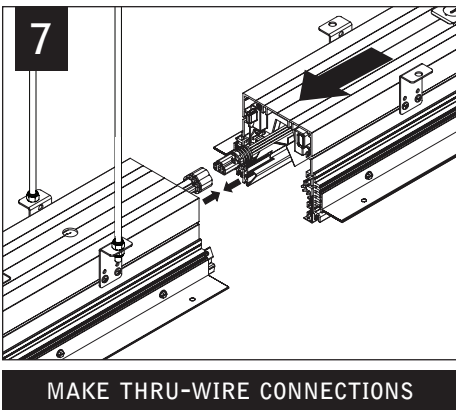

Luminaires must be installed by a qualified electrician (check with local and national codes for proper installation).
To prevent electrical shock, disconnect electrical supply before installation or servicing.

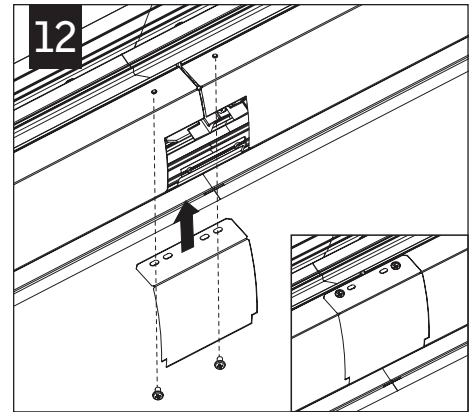
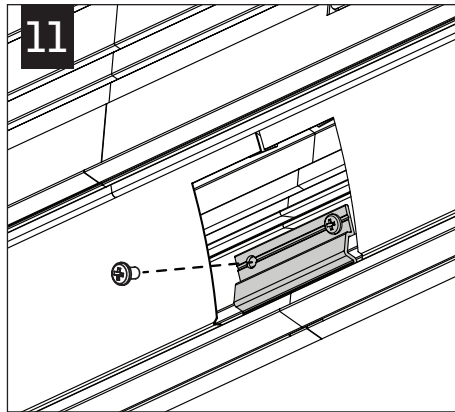
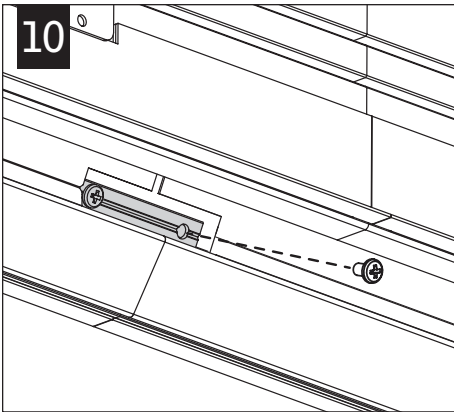

13

ATTENTION
BEFORE BEGINNING DRYWALL
INSTALLATION CONSULT GUIDE ON
PAGE 1 TO ENSURE THE BACKER
FLANGE IS SET AT THE CORRECT
DEPTH FOR THE DRYWALL.

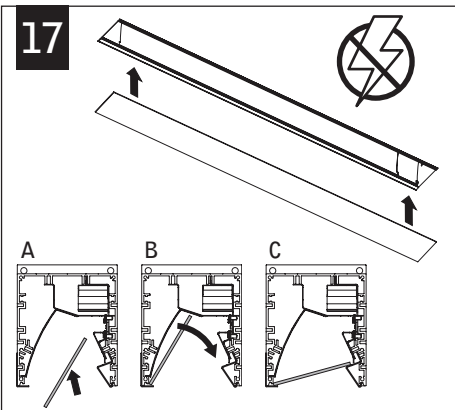
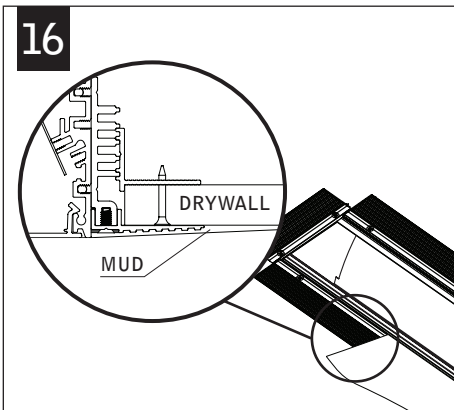
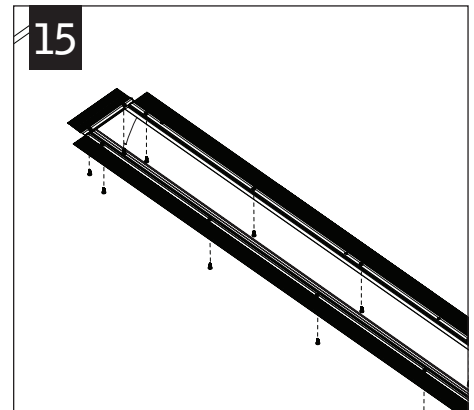
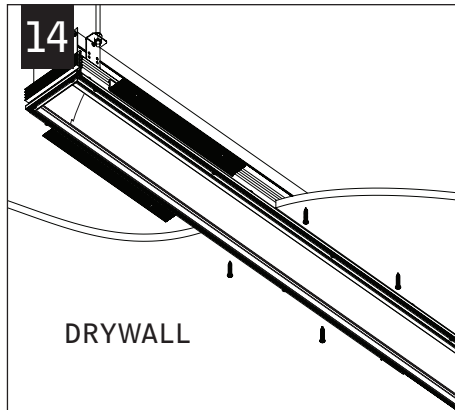

DRIVER SERVICE

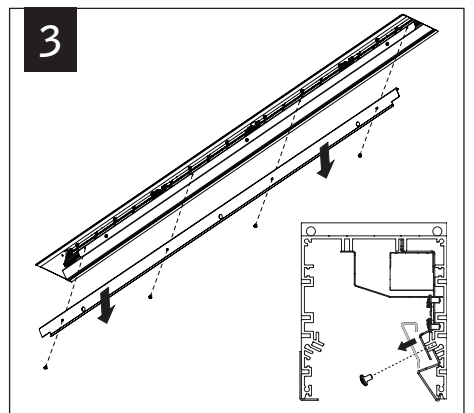
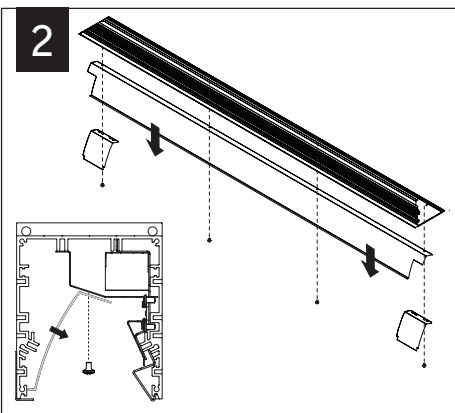
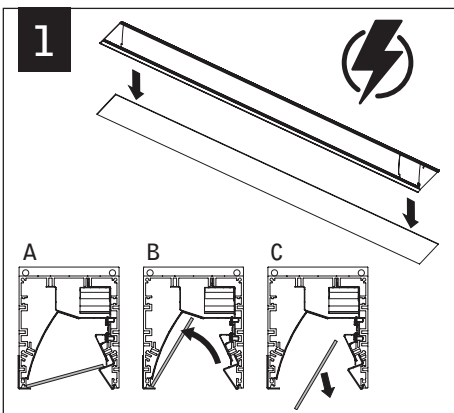

Luminaires must be installed by a qualified electrician (check with local and national codes for proper installation).
To prevent electrical shock, disconnect electrical supply before installation or servicing.

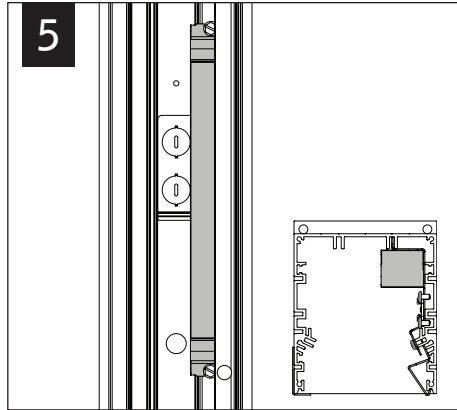
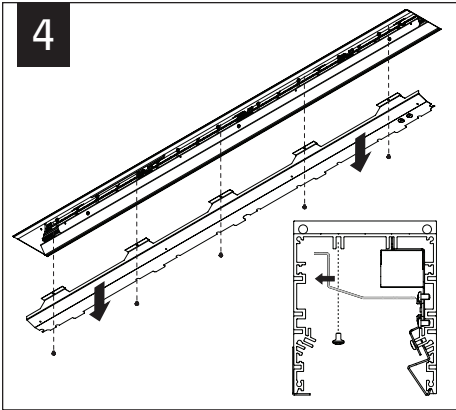

Contractor is responsible for adequately reinforcing walls and/or ceilings to support luminaire weight. Focal Point, LLC accepts no responsibility for inadequately reinforced walls and/or ceilings. The information contained in this drawing is the sole property of Focal Point, LLC. Any reproduction in part or whole without the written permission of Focal Point, LLC is prohibited.