

# id+ 4.5" & 6" square housing

FLC44D | FLC44W | FLC66D | FLC66W



FOCAL POINT®

**! LUMINAIRE MUST BE INSTALLED PRIOR TO DRYWALL CEILING. ALL GRID LUMINAIRES MUST BE SECURED TO STRUCTURE ABOVE. !**

NON-EMERGENCY - THERMALLY PROTECTED, NON-IC

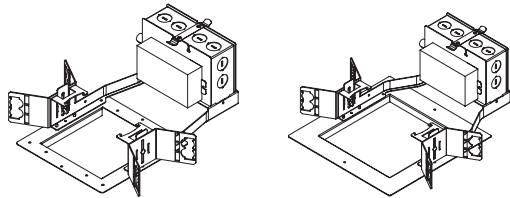

FLC44D | FLC44W      FLC66D | FLC66W

**!** OPTIONAL BAR HANGERS SOLD SEPARATELY

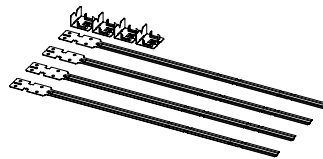

KEY

- POWER OFF
- POWER ON
- LEVEL
- ATTENTION
- I** SEE ADDITIONAL INSTRUCTIONS

EMERGENCY - INTEGRAL TEST SWITCH

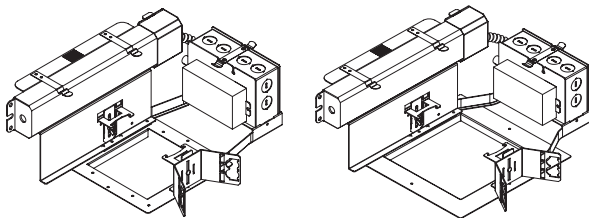

FLC44D | FLC44W      FLC66D | FLC66W

CP - EMERGENCY/NON-EMERGENCY

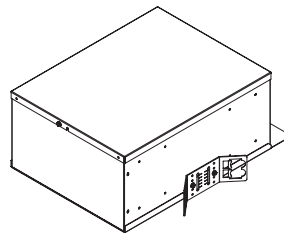

FLC44D | FLC44W | FLC66D | FLC66W

<p><b>A</b></p> <p><b>I</b></p> <p>TO SET CEILING THICKNESS SEE FOCAL POINT INSTRUCTION SHEET</p> <p>IS0720 - 4.5"</p> <p>IS0586 - 6"</p>	<p><b>1</b></p> <p>5 1/8"      5 1/8"</p> <p>4.5" overlap</p>	<p>7 5/8"      7 5/8"</p> <p>4.5" flush</p>	<p>6 3/4"      6 3/4"</p> <p>6" overlap</p>	<p>9 3/8"      9 3/8"</p> <p>6" flush</p>
---	---	---	---	---

## GRID - 1/2" CONDUIT & CLIP (BY OTHERS)

<p><b>2</b> x2</p>	<p><b>3</b></p>	<p><b>4</b> x4</p>
--------------------	-----------------	--------------------

Luminaires must be installed by a qualified electrician (check with local and national codes for proper installation). To prevent electrical shock, disconnect electrical supply before installation or servicing.

## GRID - BAR HANGERS (SOLD SEPARATELY)

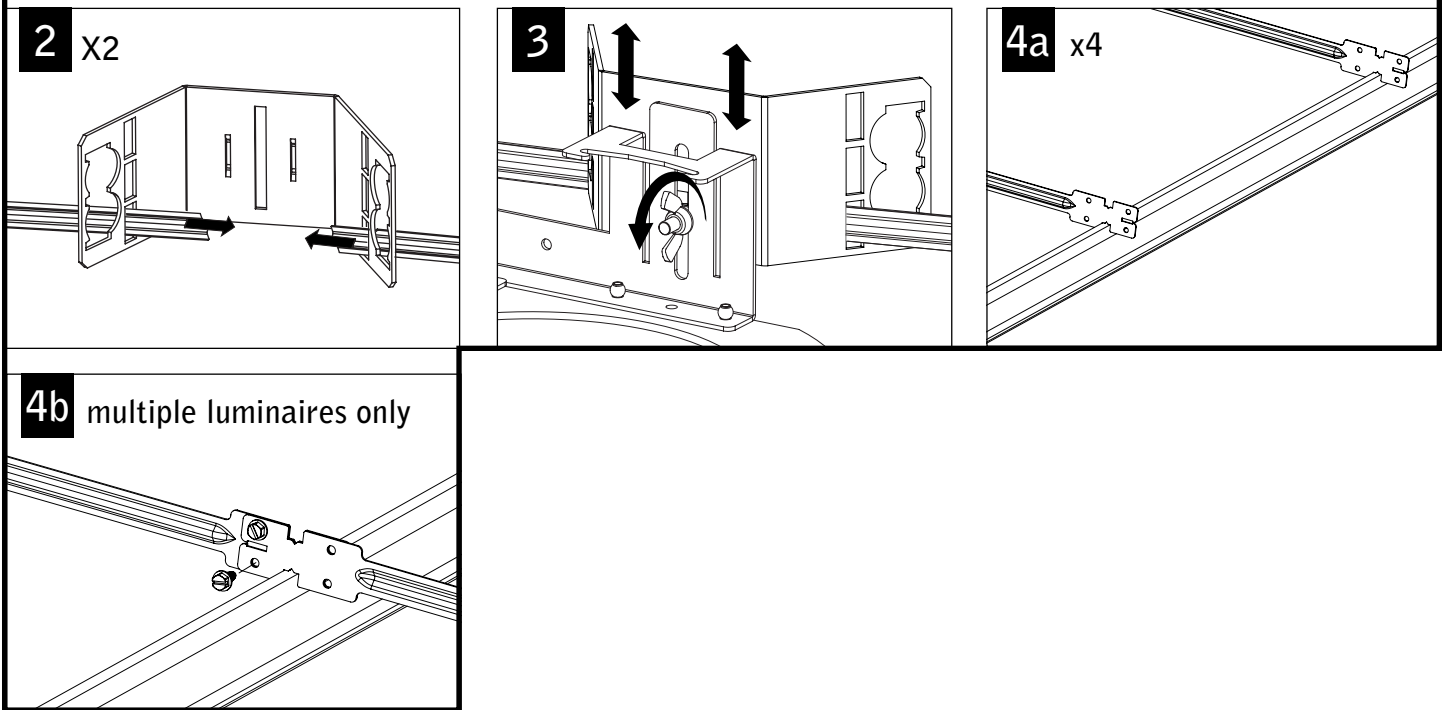

## DRYWALL - BAR HANGERS

### WOOD STUDS

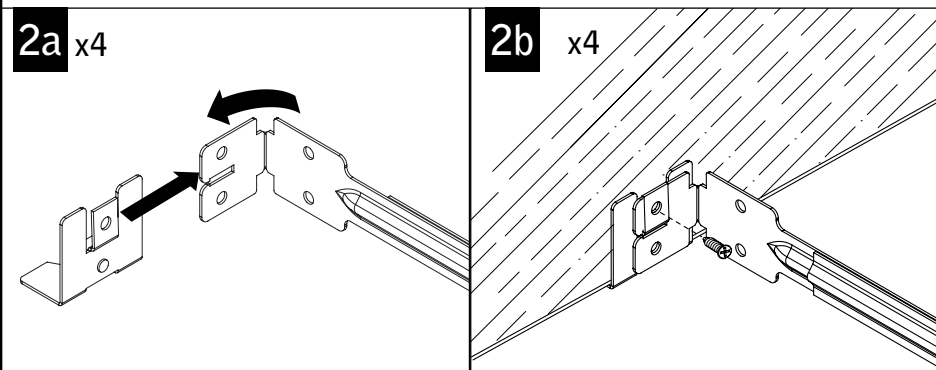

### METAL STUDS

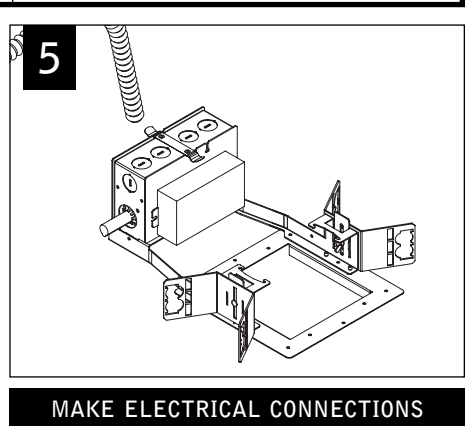
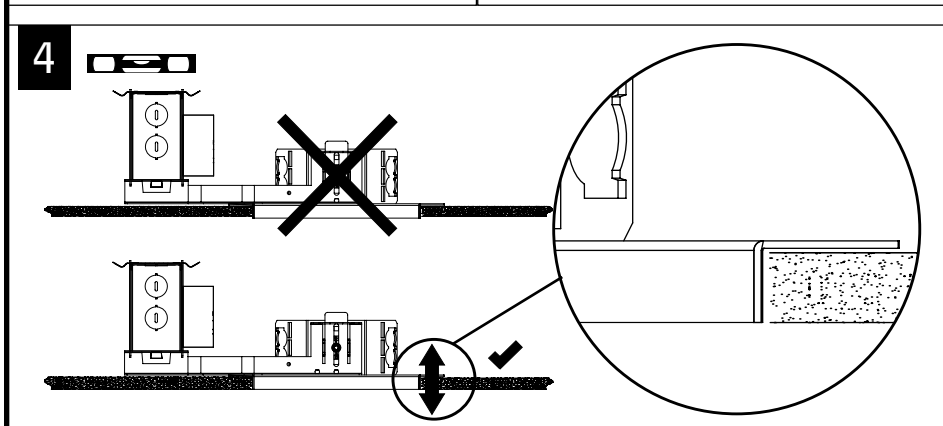
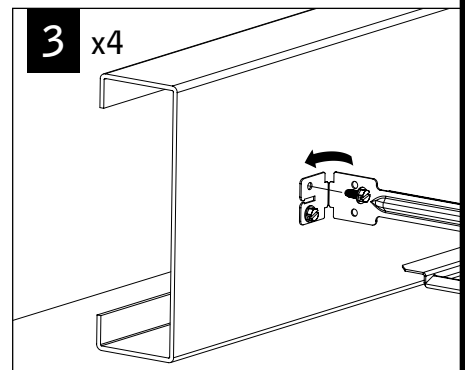

Fixtures must be installed by a qualified electrician (check with local and national codes for proper installation).  
To prevent electrical shock, disconnect electrical supply before installation or servicing.

## FLUSH TRIM MUD-IN

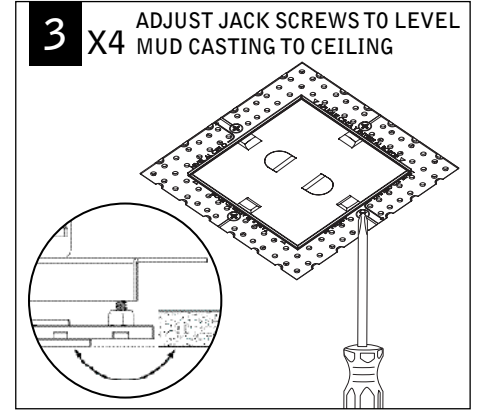
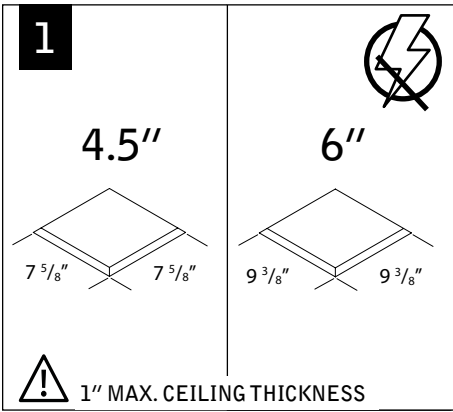

## EMERGENCY - INTEGRAL TEST SWITCH

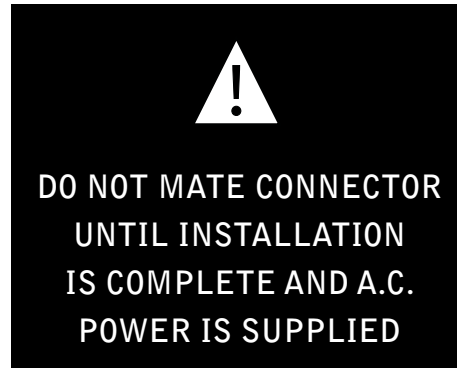
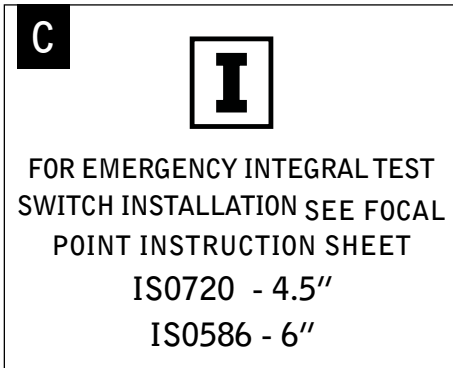
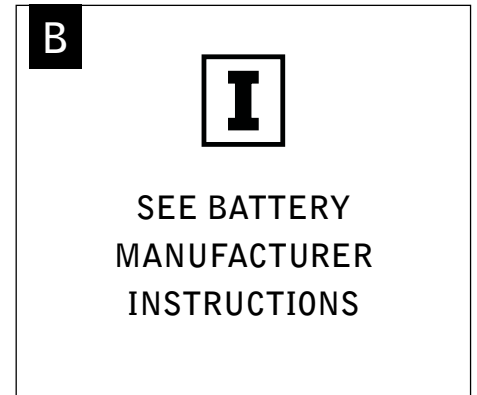
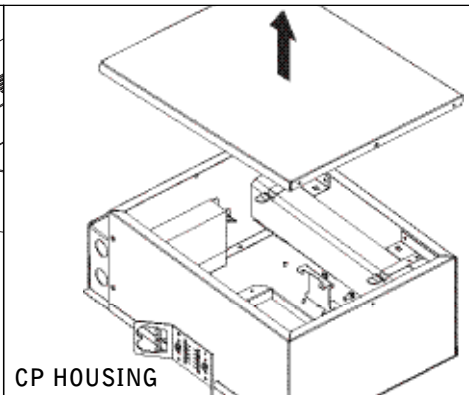
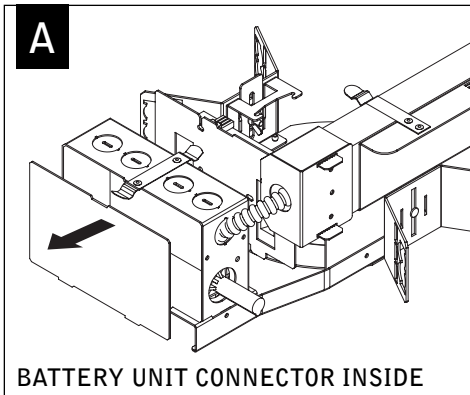

## DRIVER SERVICE

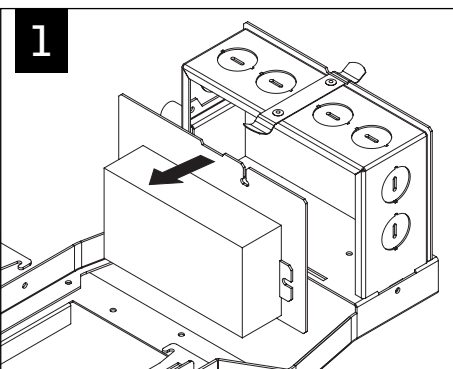

Contractor is responsible for adequately reinforcing walls and/or ceilings to support fixture weight. Focal Point, LLC accepts no responsibility for inadequately reinforced walls and/or ceilings. The information contained in this drawing is the sole property of Focal Point, LLC. Any reproduction in part or whole without the written permission of Focal Point, LLC is prohibited.