



BEFORE YOU BEGIN

- Luminaires must be installed by a qualified electrician (check with local and national codes for proper installation).
- To prevent electrical shock, disconnect electrical supply before installation or servicing.
- Contractor is responsible for adequately reinforcing walls and/or ceilings to support fixture weight.
- Focal Point, LLC accepts no responsibility for inadequately reinforced walls and/or ceilings.
- The information contained in this drawing is the sole property of Focal Point, LLC. Any reproduction in part or whole without the written permission of Focal Point, LLC is prohibited.

INSTRUCTION KEY



ATTENTION



SEE ADDITIONAL INSTRUCTIONS



POWER OFF



POWER ON

COMPONENT KEY

FOCAL POINT

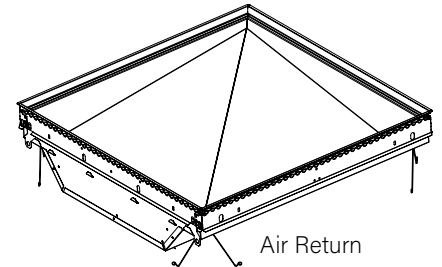
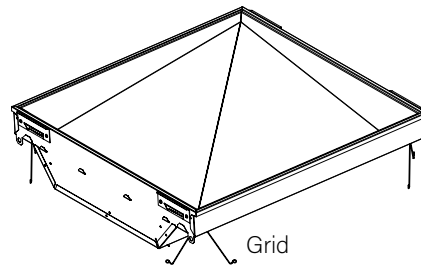

GRID INSTALLATION

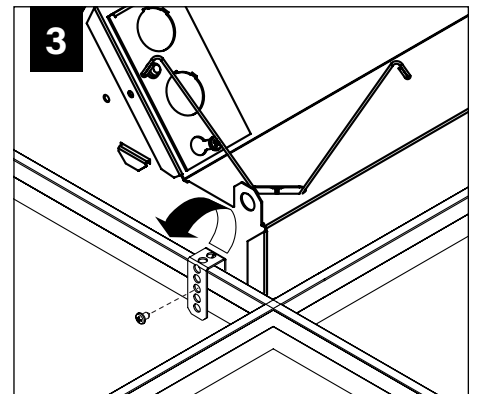
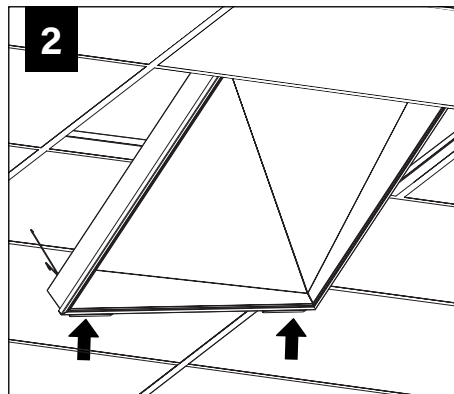
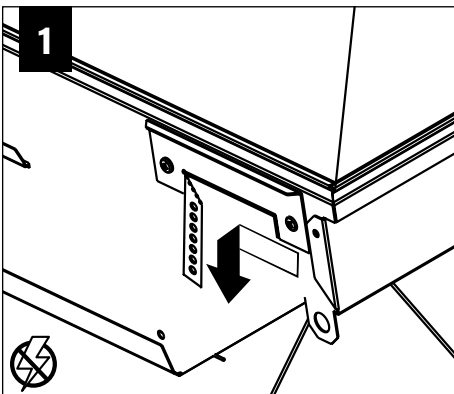

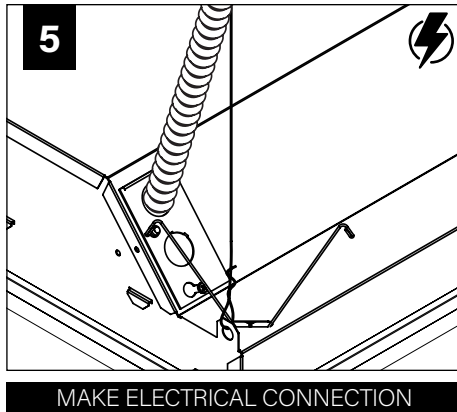
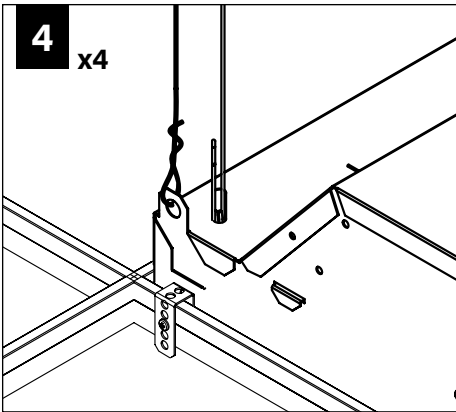

DRYWALL INSTALLATION

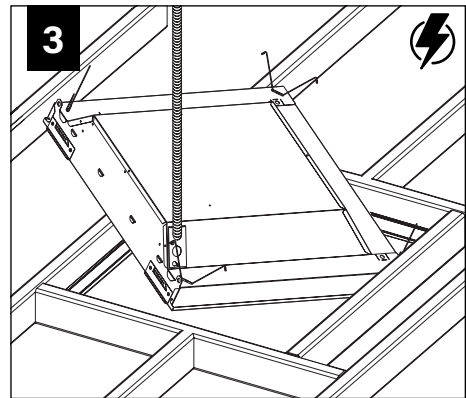
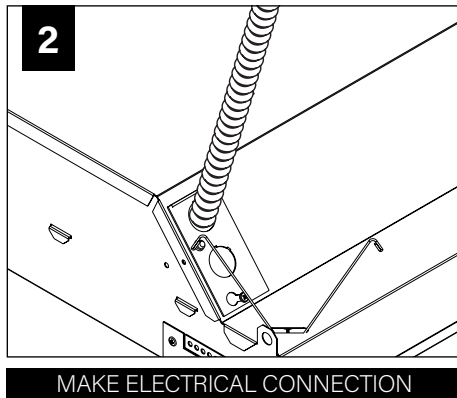
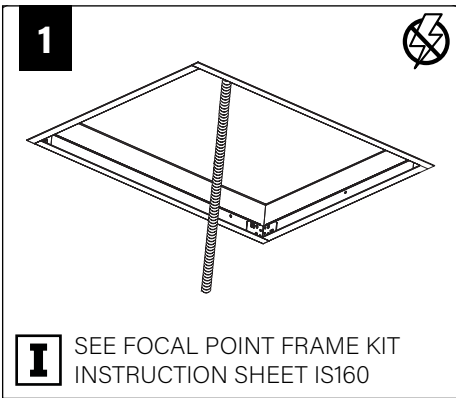

DRIVER SERVICE

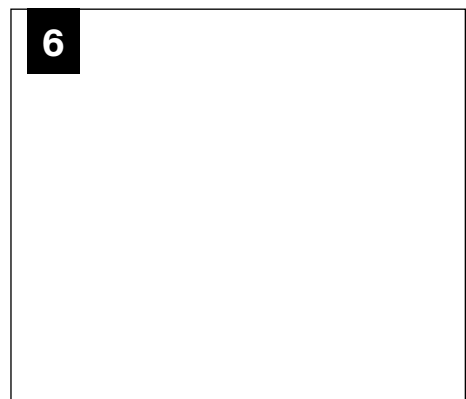
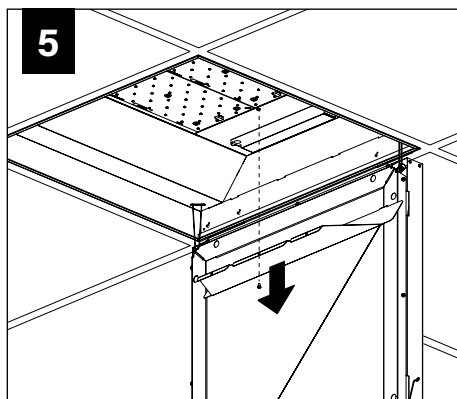
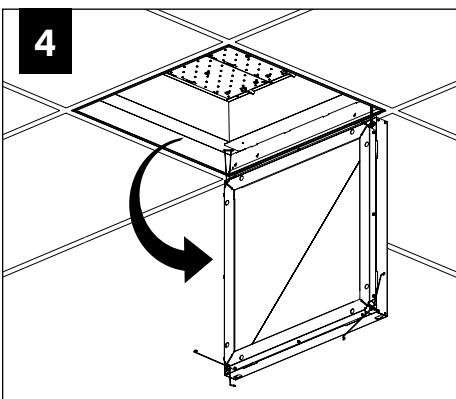
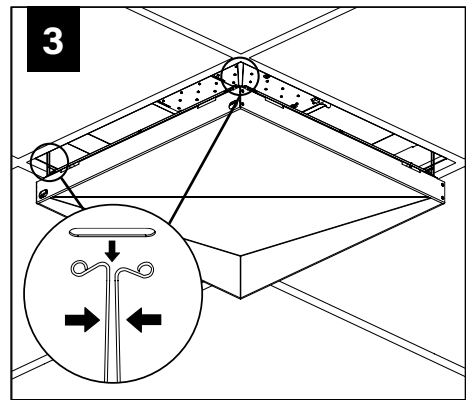
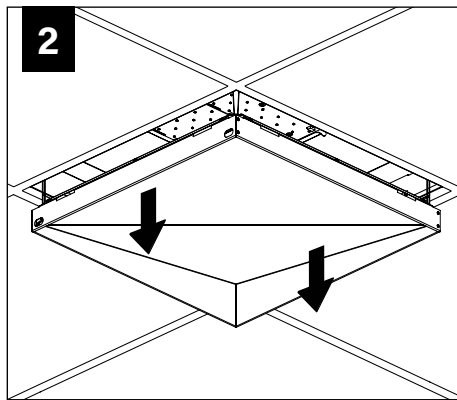
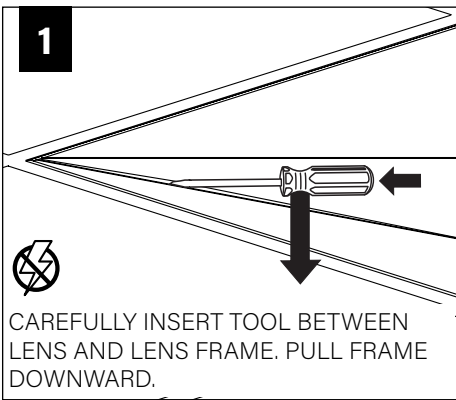

AIR RETURN INSTALLATION

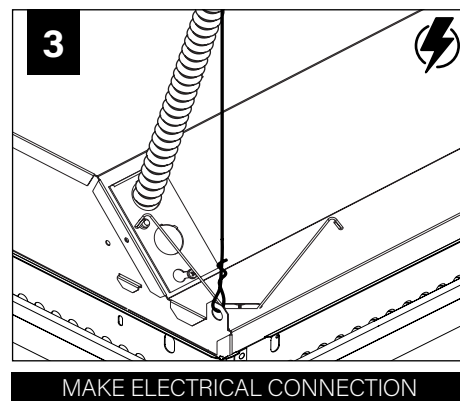
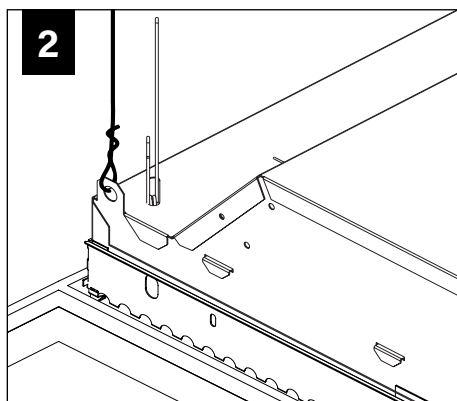
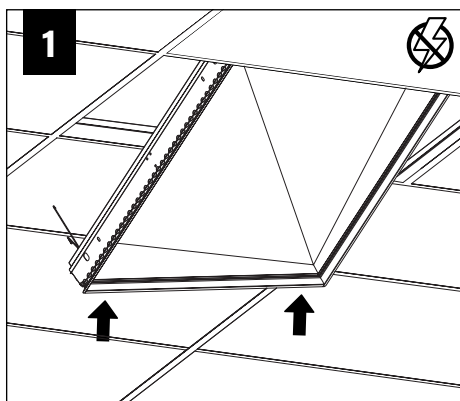

MAKE ELECTRICAL CONNECTION



WATTSTOPPER

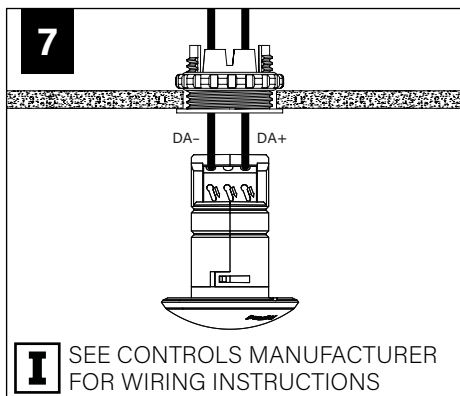
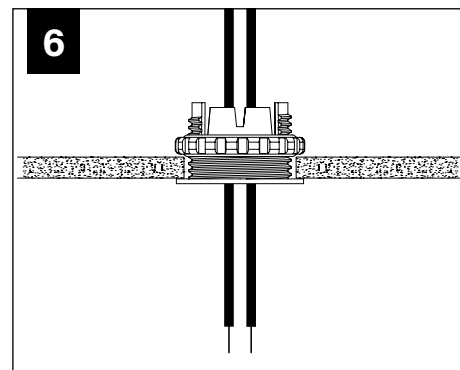
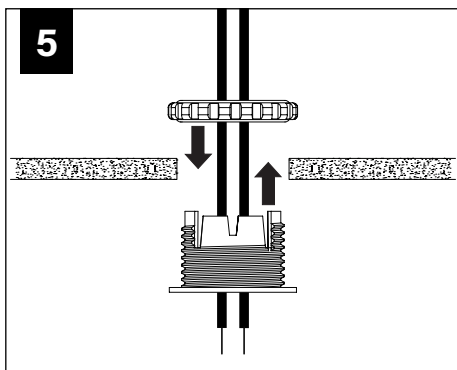
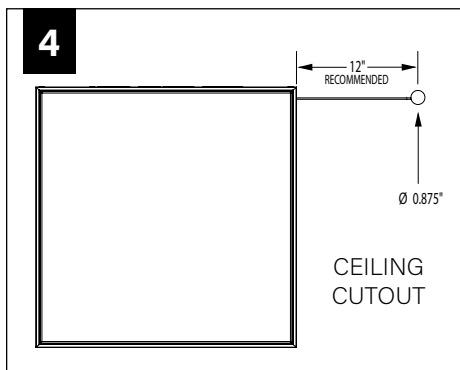
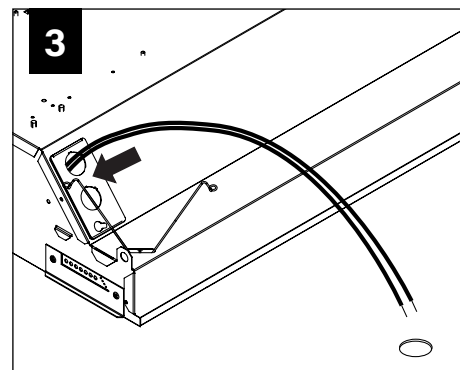
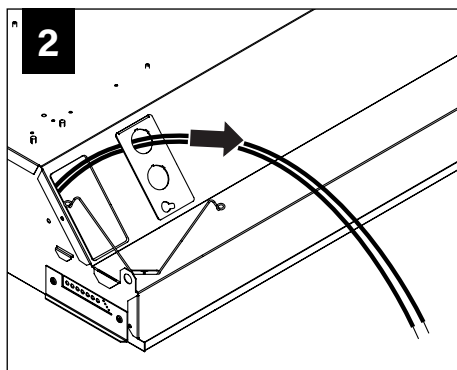
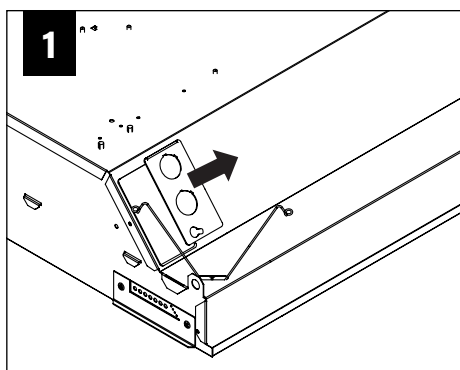

I SEE CONTROLS MANUFACTURER FOR WIRING INSTRUCTIONS

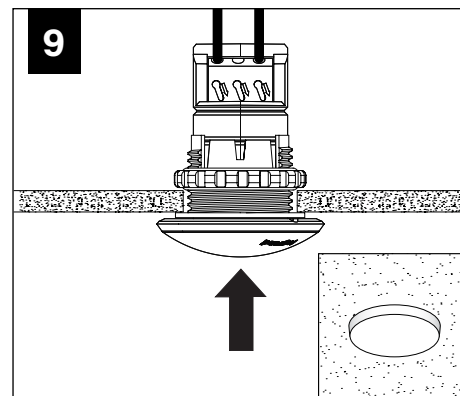
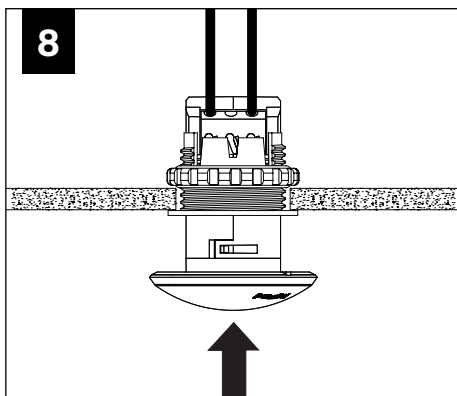

ENLIGHTED

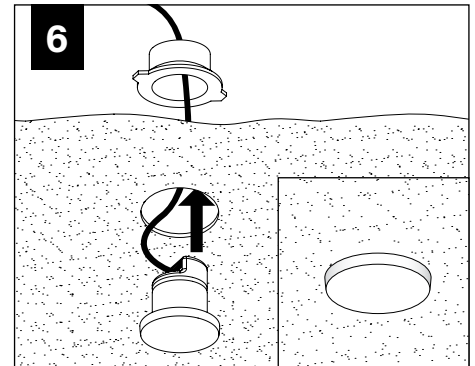
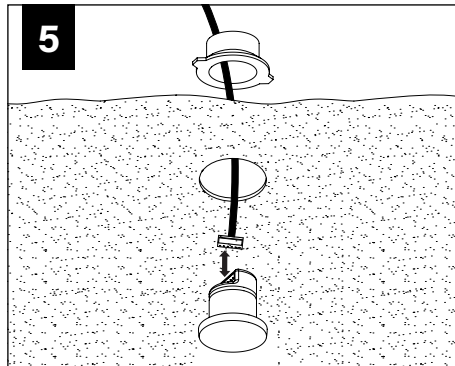
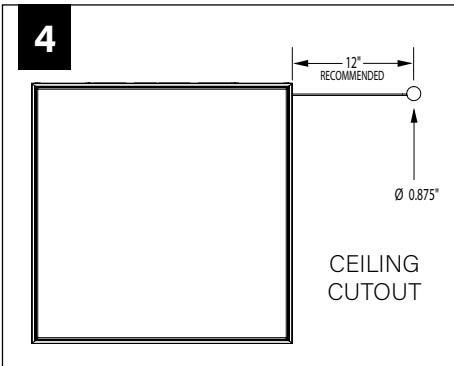
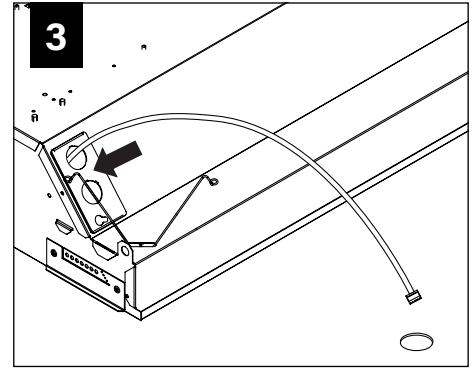
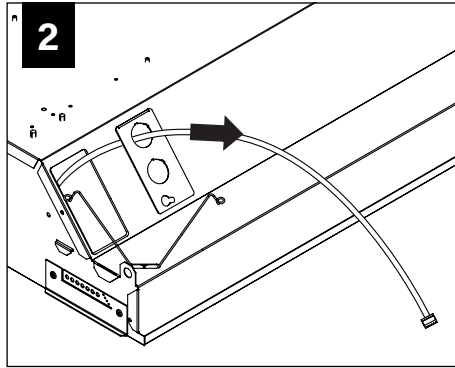
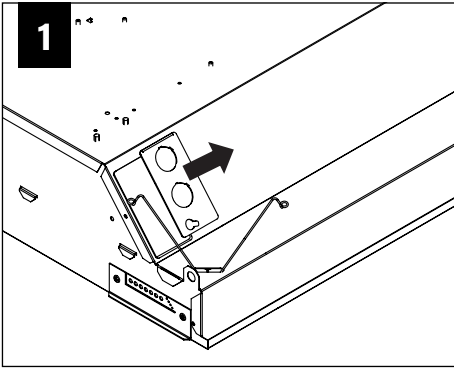

WAVELINX

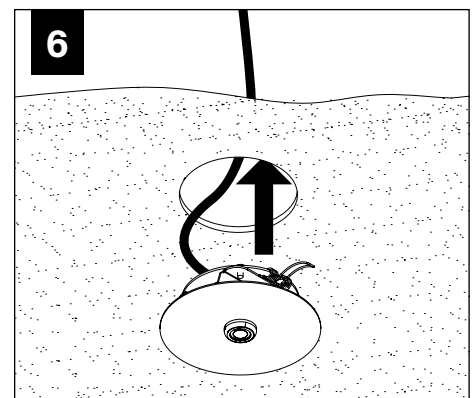
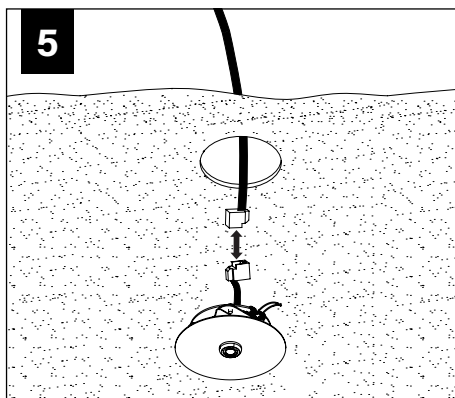
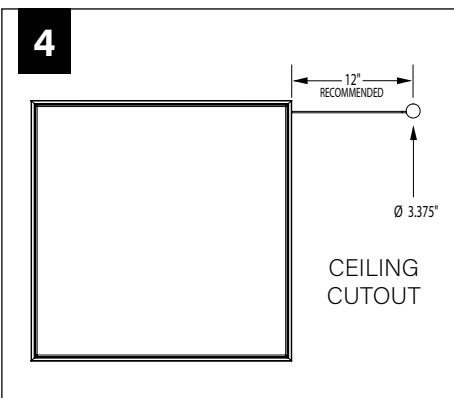
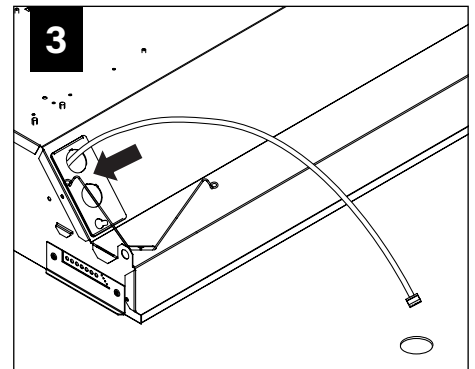
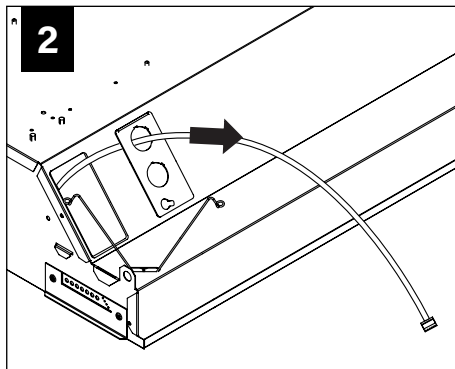
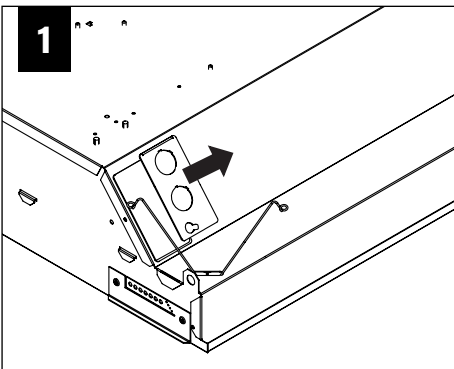

WAVELINX

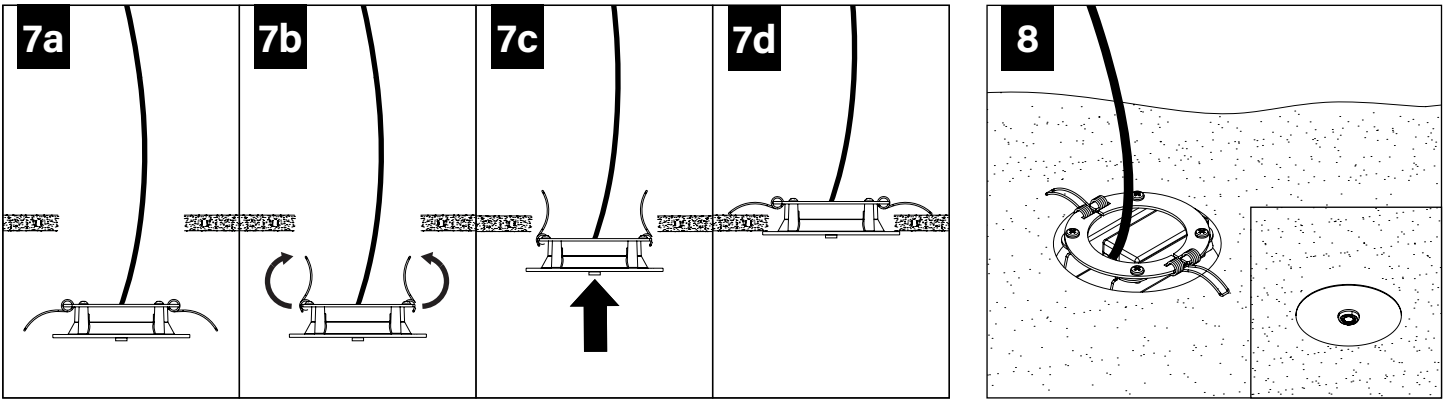

ACUITY nLIGHT

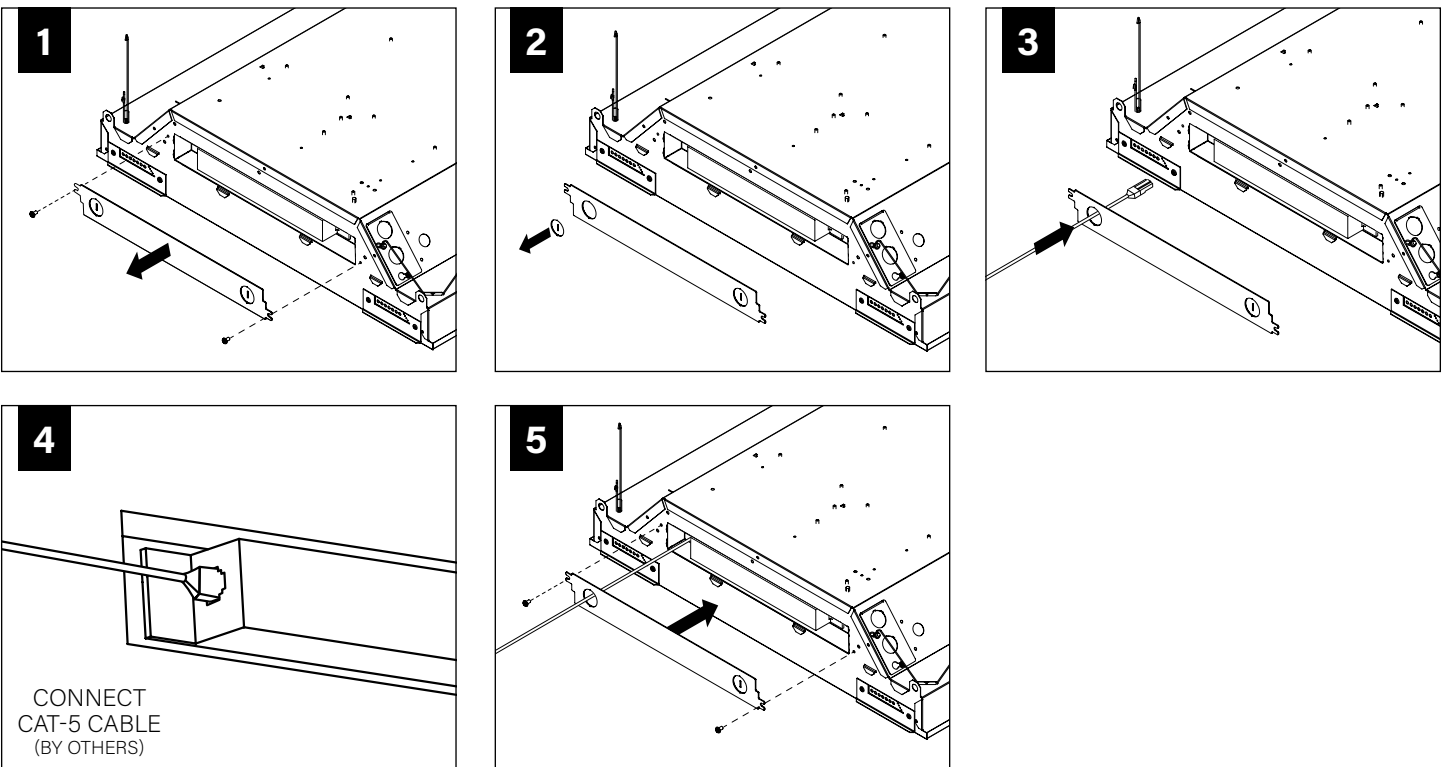

WATTSTOPPER

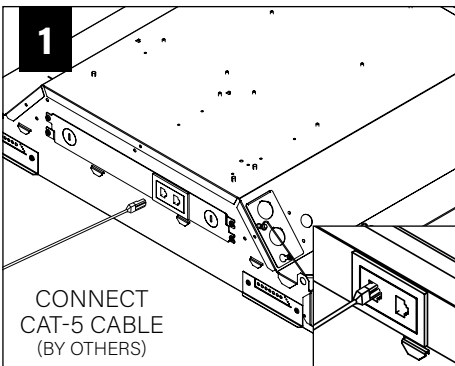

HUBBELL NX

