

FOCAL POINT

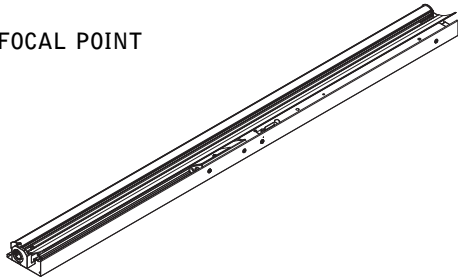

WIRING COMPARTMENT SHIPS WITH 2' HOUSING ONLY.

KEY



POWER OFF



POWER ON



ATTENTION



8" CLEARANCE ABOVE COVE RECOMMENDED FOR ALL APPLICATIONS

horizontal base with adjustable light scoop also available without light scoop

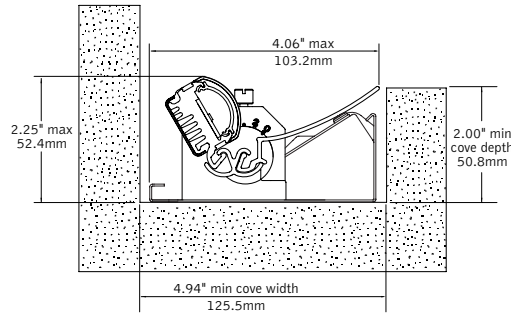

vertical base

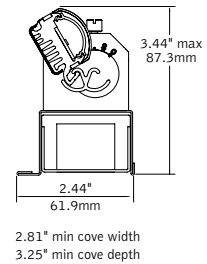

1

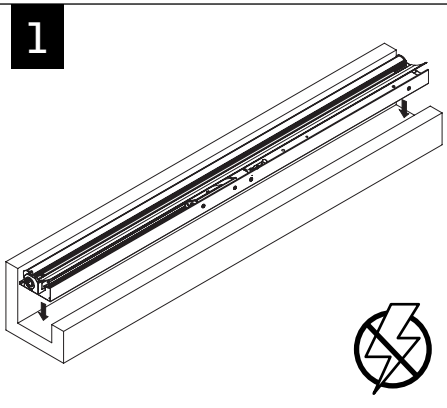

OPTIONAL - SECURE HOUSING TO COVE

2

HORIZONTAL BASE

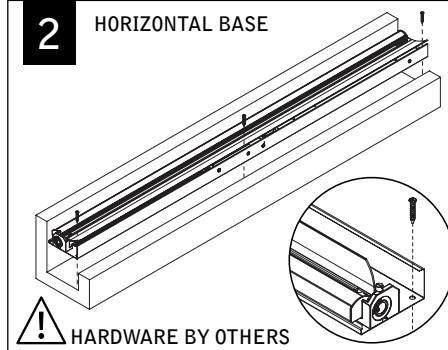

VERTICAL BASE

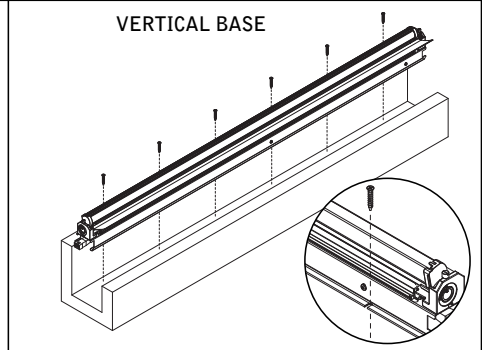

2' HOUSING ONLY

3

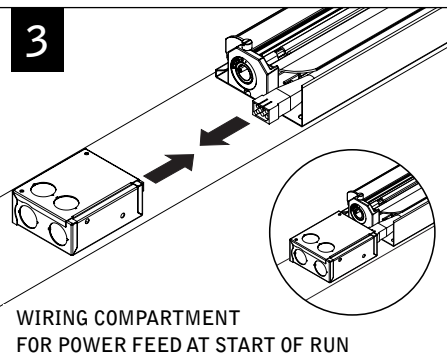

4

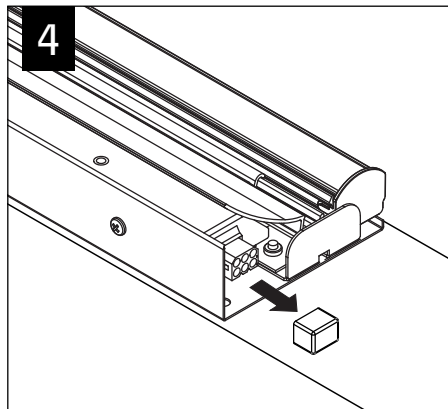

5

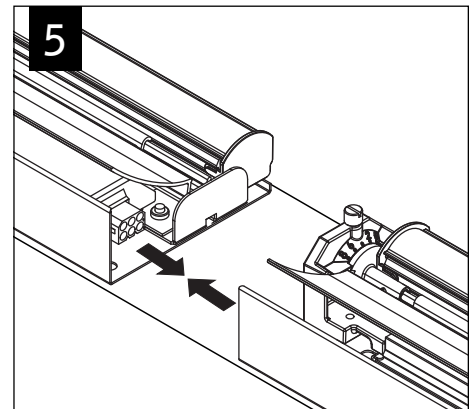

Luminaires must be installed by a qualified electrician (check with local and national codes for proper installation).
To prevent electrical shock, disconnect electrical supply before installation or servicing.

Contractor is responsible for adequately reinforcing walls and/or ceilings to support luminaire weight. Focal Point, LLC accepts no responsibility for inadequately reinforced walls and/or ceilings. The information contained in this drawing is the sole property of Focal Point, LLC. Any reproduction in part or whole without the written permission of Focal Point, LLC is prohibited.

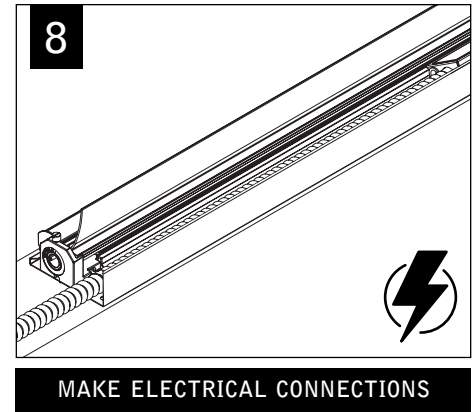
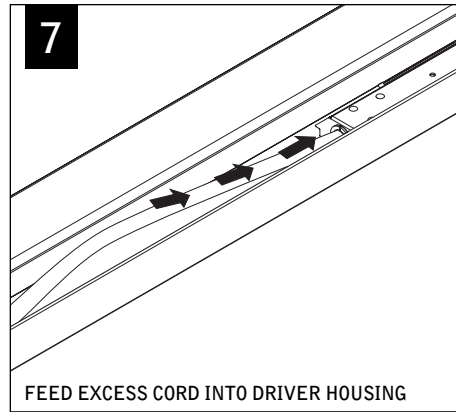
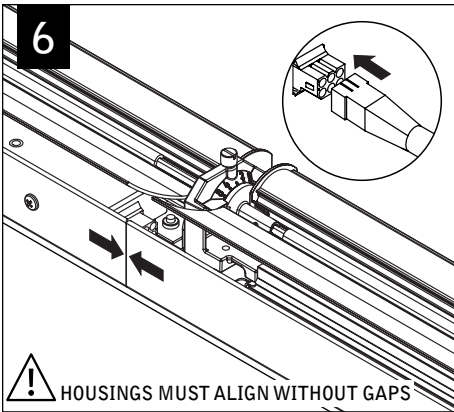

2' HOUSING ONLY

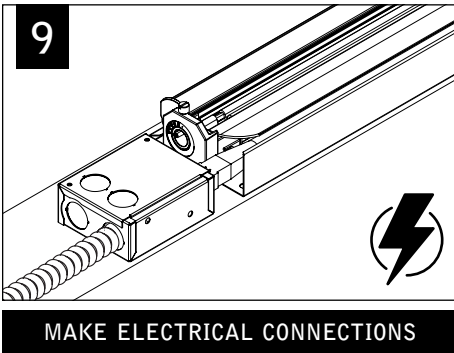

BEAM AIMING

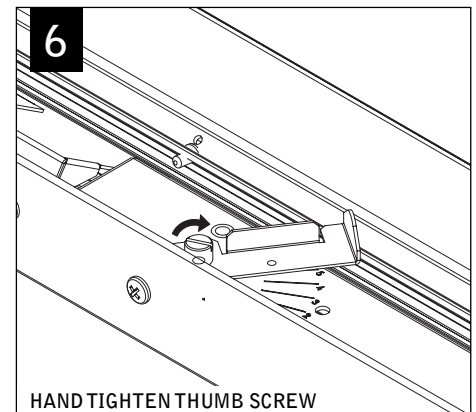
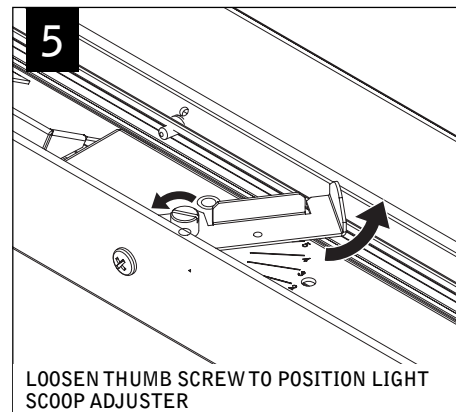
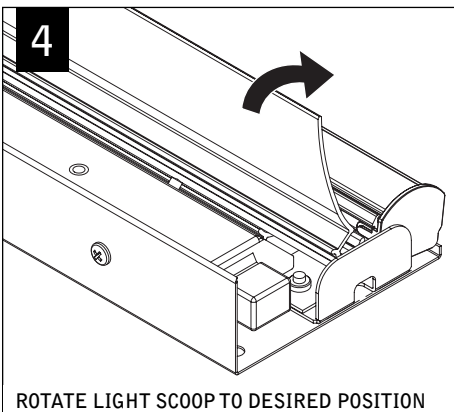
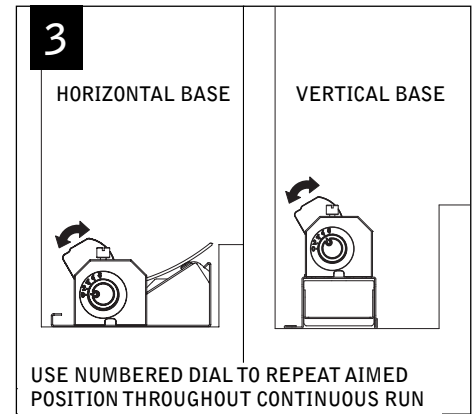
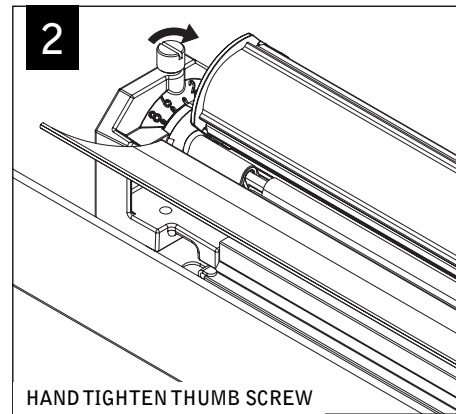
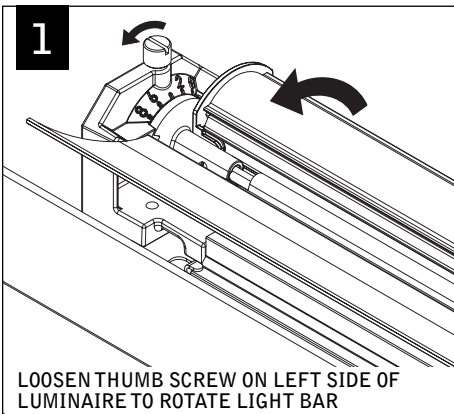

Luminaires must be installed by a qualified electrician (check with local and national codes for proper installation).
To prevent electrical shock, disconnect electrical supply before installation or servicing.

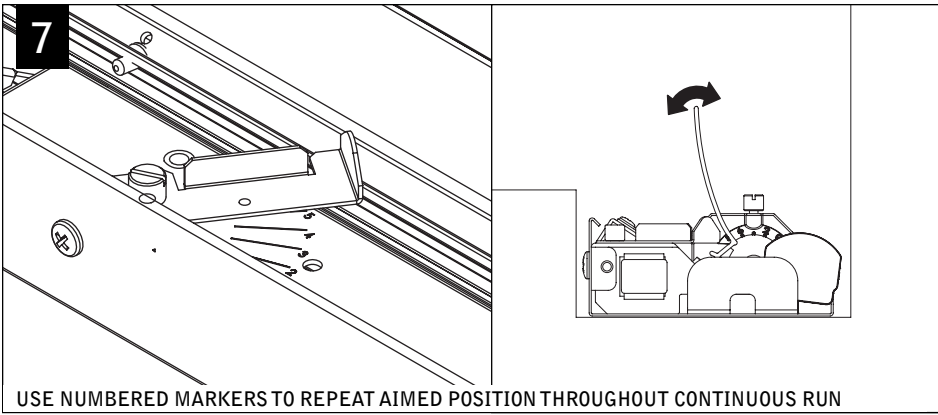

DRIVER SERVICE - HORIZONTAL BASE

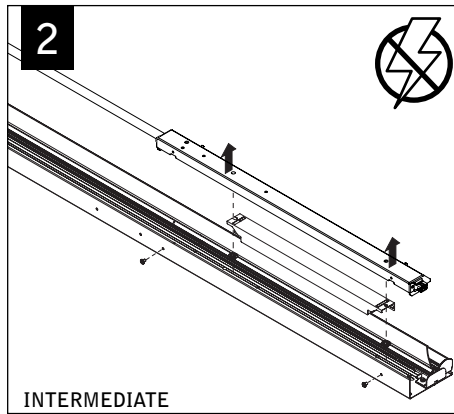
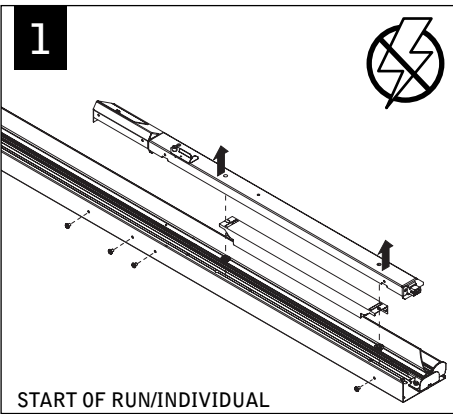

DRIVER SERVICE - VERTICAL BASE

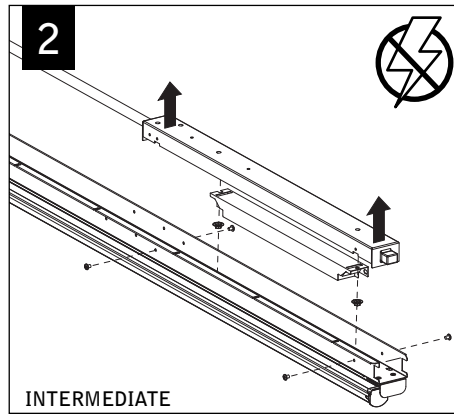
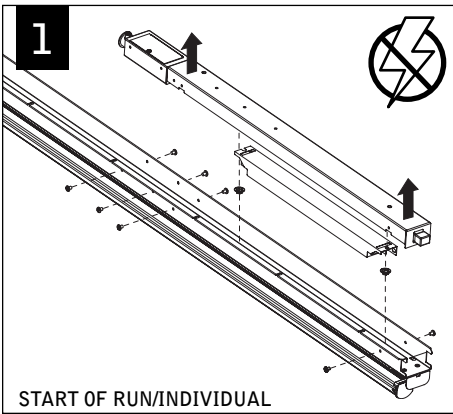

Luminaires must be installed by a qualified electrician (check with local and national codes for proper installation).
 To prevent electrical shock, disconnect electrical supply before installation or servicing.