

# Seem™ 1 grid ceiling

FSM1



FOCAL POINT™

**! CONFIGURATIONS ARE RUN SPECIFIC, PLEASE CONSULT FACTORY DRAWINGS BEFORE BEGINNING INSTALLATION. !**

## FOCAL POINT

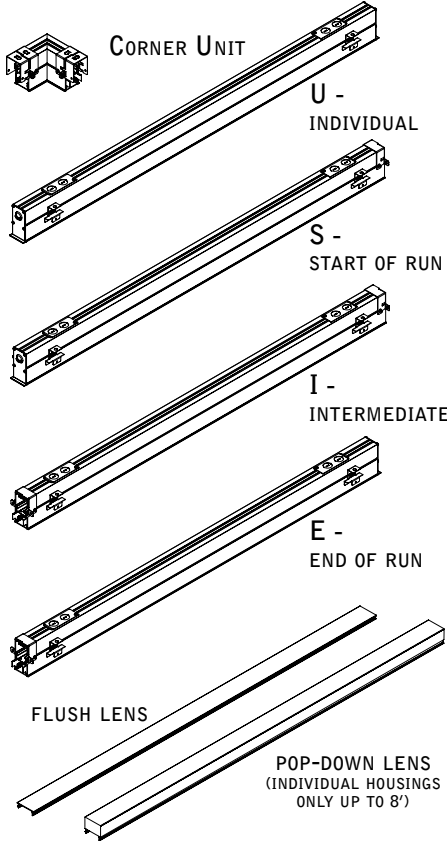

## PARTS LISTS

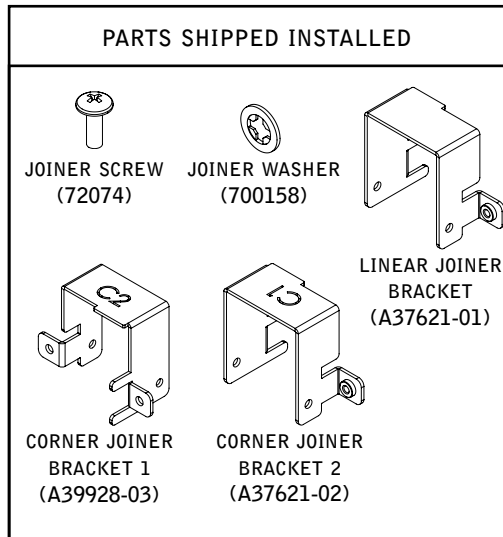
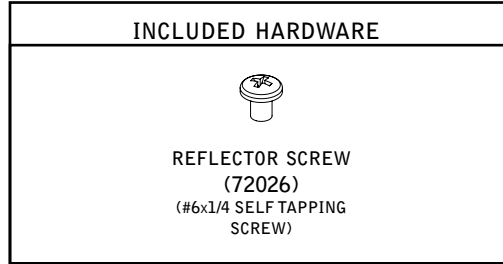

## KEY

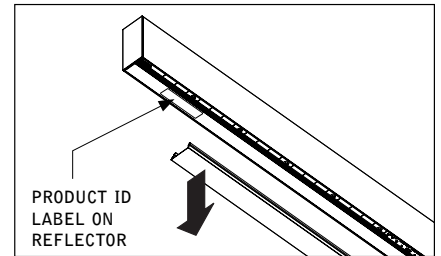
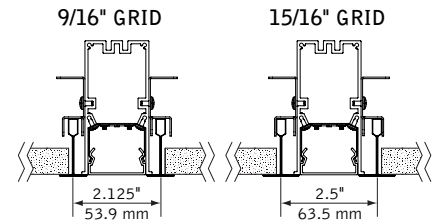
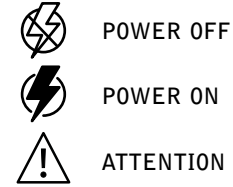

PRODUCT ID LOCATION

## RAIL & CLIP GUIDE

**! CHECK RAIL & CLIP POSITIONS BEFORE INSTALLATION. ARROWS INDICATE SCREW POSITIONS. TO CHANGE IN THE FIELD REMOVE AND REINSTALL ACCORDING TO DIAGRAMS BELOW.**

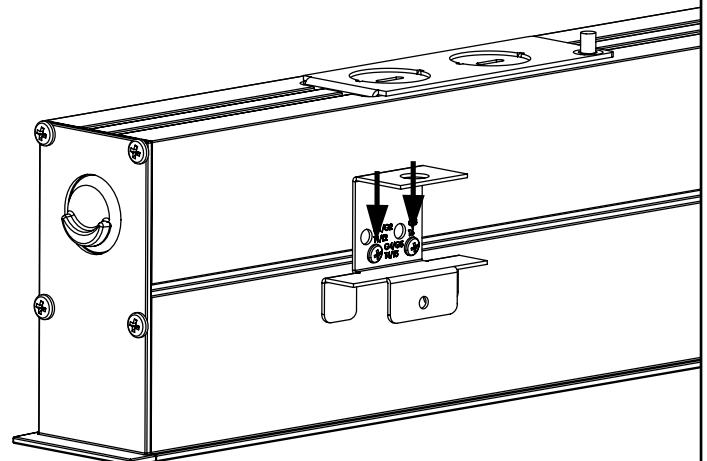
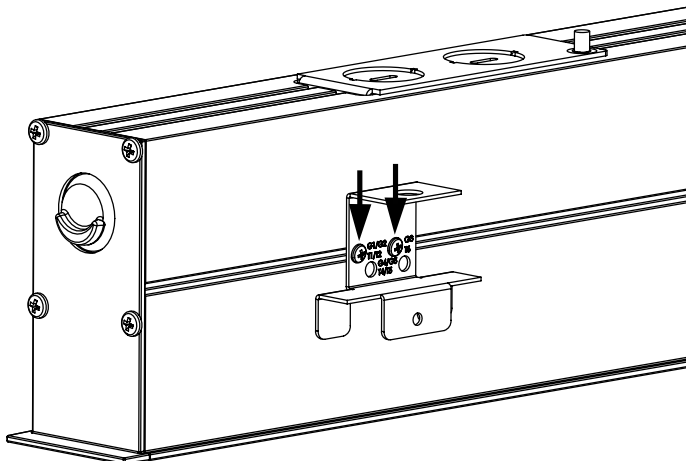

- |                                 |                             |
|---------------------------------|-----------------------------|
| G1: STD 15/16" LAY-IN TILE      | T1: STD 15/16" TEGULAR TILE |
| G2: STD 9/16" LAY-IN TILE       | T2: STD 9/16" TEGULAR TILE  |
| G3: 9/16" SLOT-TEE TEGULAR TILE | T6: 9/16" NODE TEGULAR TILE |

- |                             |                              |
|-----------------------------|------------------------------|
| G4: TALL 15/16" LAY-IN TILE | T4: TALL 15/16" TEGULAR TILE |
| G5: TALL 9/16" LAY-IN TILE  | T5: TALL 9/16" TEGULAR TILE  |
- ! STD = 1-1/2" TEE HEIGHT, TALL = 1-11/16" TEE HEIGHT**

Luminaires must be installed by a qualified electrician (check with local and national codes for proper installation). To prevent electrical shock, disconnect electrical supply before installation or servicing.

## CORNER ASSEMBLY

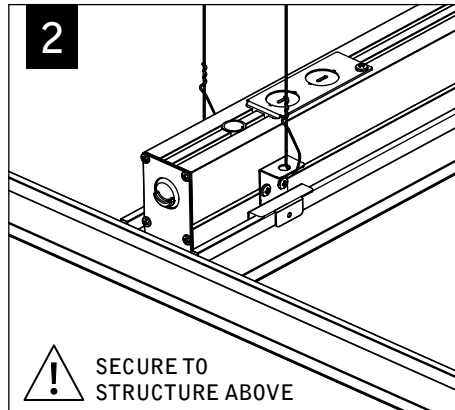
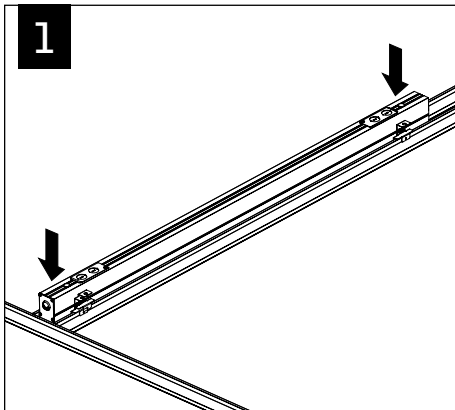
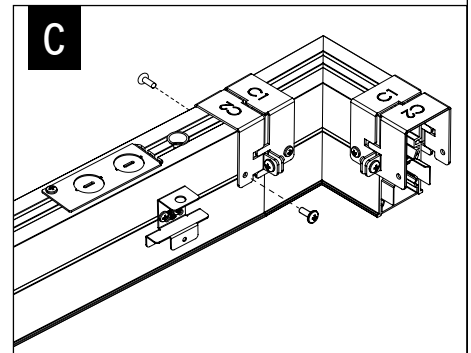
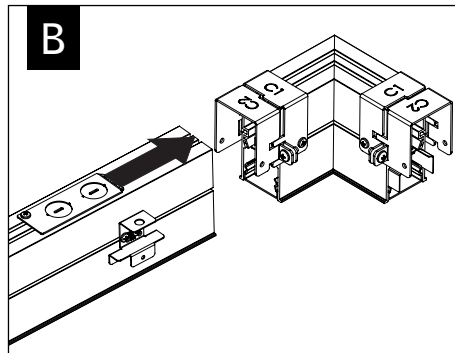
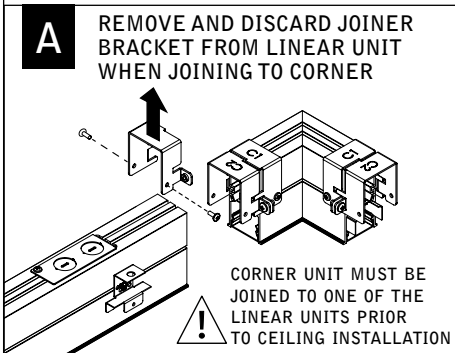

### INDIVIDUAL INSTALLATIONS SKIP TO STEP 6

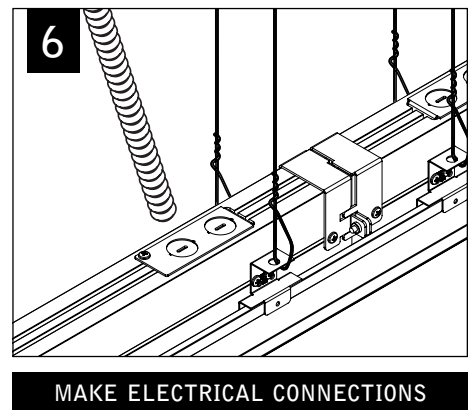
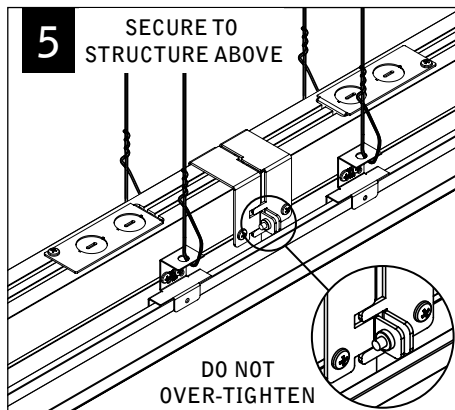
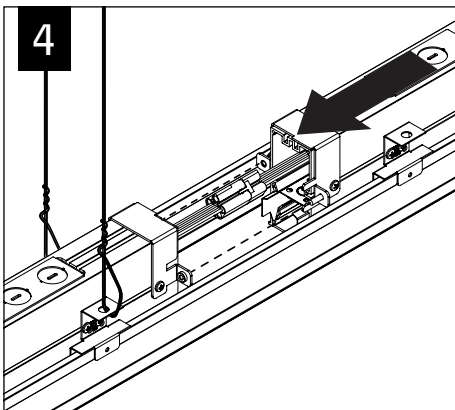
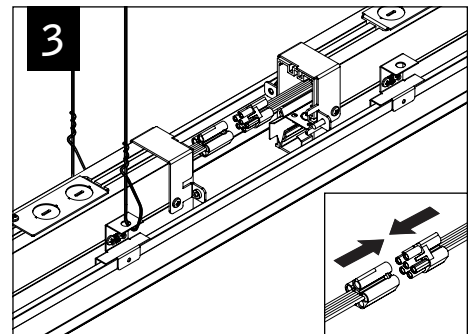

## ASYMMETRIC LENS DETAIL

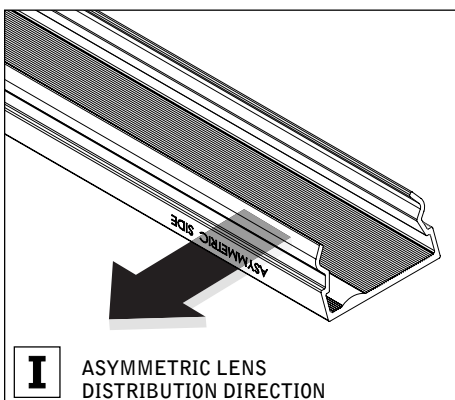

## DRIVER SERVICE

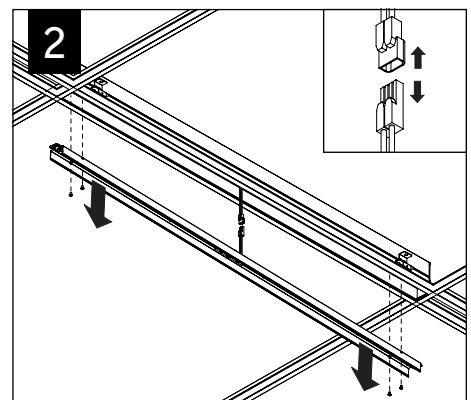
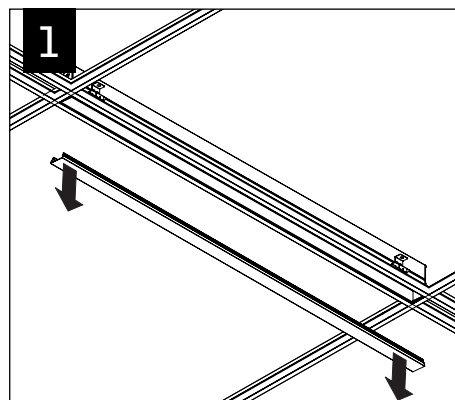

Contractor is responsible for adequately reinforcing walls and/or ceilings to support luminaire weight. Focal Point, LLC accepts no responsibility for inadequately reinforced walls and/or ceilings. The information contained in this drawing is the sole property of Focal Point, LLC. Any reproduction in part or whole without the written permission of Focal Point, LLC is prohibited.