

# Luna<sup>®</sup> led surface mount/suspended

FLUL-22 | FLUL-24



FOCAL POINT<sup>®</sup>

**⚠️ AVOID ALL CONTACT WITH LED SURFACE, LEDS ARE EASILY DAMAGED!**

FOCAL POINT

SURFACE MOUNT

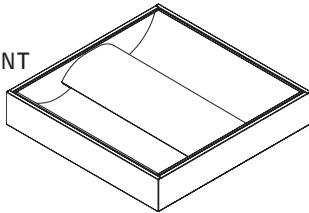

SUSPENDED

UNIVERSAL  
SUSPENSION  
SYSTEM - SHIPS  
SEPARATELY

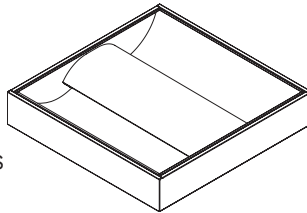

KEY



POWER OFF



POWER ON



ATTENTION

## SURFACE MOUNT

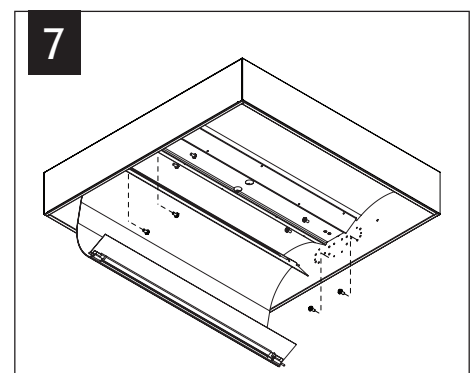
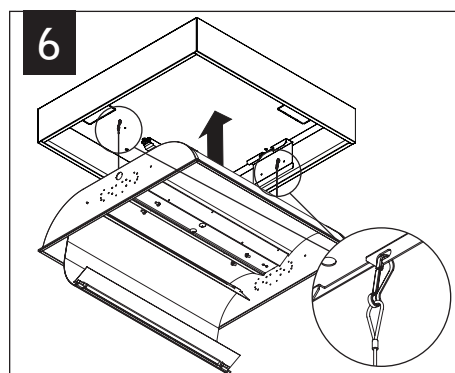
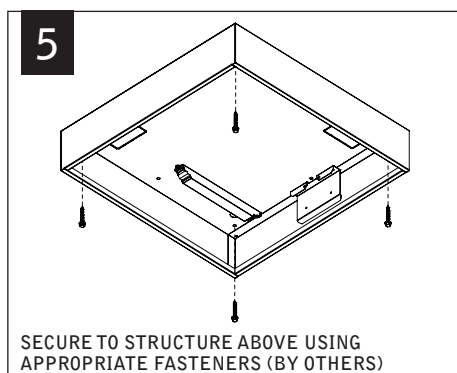
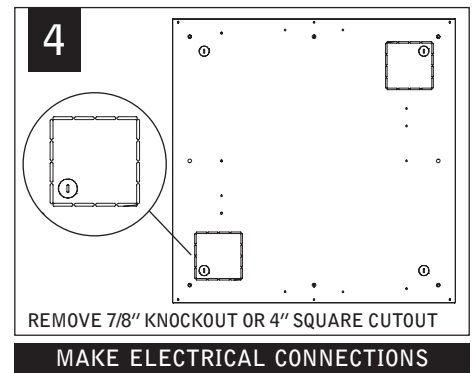
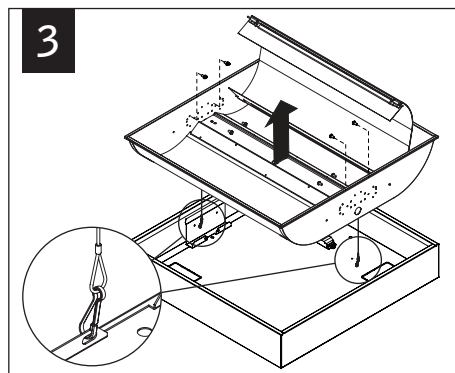
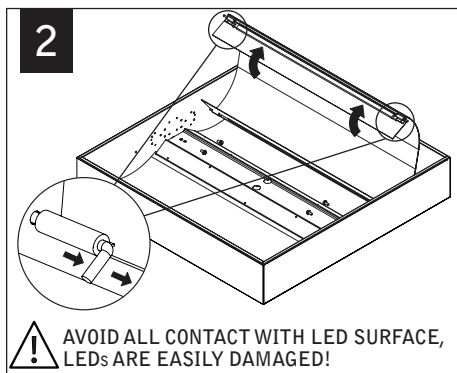
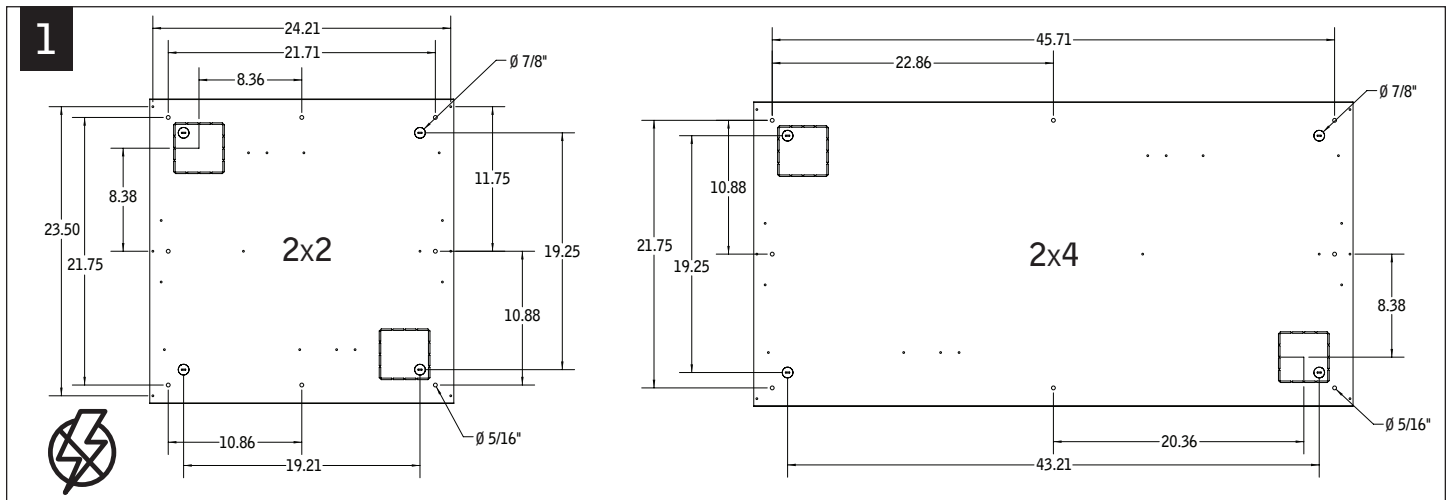

Luminaires must be installed by a qualified electrician (check with local and national codes for proper installation).  
To prevent electrical shock, disconnect electrical supply before installation or servicing.

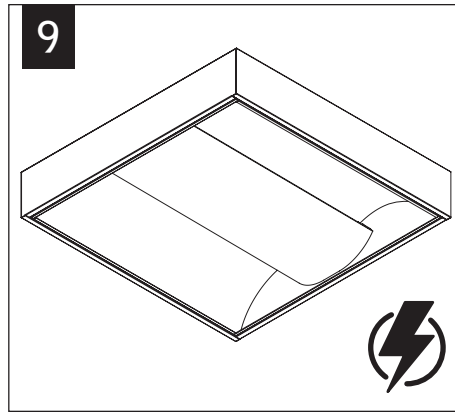
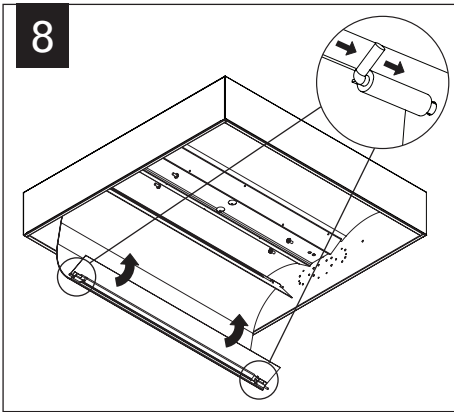

**SUSPENDED**

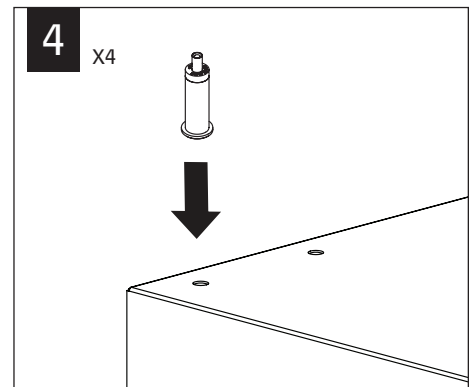
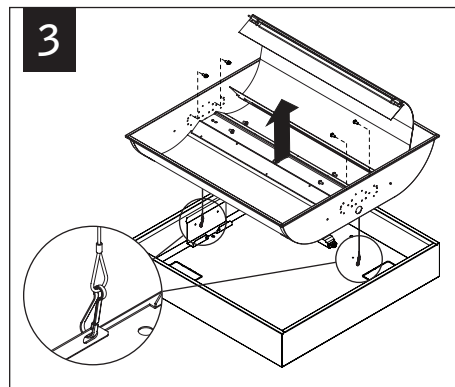
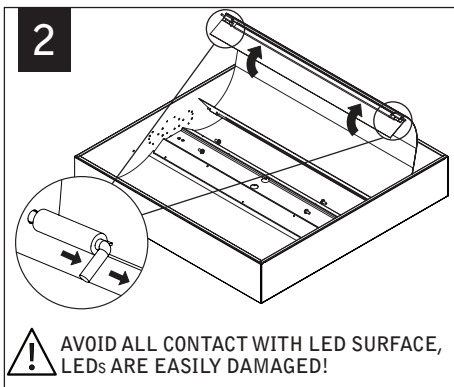
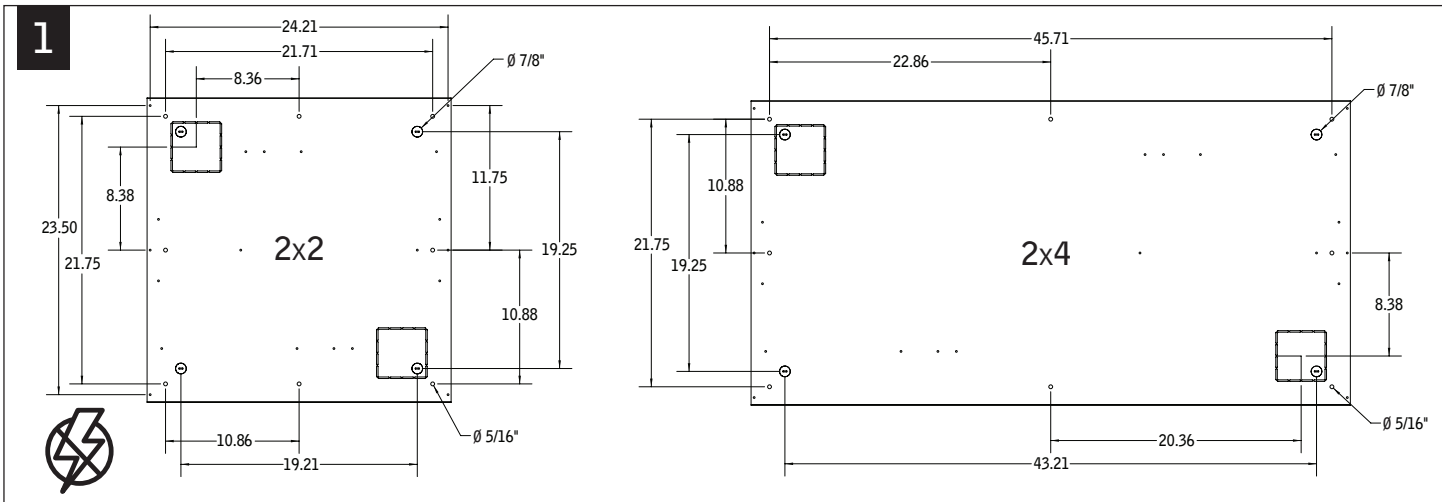

**5**

**FOLLOW FOCAL POINT INSTRUCTIONS FOR UNIVERSAL SUSPENSION SYSTEM ASSEMBLY. SEE IS0166**

**I**

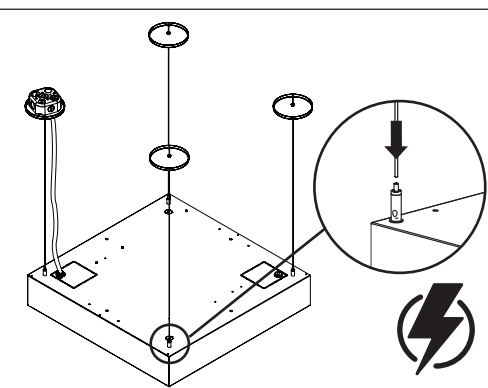

Luminaires must be installed by a qualified electrician (check with local and national codes for proper installation). To prevent electrical shock, disconnect electrical supply before installation or servicing.

## DRIVER SERVICE

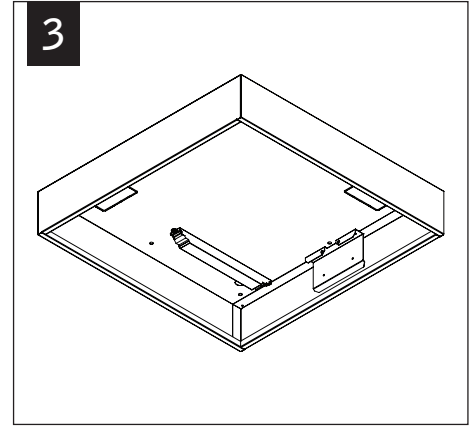
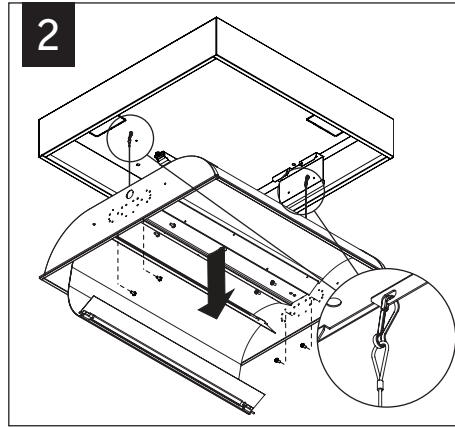
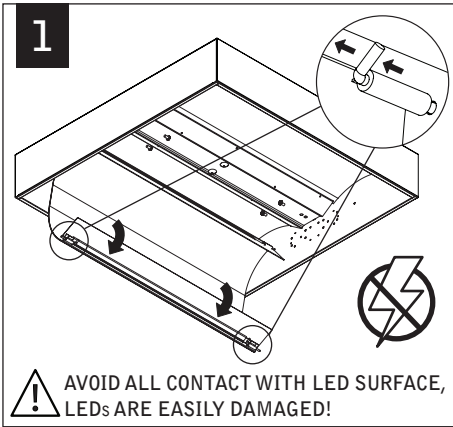

## EMERGENCY



SEE BATTERY MANUFACTURER  
INSTRUCTIONS

EMERGENCY MAXIMUM MOUNTING HEIGHT:  
24'