

ID+ 3.5" Pure Cylinder - Cord Suspension

FLCY3N-RD-4H | FLCY3N-RD-7H- Mini Power Canopy



FOCAL POINT®

BEFORE YOU BEGIN

- Luminaires must be installed by a qualified electrician (check with local and national codes for proper installation).
- To prevent electrical shock, disconnect electrical supply before installation or servicing.
- Contractor is responsible for adequately reinforcing walls and/or ceilings to support fixture weight.
- Focal Point, LLC accepts no responsibility for inadequately reinforced walls and/or ceilings.
- The information contained in this drawing is the sole property of Focal Point, LLC. Any reproduction in part or whole without the written permission of Focal Point, LLC is prohibited.

INSTRUCTION KEY

- ATTENTION
- SEE ADDITIONAL INSTRUCTIONS
- POWER OFF
- POWER ON

COMPONENT KEY

ID+ CYLINDER

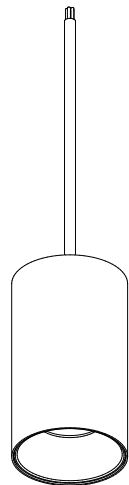

7" HOUSING HEIGHT

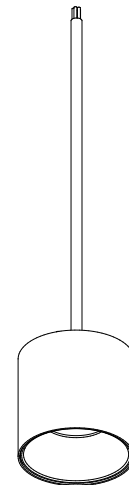

4" HOUSING HEIGHT

MINI POWER CANOPY

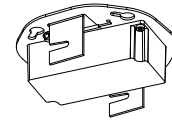

J-BOX MOUNTING BRACKET / DRIVER CARRIAGE

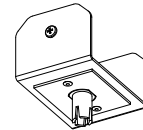

POWER CORD MOUNTING BRACKET

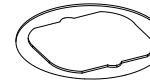

FINISHING RING

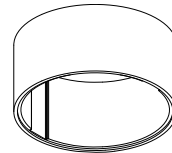

MINI POWER CANOPY

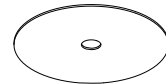

FACE PLATE



STRAIN RELIEF

4" OCTAGONAL J-BOX REQUIRED

J-BOX BY OTHERS

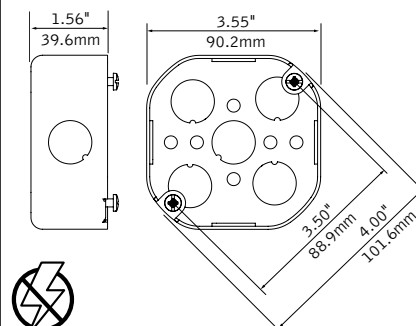

EMERGENCY



PRIOR TO LUMINAIRE INSTALLATION, SEE **PAGE 4** FOR EMERGENCY INSTALLATION INSTRUCTIONS.

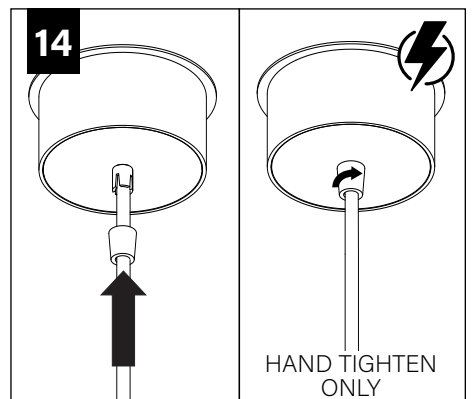
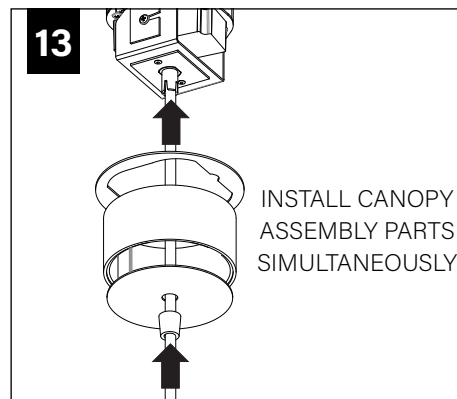
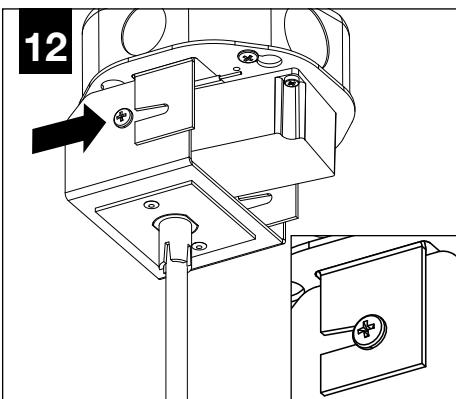
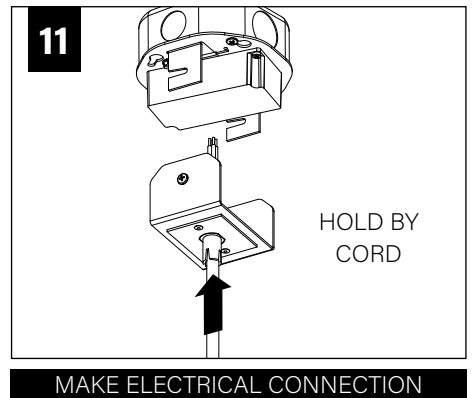
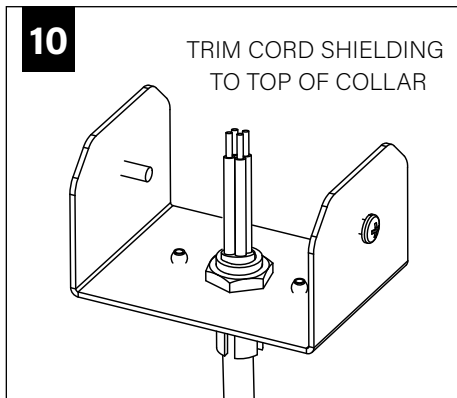
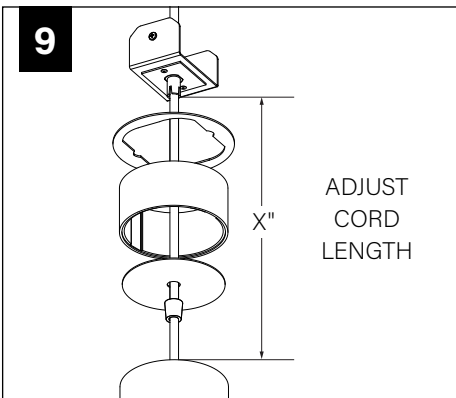
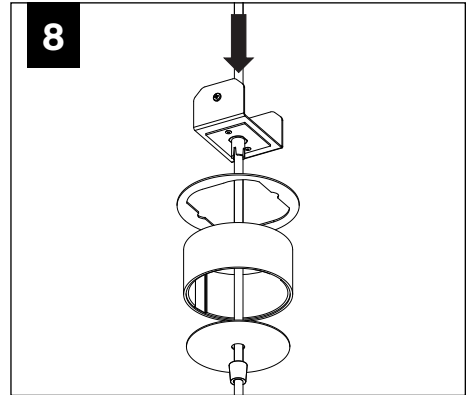
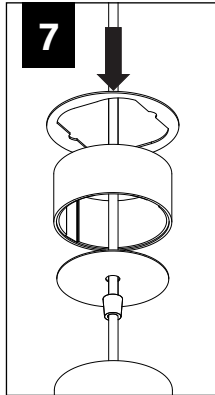
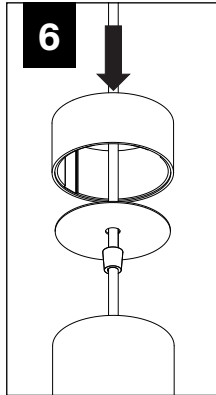
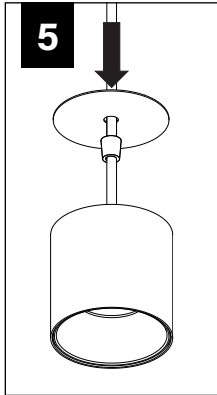
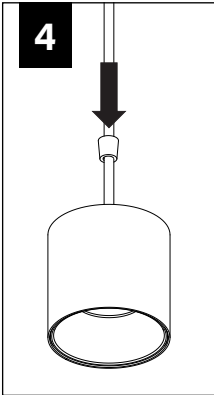
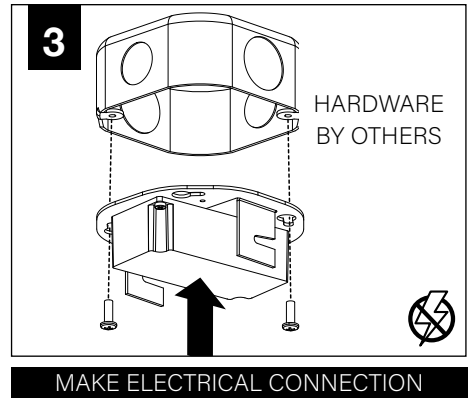
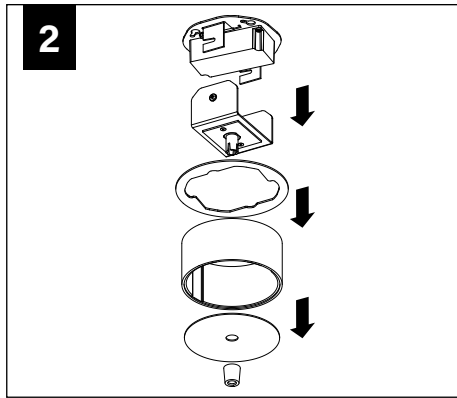
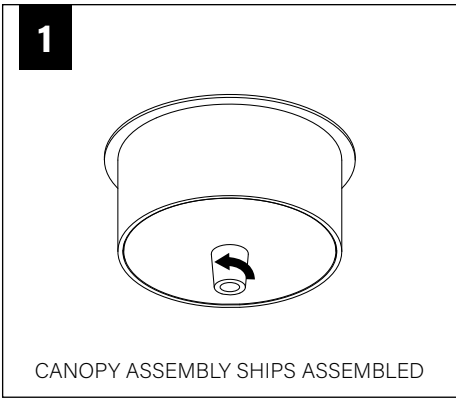

DRIVER SERVICE



TURN OFF POWER SOURCE
PRIOR TO DRIVER SERVICE

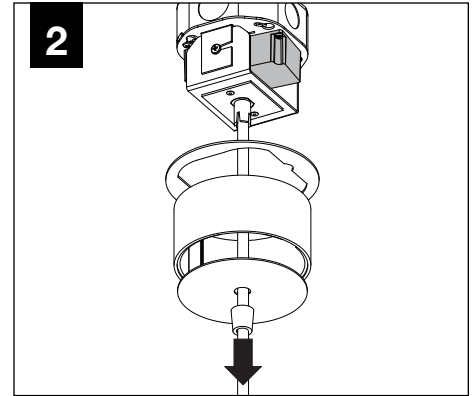
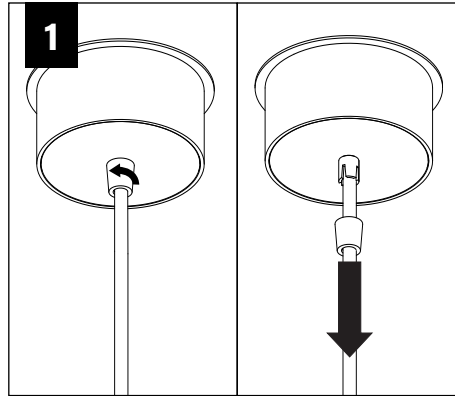

OPTIC SERVICE

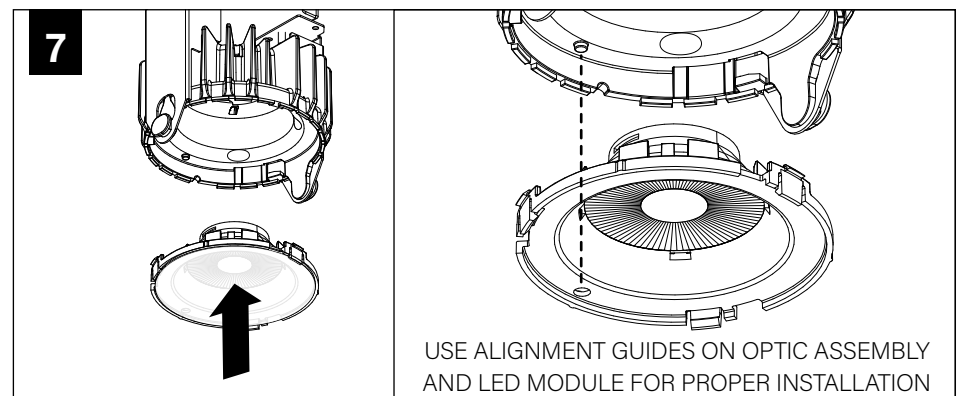
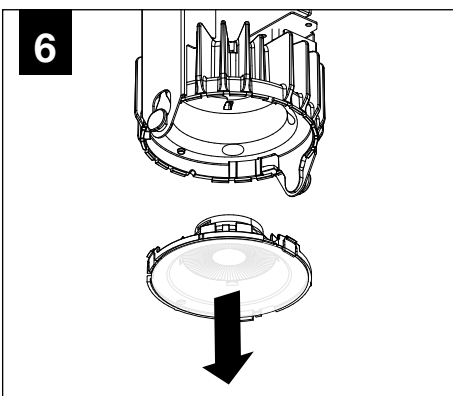
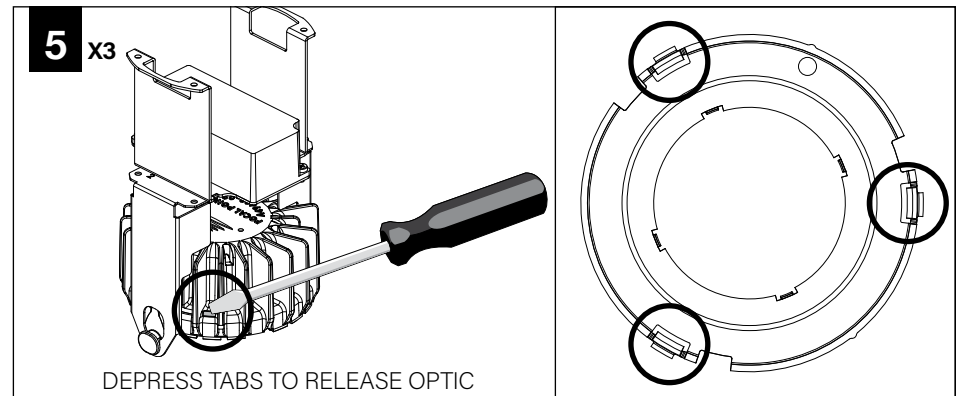
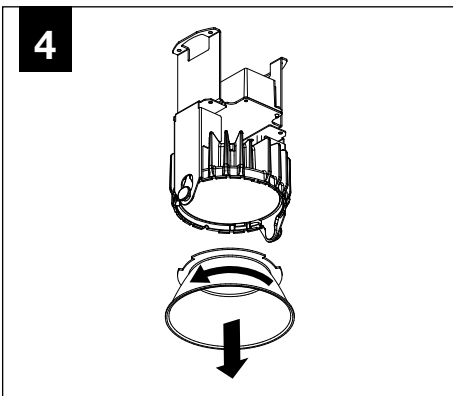
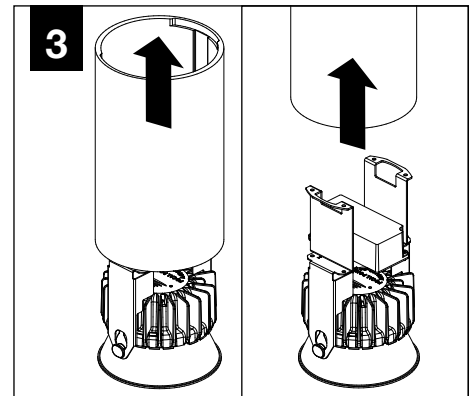
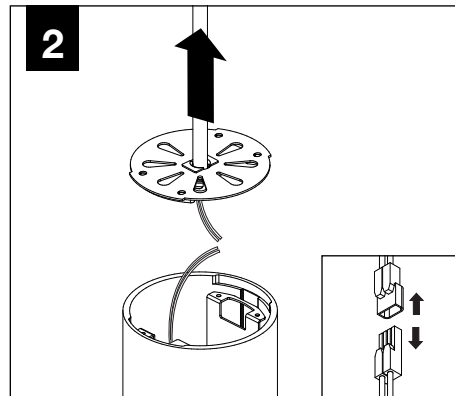
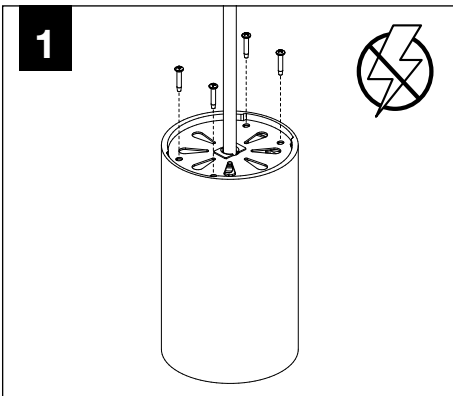

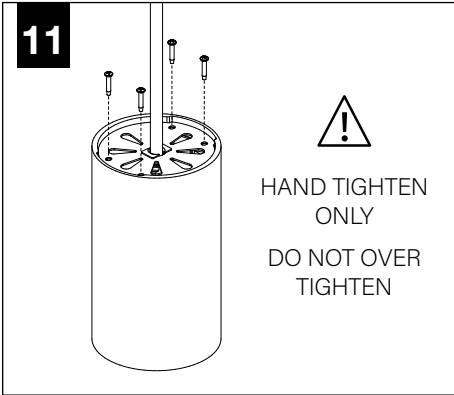
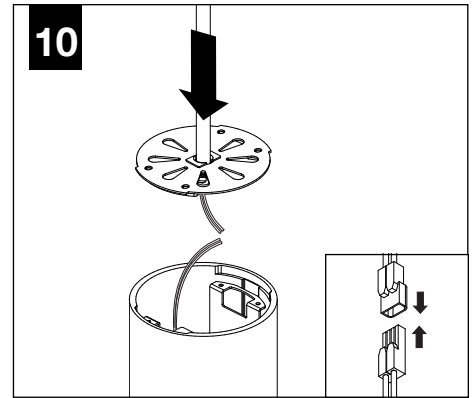
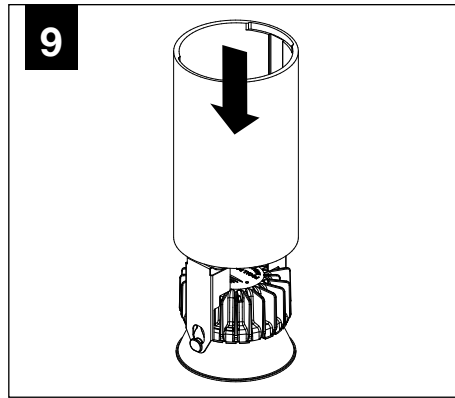
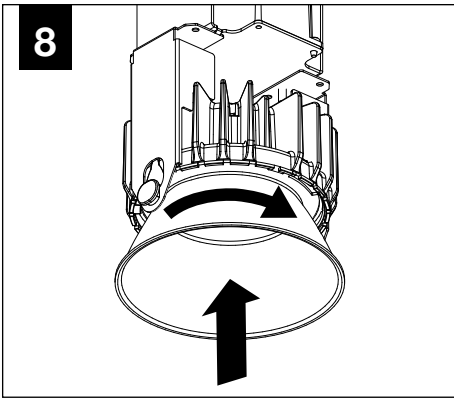

EMERGENCY

